

Isle of Man Government: General Registry

PLANS DEPOSITED IN THE
ROLLS OFFICE
UNDER THE
TITHE COMMUTATION ACT
1839

PARISH OF SANTON

(1 - 76)

Microfilm Data (IOM) Ltd., Alpine Mews,
Strathallan Lane, Onchan, Isle of Man, IM3 1NL

May 1997

NOTES

The plans have been filmed in their bound state

This will have caused some image distortion particularly where large plans go into the binding gutter and/or have been folded

Many of the larger plans are damaged

Where plans are coloured this has been noted; 'monochrome' indicates a single ink colour which may be black, brown or blue

START OF VOLUME

A
Plan and Survey
of
SEAFIELD ESTATE
in the Parish of
S' ANN
belonging to
Cesar Bacon Esqr.

STAVACH
BALA
KILBY
Mr John Crebbin

BALLA VILLETT

M W MOORE

BALLEPPIGIN

John Conall

J. C. LUCAS ESQR

Belonging to

Clay
through

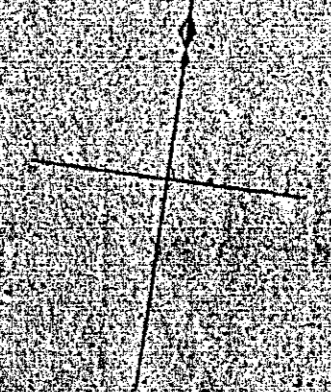

Handwritten notes and signatures in the right margin.

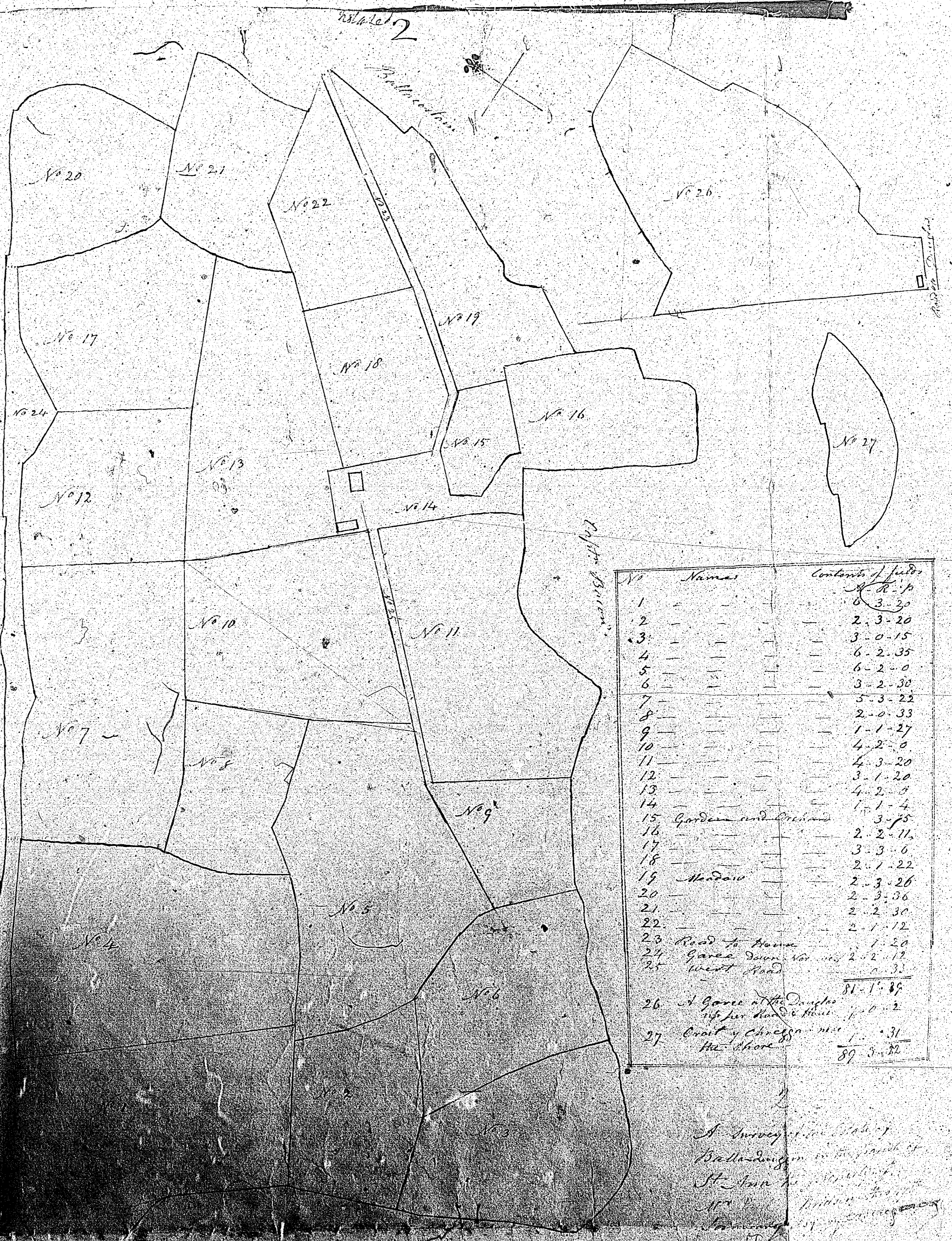

No.	Names	Contents of fields
1		6-3-30
2		2-3-20
3		3-0-15
4		6-2-35
5		6-2-0
6		3-2-30
7		3-3-22
8		2-0-33
9		1-1-27
10		4-2-0
11		4-3-20
12		3-1-20
13		4-2-8
14		1-1-4
15	Garden and Orchard	3-7-8
16		2-2-16
17		3-3-6
18		2-1-22
19	Meadow	2-3-26
20		2-3-36
21		2-2-30
22		2-1-12
23	Road to Home	1-2-0
24	Grove down West side	2-2-12
25	West Road	0-3-3
		<hr/>
		81-1-86
26	A Grove at the Dingle up for Road & House	1-0-2
27	Croft & Orchard near the shore	1-0-31
		<hr/>
		89-3-22

A Survey of the Estate of
Balladunghy in the Parish of
St. John the Baptist
County of Wick
Ireland
Surveyed by
J. J. [Name]

