

START OF VOLUME

PLAN
 OF
SURBY
 the property of
EDWARD J. G. WALES
 in the Parish of
RUSHEN
 Survey taken 1838
 by J. P. P. P.
 South St. Douglas

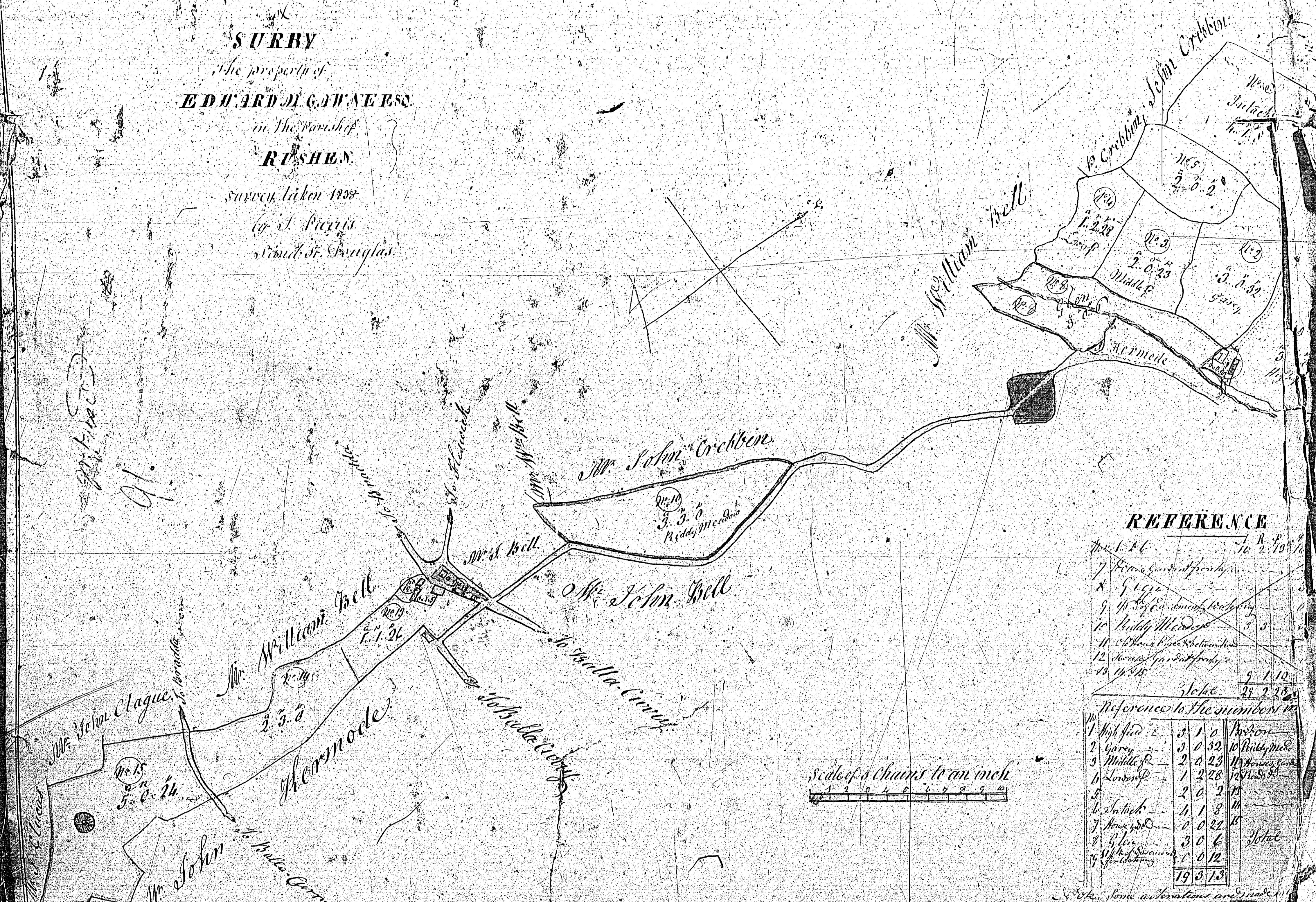

REFERENCE

No. 1	16	No. 17	10
No. 2	16	No. 18	10
No. 3	16	No. 19	10
No. 4	16	No. 20	10
No. 5	16	No. 21	10
No. 6	16	No. 22	10
No. 7	16	No. 23	10
No. 8	16	No. 24	10
No. 9	16	No. 25	10
No. 10	16	No. 26	10
No. 11	16	No. 27	10
No. 12	16	No. 28	10
No. 13	16	No. 29	10
No. 14	16	No. 30	10
No. 15	16	No. 31	10
No. 16	16	No. 32	10
No. 17	16	No. 33	10
No. 18	16	No. 34	10
No. 19	16	No. 35	10
No. 20	16	No. 36	10
No. 21	16	No. 37	10
No. 22	16	No. 38	10
No. 23	16	No. 39	10
No. 24	16	No. 40	10
No. 25	16	No. 41	10
No. 26	16	No. 42	10
No. 27	16	No. 43	10
No. 28	16	No. 44	10
No. 29	16	No. 45	10
No. 30	16	No. 46	10
No. 31	16	No. 47	10
No. 32	16	No. 48	10
No. 33	16	No. 49	10
No. 34	16	No. 50	10
No. 35	16	No. 51	10
No. 36	16	No. 52	10
No. 37	16	No. 53	10
No. 38	16	No. 54	10
No. 39	16	No. 55	10
No. 40	16	No. 56	10
No. 41	16	No. 57	10
No. 42	16	No. 58	10
No. 43	16	No. 59	10
No. 44	16	No. 60	10
No. 45	16	No. 61	10
No. 46	16	No. 62	10
No. 47	16	No. 63	10
No. 48	16	No. 64	10
No. 49	16	No. 65	10
No. 50	16	No. 66	10
No. 51	16	No. 67	10
No. 52	16	No. 68	10
No. 53	16	No. 69	10
No. 54	16	No. 70	10
No. 55	16	No. 71	10
No. 56	16	No. 72	10
No. 57	16	No. 73	10
No. 58	16	No. 74	10
No. 59	16	No. 75	10
No. 60	16	No. 76	10
No. 61	16	No. 77	10
No. 62	16	No. 78	10
No. 63	16	No. 79	10
No. 64	16	No. 80	10
No. 65	16	No. 81	10
No. 66	16	No. 82	10
No. 67	16	No. 83	10
No. 68	16	No. 84	10
No. 69	16	No. 85	10
No. 70	16	No. 86	10
No. 71	16	No. 87	10
No. 72	16	No. 88	10
No. 73	16	No. 89	10
No. 74	16	No. 90	10
No. 75	16	No. 91	10
No. 76	16	No. 92	10
No. 77	16	No. 93	10
No. 78	16	No. 94	10
No. 79	16	No. 95	10
No. 80	16	No. 96	10
No. 81	16	No. 97	10
No. 82	16	No. 98	10
No. 83	16	No. 99	10
No. 84	16	No. 100	10

Scale of 6 Chains to an inch

ISLE OF MAN GOVERNMENT: GENERAL REGISTRY
 TITHE PLANS: PARISH OF RUSHEN
 Original coloured 1:30

Part of Shenvalley, in Rushen
belonging to Geo. Crute. Nov 1840.

Q2

Total Contents $\frac{10 \cdot 2 \cdot 4}{10 \cdot 3 \cdot 22}$

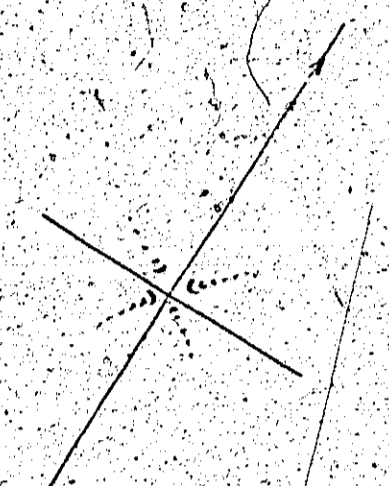

Cunninghamie, (Winors)



Scale of 3 Chains to an Inch
Jefferson & Nagell Surveyors.

ISLE OF MAN GOVERNMENT: GENERAL REGISTRY

TITHE PLANS: PARISH OF RUSHEN

Original monotone

1:30

95
Mr. Palk Canon

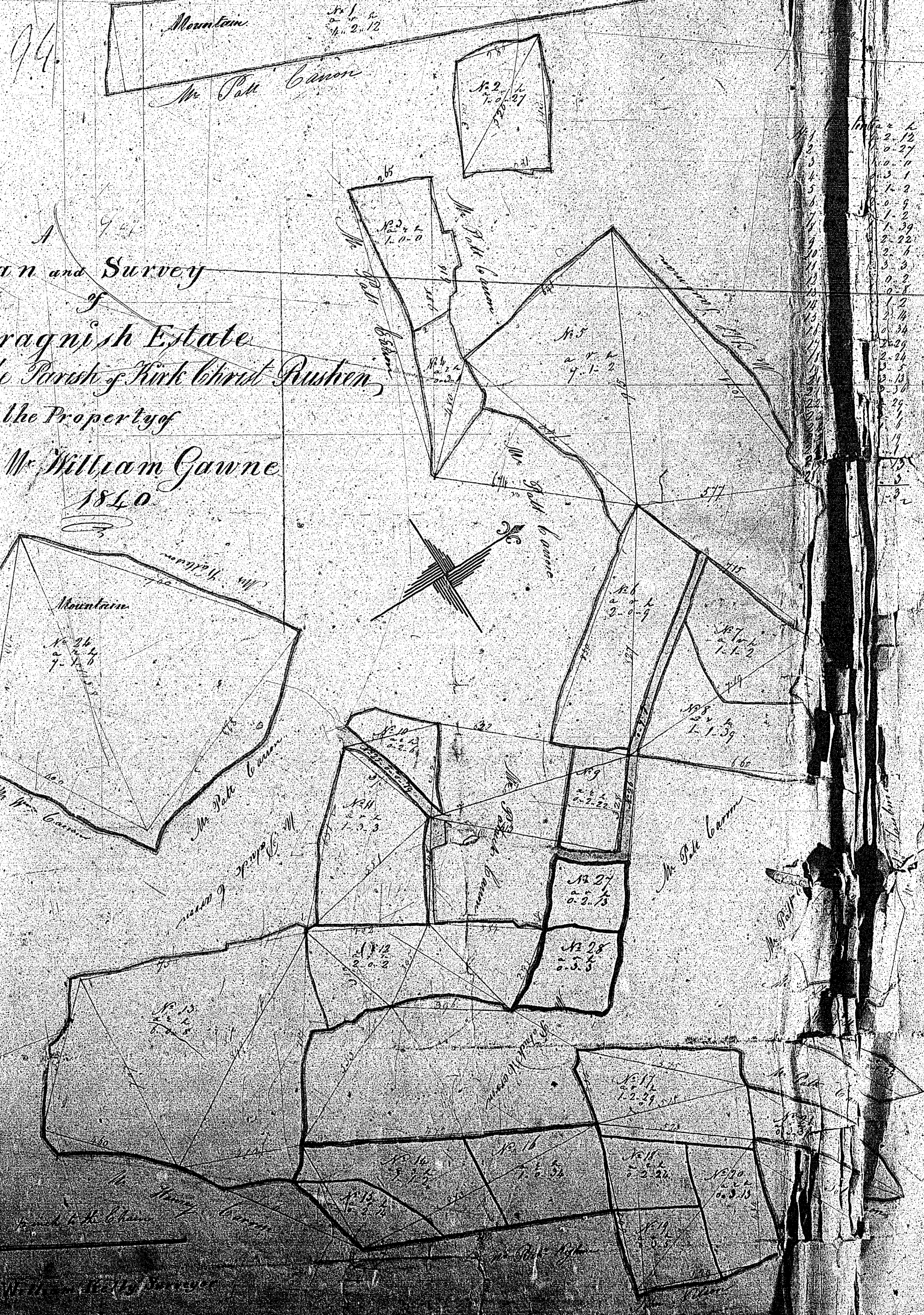

94
A
Plan and Survey
of
Craguish Estate
in the Parish of Kink Christ Rushen,
the Property of
Mr. William Gawne
1840

100
101
102
103
104
105
106
107
108
109
110
111
112
113
114
115
116
117
118
119
120
121
122
123
124
125
126
127
128
129
130
131
132
133
134
135
136
137
138
139
140
141
142
143
144
145
146
147
148
149
150
151
152
153
154
155
156
157
158
159
160
161
162
163
164
165
166
167
168
169
170
171
172
173
174
175
176
177
178
179
180
181
182
183
184
185
186
187
188
189
190
191
192
193
194
195
196
197
198
199
200

ISLE OF MAN GOVERNMENT: GENERAL REGISTRY
TITHE PLANS: PARISH OF RUSHEN
Original coloured
1:30

95

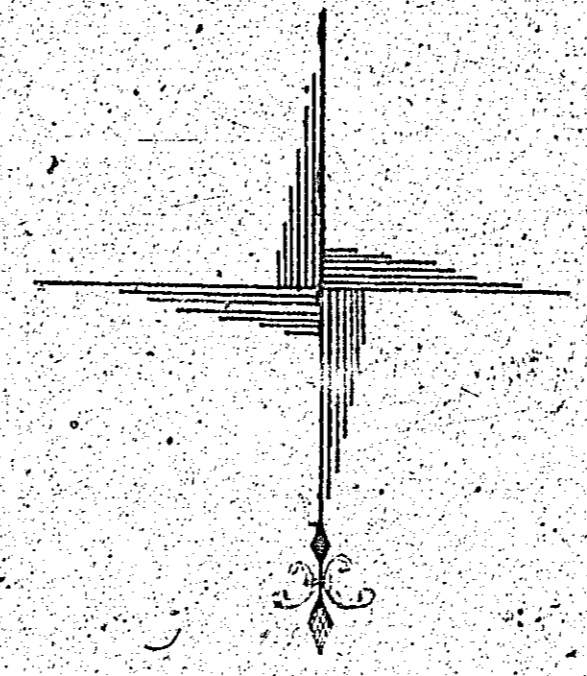

A Plan and Survey
 of
GLENDOWN
 in the Parish of Kirk Christ Church
 the Property of
 M^r W^m Cawne
 1840

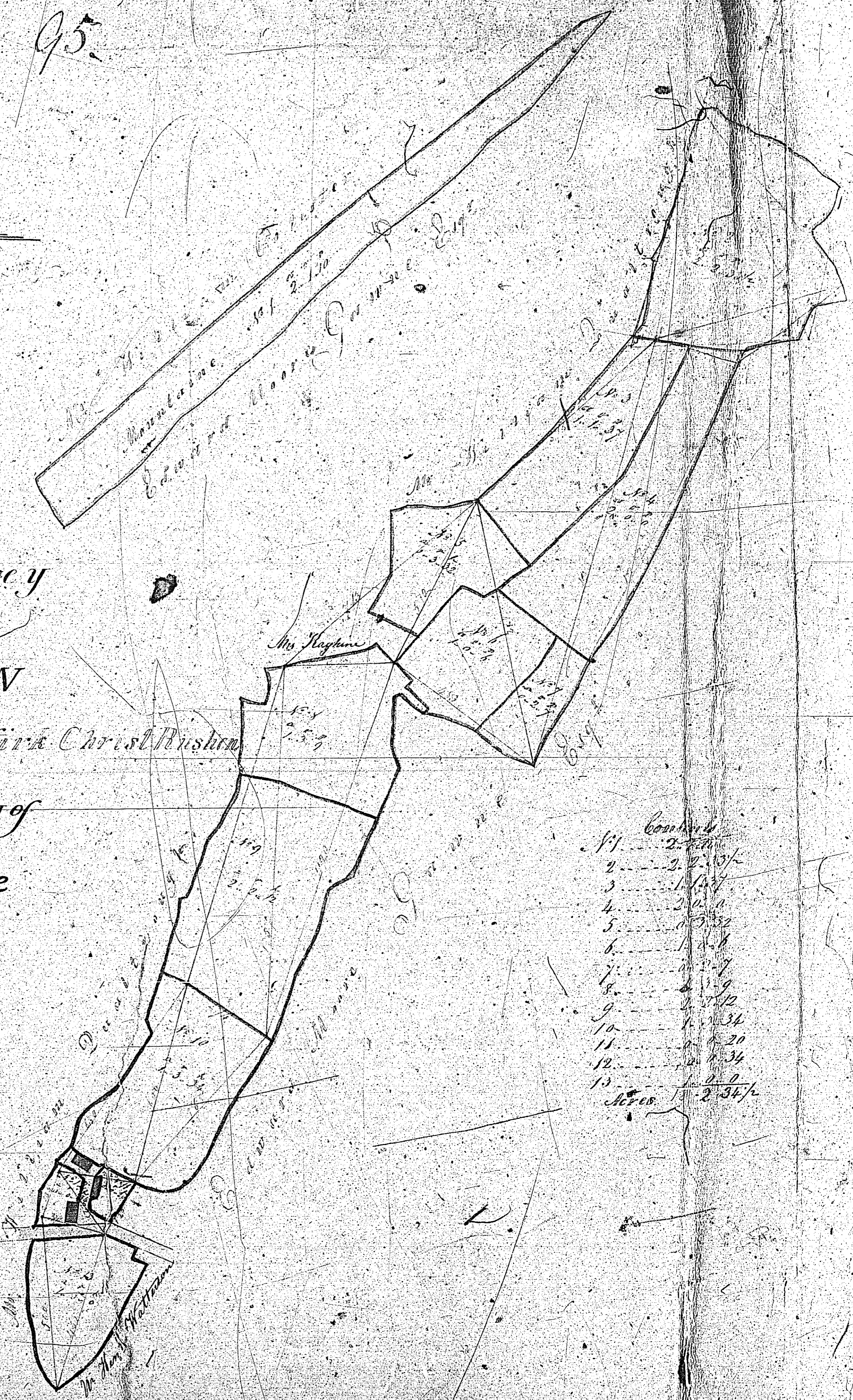

Plot	Contents
1	2. 1/2
2	2. 1/2
3	1. 1/2
4	2. 1/2
5	2. 1/2
6	1. 1/2
7	2. 1/2
8	2. 1/2
9	2. 1/2
10	2. 1/2
11	2. 1/2
12	2. 1/2
13	2. 1/2
Total	2. 34/4

As per the Chart
 William Kelly Surveyor