

163.

163
PLAN
OF THE INTACK ESTATE OR
GLENDHOO
IN THE PARISH OF ONCHAN IN THE
ISLE OF MAN
THE PROPERTY OF
C. W. S. [illegible]

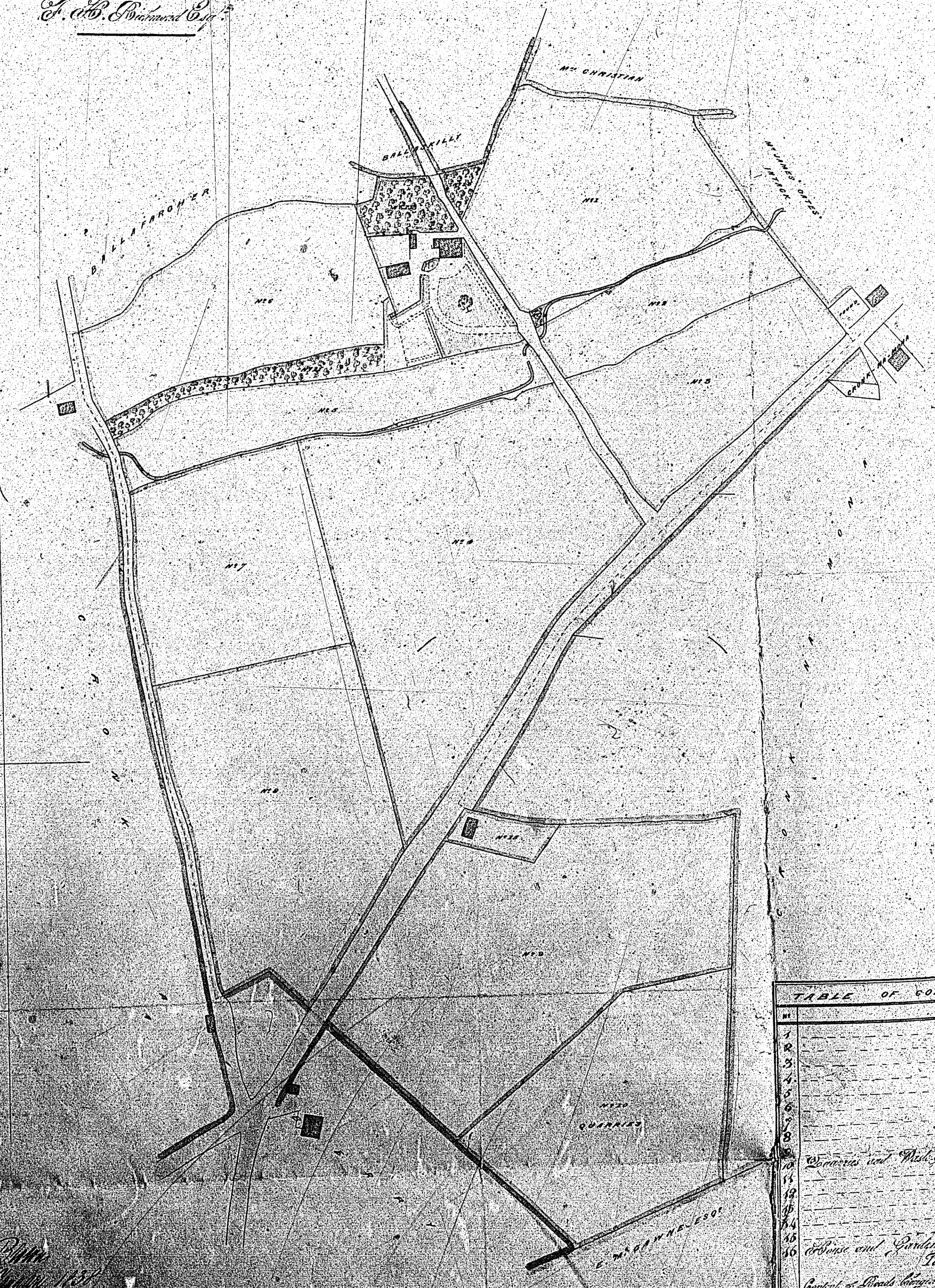

TABLE OF CONTENTS

No.	Description	Acres	Roods	Poles
1		2	16	
2		8	24	
3		4	30	
4		4	10	
5		4	13	
6		2	16	
7		2	11	
8		5	37	
9		2	5	
10	Demeris and Mill ground	2	18	
11		1	56	
12		1	14	
13		1	8	
14		2	30	
15	House and Garden	2	30	
16	Total	26	33	
17	Contd of [illegible]	1	15	

164
Plan of Dwelling Houses & Gardens

Situate in the
Parish of Cuckfield

belonging to
John Mearns, John Christian

and
Henry Robinson

Jan 18th 1841
(Finch Road, beyle)

John Mearns 1-2-8
John Christian 0-0-15
Henry Robinson 0-0-10

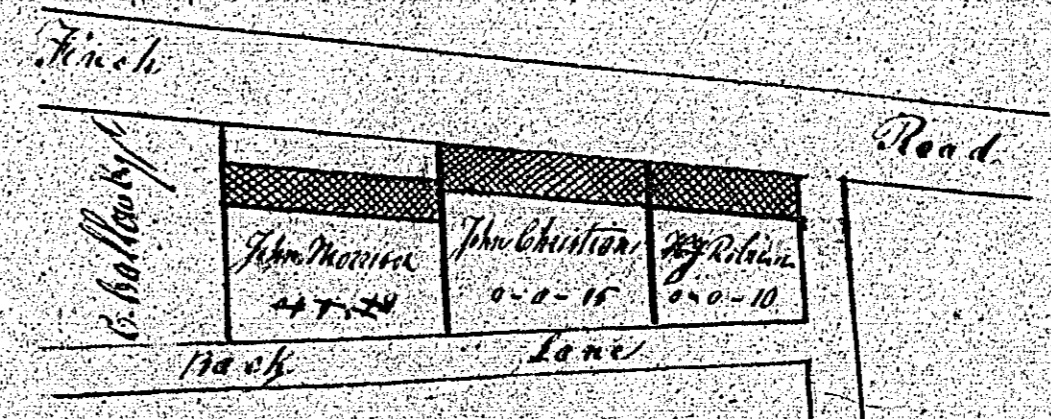

On Chain to be made
by Joseph Blake Surveyor
of Mearns given to be built by the godparents

1841

There is no plan
numbered 166

Plan
 of part of the
 Estate of Demakague
 in the
 Parish of Cuckham
 in the County of
 Middlesex
 March 1644

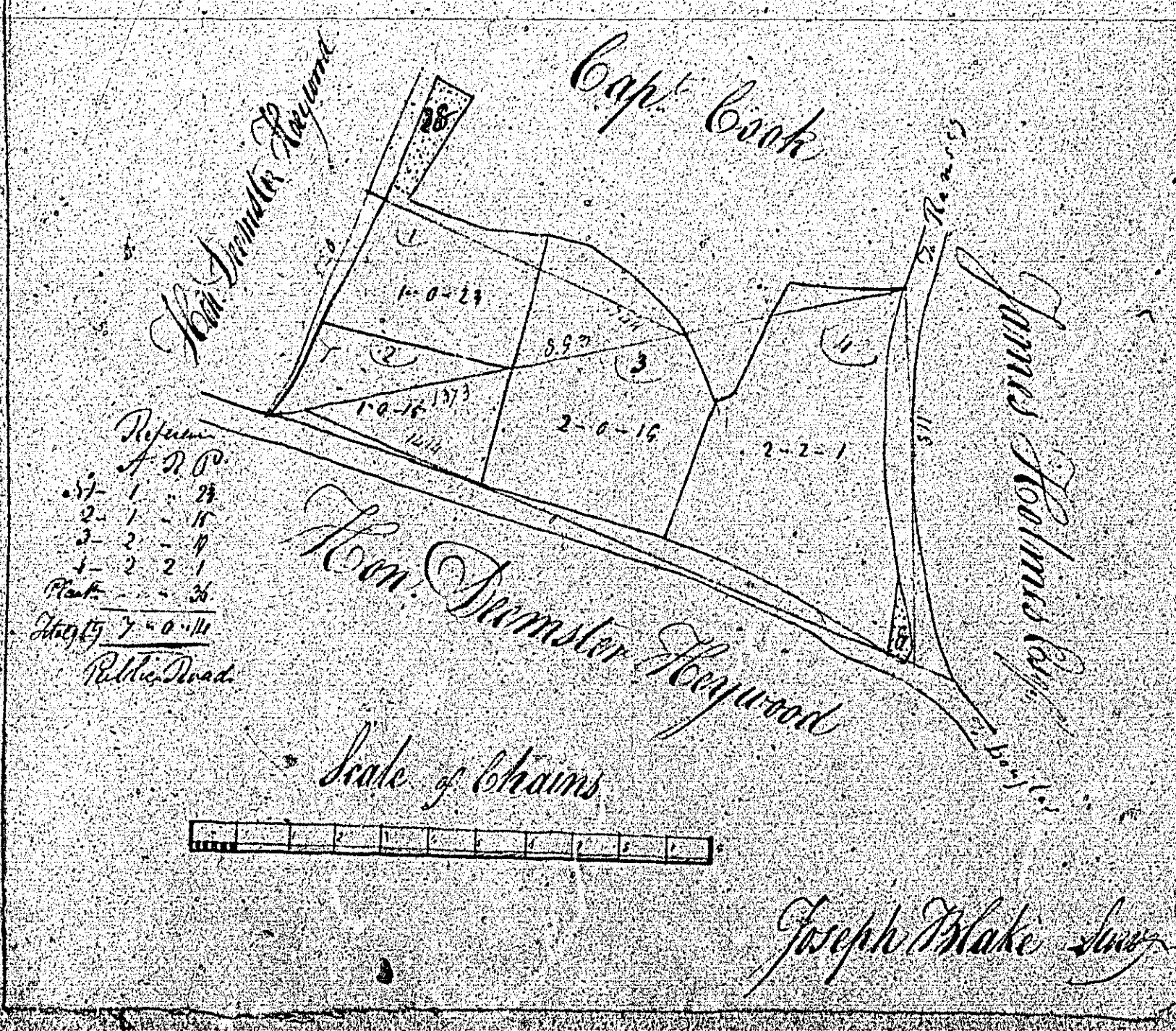

Reference
 of 200
 1-1-18
 2-2-1
 3-2-1
 4-2-1
 5-2-1
 6-2-1
 7-2-1
 8-2-1
 9-2-1
 10-2-1

138
PLAN
 of
SULBY
 The property of the
LATE WILLIAM SCOTTES
 Situate in the Parish of
ONCHAN
 1840

16°

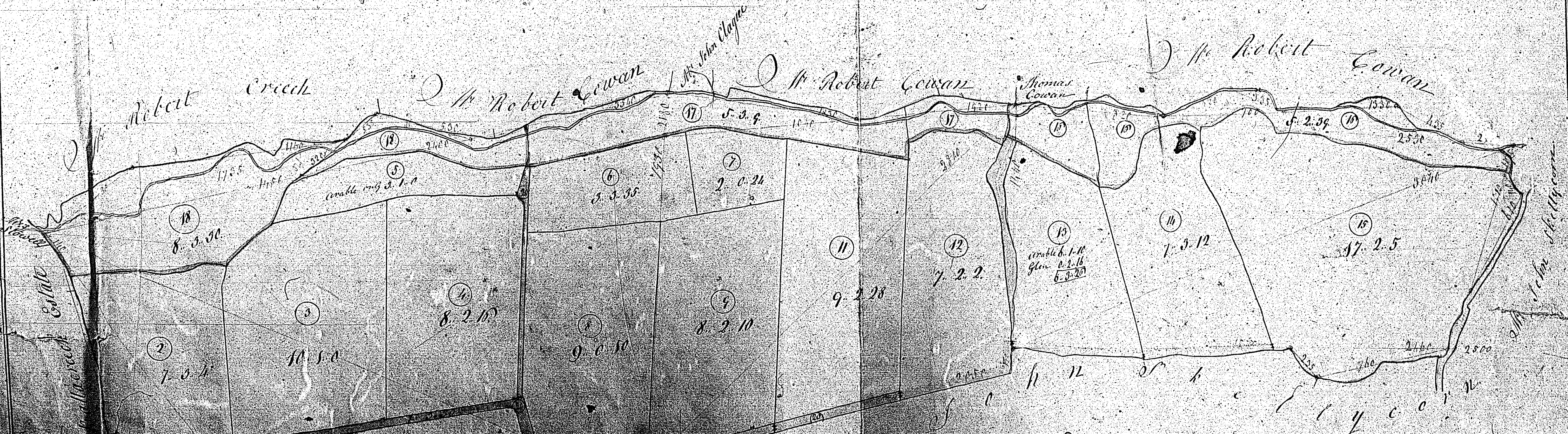

C. & A. P. & A. S.

No.	Acres	Roods	Poles
1	10	5	0
2	7	0	4
3	10	5	0
4	8	2	10
5	8	3	30
6	2	0	24
7	8	2	10
8	8	2	10
9	9	0	10
10	9	0	10
11	7	2	28
12	7	2	2
13	7	3	12
14	17	2	5
15	17	2	5
16	5	2	39
17	5	2	9
18	8	3	30
19	10	5	0
20	10	5	0
Total	143	2	37
Reserve	1	1	8
Total	144	3	2

