

W. H. *Not used*

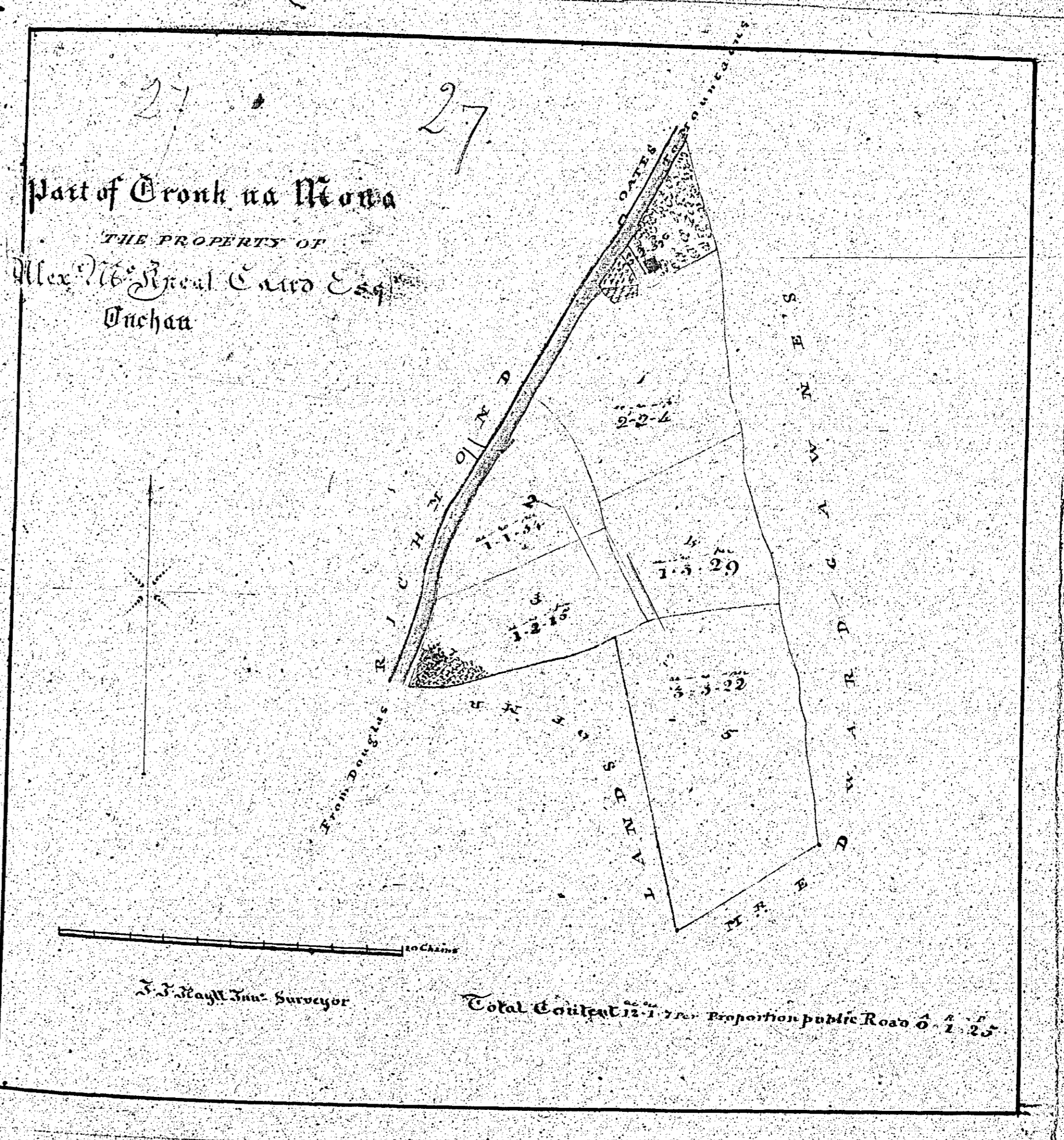

Plan  
of the  
Estate  
Ballakilmartin  
Parish in Onchan  
as taken by  
M<sup>r</sup> Edm<sup>d</sup> Christian  
April 27<sup>th</sup> 1832

Volume  
28.

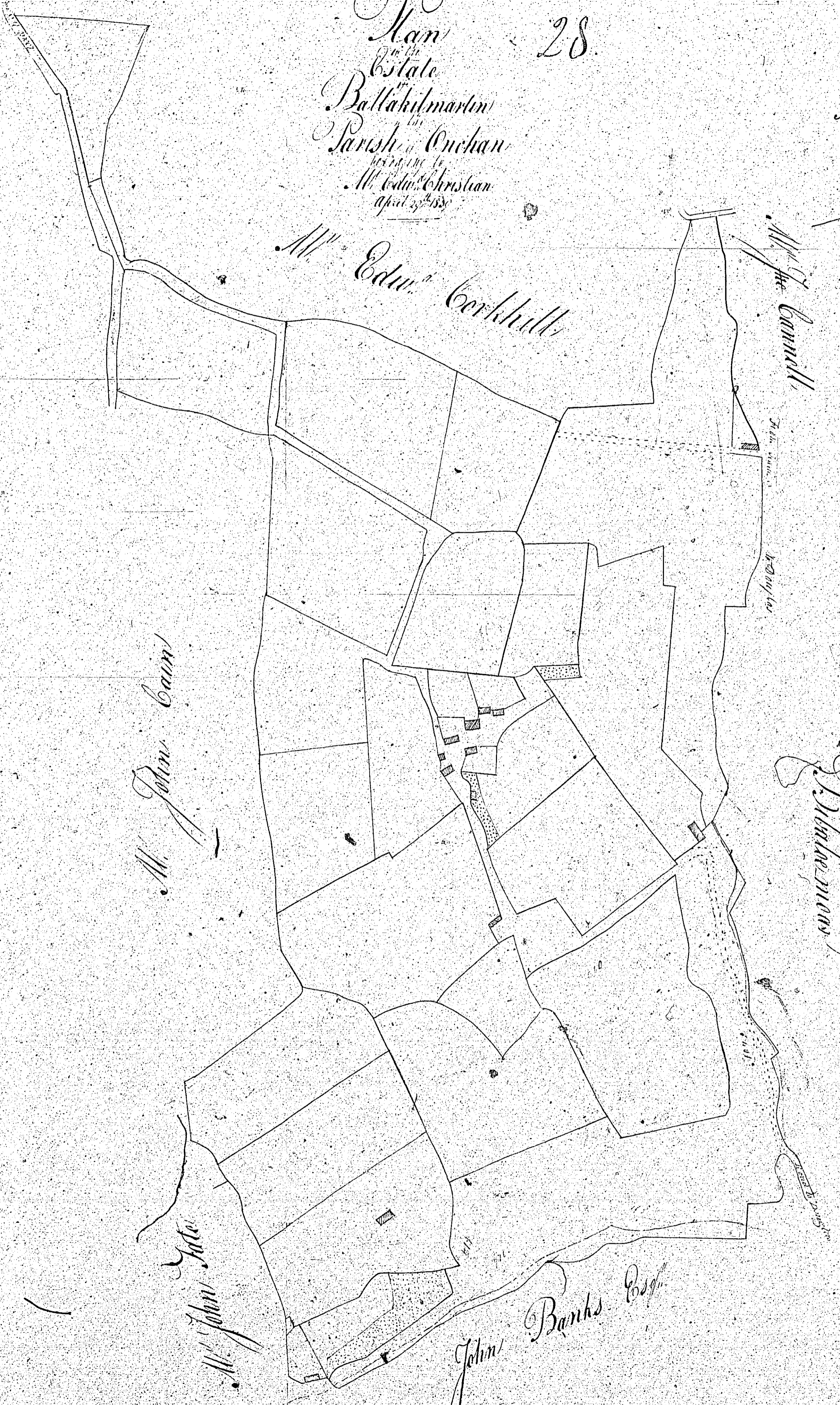
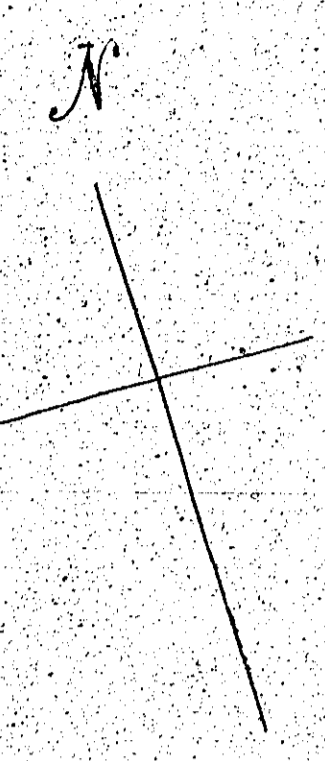

M<sup>r</sup> Edm<sup>d</sup> Corbhill

M<sup>r</sup> Geo<sup>rg</sup>e Connell

M<sup>r</sup> John Cairn

John Mackintosh

M<sup>r</sup> John Yule

John Banks Esq<sup>r</sup>

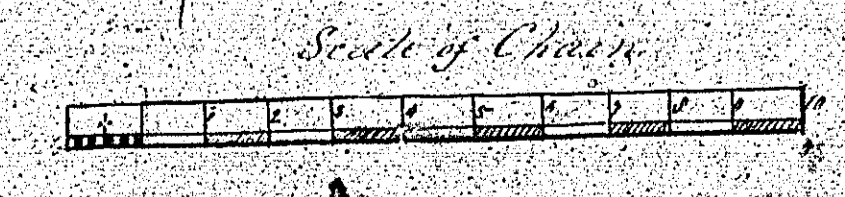

Scale of Chains

Plot No.	Acres	Roods	Poles
1	1	2	0
2	1	2	0
3	1	2	0
4	1	2	0
5	1	2	0
6	1	2	0
7	1	2	0
8	1	2	0
9	1	2	0
10	1	2	0
11	1	2	0
12	1	2	0
13	1	2	0
14	1	2	0
15	1	2	0
16	1	2	0
17	1	2	0
18	1	2	0
19	1	2	0
20	1	2	0
21	1	2	0
22	1	2	0
23	1	2	0
24	1	2	0
25	1	2	0
26	1	2	0
27	1	2	0
28	1	2	0
29	1	2	0
30	1	2	0
31	1	2	0
32	1	2	0
33	1	2	0
34	1	2	0
35	1	2	0
36	1	2	0
37	1	2	0
38	1	2	0
39	1	2	0
40	1	2	0
41	1	2	0
42	1	2	0
43	1	2	0
44	1	2	0
45	1	2	0
46	1	2	0
47	1	2	0
48	1	2	0
49	1	2	0
50	1	2	0

Joseph W. Macdonald

Plan 30.  
 of the Estate

Mr Edward Christian

FROM DOUGLAS TO SANSEY

29.

Plan  
 of the Estate of  
 Bullastole.

In the Parish of Onchan.  
 The Property of  
 Mr Daniel Gairn

Surveyed  
 July 3<sup>rd</sup> 1839  
 by  
 W. J. Brown  
 A. A. Briddan

Reference

No	Acres	Rods	Fms
1	0	0	13
2	0	0	13
3	0	0	13
4	0	0	13
5	0	0	13
6	0	0	13
7	0	0	13
8	0	0	13
9	0	0	13
10	0	0	13
11	0	0	13
12	0	0	13
Total	6	0	9
Road	0	0	29
Brook	0	1	12

Mr Daniel Gairn

Carnell

Mr

Carnell

Mr Daniel Gairn

Mr Philip Simpson

Scale 1/4 Inch to One Inch

Handwritten mark

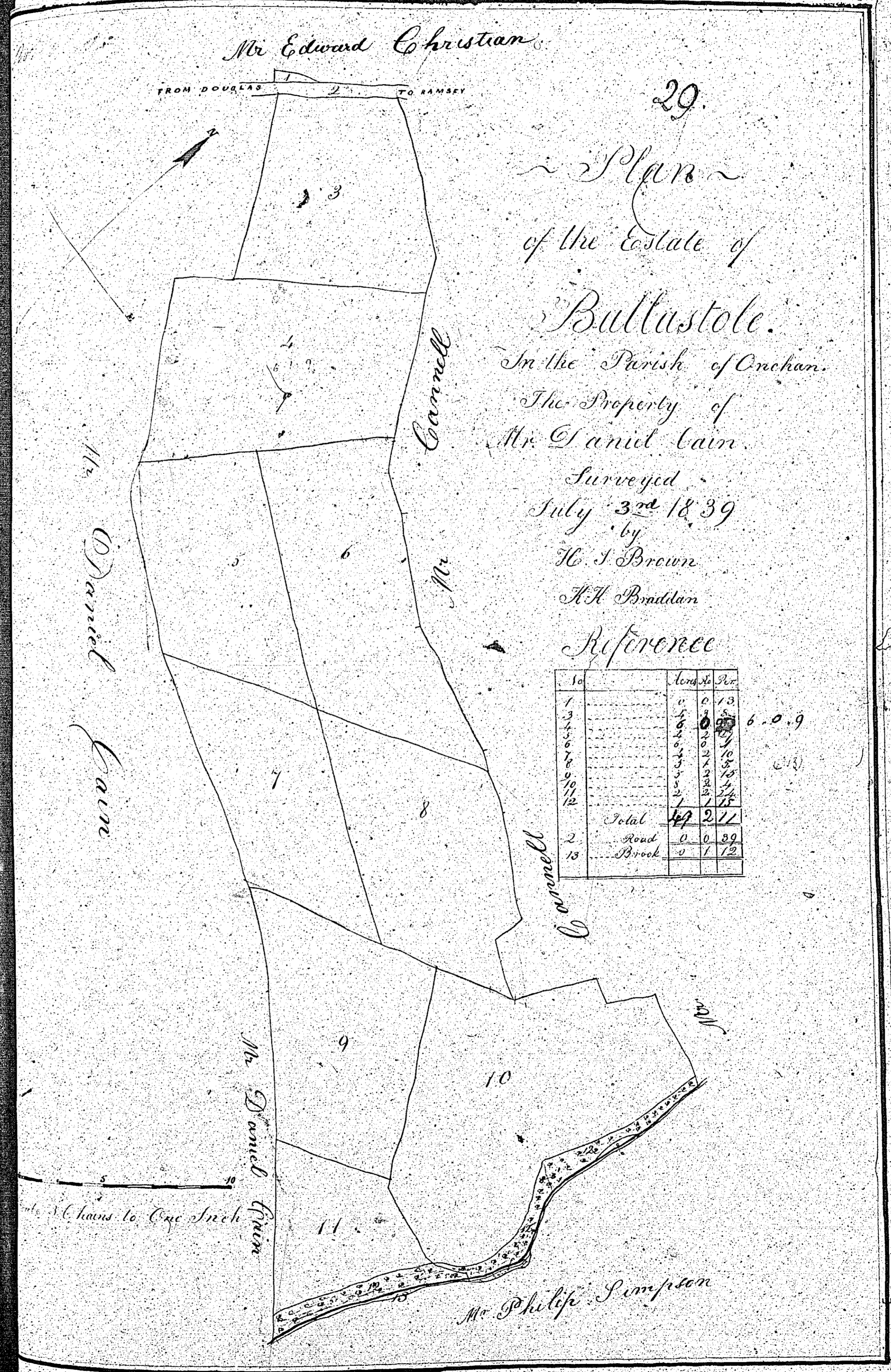

ISLE OF MAN GOVERNMENT: GENERAL REGISTRY

TITHE PLANS: PARISH OF ONCHAN

Original coloured (decorative), faint





Plan  
of Joiner's Croft  
in the Parish of Onchan.  
the property of  
Mr. Charles Craime

Contents

No.	Description	A. R. P.
1	Contains	0. 3. 37
2		1. 0. 39 1/2
3		0. 1. 37 1/2
4	Grass Garden &c	0. 0. 31
5	Garden &c	0. 0. 7
	<u>Total</u>	<u>2. 3. 32</u>

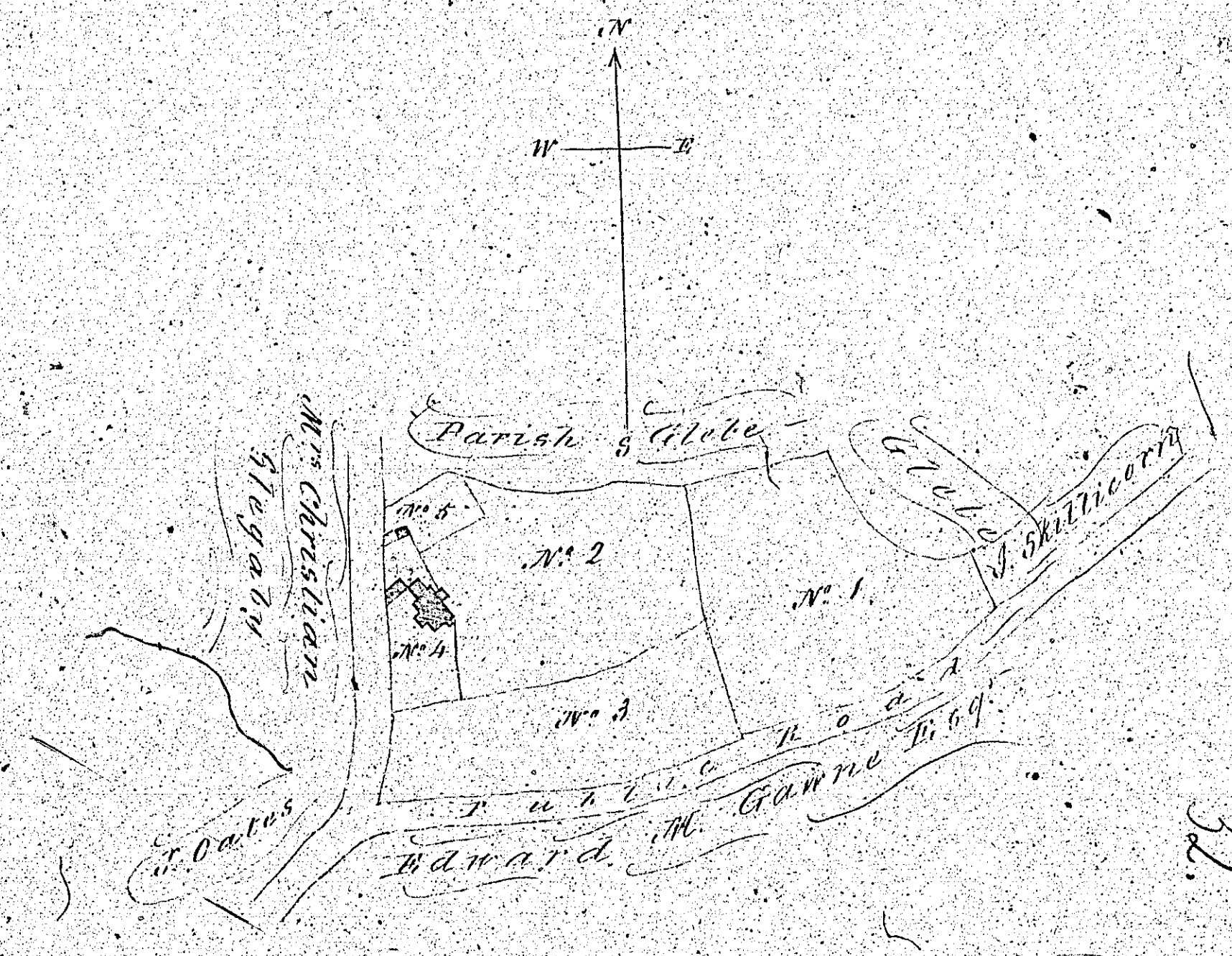

Scale 2 Chains to an Inch.  
W. G. Gawn  
Surveyor 1840.

32.