



ISLE OF MAN GOVERNMENT: GENERAL REGISTRY

TITHE PLANS: PARISH OF MICHAEL

79 Original coloured

80 Original monotone

1.30

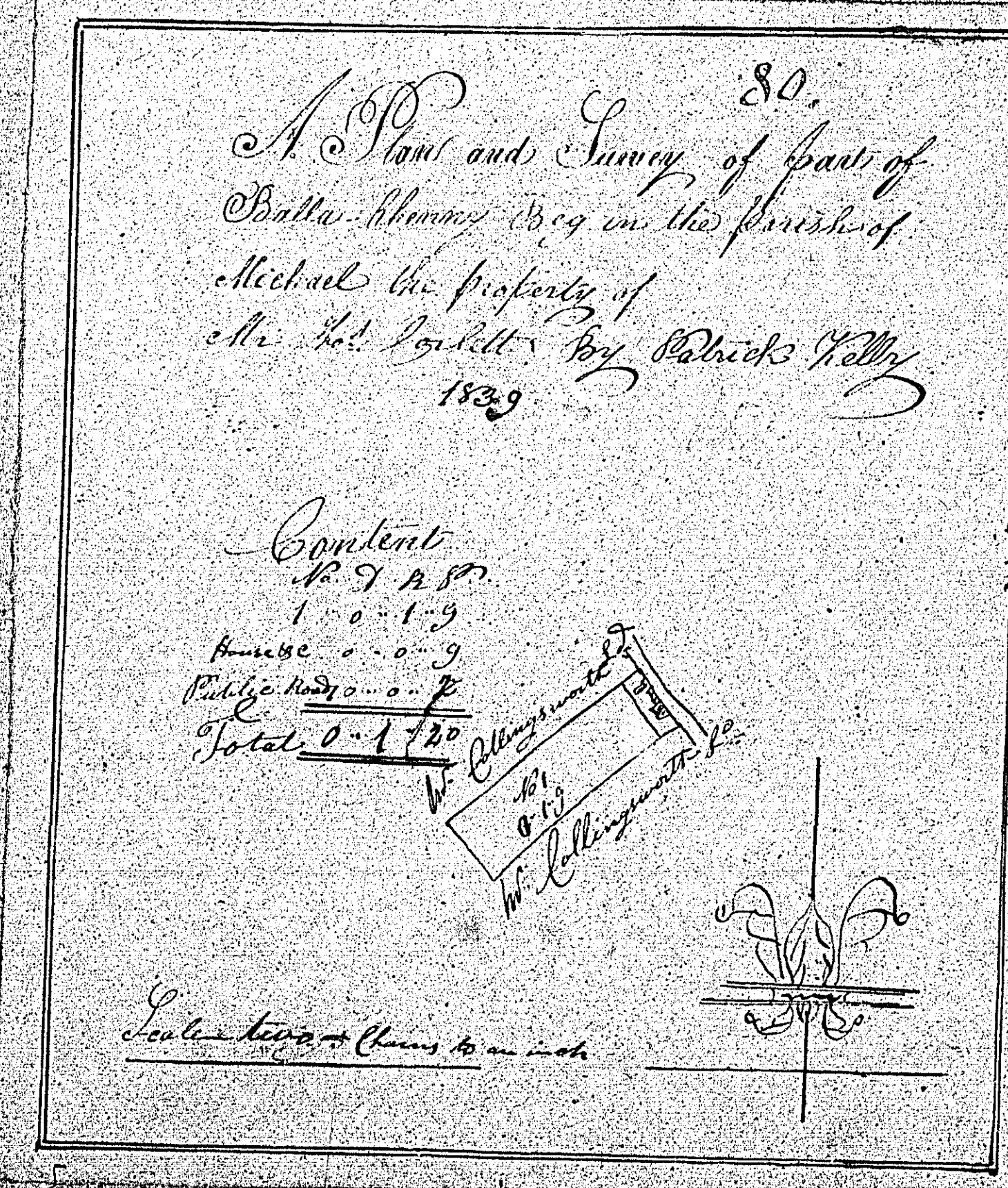
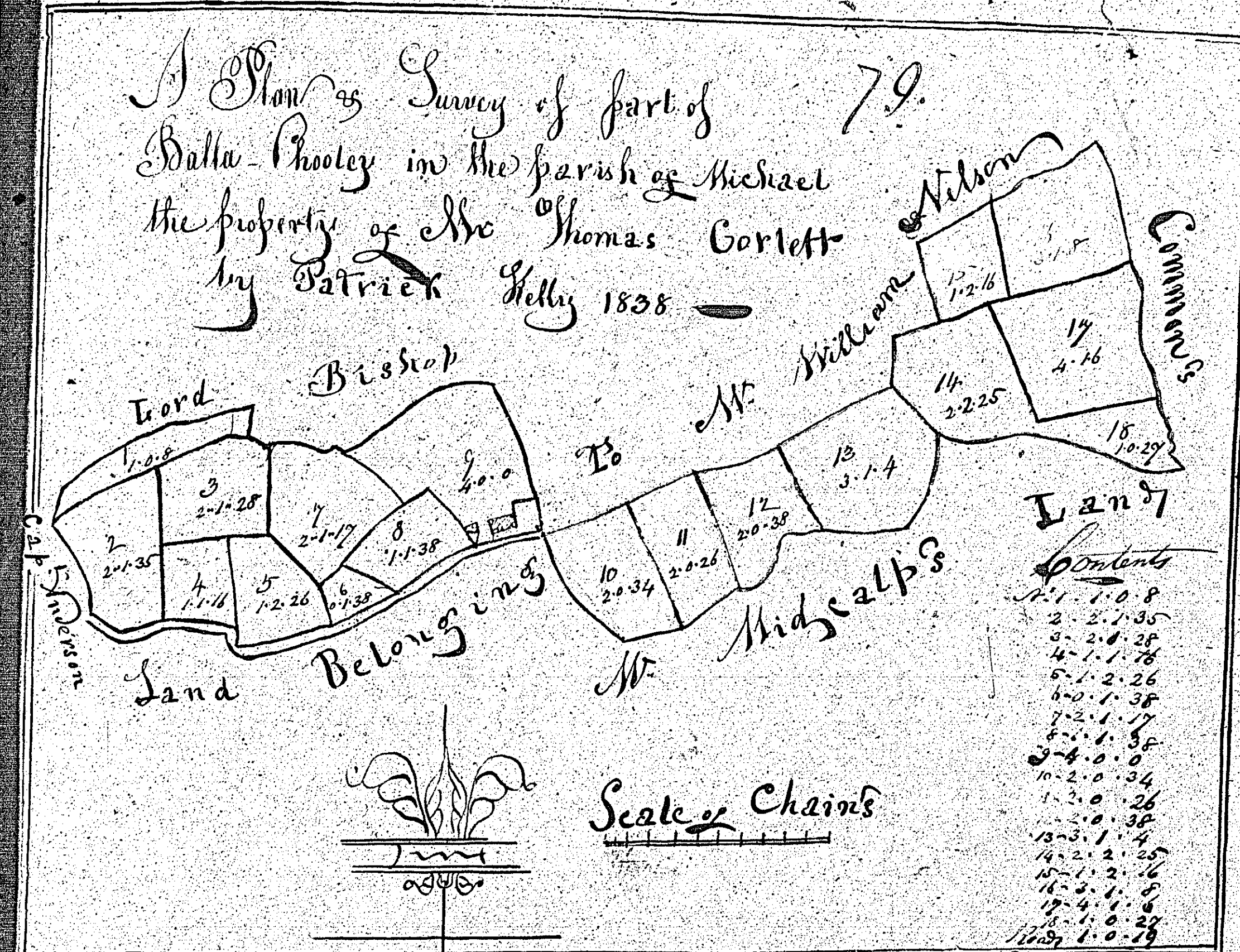

81  
 A Plan & Survey of part of  
 Ballaghlonex in the Parish  
 of Michael the Property of  
 Mr. W. Gorgeage by P. Kelly  
 August 1838

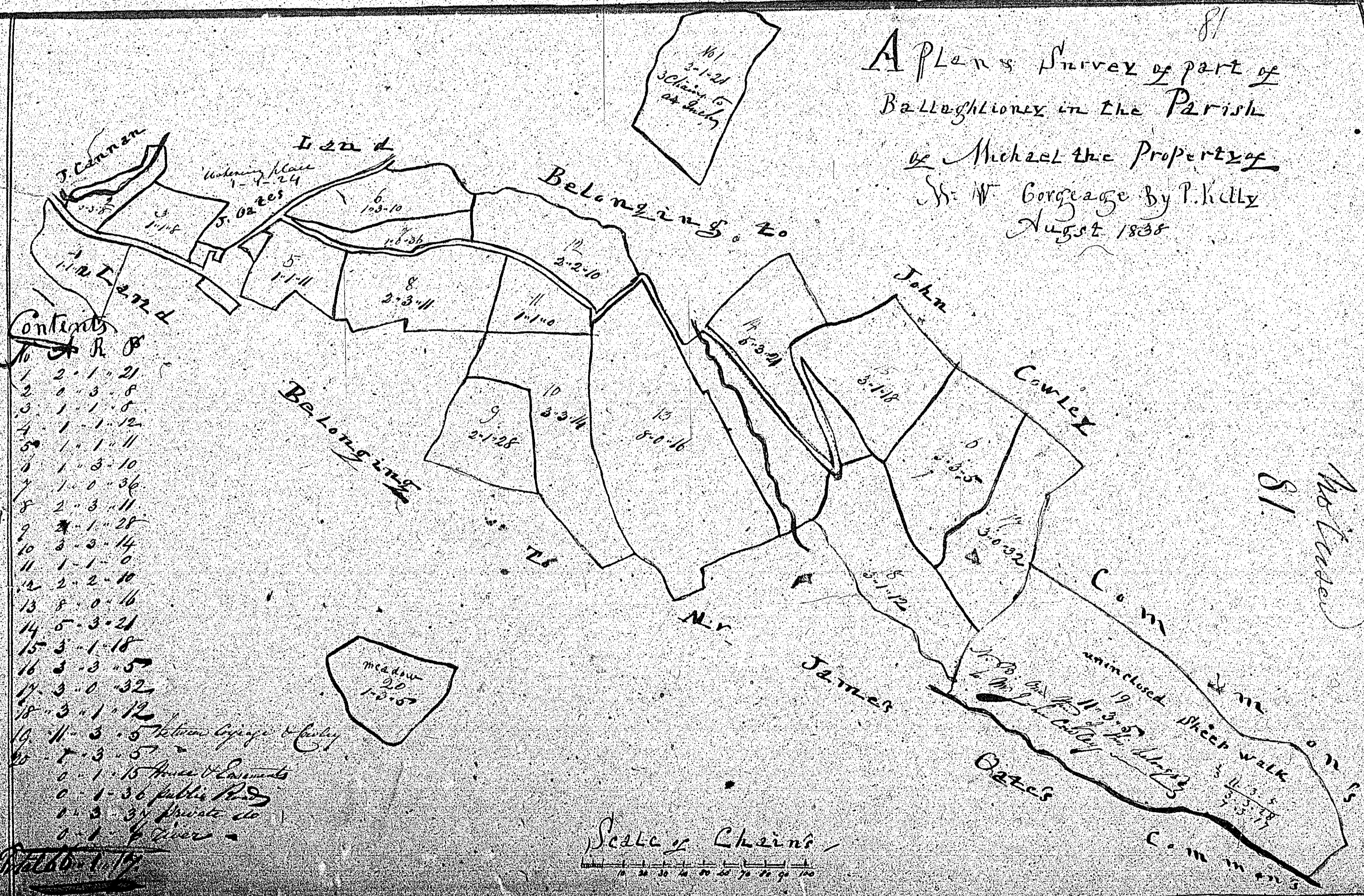

Contents

No.	R.	B.
1	2	1.21
2	0	3.8
3	1	1.8
4	1	1.12
5	1	1.11
6	1	3.10
7	1	0.36
8	2	3.11
9	2	1.28
10	3	3.14
11	1	1.0
12	2	2.10
13	3	0.16
14	5	3.21
15	5	1.18
16	3	3.5
17	3	0.32
18	3	1.12
19	11	5.5
20	7	3.5
	0	1.15
	0	1.36
	1	3.34
	0	1.3

Notes:  
 1. 1.15 House & Enclosure  
 2. 1.36 public Rd  
 3. 3.34 private do  
 4. 0.1. 3/4  
 5. 1.15  
 6. 1.15  
 7. 1.15  
 8. 1.15  
 9. 1.15  
 10. 1.15  
 11. 1.15  
 12. 1.15  
 13. 1.15  
 14. 1.15  
 15. 1.15  
 16. 1.15  
 17. 1.15  
 18. 1.15  
 19. 1.15  
 20. 1.15

Scale of Chains  
 0 10 20 30 40 50 60 70 80 90 100

81  
 Mr. Kelly

*100 Acres*

82

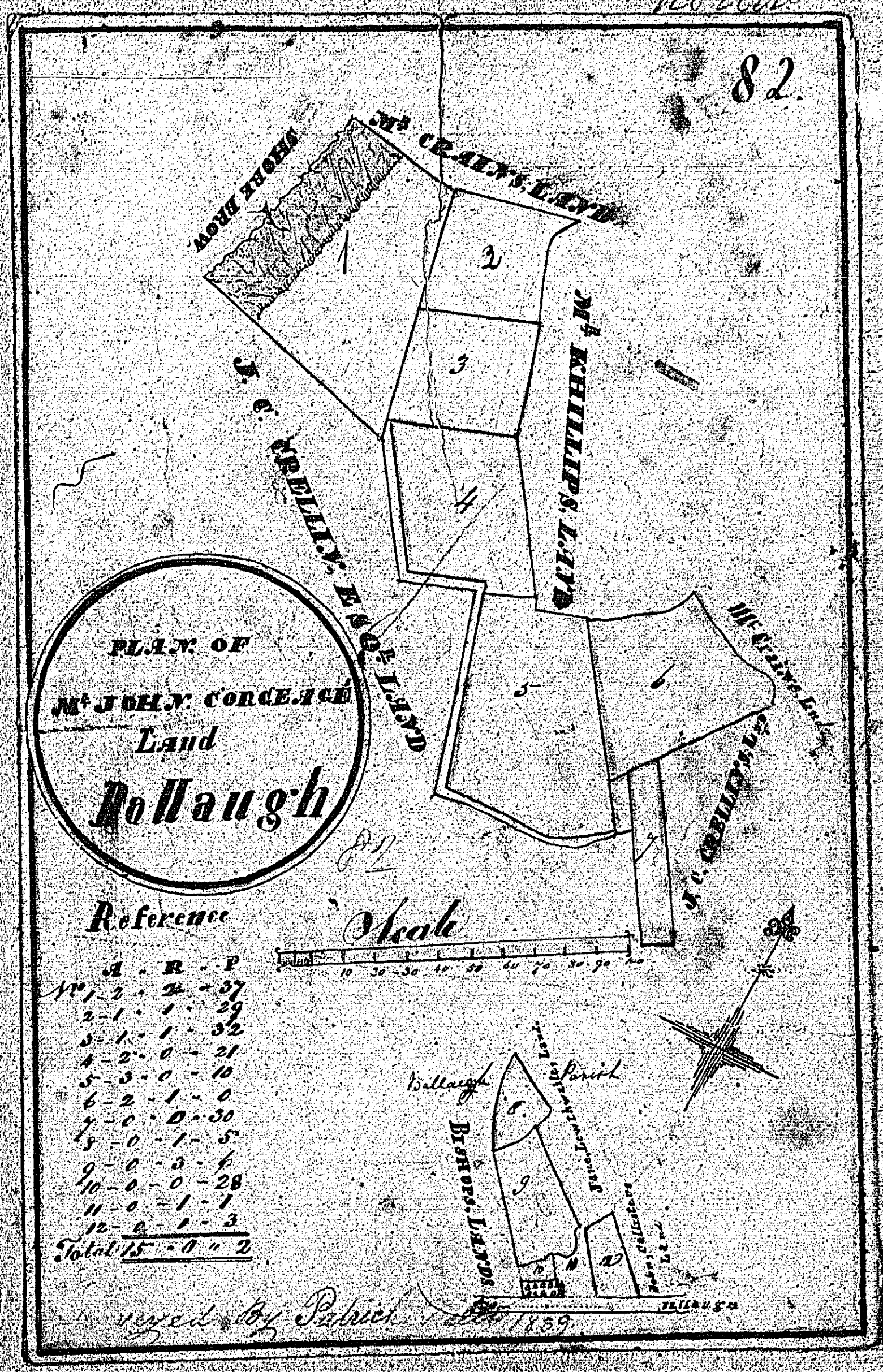

A Plan or Survey of Part  
of Pherry-Weck & a Piece of Intack  
Land in the Parish of Michael, the  
Property of Mr John Norton  
by Philip Henry Woodall  
1740

No	Acres	Roods	Fathoms
1	1.0	36	
2	2.2	35	
3	1.3	24	
4	0.3	33	
5	3.1	28	Intack
6	1.2	18	
7	1.2	9	
8	2.0	9	
9	7.2	5	
10	0.3	34	
11	1.2	23	
12	4.0	0	
13	1.0	7	
14	1.3	36	
15	1.1	32	
16	0.2	32	
17	1.2	20	
18	0.2	30	
19	0.0	21	
20	0.3	16	
21	0.1	0	
Total	38	1.20	

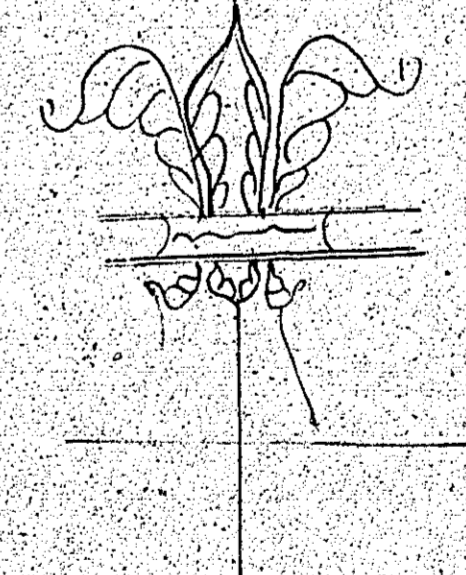
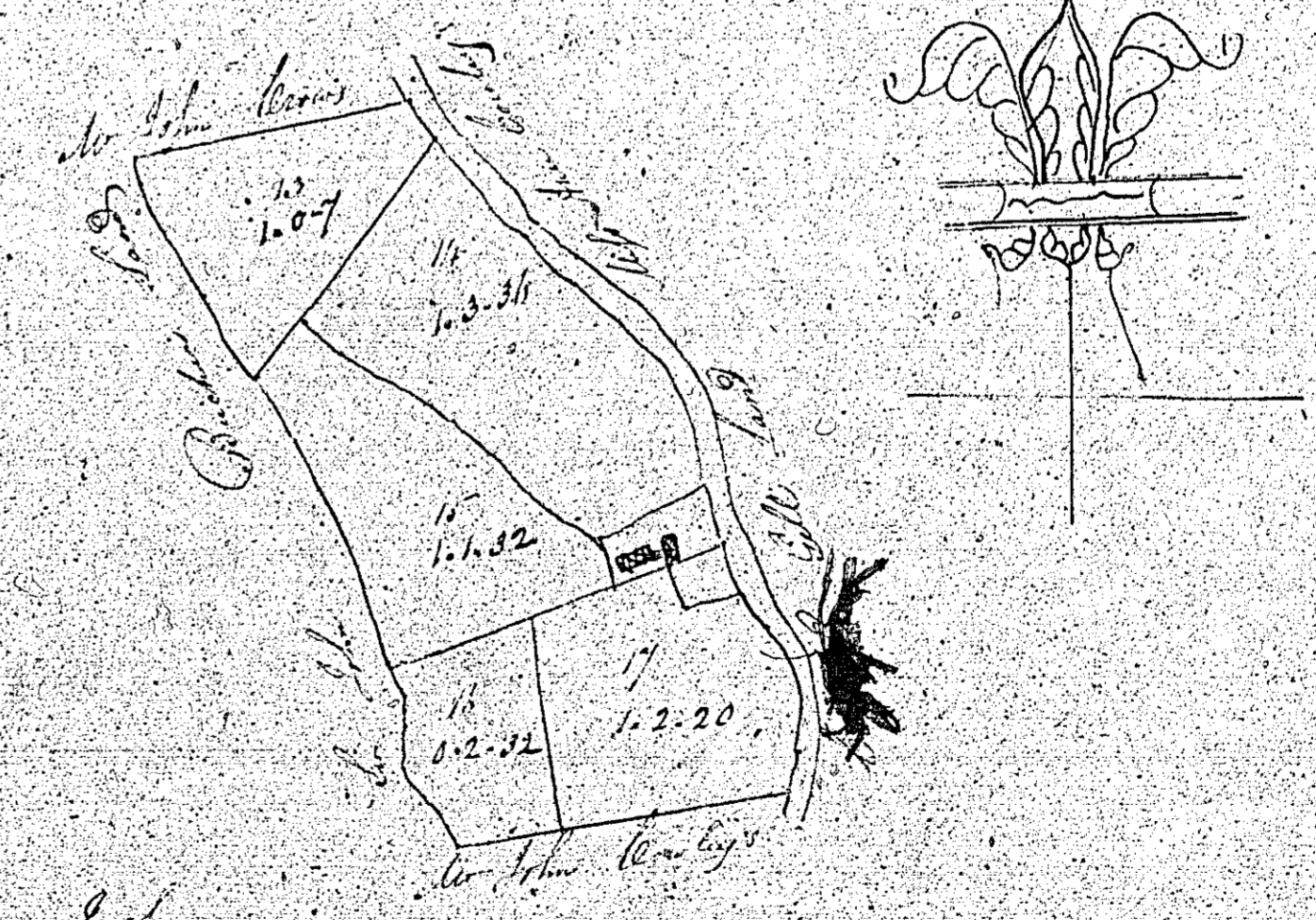
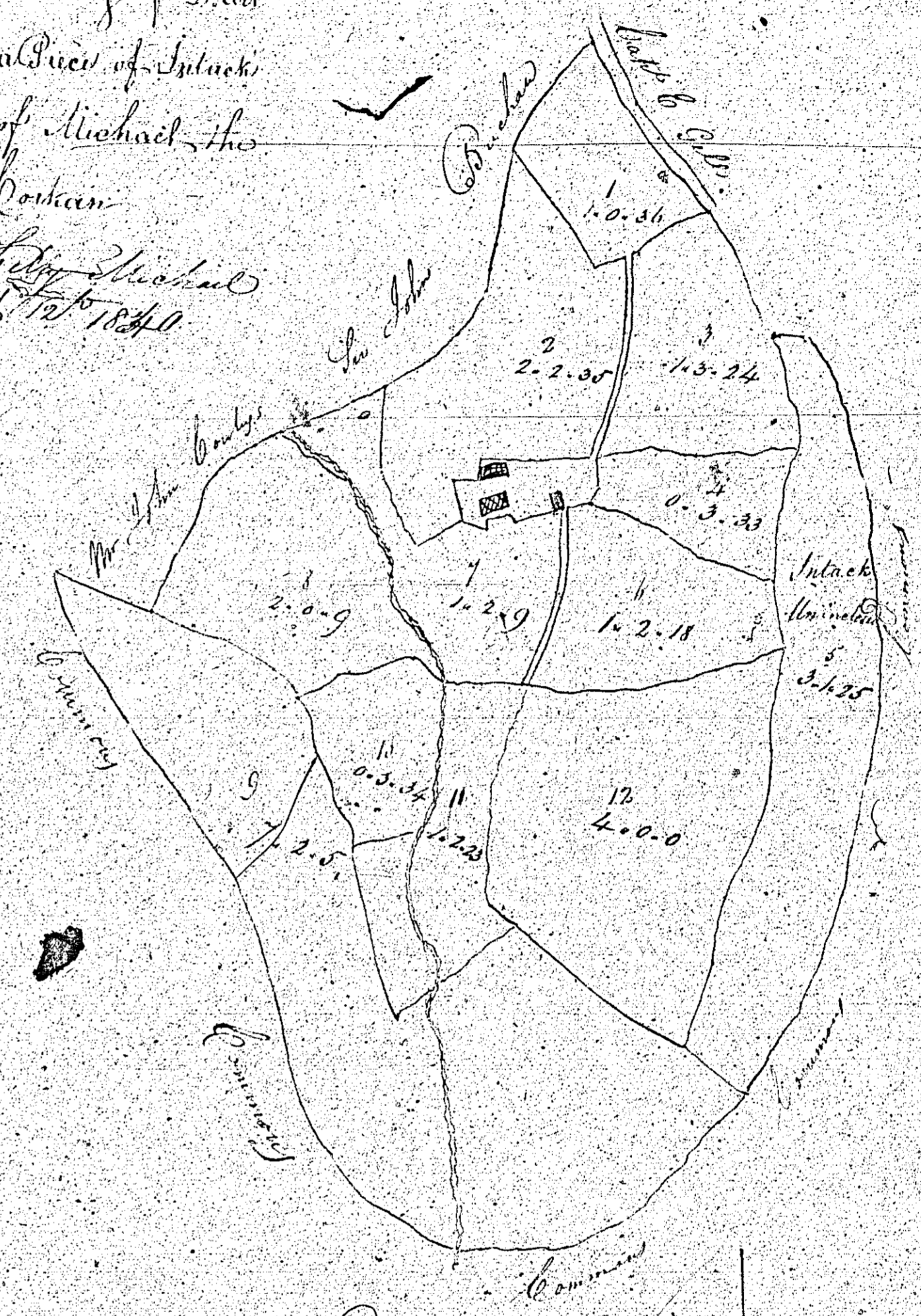

Scale 3 Inches to an Inch