

Plan & Survey
of the Estate of
James Kellag
in the Parish of Marown
the Property of
John Stowell Esq

Contents

<i>S. No.</i>	<i>Acres</i>	<i>R.</i>	<i>P.</i>
1	1	2	1
2	1	0	3
3	1	0	3
4	1	0	3
5	1	0	3
6	1	0	3
7	1	0	3
8	1	0	3
9	1	0	3
10	1	0	3
11	1	0	3
12	1	0	3
13	1	0	3
14	1	0	3
15	1	0	3
16	1	0	3
17	1	0	3
18	1	0	3
19	1	0	3
20	1	0	3
21	1	0	3
22	1	0	3
23	1	0	3
24	1	0	3
25	1	0	3
26	1	0	3
27	1	0	3
Total	64	2	3

Thomas Gick Surveyor 1840

Plan of Ground at Crosby,
in the Parish of Marston.

The Property of
David Moffat Esq.
54

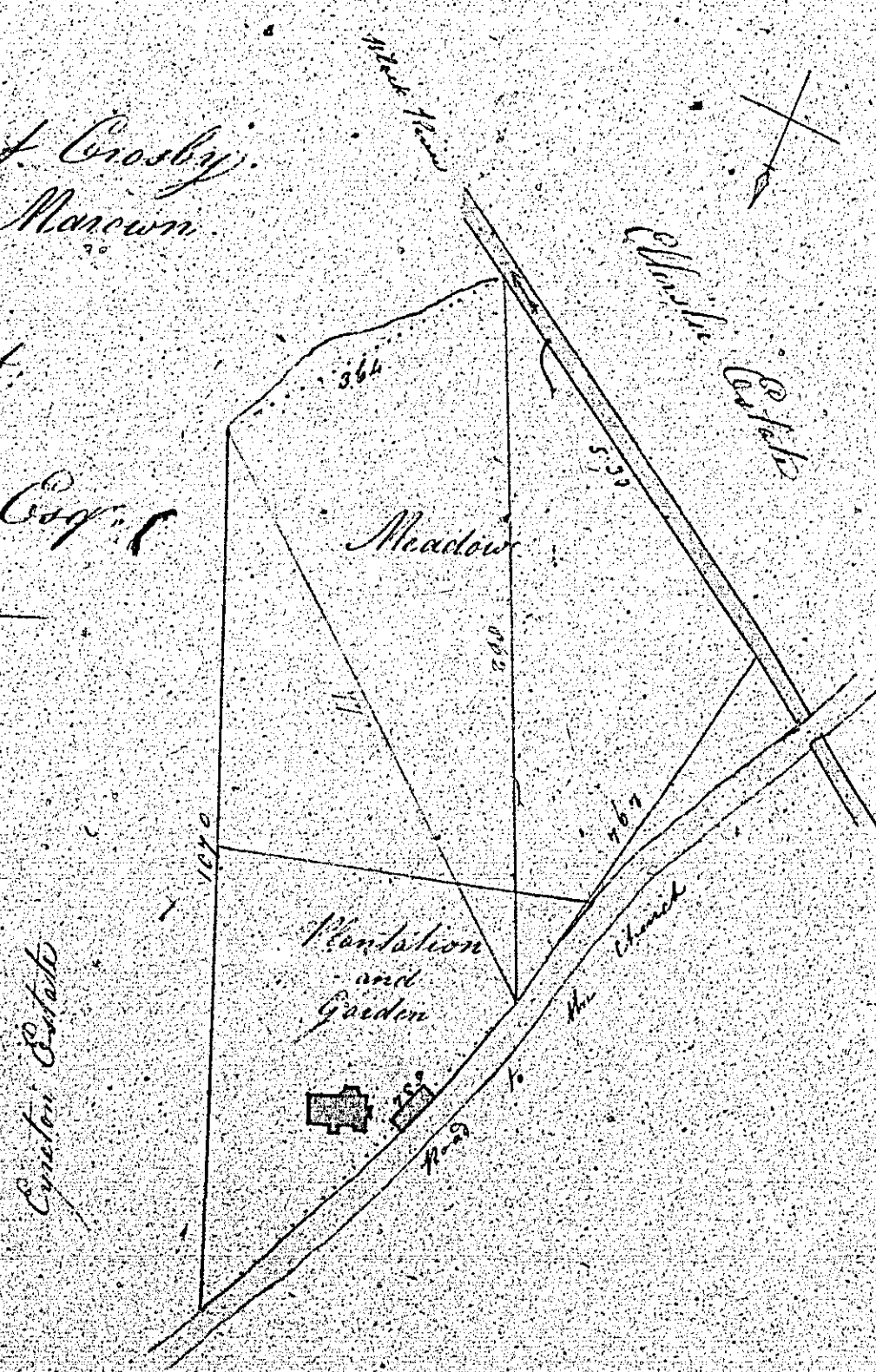

Meadow	1-0-11
Meadow	3-1-36
Plantation and Garden	1-1-5
	<hr/>
	4-2-1 Acres
River	1-1-4
Public Road	0-0-11
	<hr/>
	0-0-29
	<hr/>
	0-1-0

Scale in Chains

Surveyed by J. P. D. 21st March 1844

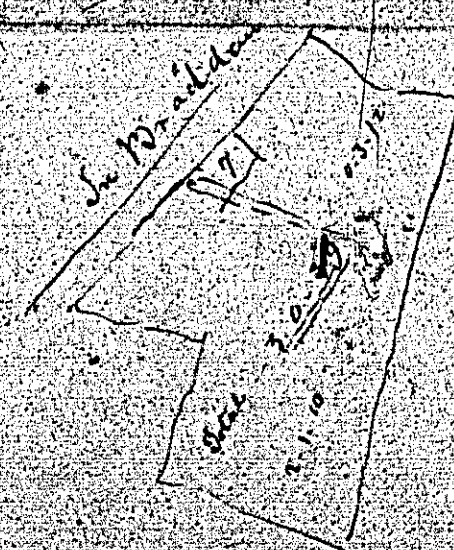

Surveyed by Chambers Esq.
for Mr. Moffat Esq.

David Moffat Esq.
 Crosby
 Marston
 54

Plan and Survey of 55
 Part of Ballacatch
 Parish of Marown
 The Property of
 Thomas Myles Esq

35.

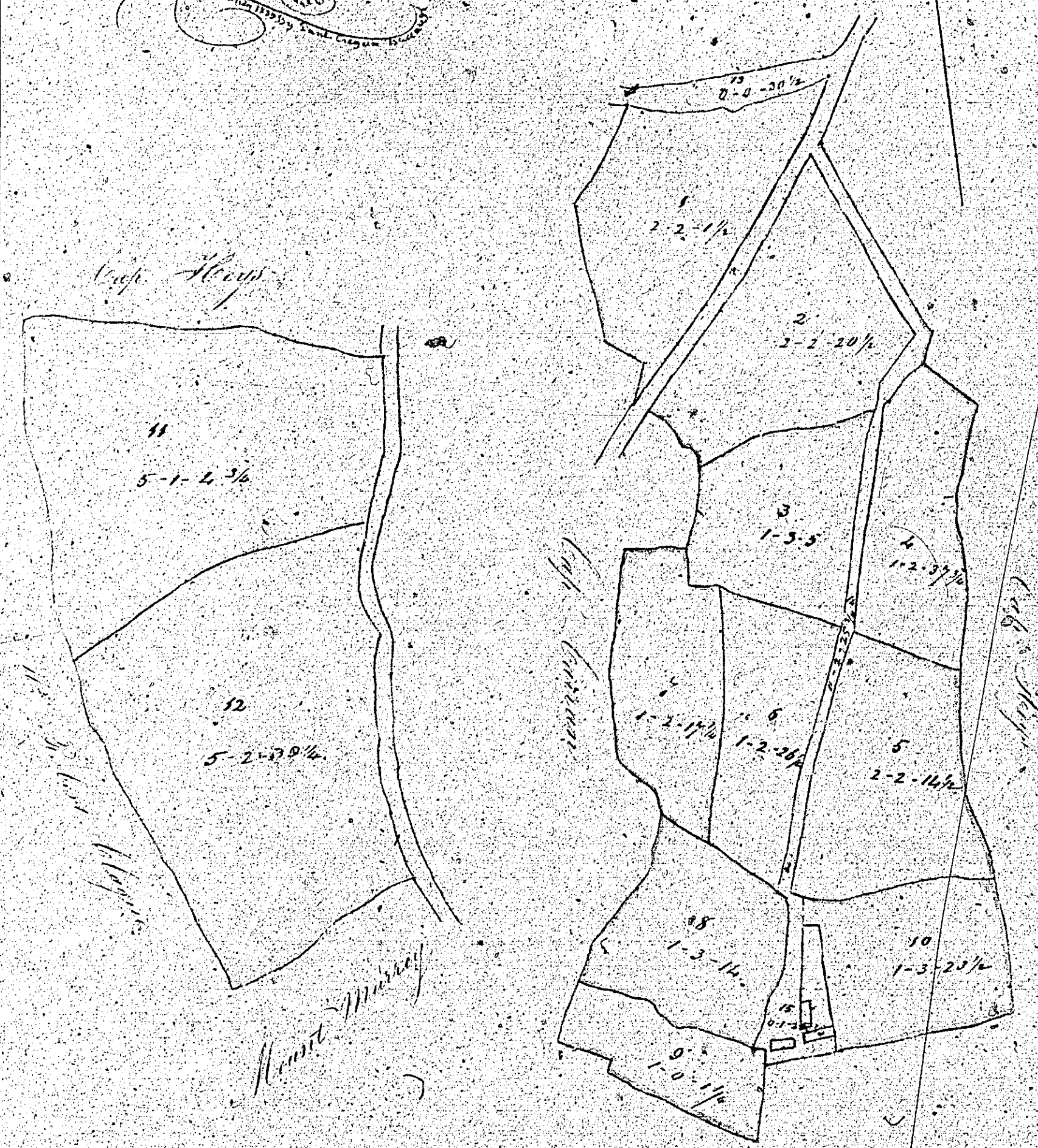

No	Ac	R	P
1	2	2	1
2	2	2	2
3	1	2	5
4	1	2	9
5	1	2	10
6	1	2	11
7	1	2	12
8	1	3	14
9	1	0	14
10	1	3	22
11	5	1	42
12	3	2	52
13	1	1	31
14	2	2	22
15	1	1	22
Total	36	3	7

Scale 50

Handwritten note:
 The Plan
 of the
 55
 Part of Ballacatch
 Parish of Marown
 The Property of
 Thomas Myles Esq

Handwritten note:
 This Plan is drawn from
 the original Survey of
 1750

Plan of certain parts of the Estate of Mount Murray
the property of Colonel Murray, situate in the parish of Merriam

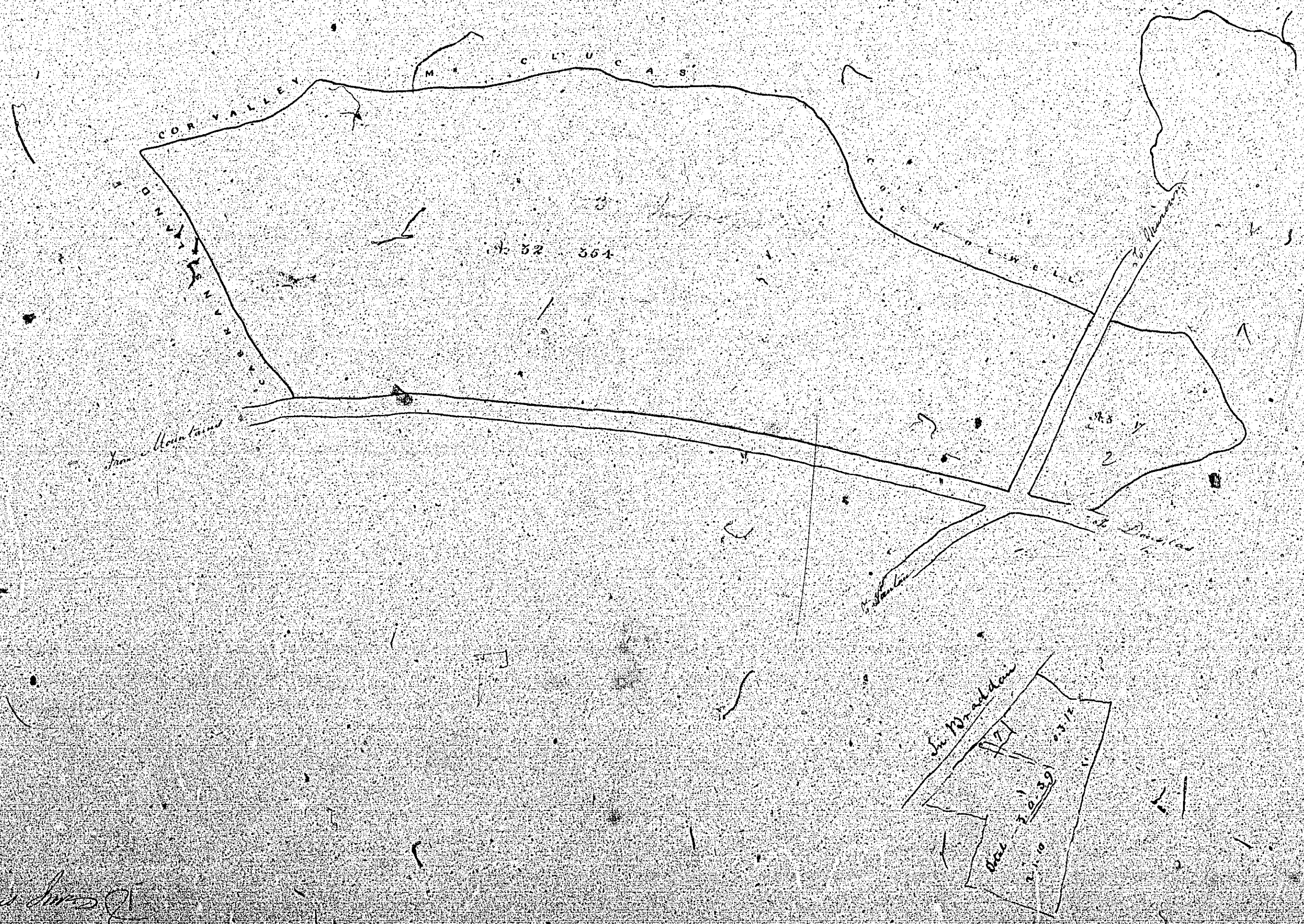

Surveyed by Andrew Smith
for the Honble the Hon. Secy

57
Murray

Part of Intack Land
called
Cousagh glogh 5/8
in the
Parish of Maroon
the property of
Mr. Thos. Quine
July 27. 1841

N 58.

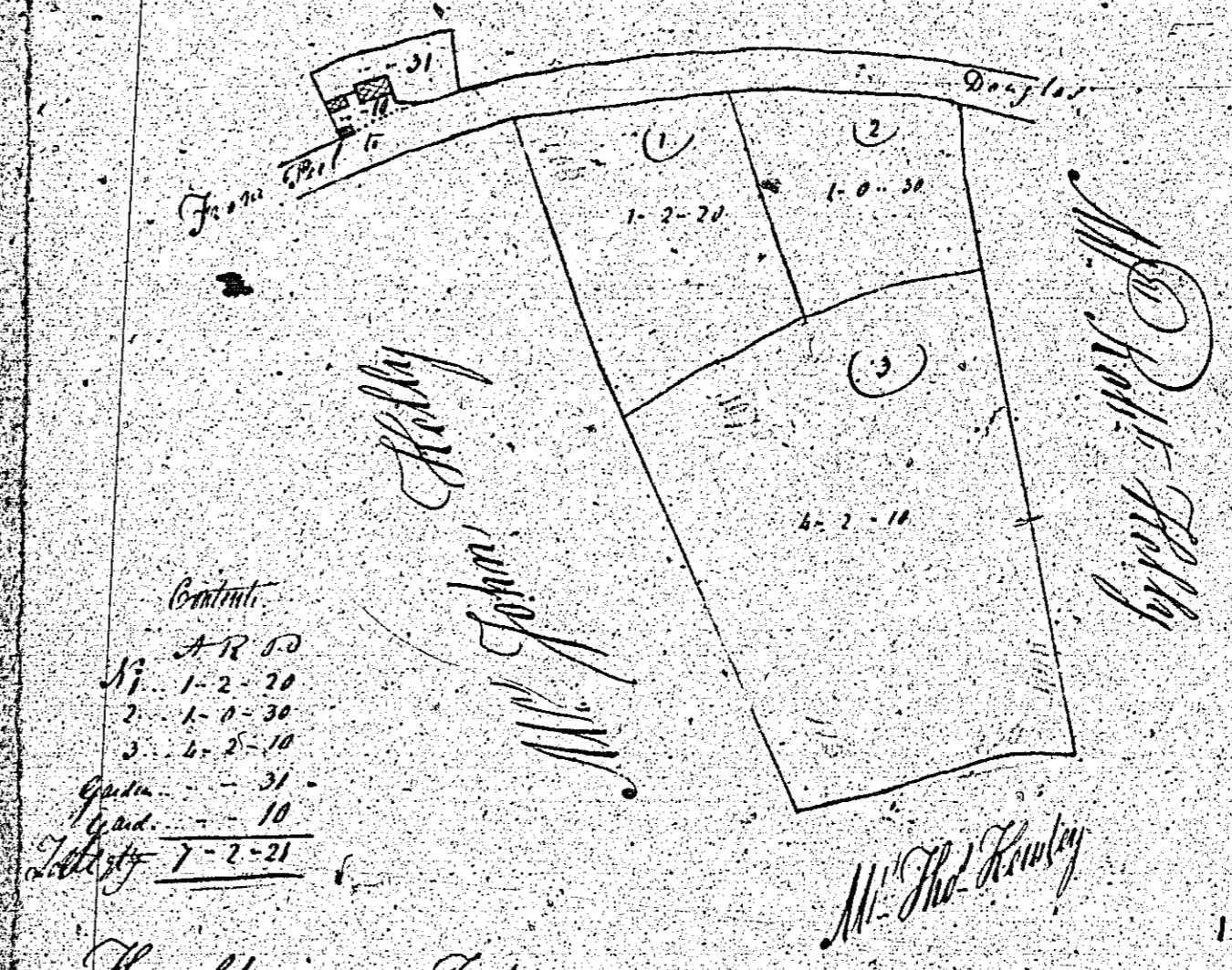

Grants
 1. 12 50
 2. 1 2 20
 3. 1 0 30
 4. 1 0 10
 5. 1 0 10
 6. 1 0 10
 7. 1 0 10
 8. 1 0 10
 9. 1 0 10
 10. 1 0 10

Three chains for each

Joseph Blake Survey