

Plan of  
Coog-Wine  
Intick.  
By the Parish of Marown  
Belonging to Ann Joyce Widow  
April 1840 by M. Carr, Surveyor

References

N <sup>o</sup>	A	R	P
1	1	1	13
2	1	3	10
3	1	0	24
4	3	3	38
5	2	12	
6	2	01	
7	1	36	
8	3	14	
9	1	33	
10	2	16	
11	2	22	
12	1	38	
13	2	29	
Gravel	2	10	
Woods	2	11	
Wid 17	2	27	

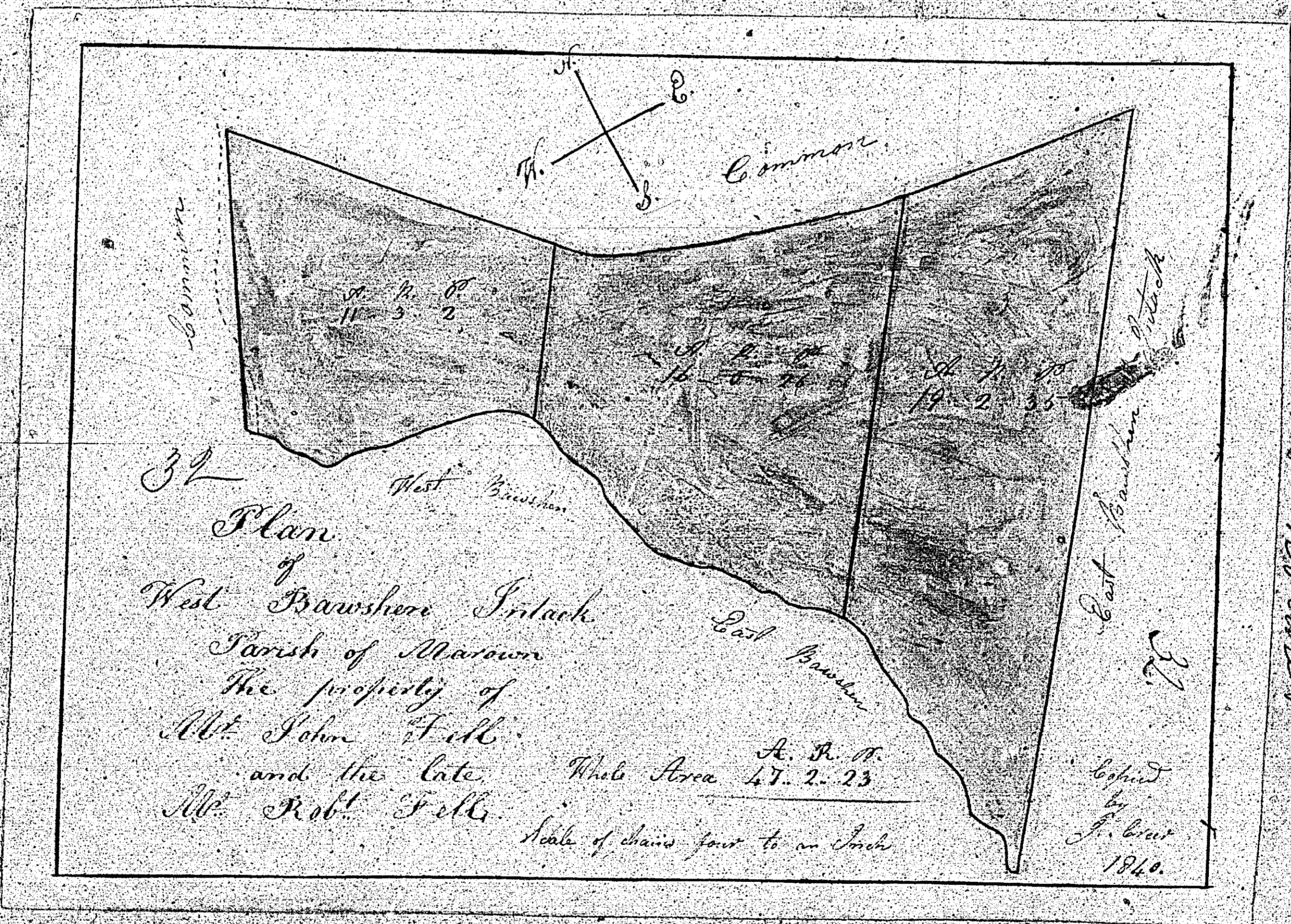

31  
 Plan  
 of  
 West Brawshore Tirlach  
 Parish of Marown  
 the property of  
 Mr. John Fall  
 and the late  
 Mr. Robt. Fall

Whole Area 47. 2. 23  
 Scale of chains four to an Inch

Copied  
 by  
 J. Cur  
 1840

*Handwritten signature*

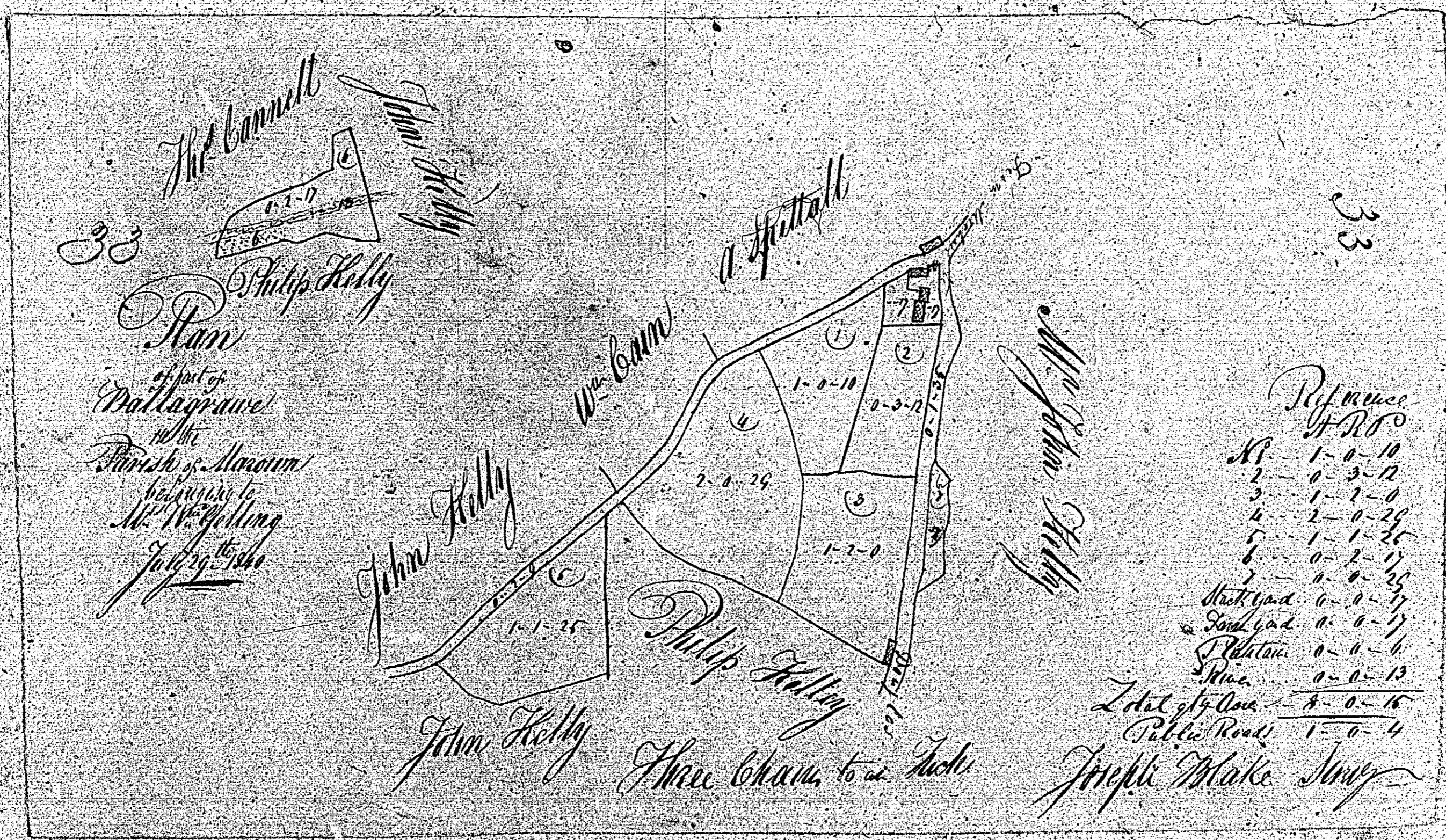

Noted

34.

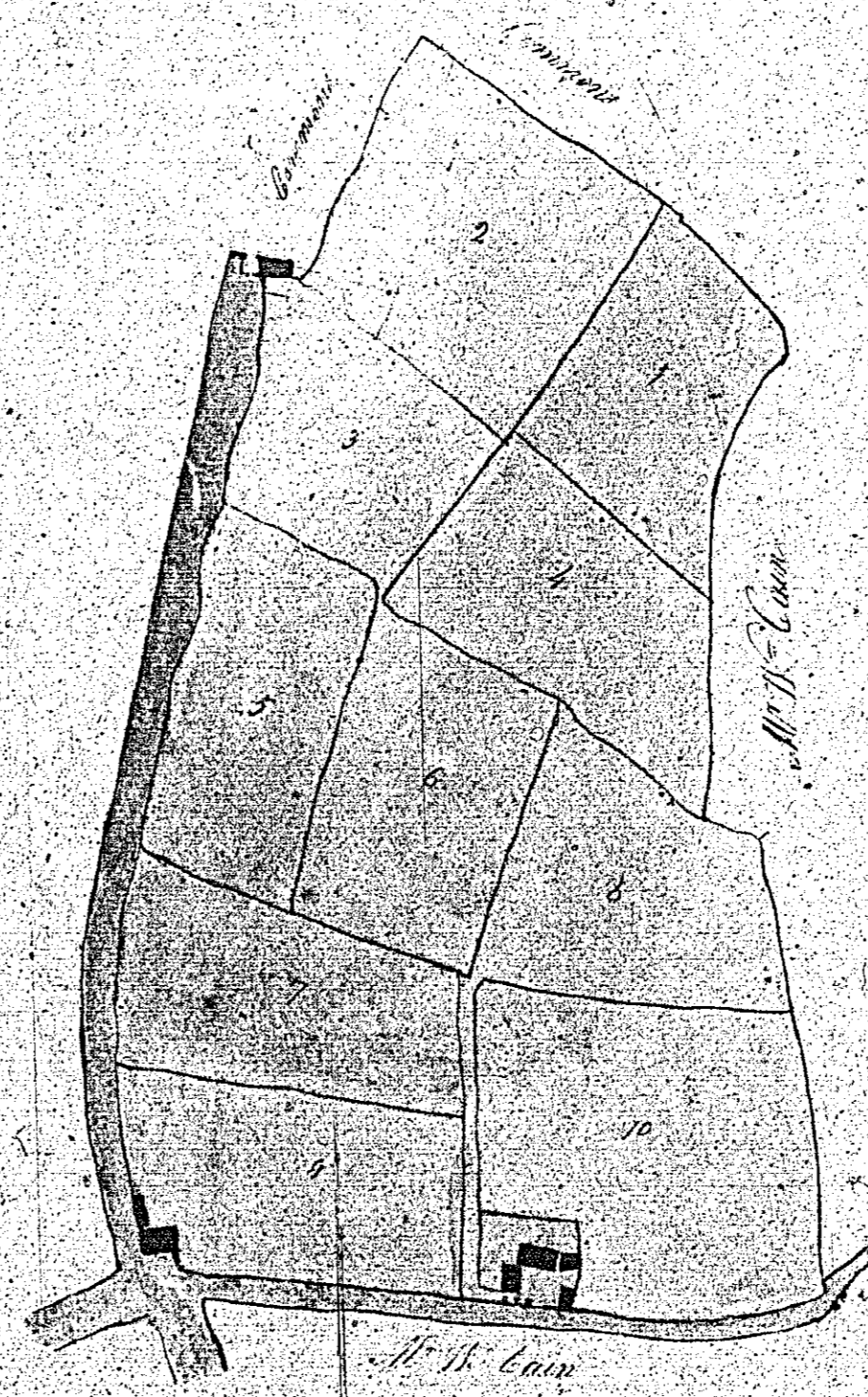

J. H.

PLAN OF STUGADHOO

Part of land situated in the Parish of Morven belonging to Mr James Galt July 1839. M. Galt M. Galt

References

N <sup>o</sup>	A	B	P
1	1	1	26
2	2		
3	1		6
4	1	2	20
5	1	2	17
6	1	2	11
7	1	2	17
8	1	2	8
9	1	2	22
10	2	2	24
Subst <sup>d</sup>	17		18

4 chains to be taken off

Surveyed by me M. Galt

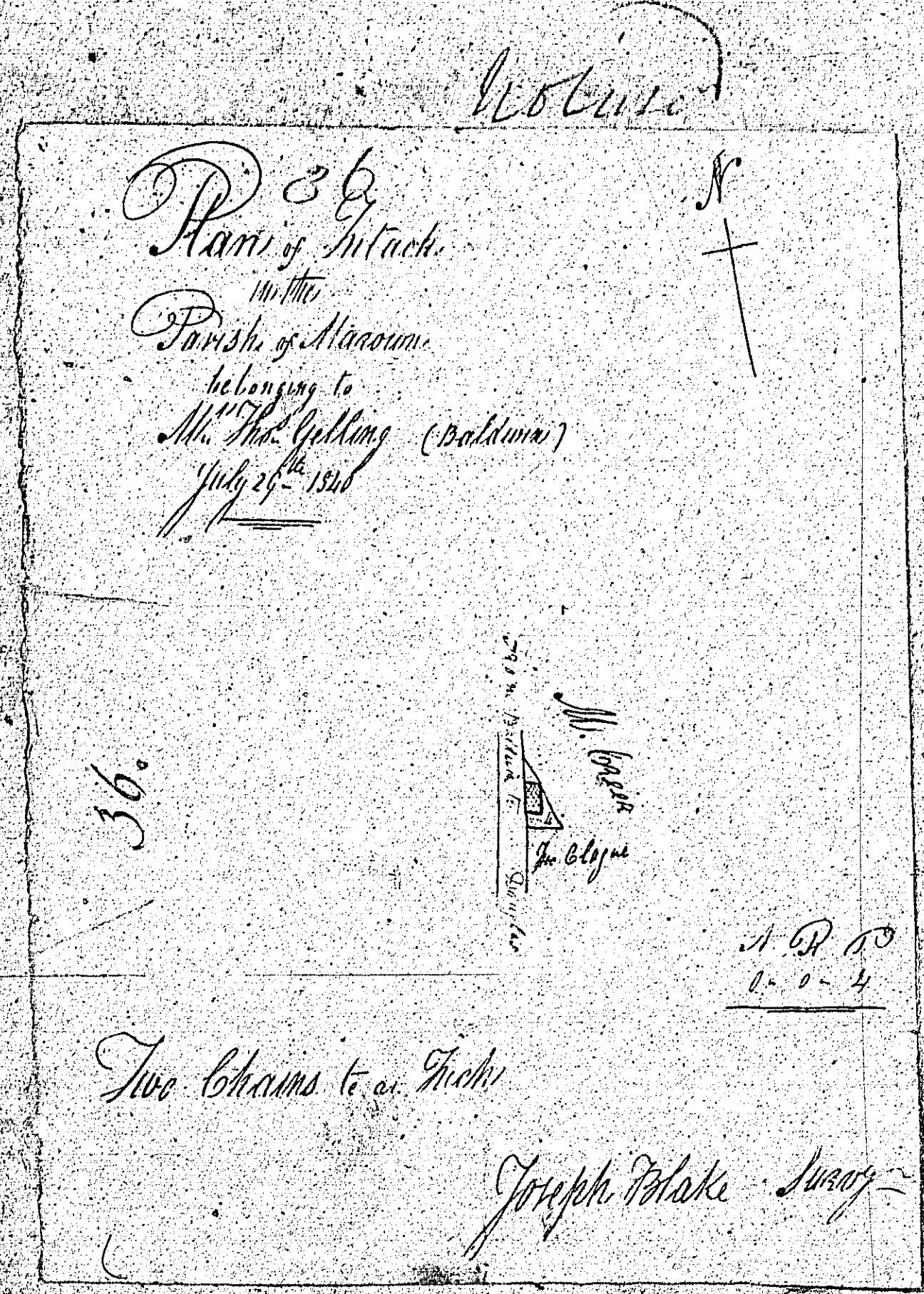
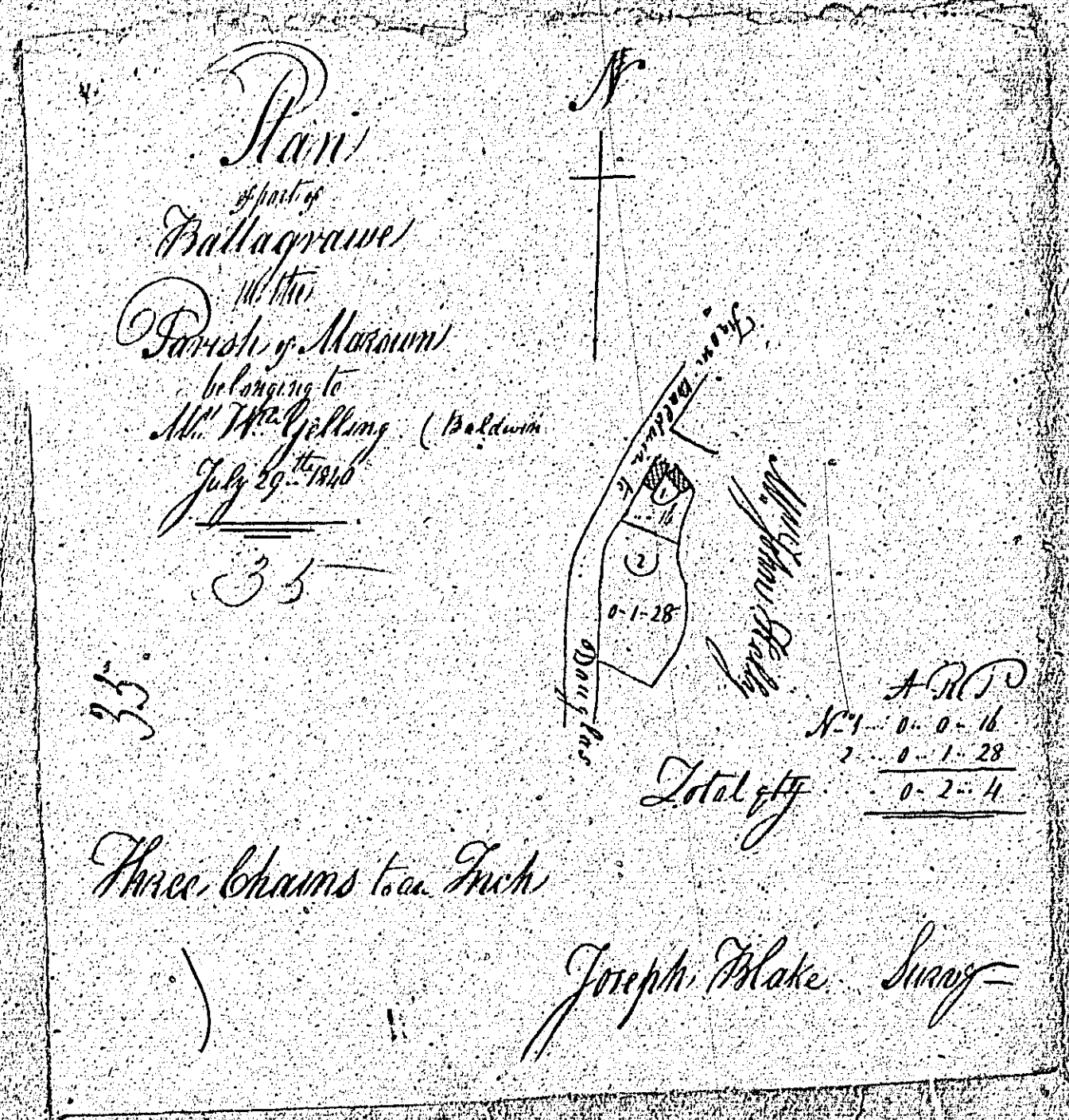

ISLE OF MAN GOVERNMENT: GENERAL REGISTRY

TITHE PLANS: PARISH OF MAROWN

Originals monotone

1:30

37

PLAN and SURVEY  
OF THE ESTATE OF  
**HOPES LODGE,**

in the  
*Parish of St. Andrew*  
the property of  
**CAPT. J. HAY.**

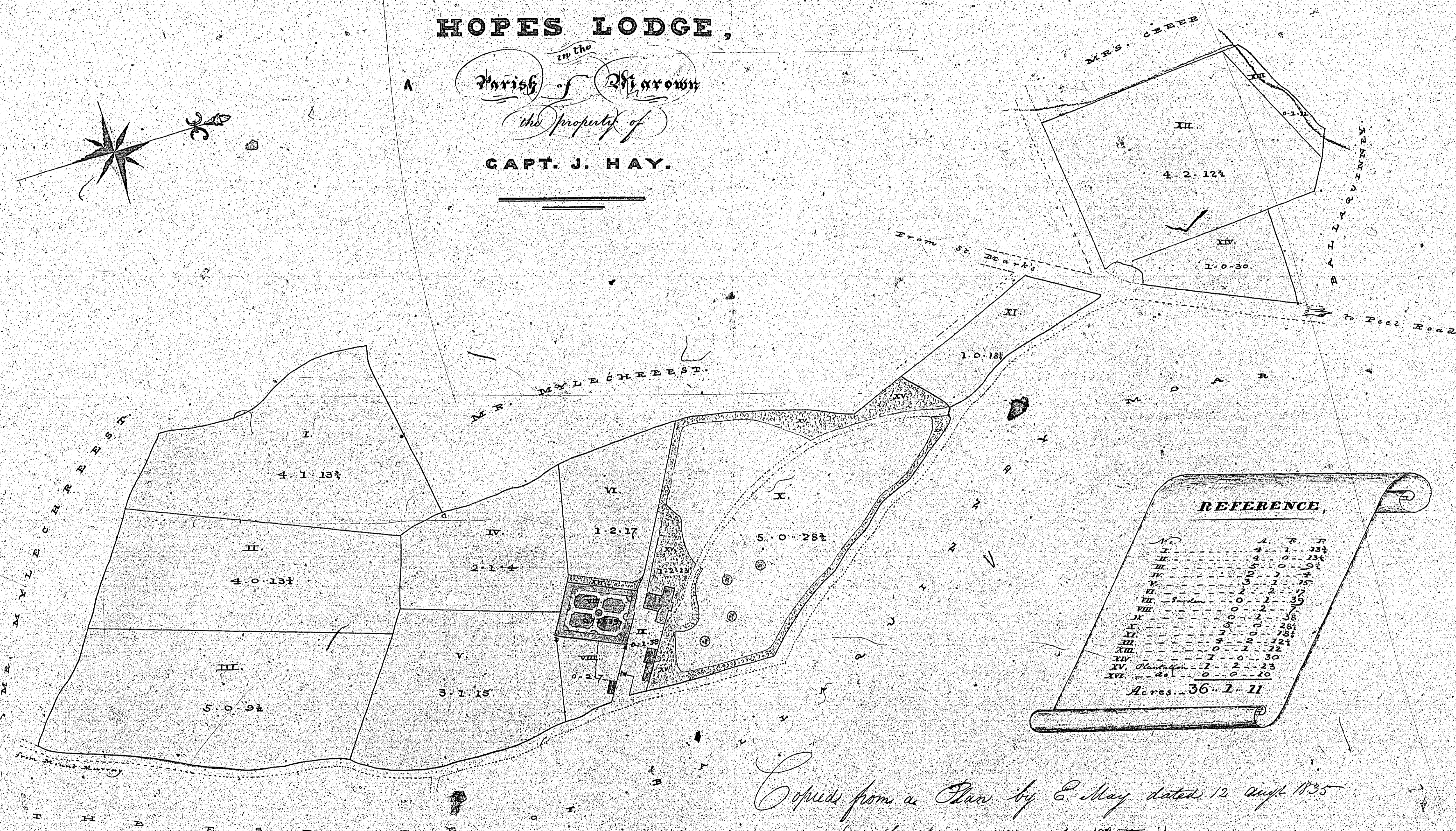
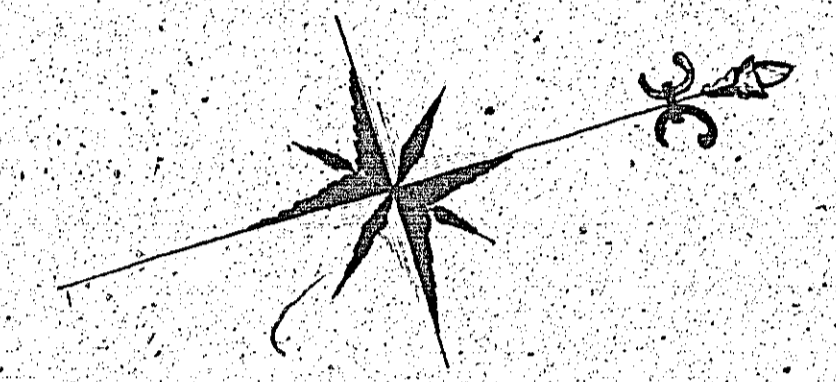

**REFERENCE**

No.	Acres	R.	F.
I	4	1	13 $\frac{1}{2}$
II	4	0	13 $\frac{1}{2}$
III	5	0	9 $\frac{1}{2}$
IV	2	1	4
V	3	1	15
VI	1	2	17
VII	1	0	18 $\frac{1}{2}$
VIII	0	2	7
IX	5	0	28 $\frac{1}{2}$
X	1	0	30
XI	4	2	12 $\frac{1}{2}$
XII	0	1	12
XIII	0	1	12
XIV	0	1	12
XV	0	1	12
XVI	0	1	12
XVII	0	1	12
Acres 36 1 11			

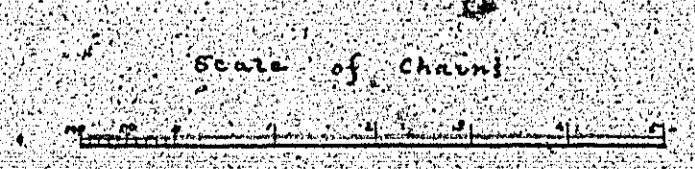

*Copied from a Plan by C. May dated 12 Aug 1835  
(with the exception of No. XI.)*

*The cross fences laid down and the contents calculated according to the  
several enclosures where they have been altered.*

*August 1840.  
John Goldsmith, Surveyor*