

Notice 80

PLAN AND SURVEY
OF
BALLAMODA,
IN THE PARISH OF MALEW,
THE PROPERTY OF MR. H. MYLECHREEST,
JANUARY, 1860.

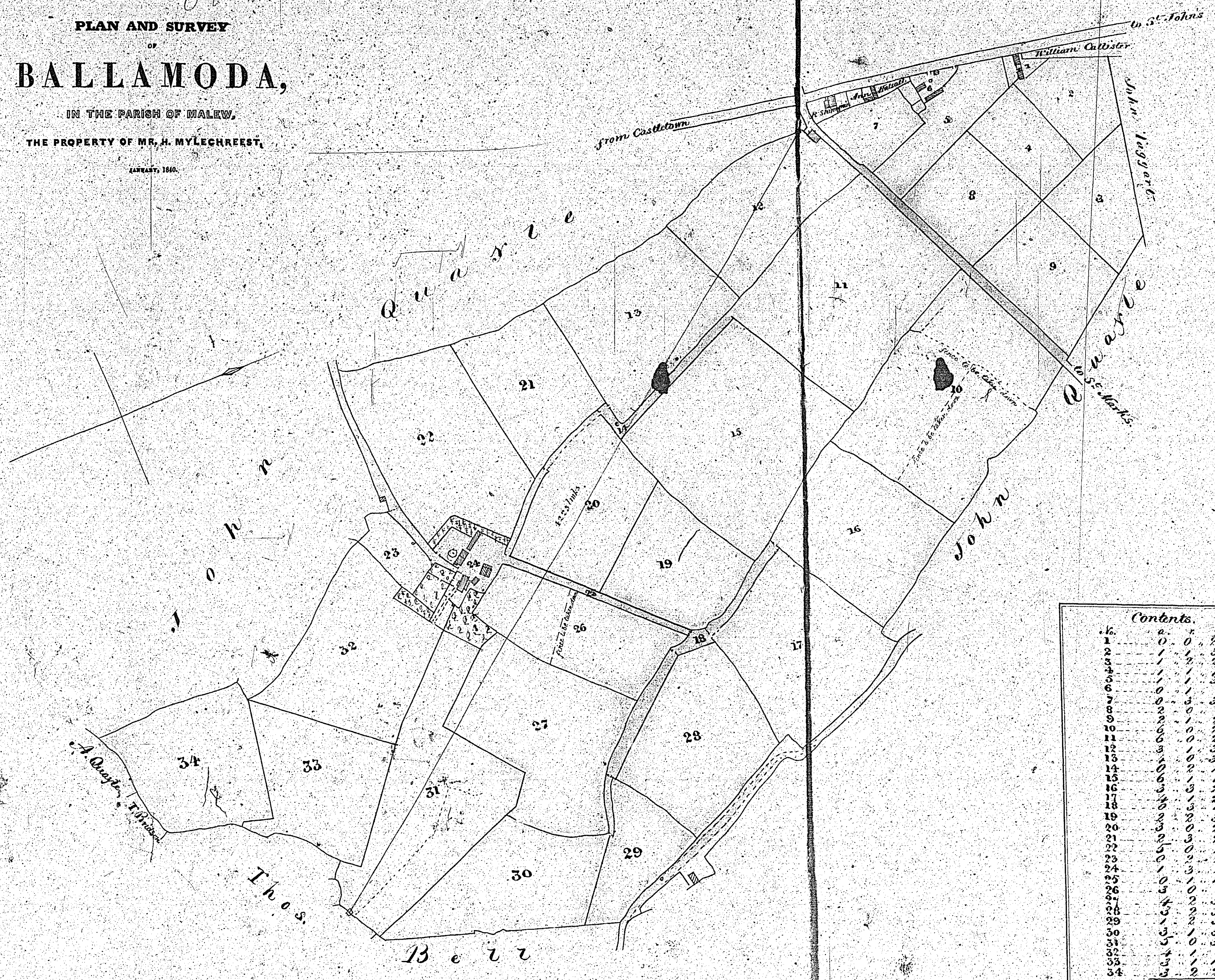

10 Chains
Jefferson and Kayll Surveyors.

Contents.			
16	a	r	p.
1	0	0	34
2	1	1	34
3	1	1	34
4	1	1	34
5	0	0	35
6	0	0	35
7	0	0	35
8	0	0	35
9	0	0	35
10	0	0	35
11	0	0	35
12	0	0	35
13	0	0	35
14	0	0	35
15	0	0	35
16	0	0	35
17	0	0	35
18	0	0	35
19	0	0	35
20	0	0	35
21	0	0	35
22	0	0	35
23	0	0	35
24	0	0	35
25	0	0	35
26	0	0	35
27	0	0	35
28	0	0	35
29	0	0	35
30	0	0	35
31	0	0	35
32	0	0	35
33	0	0	35
34	0	0	35
37-3-11			

Proportion of Public Roads Easements 1 0 78
Do. Occupation Do. 0 0 76

Plan 81
 Estate of Money Moor
 Parish of Malew
 The property of
 Mr. John Kelly
 & Co.

Edw. Shelley

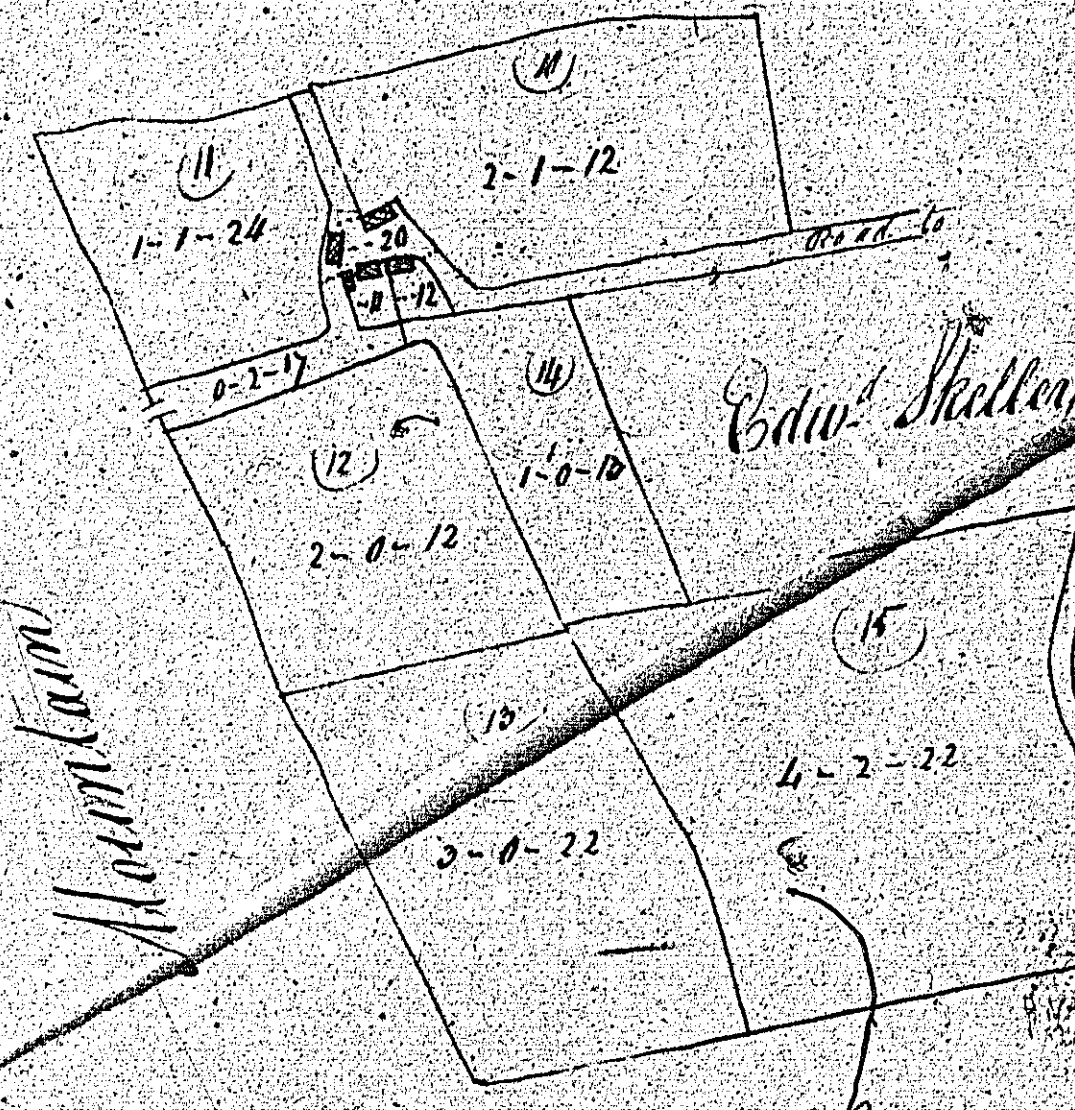

Saul Kay

Richd. Kelly and Wm. Prudson
 Scale of Chains

Ref.	Acres	sq. Rds.	sq. Poles
11	1	1	1
12	2	0	0
13	1	0	0
14	2	0	0
15	4	2	22
Total	10	2	22

Tracts of Land
 11-15
 16-20
 21-25
 26-30
 31-35
 36-40
 41-45
 46-50
 51-55
 56-60
 61-65
 66-70
 71-75
 76-80
 81-85
 86-90
 91-95
 96-100

ISLE OF MAN GOVERNMENT: GENERAL REGISTRY
 TITHE PLANS: PARISH OF MALEW
 Original coloured (decorative) 1:30

82

82
Plan
of the Estate of
Balmacgla
Intack Land
in the Parish of Malin
The Property of
Mr. JOHN MYLECHREEST

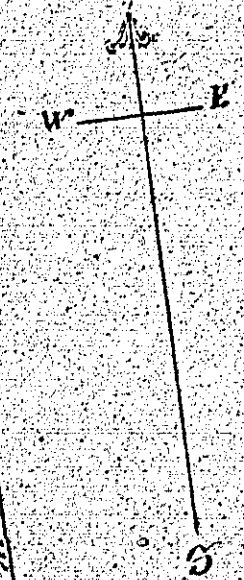

Contents		
1	1	2
2	1	20
3	1	10
4	1	10
5	1	20
6	1	4
7	1	10
8	1	0
9	1	23
10	0	0
11	1	12
12	1	18
13	1	2
Total		24

The Clerk Surveyor 1840

Scale & Chain 1/4 an Inch

Plan
part of the
Estate of Grenaby
in the
Parish of Malou
the property of
Mr. Geo. Maddrell
May 6. 1788

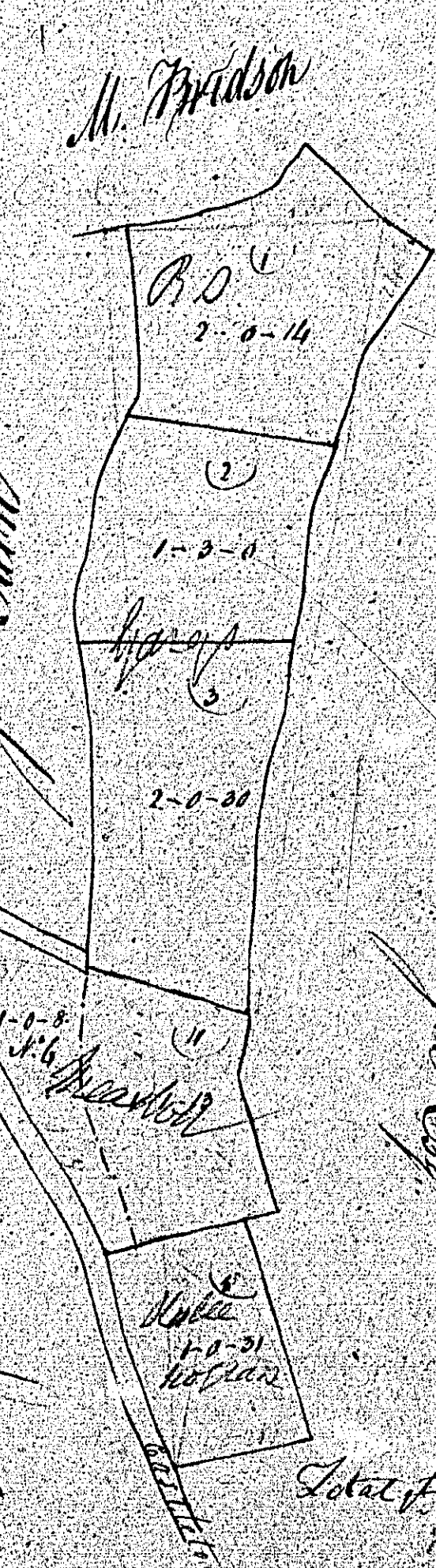

Mr. Geo. Maddrell

Reference

1	2	11
2	1	3
3	2	30
4	7	10
5	1	21

Total of Area 8-2-5
106-1-1
9-11

Scale of Chains



Joseph Wake Surveyor

Unsettled Land in Methuon parish

