

Survey
of a quantity of
Land
in the parish of
Hinkdon
the property of
Mr James Colister

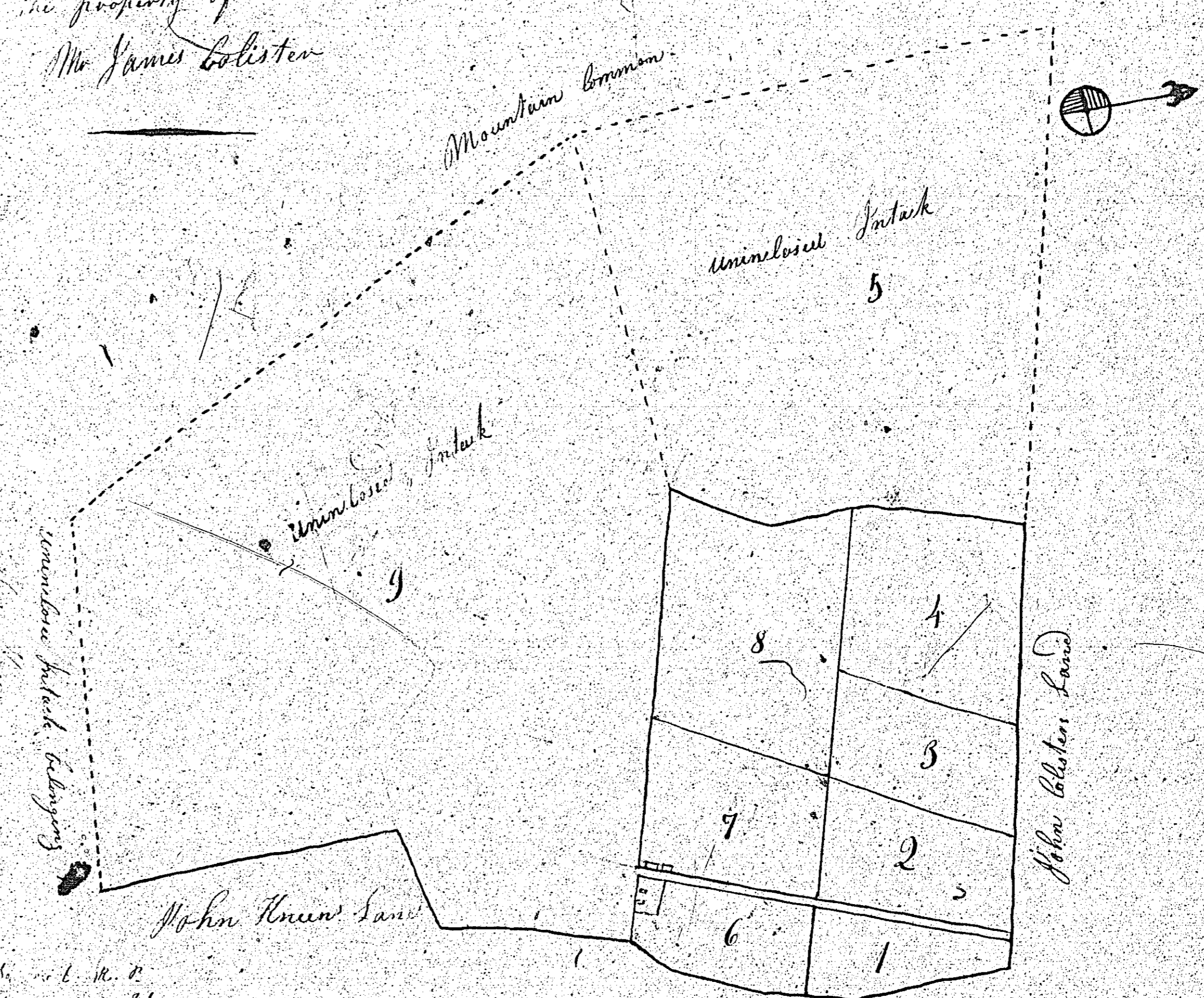

No.	Chains	Links	Links
1	1	1	26
2	1	3	5
3	1	2	17
4	2	1	8
5	13	1	2
6	1	1	19
7	1	2	13
8	3	1	34
9	26	11	36
Total	53	"	"

Scale
Three chains to an inch

This Estate all Intack

June 26th 1839
James Colister
Hinkdon

Not used

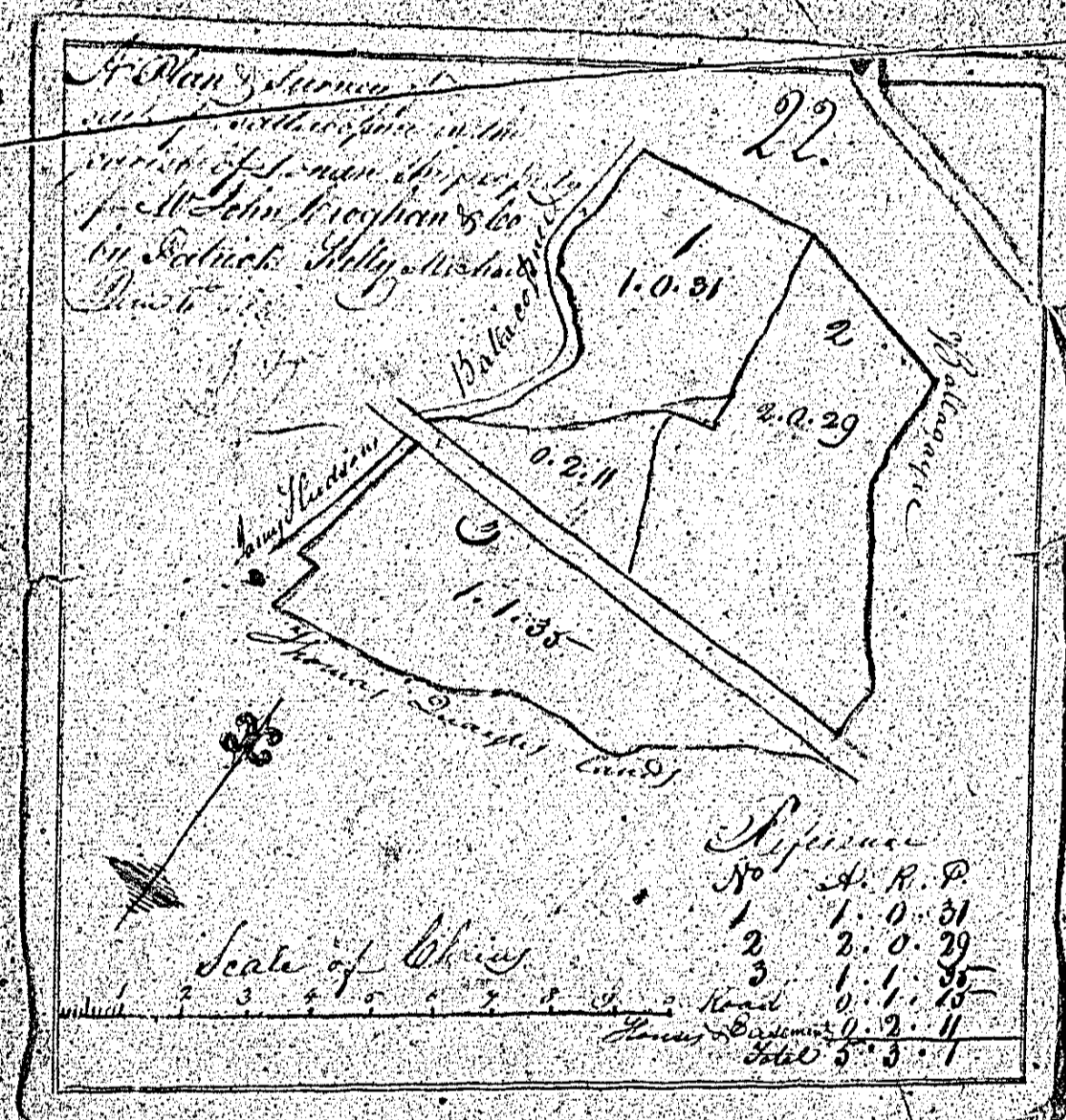

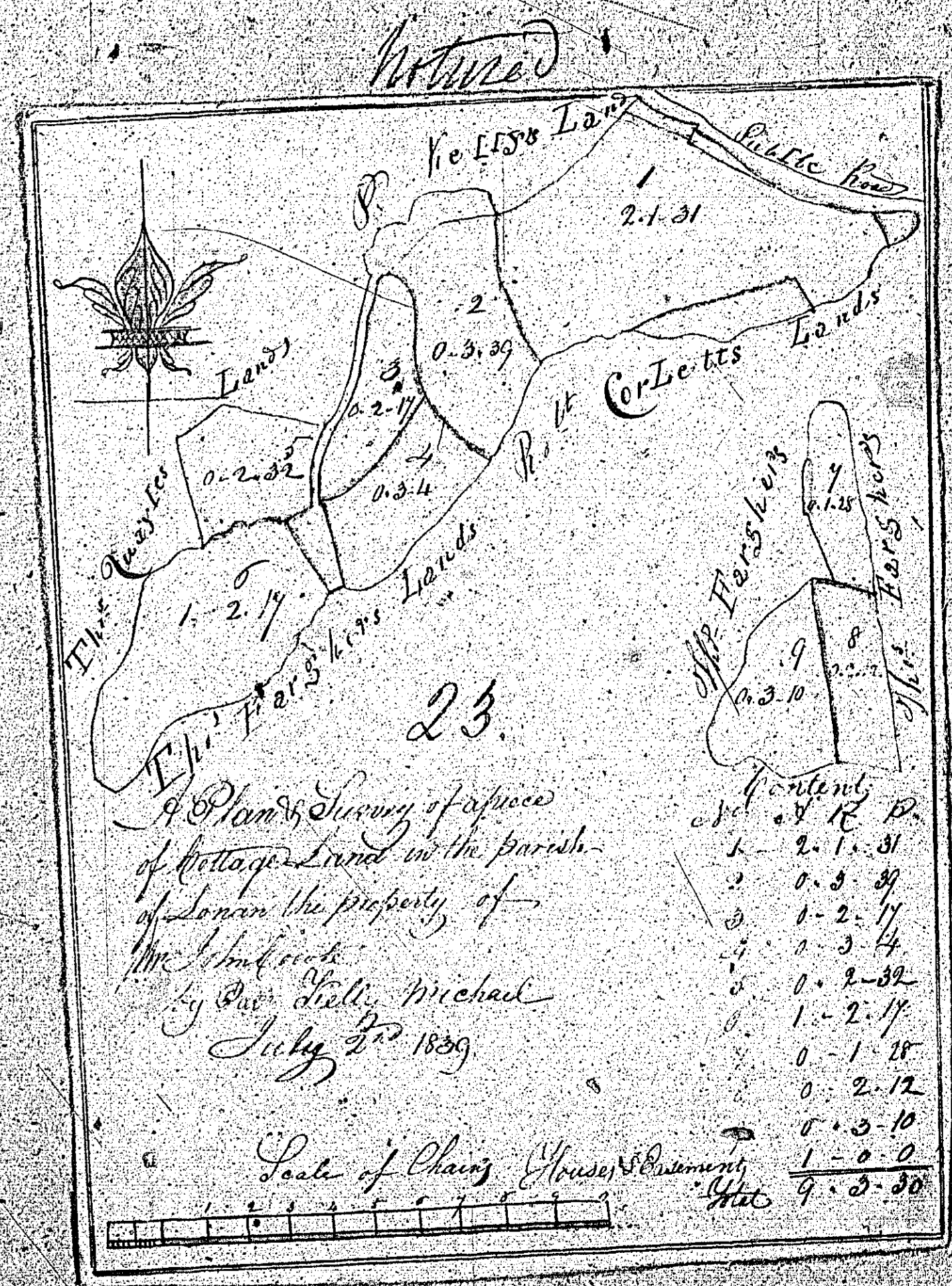

Wolsee

24.

6th Aug and
Gandinn 5-6



Spiegel

for 6 Aug, Philip Spack, May, Schellern, Th. Kinsky, and Th. Kinsky

Scale 1:1000

Survey
of part of the Estate of
Close Mass
Kirk Linn
the property of
Mr. Thomas Craik

26.

No.	1	2	3	4	5	6	7	8
	1	1	2	3	2	1	1	1
	18	37	34	27	27	24	2	
	11	3	3					

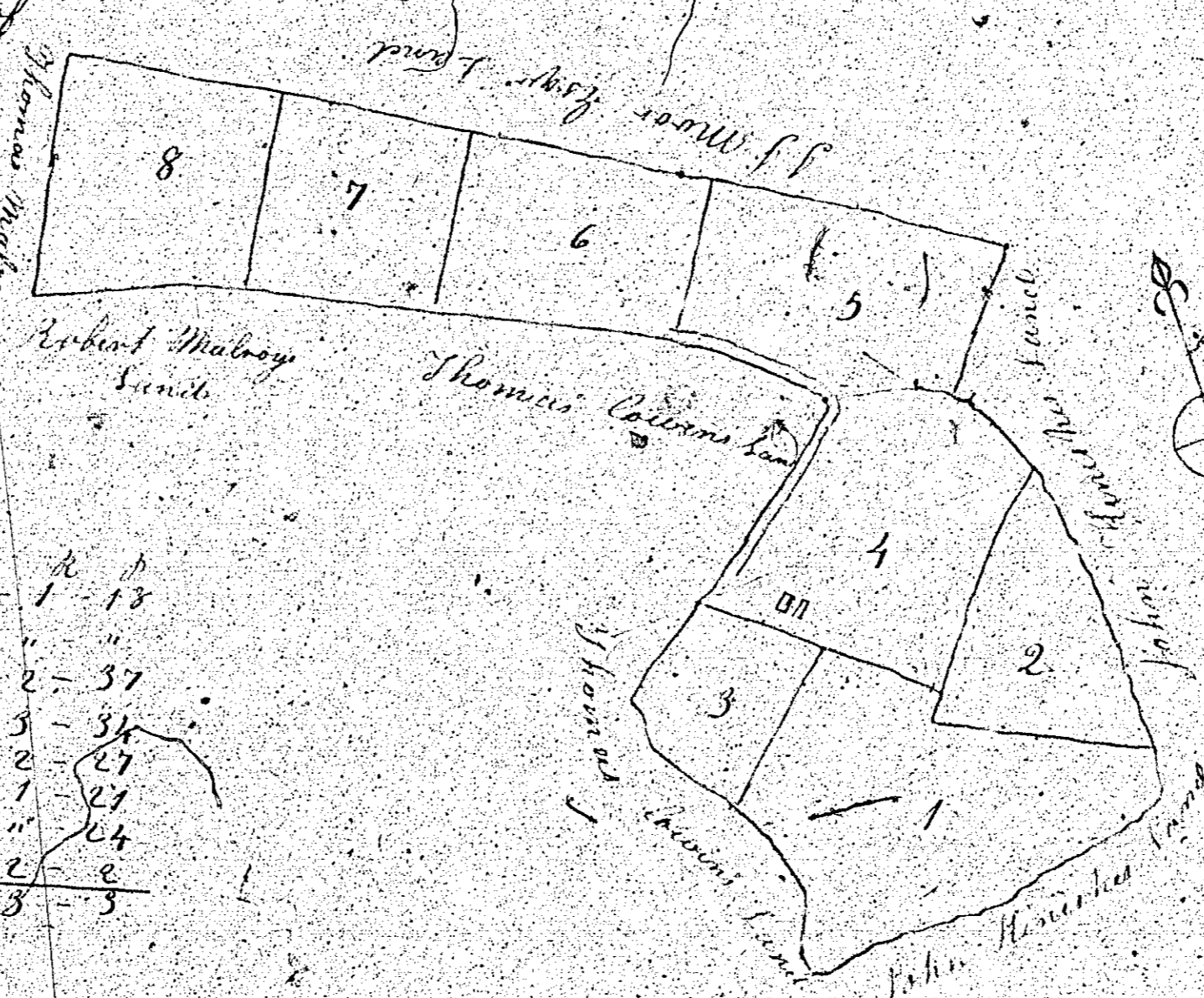

Scale
1 inch = 4000 ft

26th July 1820
Surveyed by me
James Gray
Kirk Linn