

322.

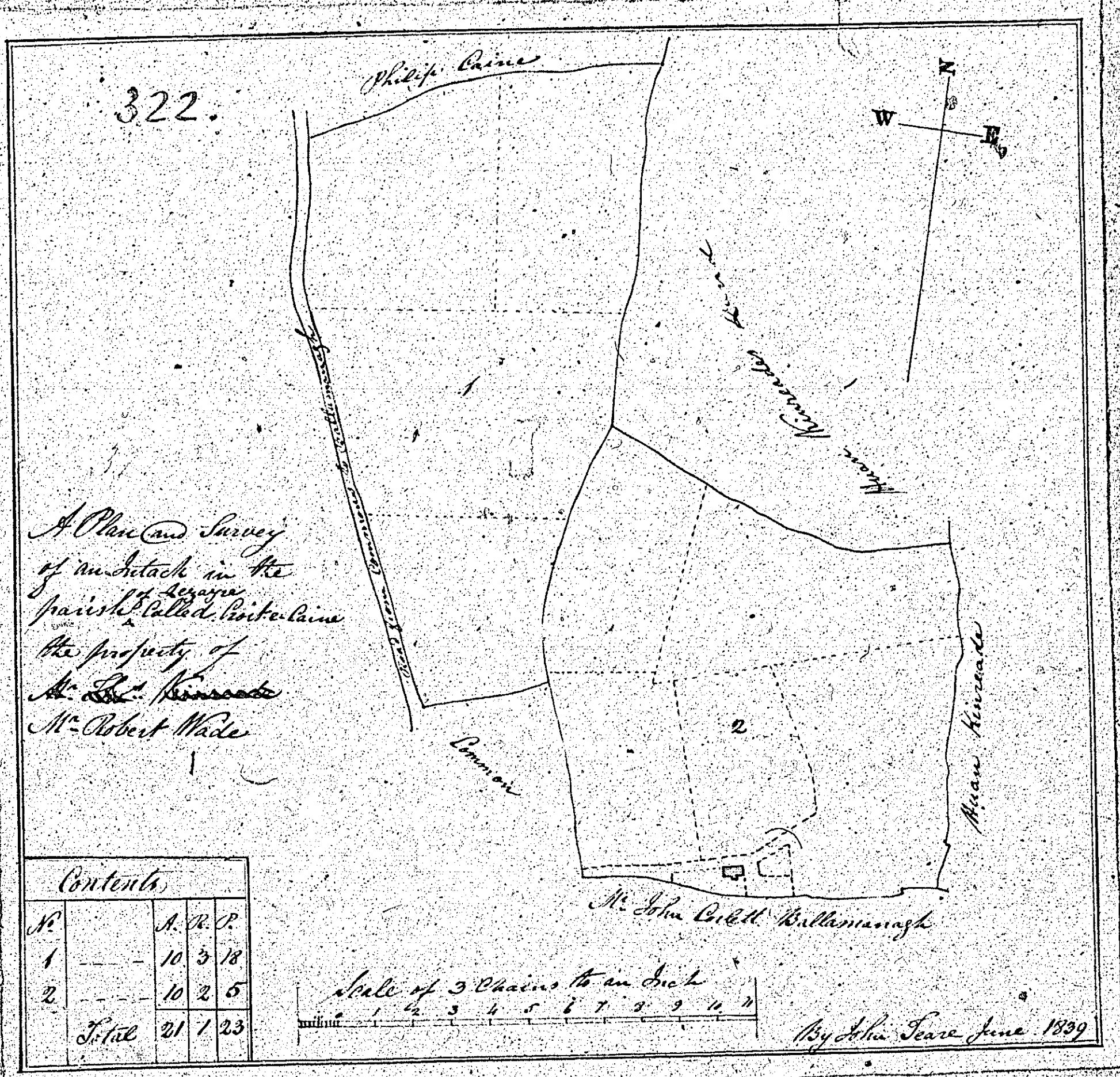

Contents		
No.	A.	R. P.
1	10	3 1/2
2	10	2 5/8
Total	20	1 23

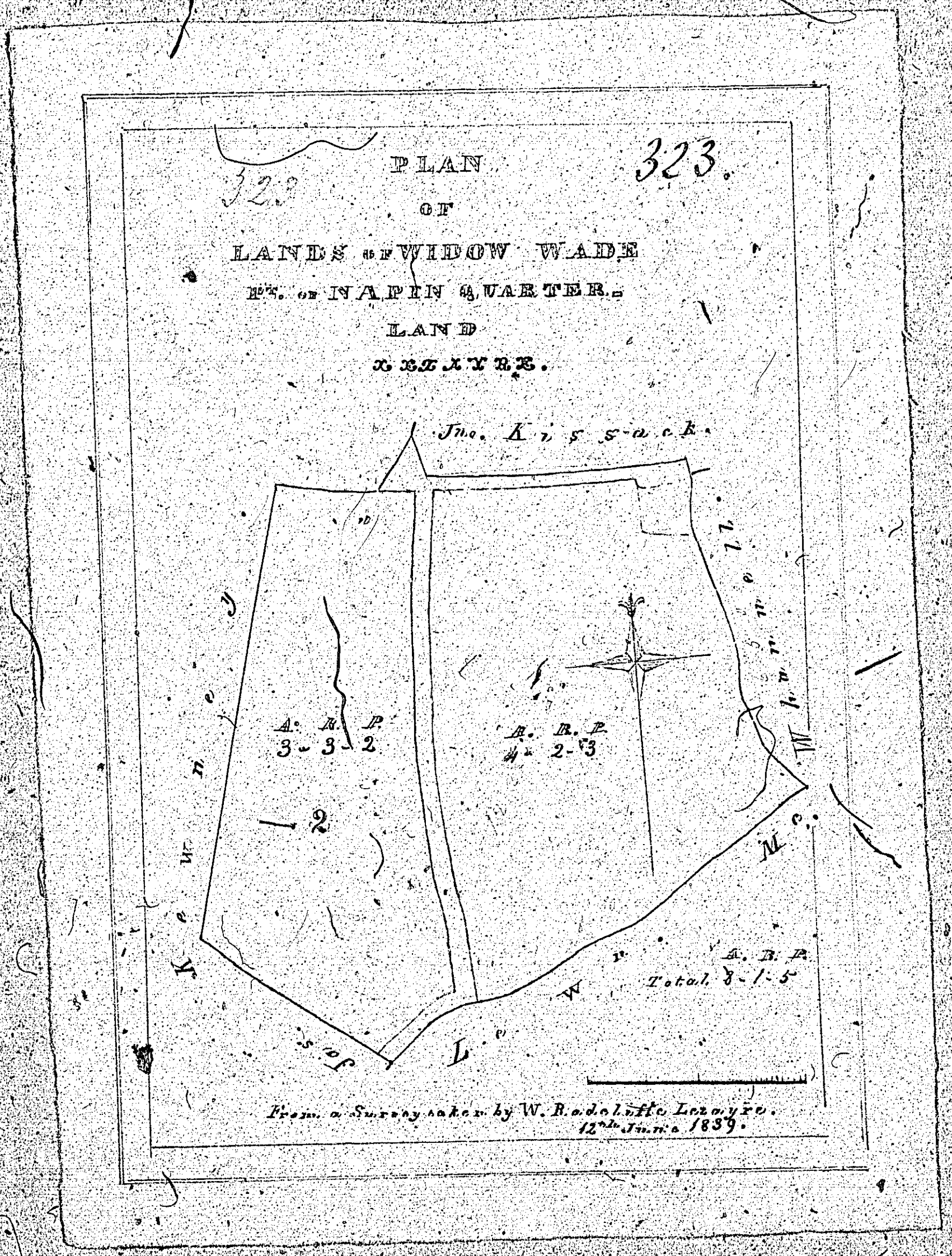





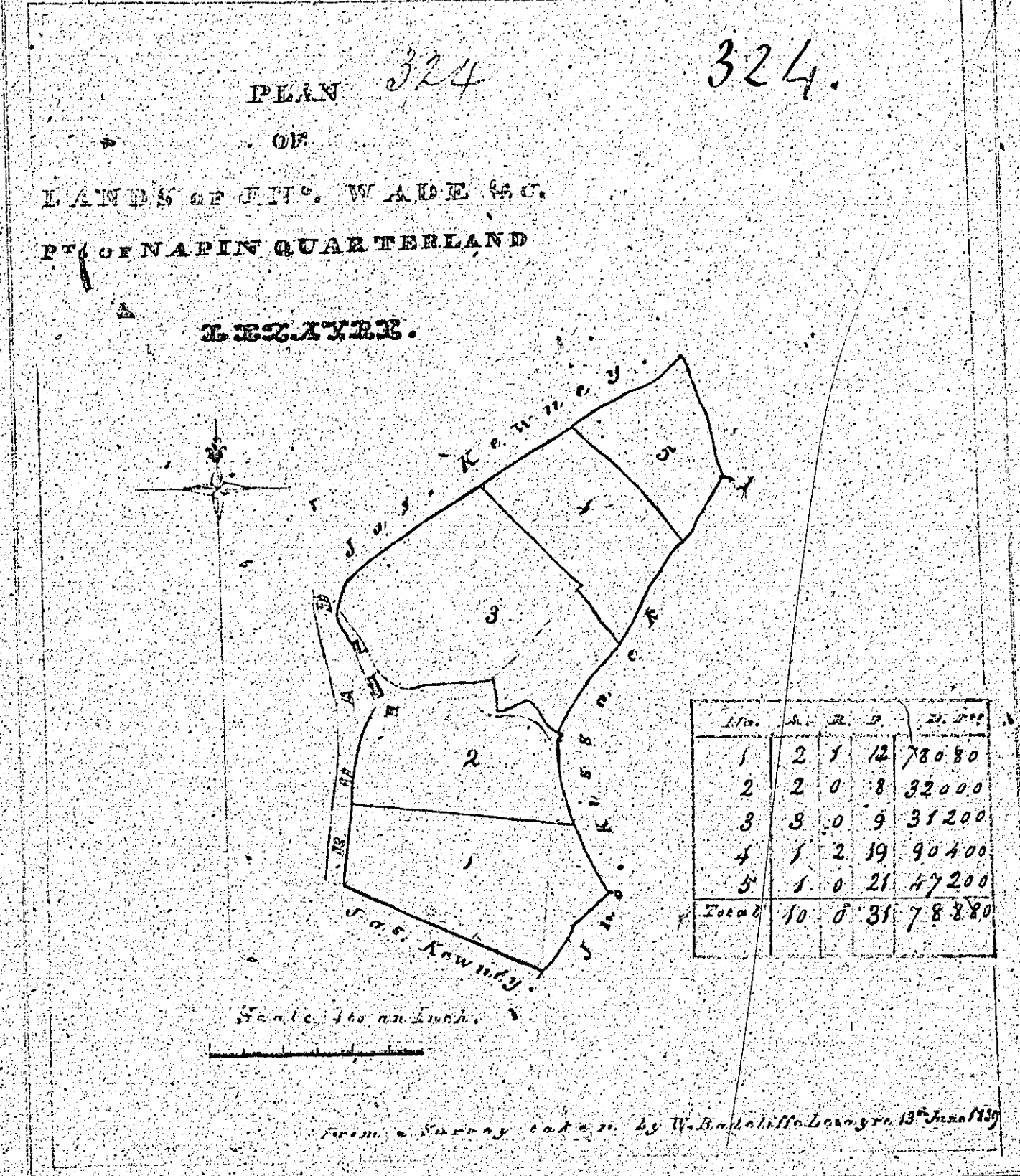



A Plan of a House & Garden  
 in the Parish of Lymington, part of the  
 Hundred of Bells, containing the  
 Property of J. G. Parker Esq by  
 Publick Survey 1742  
 Mr. Cunninghams Survey 325.

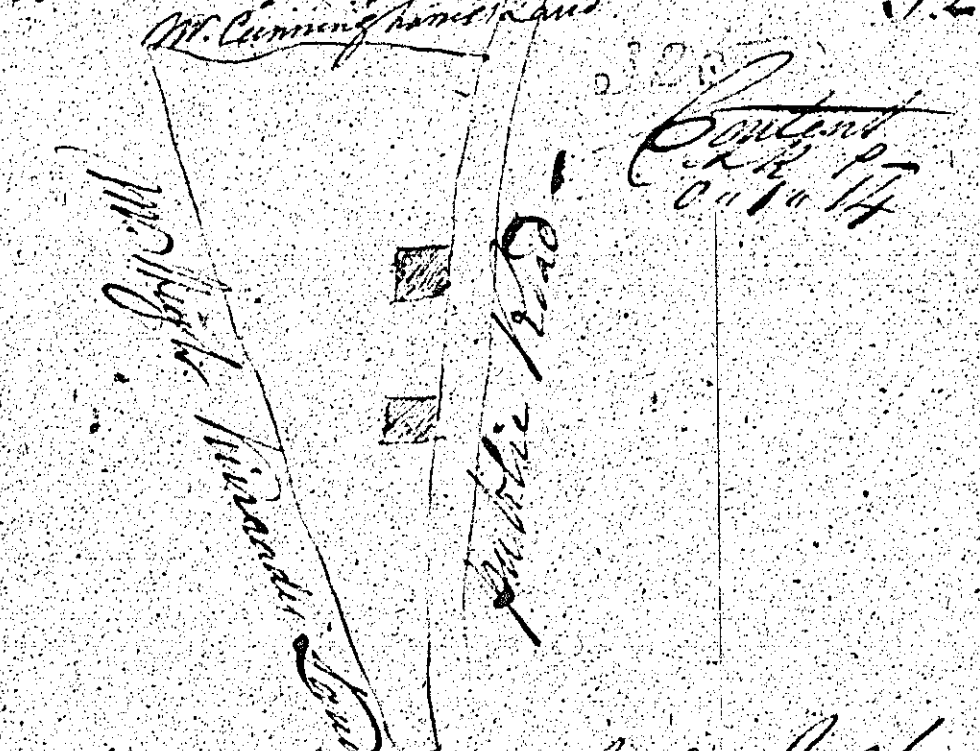

Scale a Chain to Six Inches



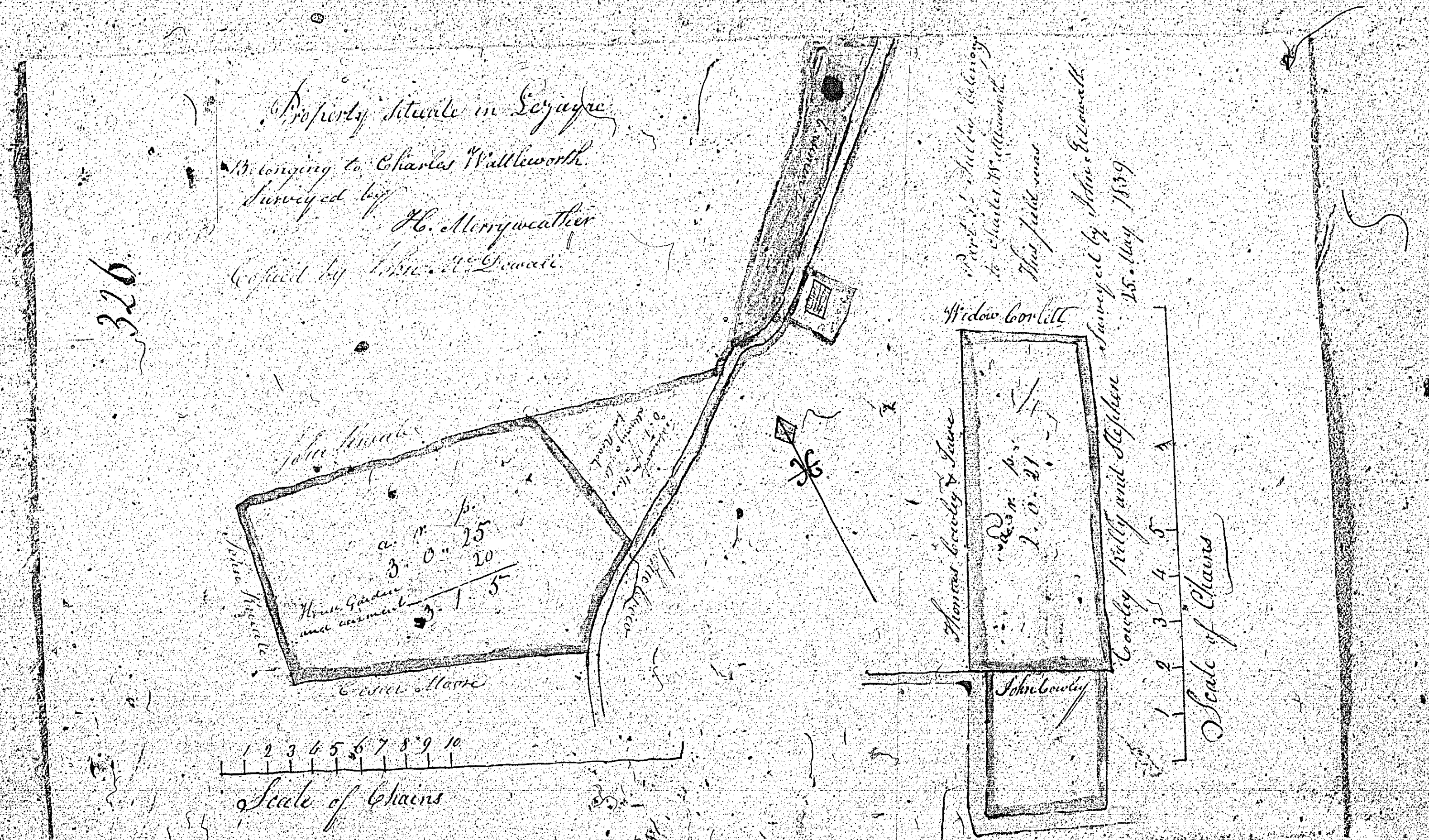

ISLE OF MAN GOVERNMENT: GENERAL REGISTRY  
 TITHE PLANS: PARISH OF LEZAYRE  
 Original coloured 1:30



*not used*

**The following 4 plans**

- (a) have no numbers in ink  
(2 sets of nos. in pencil)
- (b) Not recorded as plans in  
Tithe Composition book,  
Parish of Lezayre
- (c) Not listed on binding as  
being here.  
(numbering stops at 326)



not used

W. C. C. C.

N. 14

A Plan and Survey of a part  
of Cloynardjough in the parish  
of Scrigno the property of Thomas  
Harris taken July 15<sup>th</sup> 1839  
by Almer Hemmick  
A Scale of 36 chains to an Inch  
The Angle

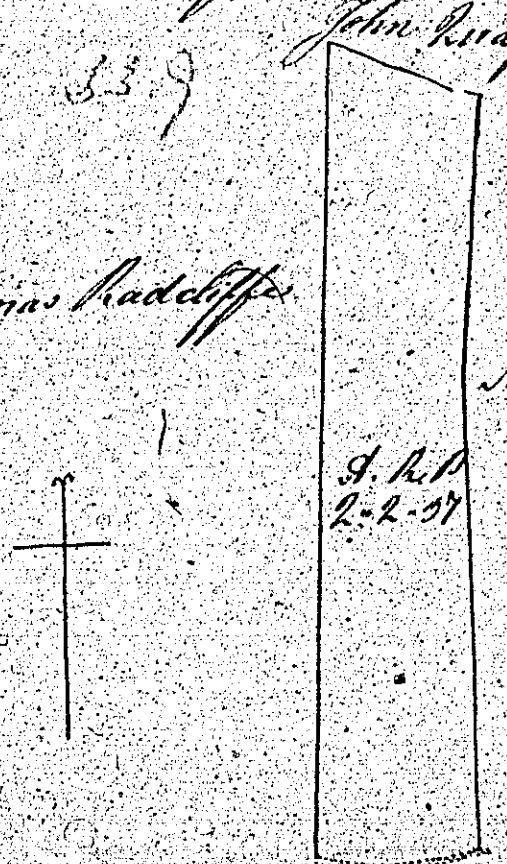

Thomas Radcliffe  
W. Collett  
J. R. P.  
2-2-37  
John Radcliffe  
J. C. Collett



*J. B. Lucas*

*Not used  
C. 15*

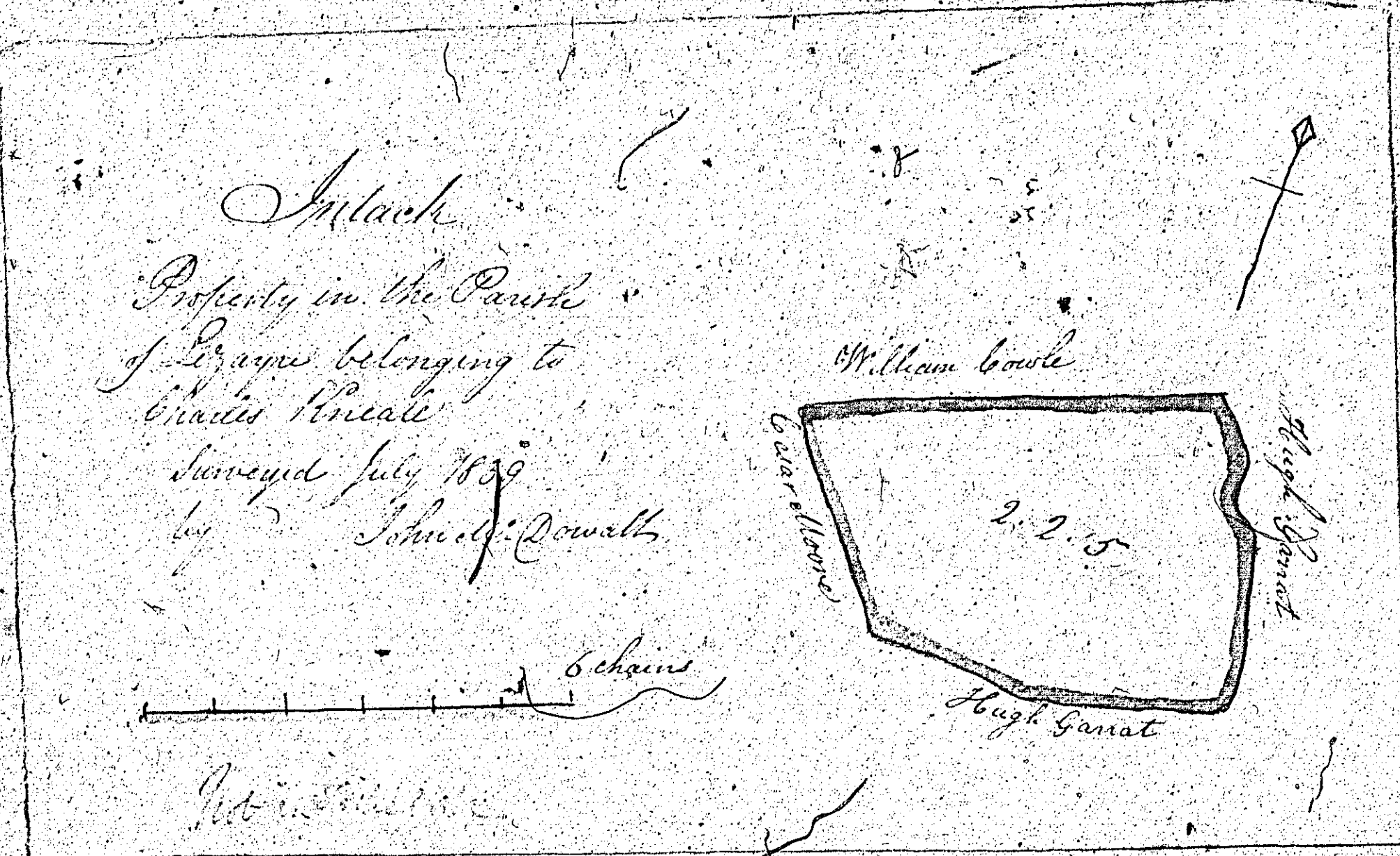

ISLE OF MAN GOVERNMENT: GENERAL REGISTRY

TITHE PLANS: PARISH OF LEZAYRE

Original coloured (decorative)

1:30







Noticed

J. 20

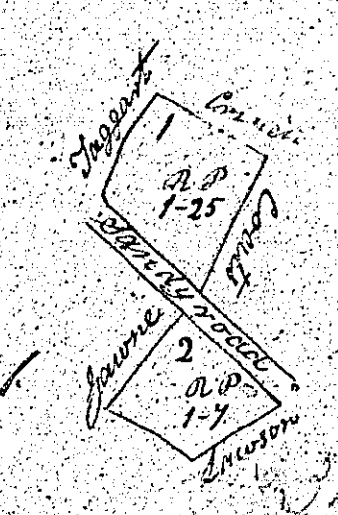
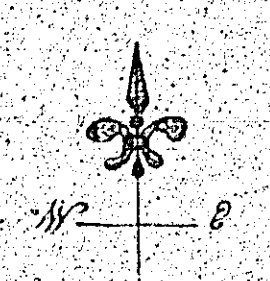

contents	
1	7 25
2	1 2
Total	2 37

Scale of Chains to one Inch

Plan and Survey  
 of Part of Ballacomb  
 in the Parish of Legnyre  
 Belonging to  
 the Lord of the Manor  
 by J. H. Smith  
 Legnyre July 14<sup>th</sup> 1839

In witness whereof I have hereunto set my hand and seal this 14th day of July 1839



END OF VOLUME