

Not used

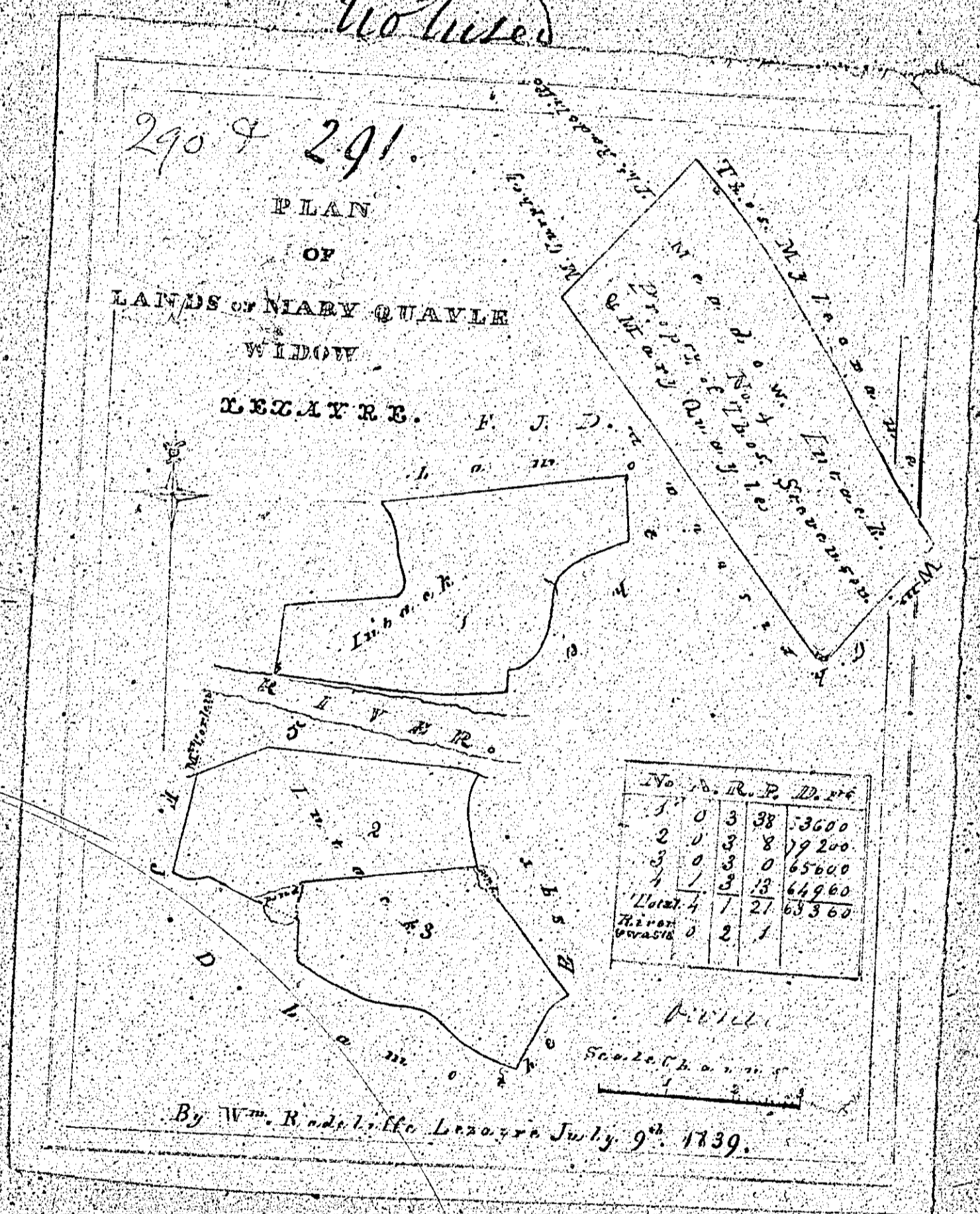

North

Section 10, T. 12 N., R. 10 W., Ga. 1839

No. 1

Chico

By Wm. H. Adair, Jr.

1839

10

20

30

40

50

60

70

80

90

100

110

120

130

140

150

160

170

180

190

200

210

220

230

240

250

260

270

280

290

300

310

320

330

340

350

360

370

380

390

400

410

420

430

440

450

460

470

480

490

500

510

520

530

540

550

560

570

580

590

600

610

620

630

640

650

660

670

680

690

700

710

720

730

740

750

760

770

780

790

800

810

820

830

840

850

860

870

880

890

900

910

920

930

940

950

960

970

980

990

1000

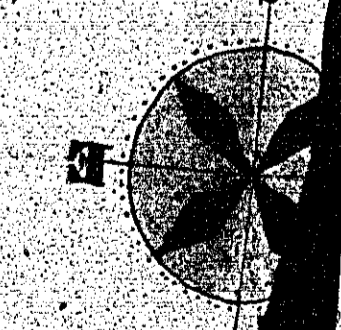

202.

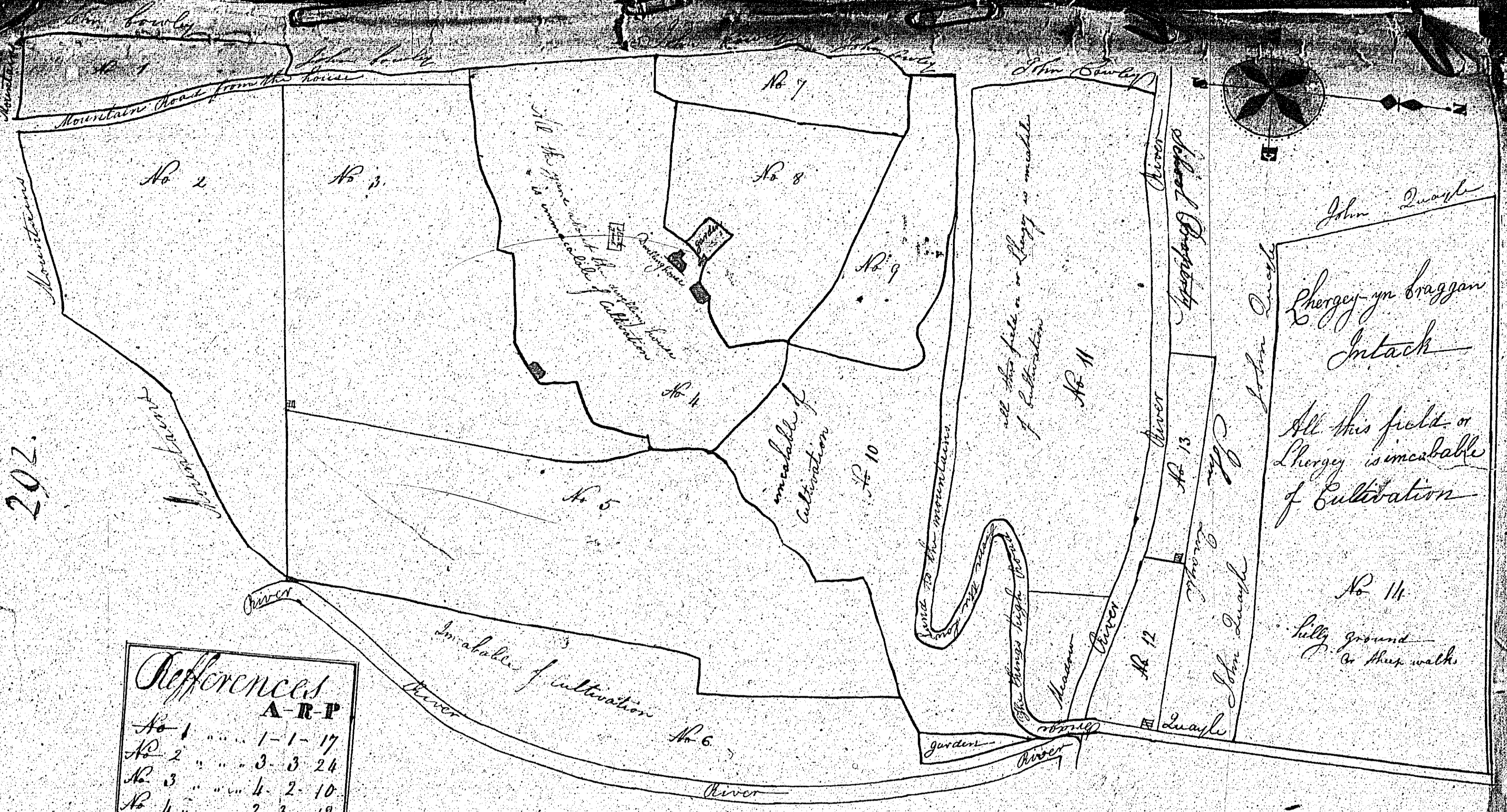

*Differences*

	A	R	P
No 1	1	-1	-17
No 2	3	-3	24
No 3	4	-2	10
No 4	2	-3	-12
No 5	4	-3	-38
No 6	2	-3	-19
No 7	1	-1	-9
No 8	3	-2	-14
No 9	2	-1	-15
No 10	8	-3	-17
No 11	0	-2	-10
No 12	0	3	-27
No 13	10	-0	-27
No 14	48	-0	39
<i>Easements and roads</i>	2	-3	-37

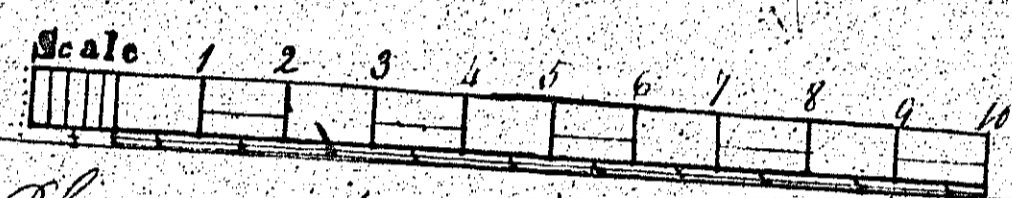

**C R A G G A N**

*A Plan and Survey of the one part of the Quarterland of Corody called Braggan in the Parish of Lezayre the property of John Duayle. The Braggan is a hilly ground therefore it is surveyed by the Horizontal plane. There are 26 Acres 2 Roods and 32 perches incapable of cultivation otherwise it cannot possibly be cultivated. Excluding Roads and Easements Surveyed by Daniel Bailey Jerby Past School master and very much by me to have it correct*

ISLE OF MAN GOVERNMENT: GENERAL REGISTRY  
 TITHE PLANS: PARISH OF LEZAYRE  
 Original coloured (decorative) 1:30

293  
 Plan of Ballasterla  
 in the Parish of Lezayre  
 The Property of  
 Mr. John Quayle  
 The whole of this Estate  
 is Prescribed  
 Noticed  
 293.



Survey  
 in the  
 Parish of  
 Lezayre  
 by  
 John Quayle  
 18th April 1837

1	1.2.26	1.2.26
2	5.2.10	5.2.10
3	2.2.0	2.2.0
4	1.2.26	1.2.26
5	6.1.0	6.1.0
6	2.2.22	2.2.22
7	1.2.24	1.2.24
8	2.2.0	2.2.0
9	2.0.1	2.0.1
10	4.4.0	4.4.0
11	2.0.1	2.0.1
12	1.2.24	1.2.24
13	1.0.5	1.0.5
14	1.3.25	1.3.25
15	1.1.21	1.1.21
16	2.0.1	2.0.1
17	2.0.1	2.0.1
18	2.1.6	2.1.6
19	2.1.23	2.1.23
20	11.2.5	11.2.5
21	1.5.25	1.5.25
22	1.5.25	1.5.25
23	102.0.3	102.0.3

Contents  
 190-3-38



ISLE OF MAN GOVERNMENT: GENERAL REGISTRY  
 TITHE PLANS: PARISH OF LEZAYRE  
 Original coloured (decorative) 1:30

Scale of 3 chains  
 1837

Howell  
 Survey 1837





Noticed

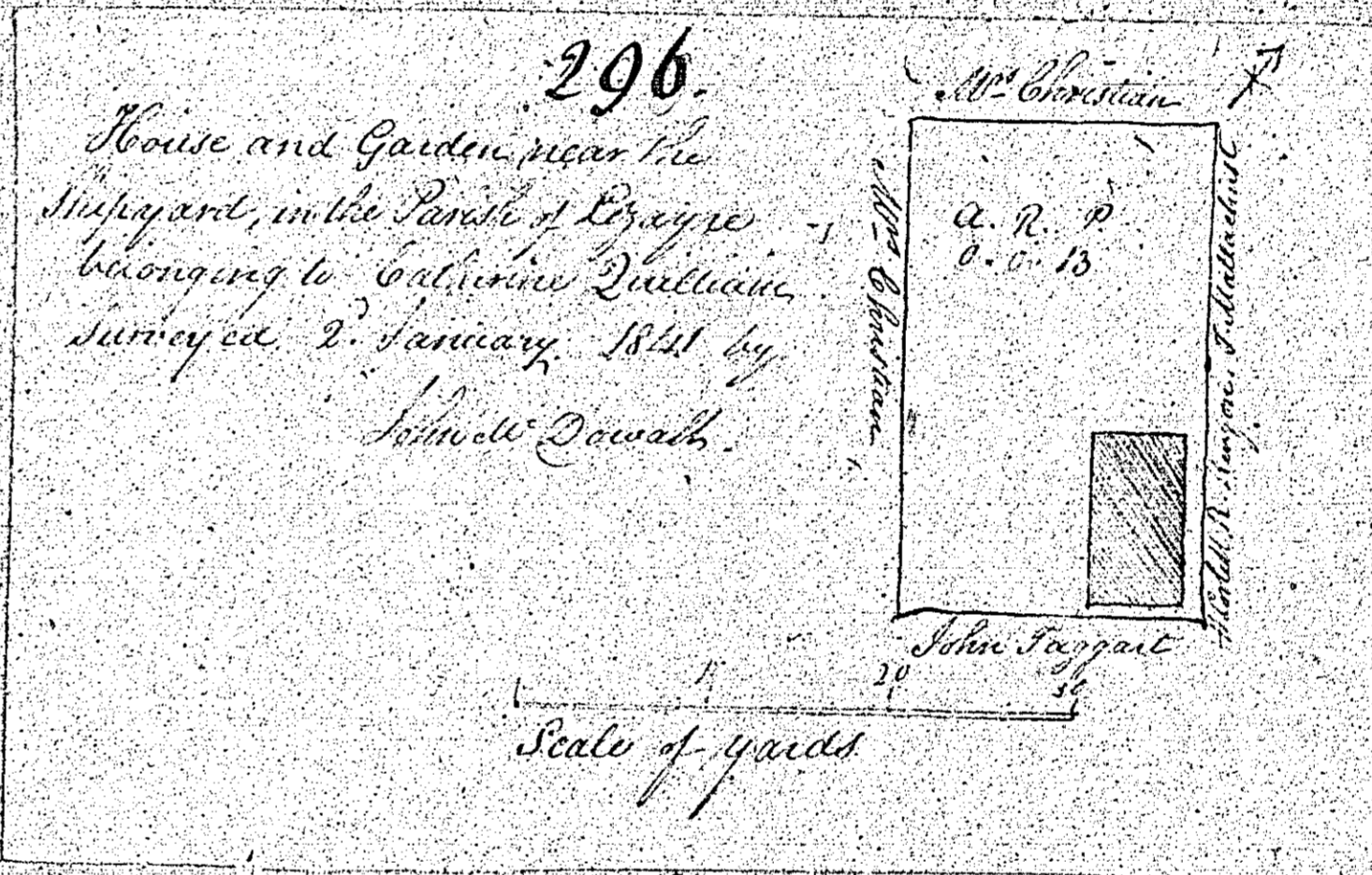

yard

land

and Survey  
 of the  
 Millpond in the  
 Parish of Brayre  
 the property of  
 Colonel Quilman  
 by John Dewalt  
 2<sup>d</sup> Jan<sup>y</sup> 1841

ft	in	A. R. P.
1	0	0. 0. 0
2	0	0. 0. 0
3	0	0. 0. 0
4	0	0. 0. 0
5	0	0. 0. 0
6	0	0. 0. 0
7	0	0. 0. 0
8	0	0. 0. 0
9	0	0. 0. 0
10	0	0. 0. 0
11	0	0. 0. 0
12	0	0. 0. 0
13	0	0. 0. 0
14	0	0. 0. 0
15	0	0. 0. 0
16	0	0. 0. 0
17	0	0. 0. 0
18	0	0. 0. 0
19	0	0. 0. 0
20	0	0. 0. 0
21	0	0. 0. 0
22	0	0. 0. 0
23	0	0. 0. 0
24	0	0. 0. 0
25	0	0. 0. 0
26	0	0. 0. 0
27	0	0. 0. 0
28	0	0. 0. 0
29	0	0. 0. 0
30	0	0. 0. 0
31	0	0. 0. 0
32	0	0. 0. 0
33	0	0. 0. 0
34	0	0. 0. 0
35	0	0. 0. 0
36	0	0. 0. 0
37	0	0. 0. 0
38	0	0. 0. 0
39	0	0. 0. 0
40	0	0. 0. 0
41	0	0. 0. 0
42	0	0. 0. 0
43	0	0. 0. 0
44	0	0. 0. 0
45	0	0. 0. 0
46	0	0. 0. 0
47	0	0. 0. 0
48	0	0. 0. 0
49	0	0. 0. 0
50	0	0. 0. 0

2-27  
 2-28  
 0-29  
 2-30  
 3-31  
 3-32  
 3-33  
 3-34  
 3-35  
 3-36  
 3-37  
 3-38  
 3-39  
 3-40  
 3-41  
 3-42  
 3-43  
 3-44  
 3-45  
 3-46  
 3-47  
 3-48  
 3-49  
 3-50  
 3-51  
 3-52  
 3-53  
 3-54  
 3-55  
 3-56  
 3-57  
 3-58  
 3-59  
 3-60  
 3-61  
 3-62  
 3-63  
 3-64  
 3-65  
 3-66  
 3-67  
 3-68  
 3-69  
 3-70  
 3-71  
 3-72  
 3-73  
 3-74  
 3-75  
 3-76  
 3-77  
 3-78  
 3-79  
 3-80  
 3-81  
 3-82  
 3-83  
 3-84  
 3-85  
 3-86  
 3-87  
 3-88  
 3-89  
 3-90  
 3-91  
 3-92  
 3-93  
 3-94  
 3-95  
 3-96  
 3-97  
 3-98  
 3-99  
 3-100