

Complete with plan

A Plan and survey of a part of Hennebich
 reg. &c in the parish of Laxayre the property
 of Thomas Kelly taken July 29th 1869
 195 By Thomas Hornish

Contents

No. 1	10. 10.
No. 2	10. 10.
No. 3	10. 10.
No. 4	10. 10.
No. 5	10. 10.
No. 6	10. 10.
No. 7	10. 10.
No. 8	10. 10.
No. 9	10. 10.
No. 10	10. 10.
No. 11	10. 10.
No. 12	10. 10.
No. 13	10. 10.
No. 14	10. 10.
No. 15	10. 10.
No. 16	10. 10.
No. 17	10. 10.
No. 18	10. 10.
No. 19	10. 10.
No. 20	10. 10.
No. 21	10. 10.
No. 22	10. 10.
No. 23	10. 10.
No. 24	10. 10.
No. 25	10. 10.
No. 26	10. 10.
No. 27	10. 10.
No. 28	10. 10.
No. 29	10. 10.
No. 30	10. 10.
No. 31	10. 10.
No. 32	10. 10.
No. 33	10. 10.
No. 34	10. 10.
No. 35	10. 10.
No. 36	10. 10.
No. 37	10. 10.
No. 38	10. 10.
No. 39	10. 10.
No. 40	10. 10.
No. 41	10. 10.
No. 42	10. 10.
No. 43	10. 10.
No. 44	10. 10.
No. 45	10. 10.
No. 46	10. 10.
No. 47	10. 10.
No. 48	10. 10.
No. 49	10. 10.
No. 50	10. 10.

A scale of 3 chains to an Inch

21
22
23
24
25
26
27
28
29
30
31
32
33
34
35
36
37
38
39
40
41
42
43
44
45
46
47
48
49
50

A Plan and Survey of a
 part of the Upper Quarterland
 and a parcel of Inland situated
 in the parish of Leazes the par-
 cels of James Hennas taken
 May 24th 1839 by
 J. B. Hennas

196.

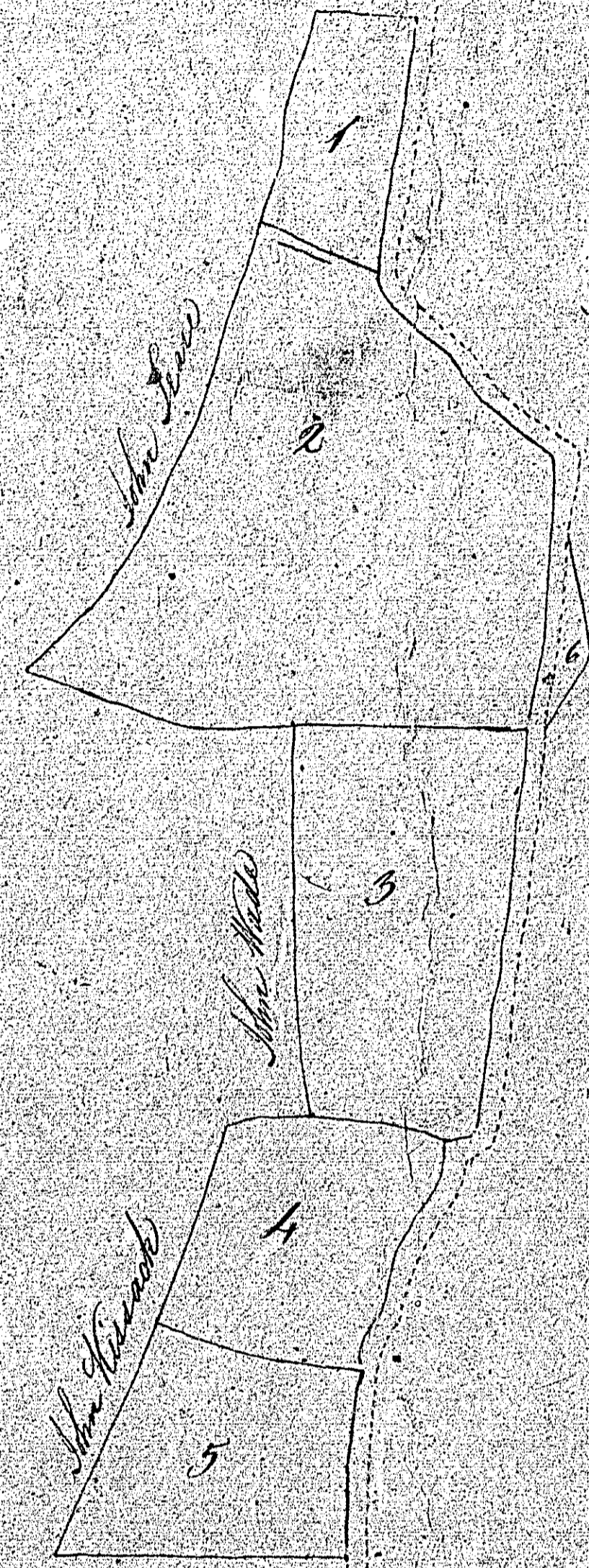

Contents

No	A	P	Q
1	0	3	24
2	1	2	24
3	5	2	24
4	2	2	21
5	2	1	12
6	0	0	22
7	2	0	11
8	1	2	16
9	1	3	24
10	1	2	11
11	1	0	11
	25	2	19

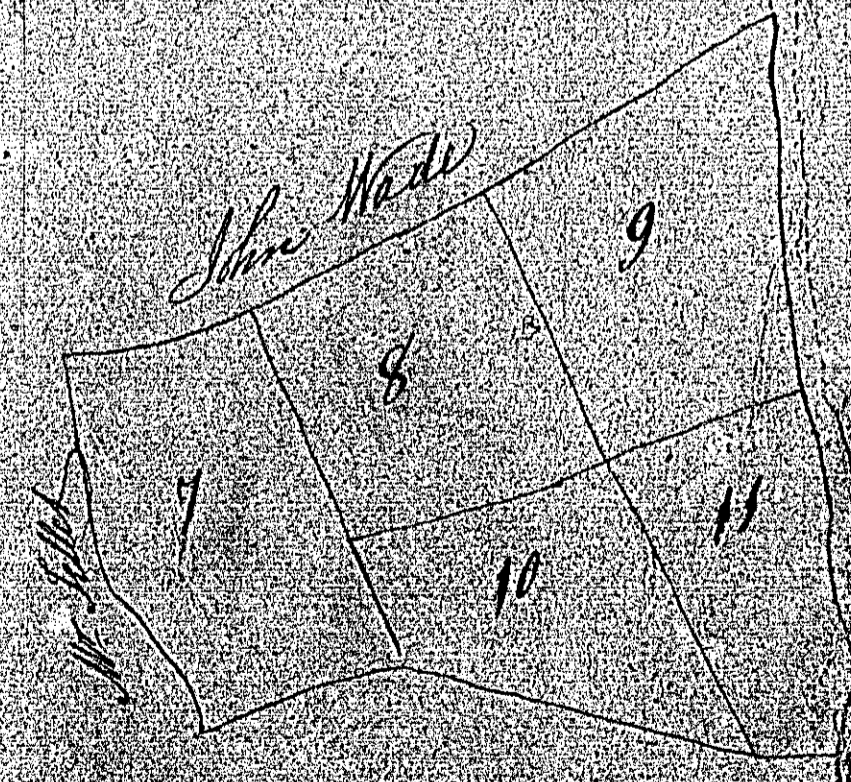

A scale of 5 Chains to an inch.

2
 2
 3
 2

197. 137 House and Garden by
the Shipyard belonging to
Robert Keyson
July 1839
W. McDonald



27
26
25
24
23
22

W. McDonald

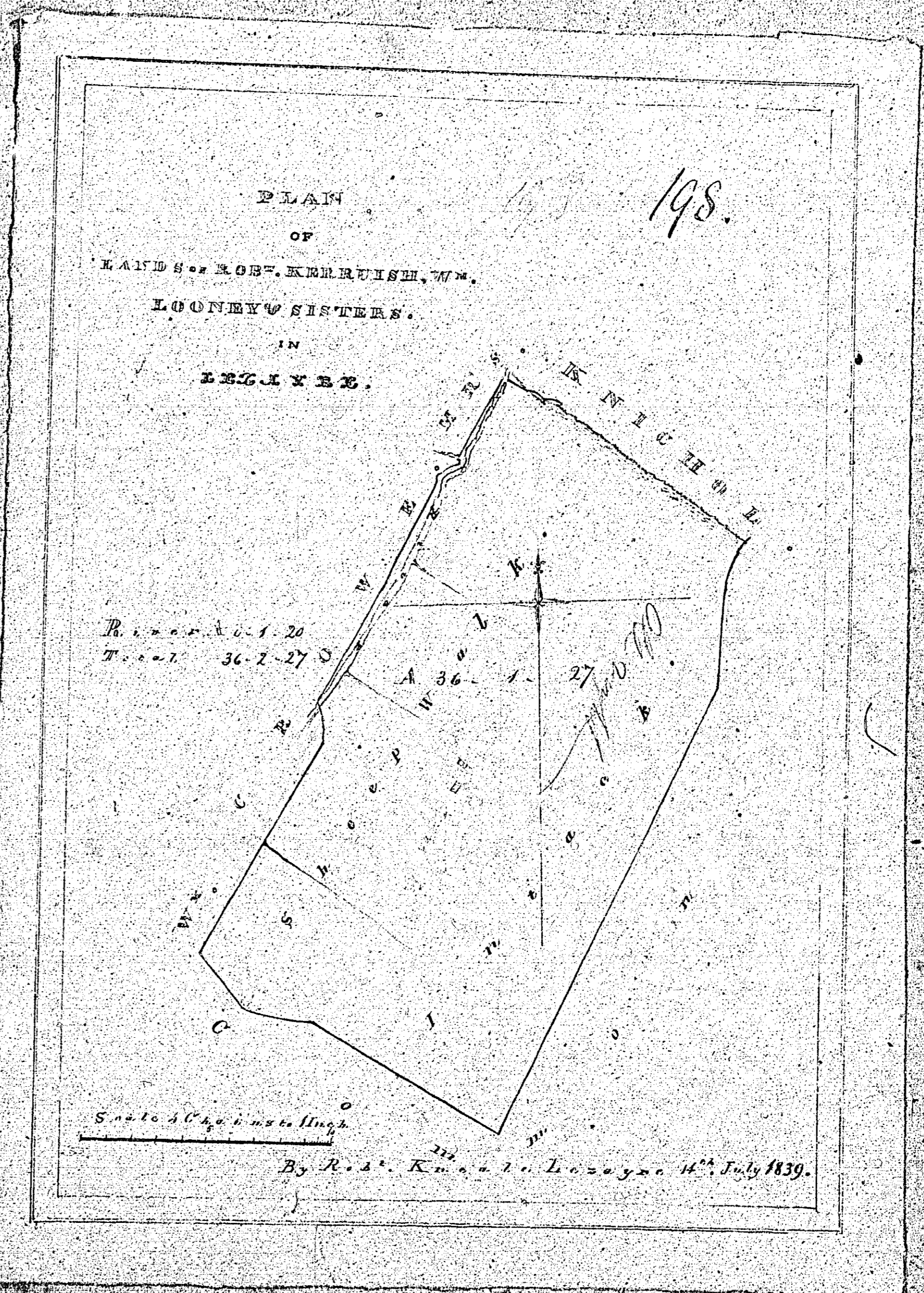

2 27
3 27
12 12

The Contents of this Book are as follows

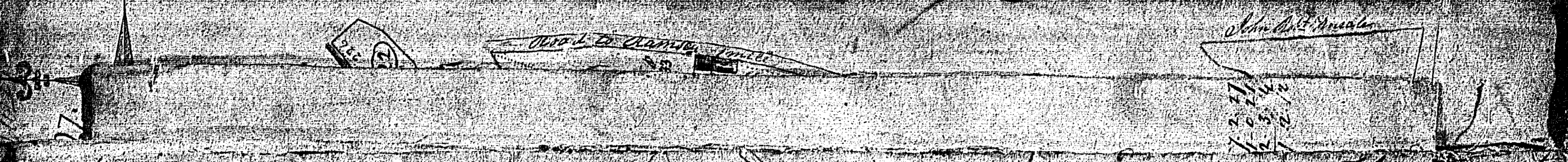

A Plan and Survey of
A part of the Ballyshannon
of the Glenmoss in the
parish of Lezayre the
property of John Martin
taken May 31st 1839
by Alfred Herrieh

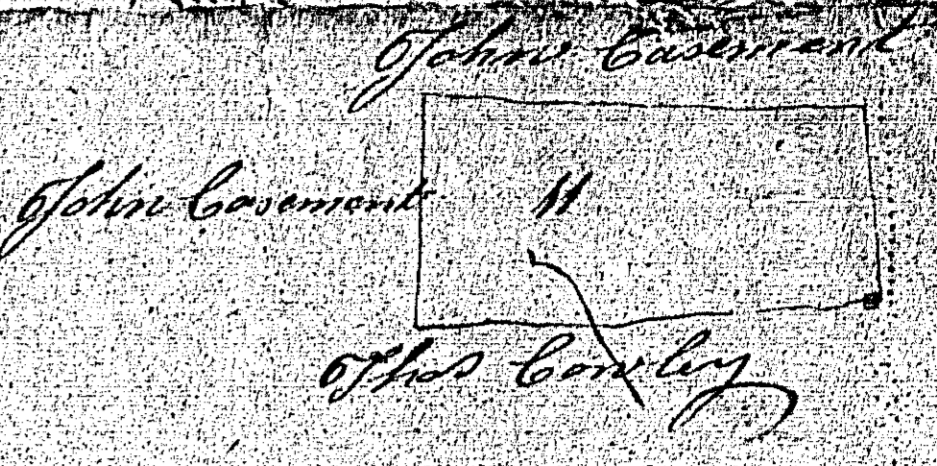
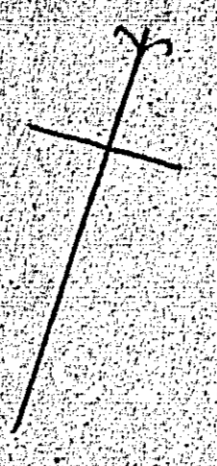

1099

A scale of 3 Chains to an Inch

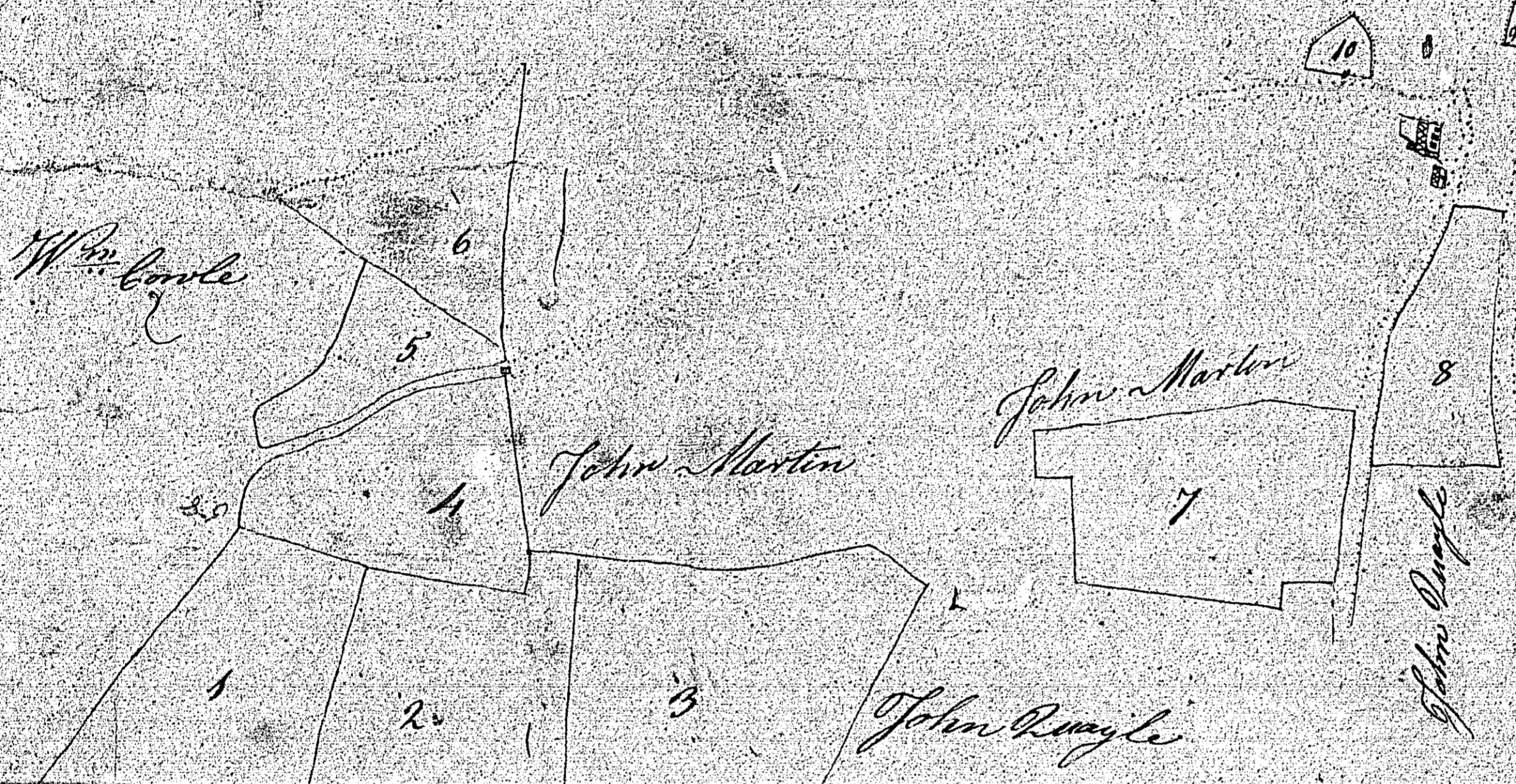

Contents

No.	A.	R.	S.
1	3	1	37
2	0	1	35
3	4	1	2
4	4	1	19
5	1	0	20
6	1	2	23
7	2	3	36
8	1	1	34
9	0	1	31
10	0	0	28
11	0	0	35
Total	7 1/2	1 1/4	3

ISLE OF MAN GOVERNMENT: GENERAL REGISTRY

TITHE PLANS: PARISH OF LEZAYRE

Original monotone

1:30

Noticed

A Plan and Survey of
A part of Clonsilla in
the parishes of Leasow and
property of Mary Thomas
taken July 15th 1839
by Alfred Kemish

200

John Wade	John Corlett
A. P.	Corlett
John Corlett	

A set of 3 Plans in Ink

2 27
20 21
3 2
2 12