

ISLE OF MAN GOVERNMENT: GENERAL REGISTRY

TITHE PLANS: PARISH OF LEZAYRE

Original coloured, marked

1:30

PLAN of SURVEY
of
BALLADOOL
IN THE

184.

PARISH of LEZAYRE

184

Belonging to John Goldsmith

Surveyed by J. Goldsmith
February 12th 1819

BALLACOTTIER

CURRAGH-BEG

HITCHMOORE

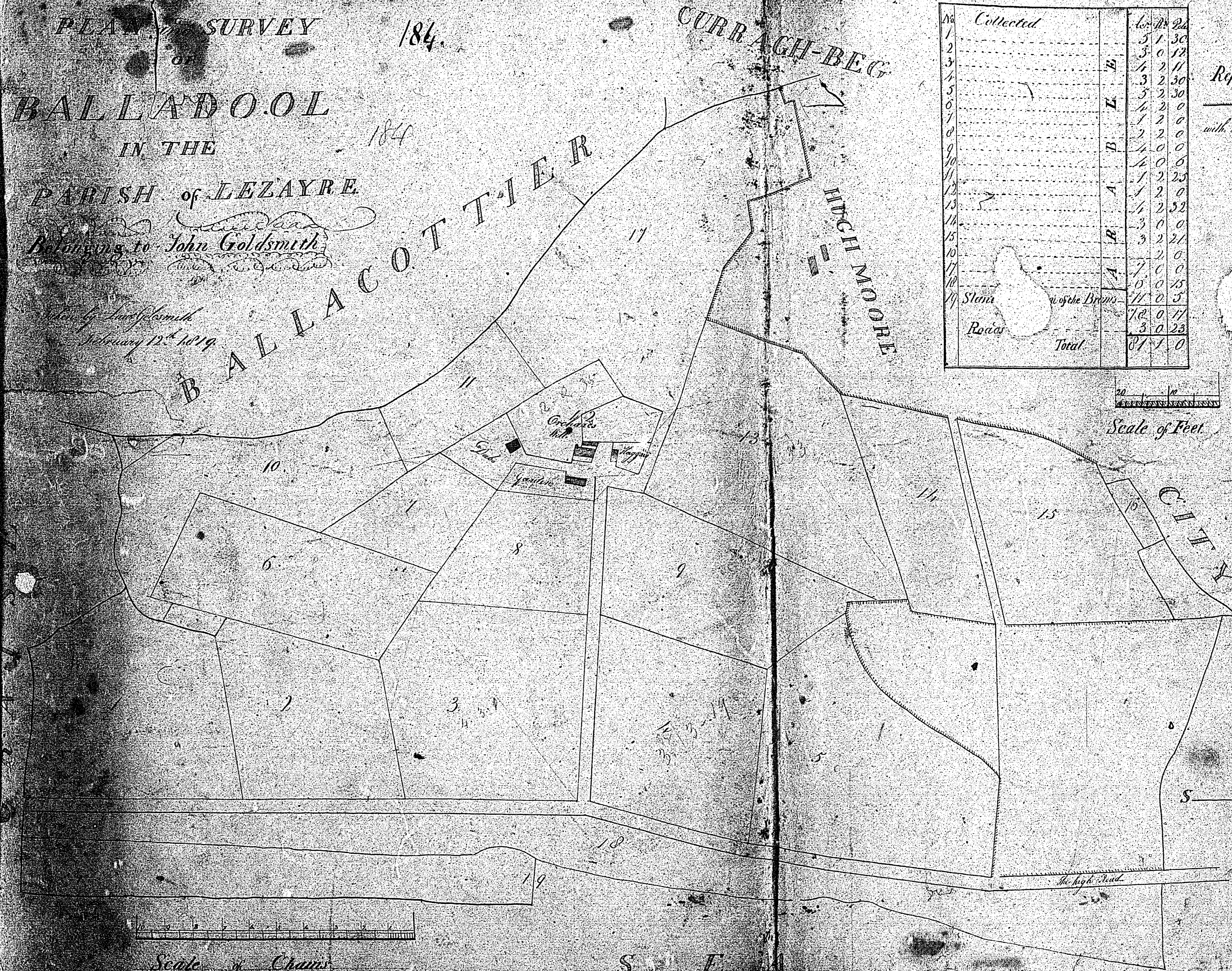

No	Collected	Acres	Roods	Faths
1		5	1	30
2		3	0	17
3		1	2	11
4		3	2	30
5		3	2	30
6		2	2	0
7		1	2	0
8		2	2	0
9		1	0	0
10		1	0	0
11		1	2	25
12		1	2	0
13		1	2	52
14		3	0	0
15		3	2	21
16		2	0	0
17		1	0	0
18		0	0	15
19		1	0	5
Stems		7	0	11
Roods		3	0	23
Total		37	1	0

References
— Shows the Boundary
with High Water

Scale of Feet

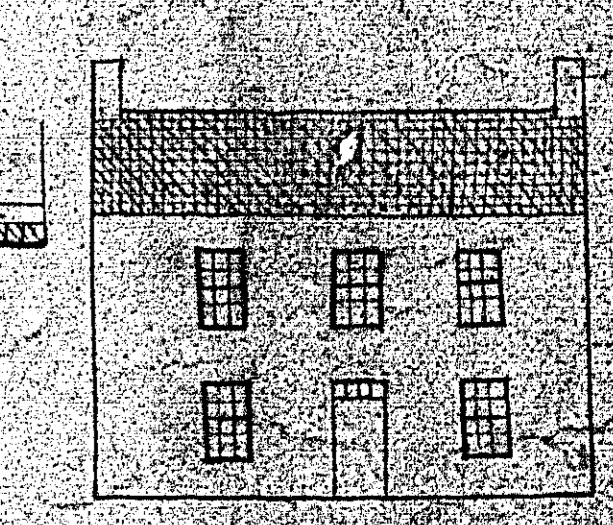

A front view
of
The Dwelling

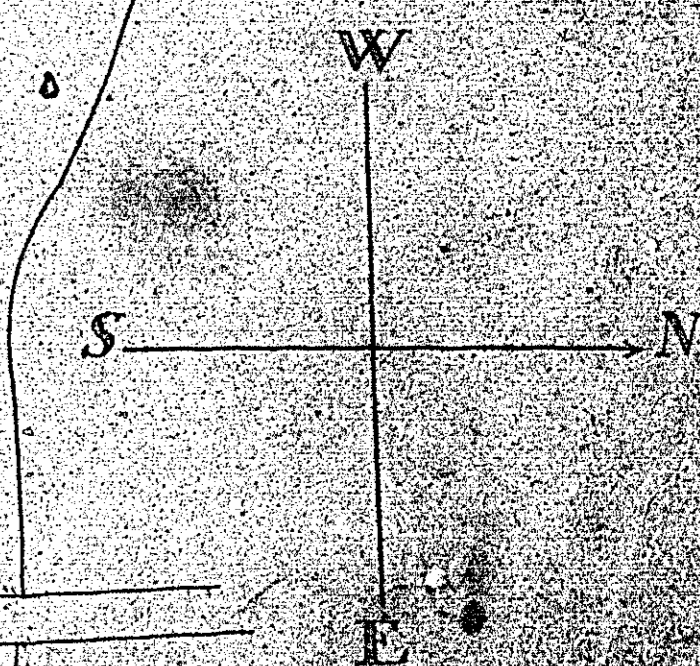

Scale of Chains

S E

A PLAN and Survey
UPPER - GRANGE
CHROIT-EY-KEWISH
GRANGE PARK

No. 1	3. 29
No. 2	0. 93
No. 3	3. 33
No. 4	9. 13
No. 5	0. 30
No. 6	1. 18
No. 7	3. 50

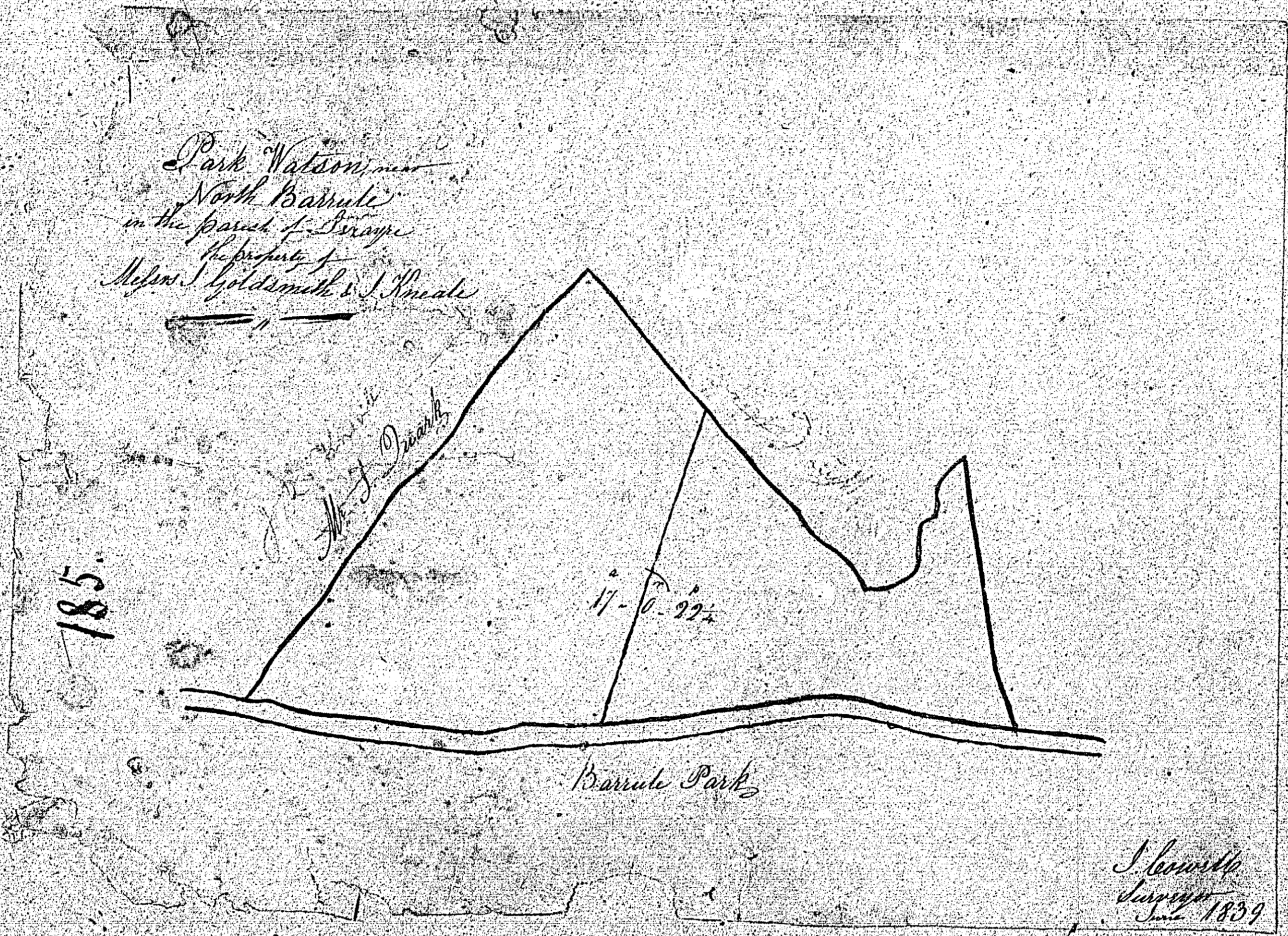

ISLE OF MAN GOVERNMENT: GENERAL REGISTRY
 TITHE PLANS: PARISH OF LEZAYRE
 Original coloured (decorative) 1:30

Not used

Not used

187.

PLAN
OF
LANDS OF JNO. HULL.
IN
NEW YORK.

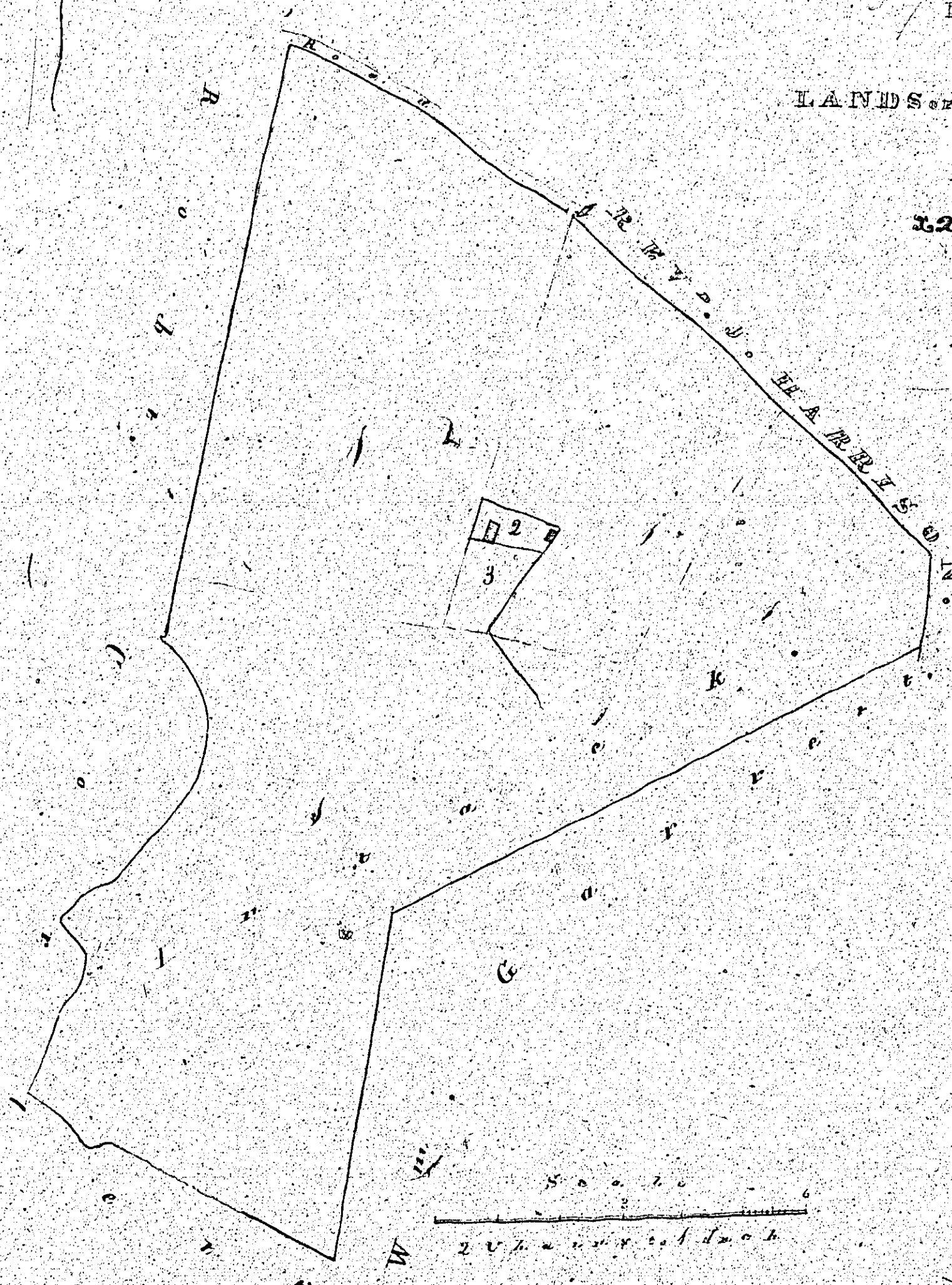

No.	Area	Value	Notes
1	2-2-1/2		
2		1-0-1/2	
3	1-0-1/2		
	1/2-2-1/2	1-0-1/2	1/2-2-1/2

By R. H. Knapp, Surveyor 3rd July 1839.

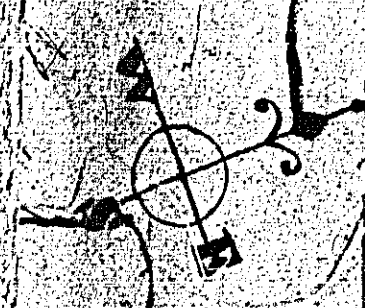

Handwritten notes and signatures in the right margin, including 'W. H. Knapp' and other illegible text.

Mr. [unclear]
West [unclear]

168
Plan of a Small Meadow near Ballinacree
in the Parish of Liscayre 168.
The Property of
Mr. Wm. [unclear]
of [unclear]



J. [unclear]
Surveyor
1689

