

39.

A Plan and survey of
A part of Coole Valley
in the parish of Jerby
taken May 18th 1840
the property of
Wm. Coyle Esq
By James Merrick

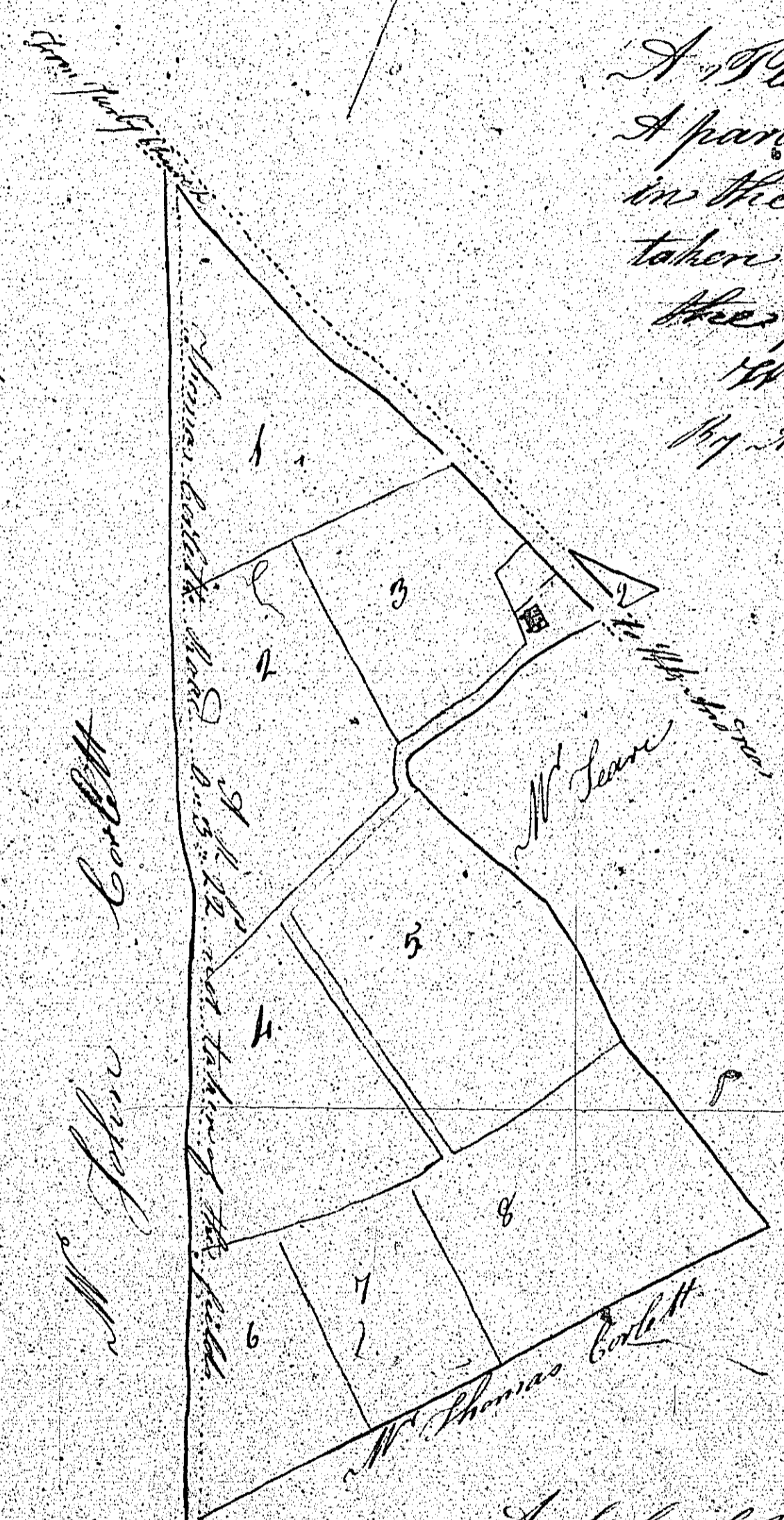

Contents

1-2-3-14
2-3-0-6
3-1-3-1
4-2-1-31
5-3-0-8
6-1-2-34
7-1-2-33
8-2-3-25
9-0-0-11
<u>London Custom House 2-32</u>
<u>Wid 19-3-35</u>
20-

A Scale of 3 Chaires to an Inch

Not used

40.
Plan and Survey
Part of Shan Valla Chonelly
Derry
Belonging to Ellen Tompkin
Andreas

No	References A. R. P.
1.	0. 5. 15
2.	0. 5. 3 1/2

Total Acres. 1. 0. 18 1/2

Thomas Caley } Derry June 1839.
Wm. Bourke } Speaks half Acre

frame 1 of 2

ISLE OF MAN GOVERNMENT: GENERAL REGISTRY

TITHE PLANS: PARISH OF JURBY

Original coloured

1:30

Osler

OF THE PARISHES PARISH OF
BALLAMOGAR
IN THE PARISH OF JURBY

THE PROPERTY OF

WILLIAM FARRANTES OF

St. George's, St. Peter's

1840.

41. *copy of the*

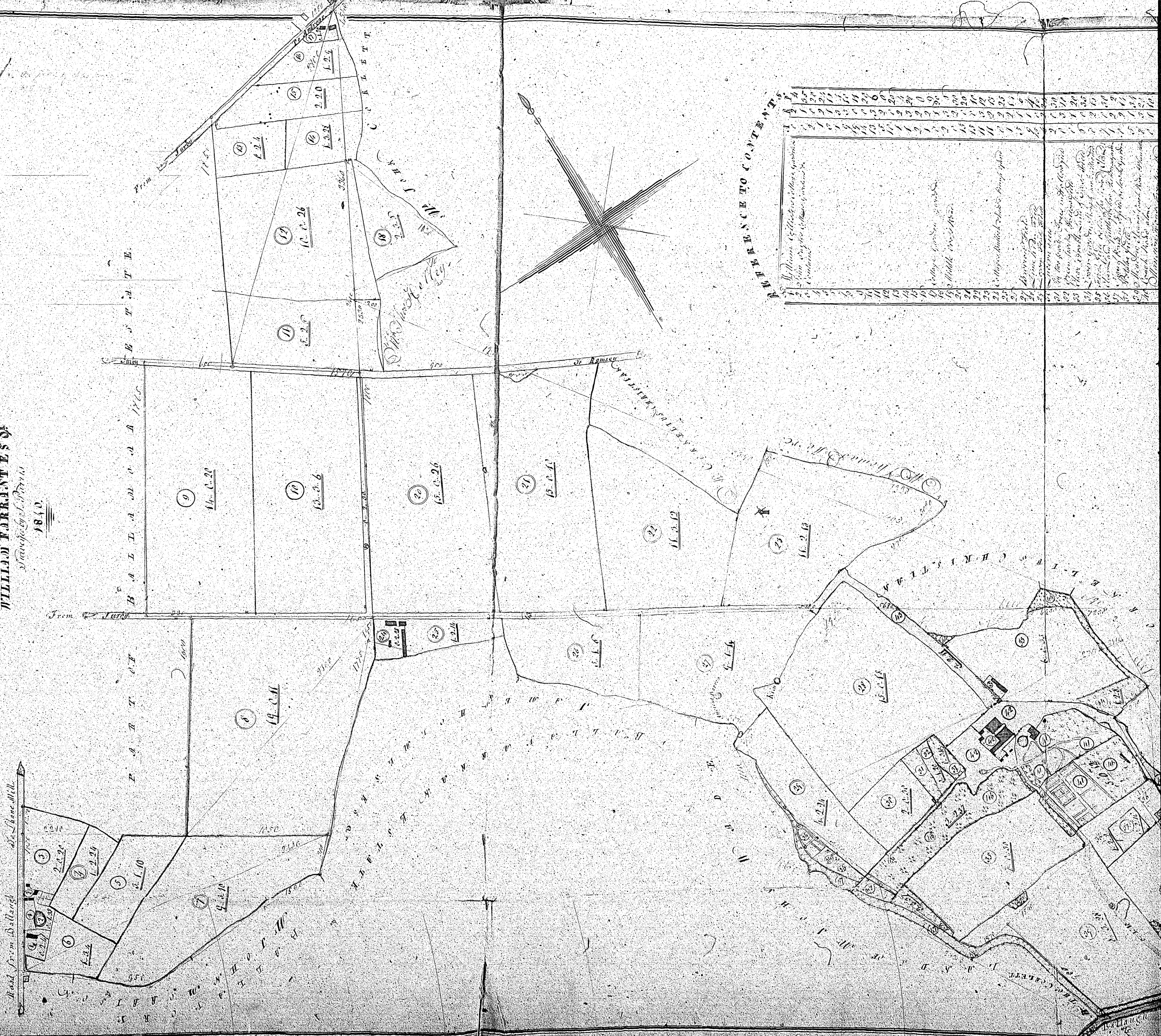

REFERENCE TO CONTENTS

1	2	3	4	5	6	7	8	9	10	11	12	13	14	15	16	17	18	19	20	21	22	23	24	25	26	27	28	29	30	31	32	33	34	35
---	---	---	---	---	---	---	---	---	----	----	----	----	----	----	----	----	----	----	----	----	----	----	----	----	----	----	----	----	----	----	----	----	----	----

