

107

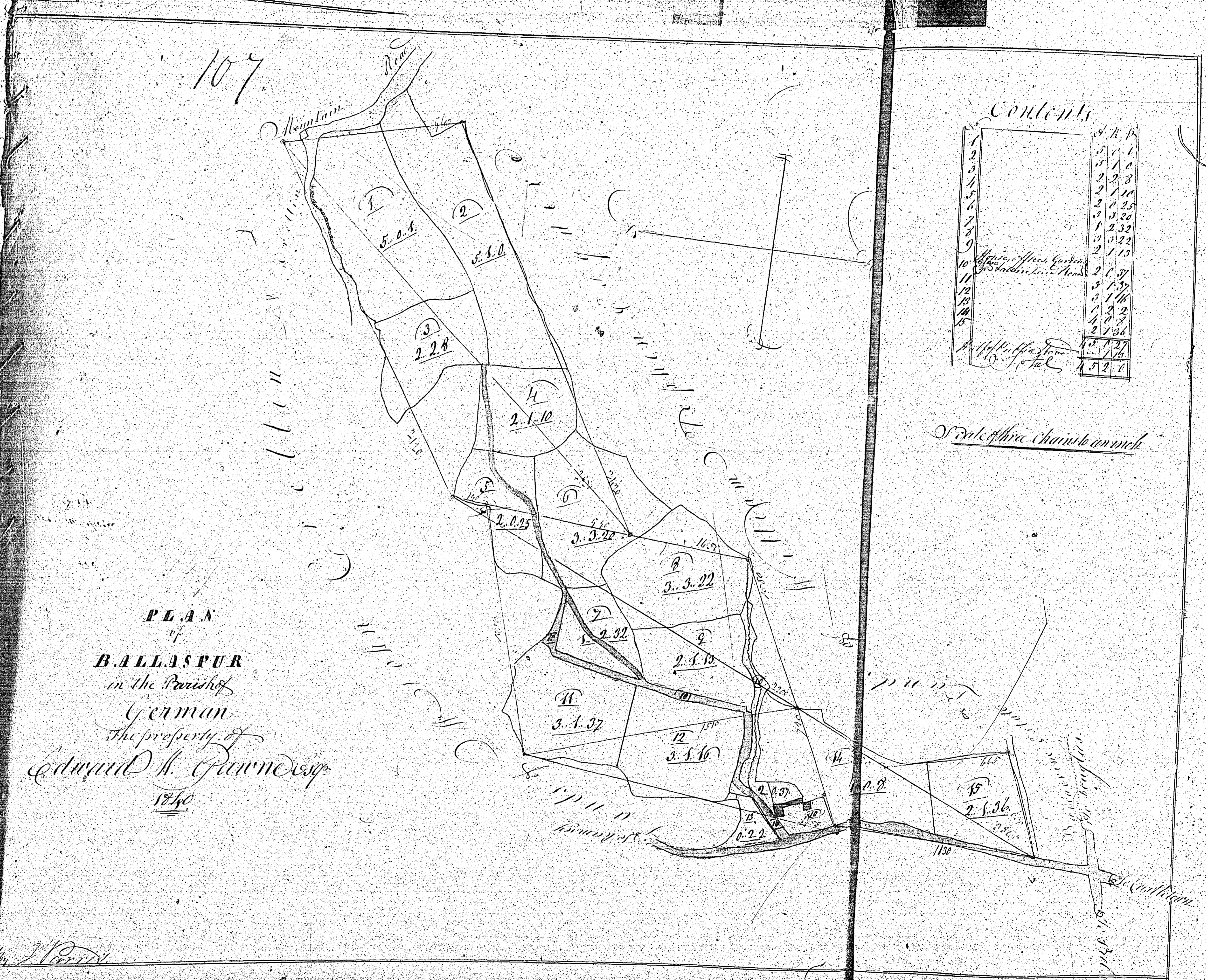

Contents

1	1.1.15
2	1.1.1
3	1.1.1
4	2.3.3
5	2.1.10
6	2.1.25
7	1.3.22
8	1.3.22
9	2.1.13
10	2.1.13
11	3.1.37
12	3.1.37
13	1.1.2
14	1.1.2
15	2.1.36
Total	
16	1.1.1
17	1.1.1
18	1.1.1
19	1.1.1
20	1.1.1
21	1.1.1
22	1.1.1
23	1.1.1
24	1.1.1
25	1.1.1
26	1.1.1
27	1.1.1
28	1.1.1
29	1.1.1
30	1.1.1
31	1.1.1
32	1.1.1
33	1.1.1
34	1.1.1
35	1.1.1
36	1.1.1
37	1.1.1
38	1.1.1
39	1.1.1
40	1.1.1
41	1.1.1
42	1.1.1
43	1.1.1
44	1.1.1
45	1.1.1
46	1.1.1
47	1.1.1
48	1.1.1
49	1.1.1
50	1.1.1
51	1.1.1
52	1.1.1
53	1.1.1
54	1.1.1
55	1.1.1
56	1.1.1
57	1.1.1
58	1.1.1
59	1.1.1
60	1.1.1
61	1.1.1
62	1.1.1
63	1.1.1
64	1.1.1
65	1.1.1
66	1.1.1
67	1.1.1
68	1.1.1
69	1.1.1
70	1.1.1
71	1.1.1
72	1.1.1
73	1.1.1
74	1.1.1
75	1.1.1
76	1.1.1
77	1.1.1
78	1.1.1
79	1.1.1
80	1.1.1
81	1.1.1
82	1.1.1
83	1.1.1
84	1.1.1
85	1.1.1
86	1.1.1
87	1.1.1
88	1.1.1
89	1.1.1
90	1.1.1
91	1.1.1
92	1.1.1
93	1.1.1
94	1.1.1
95	1.1.1
96	1.1.1
97	1.1.1
98	1.1.1
99	1.1.1
100	1.1.1

PLAN
of
BALLASPUR
in the Parish of
German
the property of
Edward H. Guinness
1840

Scale of three chains to an inch

Surveyed by
Wm. G. Gillingham

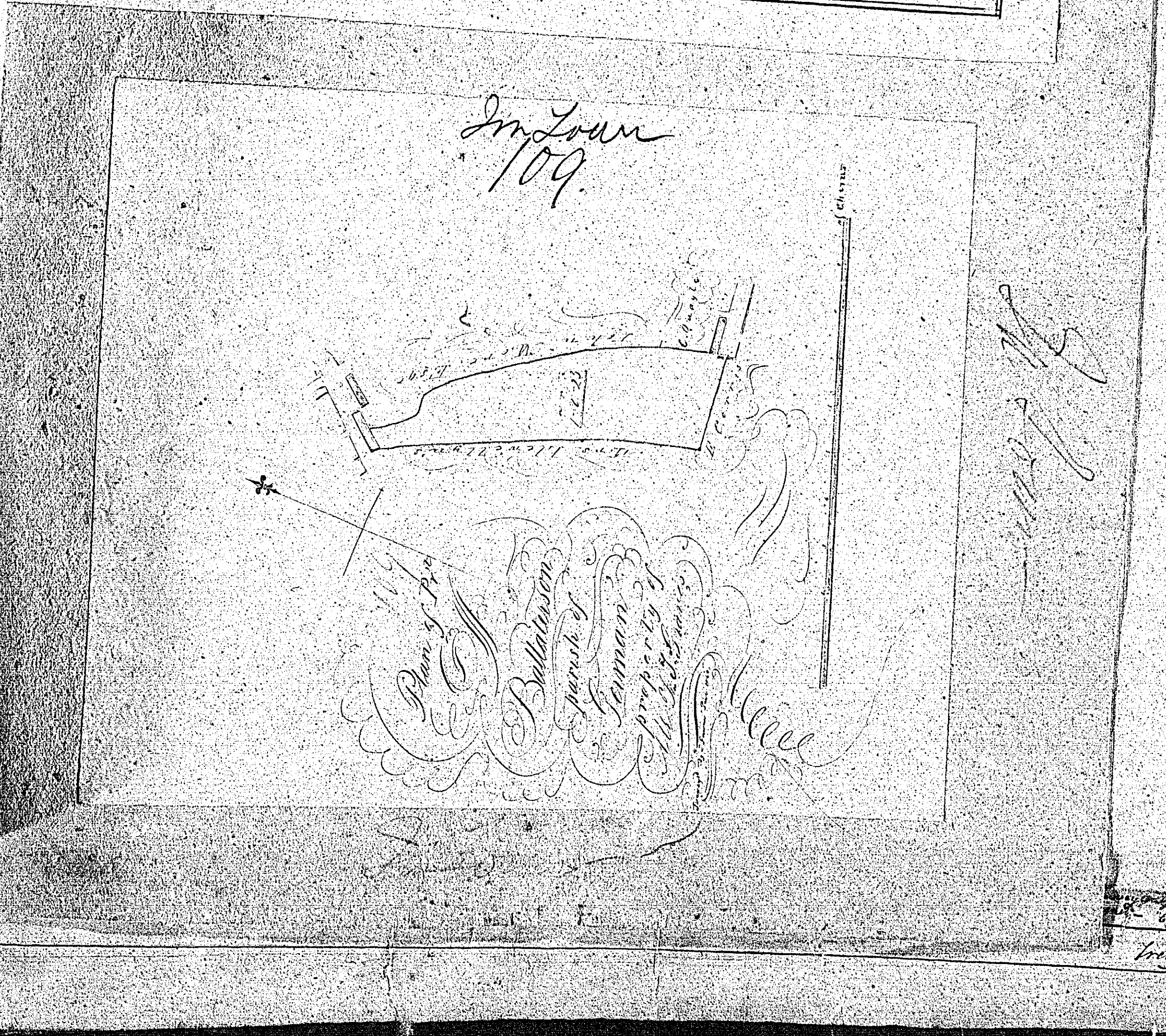
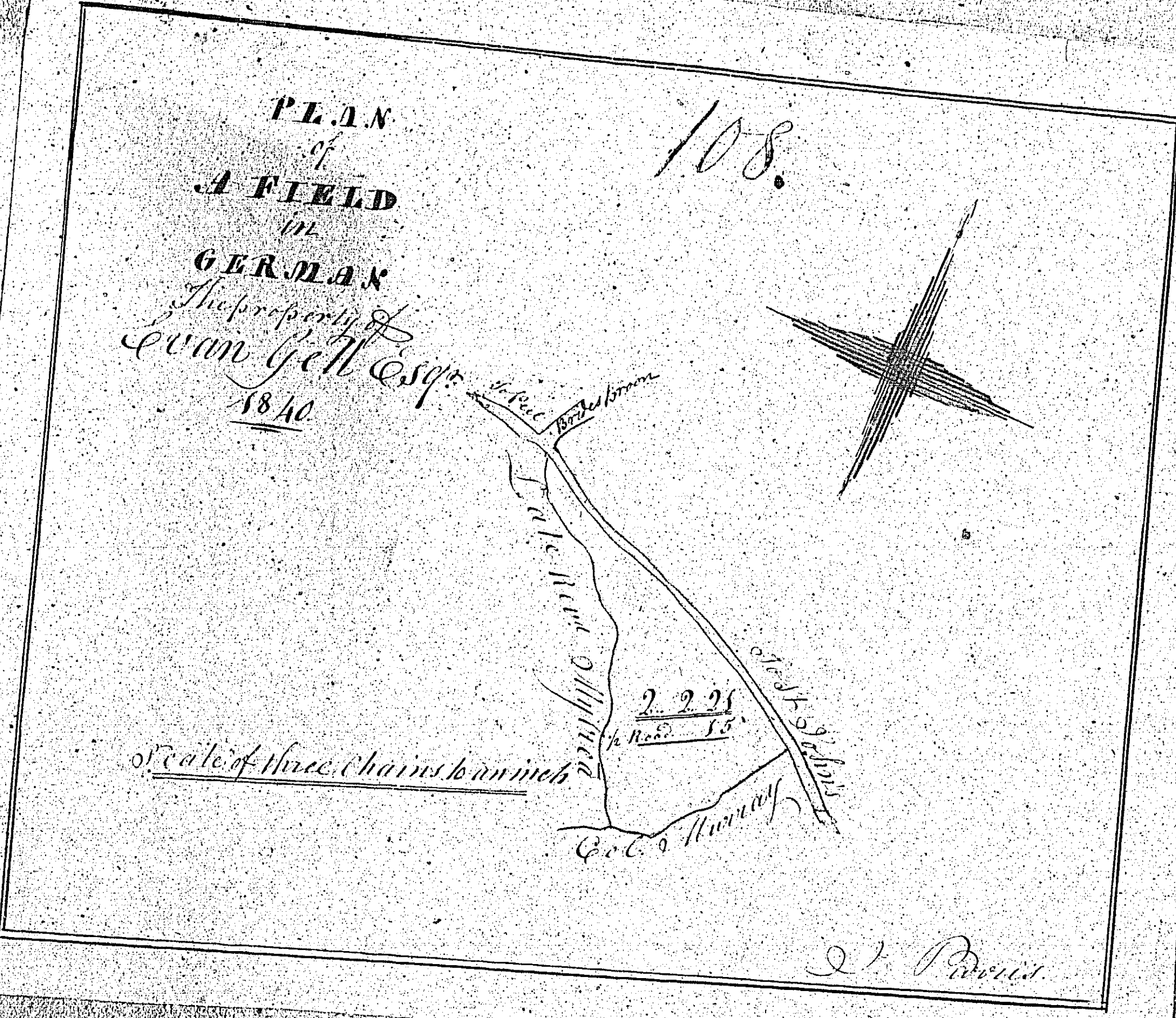

J. P. Davis
 1840

110.

PLAN and Survey OF
Part of the Quarterland of the
DRINEY in the parish of **KK. GERMAN**
The property of
M. PHILIP GARRETT

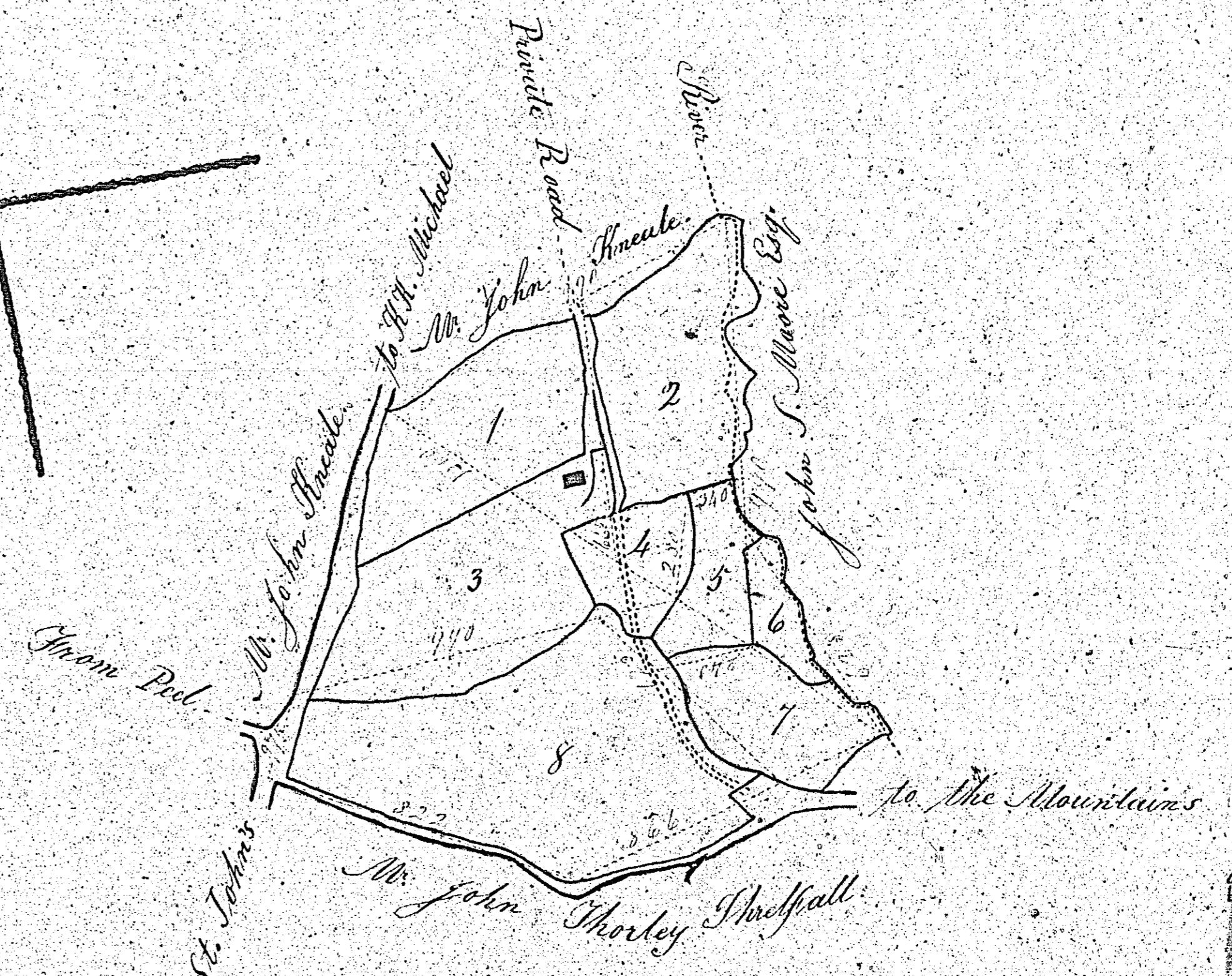
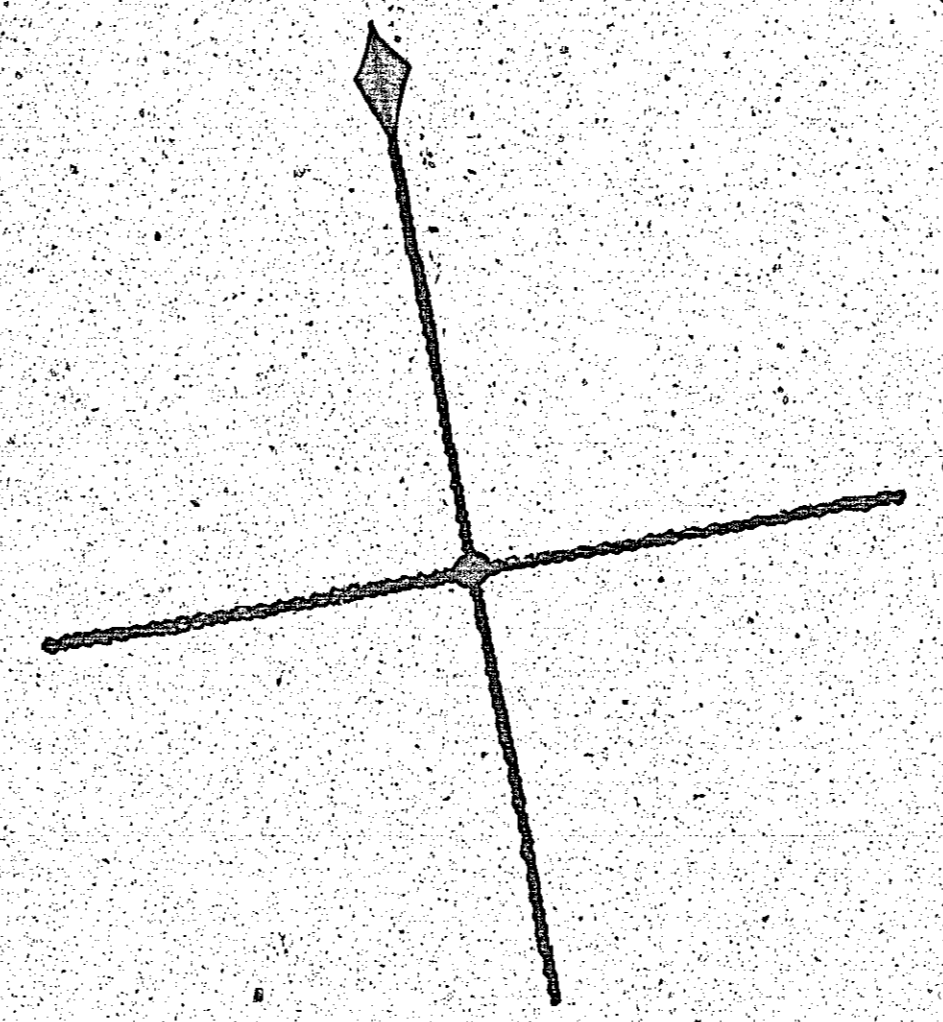

Measure.

No.	A.	R.	P.
1	2	0	15
2	2	1	0
3	2	2	33
4	0	3	2
5	0	2	34
6	0	1	23
7	1	1	5
8	4	2	20
Total 14 3 12			

1 2 3 4 5 6 7 8 9 10 Chains.

Total Content of Public Roads 8. 3. 7.

Surveyed October 1839.
By William Haigher
Rev. K. K. German.

Wm. Haigher
Surveyor

111.

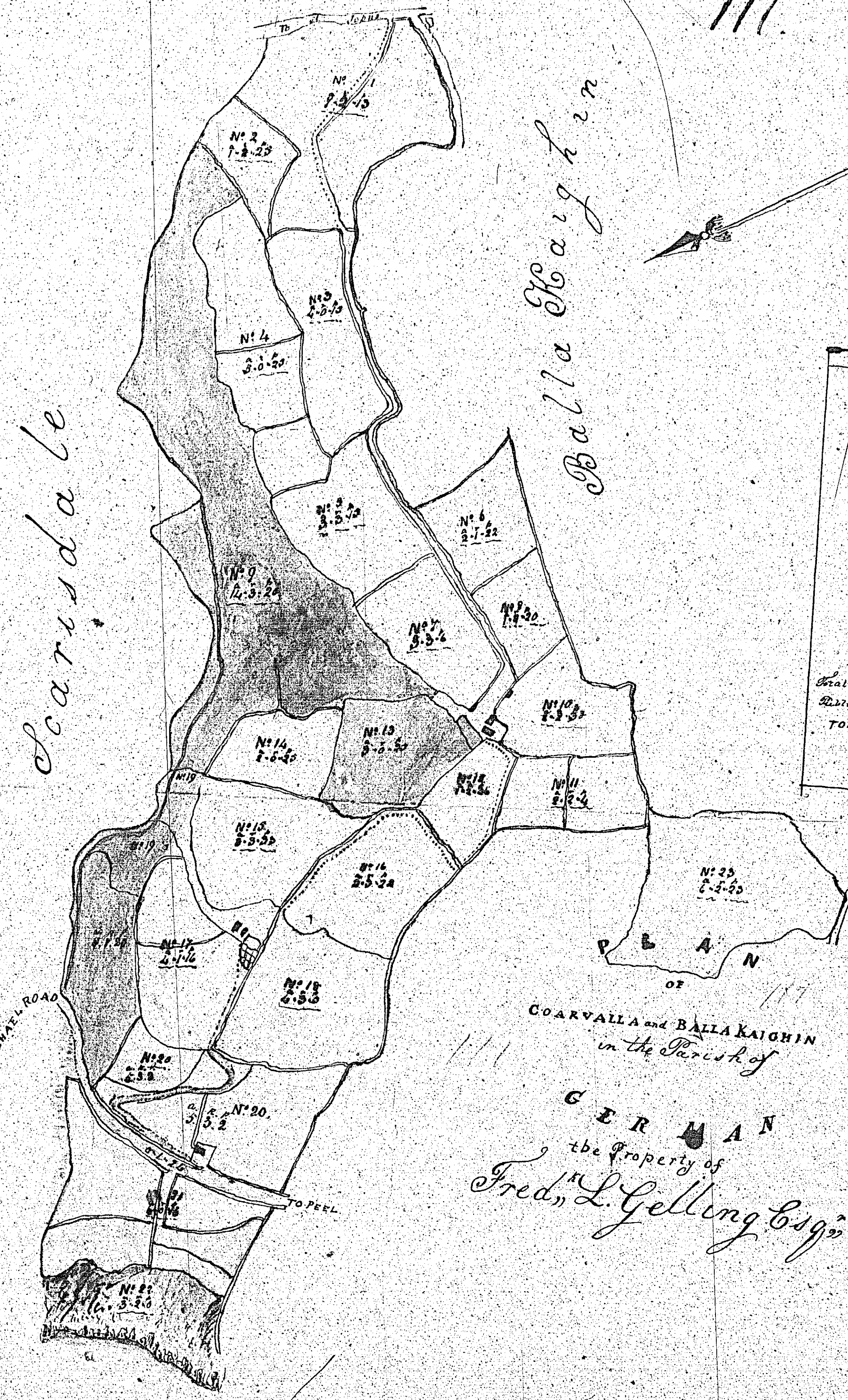

CONTENTS	
No. 1	7.2.75
No. 2	6.5.75
No. 3	5.0.25
No. 4	3.0.50
No. 5	2.7.25
No. 6	2.0.25
No. 7	1.8.20
No. 8	2.2.30
No. 9	2.2.50
No. 10	3.0.25
No. 11	2.0.25
No. 12	2.2.50
No. 13	3.0.25
No. 14	2.0.25
No. 15	3.3.25
No. 16	3.3.25
No. 17	4.1.16
No. 18	4.3.5
No. 19	5.1.20
No. 20	5.3.2
No. 21	6.0.16
No. 22	3.2.0
No. 23	6.2.28
Total Conts	101.7.11
Service Road	0.1.24
TOTAL	101.8.35

Scale of four Chains to an Inch
 Copied from a Plan Surveyed by
 J. Gelling Esq. in 1830

PLAN and Survey
 of part of Dingles Quarterland and the Sand-house
 Quarterland in the parish of St. German
 The property of
 Mr. John Gell.

112.

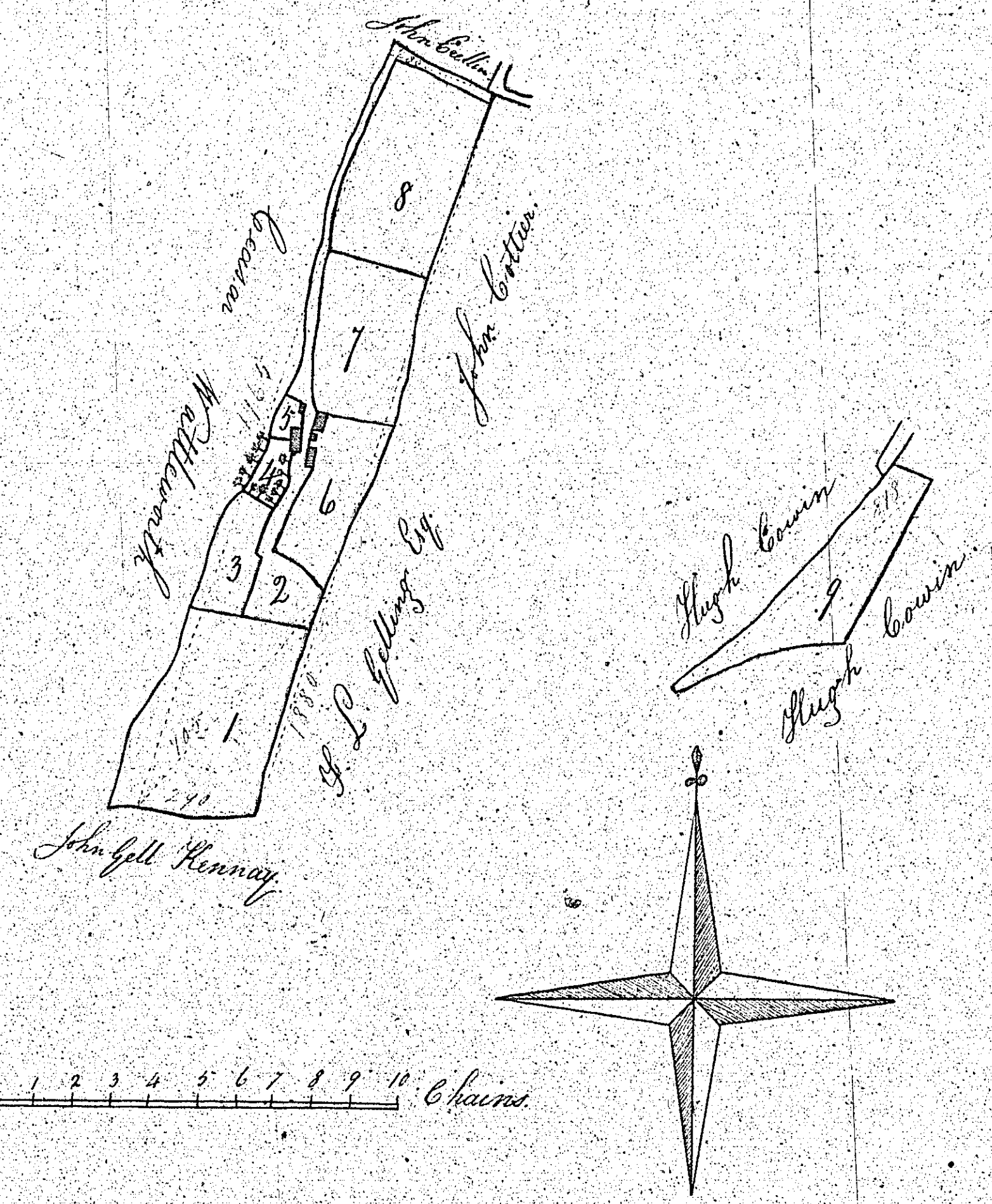

Reference			
No.	a.	b.	p.
1	1	2	12
2	0	3	24
3	0	1	15
4	0	0	20
5	0	0	9
6	0	2	23
7	0	3	33
8	1	1	16
9	0	3	28
10	1	2	24
11	1	1	25
12	1	0	36
13	0	3	9
14	1	3	10
15	0	1	28
16	2	0	36
Total Content			16 1 28

Sandhouse Quarterland.

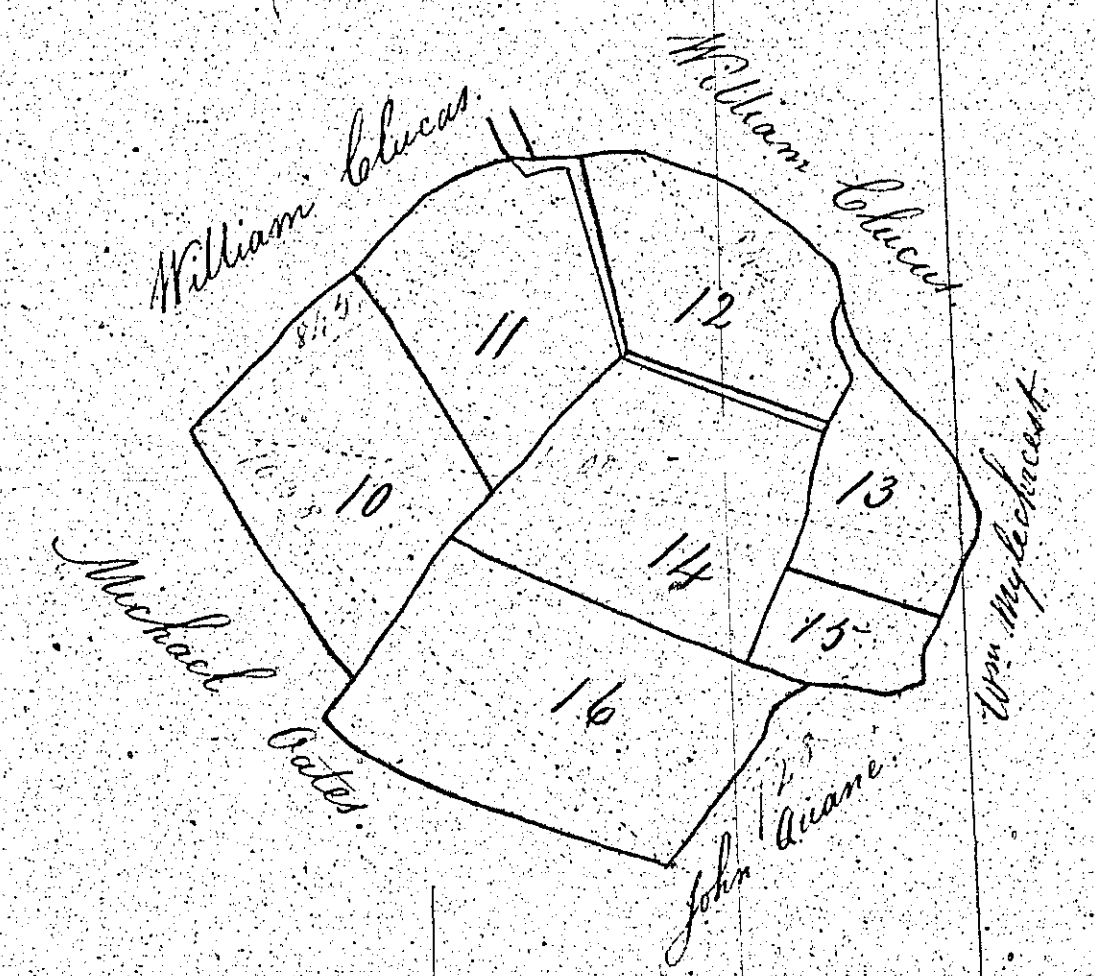

Surveyed June 1840.
 By William Haigher
 H.A. German

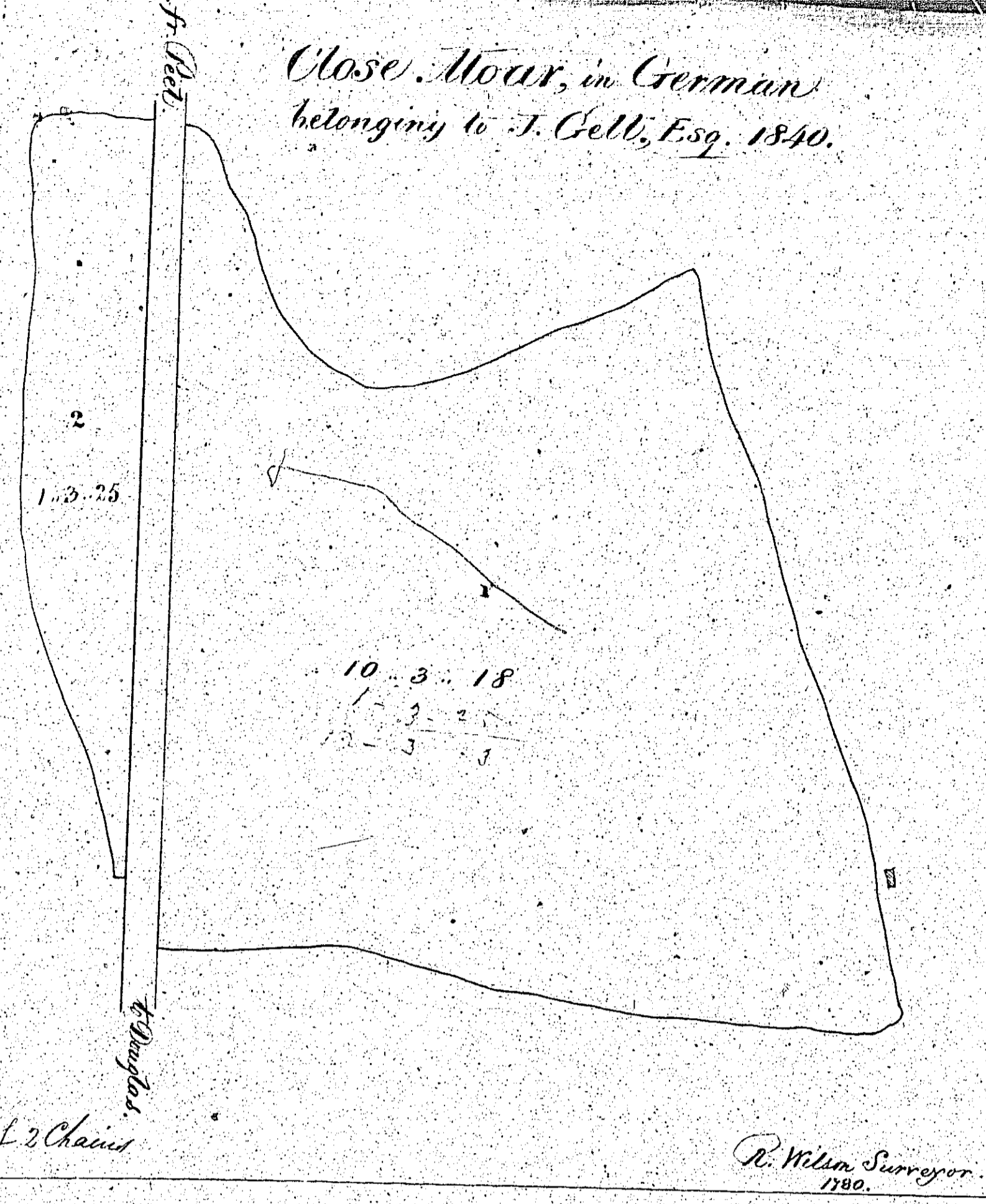

KENNA

in German

*Property of Jno. Cell, Esq.
Feb. 1840.*

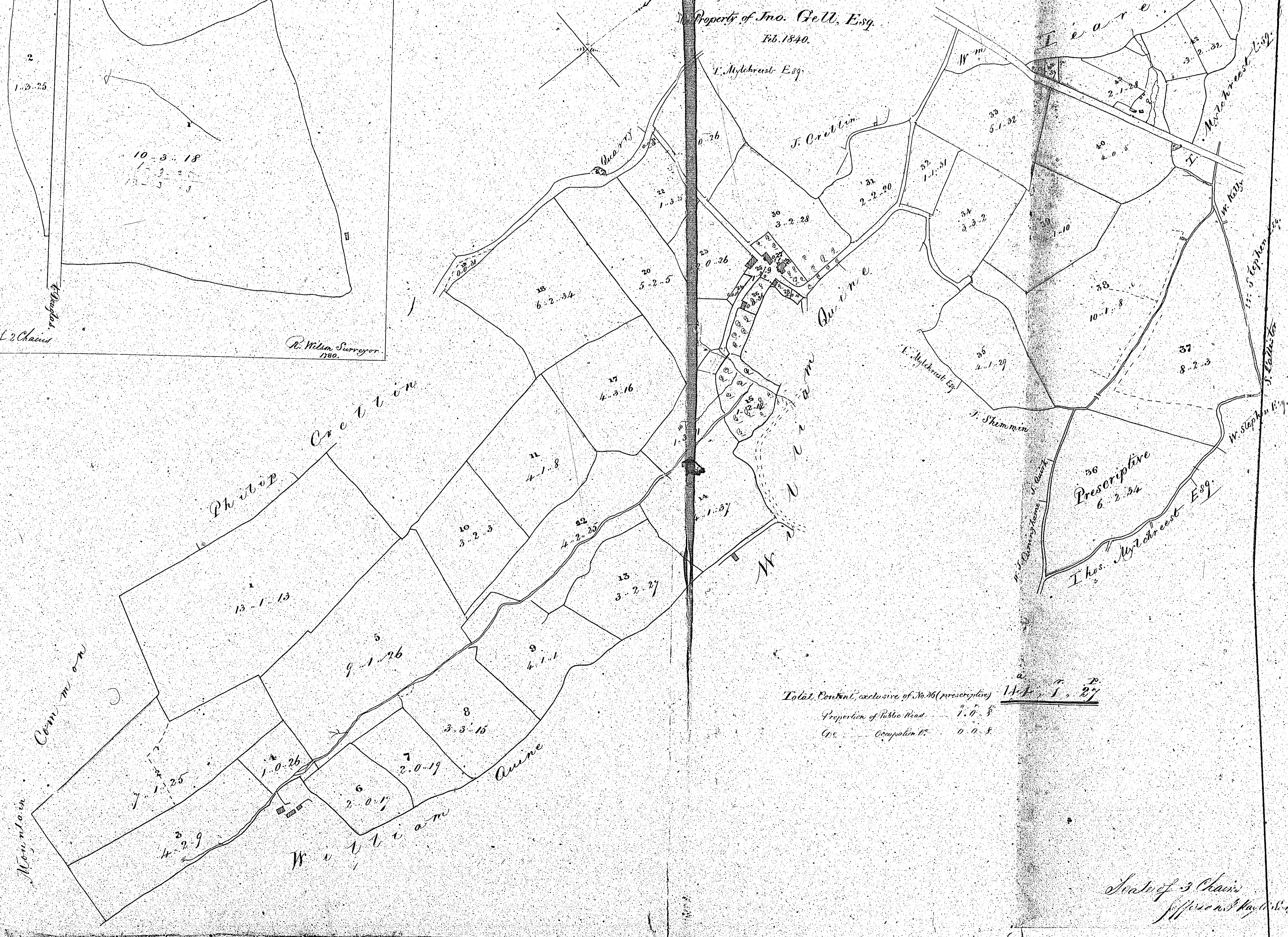

Total Content, exclusive of No. 26 (prescriptive)

Property of Public Road	1.0.8
Or Occupation	0.0.8
Total	1.0.16

*Seal of 3 Chain
Office of the Surveyor*