

68x69

68x69

PLAN

Murray's Close
 Part of *Ballamillaghyn*
 The Property of
Mr. Robert Gelling
 Likewise the
 Paper Mill Premises
 The joint Property of
Mr. Robert Gelling & Mr. Anthony Leathwait
 both properties adjoining and situate at
East Biddon
 in the Parish of
Braddon
 1840

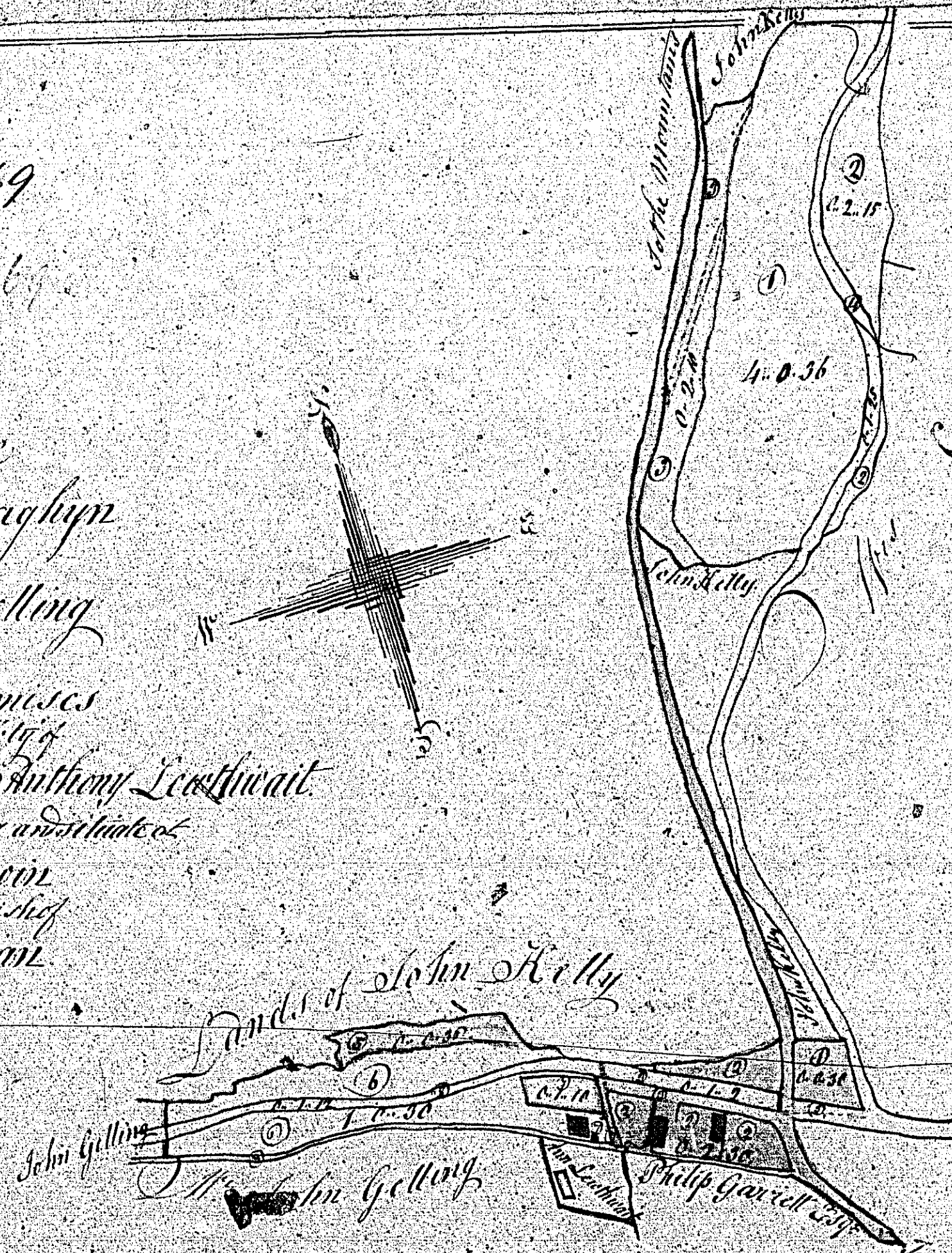
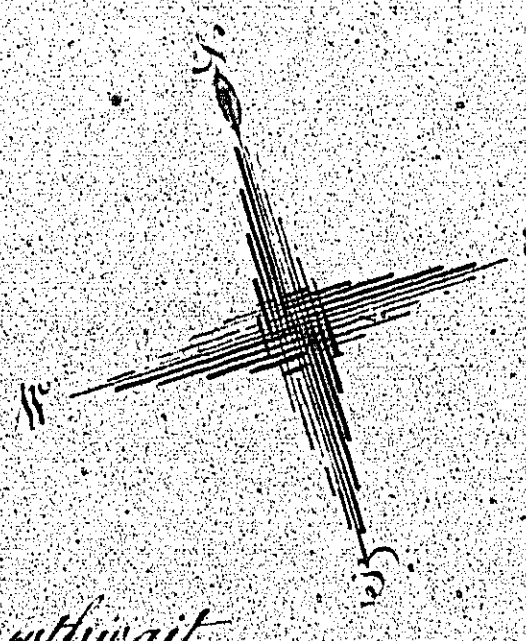

Contents

	Acres	Roods	Poles
<i>The Property of Robert Gelling</i>			
<i>Murray's Close</i>			
1. Flat Field	1	0	36
2. Meadow & the River	1	2	15
3. Meadow with trees	1	2	10
4. Public River	5	1	21
	7	5	6
<i>Part of Ballamillaghyn</i>			
5. Flat Field	1	0	36
6. Meadow with trees	1	0	30
7. Public River	1	1	16
8. River & Bank	1	2	58
	2	3	2
<i>Part of Mr. Gelling's</i>	7	5	14
<i>The joint property of Robert Gelling and Anthony Leathwait</i>			
1. Small Plot	0	0	36
2. Mill, office, yards	2	5	22
3. River and Road	1	1	22
<i>Part of Mr. Gelling's</i>	1	6	24

Surveyed by W. B. ...

75

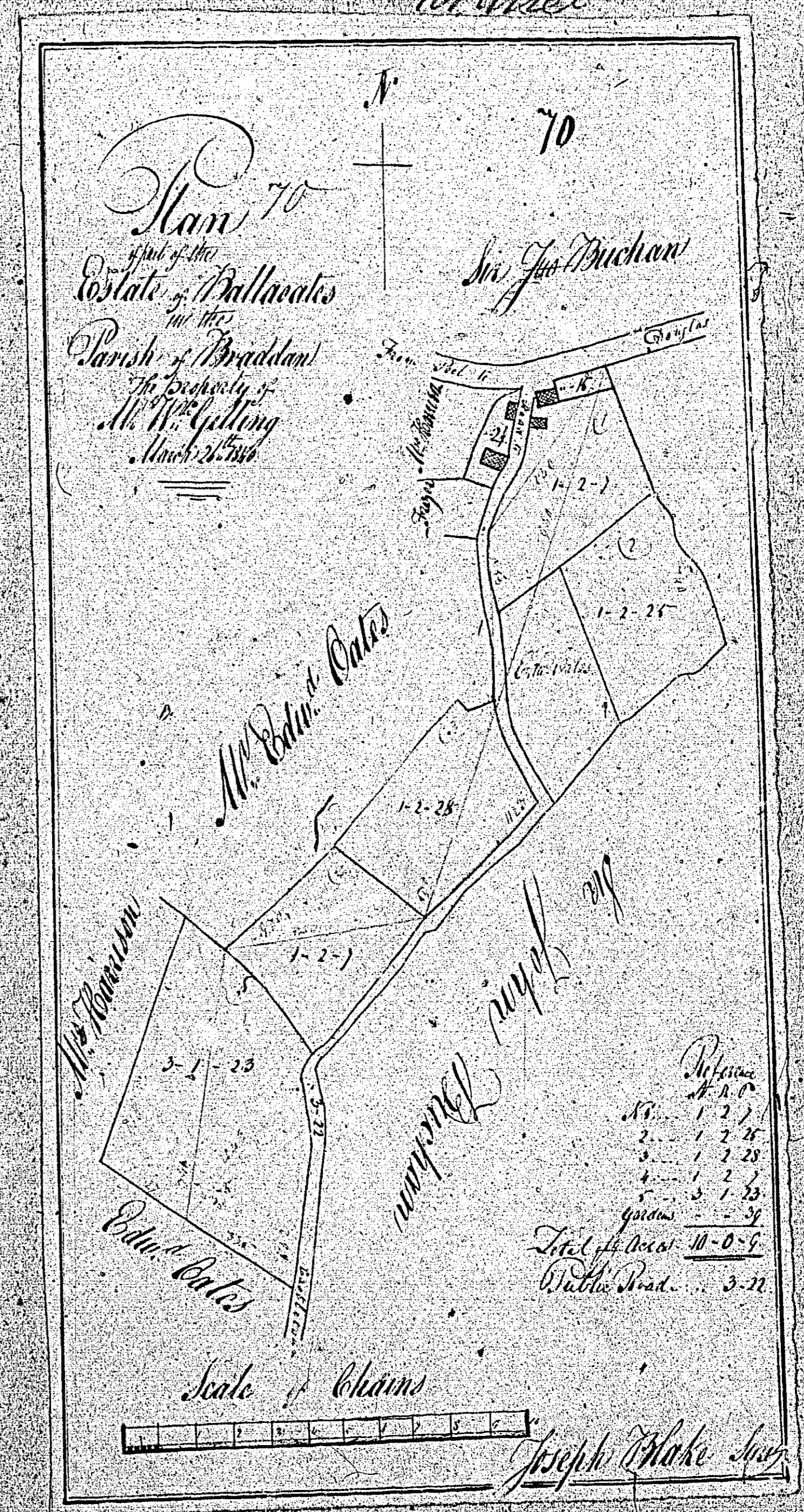

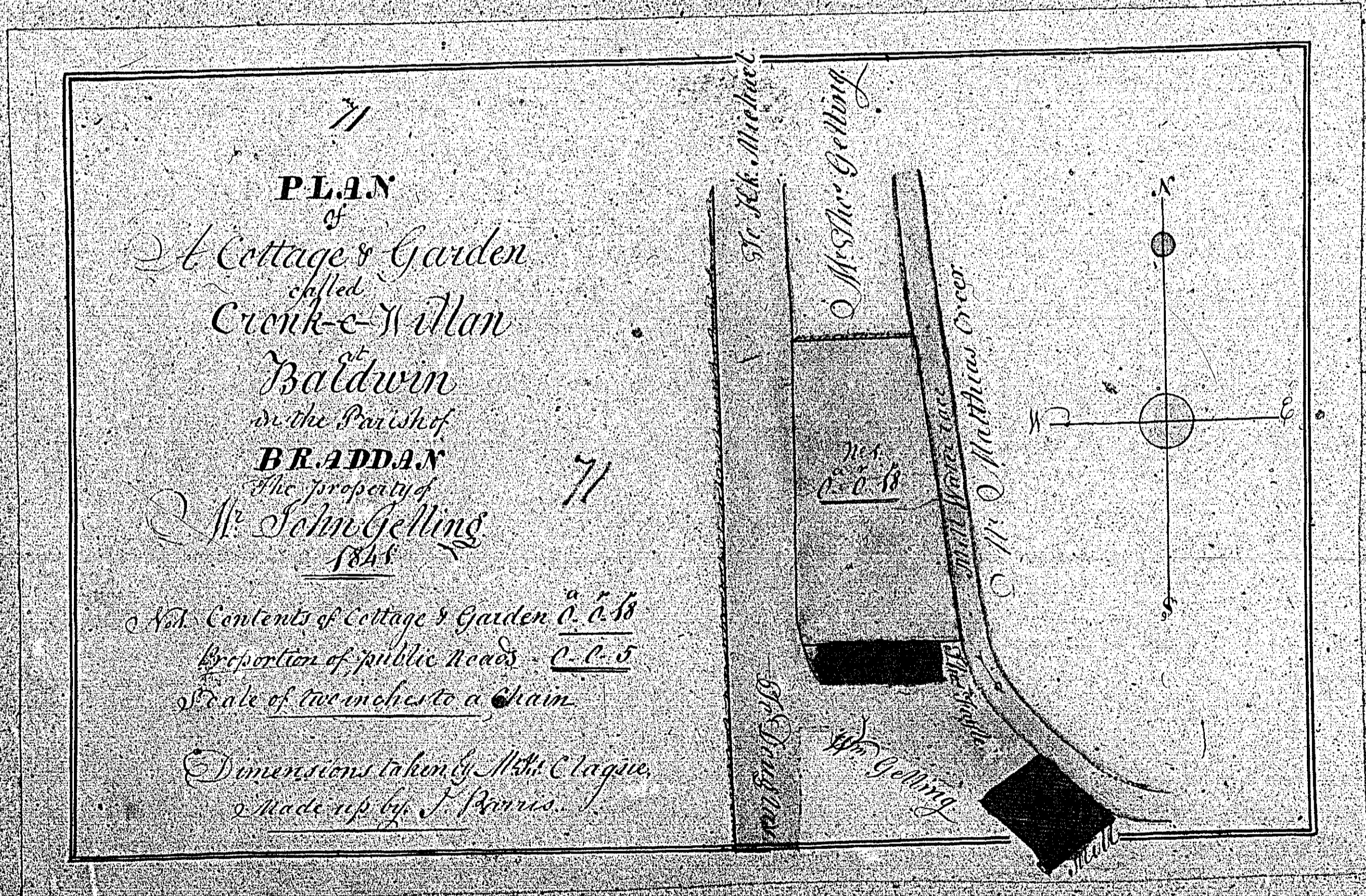

77
PLAN
 of
 A Cottage & Garden
 called
 Cronk & Willan
 Baldwin
 in the Parish of
BRADDAN
 the property of
 Mr. John Gelling
 1848

A. A. Contents of Cottage & Garden 0. 2. 5
 Proportion of public Roads 0. 0. 5
 Scale of two inches to a chain.

Dimensions taken by Mr. Clague,
 & made up by J. Harris.

St. Michael's

Mr. Gelling

Mr. Gelling

Public Road

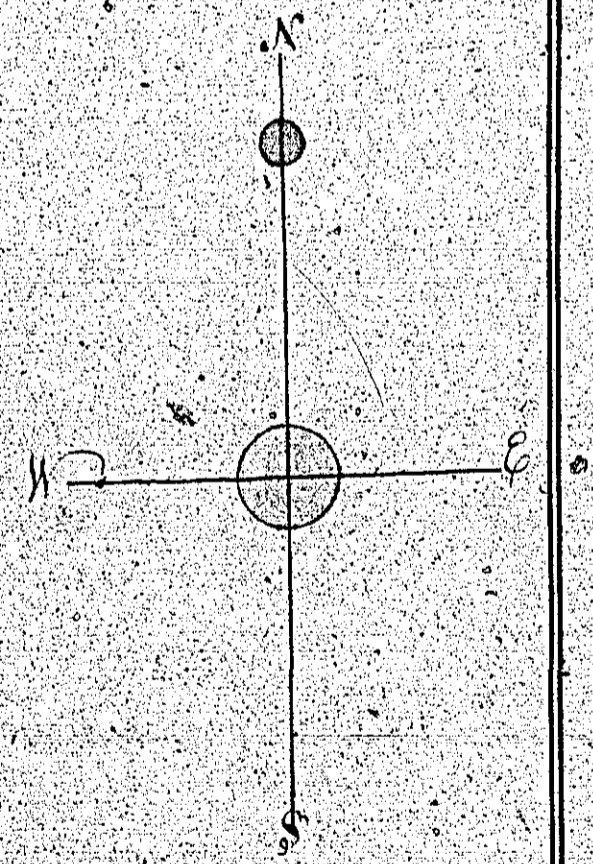

1848

1848

72

PLAN
of
SOUTHAMPTON

PARISH OF BRADDIN;
By Property of
M. HAMPTON ESQ.

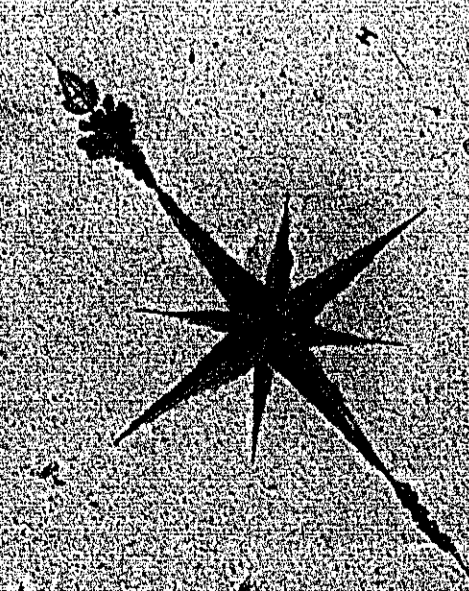
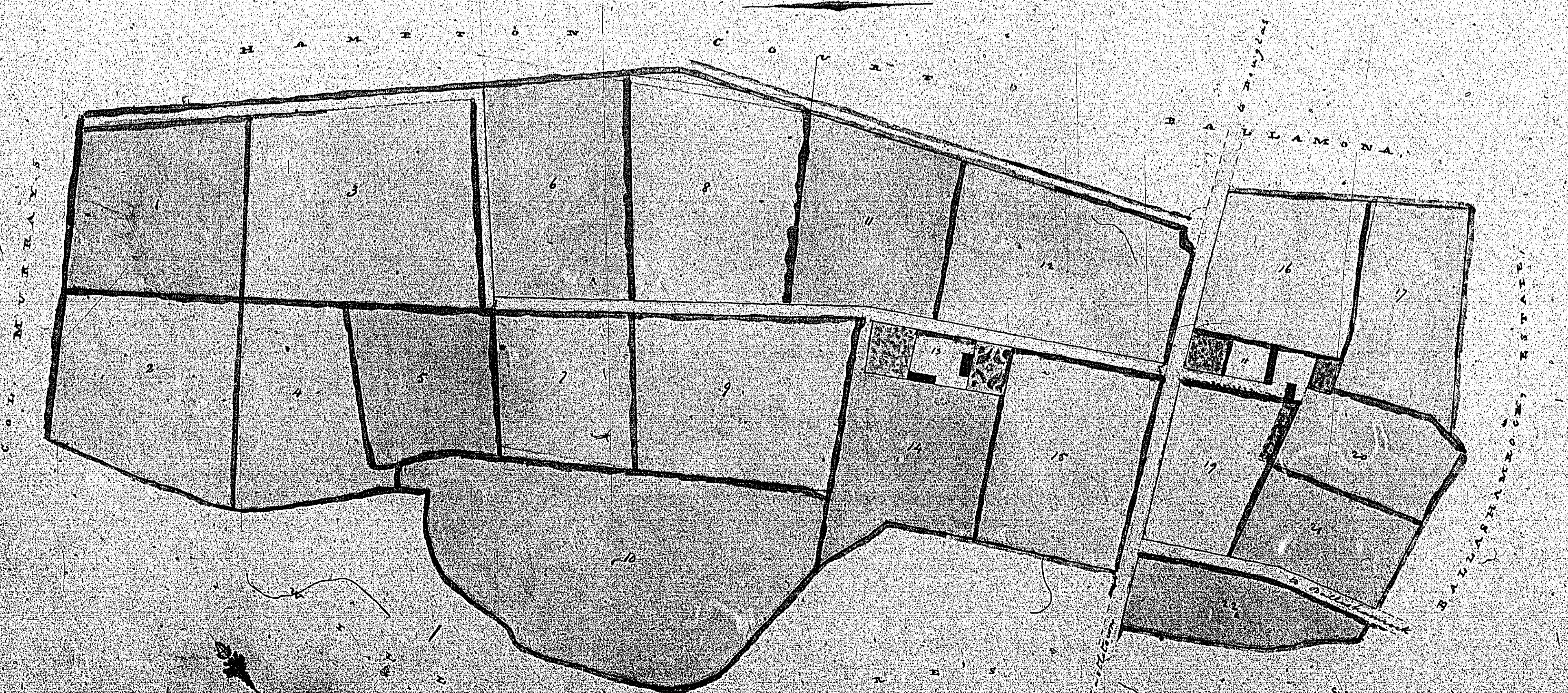

PLOTS	ACRES	RODS	FATHOMS	PERCHES
1	1	0	0	0
2	1	0	0	0
3	1	0	0	0
4	1	0	0	0
5	1	0	0	0
6	1	0	0	0
7	1	0	0	0
8	1	0	0	0
9	1	0	0	0
10	1	0	0	0
11	1	0	0	0
12	1	0	0	0
13	1	0	0	0
14	1	0	0	0
15	1	0	0	0
16	1	0	0	0
17	1	0	0	0
18	1	0	0	0
19	1	0	0	0
20	1	0	0	0

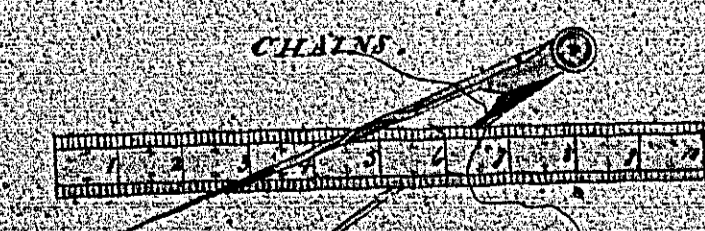

The Great Survey of Braddan 1839

PLAN
 of
HAMPTON COURT

Parish of Broadland
 The Property of

GEO. HEIGHTON ESQ.

73
LEFEES

JOHN

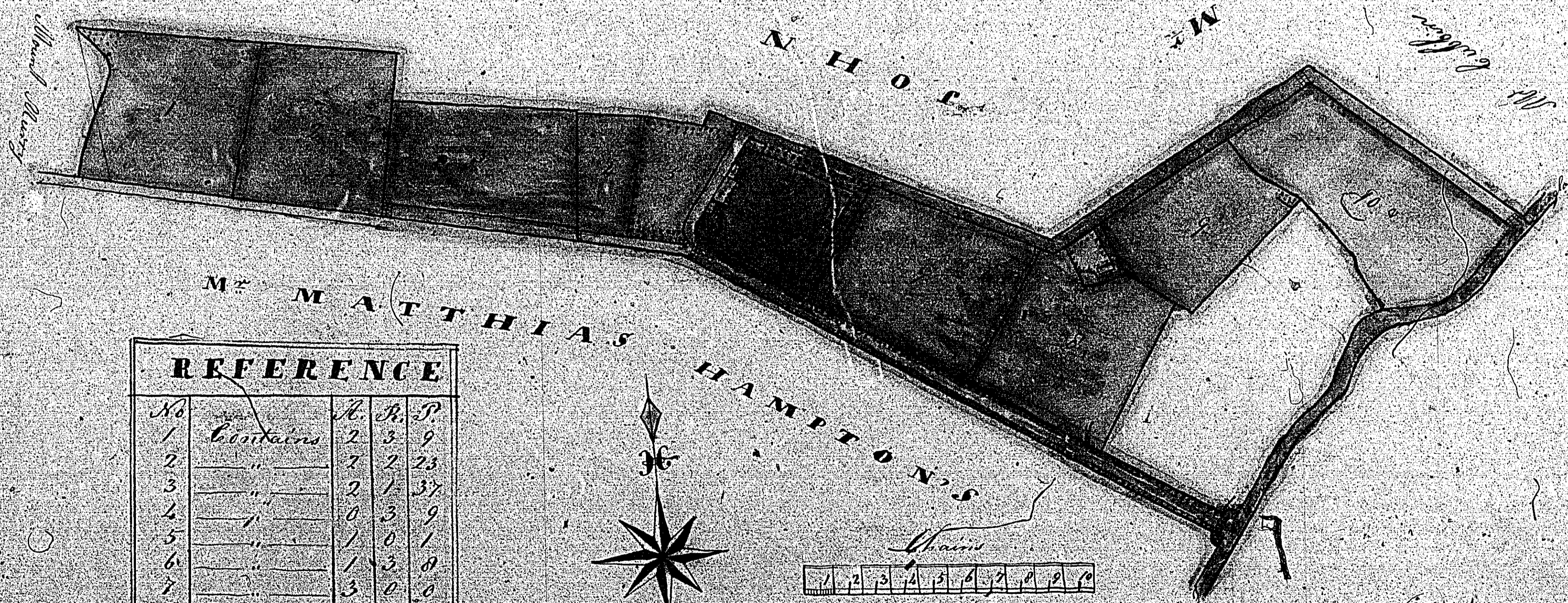

MR MATTHIAS

HAMPTON'S

REFERENCE			
No		R.	P.
1	Coaches	2	3 9
2	"	2	2 23
3	"	2	1 37
4	"	0	3 9
5	"	1	0 1
6	"	1	3 0
7	"	3	0 0
8	"	2	2 31
9	"	2	0 19
10	"	3	1 15
Parsonage & House road		3	0 0
Total		23	3 0

John Barrett Surveyor to the Bishop of Broadland 1839.

PLAN
of 74 74
BALLOUGH
Parish of Braddan
The Property of
Jane Hampton or Jane Hampton
~~MR JOHN CAIN~~ or Jane Hampton

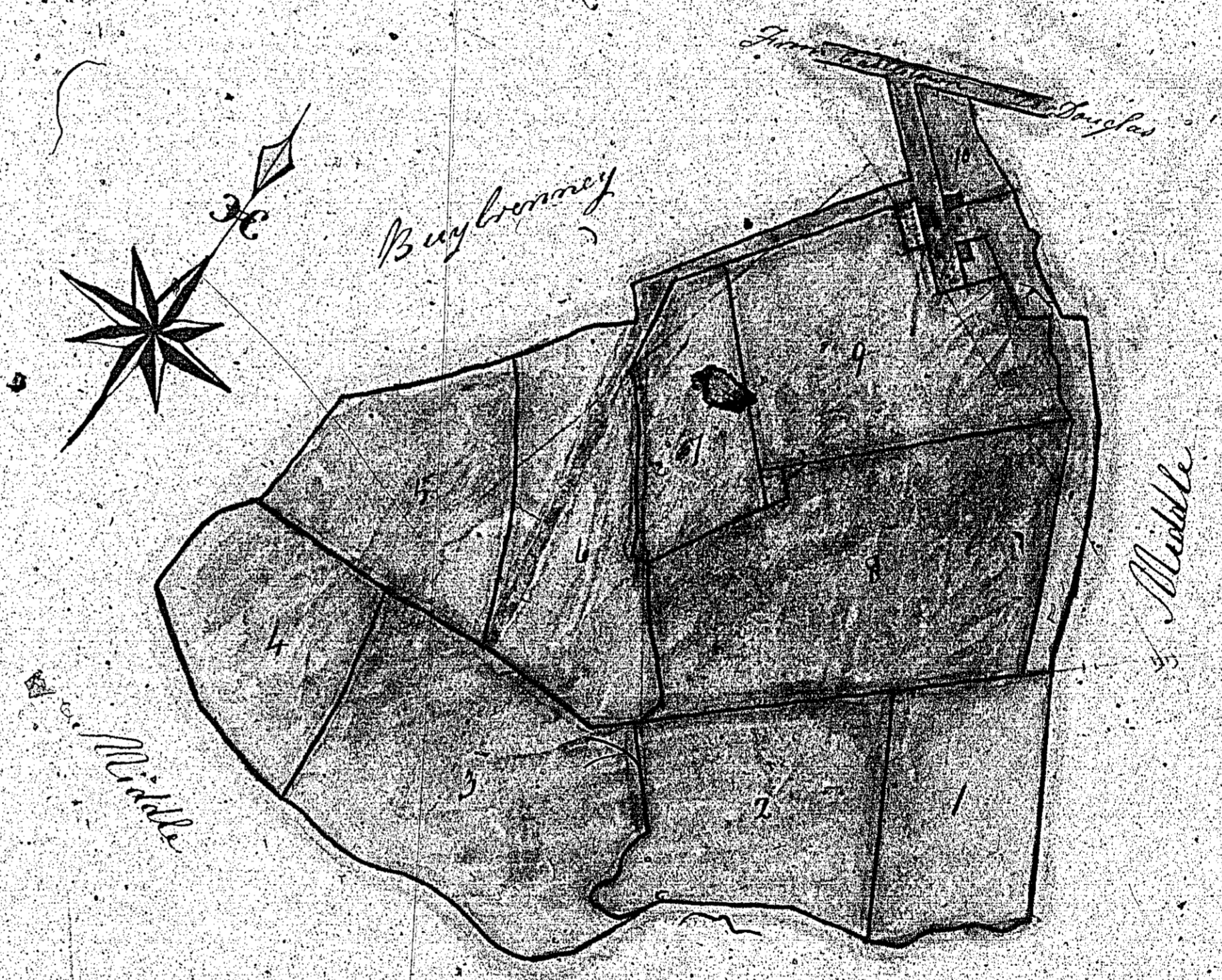

Reference

Chains	A. R. P.
1	3 31
2	2 3 36
3	4 2 1
4	1 3 23
5	2 7 16
6	3 0 11
7	1 1 17
8	4 2 22
9	3 0 30
10	0 1 15
Total 27 2 21	

Middle
Chains

John Crox Surveyor
Braddan 1839