

frame 1 of 2

ISLE OF MAN GOVERNMENT: GENERAL REGISTRY

TITHE PLANS: PARISH OF BRIDE

Original monotone

1:30

A/1

A/2

A/3

A/4

A/5

A/2

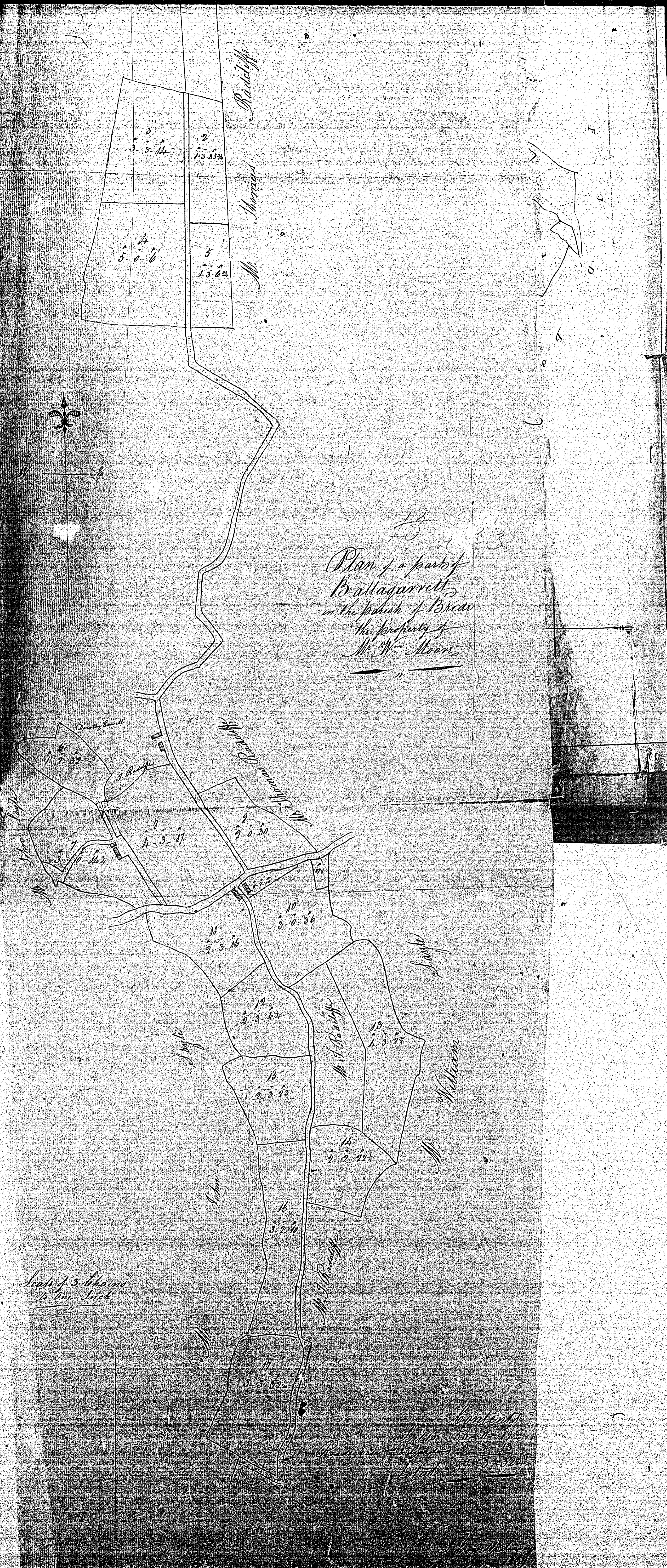

frame 2 of 2

ISLE OF MAN GOVERNMENT: GENERAL REGISTRY
 TITHE PLANS: PARISH OF BRIDE

Original monotone

1:30

124
 A. P. L. A. N. of
 part of Ballacregga
 situate in the parish of
 B. R. I. D. E.
 belonging to the peer of
 Marquis hold
 by Thomas Crane
 July 1st 1739
 Scale of 2 chains to an inch. Sheet 27.11

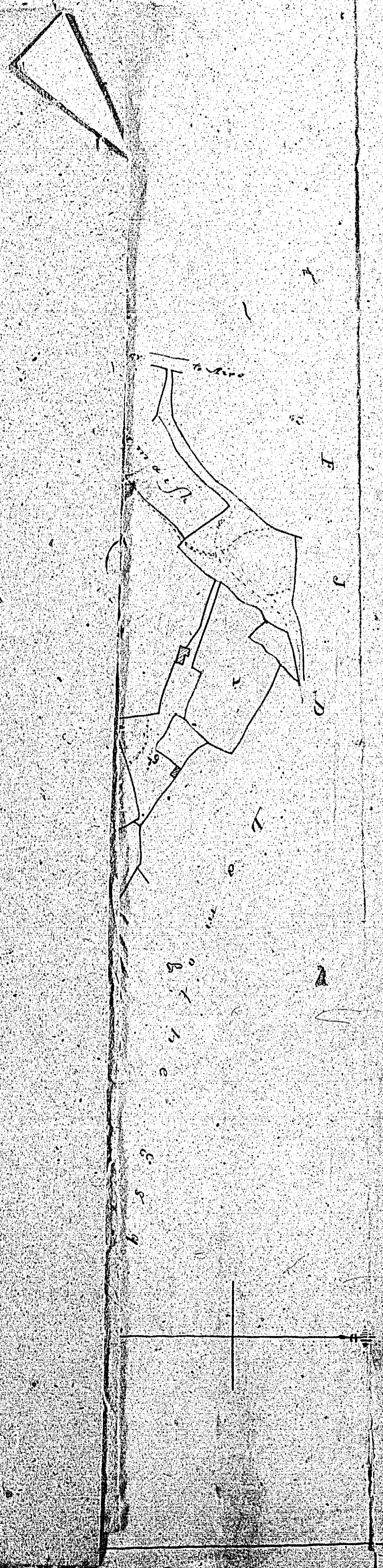

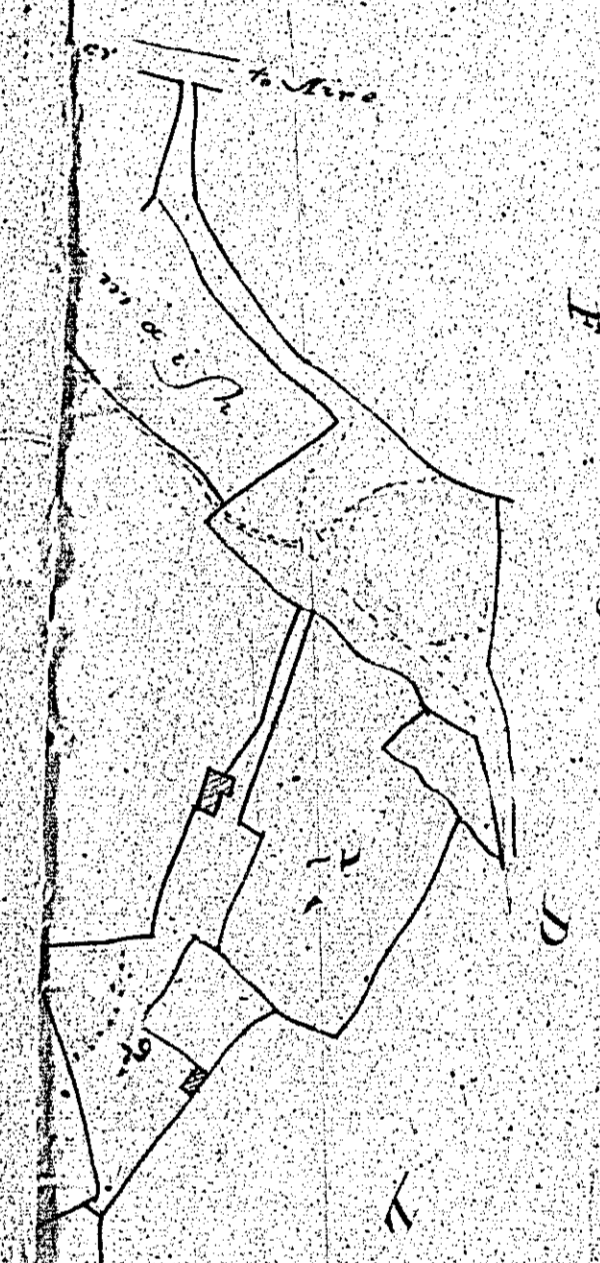
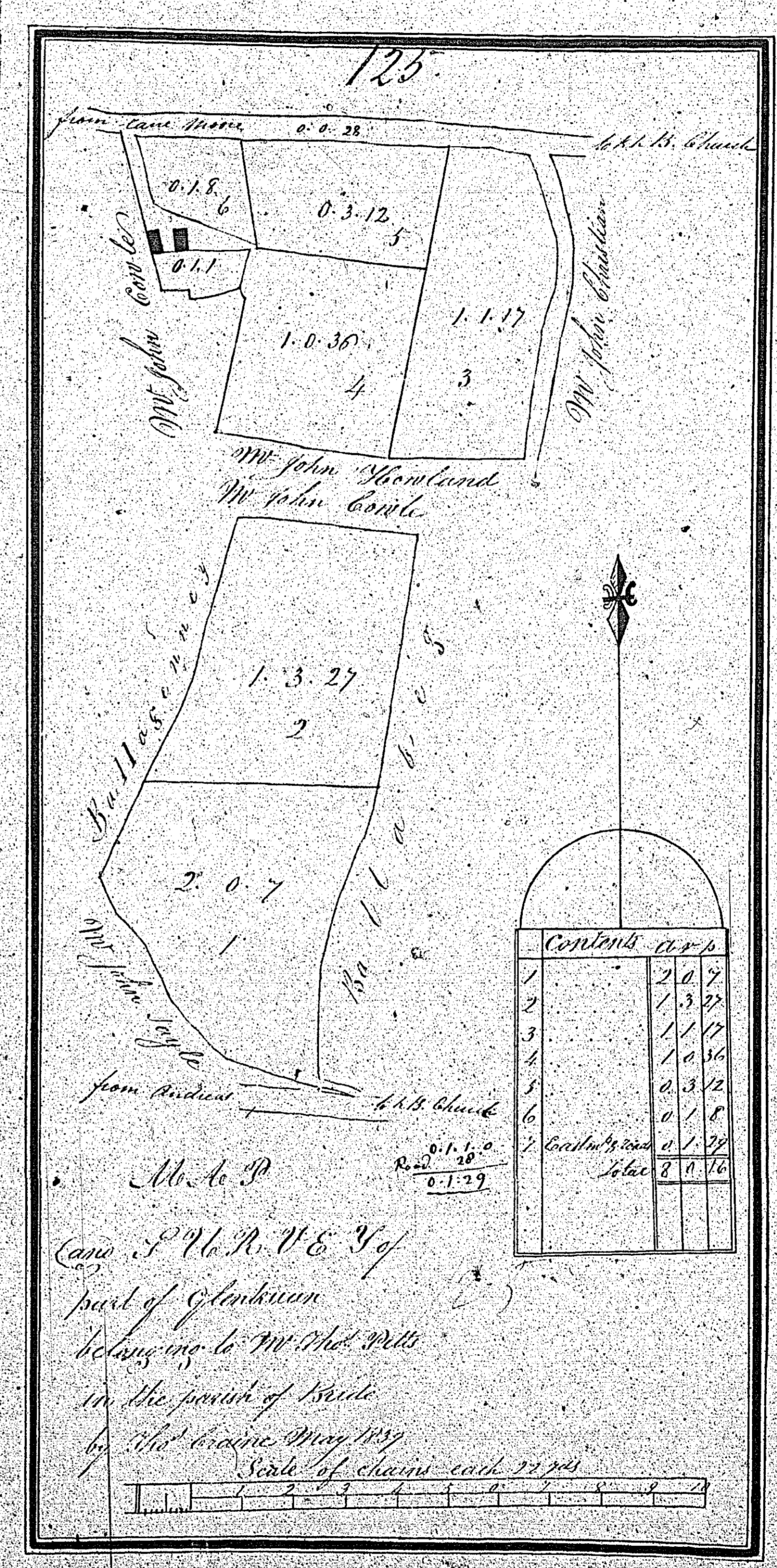

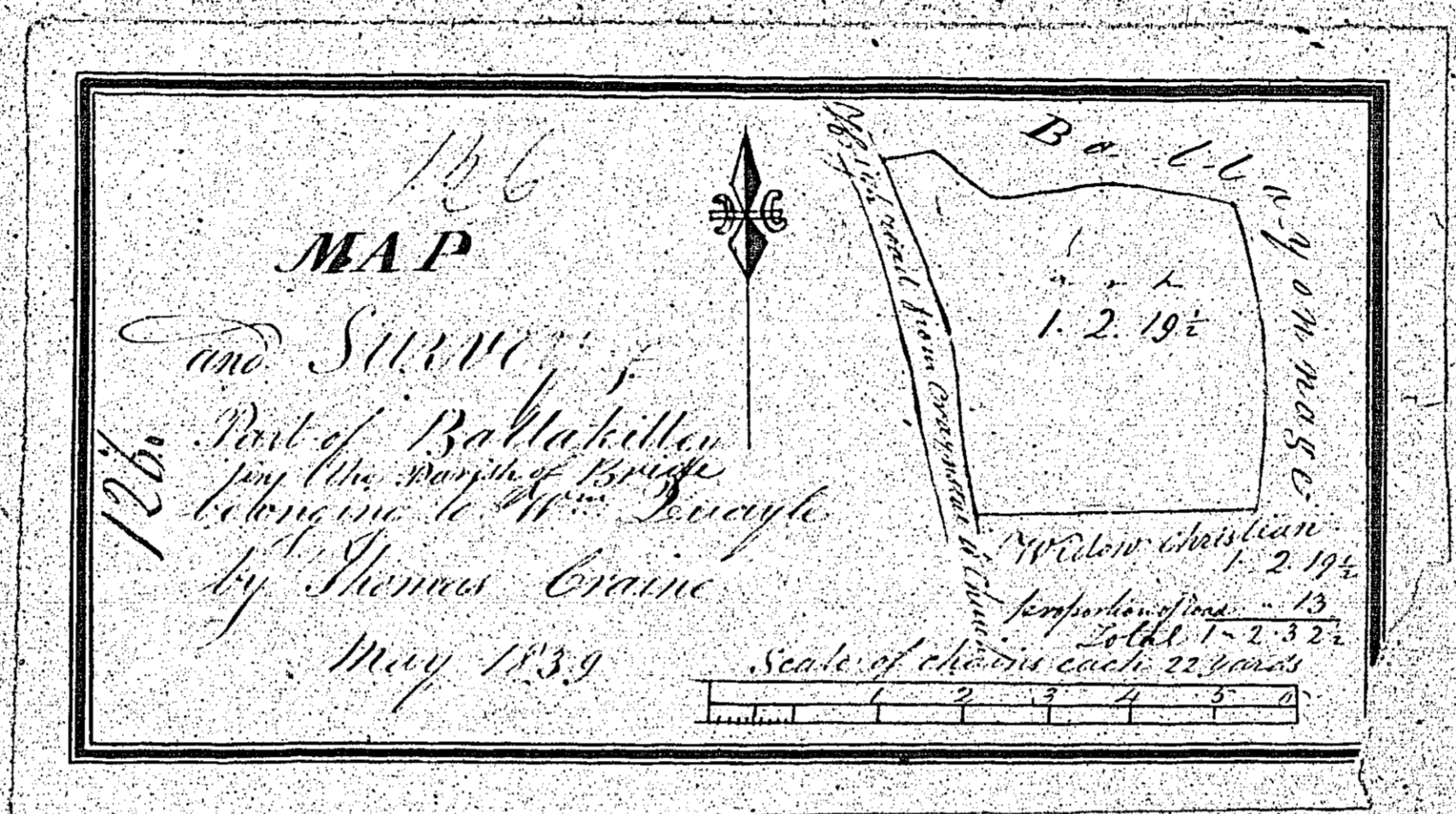

ISLE OF MAN GOVERNMENT: GENERAL REGISTRY
TITHE PLANS: PARISH OF BRIDE
Original monotone 1:30

Contents

No.	Acres
1	1.1.18
2	1.0.10
3	6.3.29
4	3.1.22
5	3.3.16
6	5.2.30
7	10.1.5
8	0.1.22
9	1.1.5
10	1.1.34
Total	35.2.18

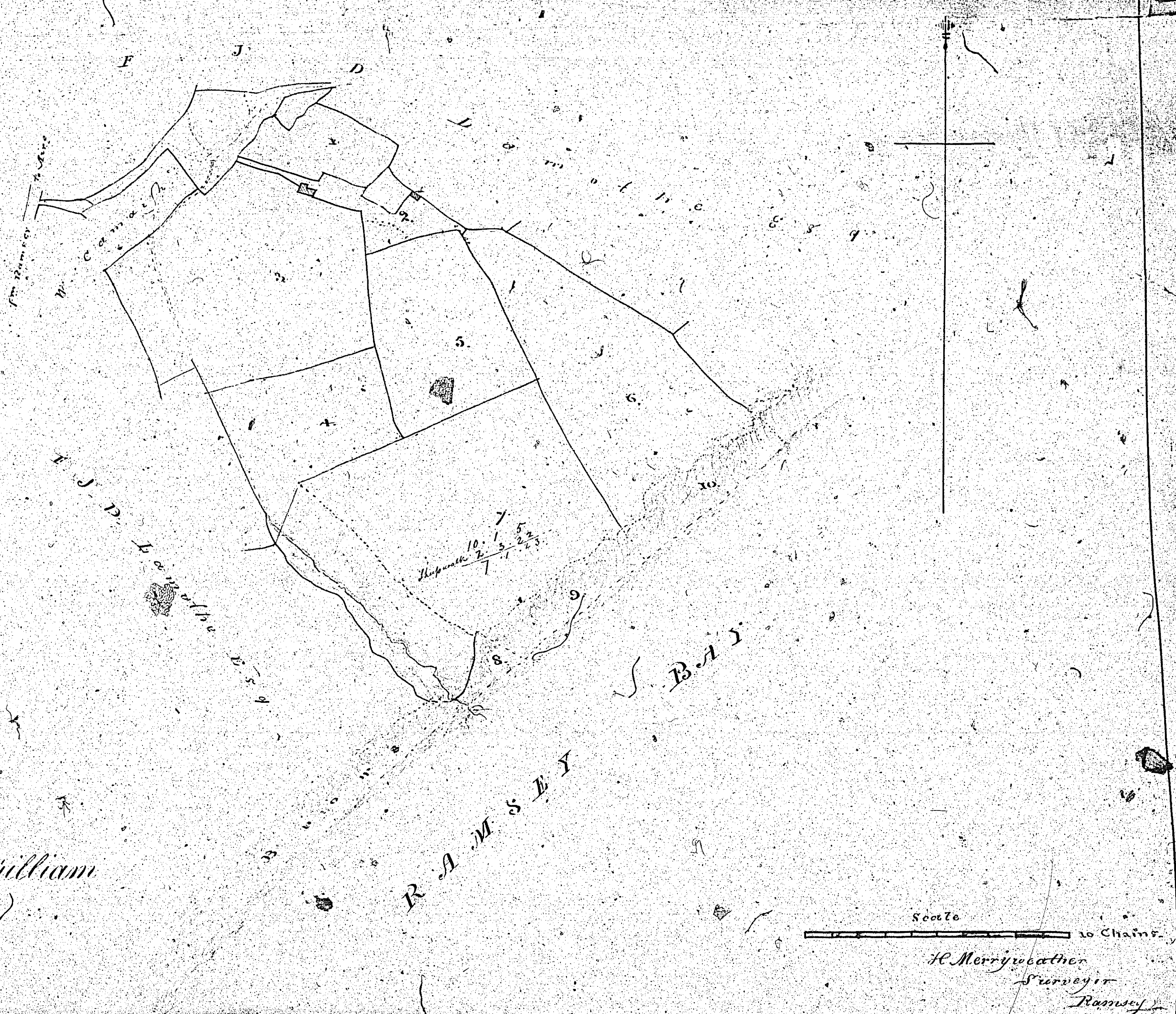

127

Kiownlough
in
Bride
belonging to
Mrs. Marg^t Quilliam
June 1839.

ISLE OF MAN GOVERNMENT: GENERAL REGISTRY,
TITHE PLANS: PARISH OF BRIDE
Original coloured (decorative) 1:30