

Handwritten notes

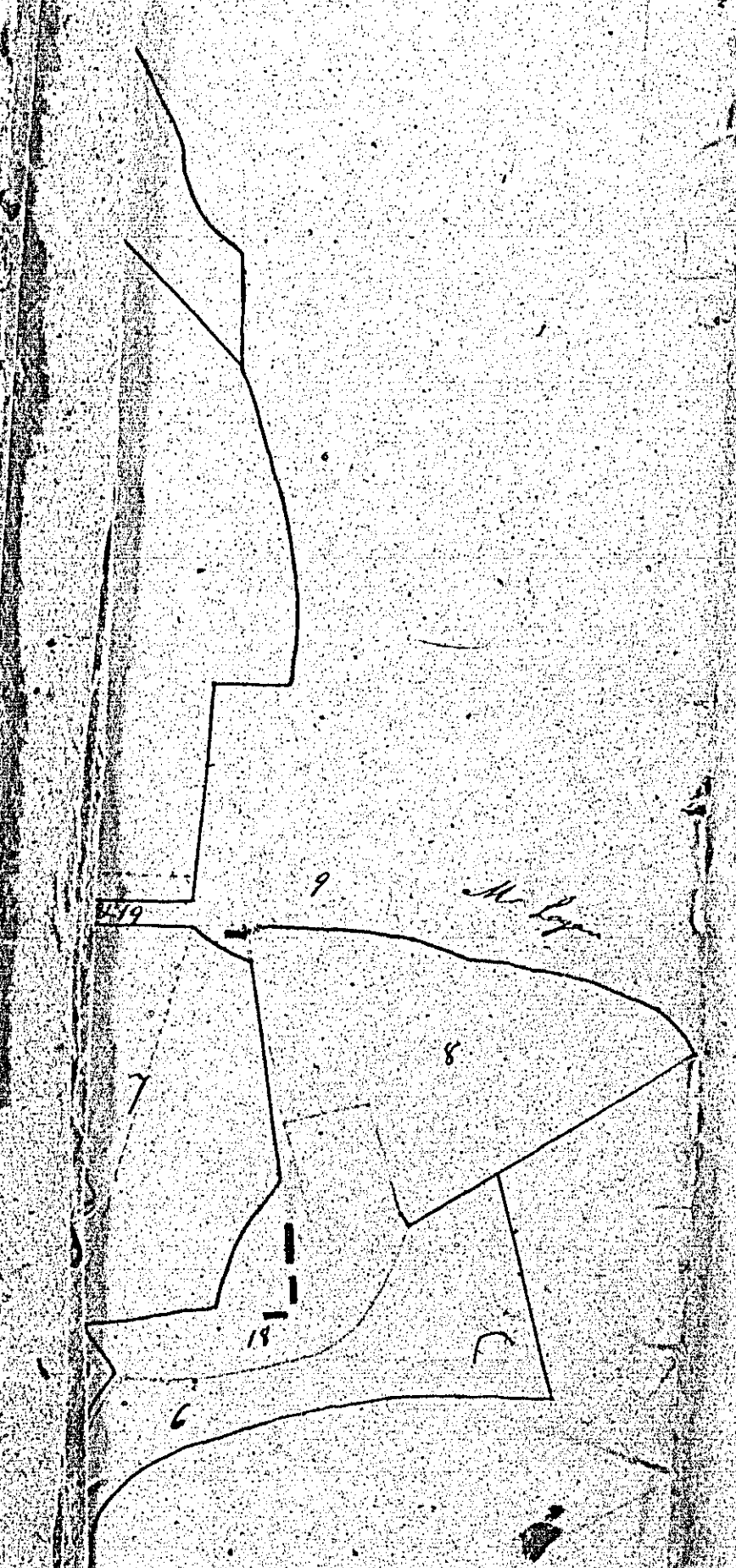
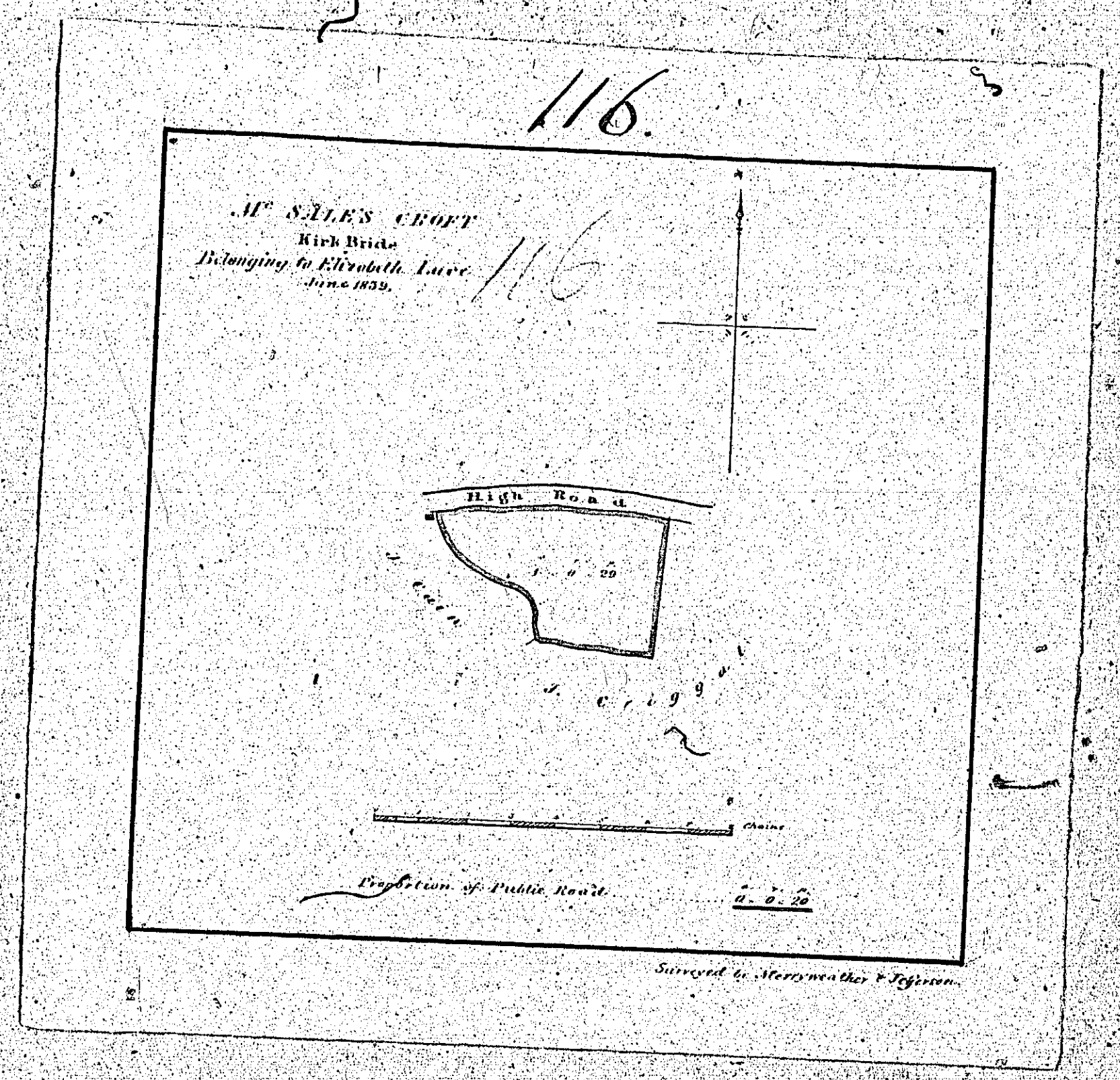

Handwritten number

Notice

*117. A Plan of
the Dog Mill
and Eastward Manure
belonging
to the parish of
B. R. I D C
the property of
Messrs. J. G. M. & Co.
by J. G. M. & Co. July 4 1839*

Scale of 1 chain to an inch

118.

*Plan of a part of
Ballacoolin in the
parish of B. R. I D C
the property of
Messrs. J. G. M. & Co.*

Scale of 1 chain to an inch

*J. G. M. & Co.
1839*

Holmes

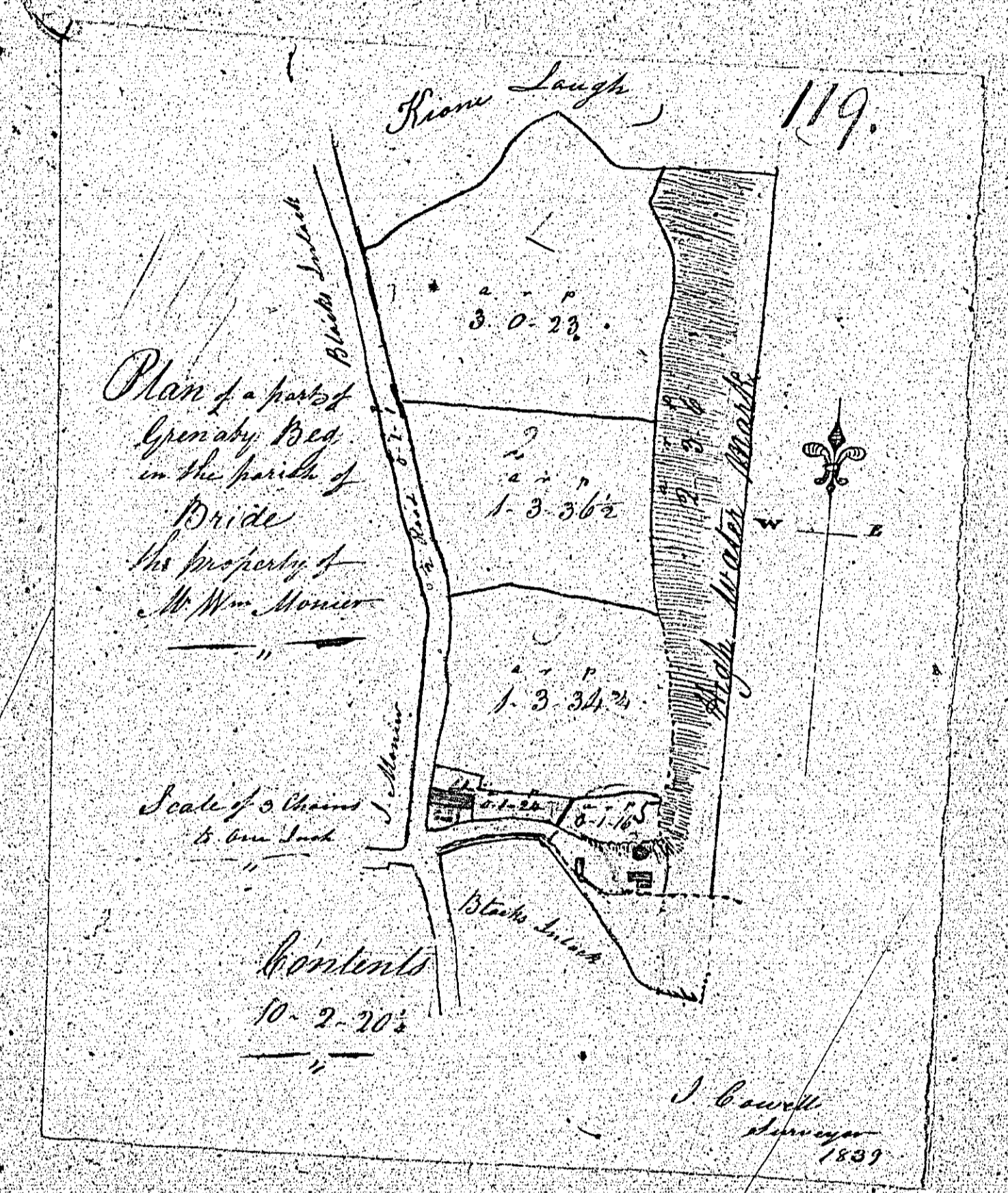

Holmes

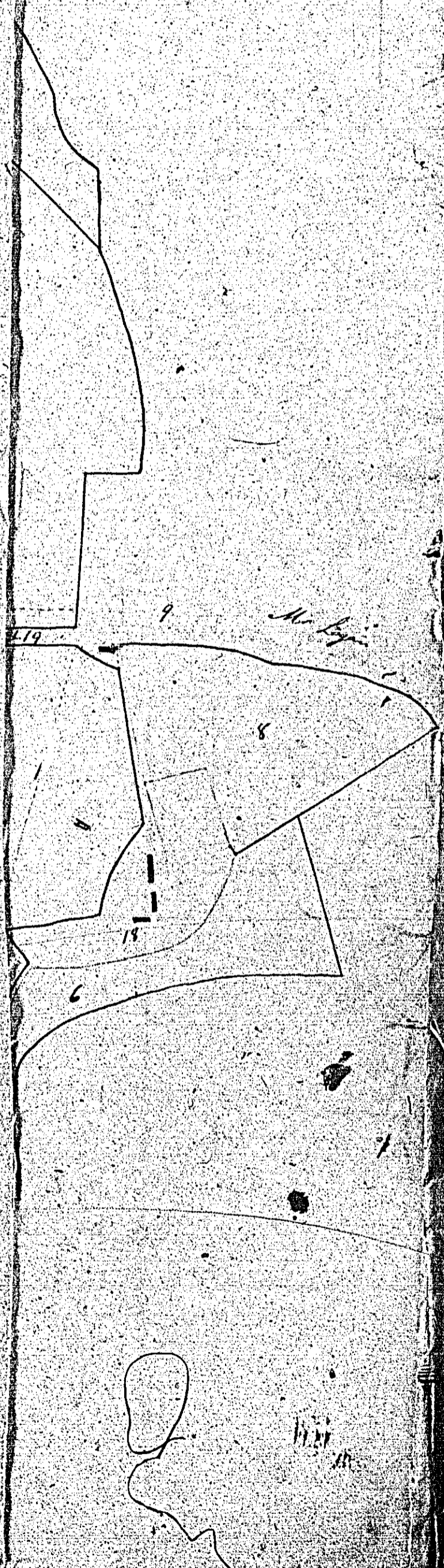
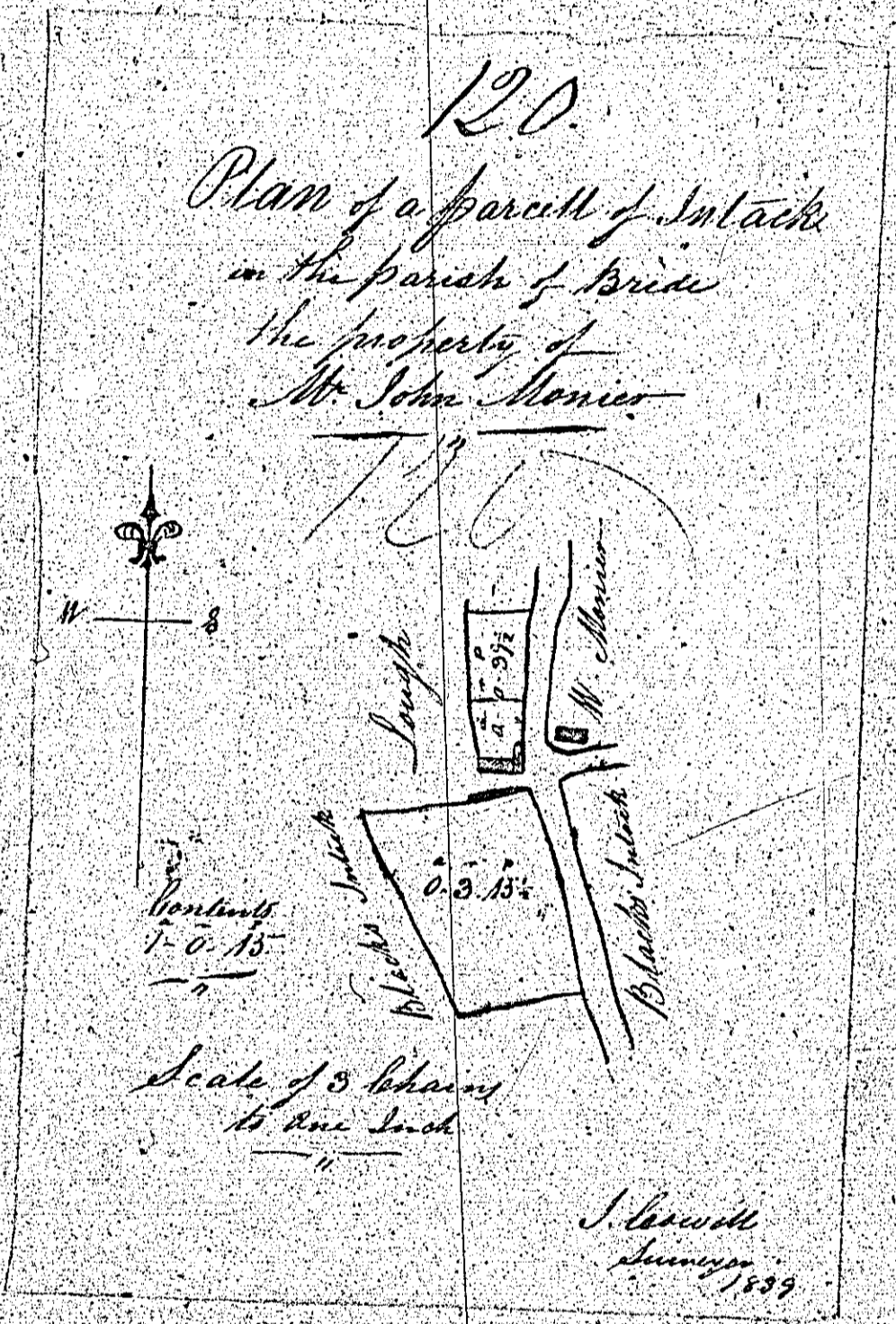

Handwritten notes at the top of the left page.

121.

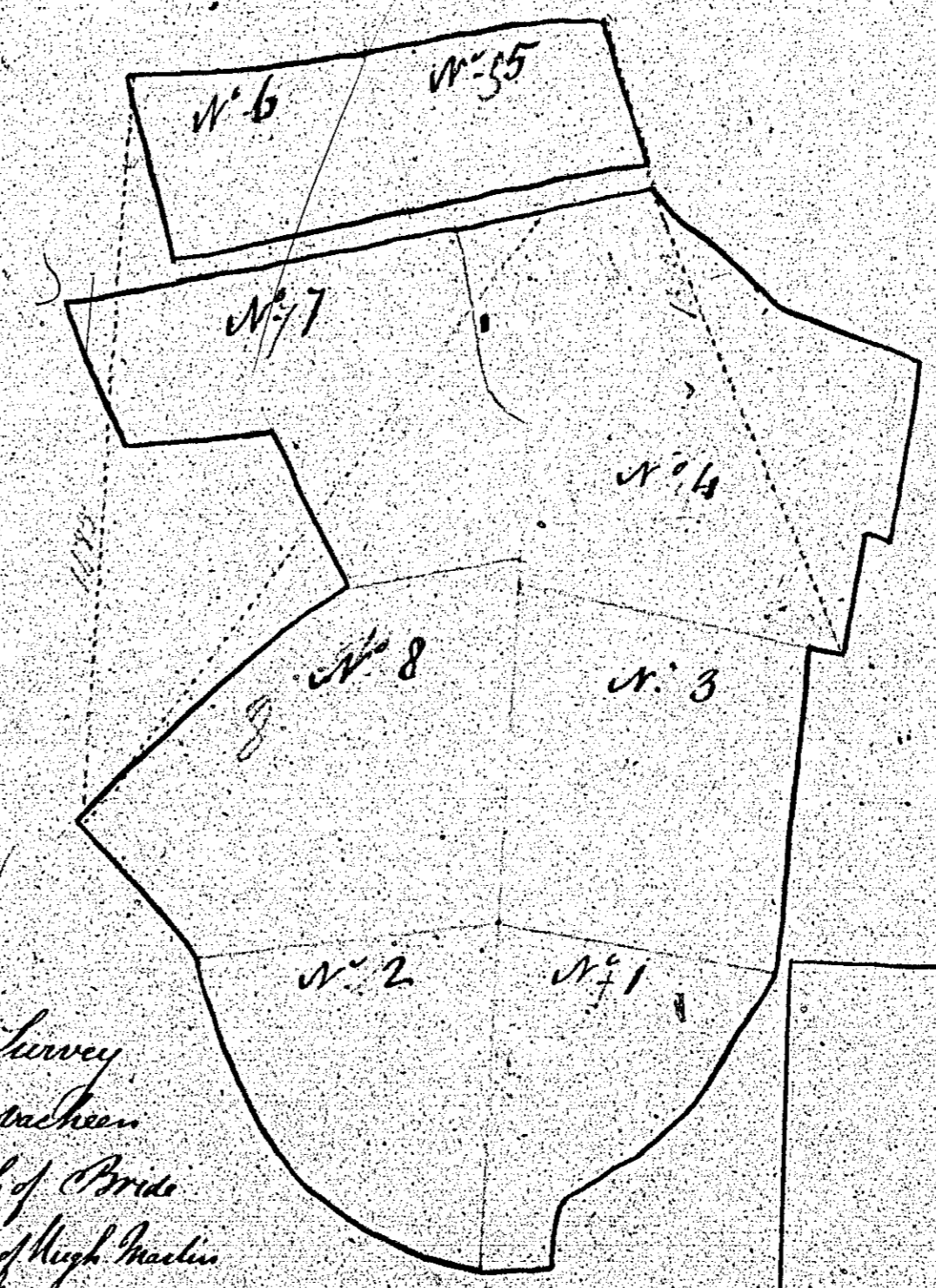

*Plan & Survey
of Ballinacree
in Parish of Bride
the property of Hugh Maclean
by John Brown
May 27*

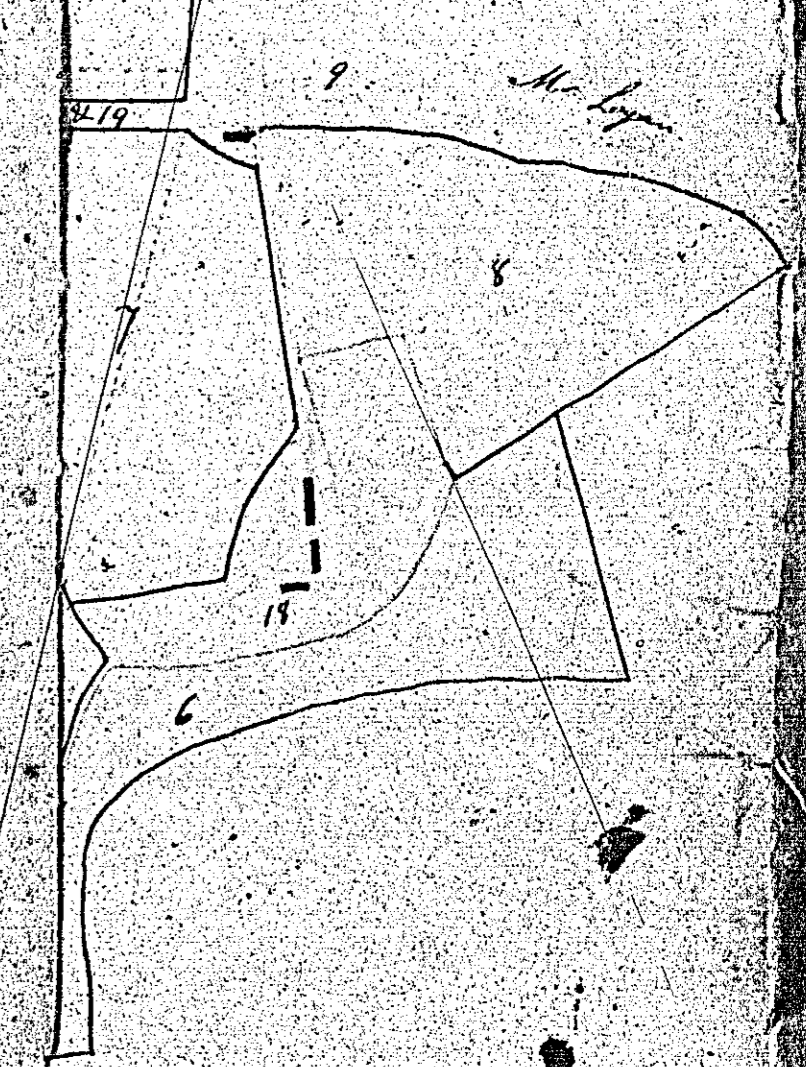

Mr. Holmes

127

*Plan and Survey
of Couragh Beg
Parish of White
belonging to
Mr. Mollen M. Whannel
by John Brown Esq.*

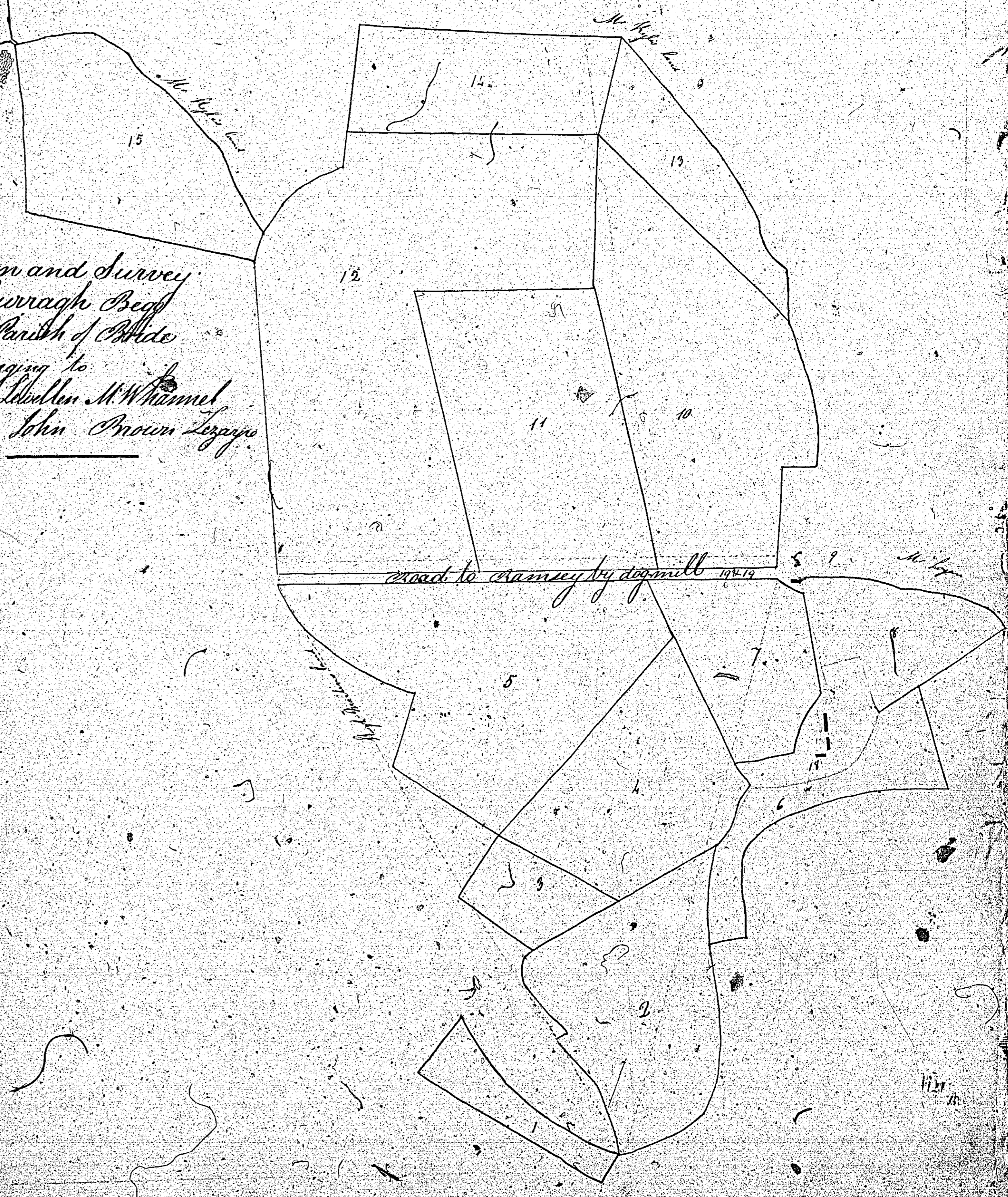

1791
1792
1793
1794
1795
1796
1797
1798
1799
1800