

frame 1 of 2

ISLE OF MAN GOVERNMENT: GENERAL REGISTRY

TITHE PLANS: PARISH OF BRIDE



PREVIOUS IMAGE REPEATED

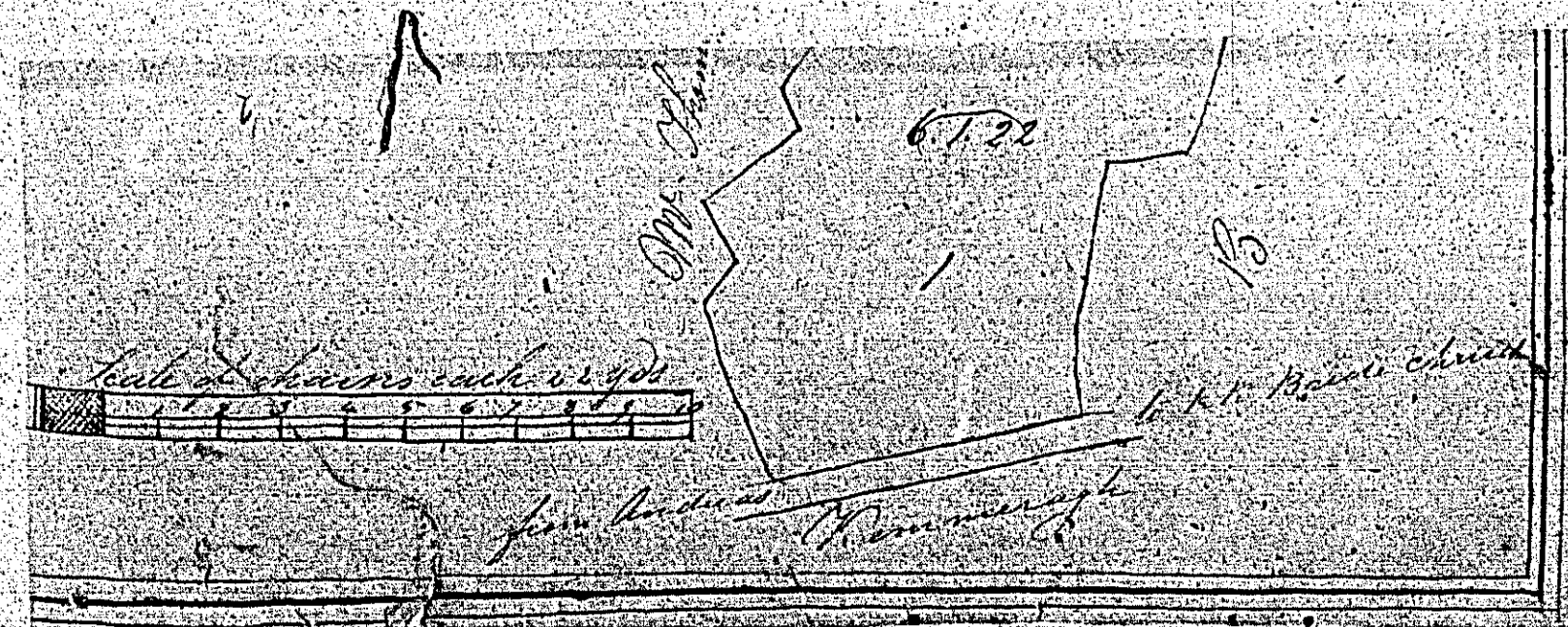

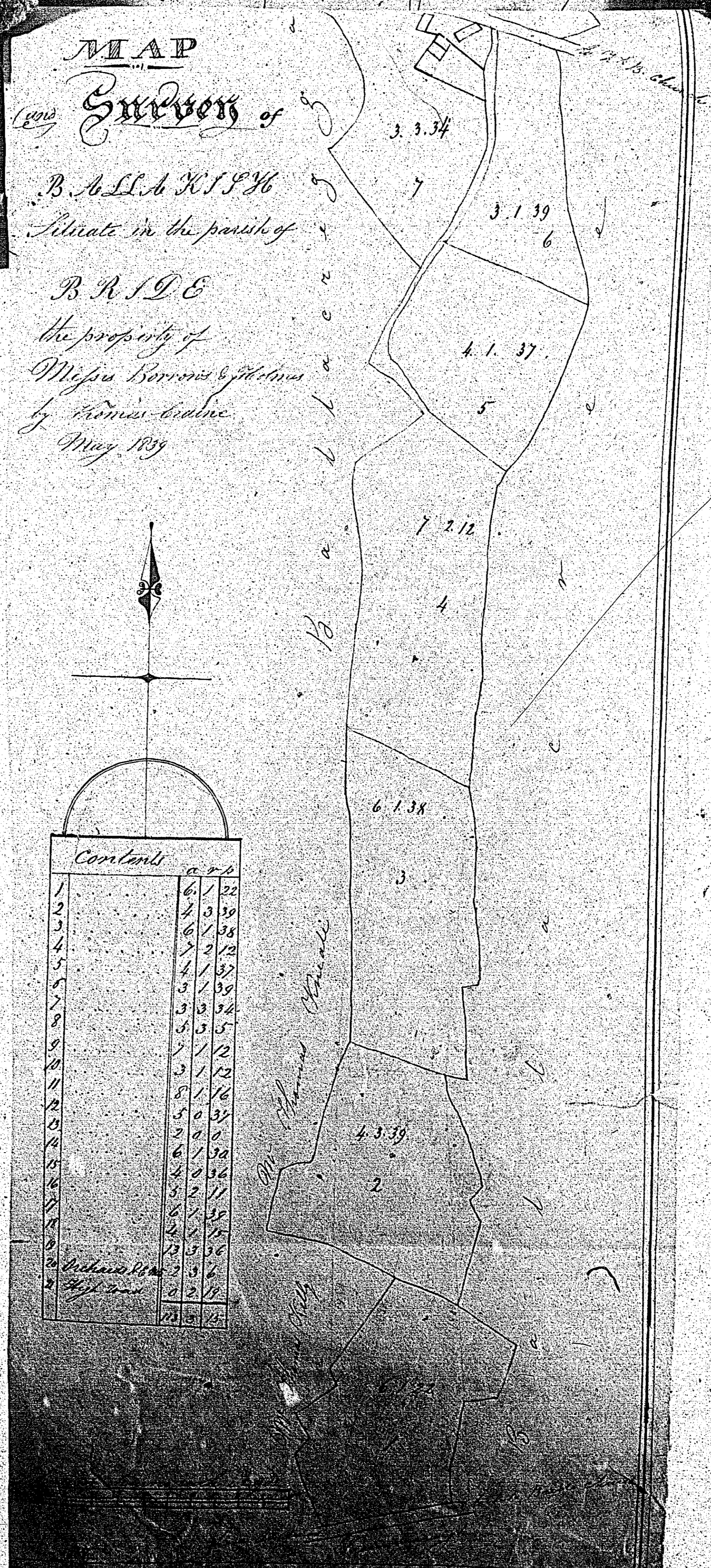

frame 2 of 2



This Parcel contains  $16$  Acre  $10$  Roods  $10$  Perches of  $1/2$  Acre

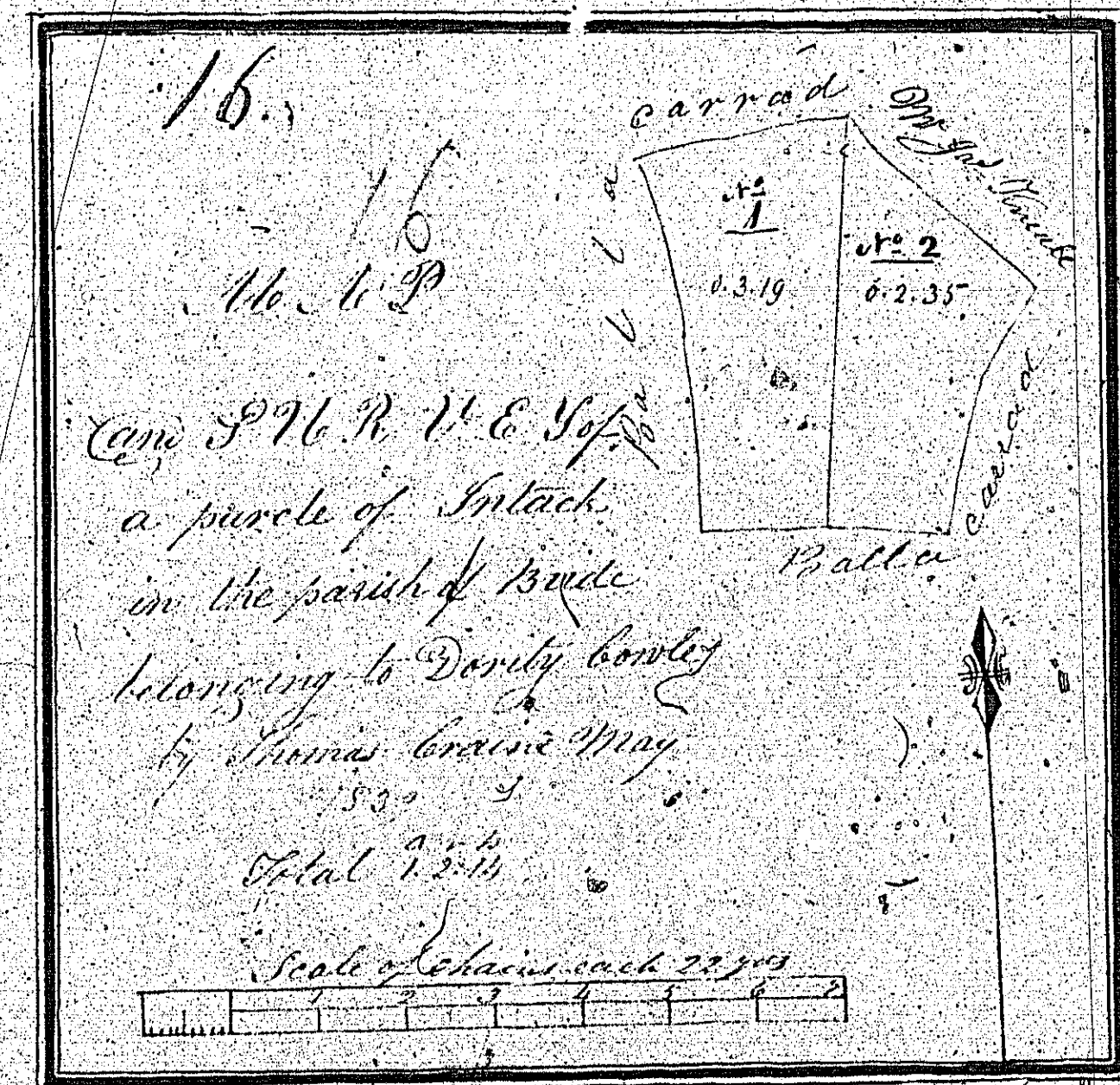

*This Parcel on Charles Lindbergh's New Plan of Baker*

The two following plans are  
both numbered 17<sup>th</sup>