

Not used

A Plan and survey of a part of
Cleeve Common in the parish of
Bollington the property of William
Quayle taken April 22nd 1840
by James Hemmick

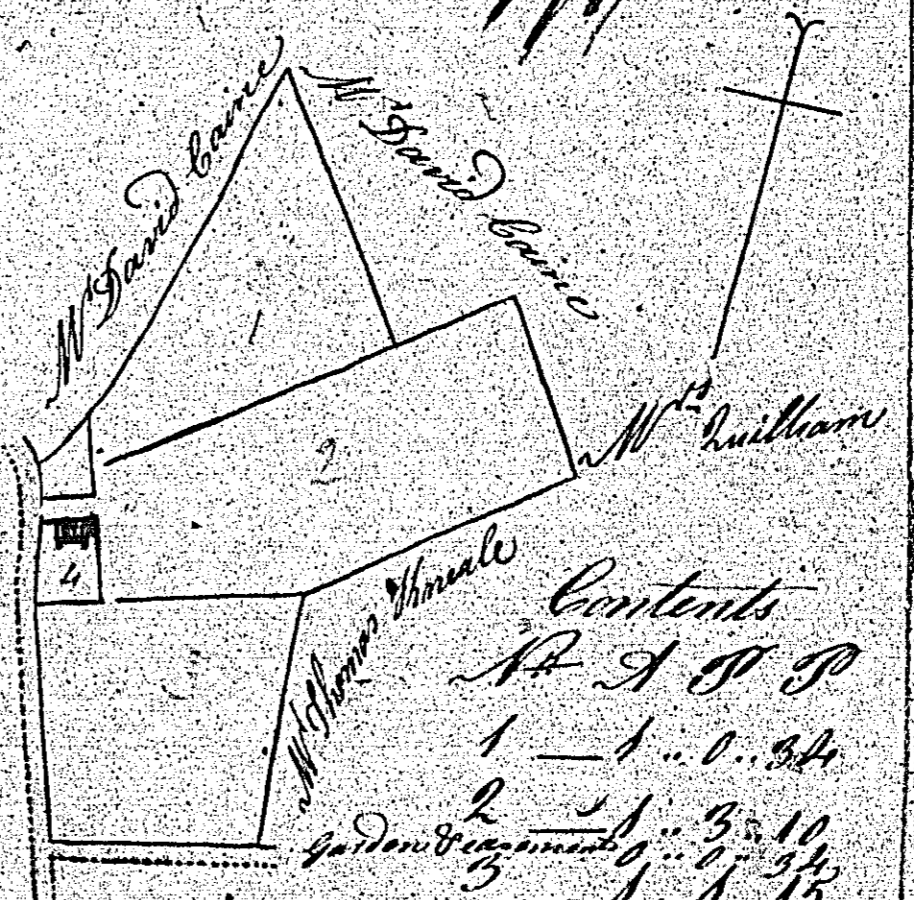

Contents

1	1	0.84
2	2	3.10
3	1	1.15
Total		2.13

A scale of 3 chains to an Inch



1840

1839

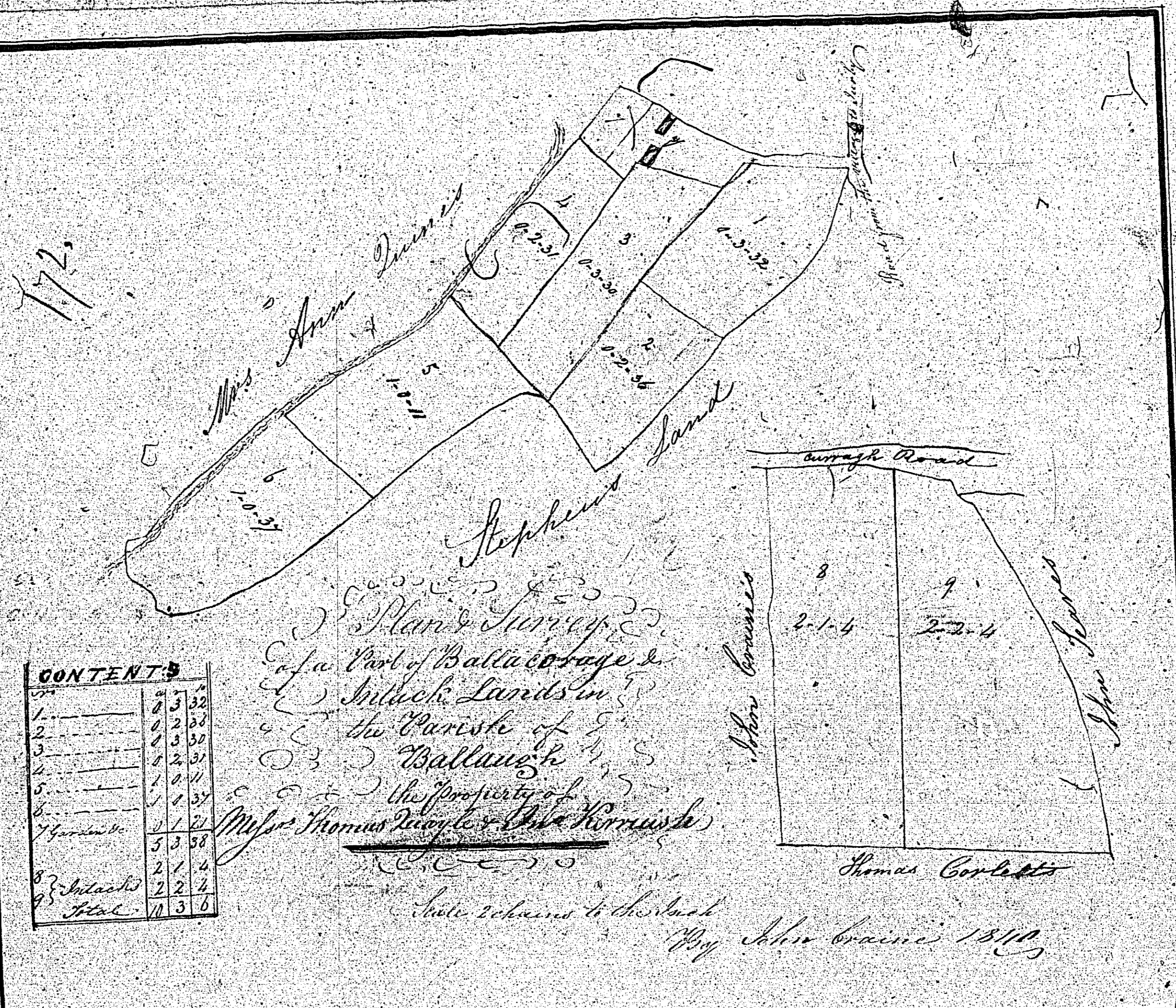
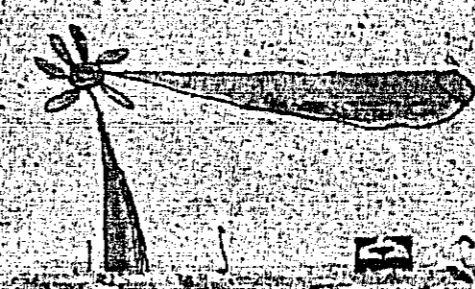

ISLE OF MAN GOVERNMENT: GENERAL REGISTRY
 TITHE PLANS: PARISH OF BALLAUGH
 Original monotone 1:30

[Faint, illegible handwritten notes and scribbles on the left page.]

Not used

173.

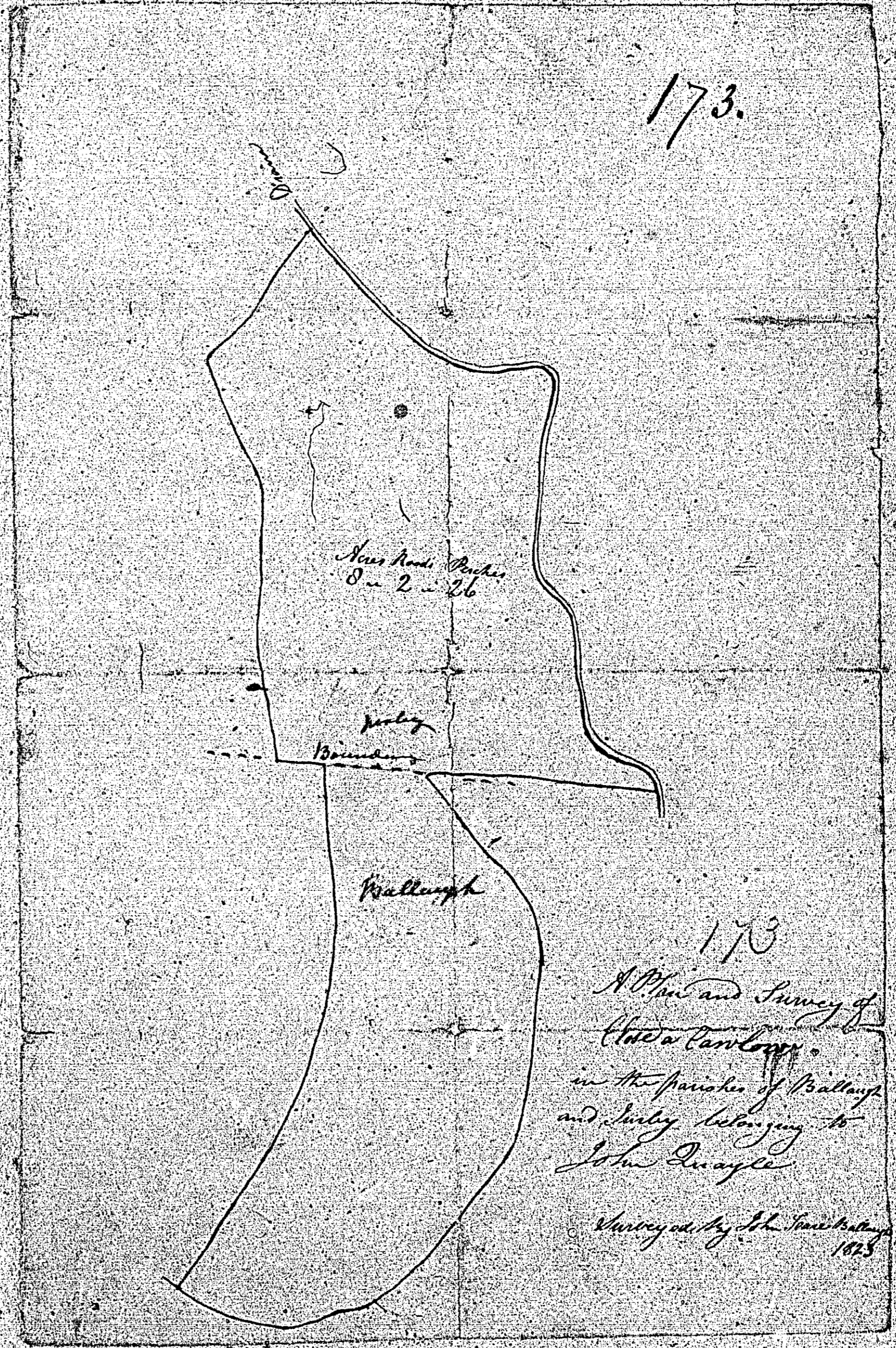

New Road
8 - 2 - 26

Irish
Boundary

Wallingford

173

A Plan and Survey of
the Land
in the Parish of Wallingford
and Irish belonging to
John Quigley

Surveyed by J. H. Smith
1825

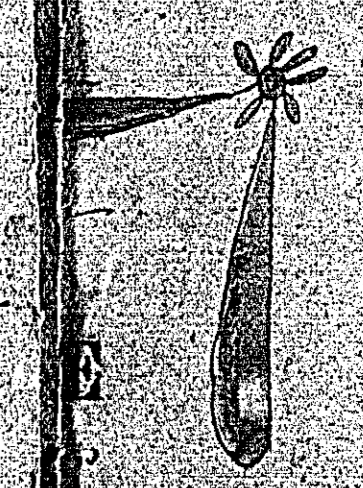

174

Part of Ballacurry Cull.
Quarreland Ballacurry
The Rights of
Mr. Tho. Quincey

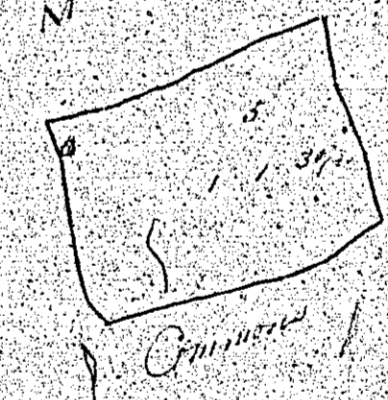
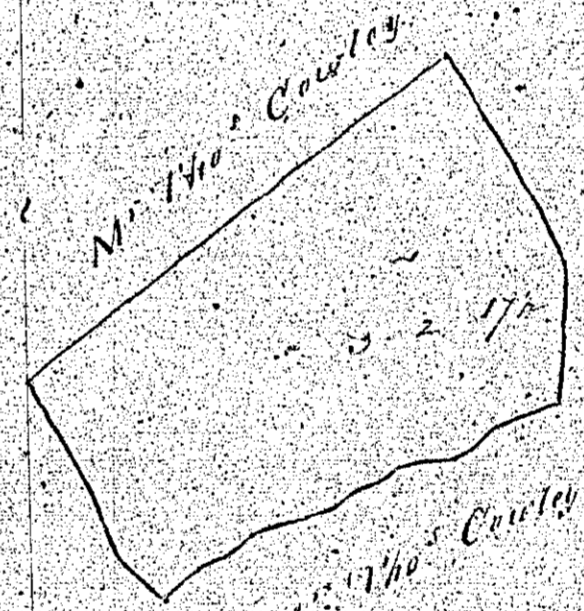
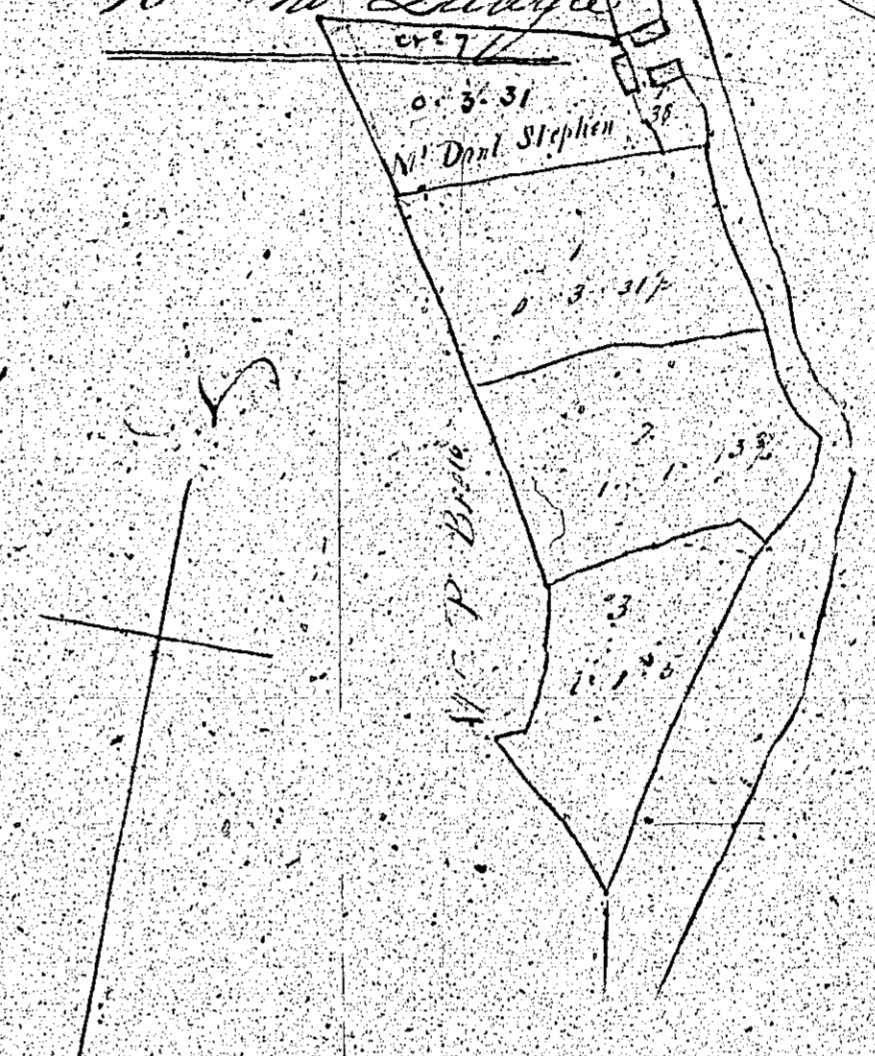

Contents

No.	A.	R.	P.
1.	0.	0.	11 1/2
2.	1.	1.	11 1/2
3.	1.	1.	11 1/2
4.	1.	1.	11 1/2
5.	1.	1.	11 1/2
6.	1.	1.	11 1/2
Total	6.	6.	68 1/2

Scale 30

By Dan. O'Connell Sept 1840

Sept 1839

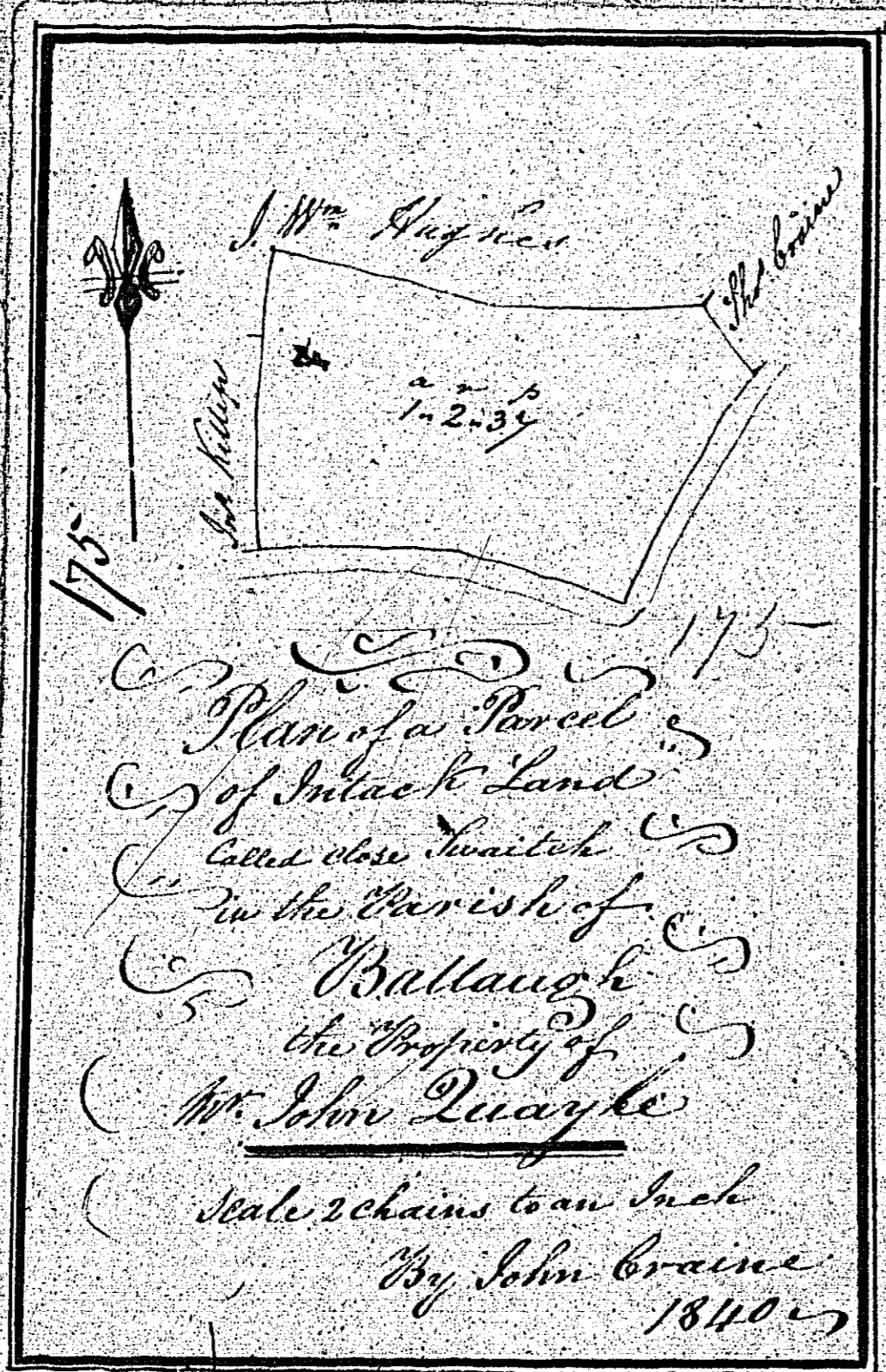

Plan of a Parcel
of Inland Land
latter close situated
in the Parish of
Ballaugh
the Property of
Mr. John Quayle
Scale 2 chains to an Inch
By John Crane
1840

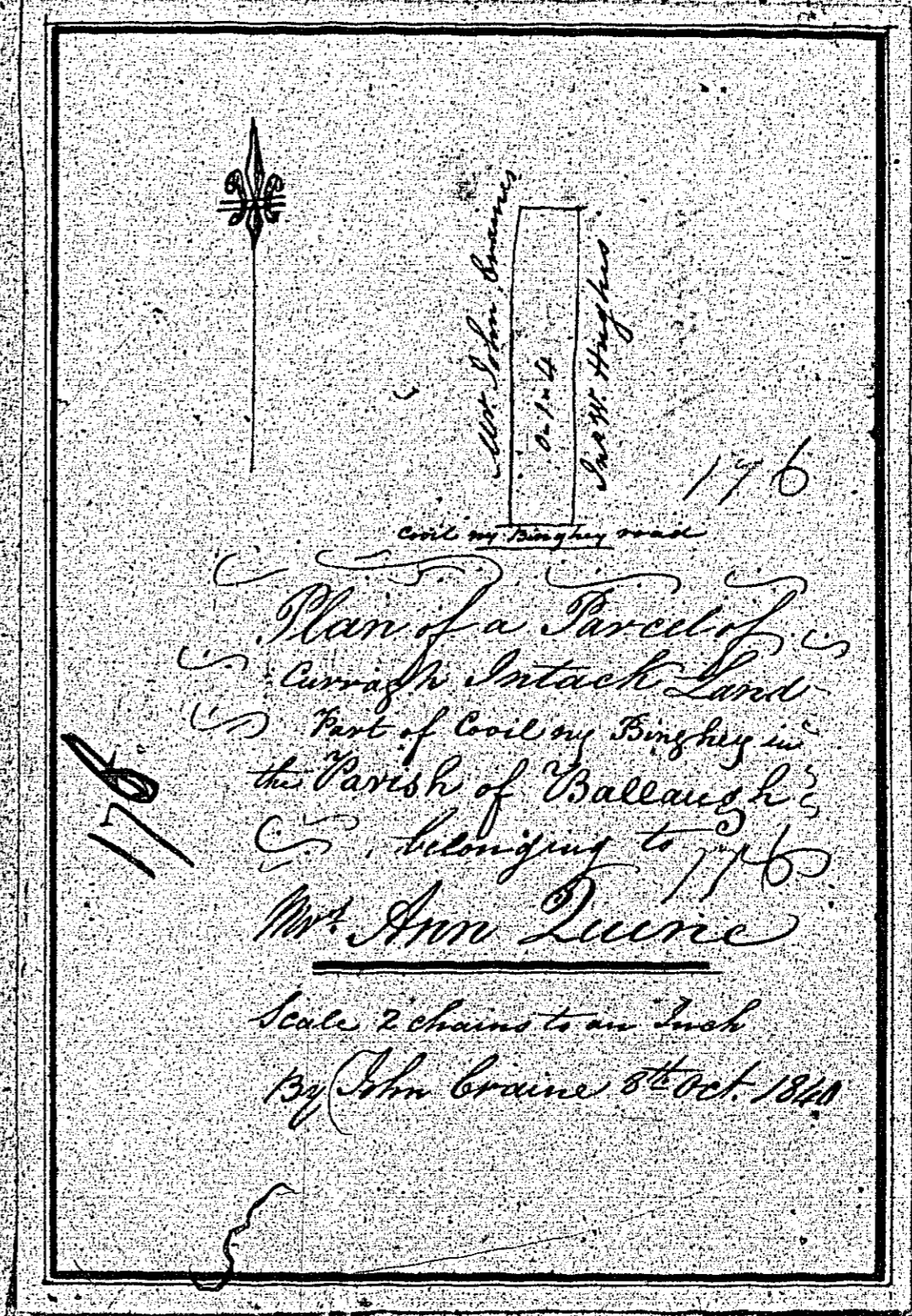

Plan of a Parcel of
Curragh Inland Land
Part of Coill na Bingsay in
the Parish of Ballaugh
belonging to
Mr. Ann Quene
Scale 2 chains to an Inch
By John Crane 5th Oct. 1840

ISLE OF MAN GOVERNMENT: GENERAL REGISTRY

TITHE PLANS: PARISH OF BALLAUGH

Originals monotone

1:30

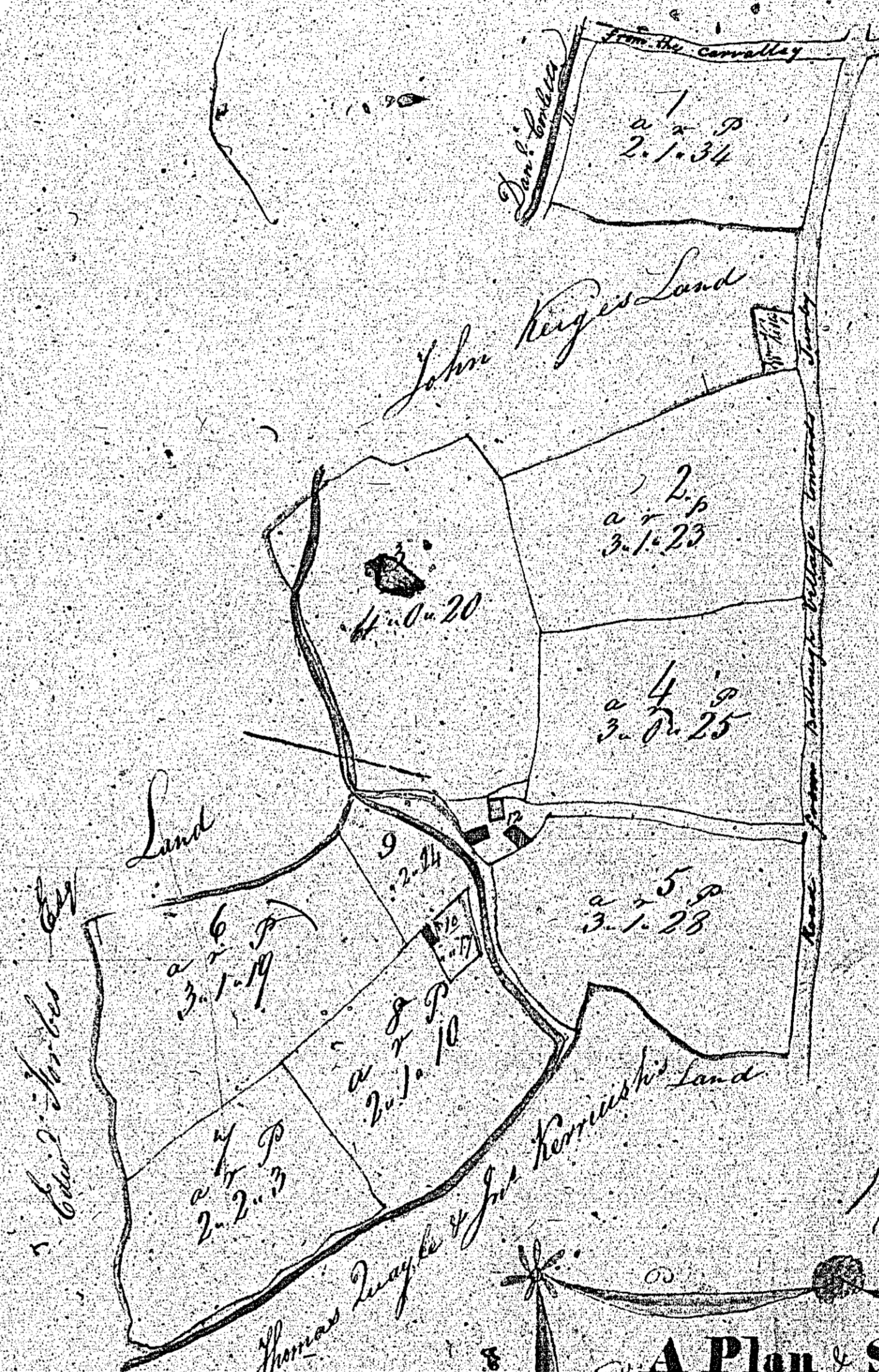

Contents

ART	
2	1 34
3	1 23
4	0 20
3	0 25
3	1 28
3	1 11
2	2 13
2	1 10
2	1 14
2	1 15
2	2 8
1	1 26
1	1 28

A Plan & Survey
 of a Part of
BALLACORAGE
 in the Parish of
BALLAUGH
 Belonging to
M^{rs} Ann Quine

