

No. 121

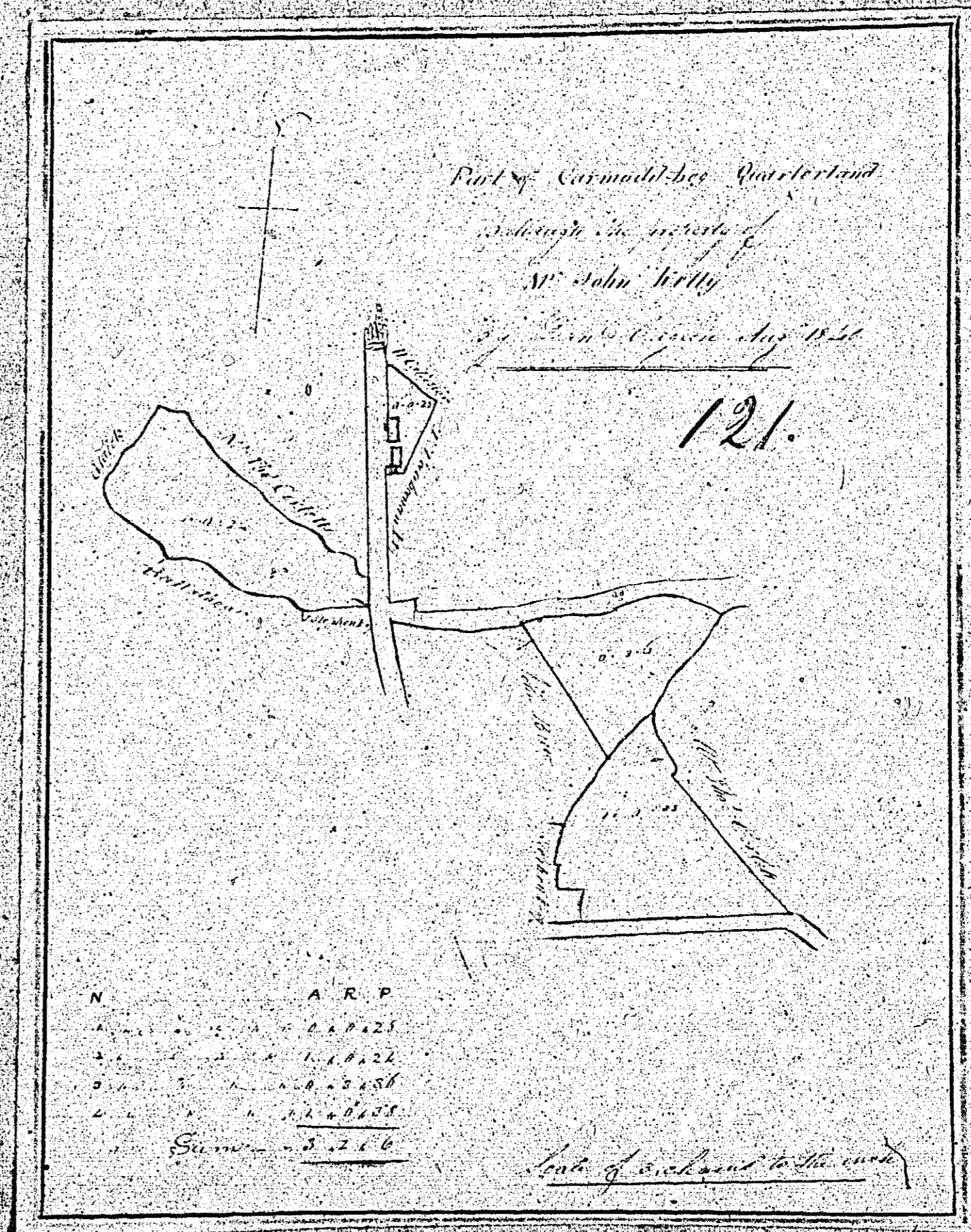

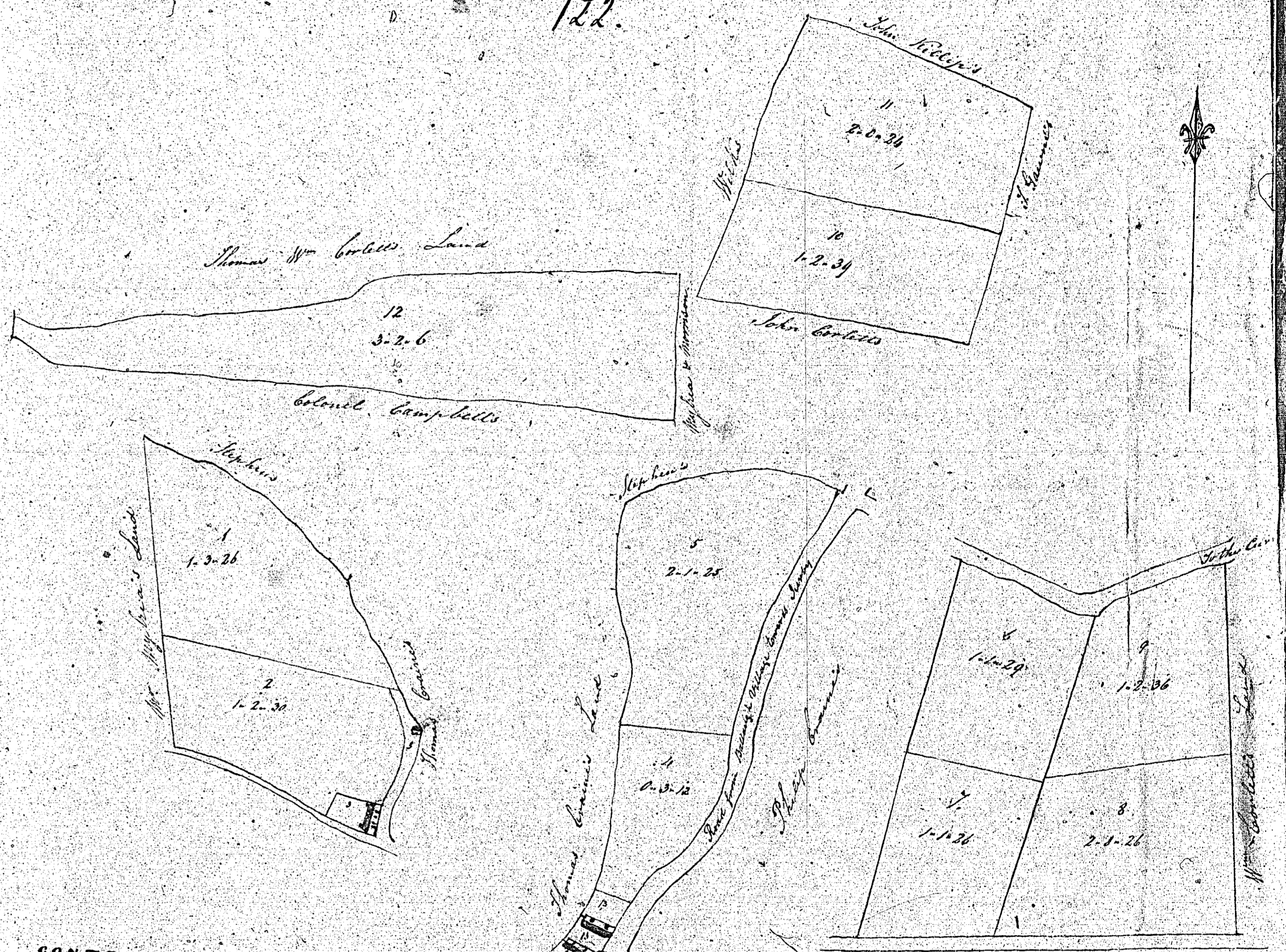

CONTENTS

1	1.3.26
2	1.2.30
3	1.3.26
4	2.1.26
5	2.1.26
6	1.2.29
7	1.1.26
8	2.0.26
9	1.2.26
10	1.2.26
11	2.7.26
12	3.2.6
Thomas Collins	2.0.30
John Collins	1.1.24
Total	21.1.24

Plan of a Part of the  
 Dohaugh Meador  
 and its  
 is the property of  
 Mr. Wm Kelly  
 Situated in the Parish of  
 Ballaugh

Scale 2 chains to the inch

By John Cruise 1835

*Handwritten signature or initials*

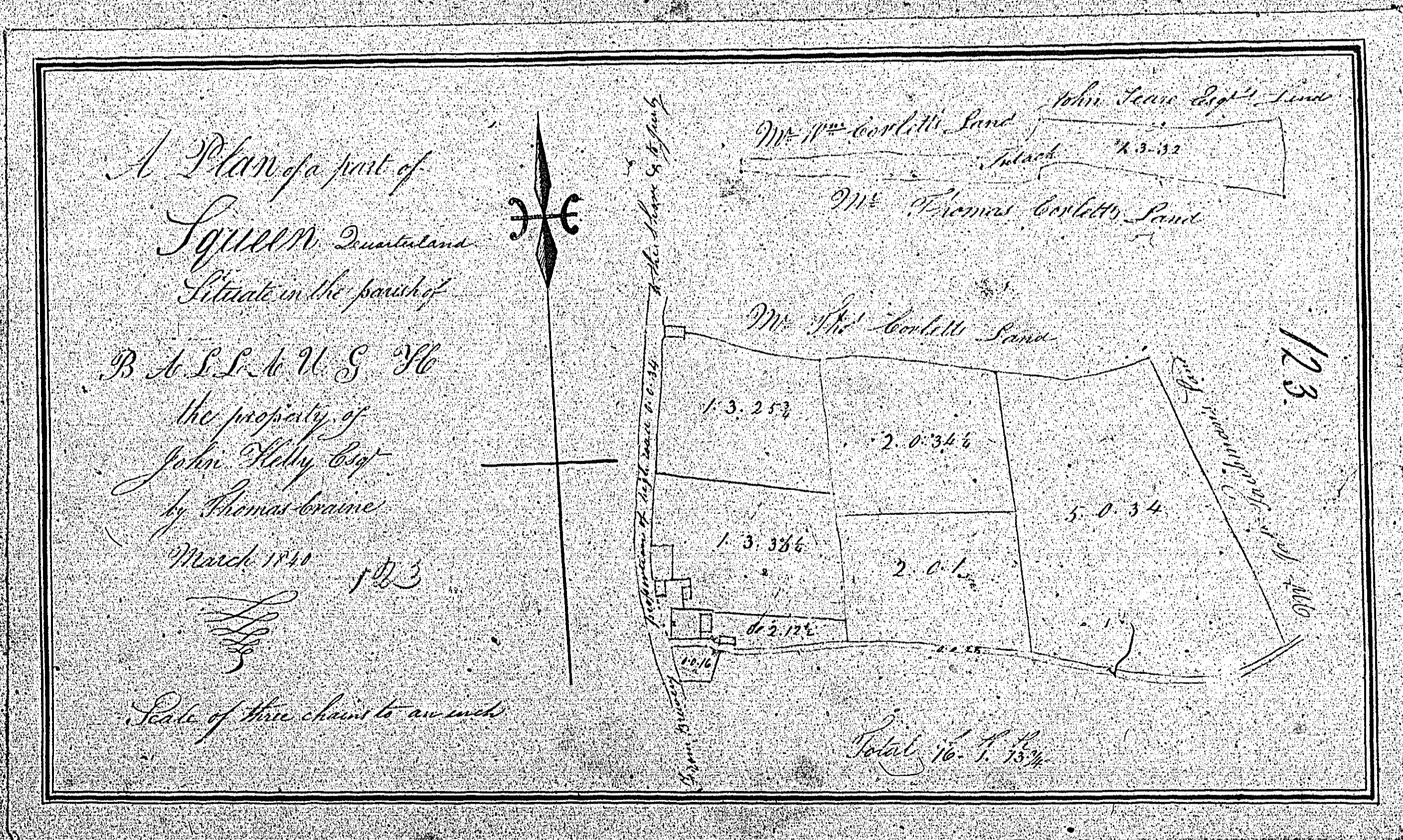

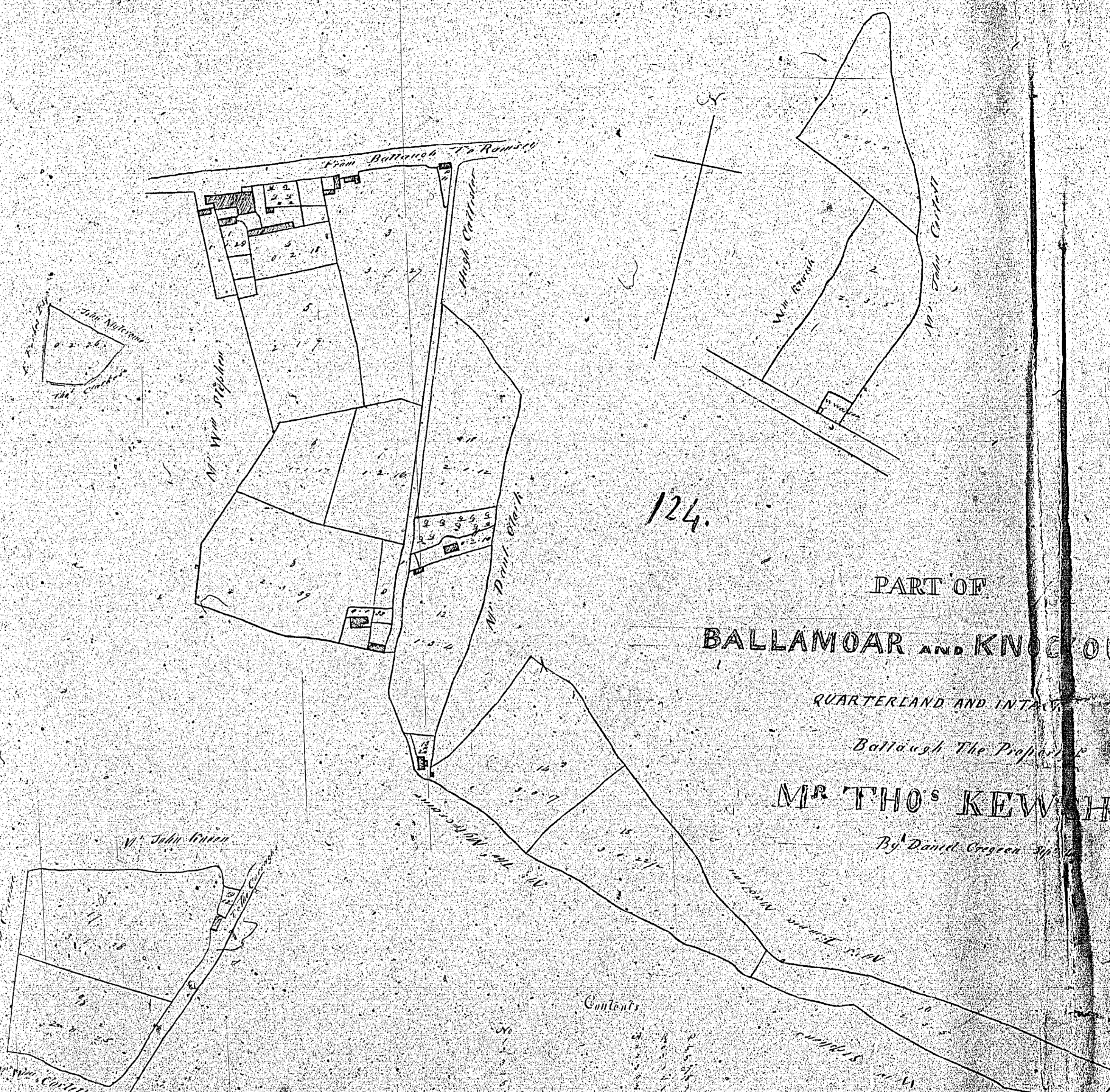

124.

PART OF  
 BALLAMOAR AND KNOCKOULD  
 QUARTERLAND AND INTERVALL  
 Ballamoar The Property  
 MR THO<sup>S</sup> KEWELL  
 By Daniel Cresson

Contents

1	1
2	2
3	3
4	4
5	5
6	6
7	7
8	8
9	9
10	10
11	11
12	12
13	13
14	14
15	15
16	16
17	17
18	18
19	19
20	20
21	21
22	22
23	23
24	24
25	25
26	26
27	27
28	28
29	29
30	30
31	31
32	32
33	33
34	34
35	35
36	36
37	37
38	38
39	39
40	40
41	41
42	42
43	43
44	44
45	45
46	46
47	47
48	48
49	49
50	50
51	51
52	52
53	53
54	54
55	55
56	56
57	57
58	58
59	59
60	60
61	61
62	62
63	63
64	64
65	65
66	66
67	67
68	68
69	69
70	70
71	71
72	72
73	73
74	74
75	75
76	76
77	77
78	78
79	79
80	80
81	81
82	82
83	83
84	84
85	85
86	86
87	87
88	88
89	89
90	90
91	91
92	92
93	93
94	94
95	95
96	96
97	97
98	98
99	99
100	100

Scale 1/2

*Not used*

There is no plan  
numbered 125

*Volume*

