

42

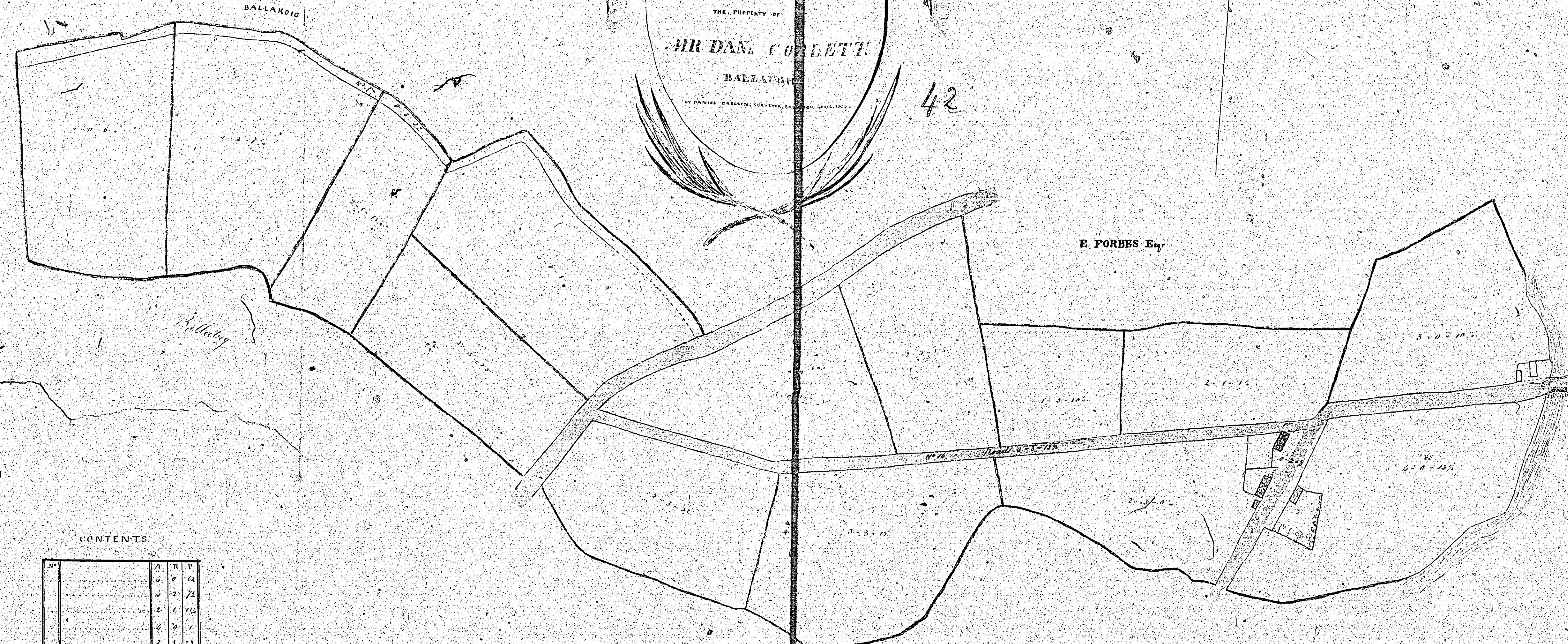
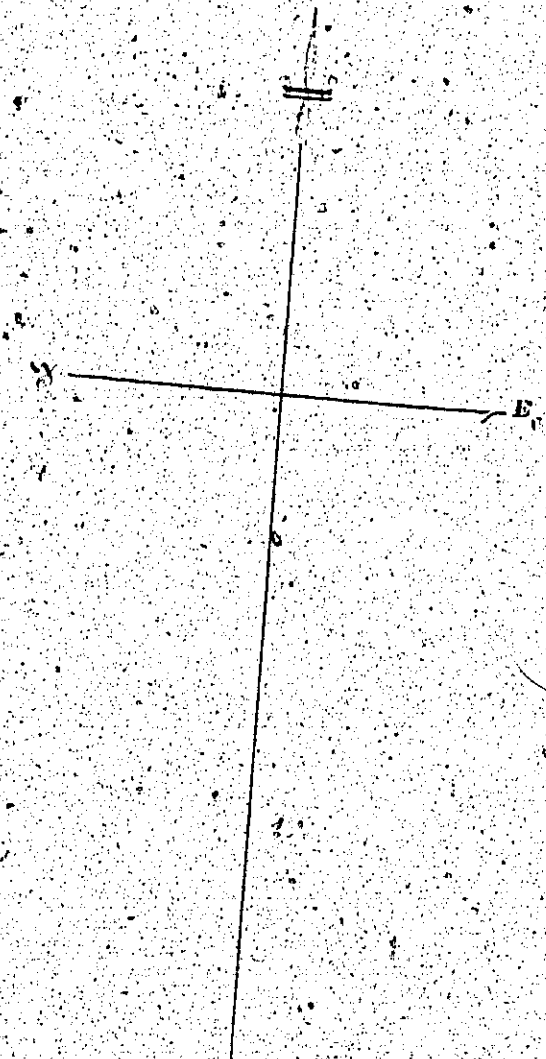

CONTENTS

No.	Acres	Roods	Poles
1	0	0	64
2	2	2	72
3	1	0	00
4	0	0	00
5	0	0	00
6	0	0	00
7	0	0	00
8	0	0	00
9	0	0	00
10	0	0	00
11	0	0	00
12	0	0	00
13	0	0	00
14	0	0	00
15	0	0	00
16	0	0	00
17	0	0	00
18	0	0	00
19	0	0	00
20	0	0	00
21	0	0	00
22	0	0	00
23	0	0	00
24	0	0	00
25	0	0	00
26	0	0	00
27	0	0	00
28	0	0	00
29	0	0	00
30	0	0	00
31	0	0	00
32	0	0	00
33	0	0	00
34	0	0	00
35	0	0	00
36	0	0	00
37	0	0	00
38	0	0	00
39	0	0	00
40	0	0	00
41	0	0	00
42	0	0	00
43	0	0	00
44	0	0	00
45	0	0	00
46	0	0	00
47	0	0	00
48	0	0	00
49	0	0	00
50	0	0	00
51	0	0	00
52	0	0	00
53	0	0	00
54	0	0	00
55	0	0	00
56	0	0	00
57	0	0	00
58	0	0	00
59	0	0	00
60	0	0	00
61	0	0	00
62	0	0	00
63	0	0	00
64	0	0	00
65	0	0	00
66	0	0	00
67	0	0	00
68	0	0	00
69	0	0	00
70	0	0	00
71	0	0	00
72	0	0	00
73	0	0	00
74	0	0	00
75	0	0	00
76	0	0	00
77	0	0	00
78	0	0	00
79	0	0	00
80	0	0	00
81	0	0	00
82	0	0	00
83	0	0	00
84	0	0	00
85	0	0	00
86	0	0	00
87	0	0	00
88	0	0	00
89	0	0	00
90	0	0	00
91	0	0	00
92	0	0	00
93	0	0	00
94	0	0	00
95	0	0	00
96	0	0	00
97	0	0	00
98	0	0	00
99	0	0	00
100	0	0	00

Surface Content is 45 1 25  
 Deduct for Marshes 0 3 28  
 Do Road 1 3 29  
 Added 1 3 28  
 Subtotal Surface Cont 45 3 5

Scale of 2 Chains to an Inch

BALLABEE

E. FORBES Esq

not near  
B.

PLAN  
and  
Survey  
PART OF BROUGH JAIRG  
QUARTERLAND VINTAGE  
The Property of  
MR THOS CORLETT  
BY DAN. CRAIGEN MARCH 1840

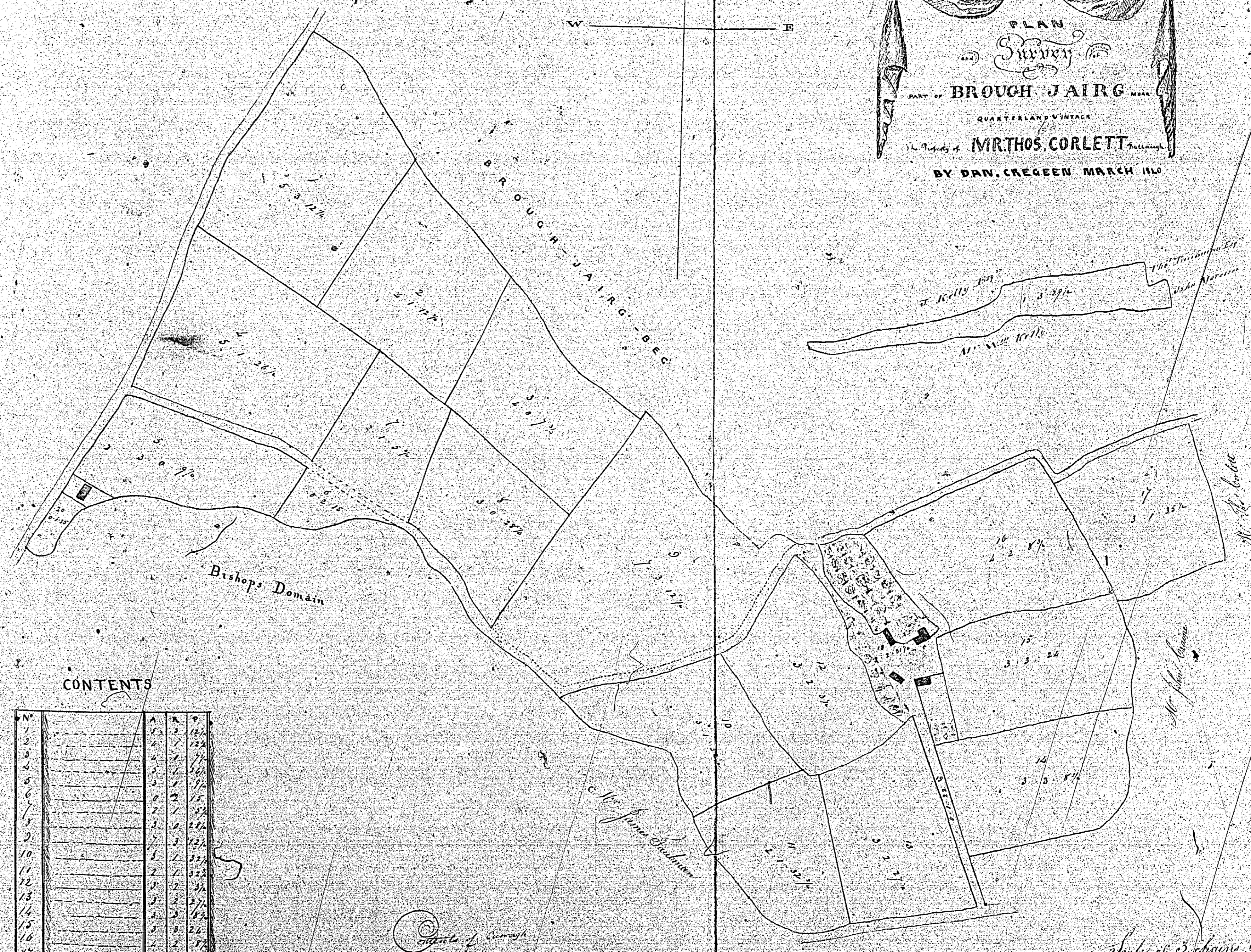

CONTENTS

No.	Acres	Roods	Poles
1	12	1	12
2	12	1	12
3	12	1	12
4	12	1	12
5	12	1	12
6	12	1	12
7	12	1	12
8	12	1	12
9	12	1	12
10	12	1	12
11	12	1	12
12	12	1	12
13	12	1	12
14	12	1	12
15	12	1	12
16	12	1	12
17	12	1	12
18	12	1	12
19	12	1	12
20	12	1	12
21	12	1	12
22	12	1	12
23	12	1	12
24	12	1	12
25	12	1	12
26	12	1	12
27	12	1	12
28	12	1	12
29	12	1	12
30	12	1	12
31	12	1	12
32	12	1	12
33	12	1	12
34	12	1	12
35	12	1	12
36	12	1	12
37	12	1	12
38	12	1	12
39	12	1	12
40	12	1	12
41	12	1	12
42	12	1	12
43	12	1	12
44	12	1	12
45	12	1	12
46	12	1	12
47	12	1	12
48	12	1	12
49	12	1	12
50	12	1	12
51	12	1	12
52	12	1	12
53	12	1	12
54	12	1	12
55	12	1	12
56	12	1	12
57	12	1	12
58	12	1	12
59	12	1	12
60	12	1	12
61	12	1	12
62	12	1	12
63	12	1	12
64	12	1	12
65	12	1	12
66	12	1	12
67	12	1	12
68	12	1	12
69	12	1	12
70	12	1	12
71	12	1	12
72	12	1	12
73	12	1	12
74	12	1	12
75	12	1	12
76	12	1	12
77	12	1	12
78	12	1	12
79	12	1	12
80	12	1	12
81	12	1	12
82	12	1	12
83	12	1	12
84	12	1	12
85	12	1	12
86	12	1	12
87	12	1	12
88	12	1	12
89	12	1	12
90	12	1	12
91	12	1	12
92	12	1	12
93	12	1	12
94	12	1	12
95	12	1	12
96	12	1	12
97	12	1	12
98	12	1	12
99	12	1	12
100	12	1	12

Scale of Survey  
1 inch = 100 feet

Scale of 8 chains to an inch

44

Mrs Stephens & this Curragh

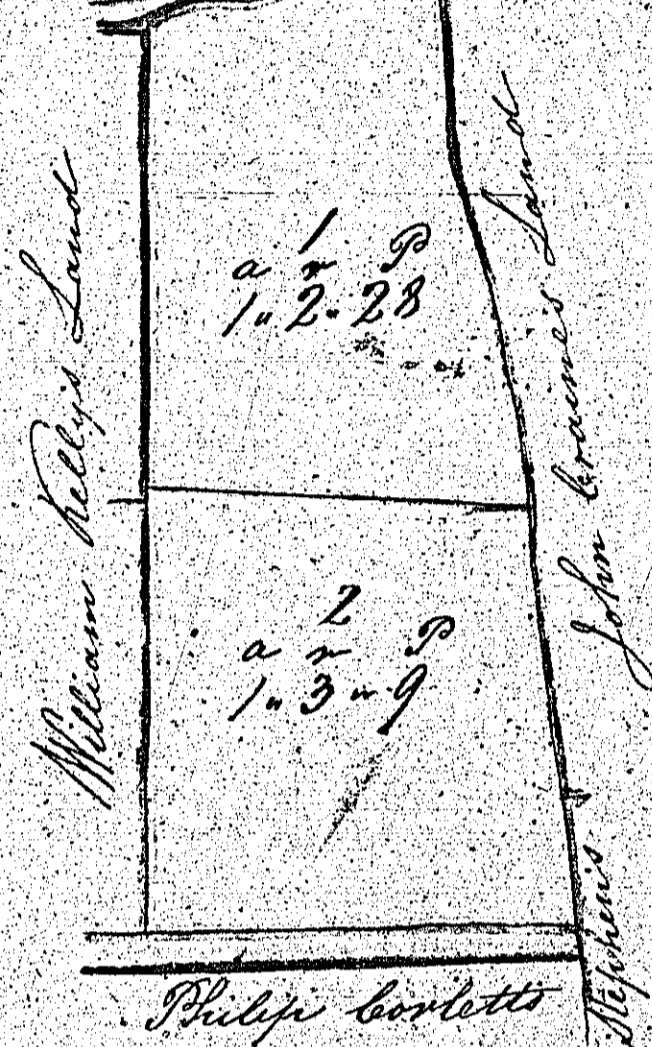

Contents

	A	R	P
	1	2	28
	1	3	9
	1	1	9
	2	0	11
	0	3	7
Ballalison		1	8
		1	21
		2	0
W. Kelly's		1	12
Total	4	3	18

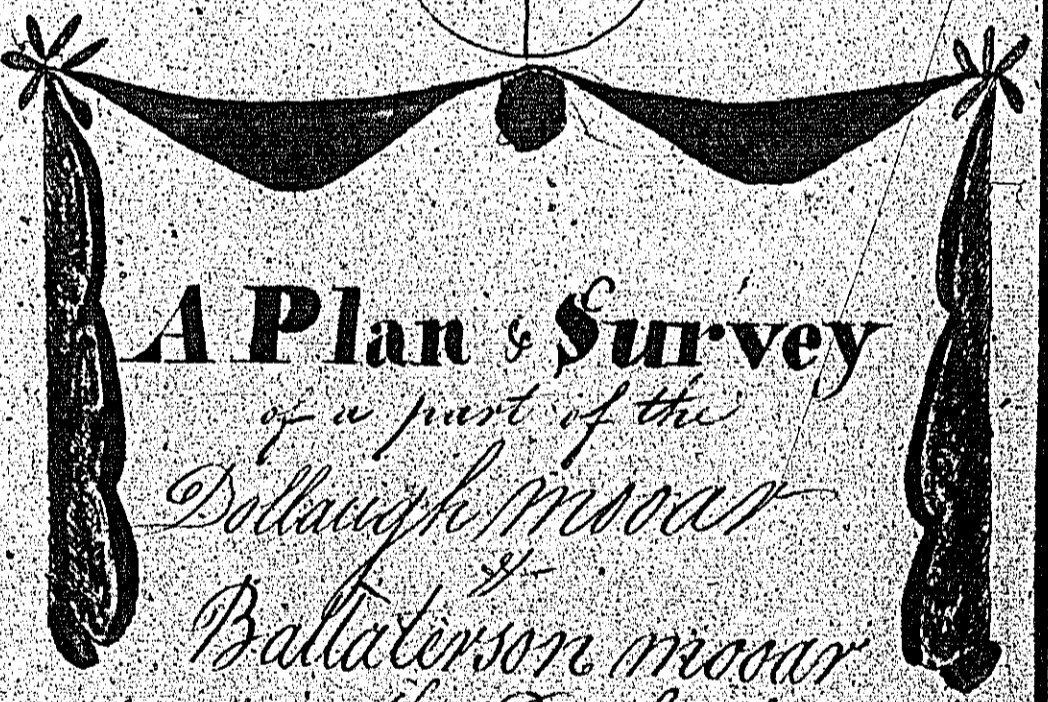
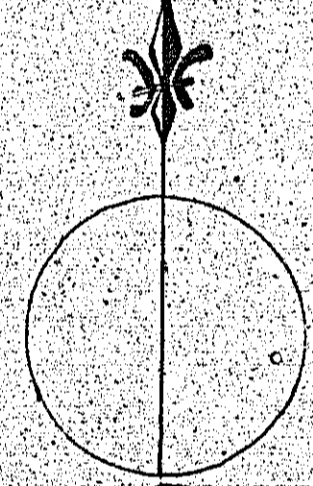
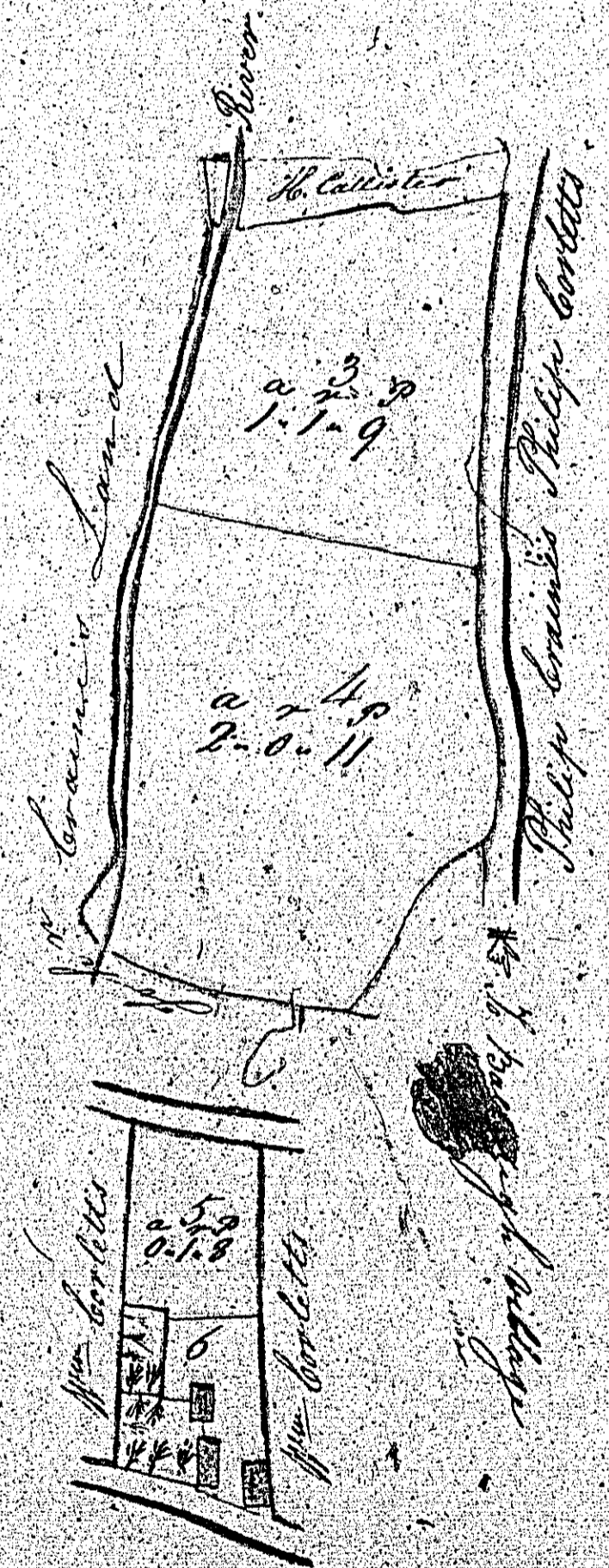

**A Plan & Survey**  
of a part of the  
Dollough Moor  
of  
Ballalison Moor  
in the Parish of  
**BALLAUGH**  
belonging to  
**M<sup>r</sup> W. Corlett**

Scale of Chains

By John Currier 1830

Map Survey  
OF  
BALLATERSON MOOR

the property of  
William Coyle

Situate in the

PARISH BALLAUGH

taken July 5<sup>th</sup> 1874

By Samuel Cox  
Surveyor

45

Number	Area
1	1/2
2	1/2
3	1/2
4	1/2
5	1/2
6	1/2
7	1/2
8	1/2
9	1/2
10	1/2
11	1/2
12	1/2
13	1/2
14	1/2
15	1/2
16	1/2
17	1/2
18	1/2
19	1/2
20	1/2
21	1/2
22	1/2
23	1/2
24	1/2
25	1/2
26	1/2
27	1/2
28	1/2
29	1/2
30	1/2
31	1/2
32	1/2
33	1/2
34	1/2
35	1/2
36	1/2
37	1/2
38	1/2
39	1/2
40	1/2
41	1/2
42	1/2
43	1/2
44	1/2
45	1/2

North of the  
road in 5.5.0.1

James Coyle's land  
marked

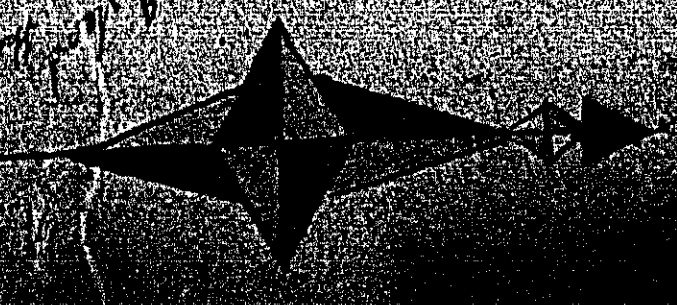
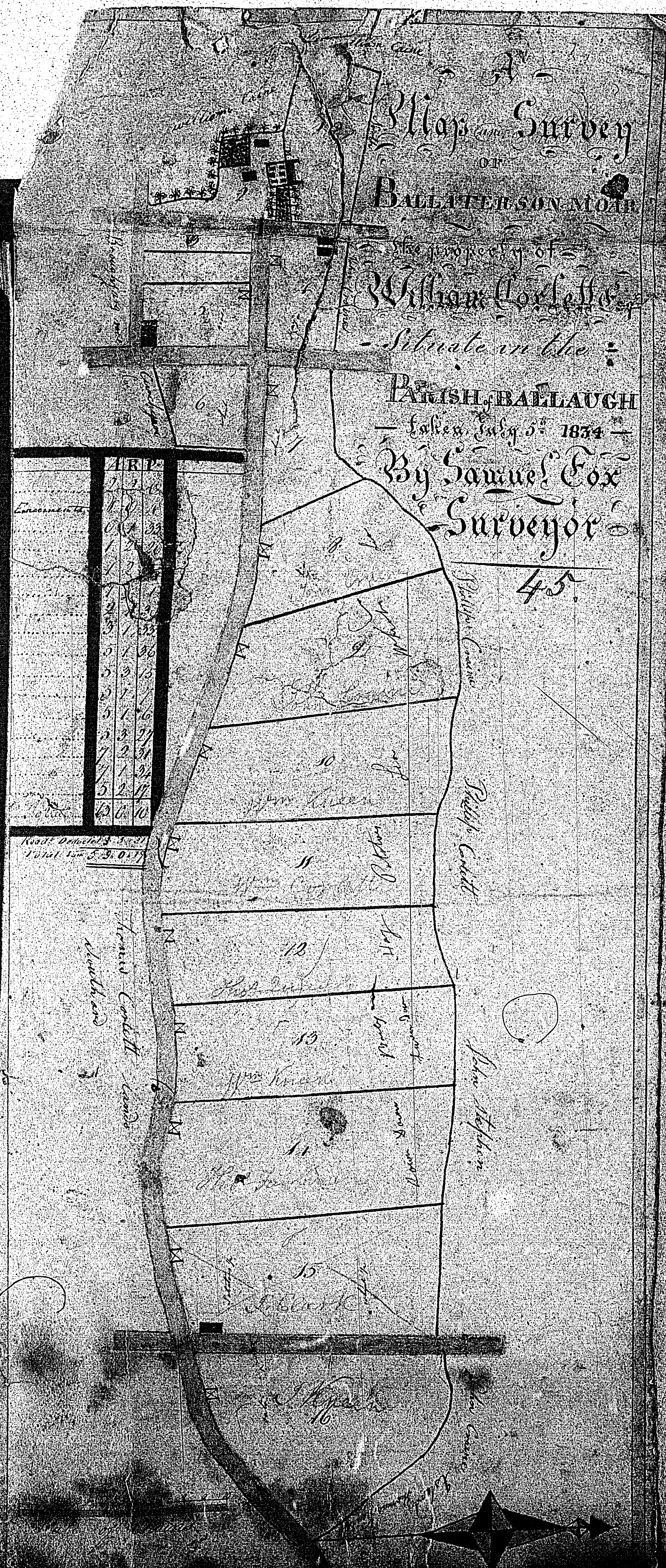

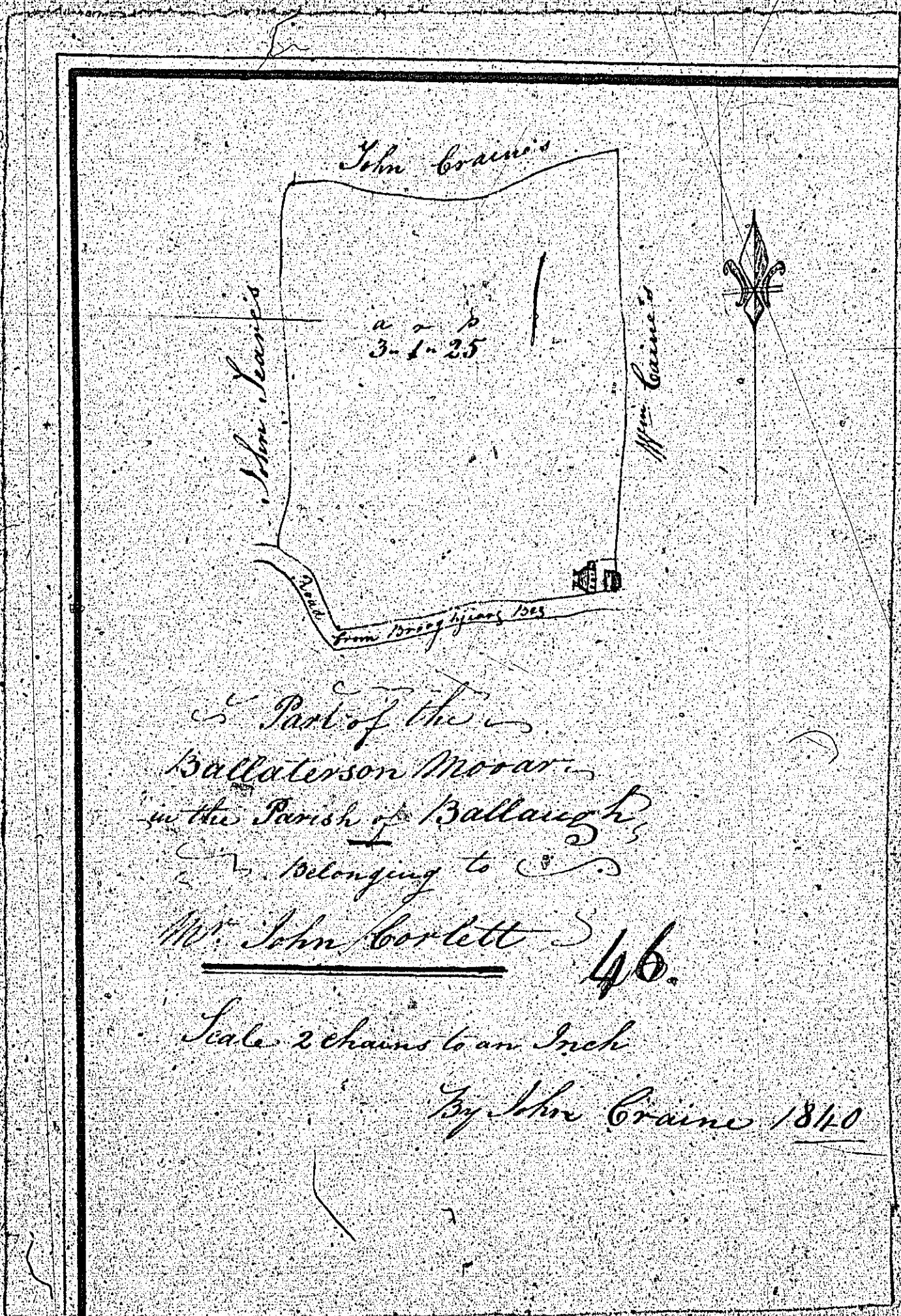

Part of the  
Ballateron Morar  
in the Parish of Ballaugh,  
belonging to  
Mr. John Corlett 46.

Scale 2 chains to an Inch

By John Craine 1840

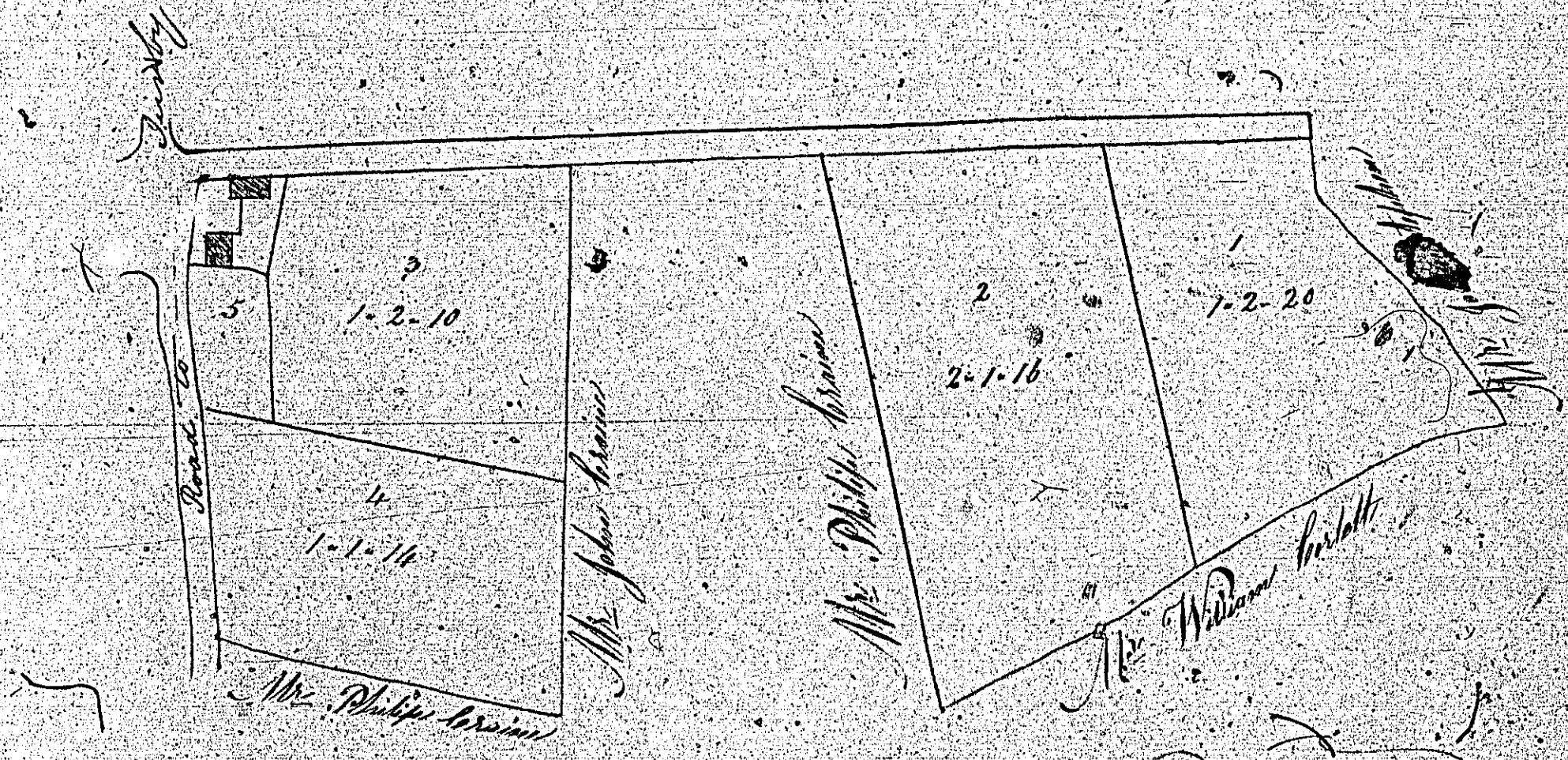

Contents	
No	ARE
1	1 2 20
2	2 1 16
3	1 2 10
4	1 1 16
5	1 1 16
Total	7 0 4
Road	50

PLAN & SURVEY  
 of a Part of the  
**DOLLAUGH-MOAR**  
 in the Parish of  
**BALLAUGH**  
 Belonging to  
**M<sup>r</sup> PHILIP CORLETT**

Scale 2 chains to the Inch

Copied by John Corlett  
 from a Plan by John Seave  
 Dated 1815