

135
134

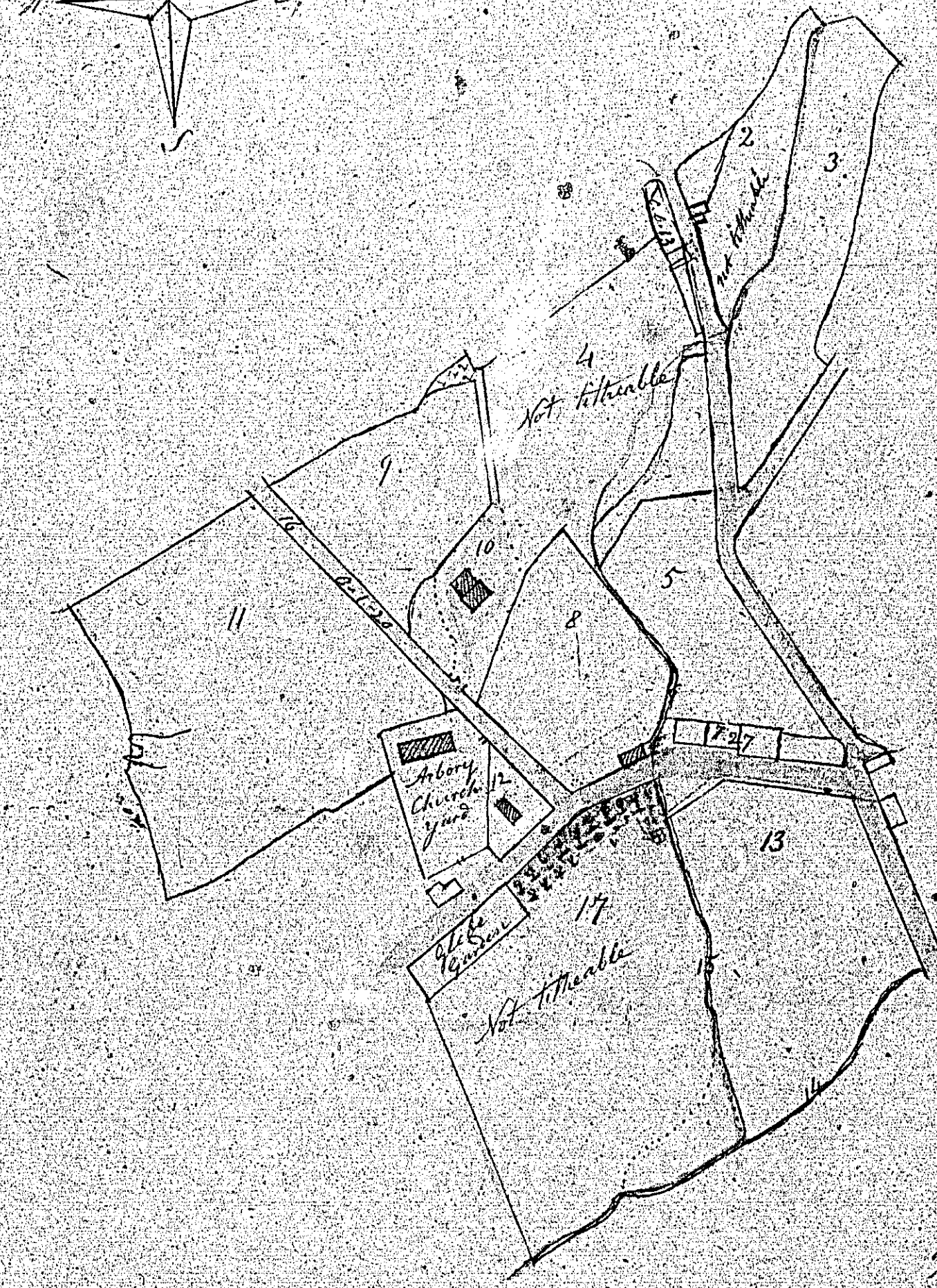

No.	Description	A. C. P.
1	Glen Garden	0. 6. 13
2	W. House & Clo.	3. 25
3	Rea Alley	1. 3. 1
4	Green Field	2. 3. 16
5	Crook	1. 1. 4
6	Thorn in D.	.16
7	R. Co. Road	27
8	Garden & Pottage	2. 23
9	Field about House	1. 30
10	Manor House	2. 16
11	Church Yard	4. 0. 11
12	Office & Yard	0. 32
13	South Field	3. 0. 24
14	South Stream	10
15	West D.	1
16	Road	1. 20
17	Arable	4. 9. 25
		22. 3. 25

By a scale of three chains to the inch

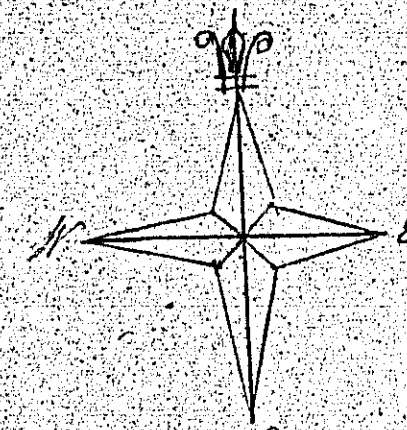
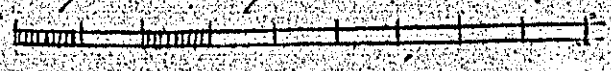

Barville in the parish
of Abney the property
of Geo. Duck Esq.
Surveyed by M. J. Lewis
in the year 1800 but some
alterations being made since
in the fences parts thereof
were surveyed again in
1839 by A. Cresson

Wanted 136

There is no plan
numbered 136

ISLE OF MAN GOVERNMENT: GENERAL REGISTRY

TITHE PLANS: PARISH OF ARBORY

- 137 Original monotone 1.30
- 138 Original coloured (decorative), marked

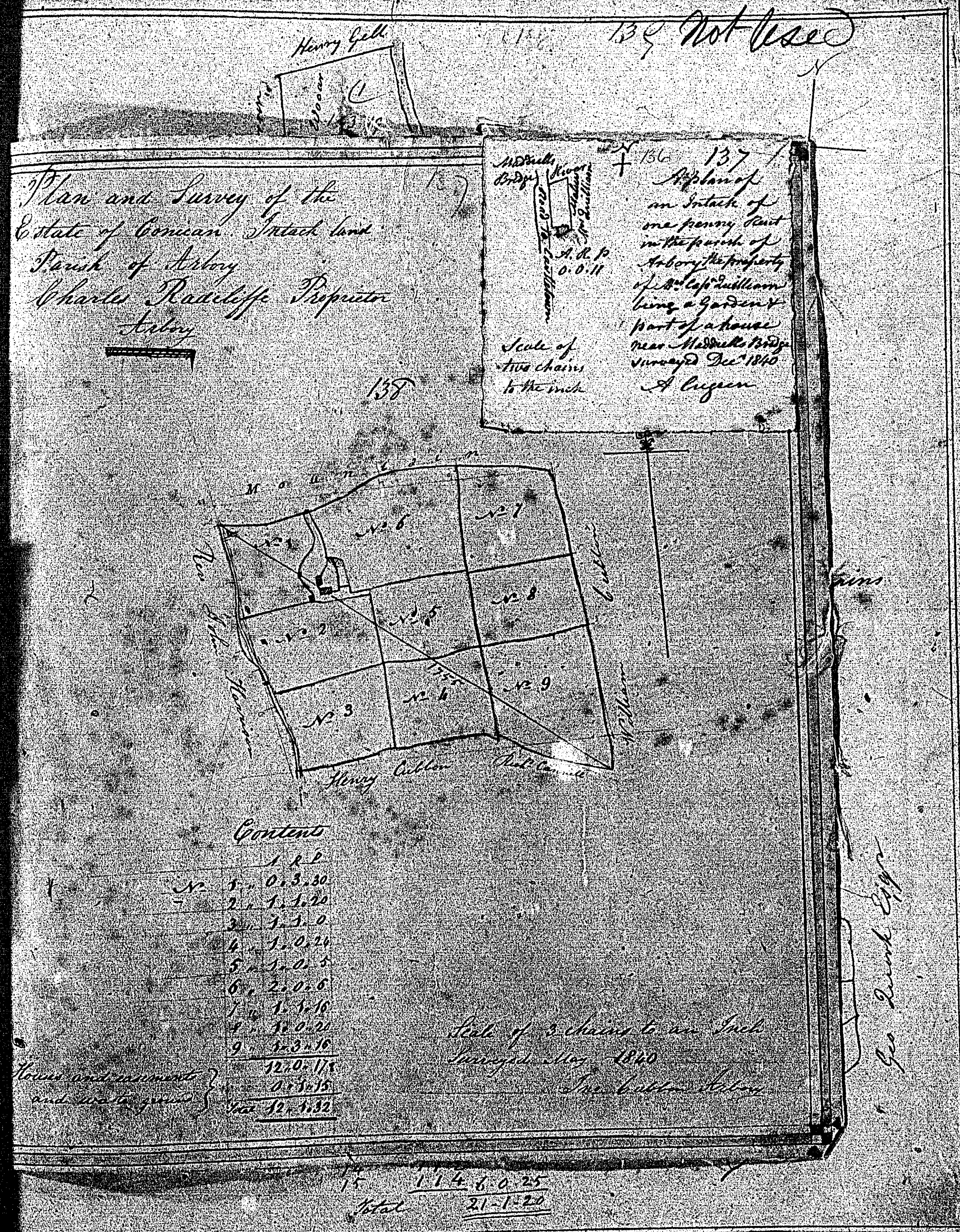

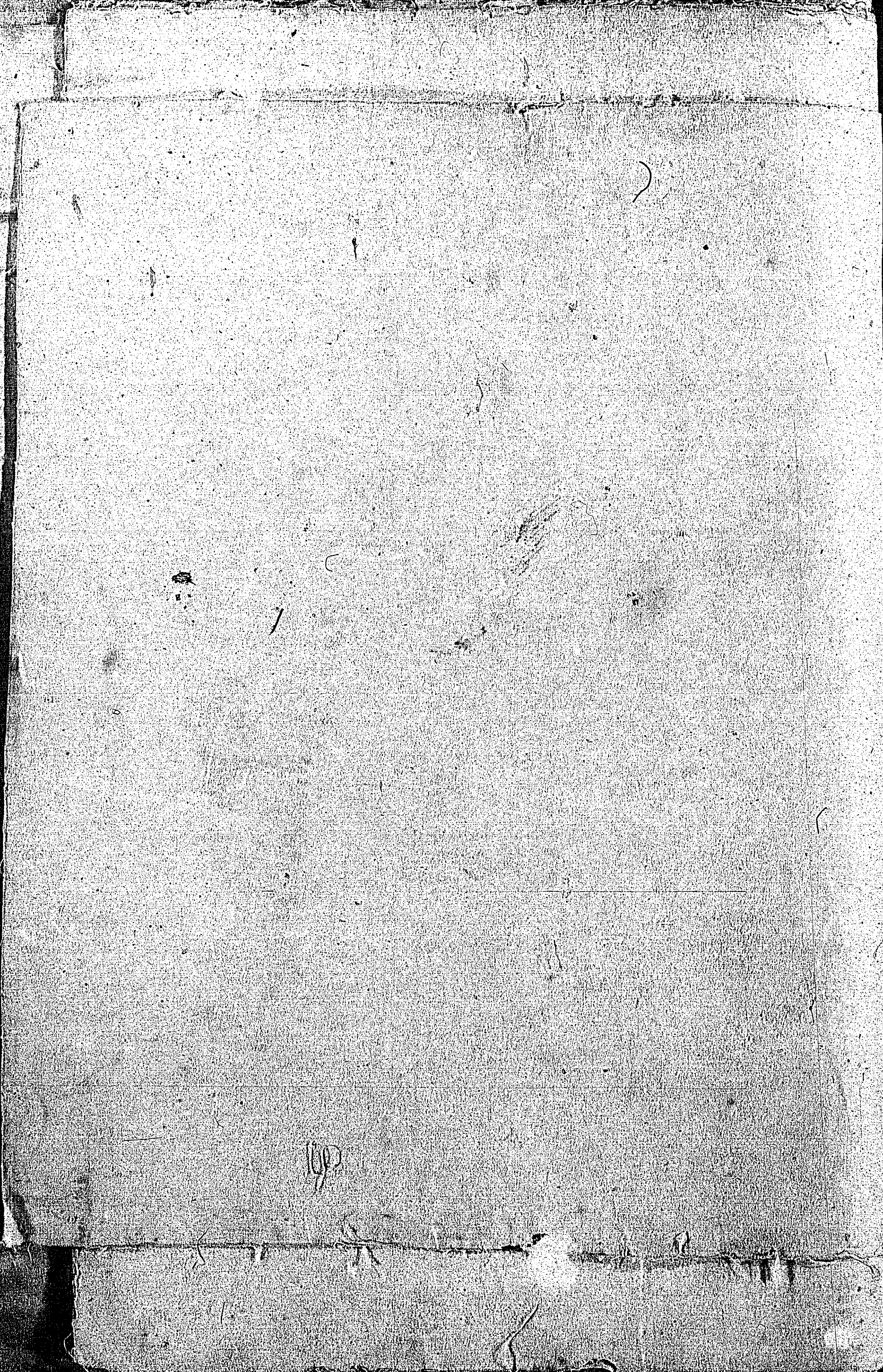

Contents

1	1
2	2
3	3
4	4
5	5
6	6
7	7
8	8
9	9
10	10
11	11
12	12
13	13
14	14
15	15
16	16
17	17
18	18
19	19
20	20
21	21
22	22
23	23
24	24
25	25
26	26
27	27
28	28
29	29
30	30
31	31
32	32
33	33
34	34
35	35
36	36
37	37
38	38
39	39
40	40
41	41
42	42
43	43
44	44
45	45
46	46
47	47
48	48
49	49
50	50
51	51
52	52
53	53
54	54
55	55
56	56
57	57
58	58
59	59
60	60
61	61
62	62
63	63
64	64
65	65
66	66
67	67
68	68
69	69
70	70
71	71
72	72
73	73
74	74
75	75
76	76
77	77
78	78
79	79
80	80
81	81
82	82
83	83
84	84
85	85
86	86
87	87
88	88
89	89
90	90
91	91
92	92
93	93
94	94
95	95
96	96
97	97
98	98
99	99
100	100

Antiquary

Slam

of the
Estate of Ballacaron

in the
Parish of Achery

in the property of
Mr John Shannon
May 15th 1841

141

140

Henry Kelly



142

Reference to the
original map
of the
Ballacaron