

ISLE OF MAN GOVERNMENT: GENERAL REGISTRY

TITHE PLANS: PARISH OF ARBORY

- 1.30
 117 Original coloured (decorative), marked
 118 Original coloured (decorative), marked, faint

119 118
 A Plan and Survey of part
 of Belle Combe and a piece of Black
 Land in the parish of Arbory the
 property of Mr Robert Moore
 By Daniel Kelly Nov 15th 1842

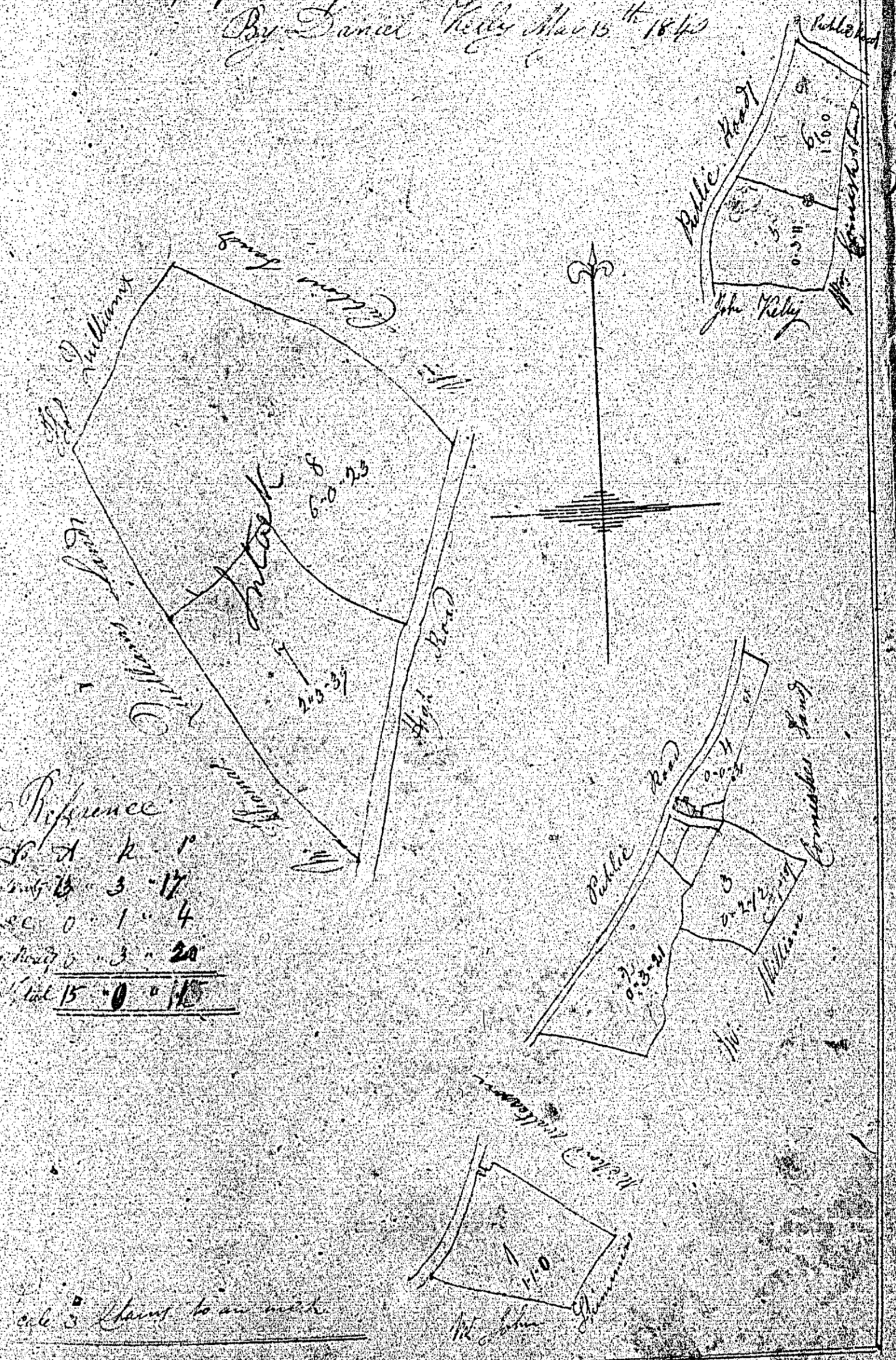

Plan and Survey of Land
 Part of Belle Combe and a piece
 of Black Land the property
 of Mr Robert Moore taken
 by Daniel Kelly on the 15th day of Nov and
 the year 1842

Reference

1	2	1
1	3	17
1	1	4
1	3	20
1	15	0
<hr/>		
1	47	2

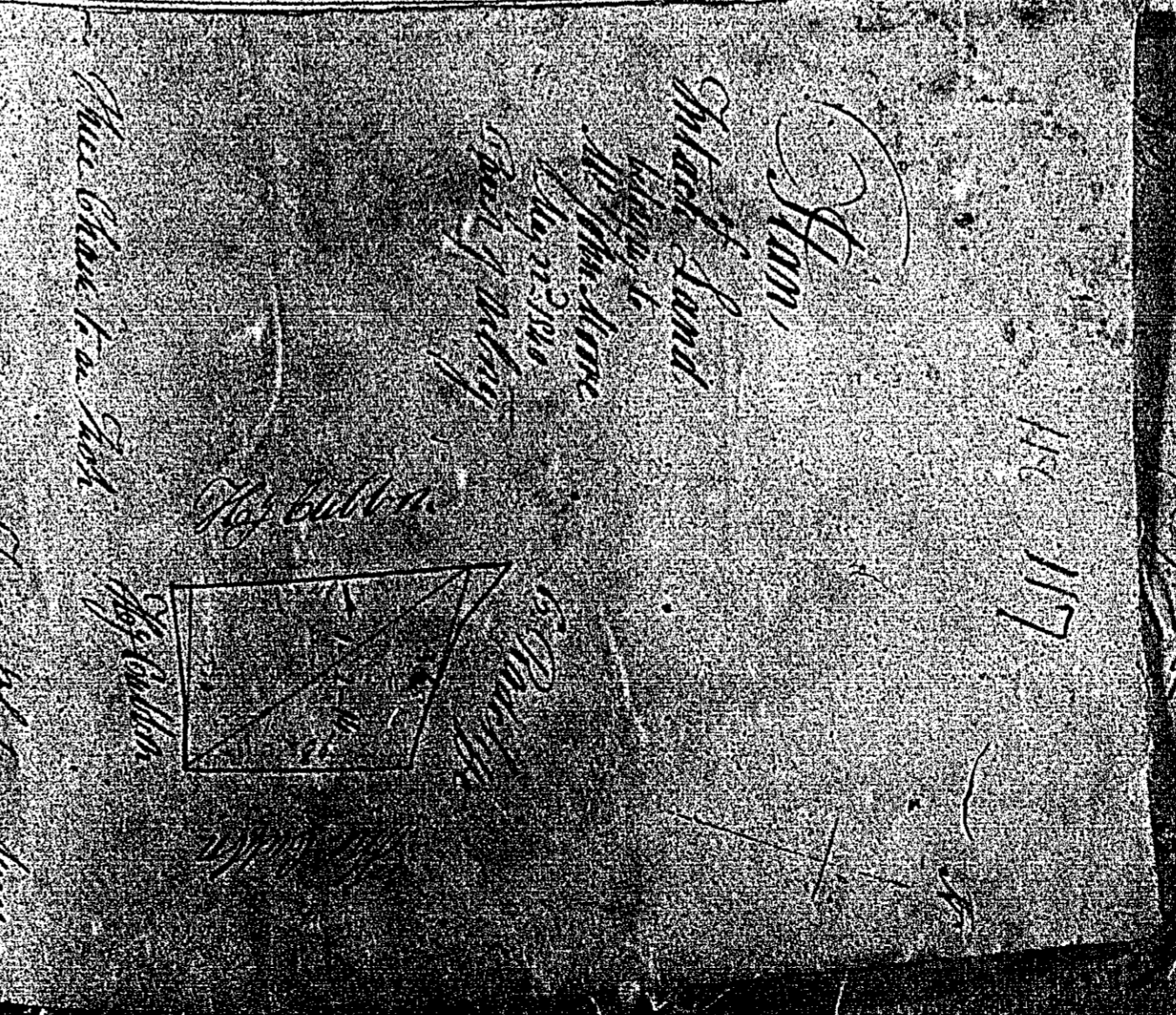

JOHN SHIPTON
 POWER & CO. SOLE AGENTS
 7

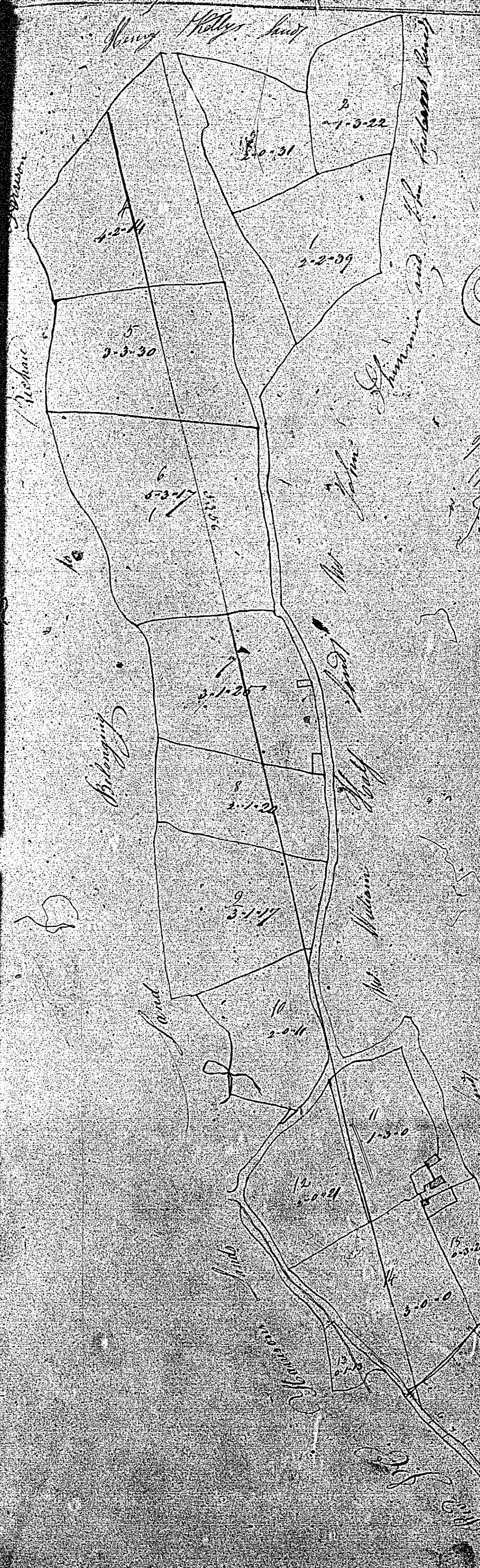

A Plan and Survey of Lands
 being the Plantation of Bull's Head
 and the Parsonage of Collyer the property
 of Mr. John Moore taken by David
 Miller of New York on the 15th day of May and
 in the year 1710

Reference
 No. 1
 Bull's Head 1710
 Parsonage 1710
 Bull's Head 1710
 Parsonage 1710
 Bull's Head 1710

John Moore to his heirs

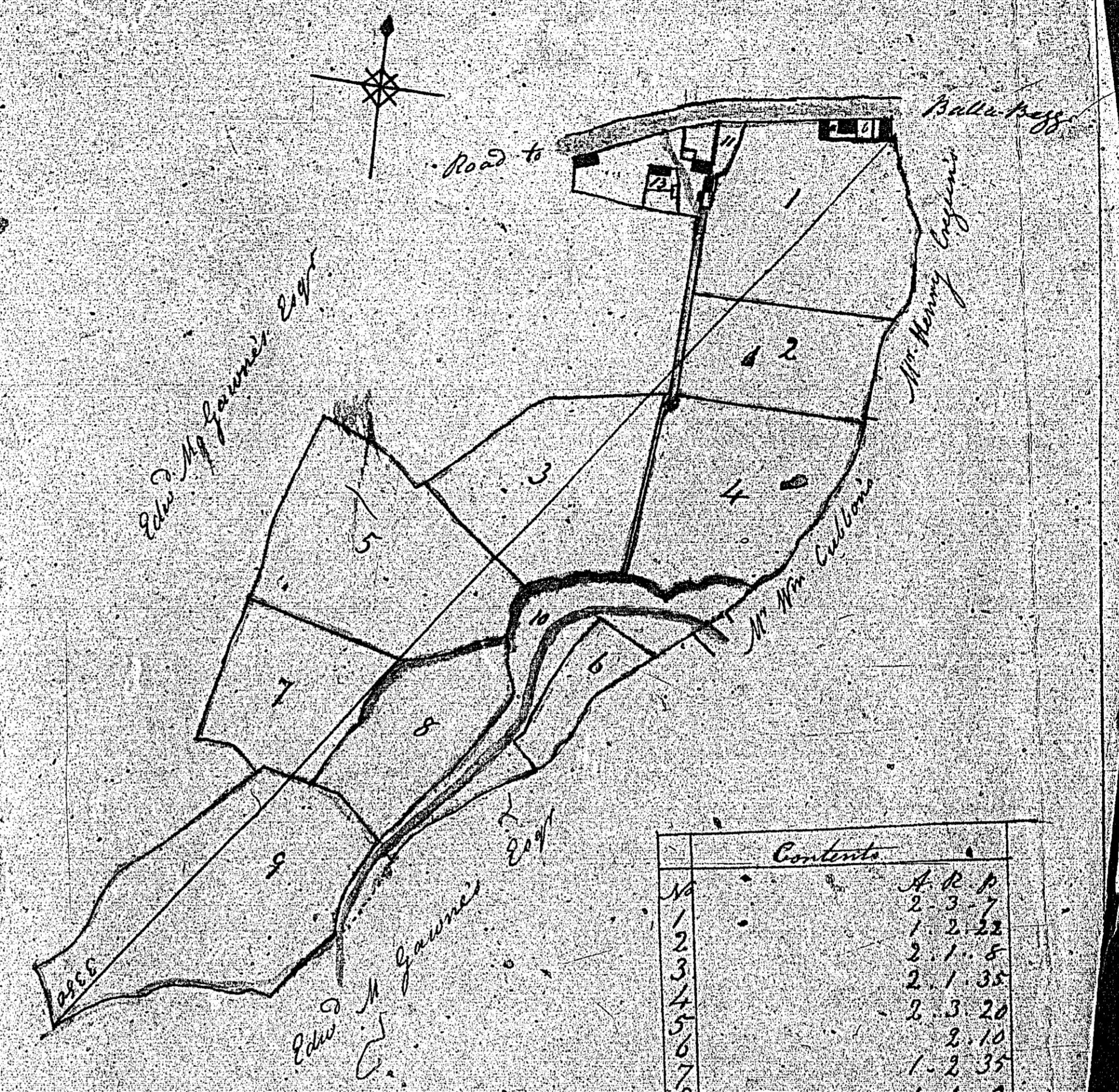

Clagh-Vane
 In the parish of Ashbury
 The property of
 M^r. John's Tho^s Moore
 Surveyed this 24th of April
 1840 by A. Cogan

Contents		
1	A. R. P.	
2	3	7
1	2	23
2	1	5
2	1	35
2	3	20
2	10	
1	2	35
1	1	0
3	3	11
10	Clagh-Vane	2 0 15
11	Garden	15
12	Half of Passy Stack yard	30
13	Stack yard Barth	12
14	Road on farm	36
	Total	<u>22 0 16</u>

Scale 3 Chains to an inch
 a M^r. John Kiffe Honey
 and Garden = 2 0 10 1/4
 b M^r. Rich^d. Honey 3 0 0 10 1/2
 2 0 21

There is no plan
numbered 121

ISLE OF MAN GOVERNMENT: GENERAL REGISTRY

TITHE PLANS: PARISH OF ARBORY

- 122 Original coloured 1.30
- 123 Original monotone, marked
- 124 Original monotone, marked
- 125 No plan for this number
- 126 Original coloured (decorative), marked, faint
- 127 Original monotone, marked

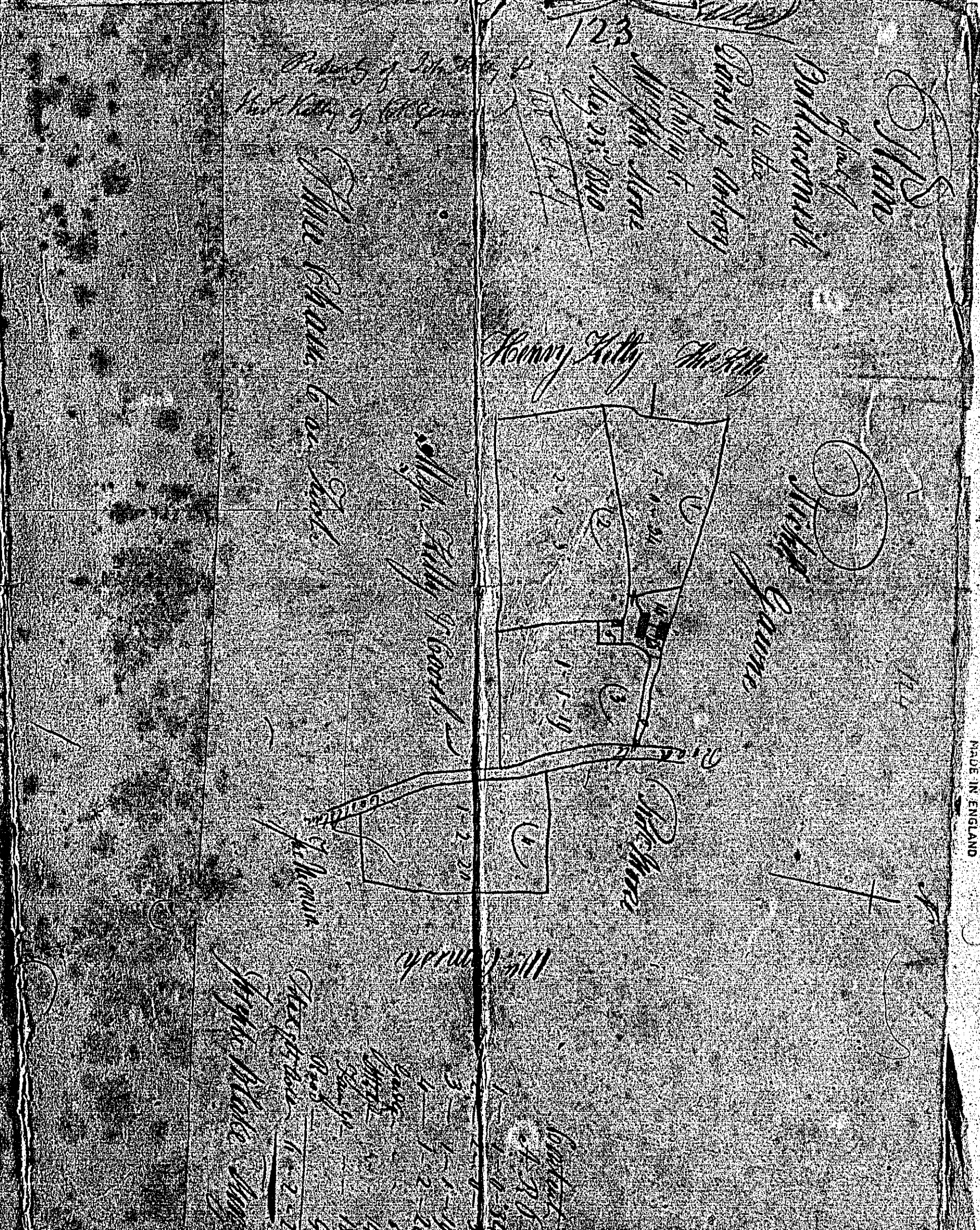
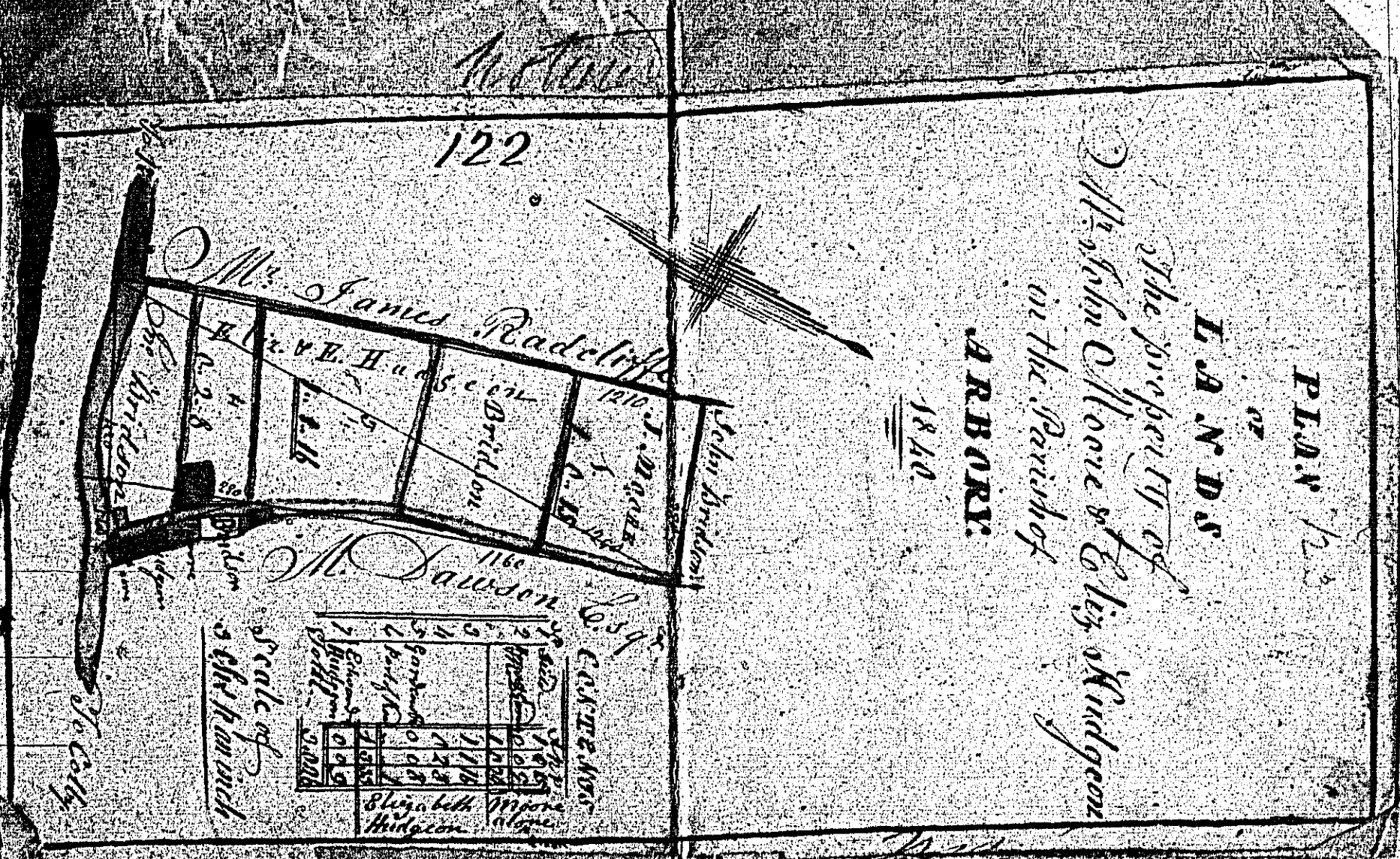

Scale in feet: 0, 10, 20, 30, 40, 50, 60, 70, 80, 90, 100, 110, 120, 130, 140, 150, 160, 170, 180, 190, 200, 210, 220, 230, 240, 250, 260, 270, 280, 290, 300

128 Not used

PLAN
of
A part of the Quarterland
of Crot & Killey and other Lands
lying in the Parishes of
Arbery & Rushen
Surveyed by J. Parris
The Property of
Mr. William Quilbrough

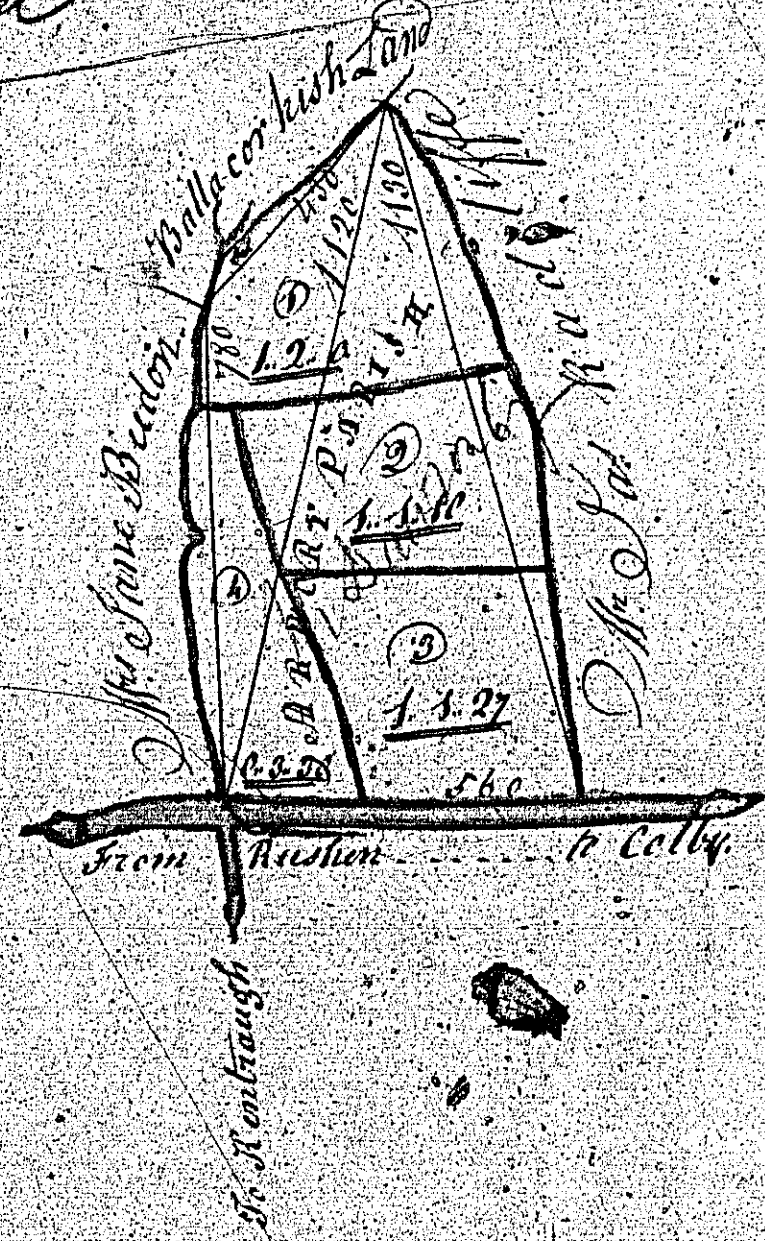

Contents

Arbery Parish	A	R	P
1 Upper field	1	2	0
2 Middle field	1	1	11
3 Lower field	1	1	27
4 Arbery field	0	0	27
Arbery total	3	4	65
1 Arbery field	2	2	0
2 Arbery field	1	2	16
Arbery total	3	4	16
Arbery total	6	8	81

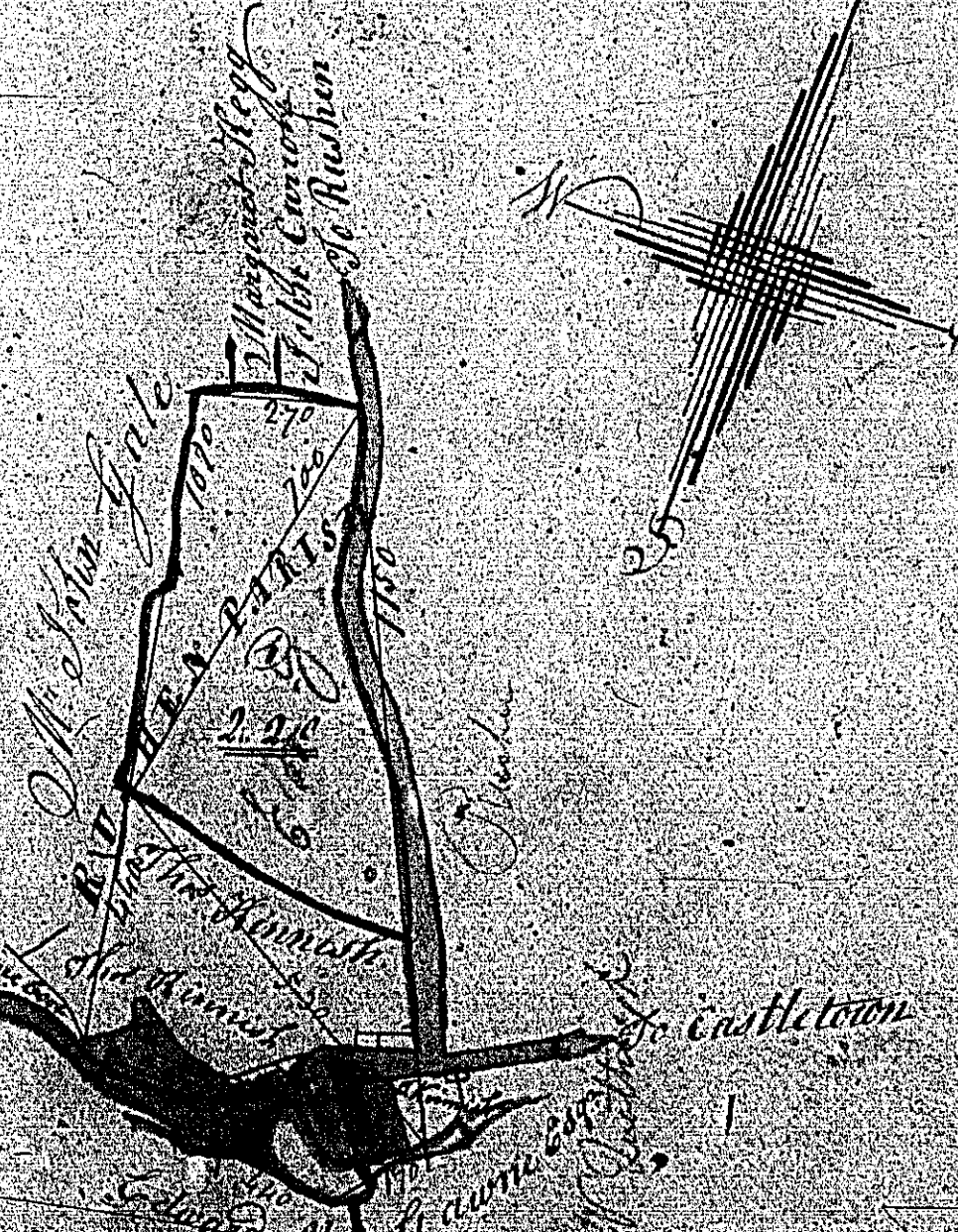

Scale of three Chains to an inch