

(faint handwritten text)

PREVIOUS IMAGE REPEATED

(faint handwritten text)

A
Plan & Survey
 of the Estate of
KIONDROGHAD
 In the parish of
ANDREAS
 the property of
JOHN M^cHUTCHIN ESQ^r

202

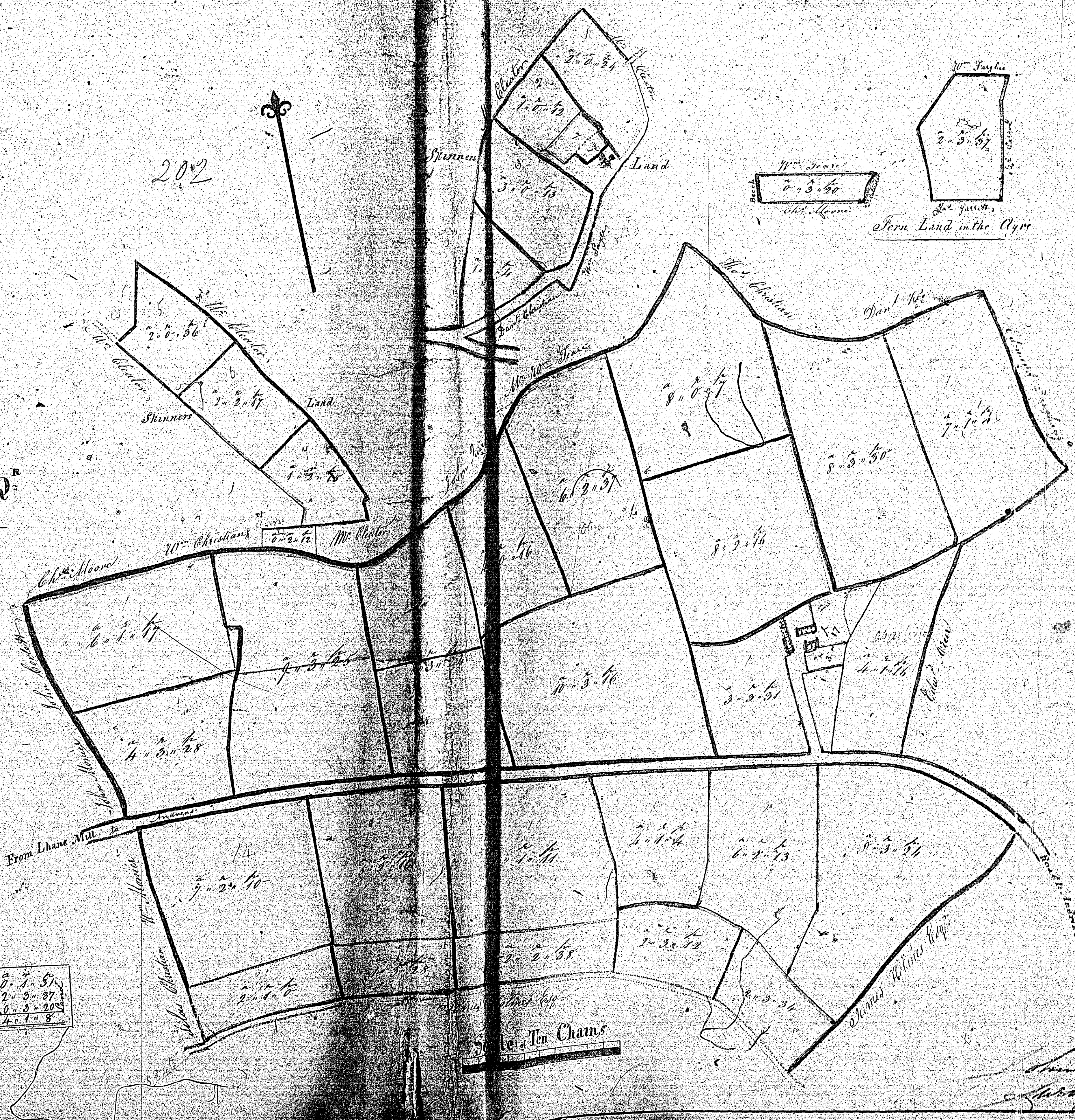

Acres	Parts	Furlongs
1	6	1
2	4	3
3	9	3
4	8	3
5	4	0
6	6	2
7	8	0
8	8	2
9	8	3
10	7	1
11	4	1
12	3	3
13	10	3
14	7	2
15	5	2
16	7	1
17	4	1
18	6	2
19	8	3
20	2	1
21	1	3
22	2	2
23	2	3
24	2	2
Contents 145 2 12		
Gardens 1 3 17		
Drains 0 2 2		
High Road 2 2 14		
Foss Land 4 1 8		
Kiondroghad 11 3 13		
Shannon Land 16 2 12		
Total 171 4 25		

Acres	Parts	Furlongs
1	2	7
2	1	0
3	3	0
4	1	3
5	2	0
6	2	2
7	1	0
8	0	2
9	15	0
10	16	2

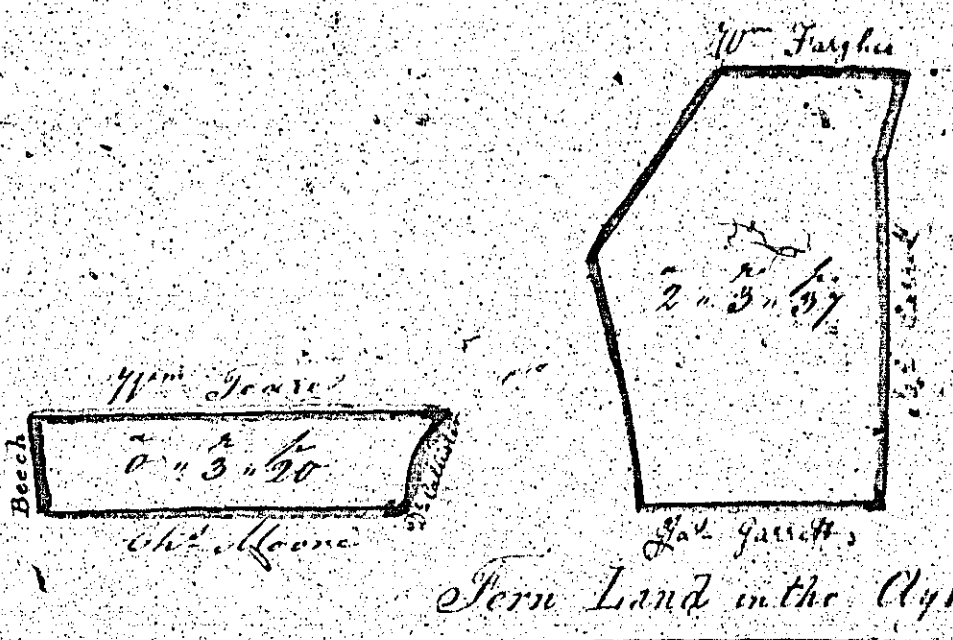

John Hutchin
Surveyor

PLAN
 of
 A CORRUGH
 of
 M^{rs} CESAR MOORE'S
 in the Parish of
 ANDREAS
 1839

203,
 203

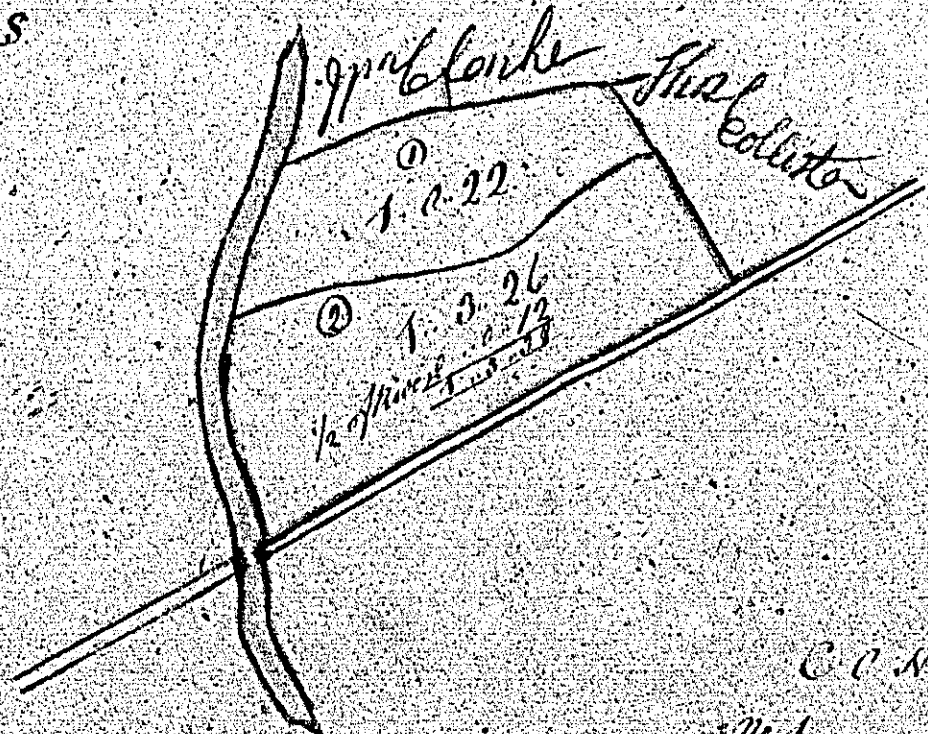

CONTRACTS

No. 1	1. 2. 22
2. (land)	1. 3. 26
to have	1. 2. 12
Total	3. 2. 20

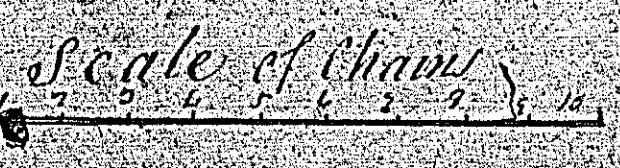

J. P. Moore
 Surveyor

ISLE OF MAN GOVERNMENT: GENERAL REGISTRY
 TITHE PLANS: PARISH OF ANDREAS
 Original coloured (decorative) 1:30

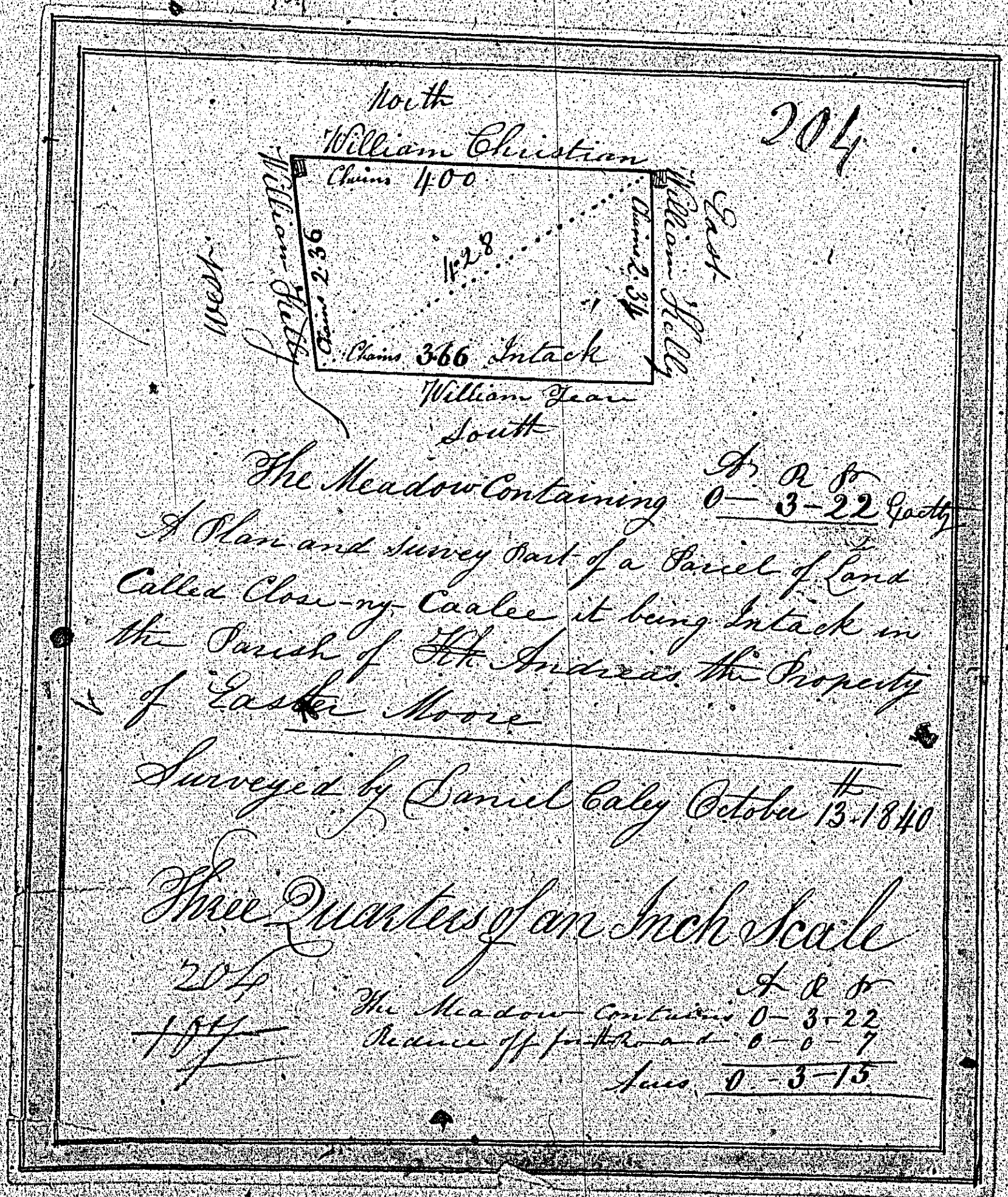

The Meadow containing $\frac{3}{4}$ of an Acre
 A Plan and Survey Part of a Parcel of Land
 Called Cloony Caulee it being Intack in
 the Parish of St. Andrew the Property
 of Easter Moore

Surveyed by Daniel Caley October 13. 1840

Three Quarters of an Inch Scale

204 The Meadow contains $\frac{3}{4}$ of an Acre
 Chain 400 North East
 Chain 366 South
 Chain 236 West
 Chain 234 East
 Chain 428 Diagonal
 June 0-3-15

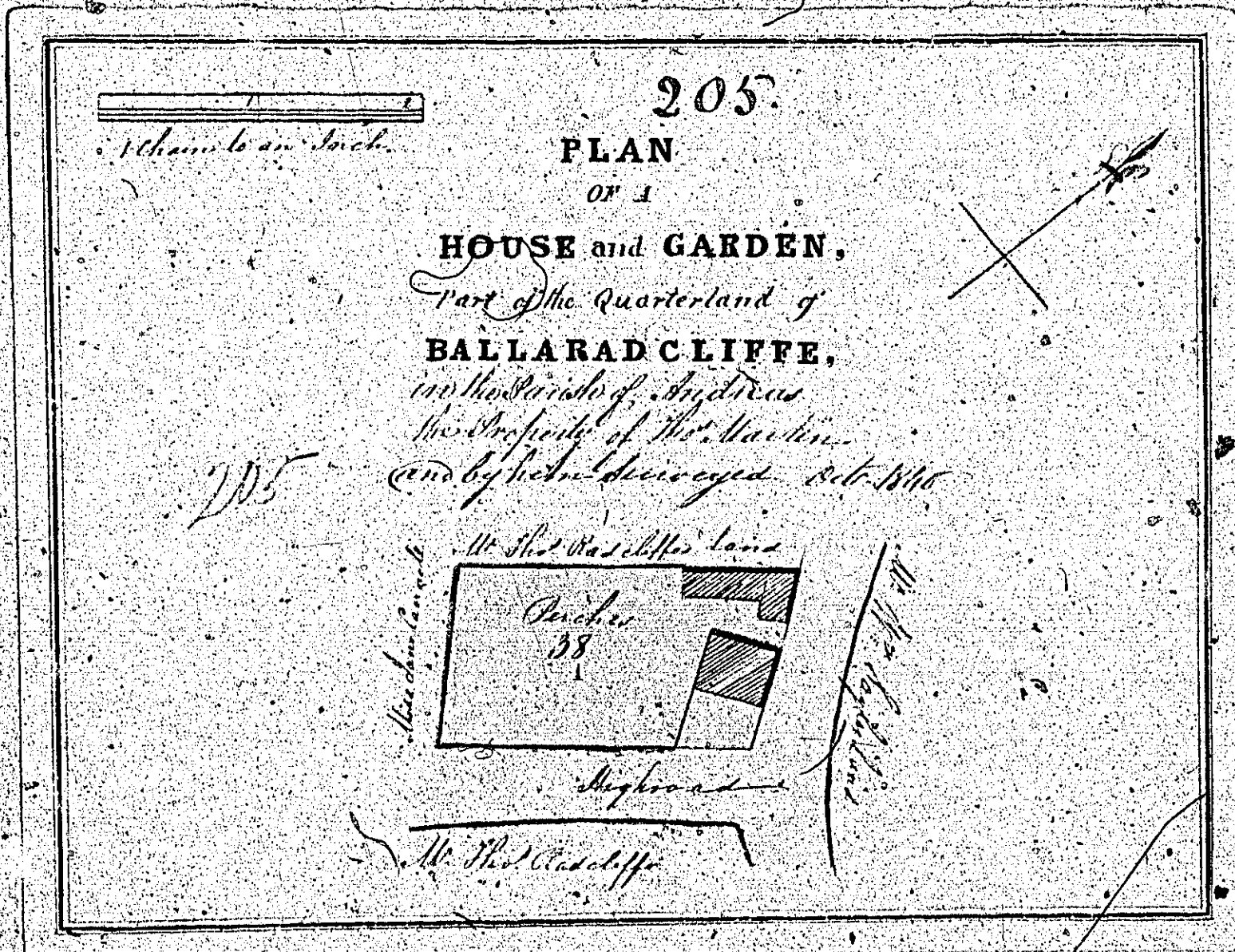

Handwritten notes in the right margin, including a vertical line of text and a small sketch of a rectangular plot with a diagonal line.



206

A Plan and Survey of a
part of the Quarterland of
the West Coast in the parish
of Andrews the property of
William Mitchell
taken May 1st 1859

By James Stewart

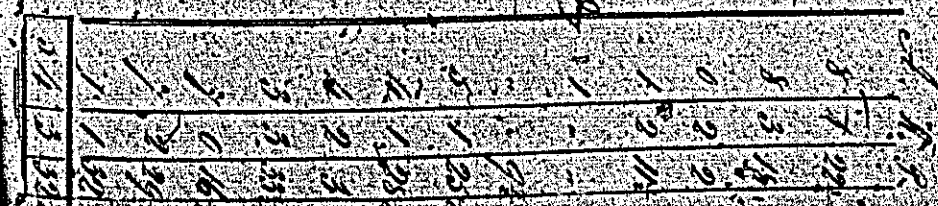

James Stewart