

BALLADEANDY and part of B-CORDY

Map and Survey of a
parcel of Land in the parish of
Andreas the property of Thomas Connolly
Surveyed by J. G. G. G.

146.

146

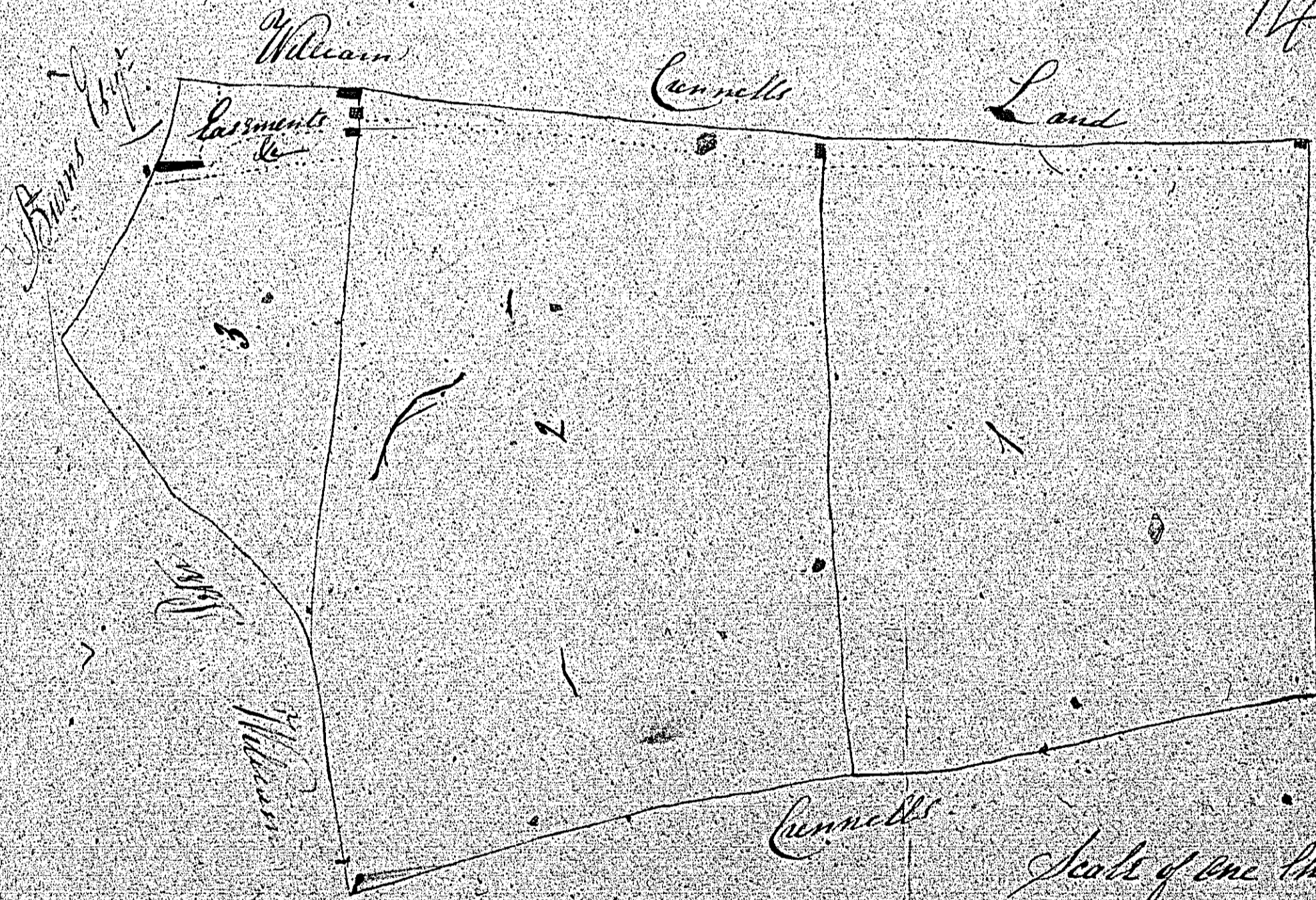

Contents	S.	R.	P.
No. 1	1	1	33
2	1	2	37
3	0	1	16
House	0	0	12
Road to the House	0	0	32
Total	3	3	10

Scale of one chain to an Inch

ISLE OF MAN GOVERNMENT: GENERAL REGISTRY

TITHE PLANS: PARISH OF ANDREAS

Original monochrome

1:30

147.
1. 1. 30
147.
A plan of a part
of Ballynane
called Croft & Kelly
in the parish of Ardara
the property of
John & Jane Keane
by Tho. Craun: July 1839
Scale of 2 chains to an inch. Total 15.3

BALLADBANDY and part of B. COREY

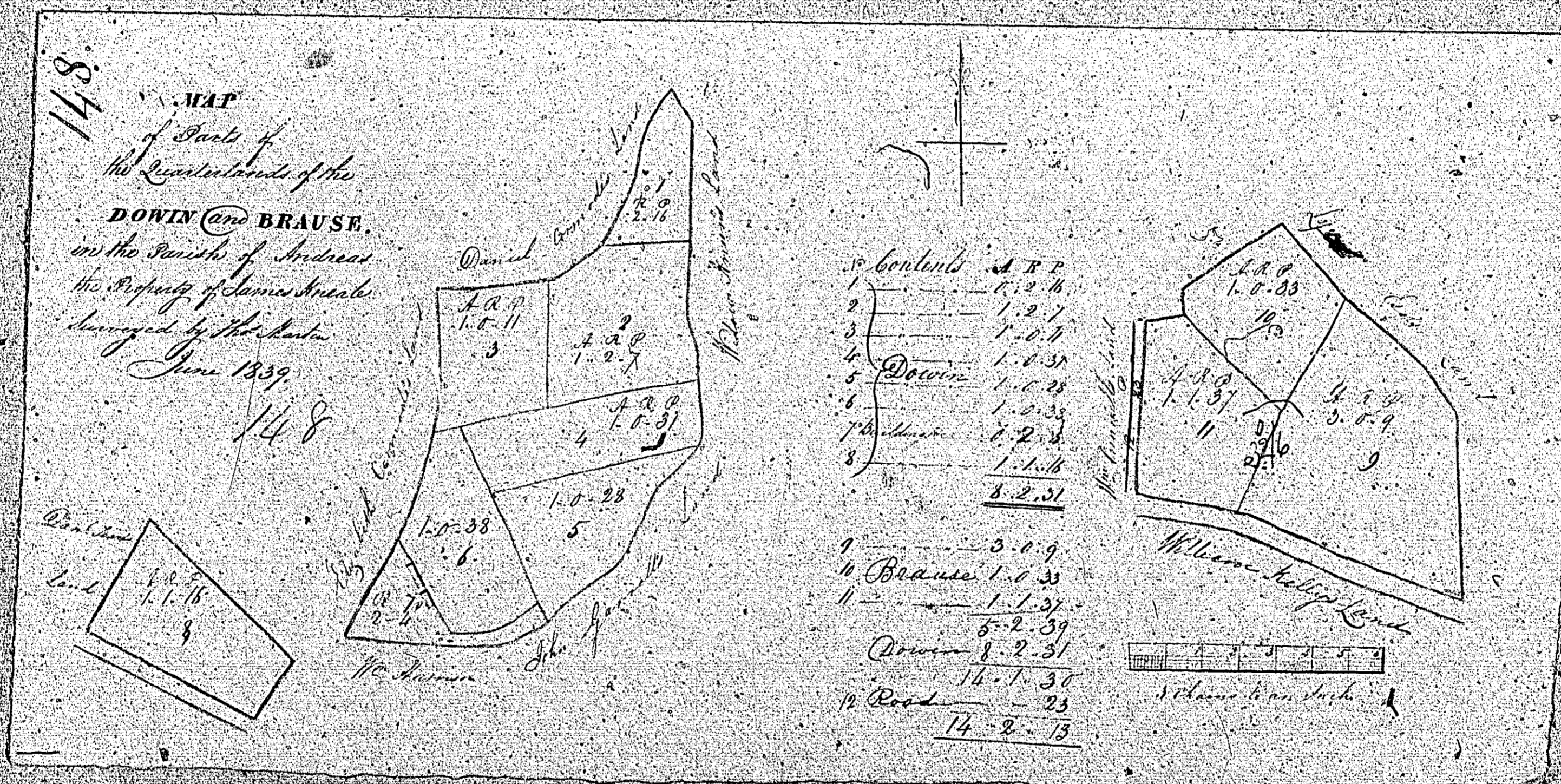

ISLE OF MAN GOVERNMENT: GENERAL REGISTRY

TITHE PLANS: PARISH OF ANDREAS

Original coloured (decorative)

1:30

