

ISLE OF MAN GOVERNMENT: GENERAL REGISTRY

ASYLUM PLANS: PARISH OF RUSHEN

Original monotone

1:23

(365)  
Copy  
Liaise. c. Dhoorey  
in Rushen  
Belonging to Jno Costain

April 1888.

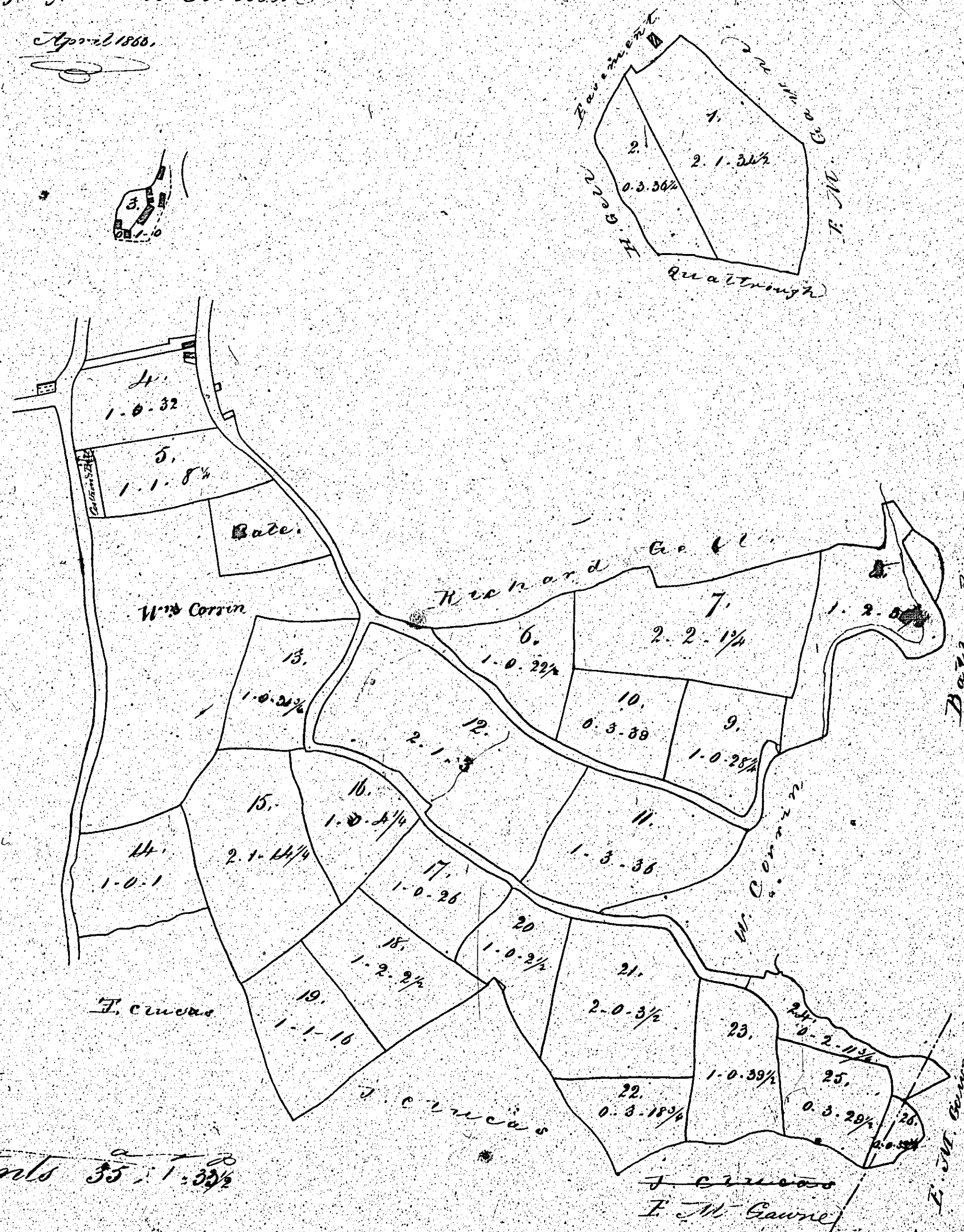

Contents 35 1-33 1/2

Calc. & Chains to an Inch

Copy from plans 181754  
Moray Currier



ISLE OF MAN GOVERNMENT: GENERAL REGISTRY

ASYLUM PLANS: PARISH OF RUSHEN

Originals monotone

1:23

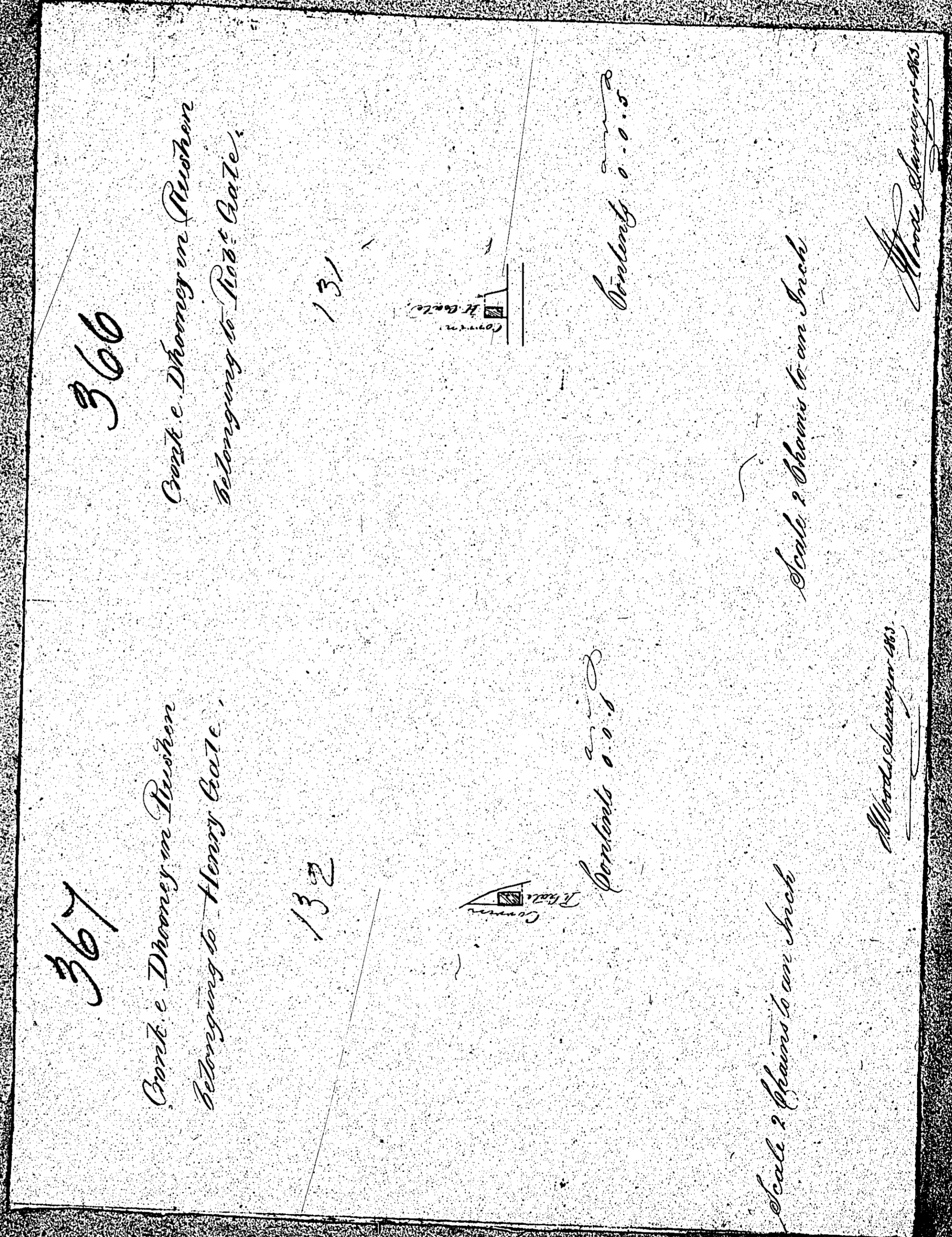



ISLE OF MAN GOVERNMENT: GENERAL REGISTRY

ASYLUM PLANS: PARISH OF RUSHEN

Original monotone

1:23

(368)

Cronk e Drooney in Parish  
Belonging to Mr Wm Gate

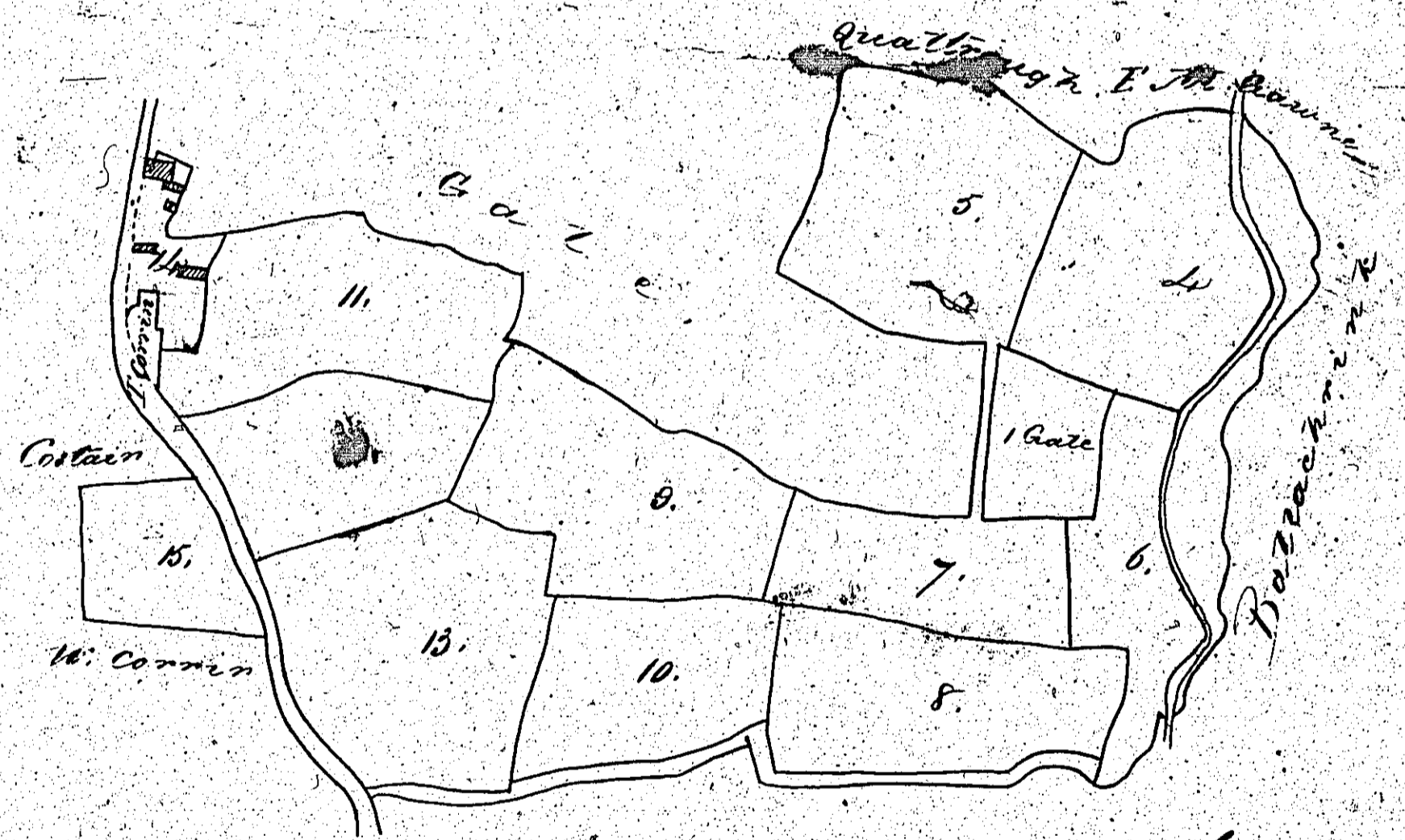
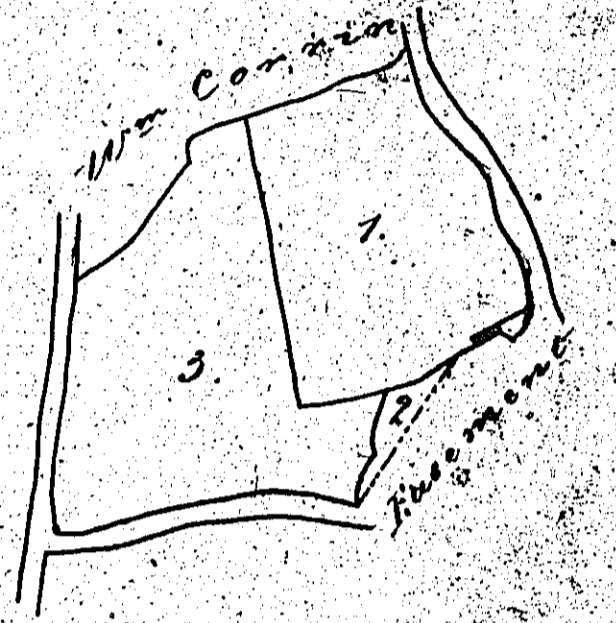

Scale 3 Chains to an Inch

Contents	
No	Area
1	1.2.5
2	0.0.11
3	1.3.15
4	1.3.18
5	2.1.2
6	1.3.13 1/2
7	1.1.16 1/2
8	1.2.33 1/2
9	1.0.25 1/2
10	1.0.23 1/2
11	1.3.14 1/2
12	1.1.15 1/2
13	2.1.9 1/2
14	0.1.16 1/2
15	1.0.30 1/2
Doors & Piers	0.2.29 1/2
<b>Total</b>	<b>23.0.32 1/2</b>

Drawn from Plan 78 by  
Woods Surveyor 1863



ISLE OF MAN GOVERNMENT: GENERAL REGISTRY

ASYLUM PLANS: PARISH OF RUSHEN

1:23

- 369 Original coloured (decorative)
- 370 Original monotone

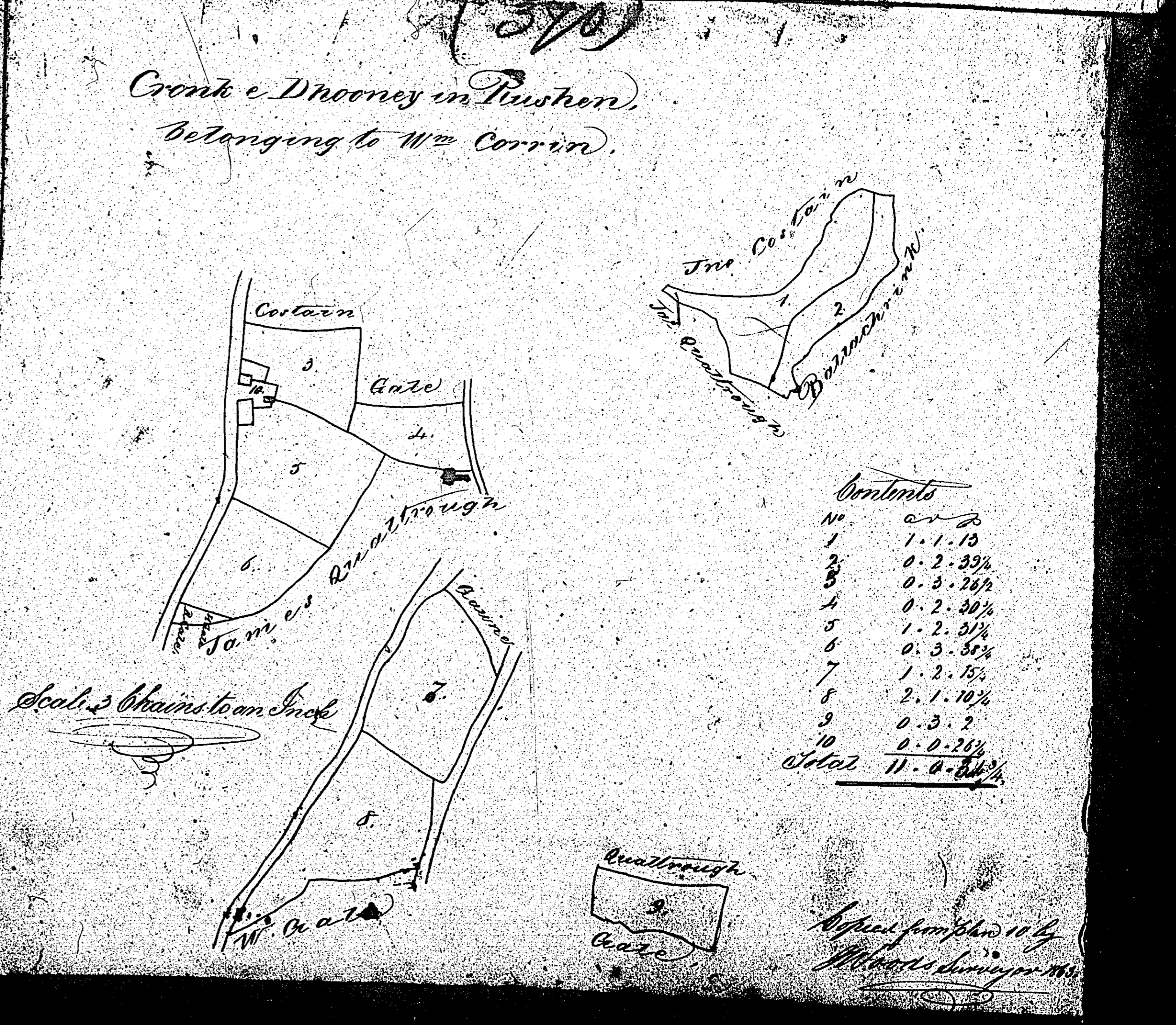
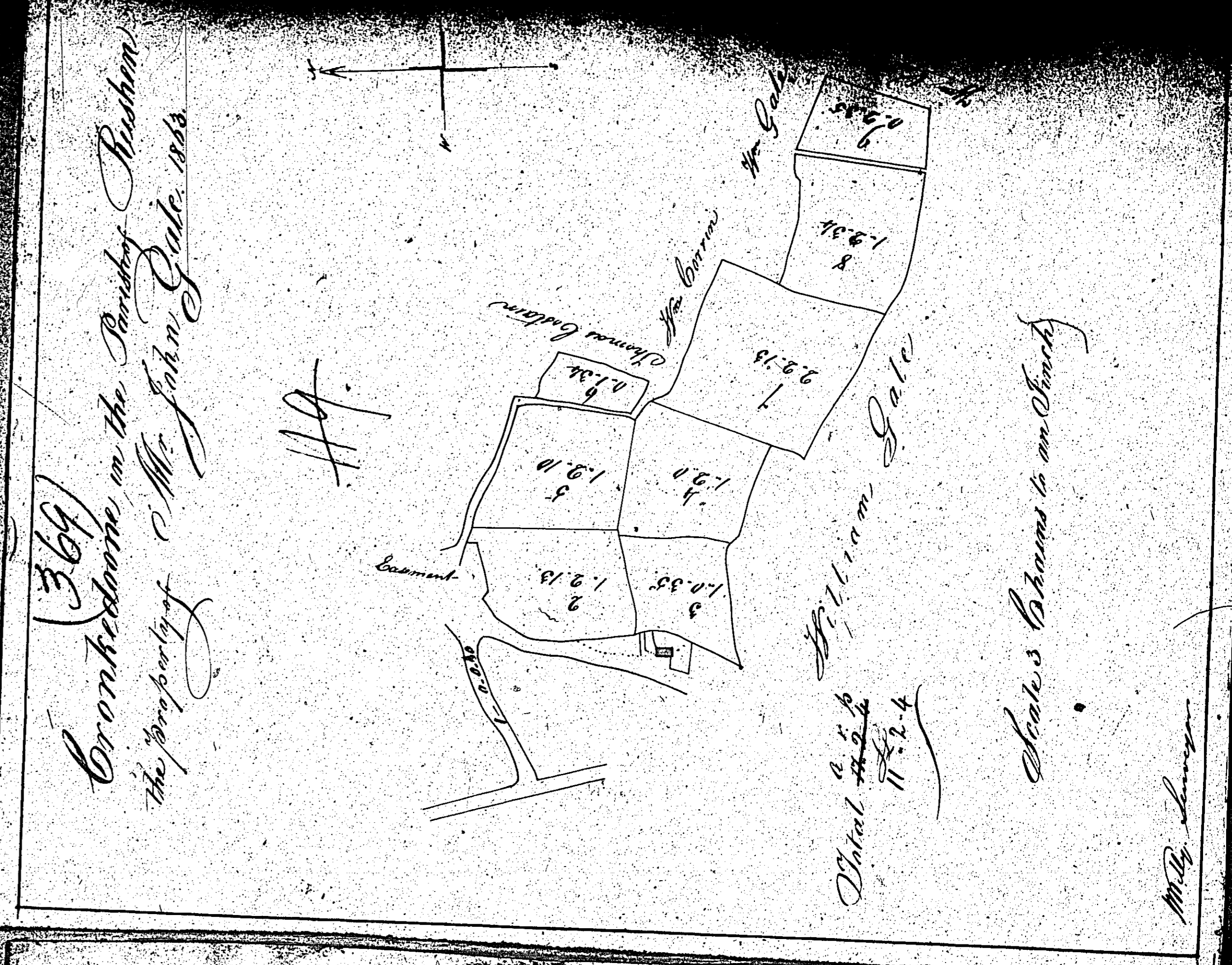



ISLE OF MAN GOVERNMENT: GENERAL REGISTRY

ASYLUM PLANS: PARISH OF RUSHEN

Originals monotone

1:23

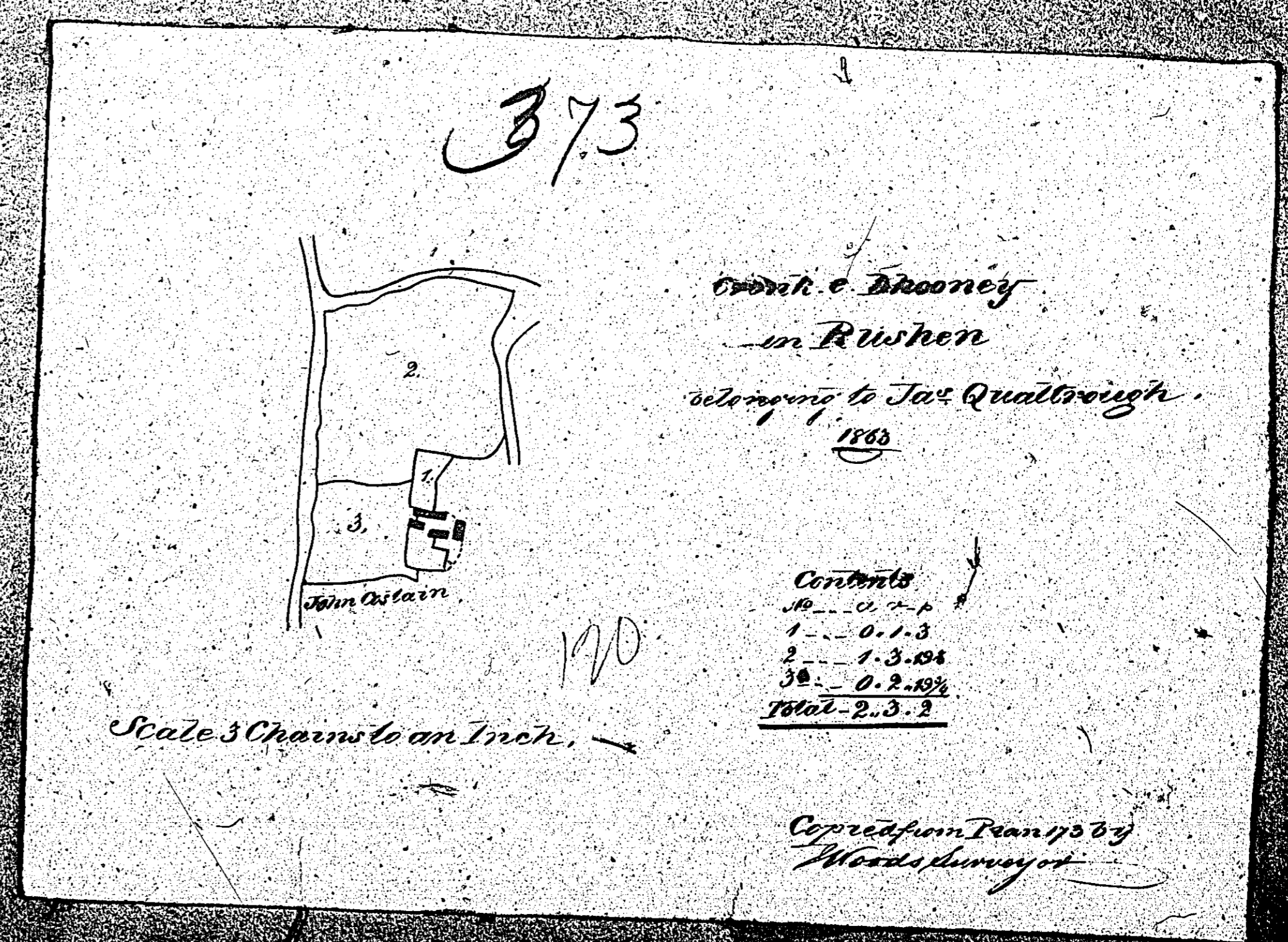
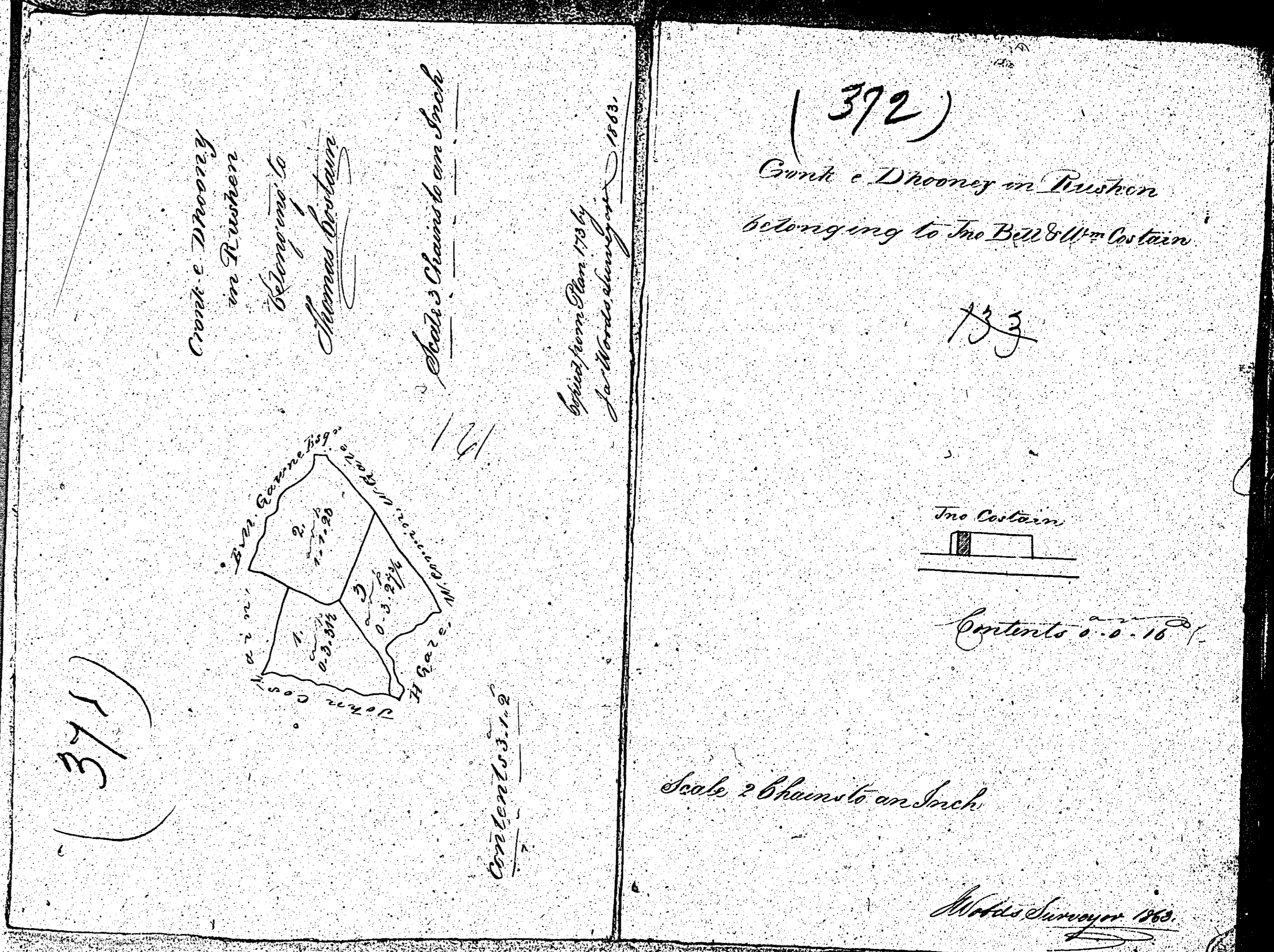



ISLE OF MAN GOVERNMENT: GENERAL REGISTRY

ASYLUM PLANS: PARISH OF RUSHEN

Originals monotone

1:23

374

Crank & Dhooney in Rushen  
Belonging to Thomas Corrin

142

W. Gate

Contents 0' 0" 3/4

Scale 2 Chains to an Inch

Woods Surveyor 1863

(375)

Crank & Dhooney in Rushen  
Belonging to Margt. Crater  
Edw. & Costain

Two Gaze

Contents 0' 0" 5'

Scale 2 Chains

Woods Surveyor 1863

376

Crank & Dhooney in Rushen  
Belonging to Margt. Crater

135

Two Gaze  
Basement

Contents 0' 0" 6'

Scale 2 Chains to an Inch

Woods Surveyor 1863