

ISLE OF MAN GOVERNMENT: GENERAL REGISTRY

ASYLUM PLANS: PARISH OF ONCHAN

1:23

- 45 Original coloured (decorative)
- 46 Original monotone

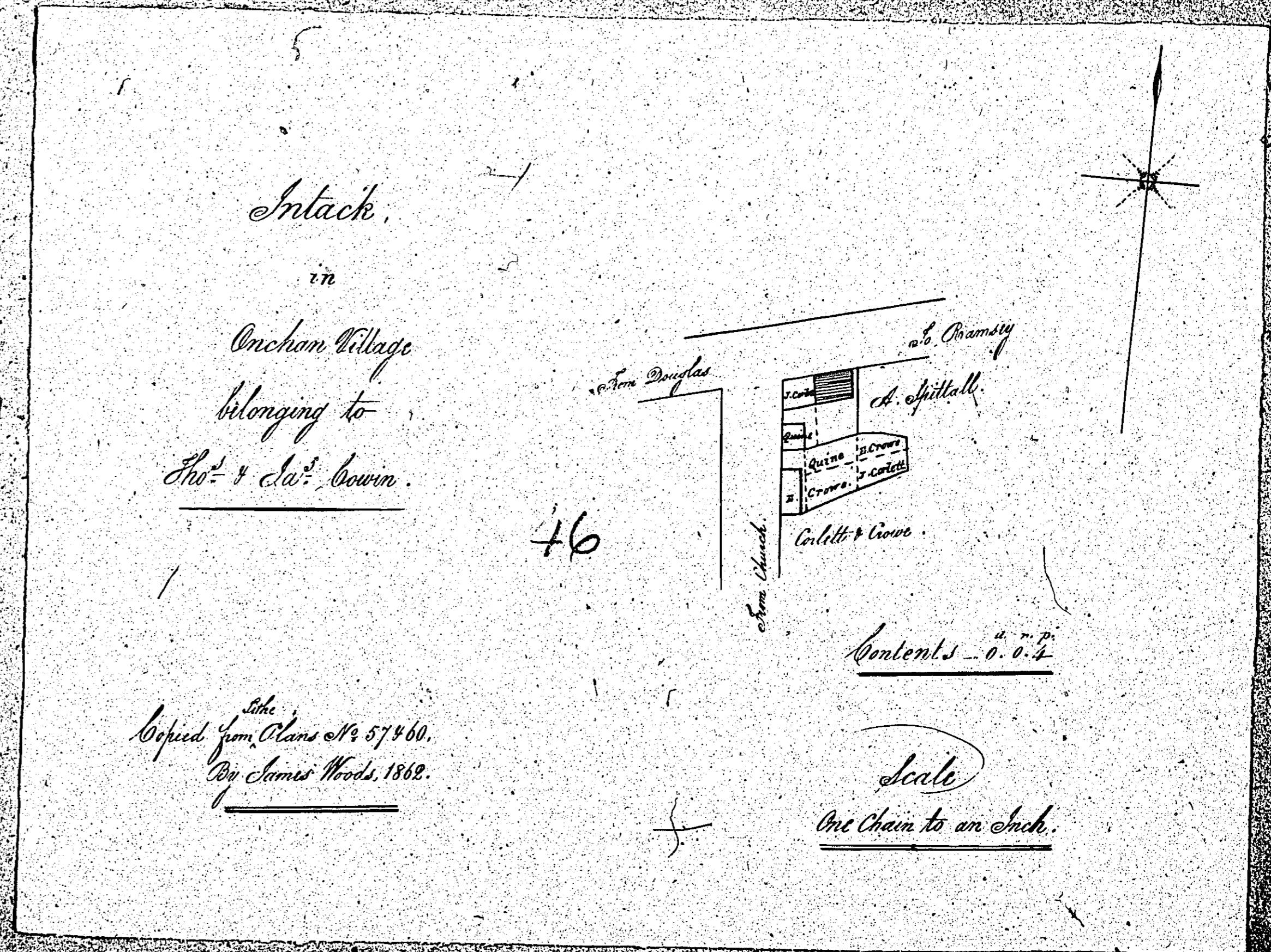
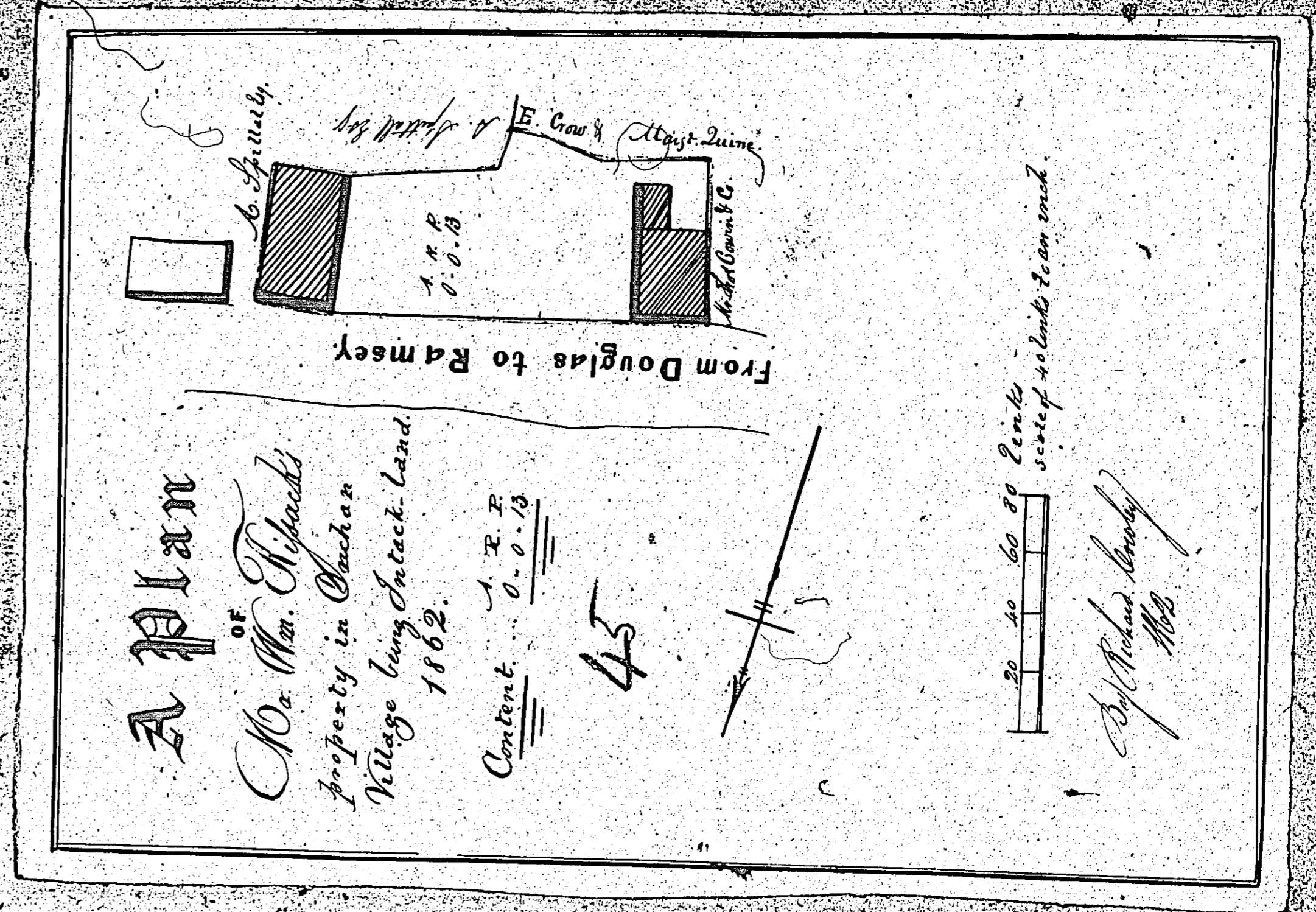

ISLE OF MAN GOVERNMENT: GENERAL REGISTRY

ASYLUM PLANS: PARISH OF ONCHAN

Originals monotone

1:23

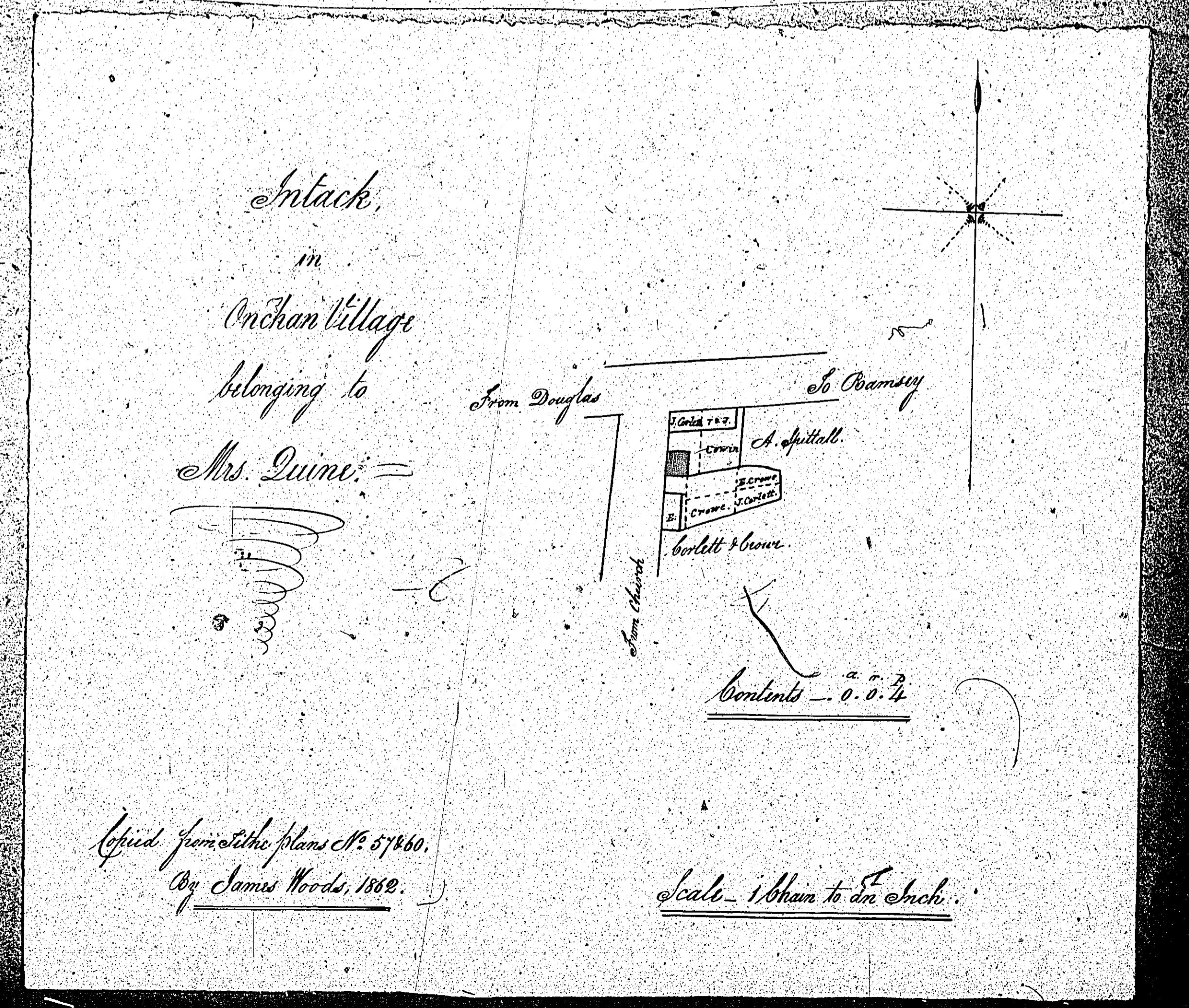
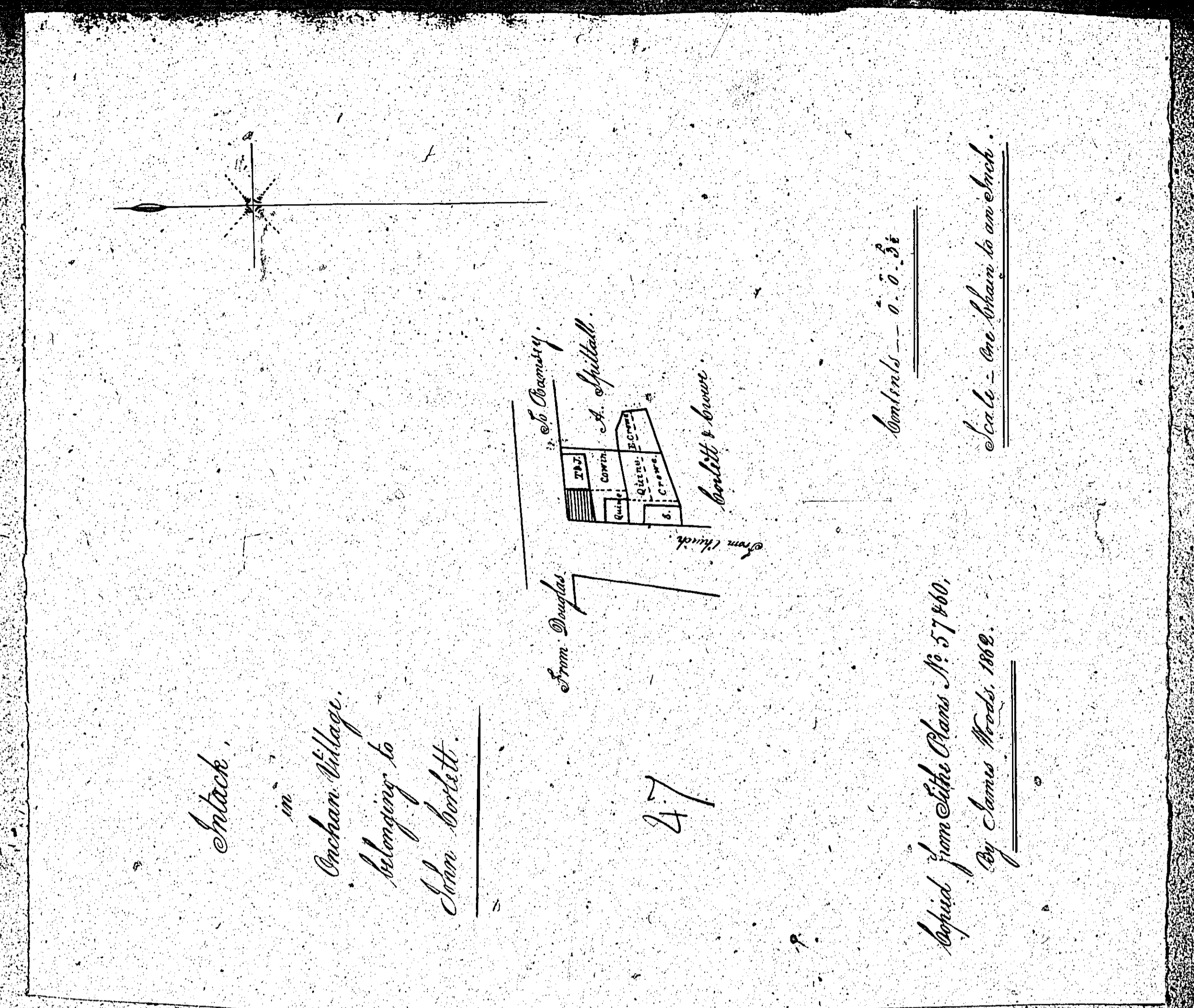

ISLE OF MAN GOVERNMENT: GENERAL REGISTRY

ASYLUM PLANS: PARISH OF ONCHAN

Originals monotone

1:23

Intack
in
Onchan Village
belonging to
Alanot Grove.

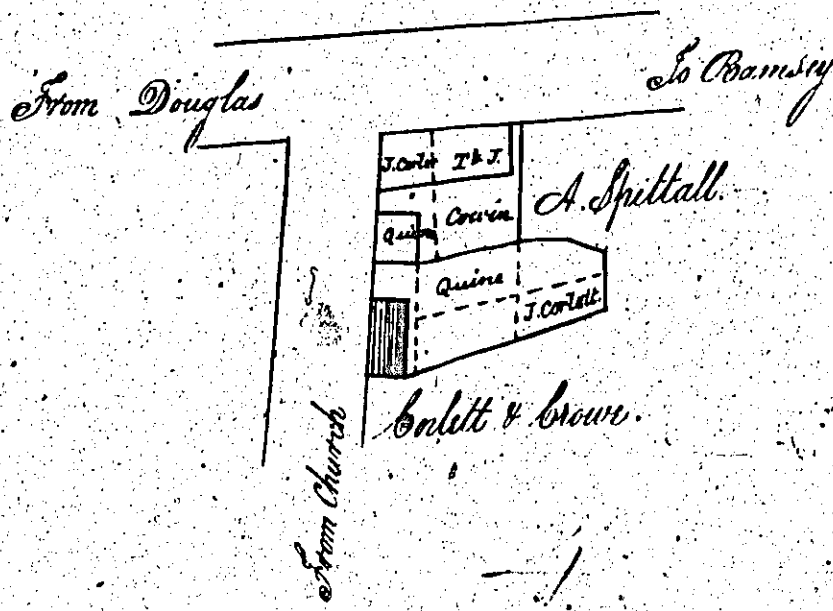

49

Contents - 0. 0. 6

Copied from Site Plans No. 57 & 60.
By James Woods. 1862.

Scale - One chain to an Inch.

Intack
in
Onchan
belonging to
Alan Grove.

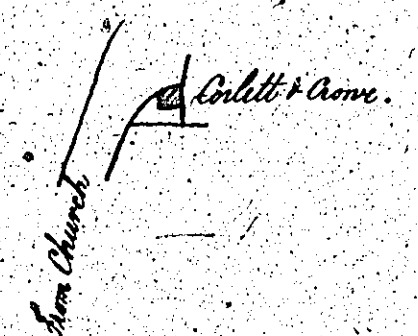

50

Contents - 0. 0. 2

J. Woods Surveyor. 1862

Scale
2 Chains to an Inch.

ISLE OF MAN GOVERNMENT: GENERAL REGISTRY
ASYLUM PLANS: PARISH OF ONCHAN

Original monotone

1:23

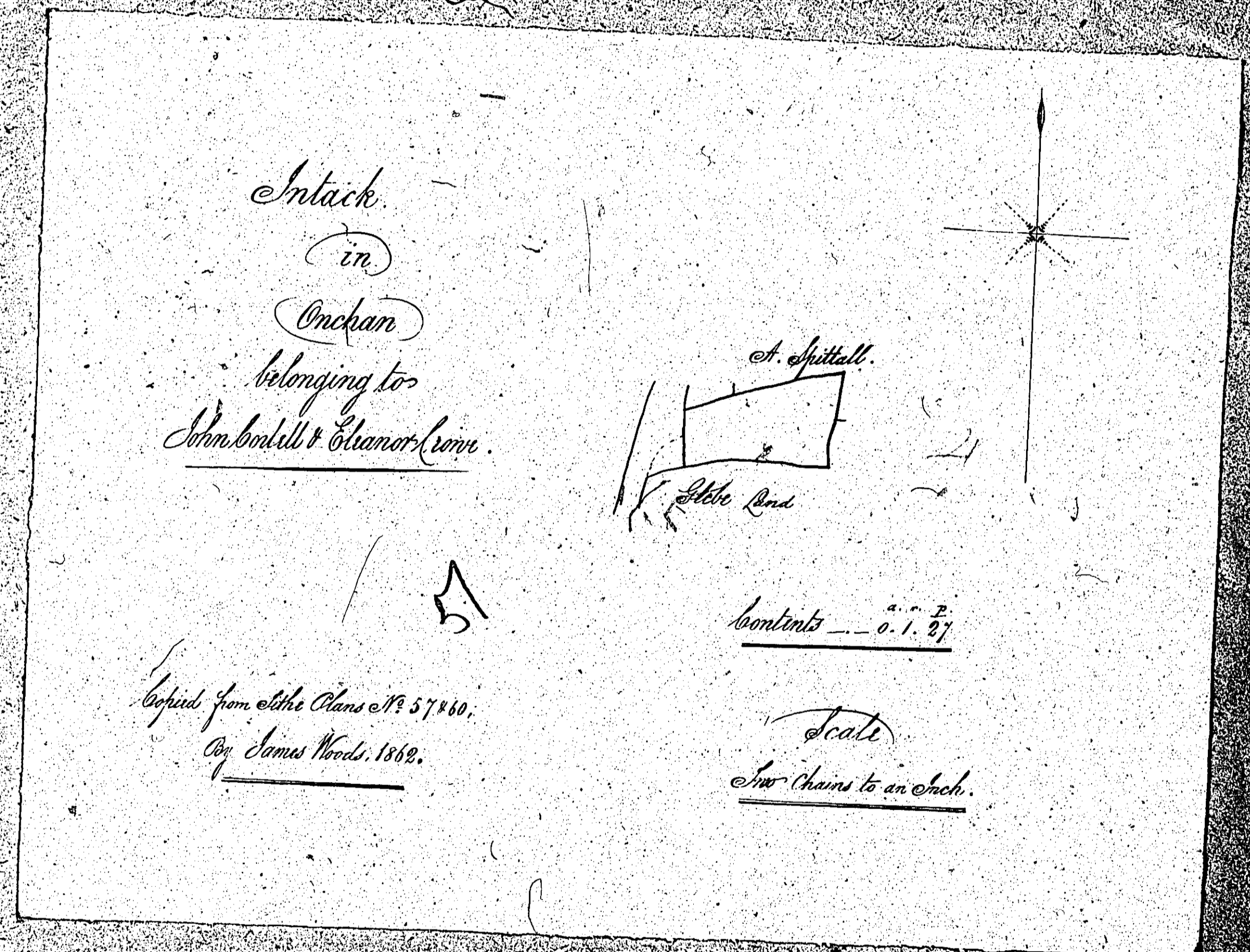

ISLE OF MAN GOVERNMENT: GENERAL REGISTRY
ASYLUM PLANS: PARISH OF ONCHAN

Original coloured (decorative)

1:23

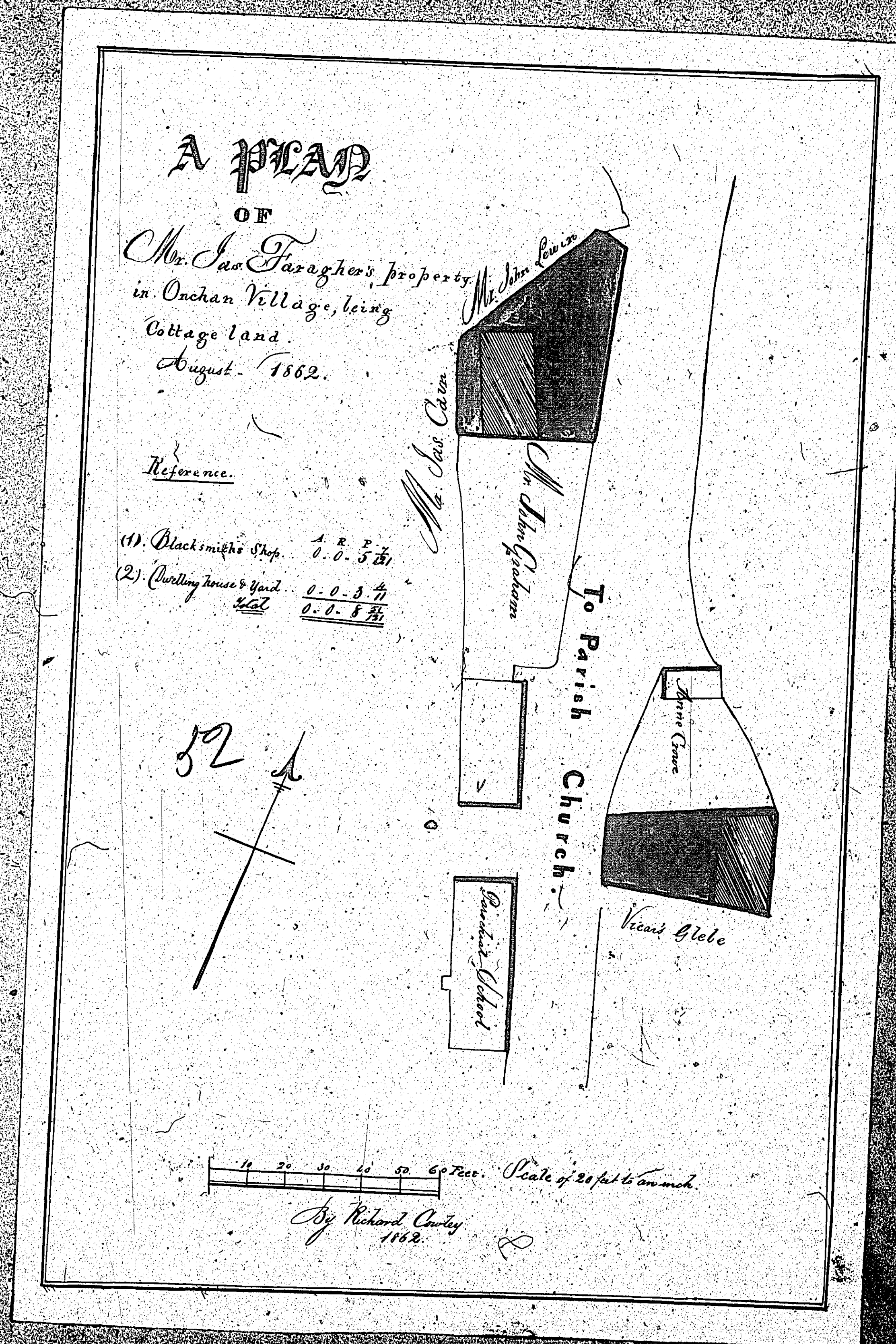

ISLE OF MAN GOVERNMENT: GENERAL REGISTRY

ASYLUM PLANS: PARISH OF ONCHAN

Original coloured

1:23

Onchan Parsonage.

1862.

Reference.

	A	R.	P.
1	0	2	31
2	0	1	22
3	0	1	20
4	0	2	5
Total	1	3.	58

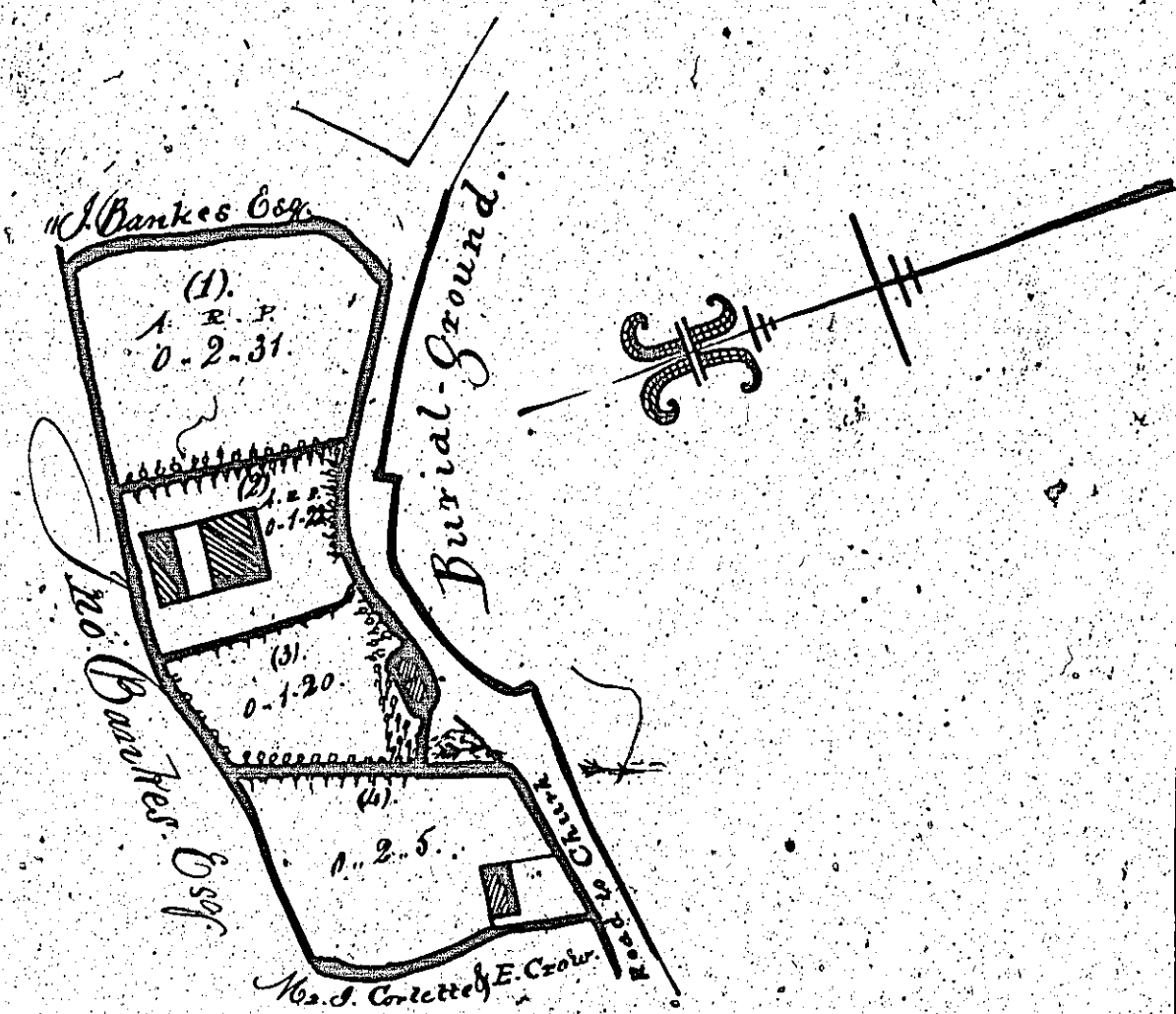

100 200 300 400 500 600 Links
Scale of 2 Chains to an inch.

By Richard Bowley
1862.