

ISLE OF MAN GOVERNMENT: GENERAL REGISTRY

ASYLUM PLANS: PARISH OF MICHAEL

Original coloured, (decorative), faint

1:23

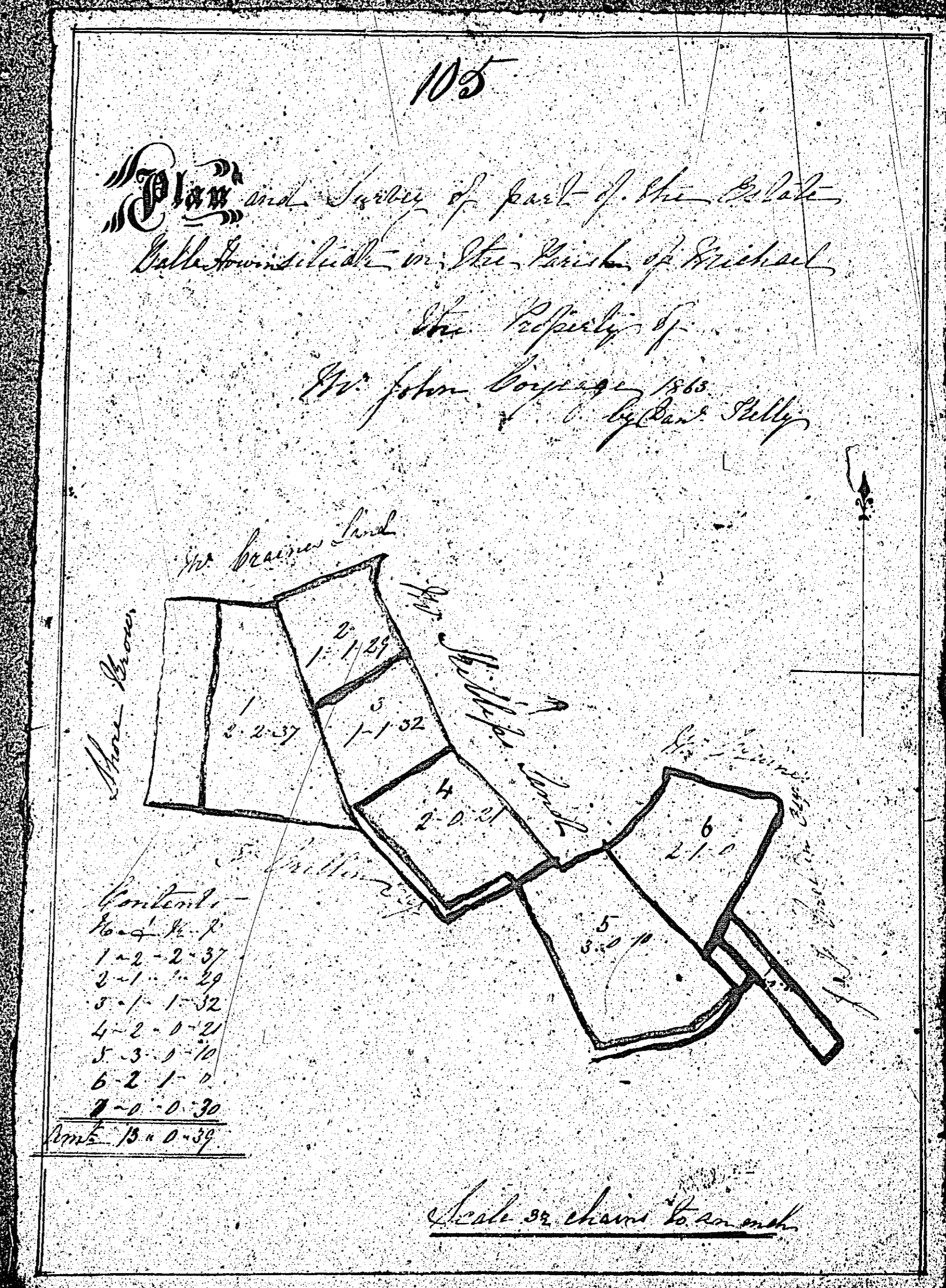

ASYLUM
 Plan of parts of the Parish of Michael
 situated in the Parish of St. Michael, Isle of Man
 in the possession of
 The Honble Francis Baring Esq.
 Lord Bishop of Sodor & Man
 1862
 Dr. Daniel Kelly

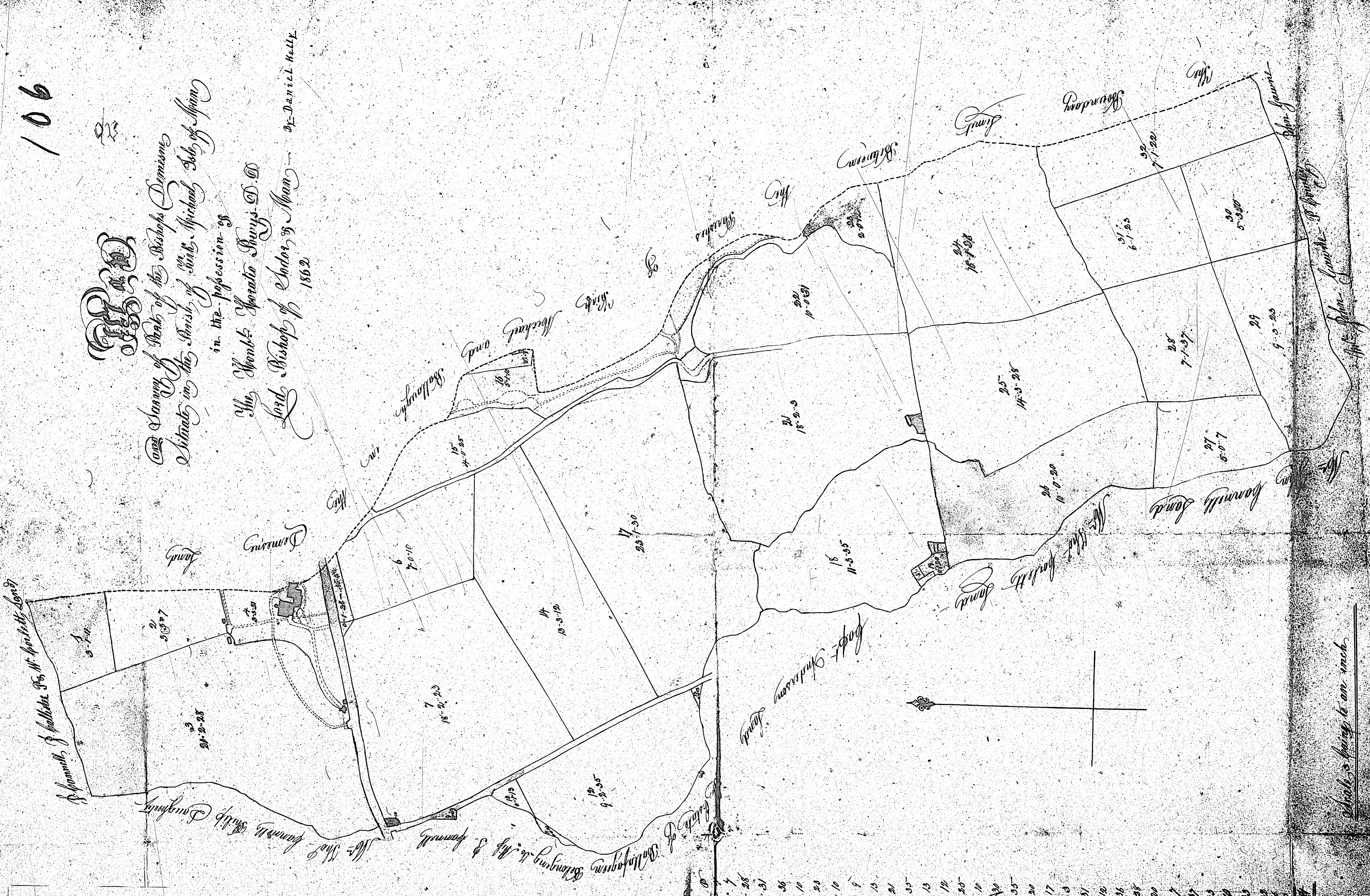

ISLE OF MAN GOVERNMENT: GENERAL REGISTRY

ASYLUM PLANS: PARISH OF MICHAEL

Original coloured

1:23

1	5-11	5-11
2	5-11	5-11
3	5-11	5-11
4	5-11	5-11
5	5-11	5-11
6	5-11	5-11
7	5-11	5-11
8	5-11	5-11
9	5-11	5-11
10	5-11	5-11
11	5-11	5-11
12	5-11	5-11
13	5-11	5-11
14	5-11	5-11
15	5-11	5-11
16	5-11	5-11
17	5-11	5-11
18	5-11	5-11
19	5-11	5-11
20	5-11	5-11
21	5-11	5-11
22	5-11	5-11
23	5-11	5-11
24	5-11	5-11
25	5-11	5-11
26	5-11	5-11
27	5-11	5-11
28	5-11	5-11
29	5-11	5-11
30	5-11	5-11

about 5 fangs to an inch

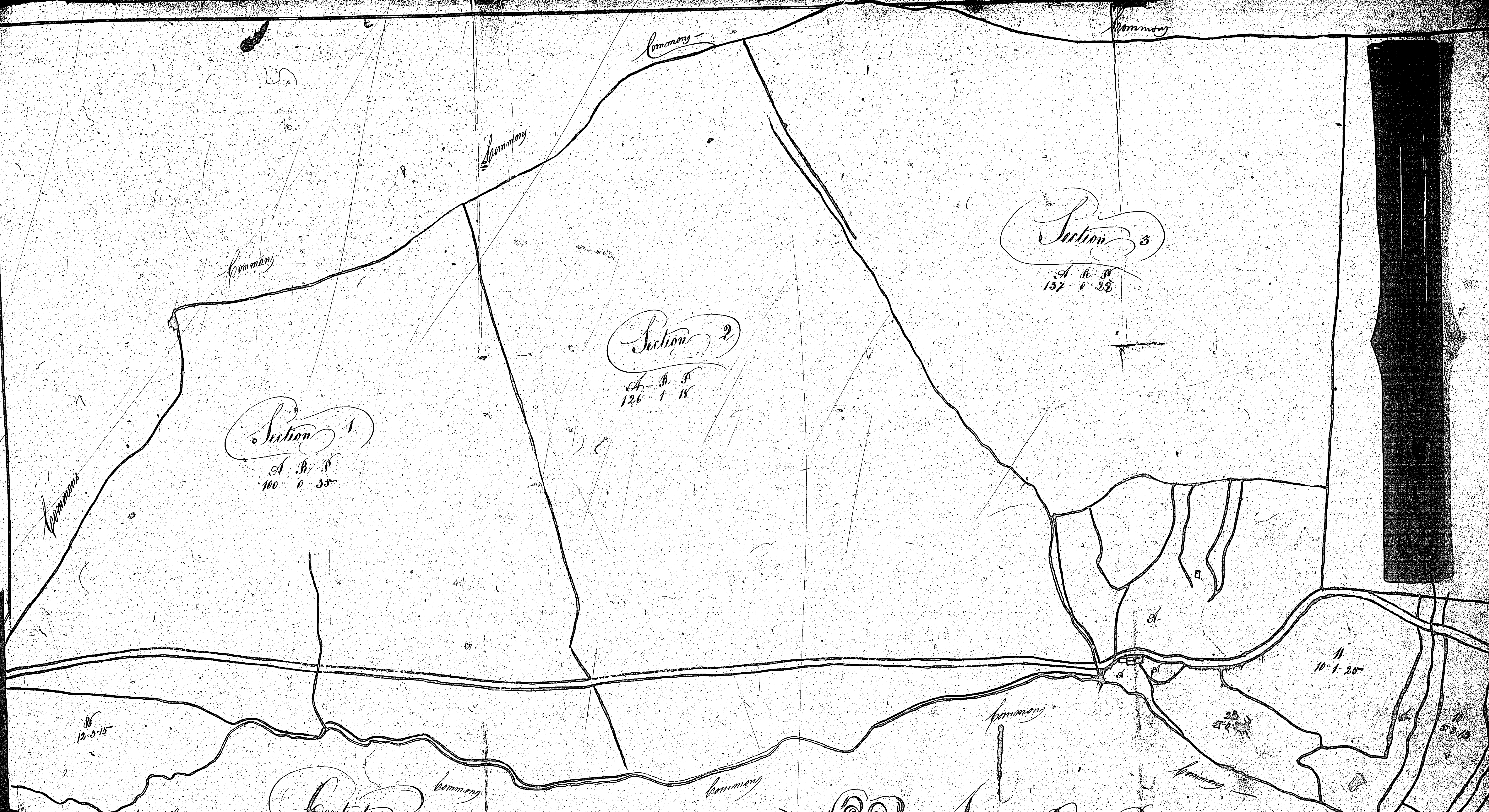

Section 1
A. B. P.
100 - 0 - 35

Section 2
A. B. P.
126 - 1 - 18

Section 3
A. B. P.
137 - 0 - 35

Contents

	A.	B.	P.
Section 1	100	0	35
Section 2	126	1	18
Section 3	137	0	35
Section 4	168	3	27
Number 4	2	2	13
5	3	0	24
6	4	2	19
7	4	3	22
8	23	3	27
9	29	0	24
10	5	2	18
11	10	1	25
12	6	0	35
13	4	0	31
14	8	0	21
15	2	0	36
16	6	1	37
17	11	0	34
18	2	2	1
19	2	2	21
20	2	2	0
21	15	0	25
22	5	0	25
23	5	0	26
24	12	3	15
Total	726	0	36

A Plan and Survey of Part of Drumdale and Mountbellin Situate in the Parish of Kirk Michael the Property of Samuel Brook Esq. 1862 by Daniel Kelly

187

Scale 3 Chains to an inch

Plantations and fens marked as Part of the uninclosed Commons

ISLE OF MAN GOVERNMENT: GENERAL REGISTRY
 ASYLUM PLANS: PARISH OF MICHAEL
 Original coloured

frame 1 of 2

1:23

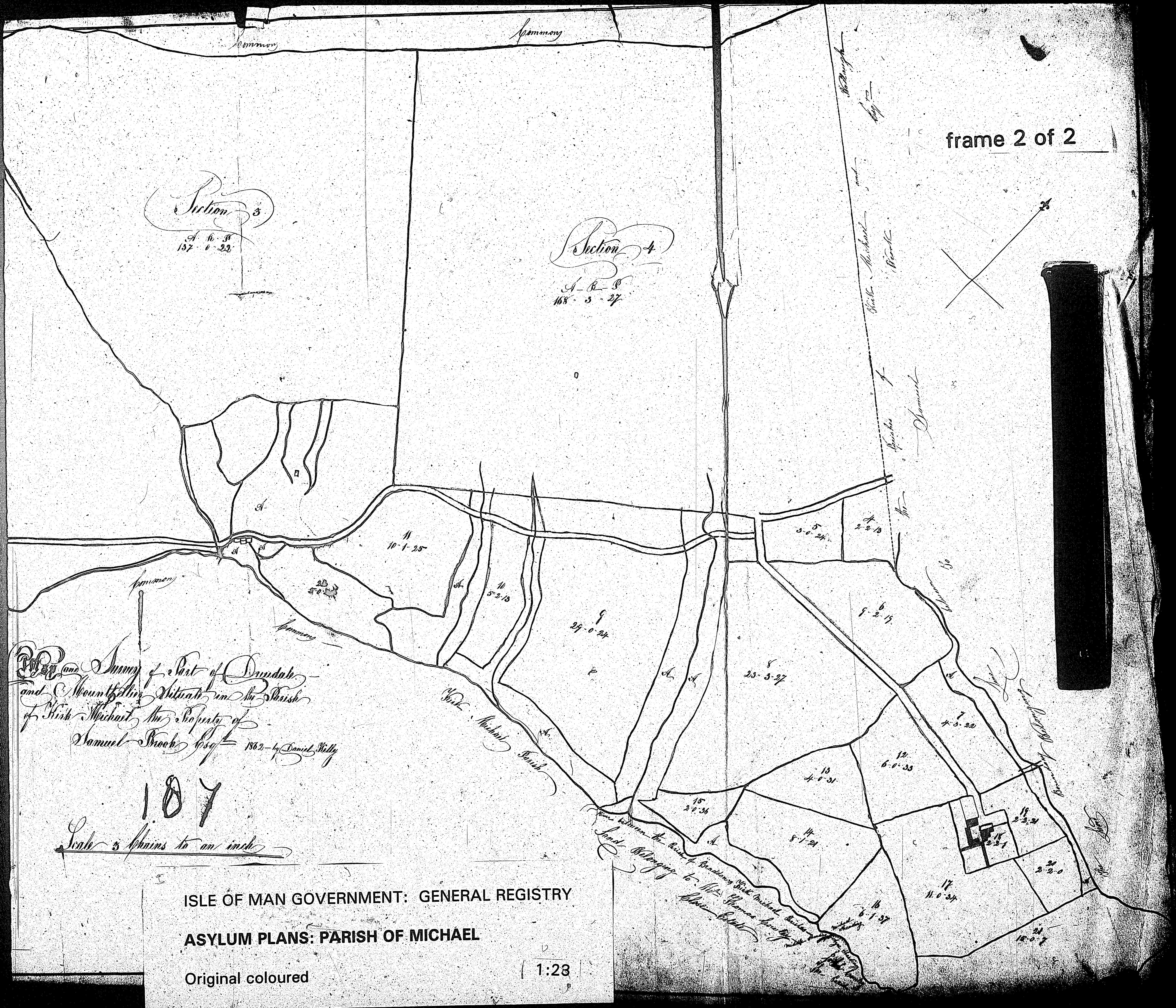

Section 3
 A. R. P.
 137. 0. 22

Section 4
 A. R. P.
 168. 5. 27

Plan and Survey of Part of Dunderdale
 and Mountbellin Situate in the Parish
 of Kirk Michael the Property of
 Samuel Brock Esq. 1862 by Daniel Kelly

187

Scale 5 Chains to an inch

ISLE OF MAN GOVERNMENT: GENERAL REGISTRY

ASYLUM PLANS: PARISH OF MICHAEL

Original coloured

1:23

END OF VOLUME