

ISLE OF MAN GOVERNMENT: GENERAL REGISTRY

ASYLUM PLANS: PARISH OF MICHAEL

1:23

- 78 Original coloured (decorative)
- 79 Original coloured
- 80 Original coloured
- 81 Original coloured
- 82 Original coloured
- 83 Original coloured (decorative)

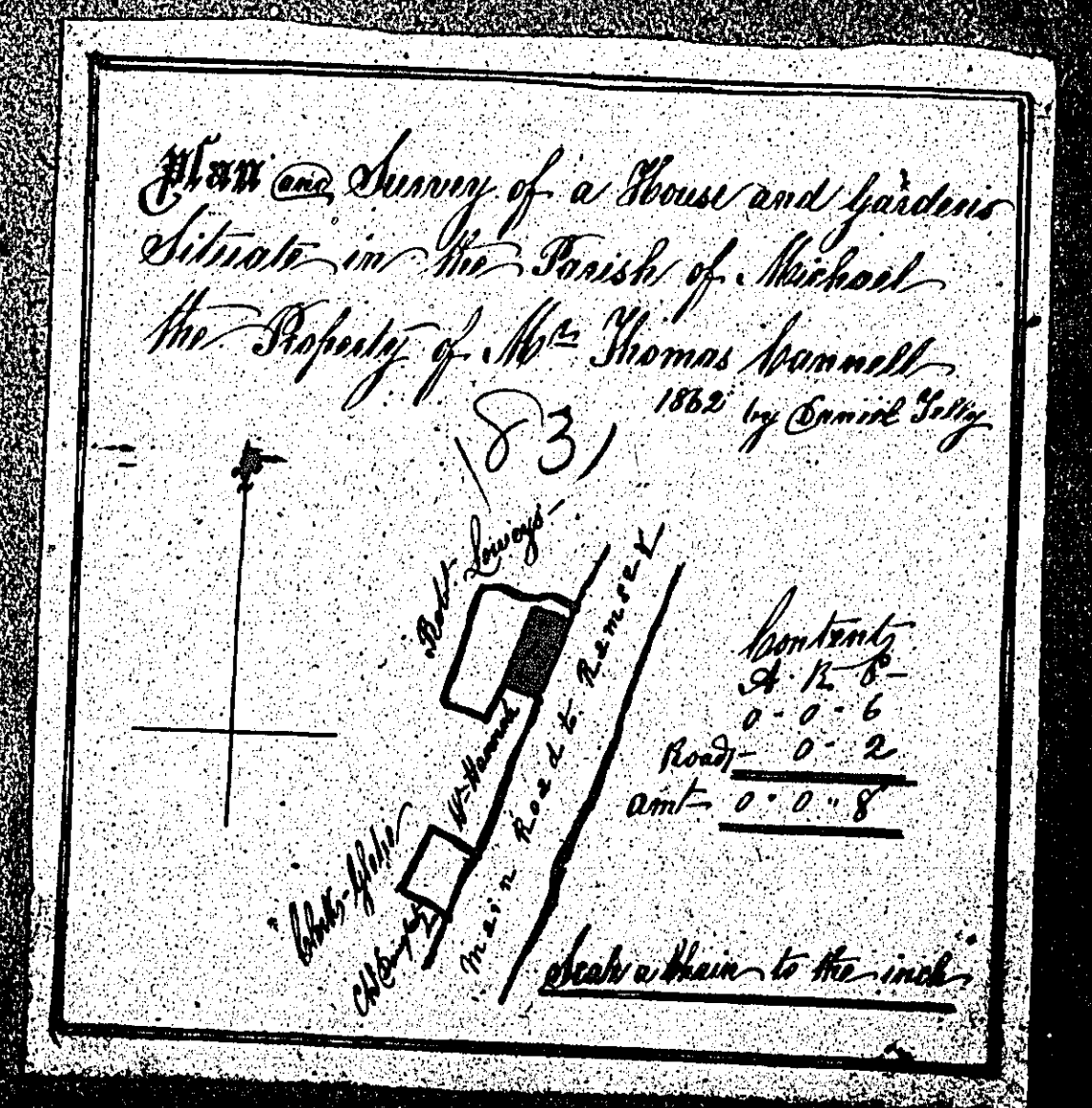
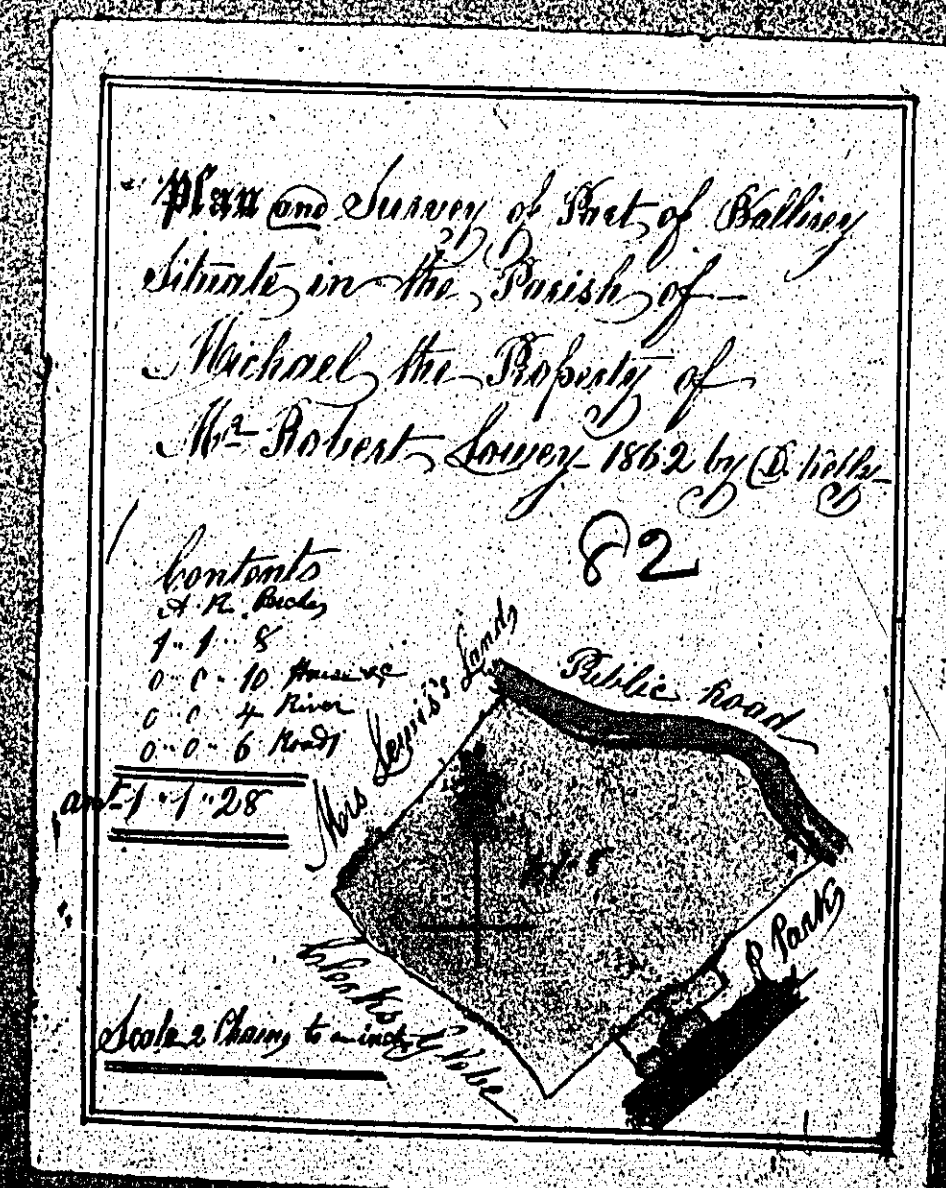
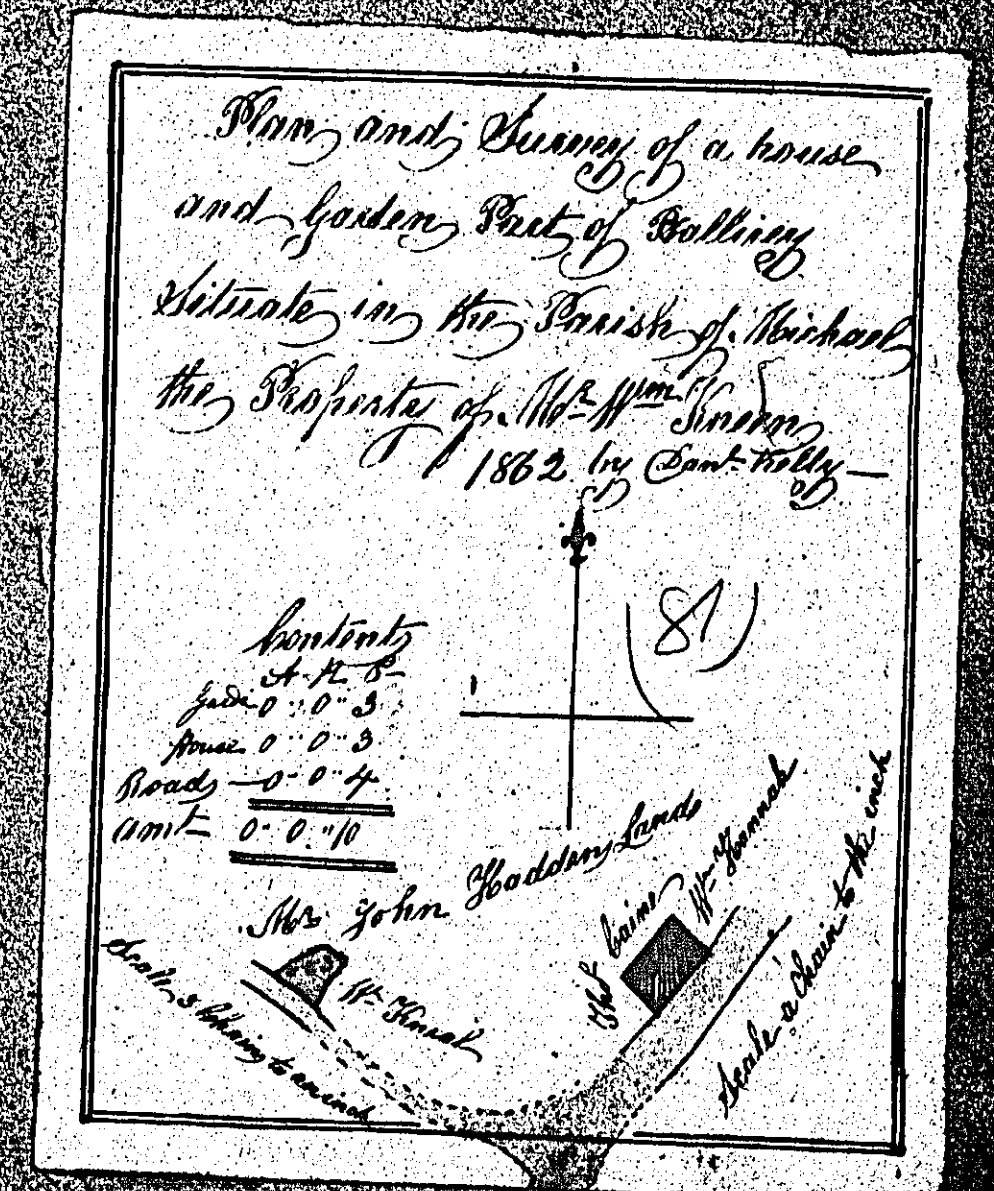
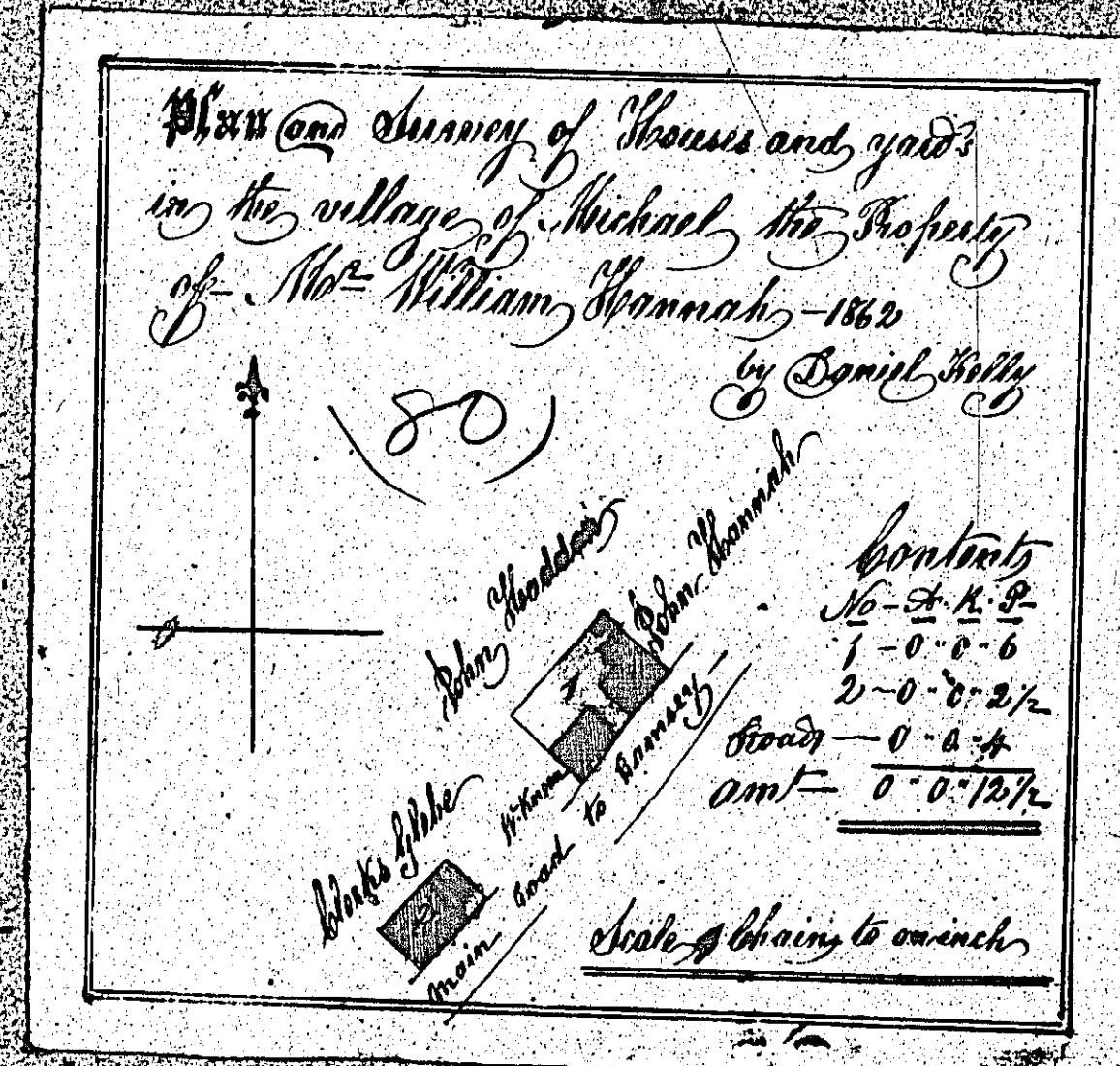
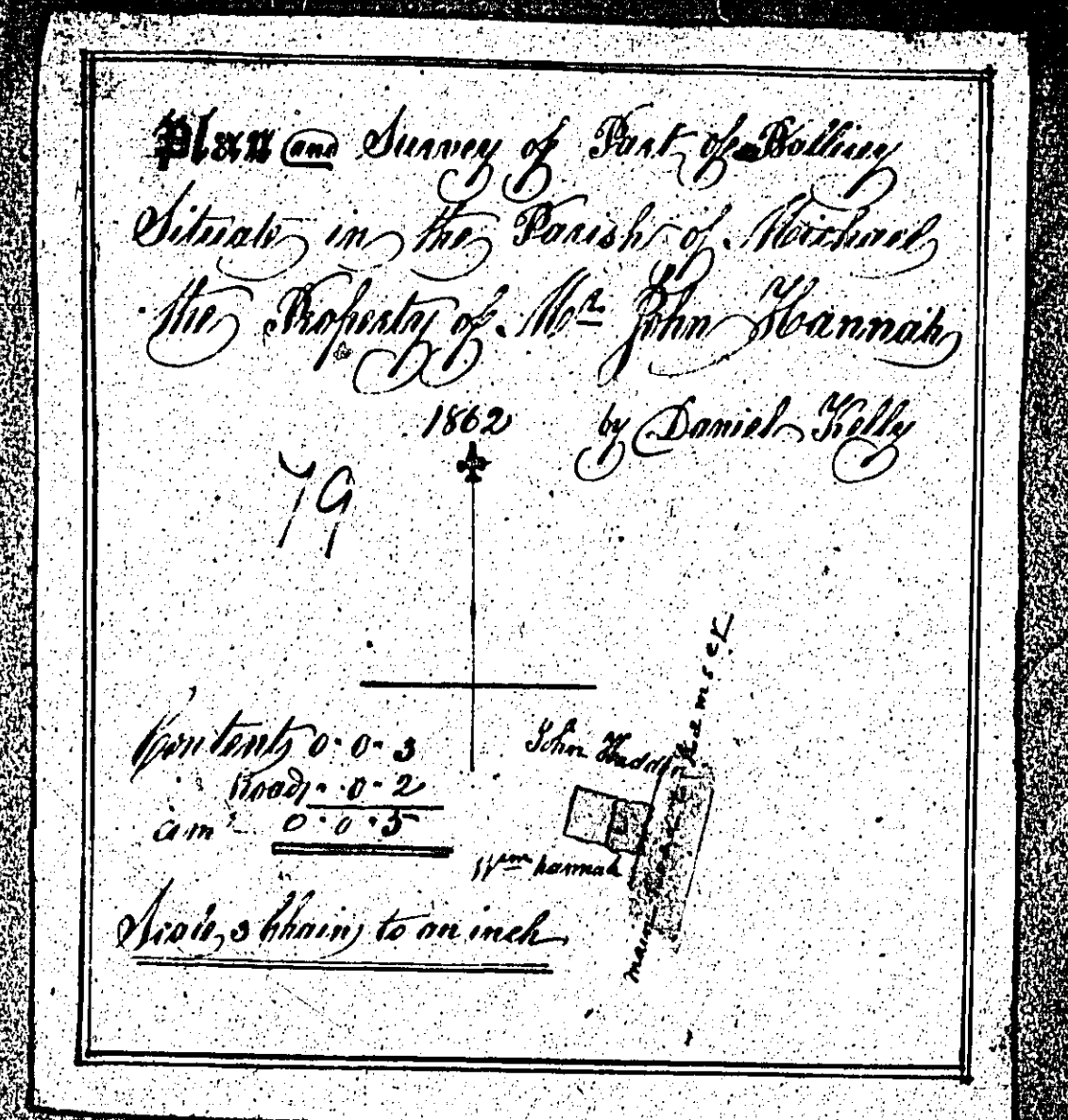
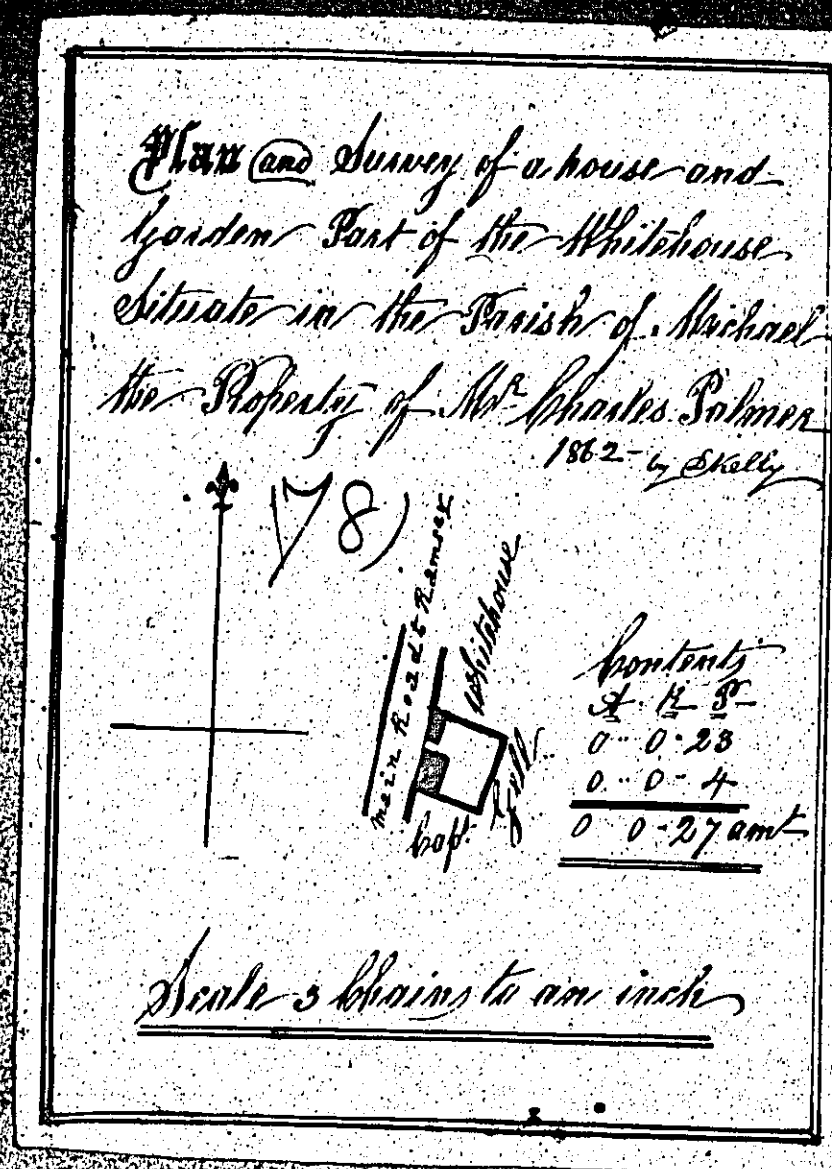

There is no plan

numbered

84

ISLE OF MAN GOVERNMENT: GENERAL REGISTRY

ASYLUM PLANS: PARISH OF MICHAEL

- 85 Original coloured
- 86 Original coloured (decorative)
- 87 Original coloured
- 88 Original coloured
- 89 Original coloured

1:23

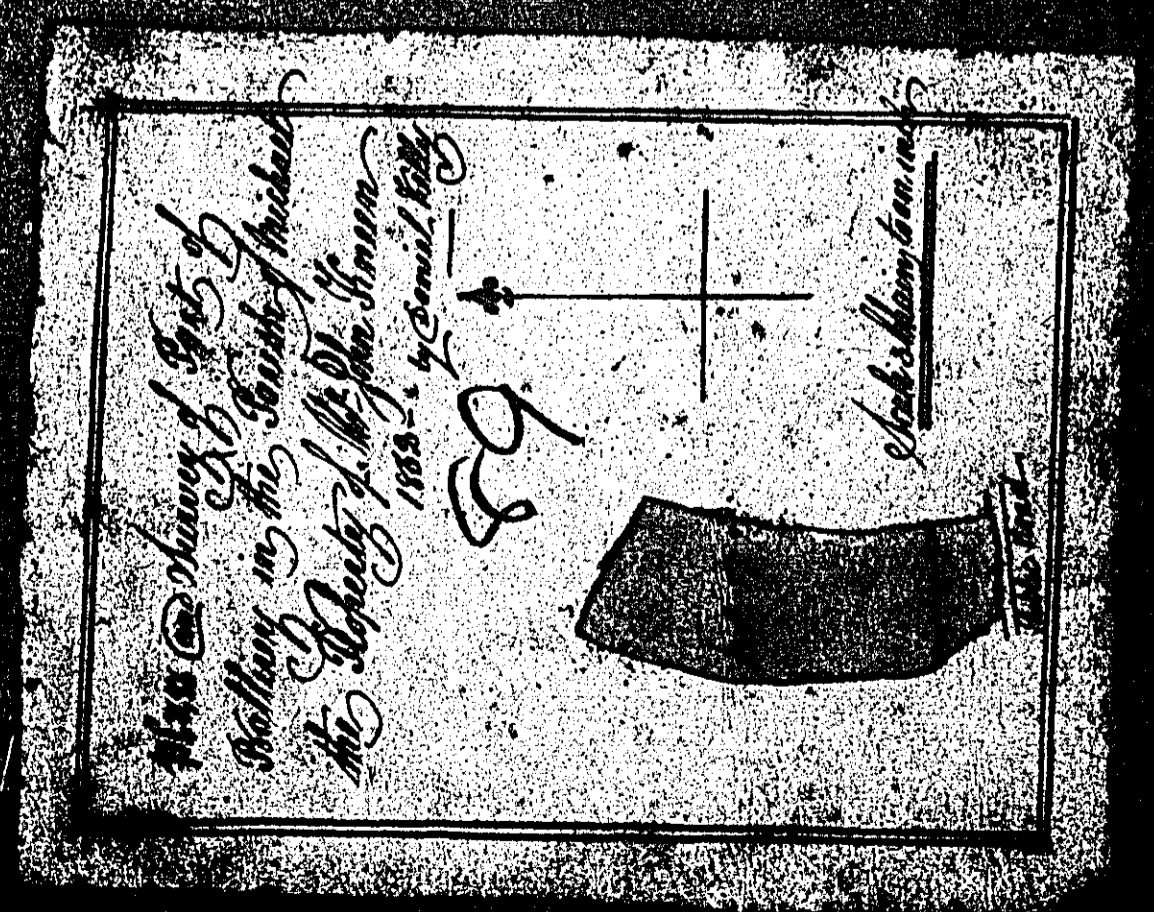
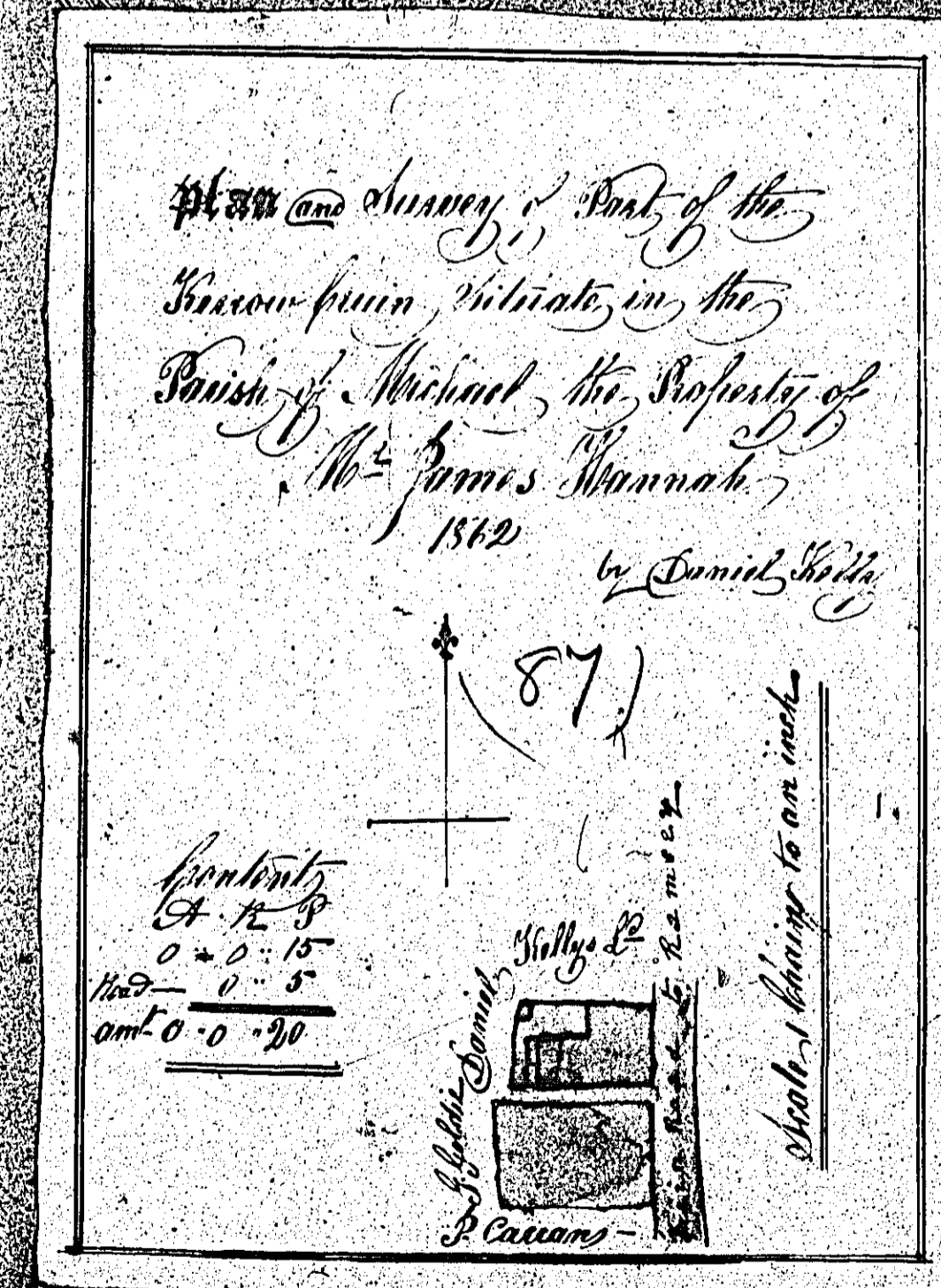
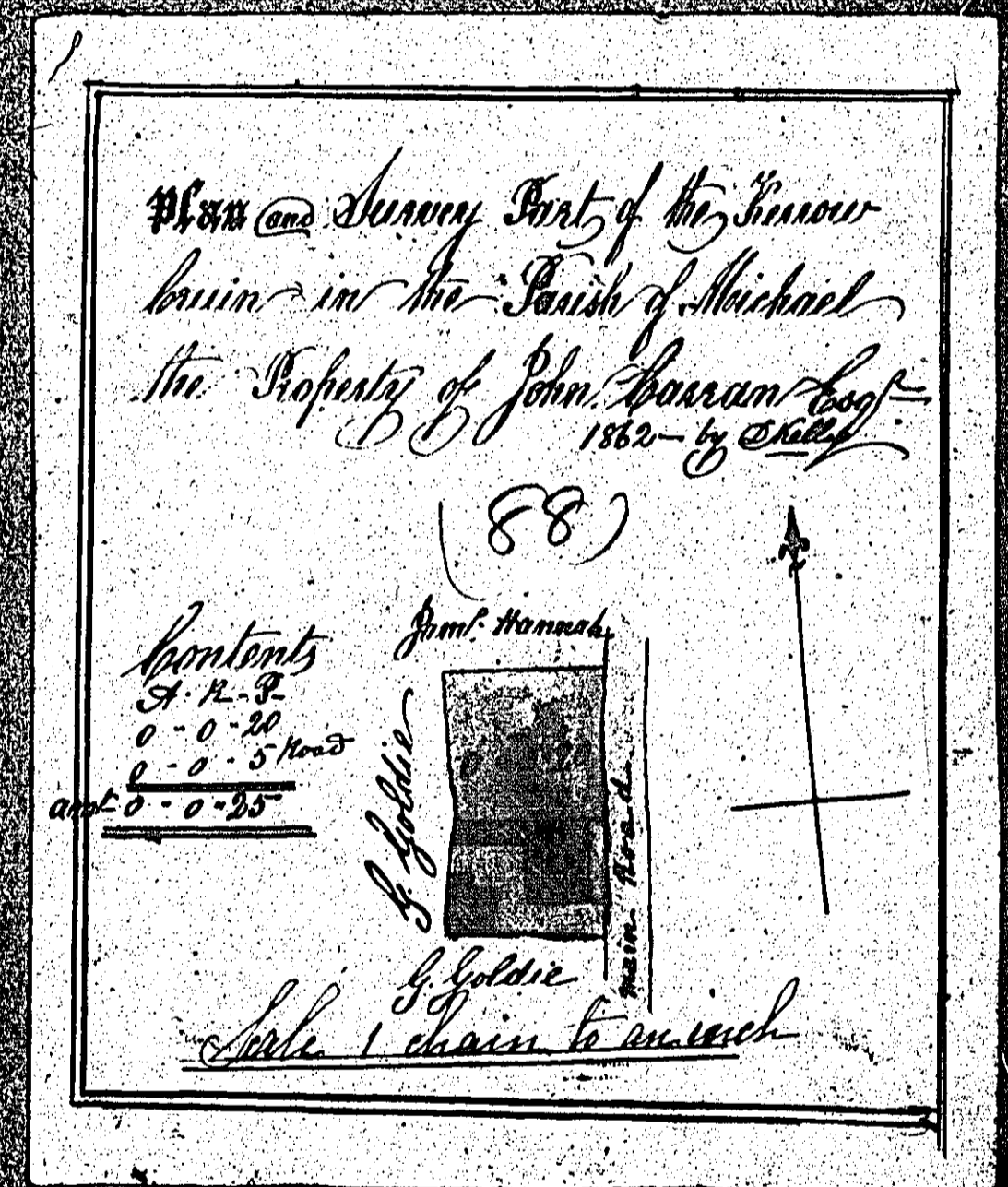
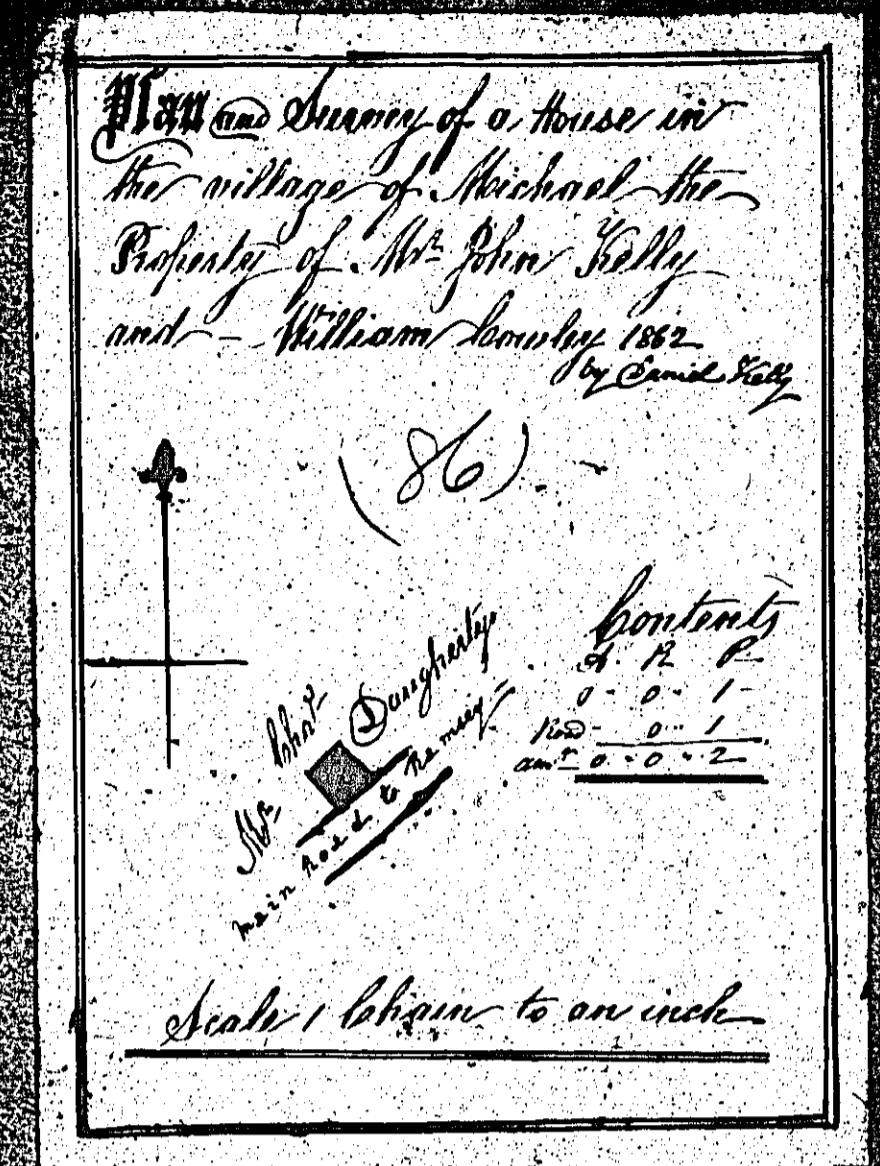
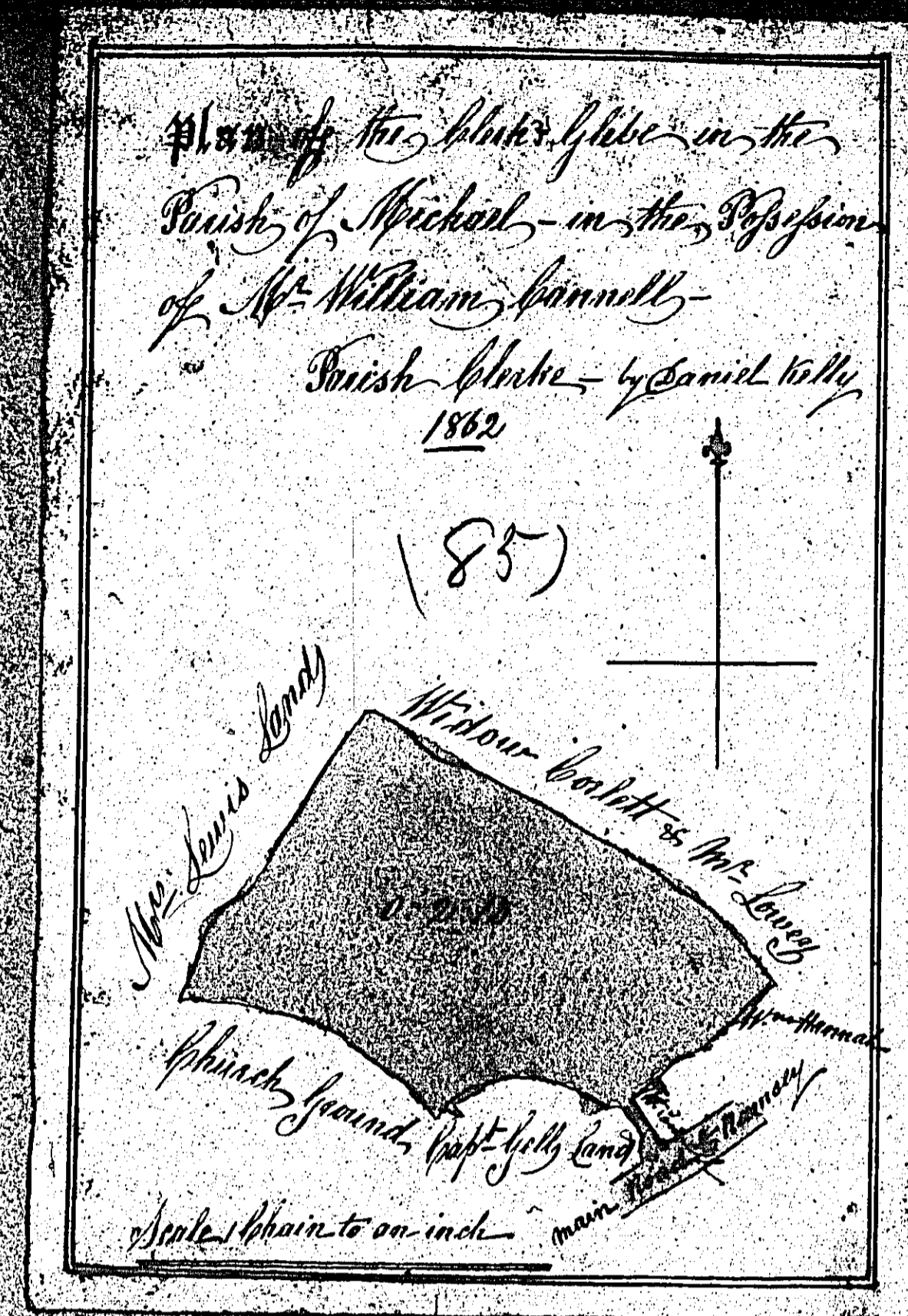

ISLE OF MAN GOVERNMENT: GENERAL REGISTRY

ASYLUM PLANS: PARISH OF MICHAEL

- 90 Original coloured
- 91 Original coloured (decorative)

1:23

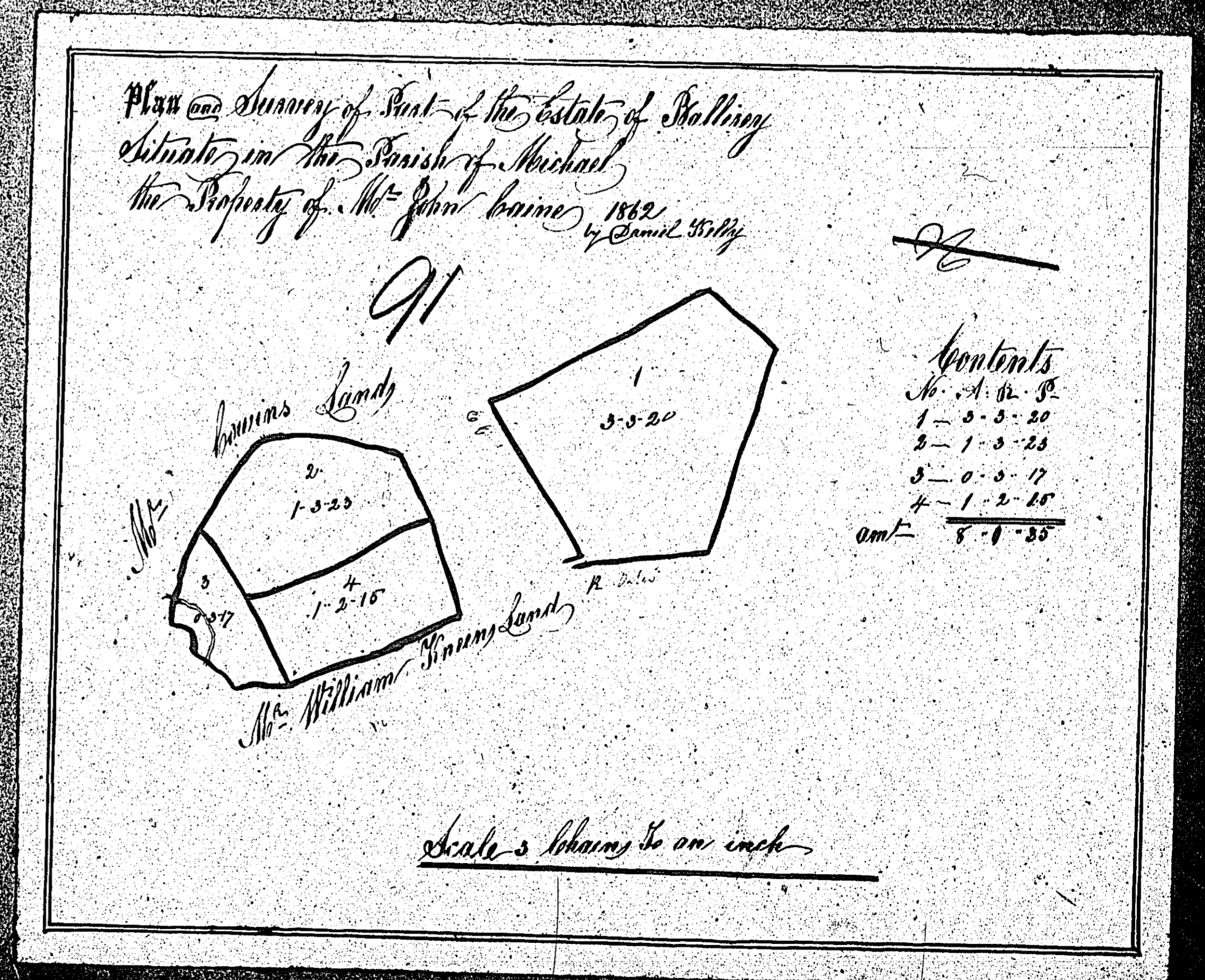
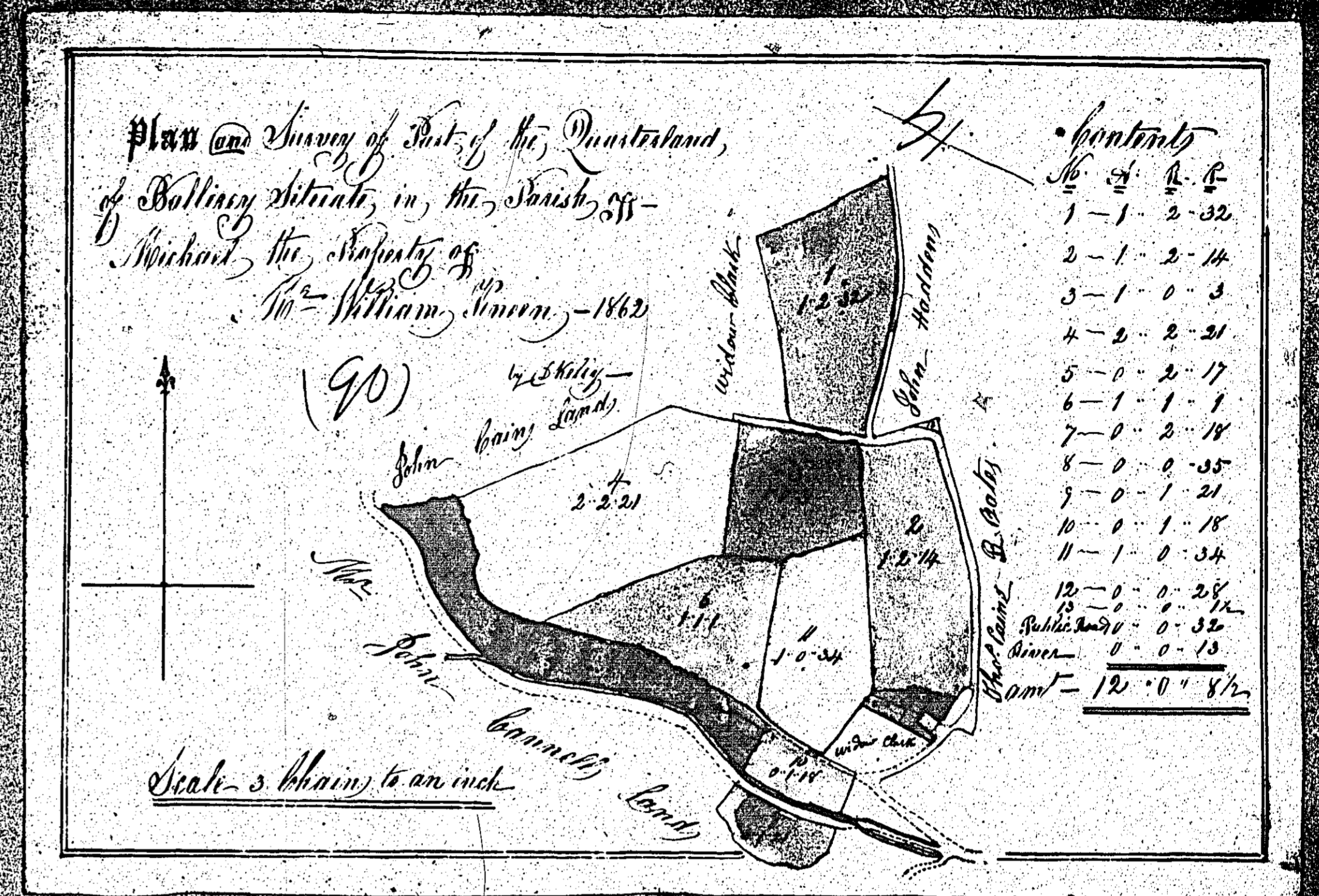

ISLE OF MAN GOVERNMENT: GENERAL REGISTRY

ASYLUM PLANS: PARISH OF MICHAEL

Original coloured (decorative)

1:23

*Plan and Survey of the Estate of Ballacorney
situate in the Parish of Michael
the Property of
Mrs Elizabeth Adams by Deed Dated 1802.*

92

Acres	Perches	Square Feet
1	0	2.24
2	0	2.31
3	5	1.24
4	0	0.27
5	7	2.1
6	5	0.5
7	5	1.16
8	4	0.20
9	0	0.19
10	0	1.24
11	2	2.33
12	2	2.34
13	1	2.32
14	2	2.14
15	0	2.11
16	0	0.13
17	0	0.38
18	4	2.15
19	2	1.0
Public Roads	1	0.30
Commons	0	0.33
Commons	2	1.17
Commons	0	1.0
Total		22.27

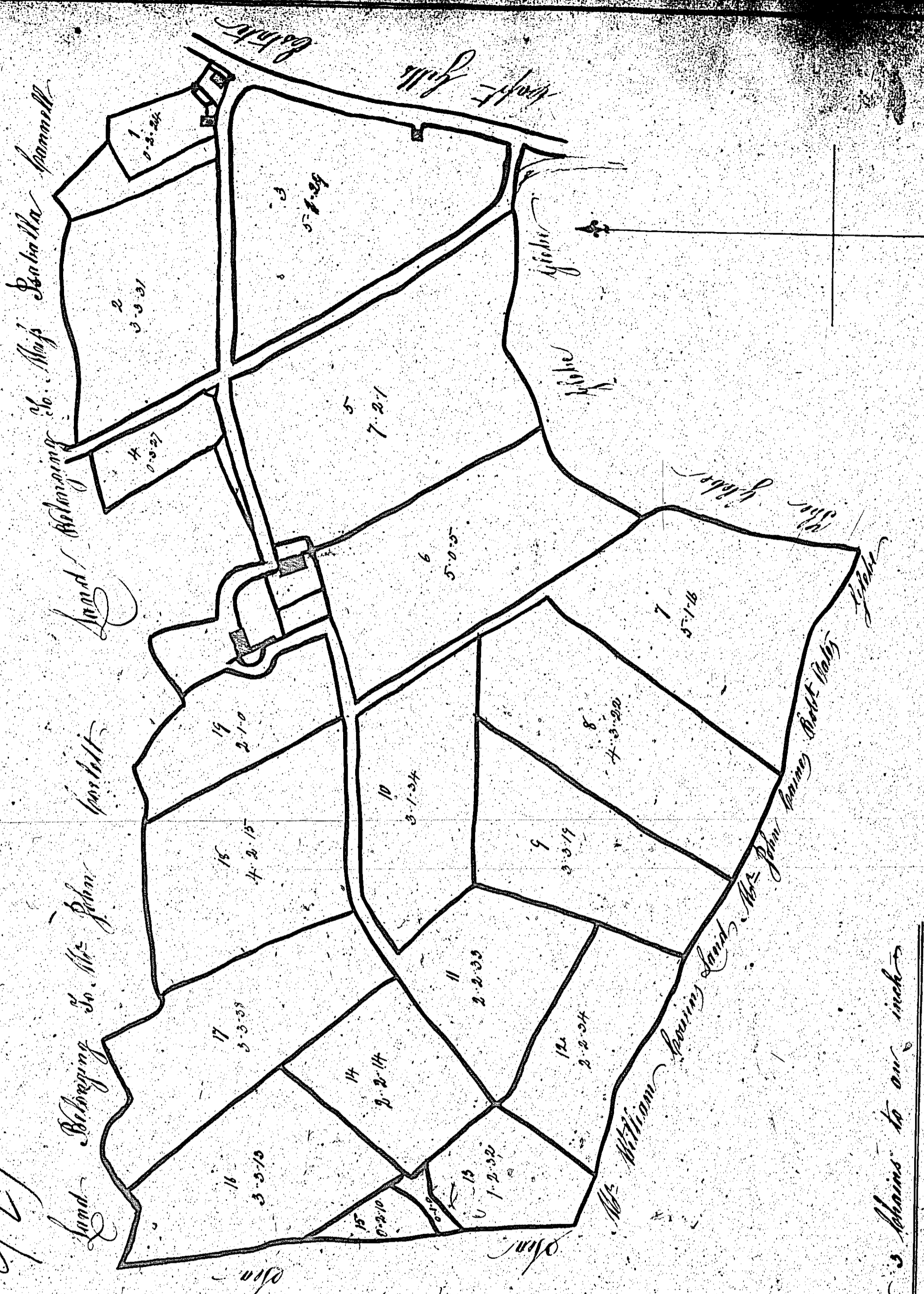

Scale 3 chains to an inch

ISLE OF MAN GOVERNMENT: GENERAL REGISTRY

ASYLUM PLANS: PARISH OF MICHAEL

Originals coloured

1:23

