

ISLE OF MAN GOVERNMENT: GENERAL REGISTRY

ASYLUM PLANS: PARISH OF MAUGHOLD

Original coloured (decorative)

1:23

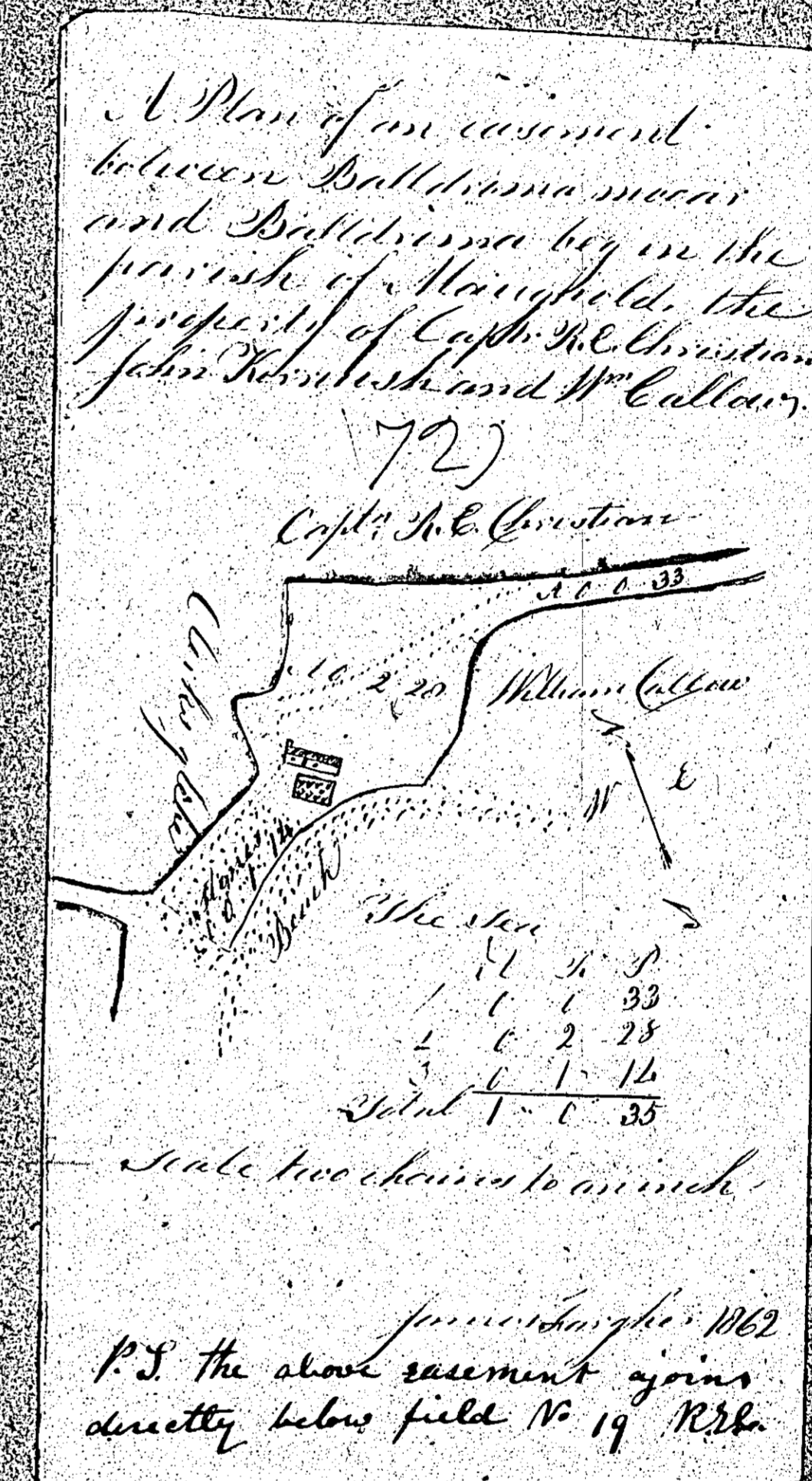

ISLE OF MAN GOVERNMENT: GENERAL REGISTRY

ASYLUM PLANS: PARISH OF MAUGHOLD

Original coloured (decorative)

1:23

(73)

*Balladroma*  
 and  
*Ballyory*  
 in  
*Maughold*  
 belonging  
 to  
*John O'Donnish*

Content	
10	arp
1	3.1.19
2	3.1.1
3	0.1.24
4	2.3.11
5	2.9.16
6	3.1.14
7	2.0.15
8	2.3.28
9	2.1.12
Road	0.0.33
Basement	0.0.33
<u>Total 23.0.18</u>	

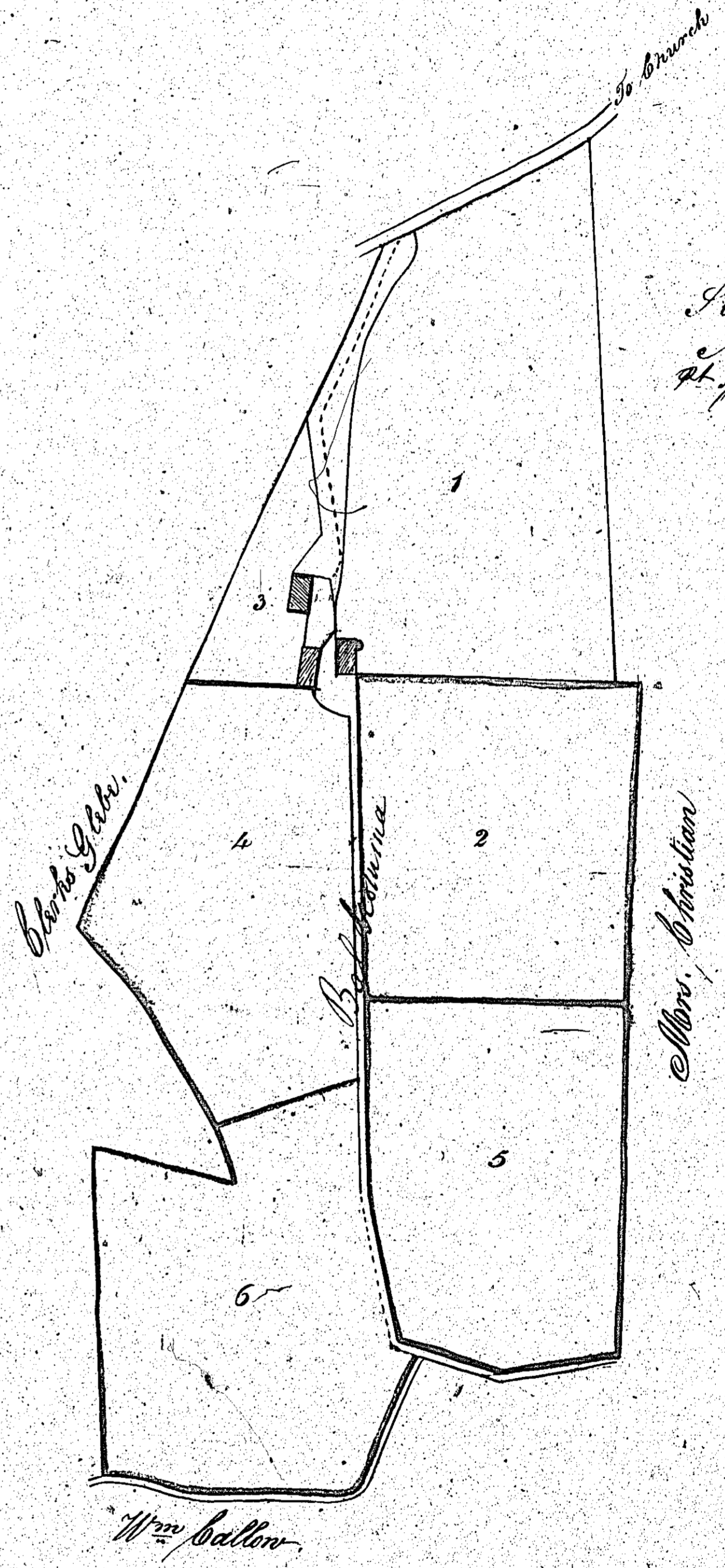

Staff Land  
 2  
 25-8-1-24  
 27-9-1-0-2-8  
0-3-30

81

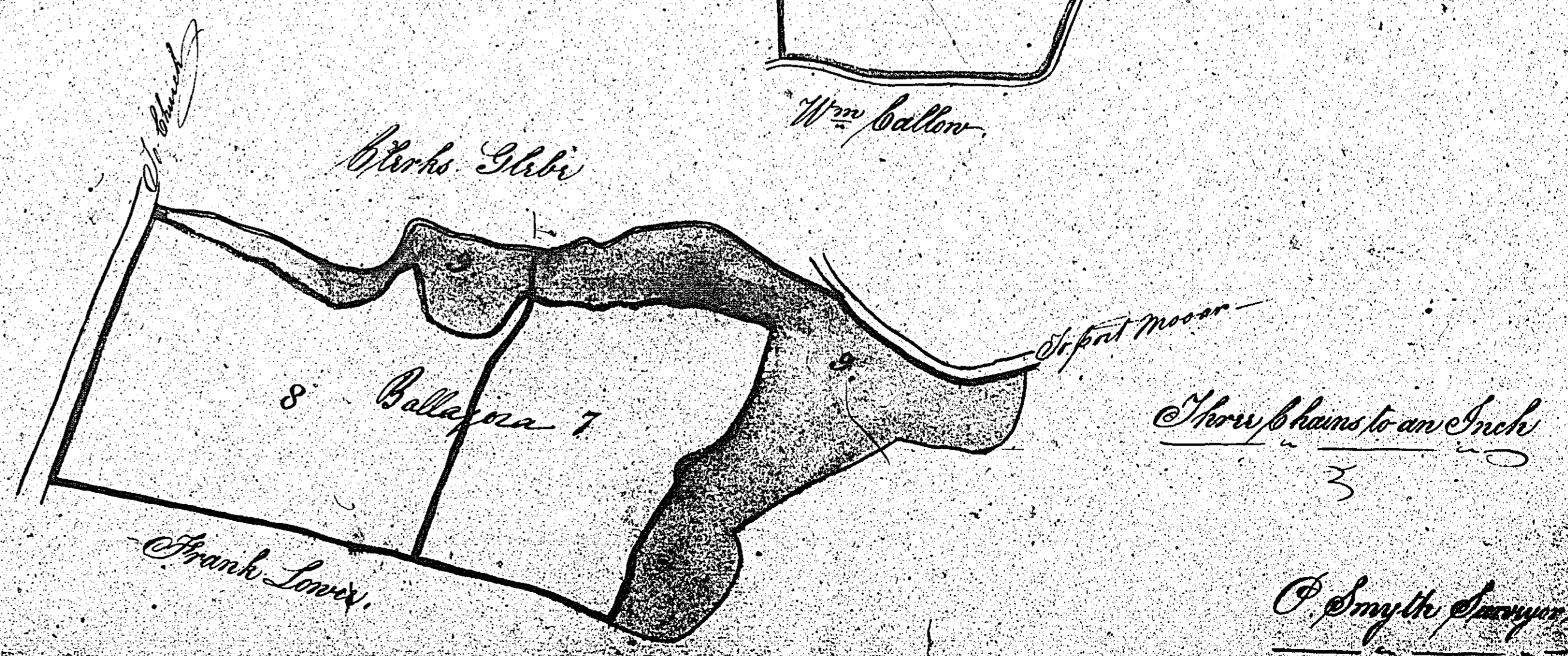

P. Smyth Surveyor 1863

ISLE OF MAN GOVERNMENT: GENERAL REGISTRY

ASYLUM PLANS: PARISH OF MAUGHOLD

Original coloured (decorative)

1:23

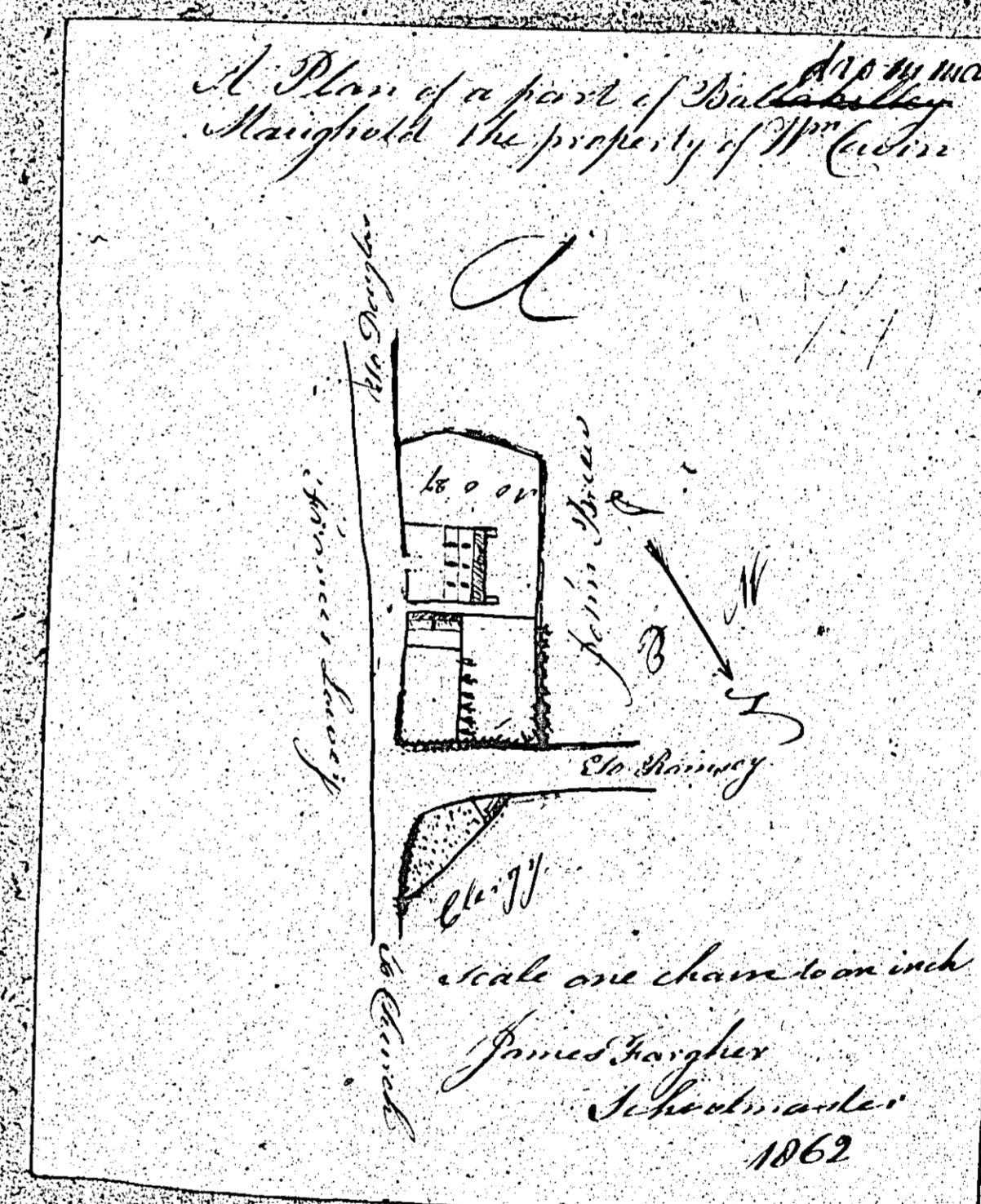

ISLE OF MAN GOVERNMENT: GENERAL REGISTRY

ASYLUM PLANS: PARISH OF MAUGHOLD

Original monotone, marked

1:23

**PLAN**  
of a Part of  
**BALILAKILLY**  
in the PARISH of  
**Maughold**  
The Property of  
**W. KELLY ESQ.**



ISLE OF MAN GOVERNMENT: GENERAL REGISTRY

ASYLUM PLANS: PARISH OF MAUGHOLD

Originals coloured (decorative)

1:23

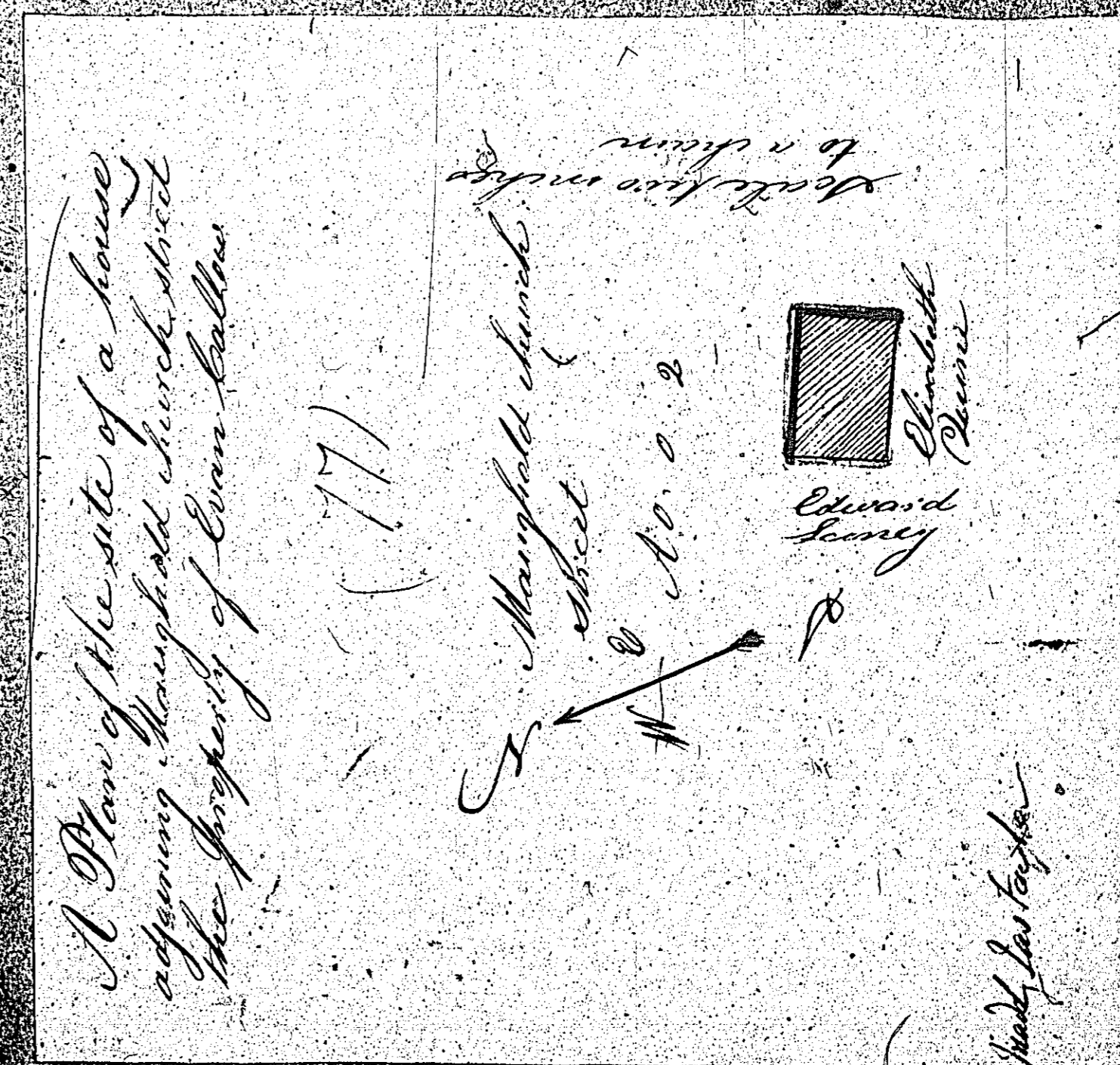
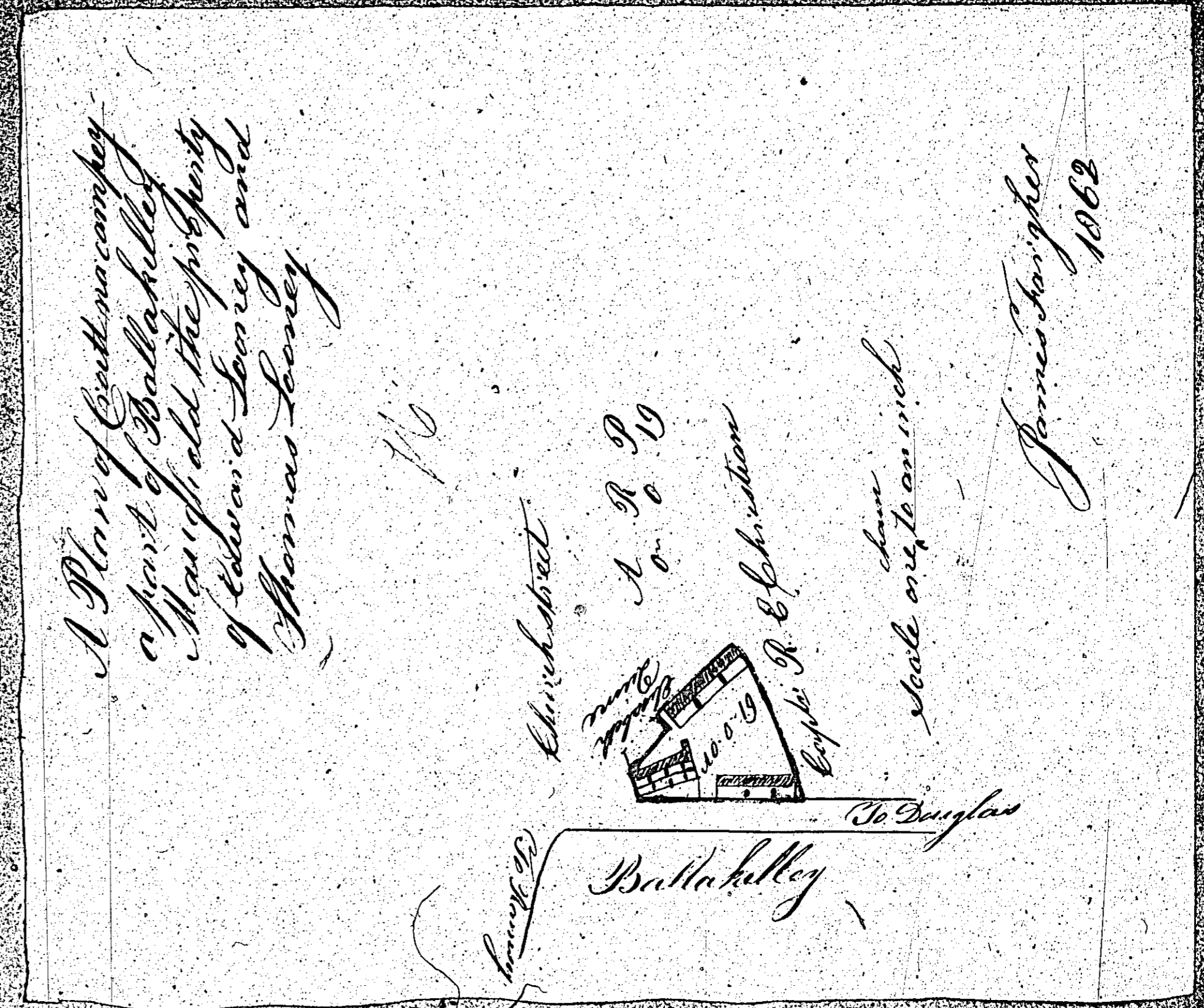

ISLE OF MAN GOVERNMENT: GENERAL REGISTRY

ASYLUM PLANS: PARISH OF MAUGHOLD

Originals coloured (decorative)

1:23

