

PLAN AND SURVEY OF  
 THE "G A T E,"  
 IN THE PARISH OF MALEW, ISLE OF MAN.  
 THE PROPERTY OF WILLIAM QUAYLE.  
 BY PHILIP MYLREA. 1862.

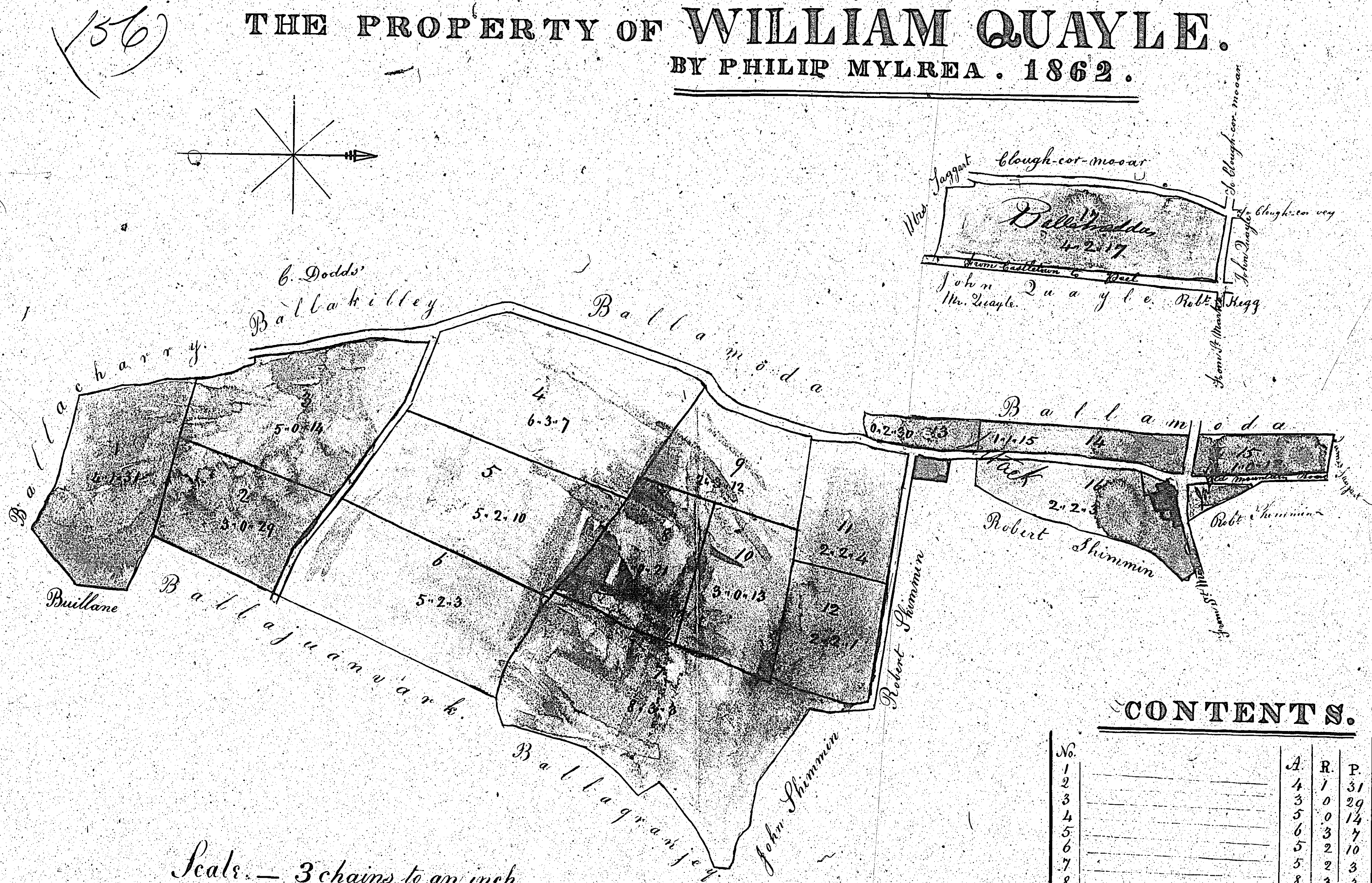

**CONTENTS.**

No.	A.	R.	P.
1			
2	4	7	31
3	3	0	29
4	5	0	14
5	6	3	7
6	5	2	10
7	5	2	3
8	8	3	3
9	3	0	21
10	2	3	12
11	3	0	13
12	2	2	4
13	2	2	1
14	0	2	30
15	1	1	15
16	1	0	12
17	2	2	3
	4	2	17
Yards, street, and garden	0	0	25
Collage and garden &c	0	0	26
Roads	2	1	24
do. by No. 17.	0	2	15
Total	67	0	35

ISLE OF MAN GOVERNMENT: GENERAL REGISTRY

ASYLUM PLANS: PARISH OF MALEW

Original coloured

1:23

(157)

Plan and Survey  
of  
Ballamoda,  
in the Parish of Malew,  
The property of Mr. H. Mylechreest.  
January, 1840.

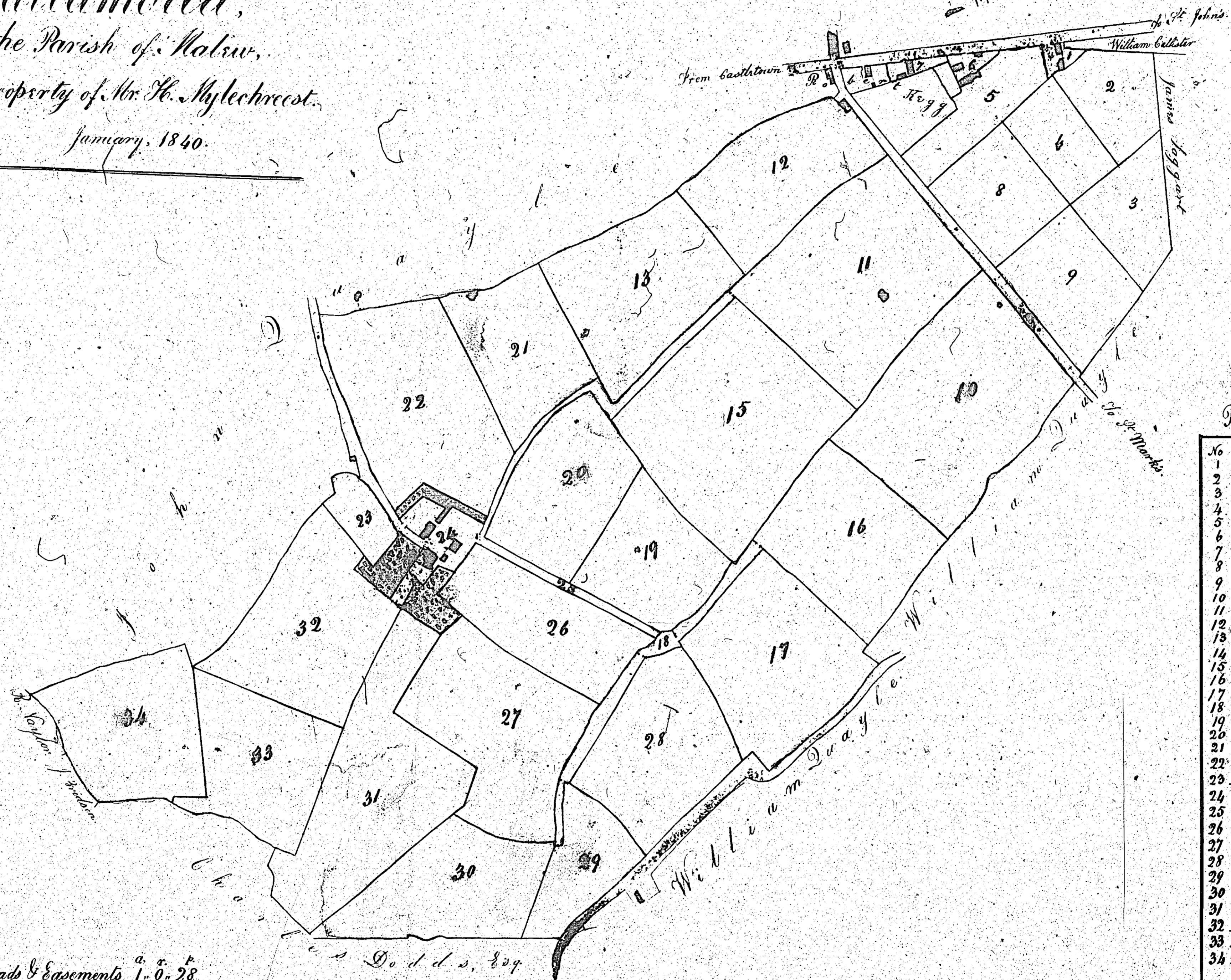

Reference.

No.	a.	r.	p.
1	0	0	34
2	1	1	34
3	1	2	23
4	1	1	15
5	1	1	38
6	0	1	3
7	0	0	23
8	2	0	4
9	2	1	29
10	6	0	28
11	6	0	27
12	3	1	37
13	4	0	34
14	0	2	18
15	6	1	16
16	3	3	27
17	4	1	26
18	0	3	10
19	2	2	30
20	3	0	25
21	2	3	25
22	5	0	16
23	0	2	28
24	1	3	21
25	0	1	10
26	3	0	7
27	4	2	31
28	3	2	36
29	1	2	30
30	3	1	39
31	5	0	34
32	4	1	7
33	3	1	19
34	3	2	21
			96
			3
			35
			1-1-8
			47-1-3

Proportion of Public Roads & Easements a. r. p. 1. 0. 28  
Do. Occupation Do. 0. 0. 20

10 chains.  
Jefferson and Kayll, Surveyors, Douglas.  
Copied and alterations made therein  
By Philip Myhra. 1863.

ISLE OF MAN GOVERNMENT: GENERAL REGISTRY

ASYLUM PLANS: PARISH OF MALEW

Original coloured

157

ISLE OF MAN GOVERNMENT: GENERAL REGISTRY

ASYLUM PLANS: PARISH OF MALEW

- 158 Original coloured, marked
- 159 Original coloured

1:23

*Malew*

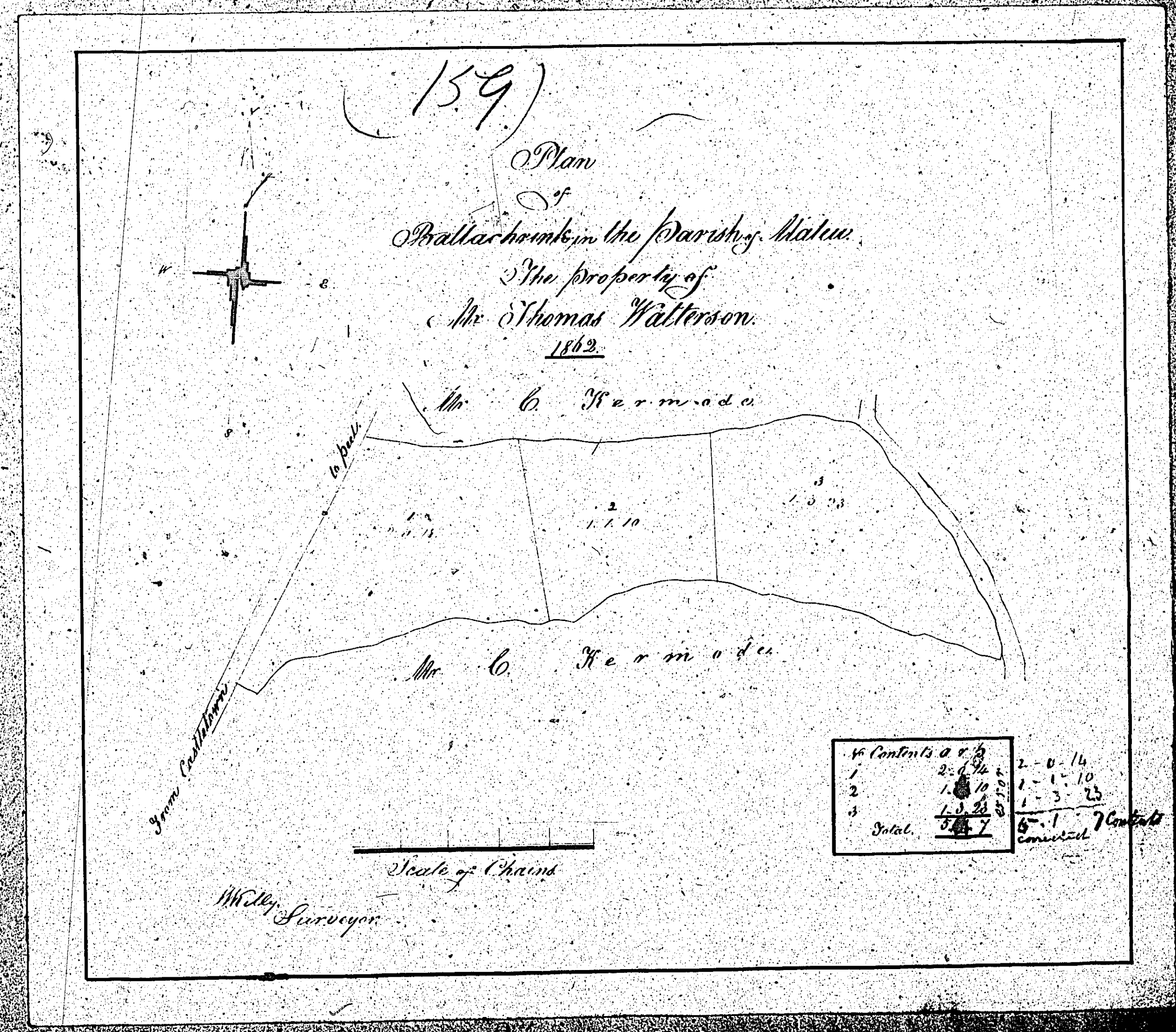
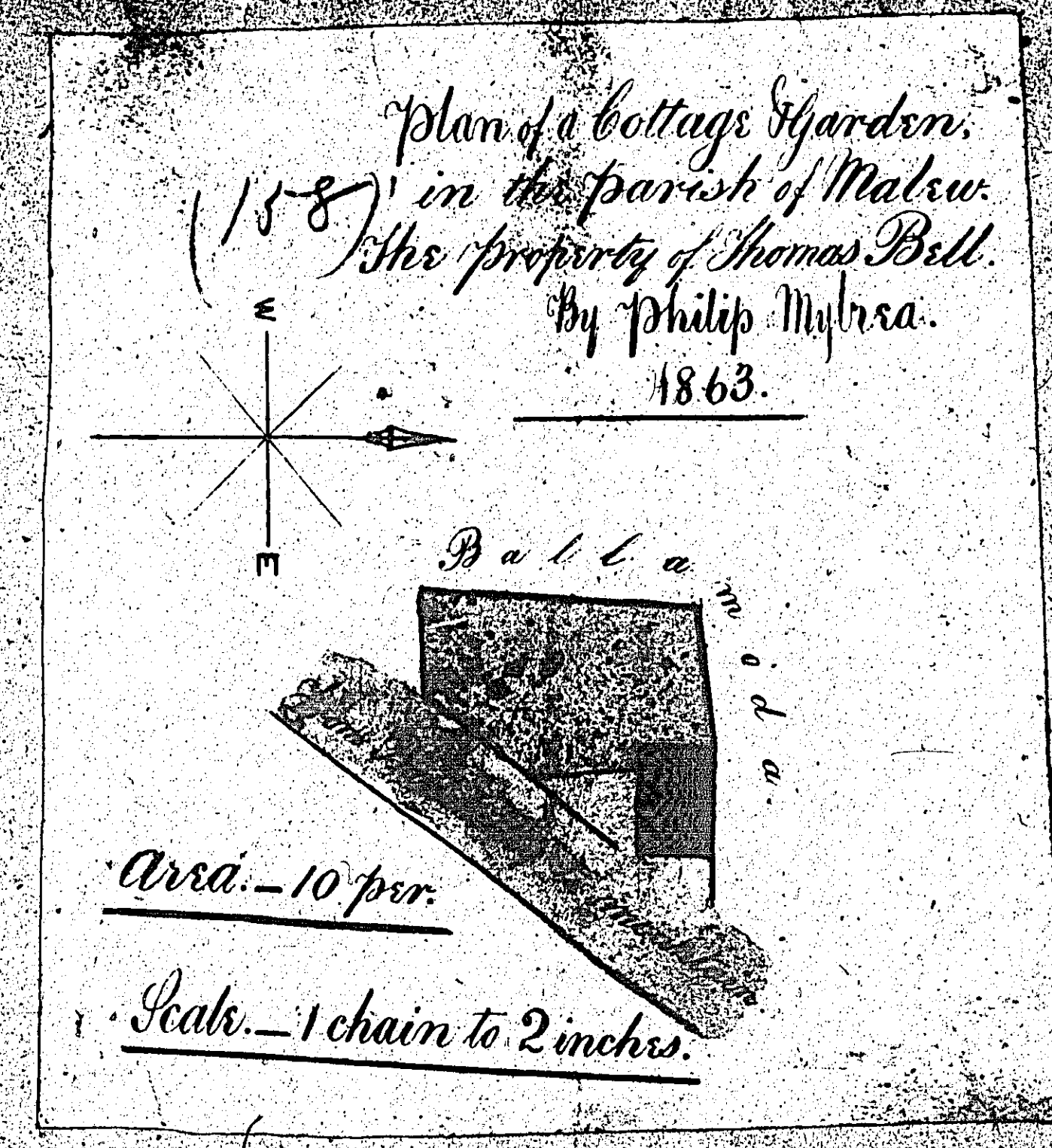

ISLE OF MAN GOVERNMENT: GENERAL REGISTRY

ASYLUM PLANS: PARISH OF MALEW

Original coloured (decorative)

1:23

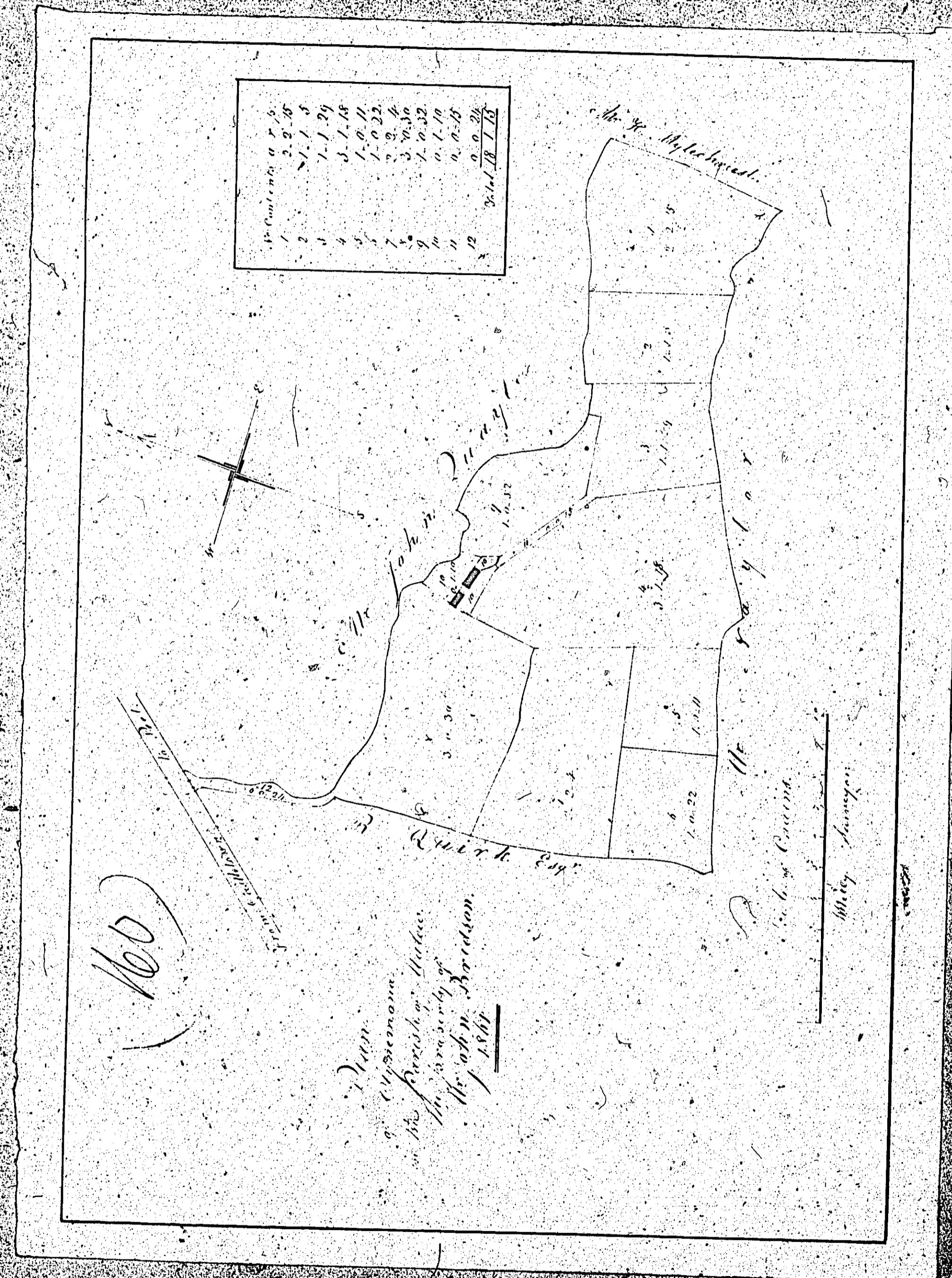

ISLE OF MAN GOVERNMENT: GENERAL REGISTRY

ASYLUM PLANS: PARISH OF MALEW

Original coloured

1:23

