

ISLE OF MAN GOVERNMENT: GENERAL REGISTRY  
 ASYLUM PLANS: PARISH OF LEZAYRE

Original monotone

1:23

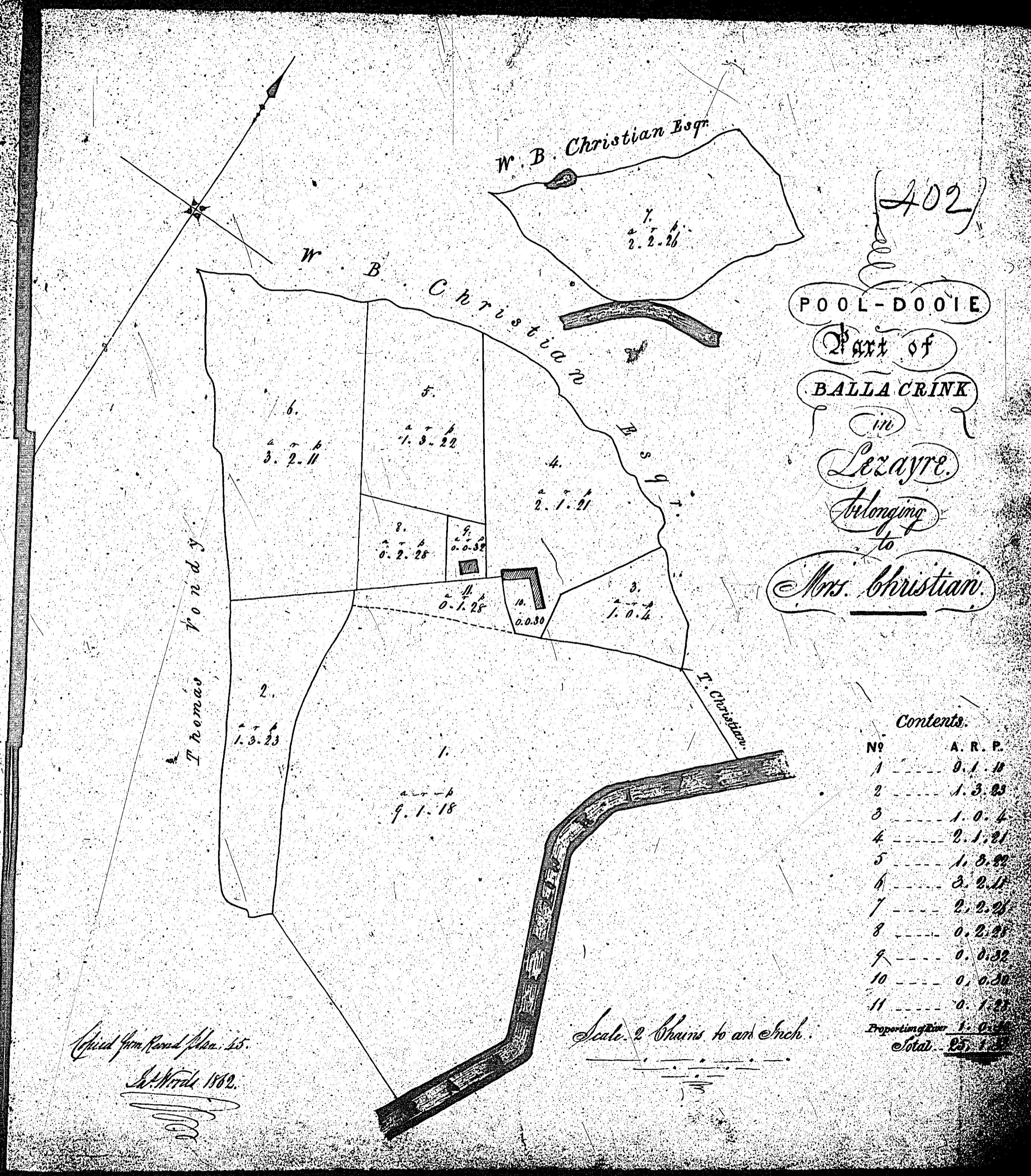

402

Contents.

NO	A. R. P.
1	9.1.18
2	1.3.23
3	1.0.4
4	2.1.21
5	1.3.22
6	3.2.11
7	2.2.26
8	0.2.28
9	0.0.32
10	0.0.30
11	0.1.21
Proportion given 1.0.18	
Total 25.1.22	

ISLE OF MAN GOVERNMENT: GENERAL REGISTRY

ASYLUM PLANS: PARISH OF LEZAYRE

Original coloured

1:23

frame 1 of 2

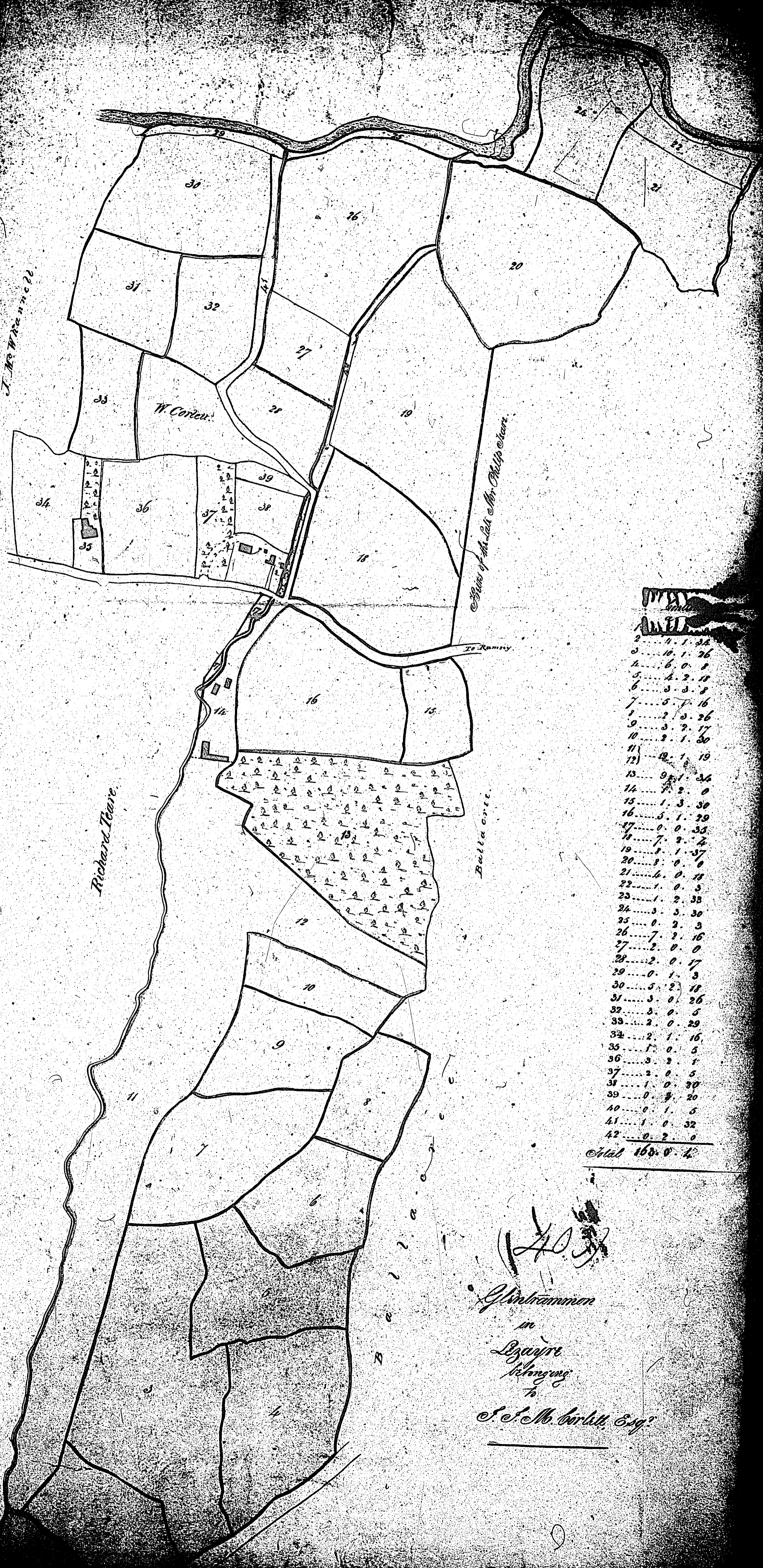

1	4.1.26
2	10.1.26
3	6.0.1
4	4.2.18
5	3.3.8
6	5.7.16
7	2.5.26
8	3.7.17
9	3.1.30
10	12.1.19
11	0.1.36
12	7.2.0
13	1.3.30
14	5.1.29
15	0.0.35
16	7.2.2
17	1.1.37
18	8.0.6
19	6.0.18
20	1.0.5
21	1.2.33
22	3.5.30
23	0.2.3
24	7.1.16
25	2.0.0
26	2.0.17
27	0.1.3
28	5.2.18
29	3.0.26
30	5.0.5
31	2.0.29
32	2.1.16
33	1.0.5
34	3.3.1
35	3.0.5
36	1.0.30
37	0.3.20
38	0.1.5
39	1.0.32
40	0.2.0
41	0.2.0
42	0.2.0

Total 160.0.4

403  
G. Strømmer  
in  
Lezayre  
belonging  
to  
S. S. M. Corbett Esq.

ISLE OF MAN GOVERNMENT: GENERAL REGISTRY

ASYLUM PLANS: PARISH OF LEZAYRE

Original coloured

1:23

frame 2 of 2

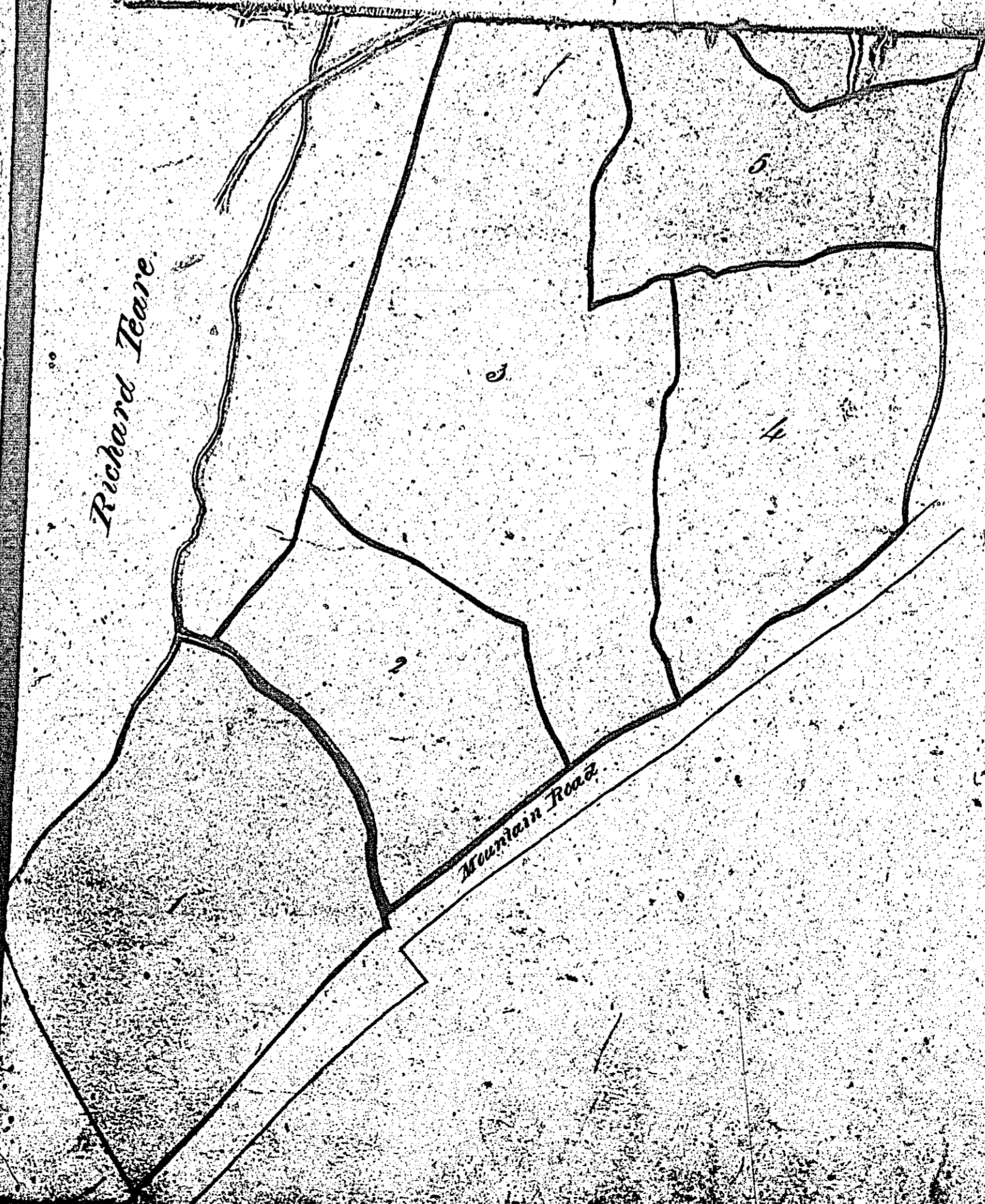

*Glentramman*  
 in  
 Lezayre  
 belonging  
 to  
 S. C. M. Corbett, Esq.

Note - *Glentramman* is coloured Green  
*Glenduff* is Yellow  
 Intacks are Pink  
 Examined by J. W. C. H.

*Arthur Morgan*

4-6  
 96-8-6  
 68/11





