

ISLE OF MAN GOVERNMENT: GENERAL REGISTRY

ASYLUM PLANS: PARISH OF LEZAYRE

Originals monotone

1:23

Part of Ballachink
 Quarreland in
 Lezayre
 the property of
 Mr. Wm Christian

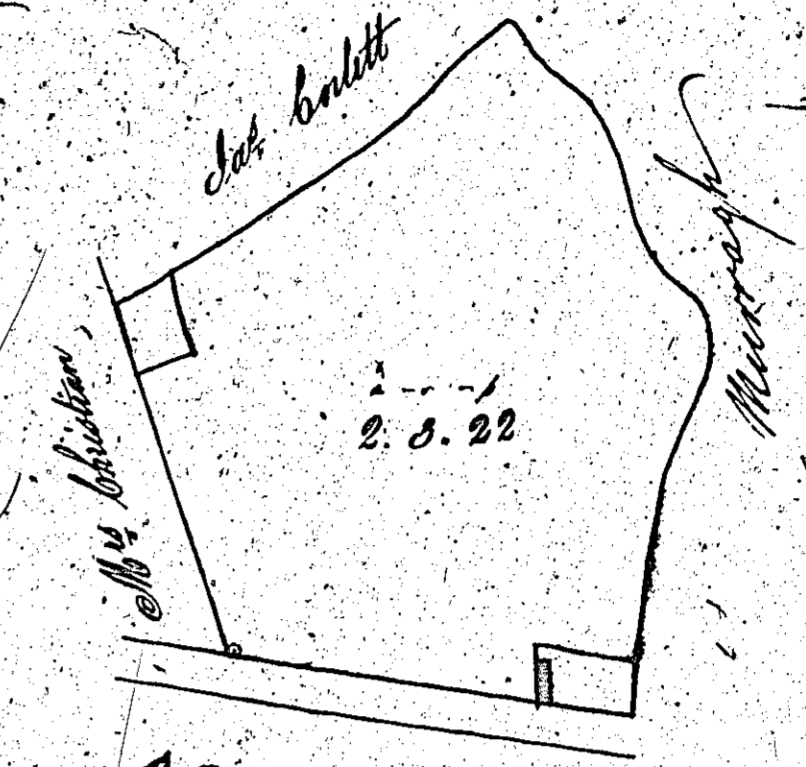

Scale - 2 Chains to an Inch.

Contents - 2. 5. 22

James Woods
 Surveyor 1862

Part of Ballachink
 in Lezayre,
 belonging to
 Mr. James Corbett.

Contents

n.	a. r. p.
1	1. 3. 24
2	1. 1. 38
3	1. 1. 36
4	5. 1. 24
Total	10. 1. 2

385

Scale: Two Chains to an Inch.

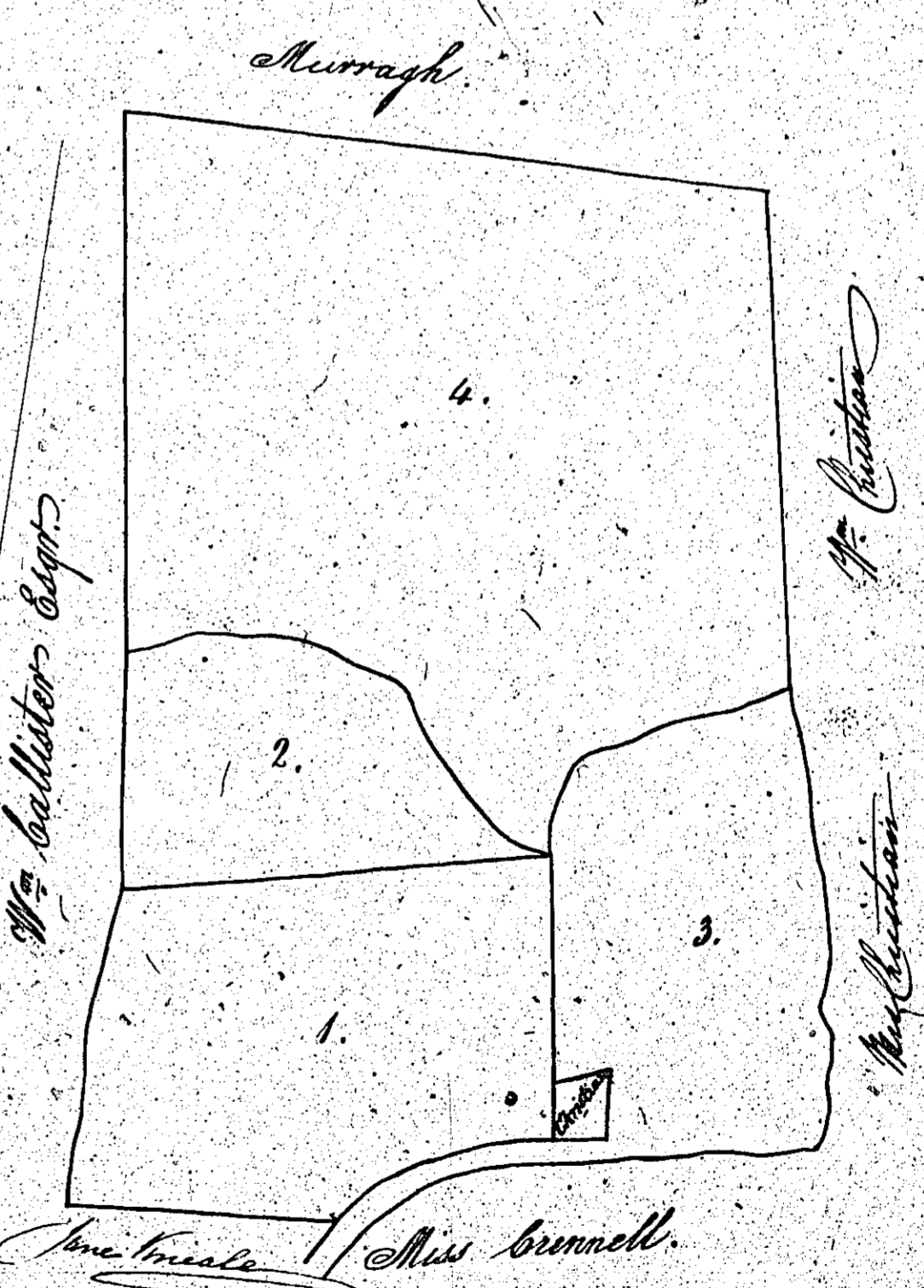

James Woods, Surveyor, 1862.

Copied from Record plan N^o. 140

ISLE OF MAN GOVERNMENT: GENERAL REGISTRY

ASYLUM PLANS: PARISH OF LEZAYRE

Originals monotone

1:23

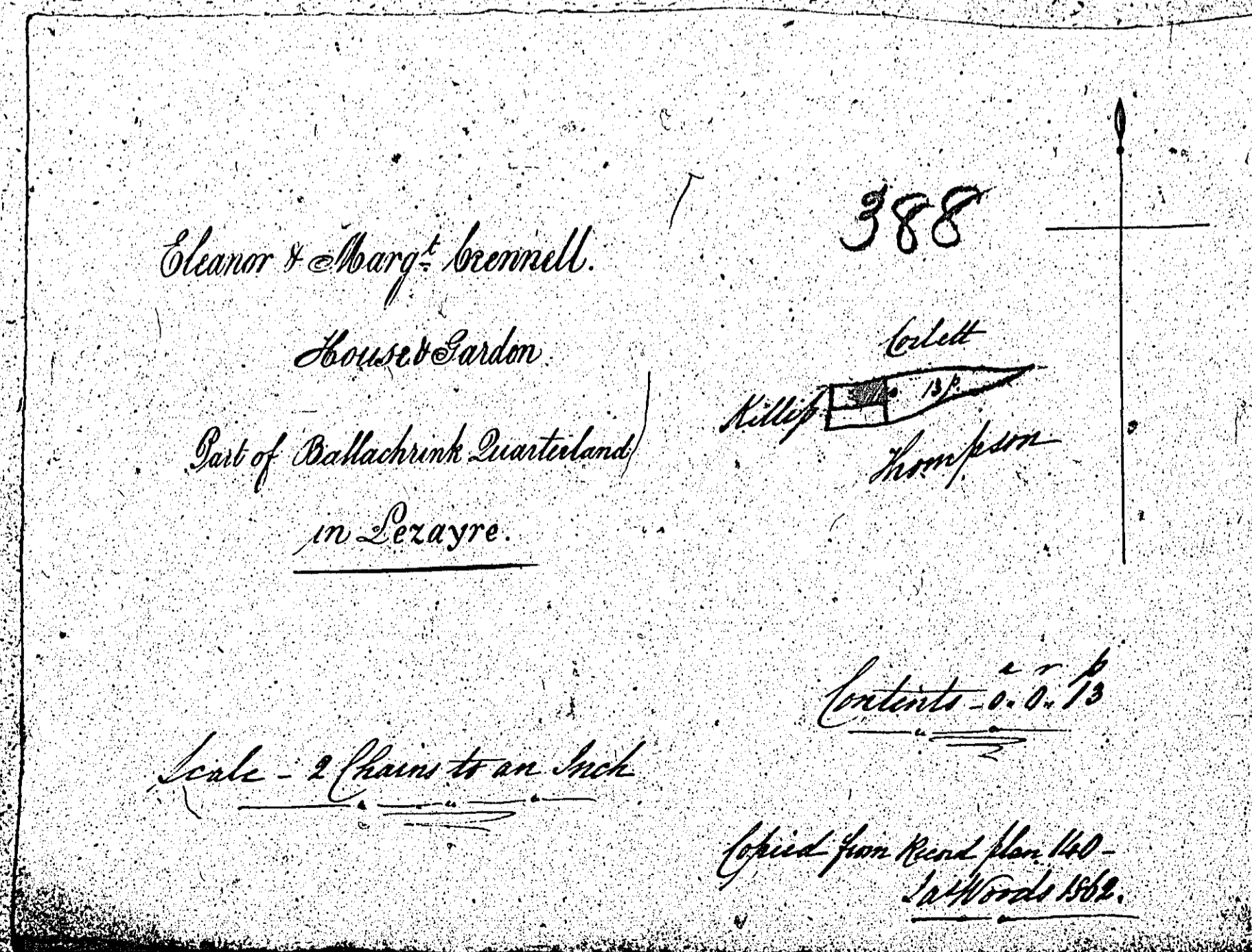
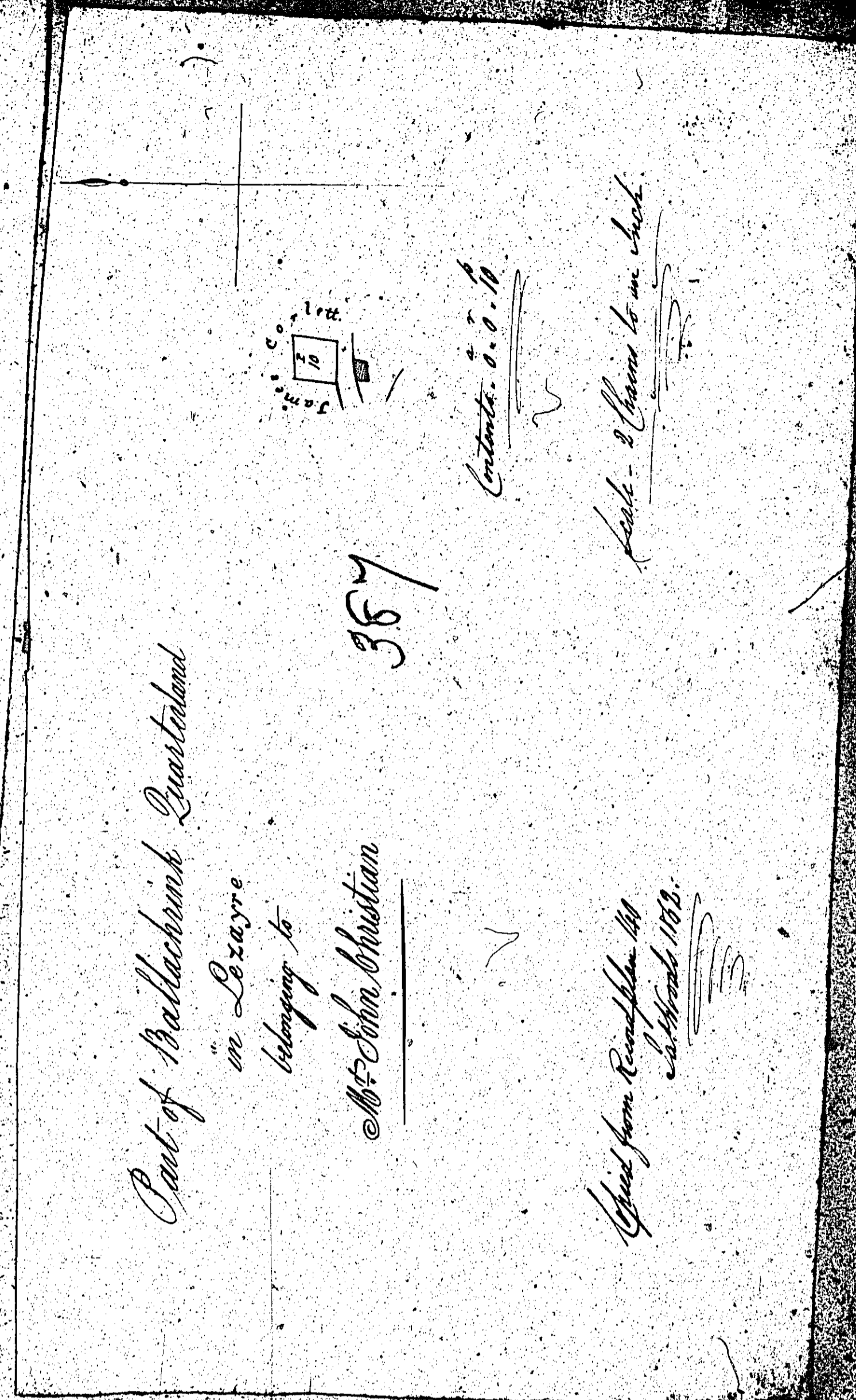
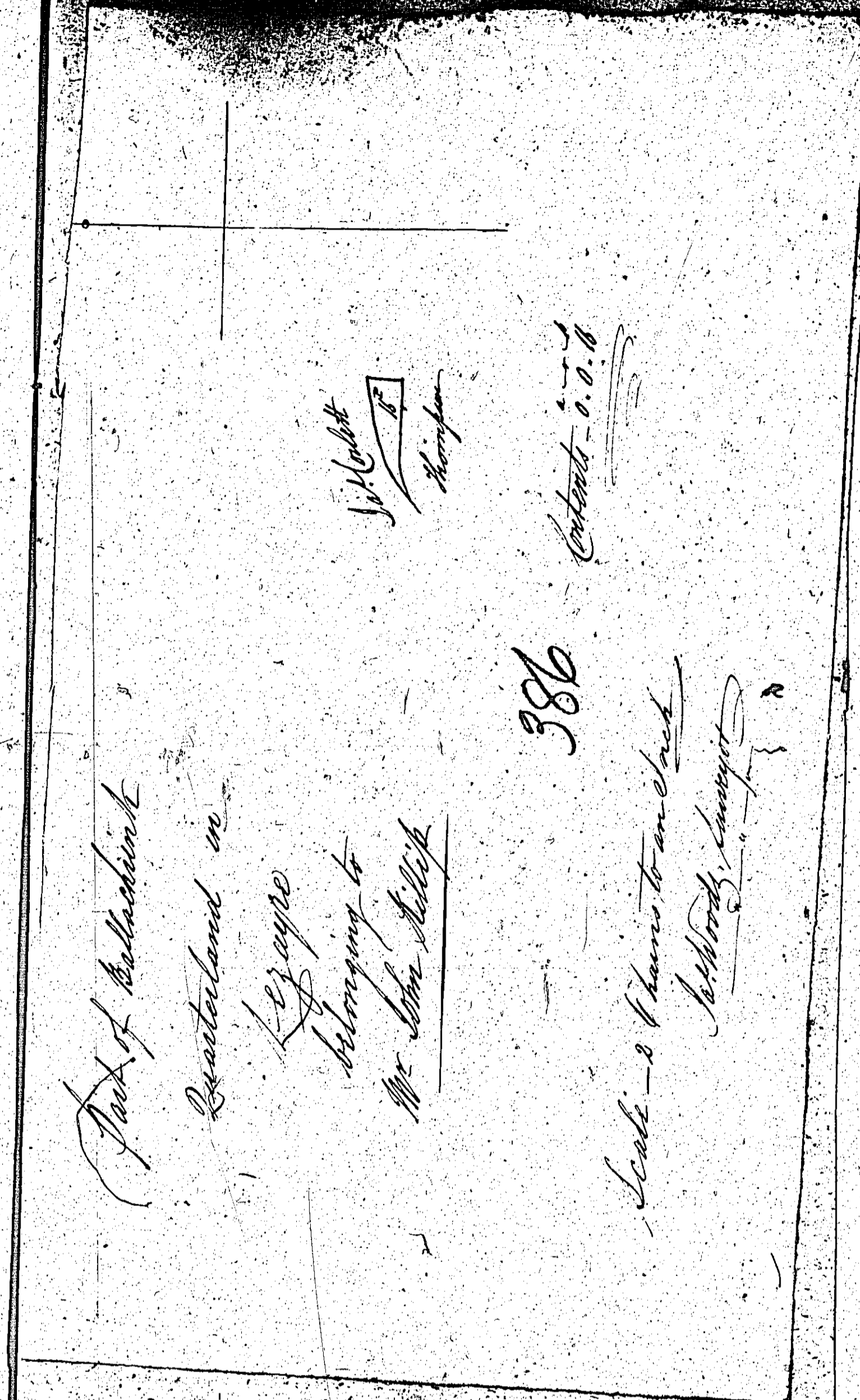

The following two
plans are both
numbered

389

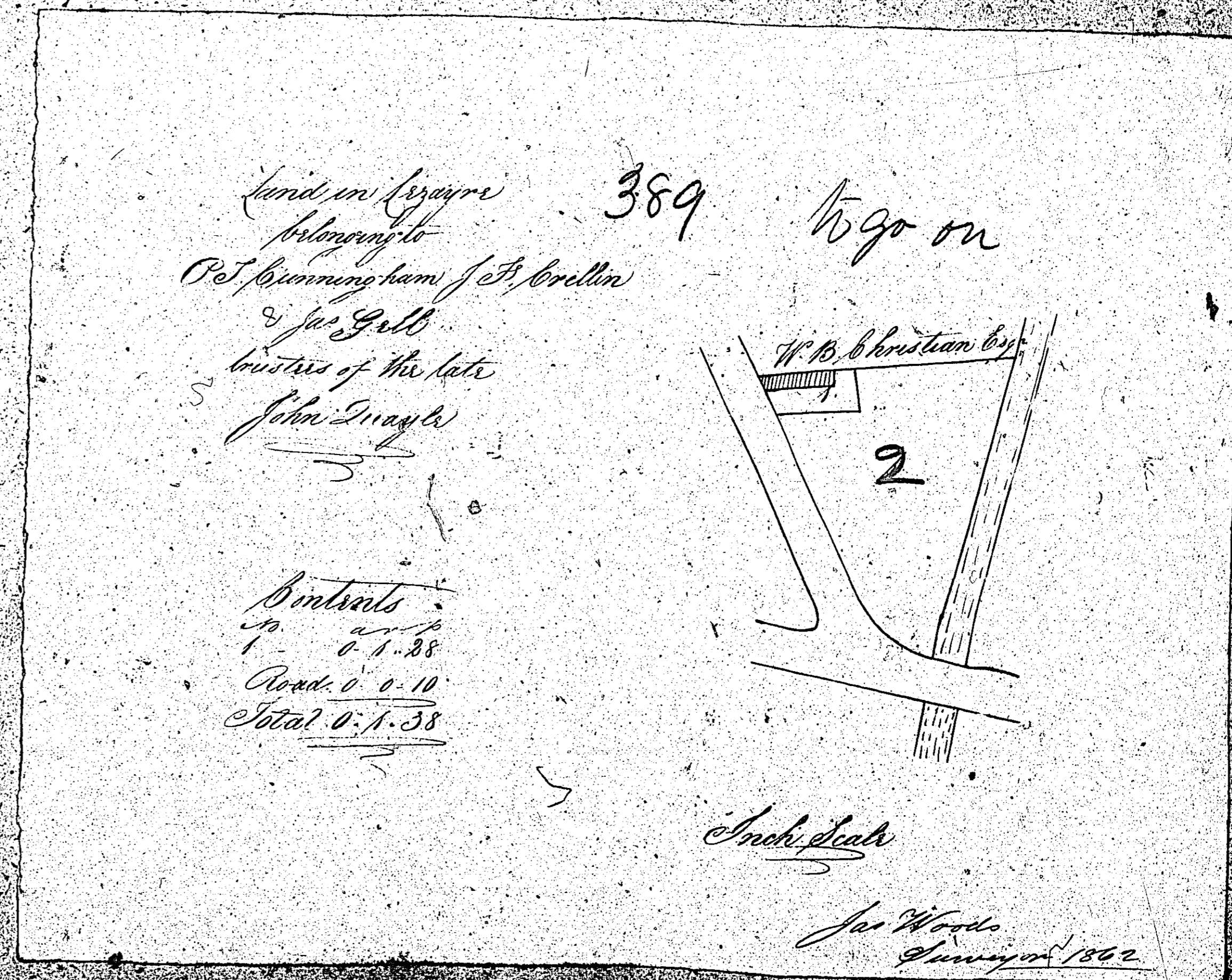
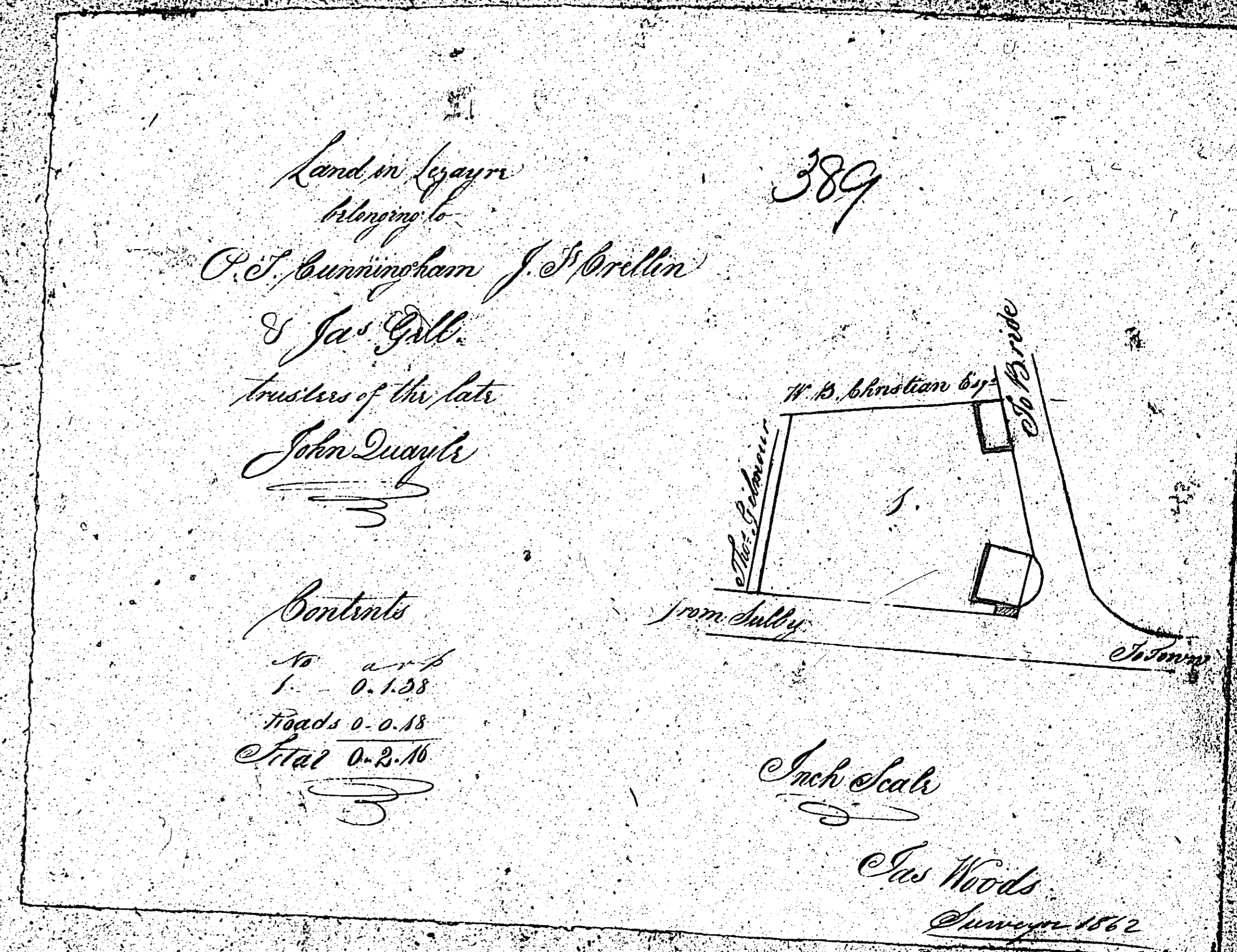

ISLE OF MAN GOVERNMENT: GENERAL REGISTRY

ASYLUM PLANS: PARISH OF LEZAYRE

Originals monotone

1:23

ISLE OF MAN GOVERNMENT: GENERAL REGISTRY

ASYLUM PLANS: PARISH OF LEZAYRE

Original monotone

1:23

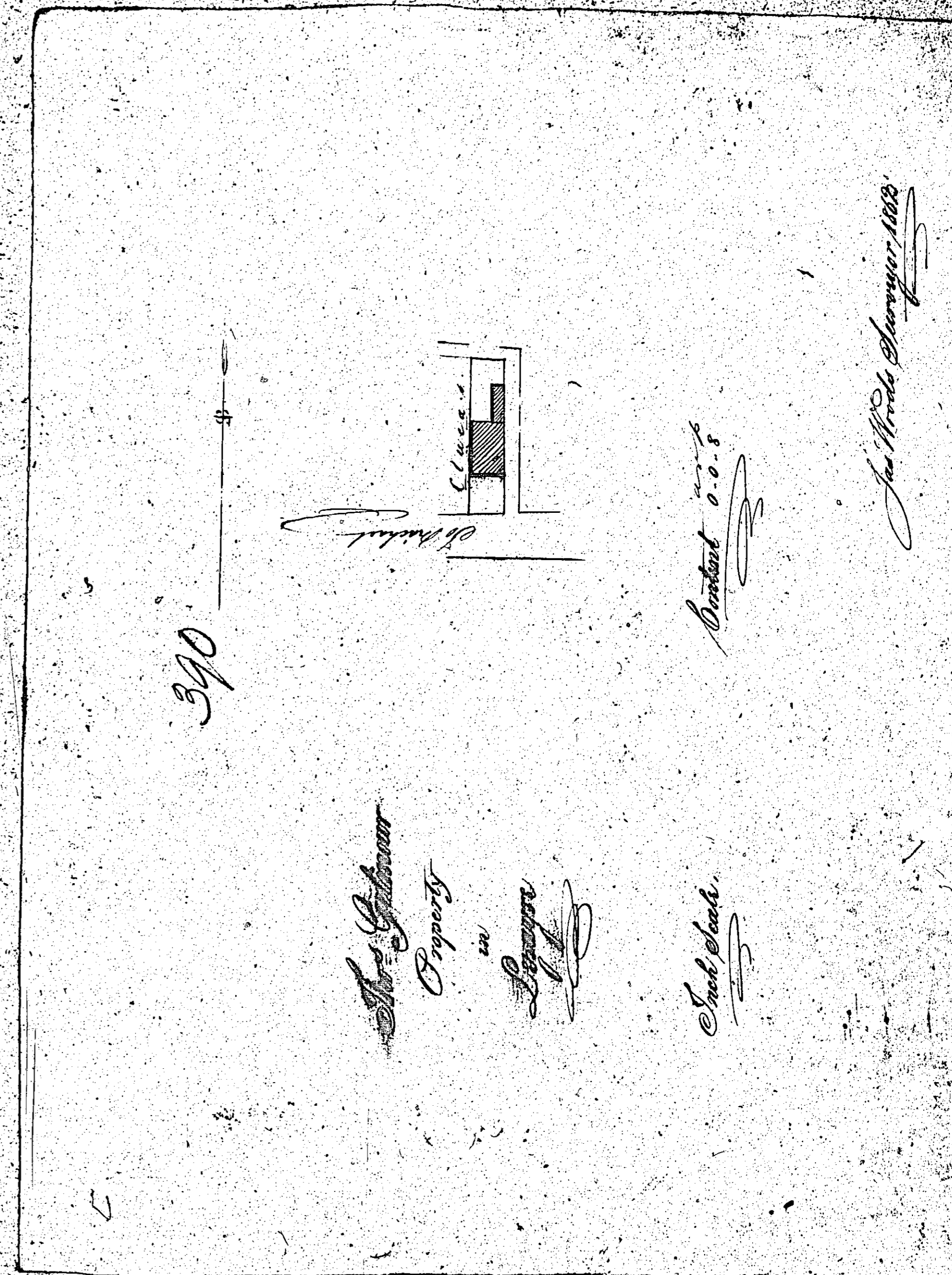

ISLE OF MAN GOVERNMENT: GENERAL REGISTRY

ASYLUM PLANS: PARISH OF LEZAYRE

Original monotone

1:23

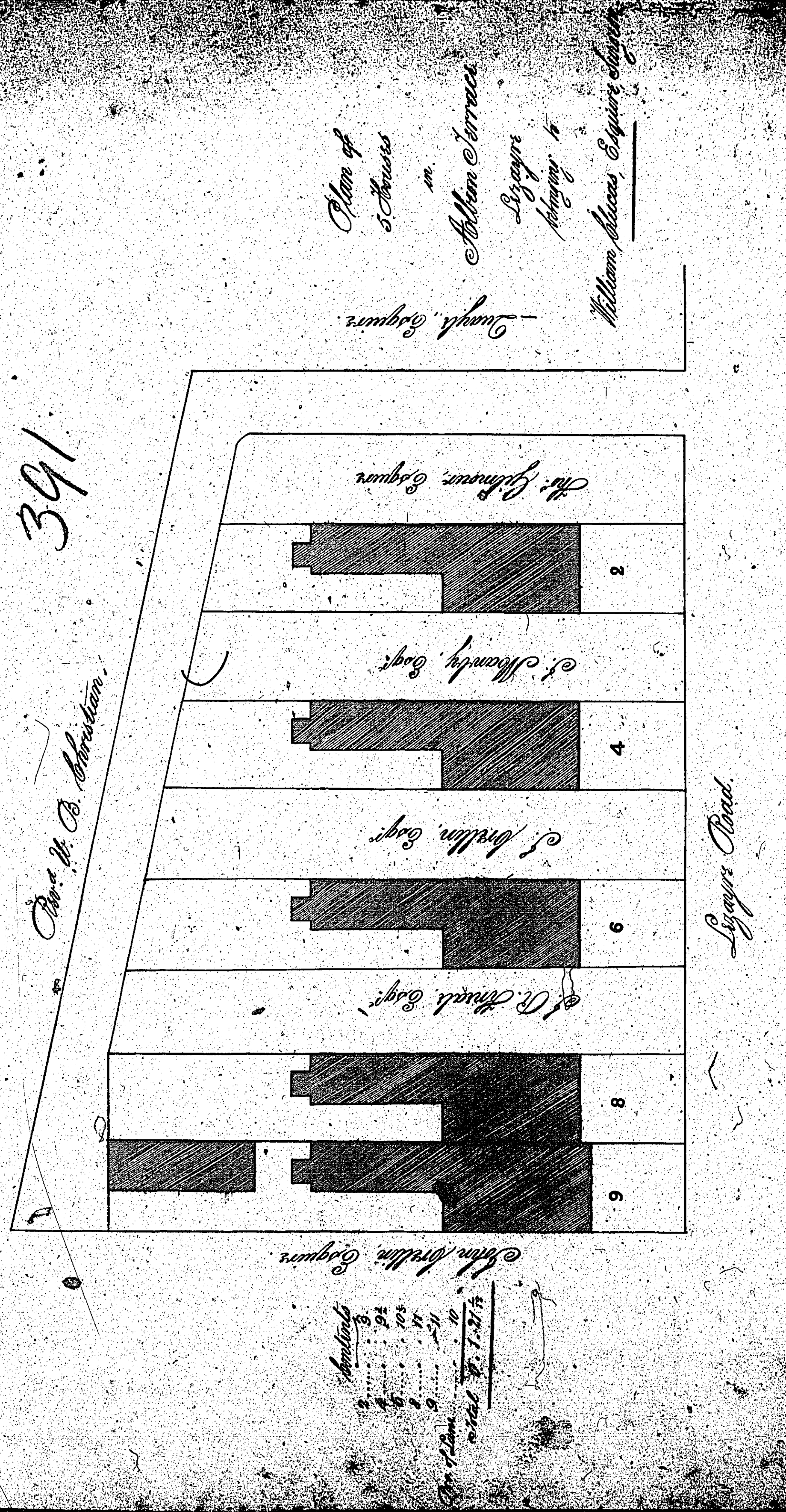

ISLE OF MAN GOVERNMENT: GENERAL REGISTRY
 ASYLUM PLANS: PARISH OF LEZAYRE

Originals monotone 1:23

