

ISLE OF MAN GOVERNMENT: GENERAL REGISTRY

ASYLUM PLANS: PARISH OF LEZAYRE

Original coloured, marked

1:23

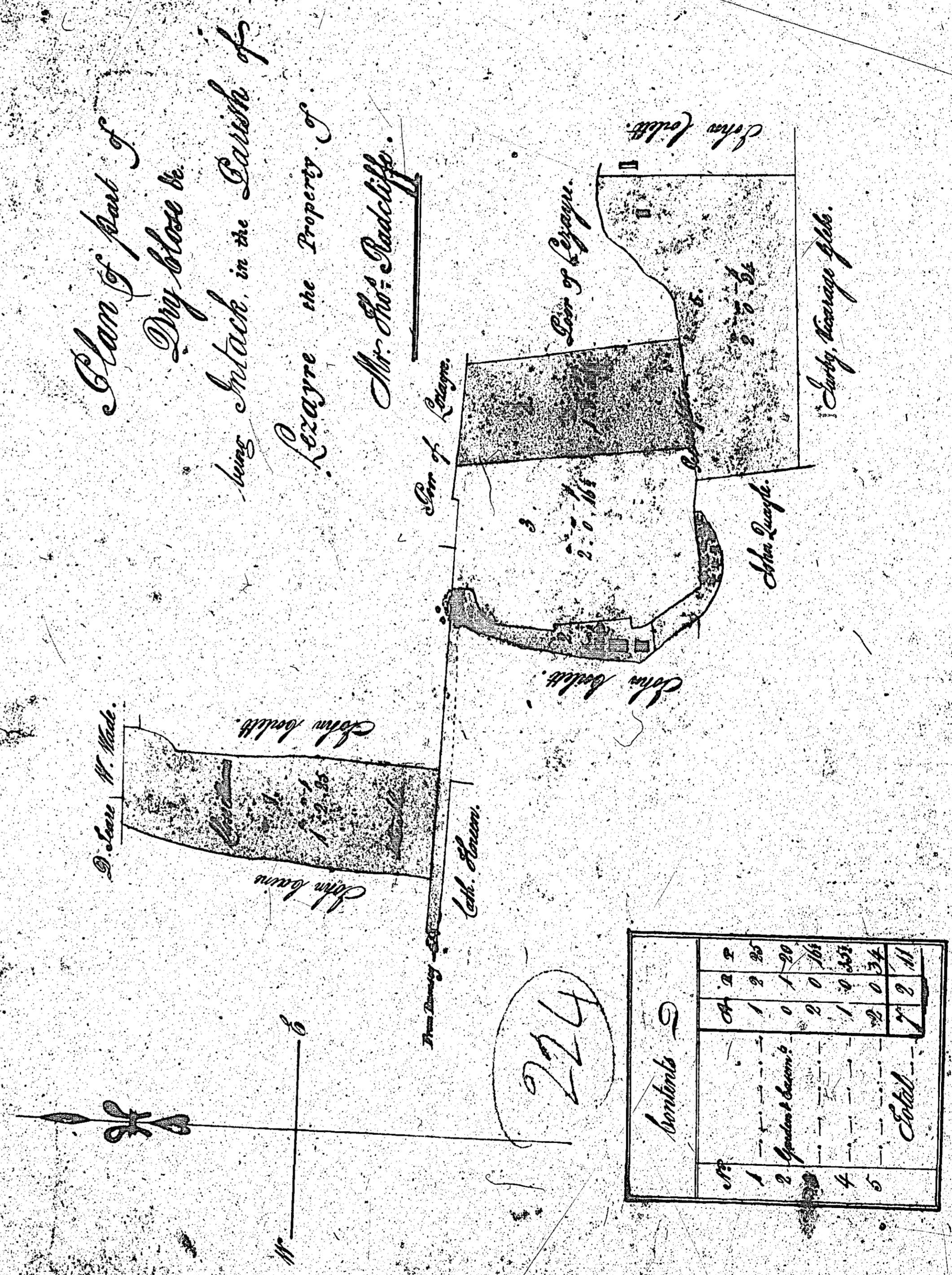

J. C. Page Surveyor 1869.

ISLE OF MAN GOVERNMENT: GENERAL REGISTRY
ASYLUM PLANS: PARISH OF LEZAYRE

Originals monotone

1:23

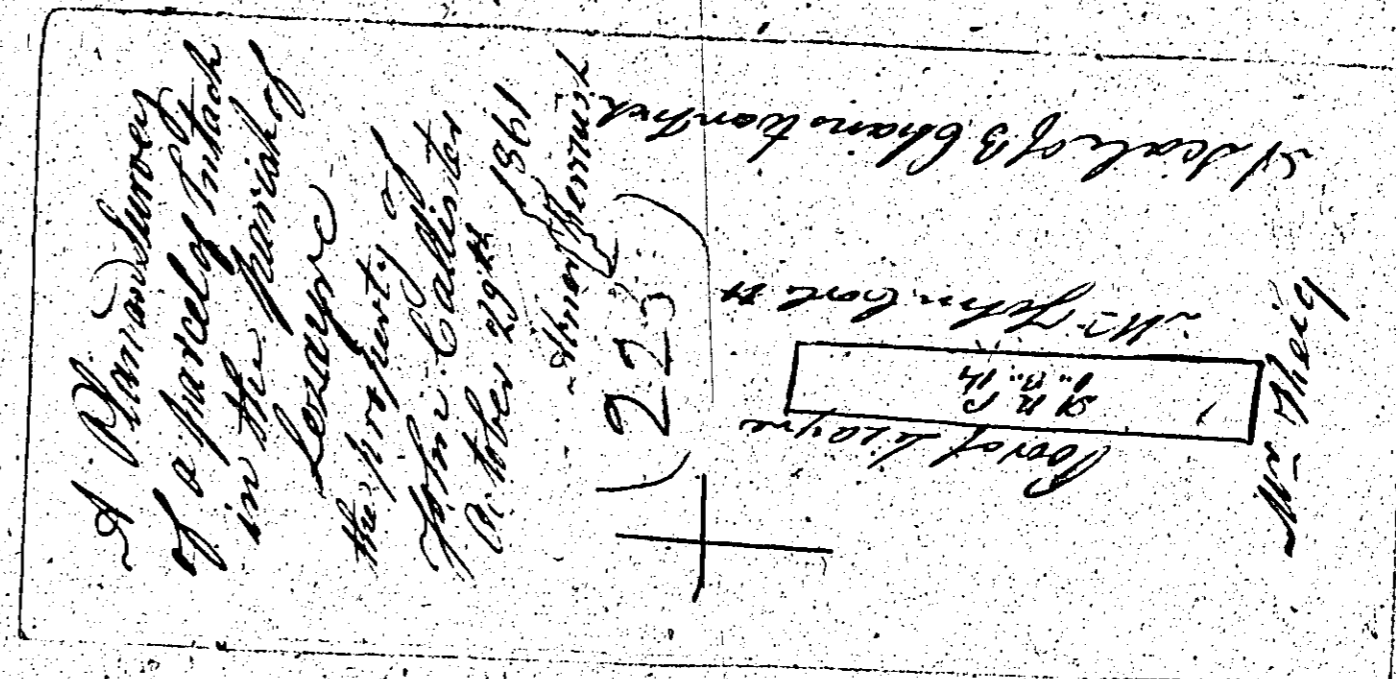

Plan of part of Dry Close
in the parish of Lezayre
the Property of
Mr. John Corlett

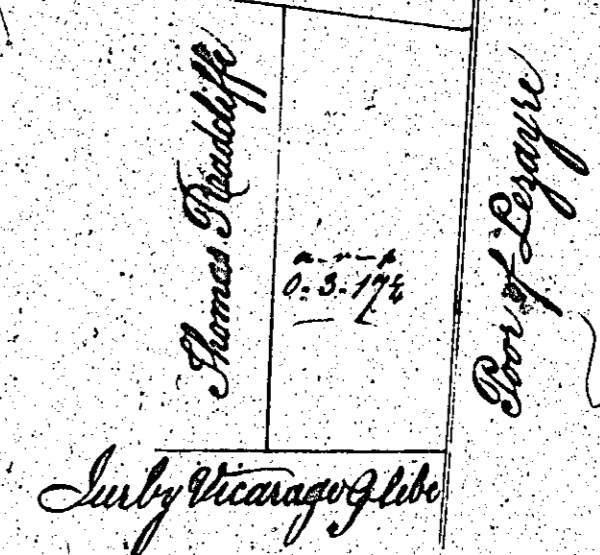

226

Scale of two Chains to One Inch

Contents

0.5.74

James Woods
Surveyor 1862

ISLE OF MAN GOVERNMENT: GENERAL REGISTRY

ASYLUM PLANS: PARISH OF LEZAYRE

Originals monotone

1:23

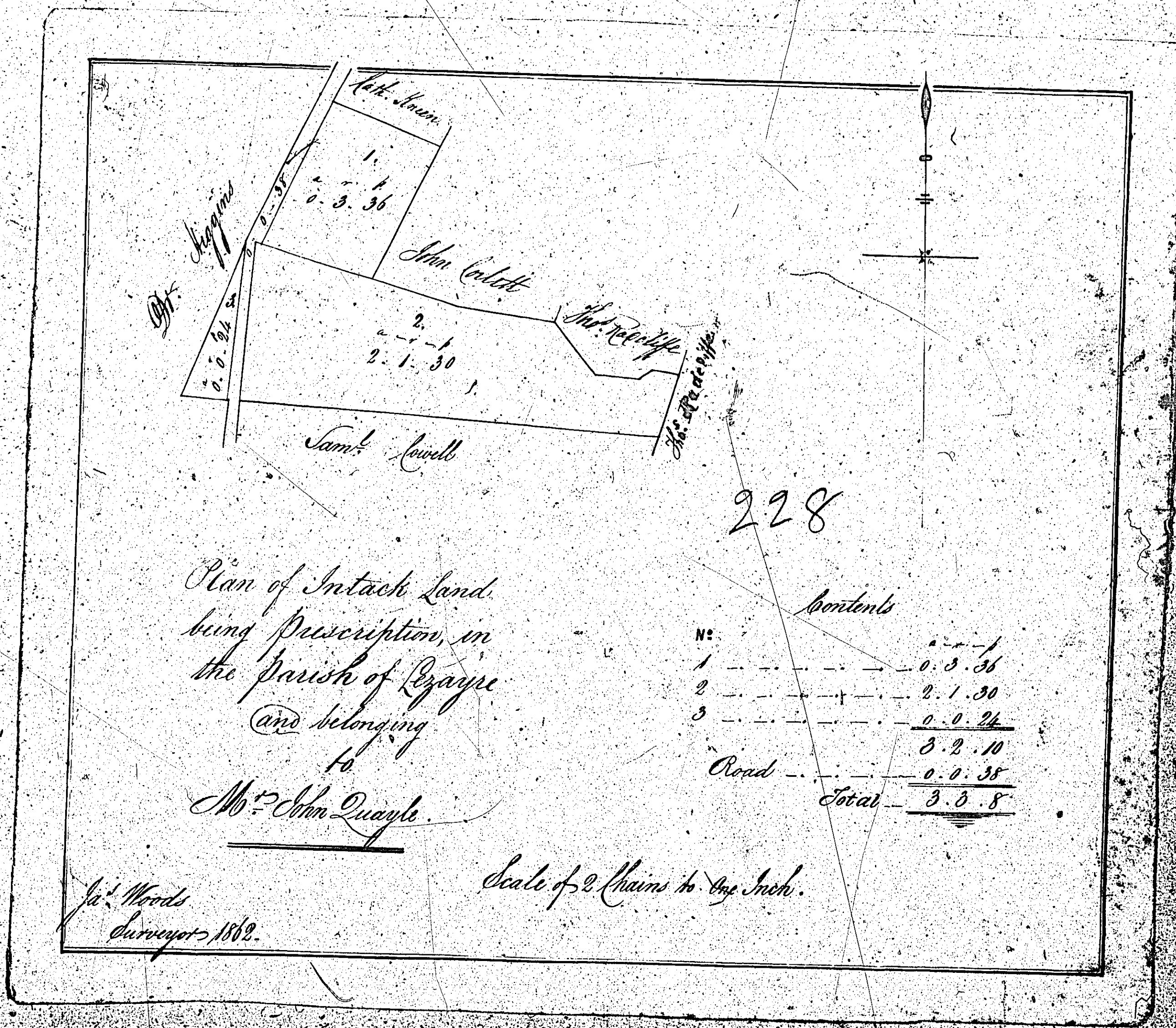
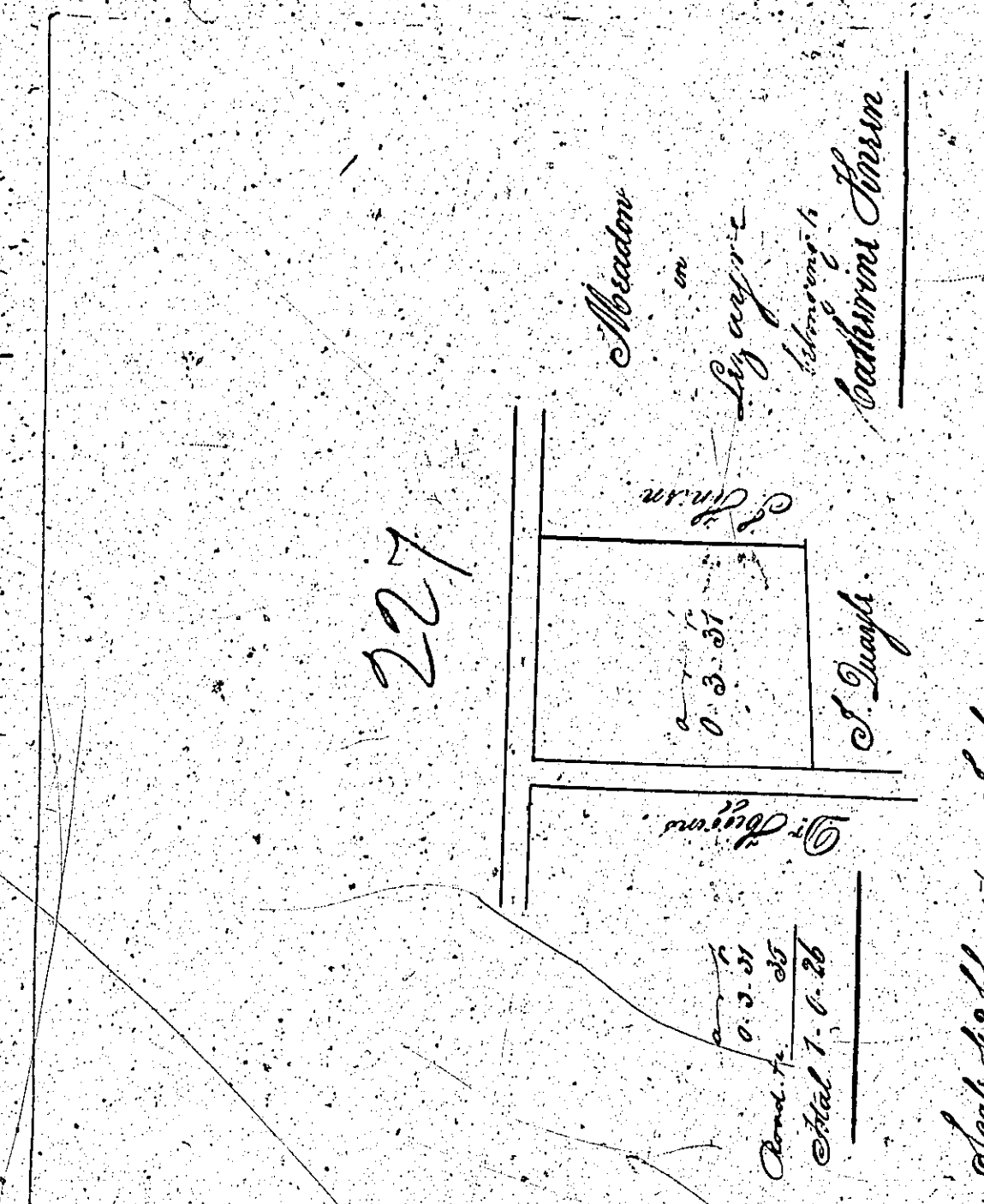

ISLE OF MAN GOVERNMENT: GENERAL REGISTRY

ASYLUM PLANS: PARISH OF LEZAYRE

- 229 Original coloured (decorative)
- 230 Original monotone

1:23

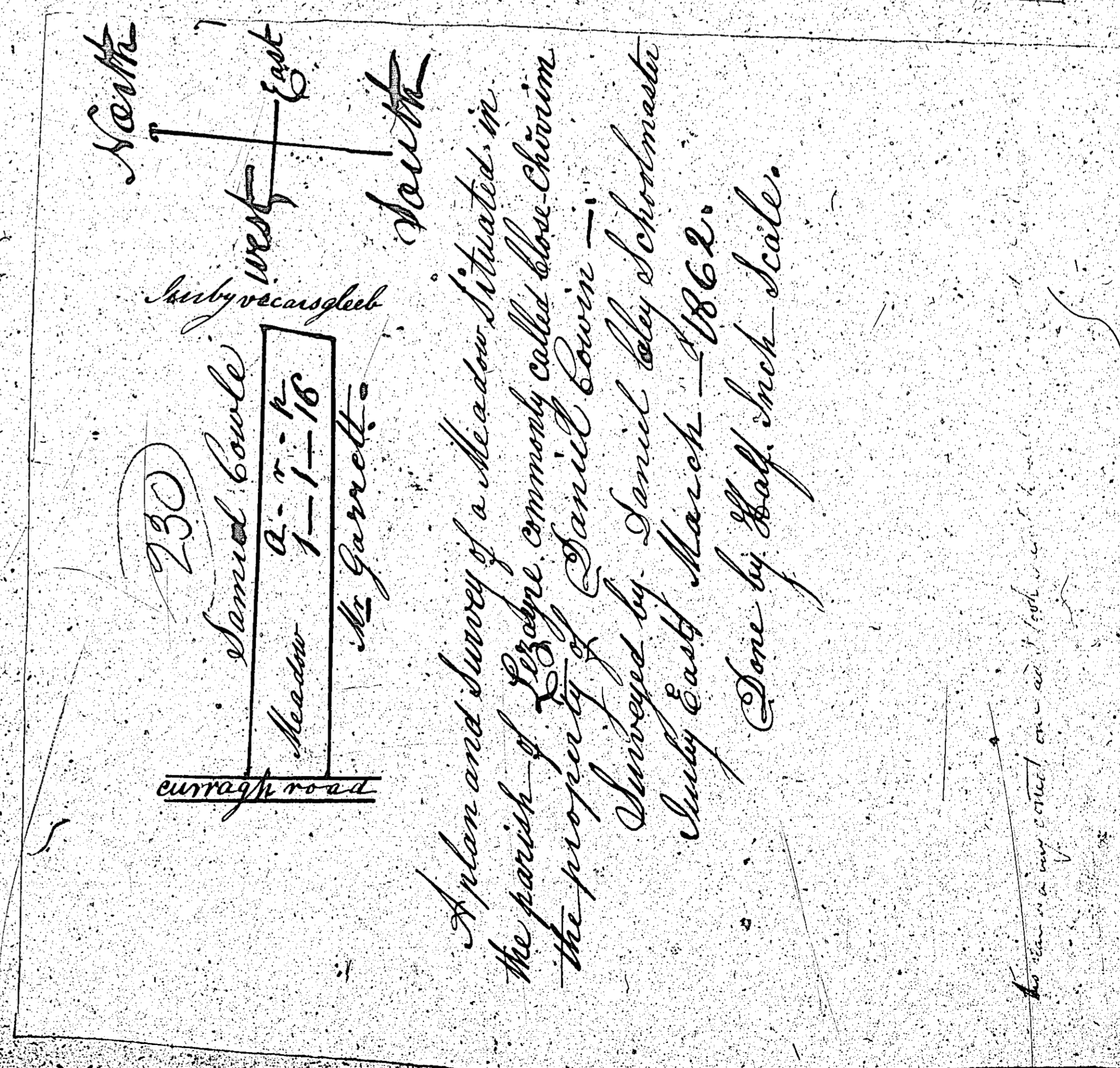
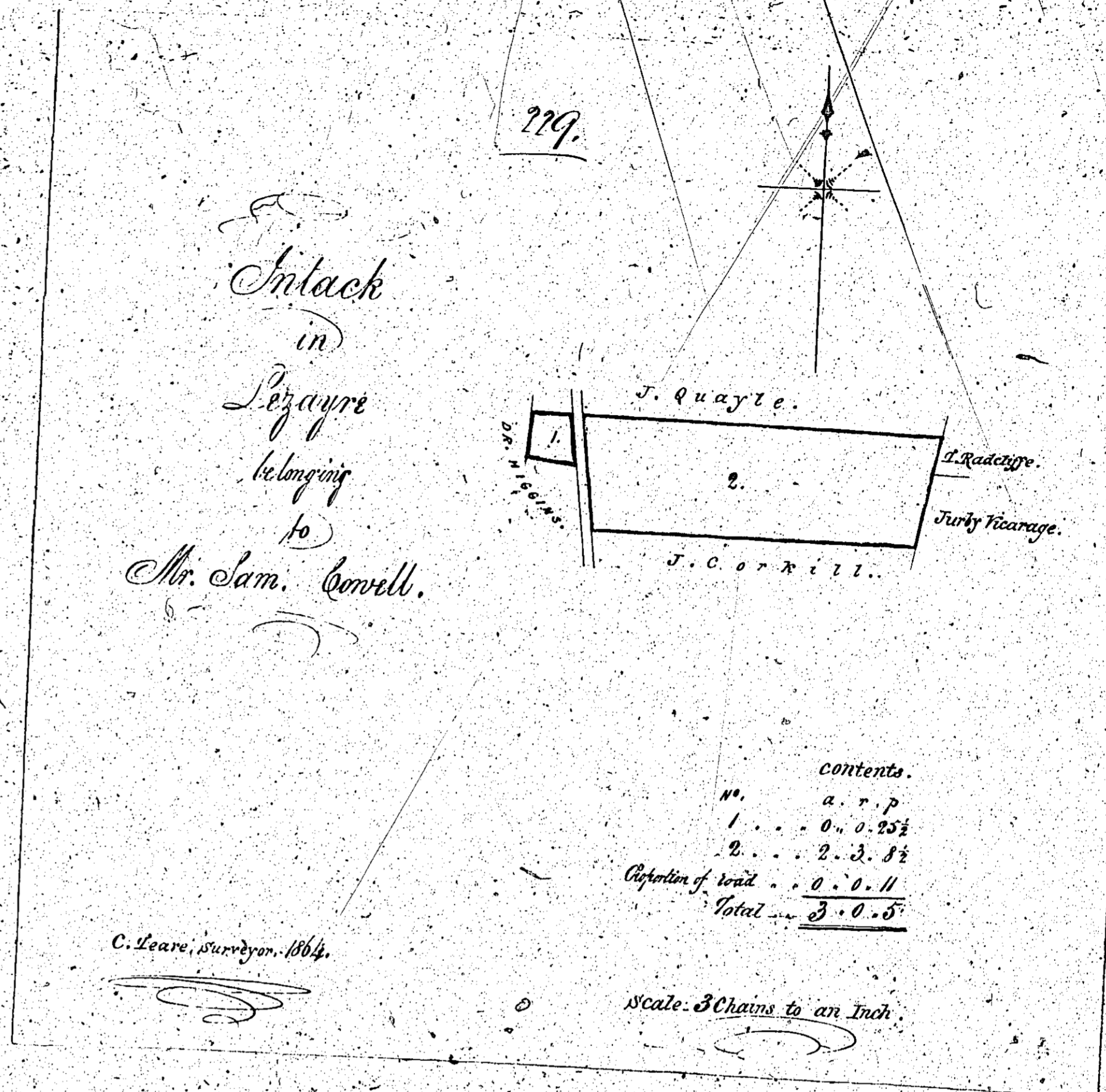

ISLE OF MAN GOVERNMENT: GENERAL REGISTRY

ASYLUM PLANS: PARISH OF LEZAYRE

Original monotone

1:23

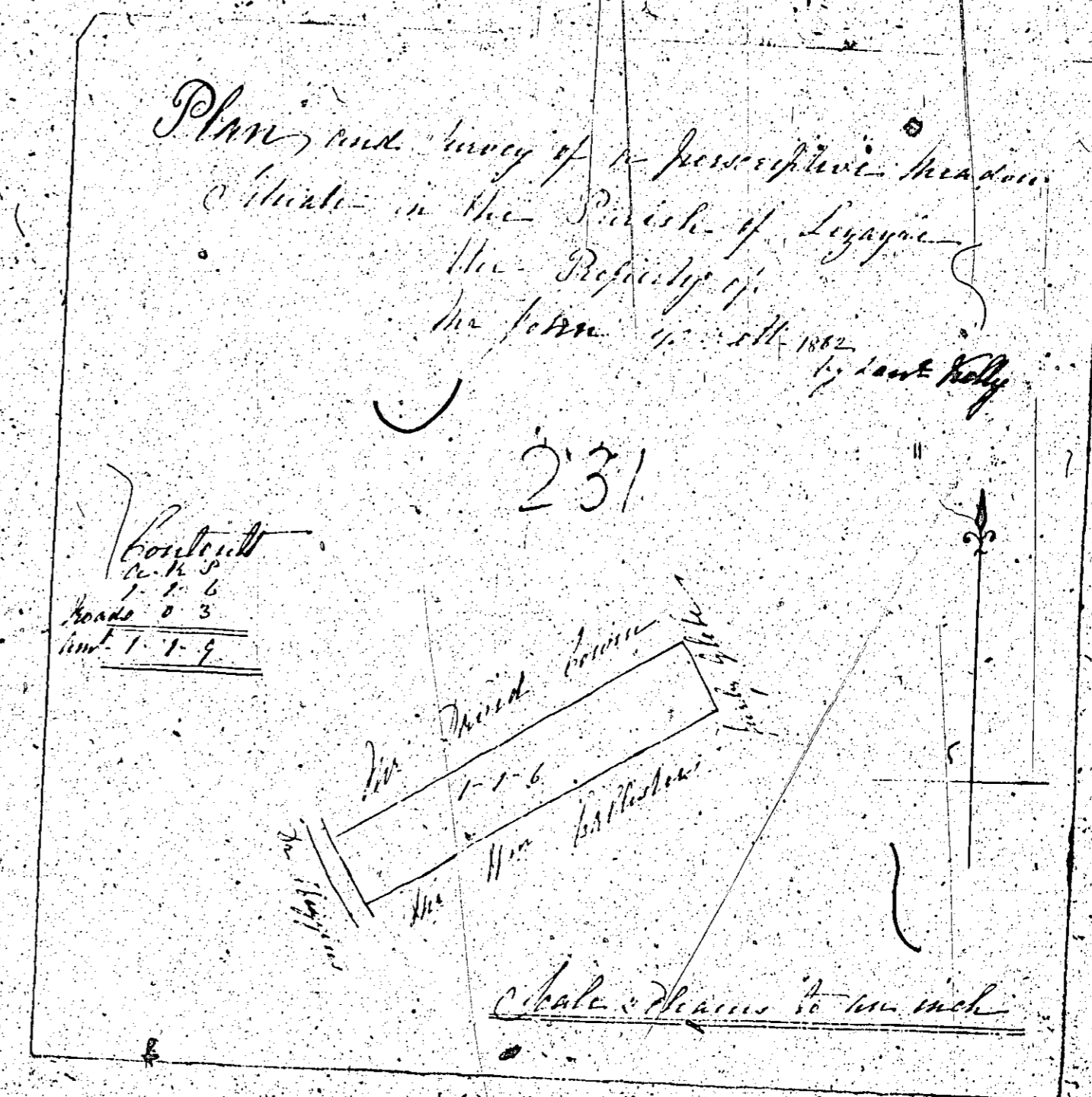

ISLE OF MAN GOVERNMENT: GENERAL REGISTRY

ASYLUM PLANS: PARISH OF LEZAYRE

Original monotone

1:23

*A Plan and Survey of the Meadow
belonging to the Vicarage of Turby,
situate in the Parish of Lezayre.*

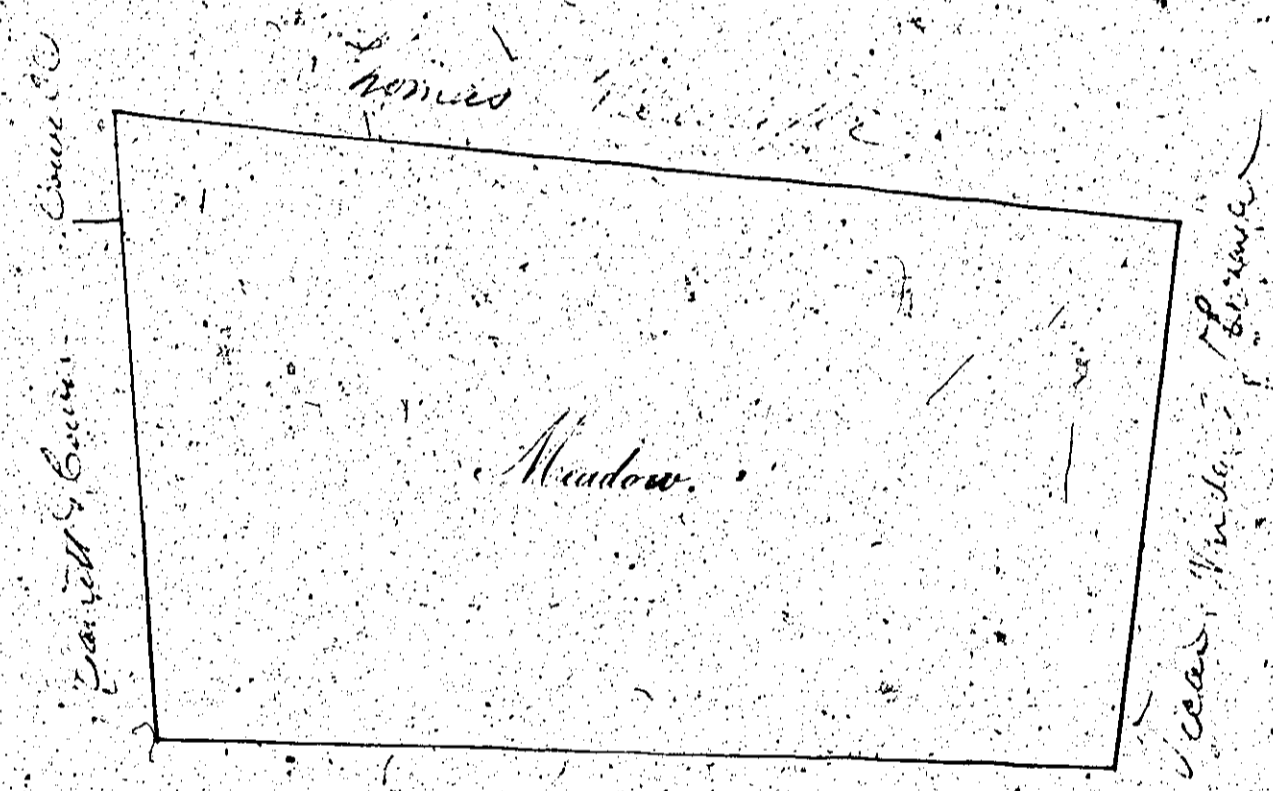

Contents A.R.P. 3.2.5.

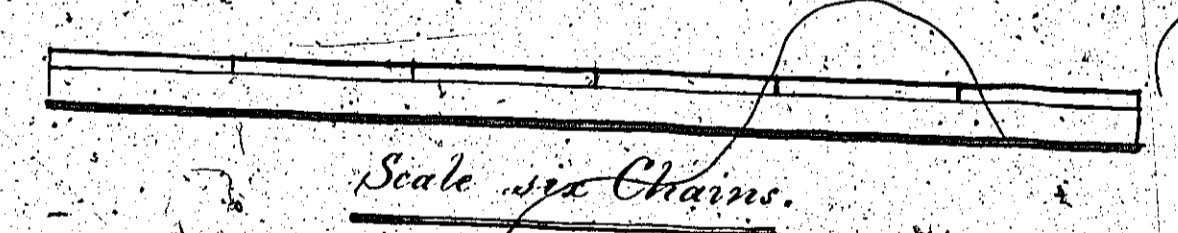

232