

Plan
OF THE
GRANGE
in the Parish of
LEZAYRE
the Property of
J. F. Cunningham Esq.

Surveyed by S. Davis 1764
Copied by C. H. Wood 1812.

ISLE OF MAN GOVERNMENT: GENERAL REGISTRY
ASYLUM PLANS: PARISH OF LEZAYRE
Original coloured
1:23



The following plan
is not numbered
but 21 is
pencilled on the back

ISLE OF MAN GOVERNMENT: GENERAL REGISTRY

ASYLUM PLANS: PARISH OF LEZAYRE

Original monotone

1:23

frame 1 of 2

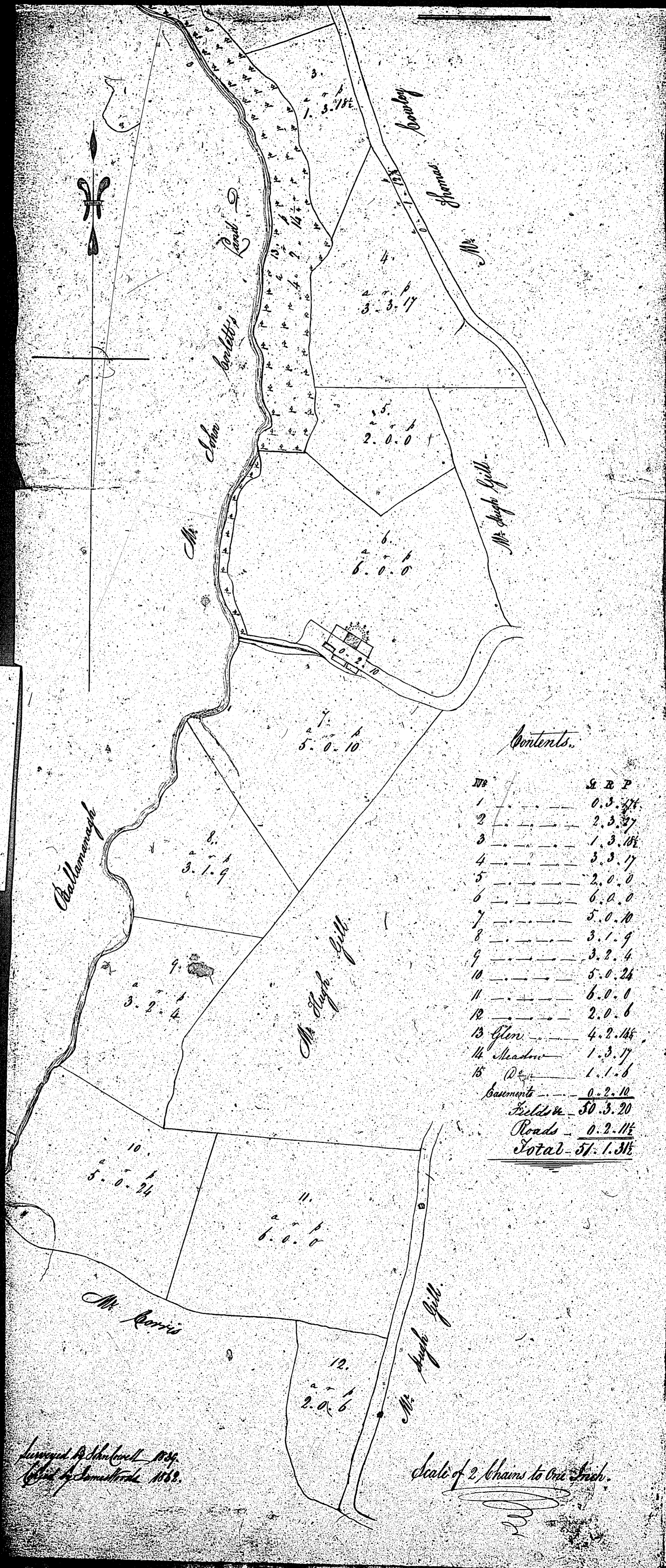

Contents.

No.	Acres	Rods	Faths
1	0	3	37
2	2	3	37
3	1	3	10 1/2
4	3	3	17
5	2	0	0
6	6	0	0
7	5	0	10
8	3	1	9
9	3	2	4
10	5	0	24
11	6	0	0
12	2	0	6
13	4	2	14 1/2
14	1	3	17
15	1	1	6
Buildings	0	2	10
Fields &c.	50	3	20
Roads	0	2	11 1/2
Total	51	1	31 1/2

Surveyed by A. Ashurst 1834
 Edited by J. Smith 1868.

ISLE OF MAN GOVERNMENT: GENERAL REGISTRY

ASYLUM PLANS: PARISH OF LEZAYRE

Original monotone

1:23

frame 2 of 2

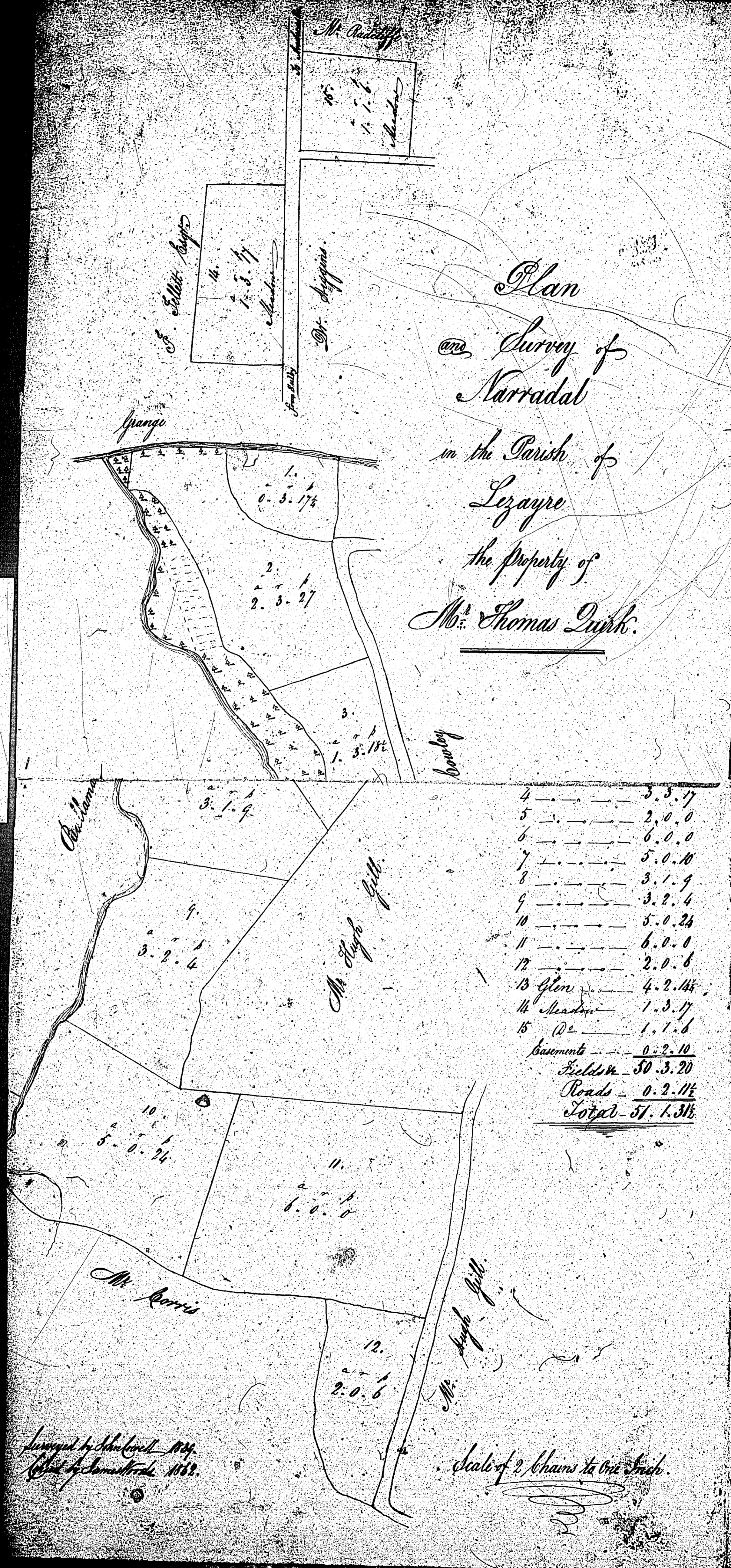

21

ISLE OF MAN GOVERNMENT: GENERAL REGISTRY

ASYLUM PLANS: PARISH OF LEZAYRE

Original monotone

1:23

frame 1 of 2

Plan of a part of
 Narradal
 Quarreland and Inland in the parish of
 Lezayre
 and belonging to
 Mr. Thomas Cowley.

(23)

Contents

No.	A	R	P
1	1	2	30
2	4	1	12
3	1	0	0
4	3	2	8
5	2	3	6
6	2	0	14
7	1	3	8
8	0	1	12
9	1	3	21
10	1	3	13
11	1	1	36
12	0	3	16
13	0	2	33
14	1	0	9
15	1	2	15
16	0	4	27
17	3	2	11
18	8	2	9
19	3	1	2
20	2	2	14
21	2	1	4
22	0	2	22
23	9	3	15
24	7	0	39
25	11	3	16
Total	75	2	36

