

ISLE OF MAN GOVERNMENT: GENERAL REGISTRY

ASYLUM PLANS: PARISH OF LEZAYRE

Originals monotone

1:23

*A copy of a survey of a
part of Ballamannah
in the parish of
Lezayre the property
of William Duggle
was the 21st of March 1862.*

*Contents
Sheet 1. D
1. 1. 26
2. 1. 26
3. 1. 26
4. 1. 26*

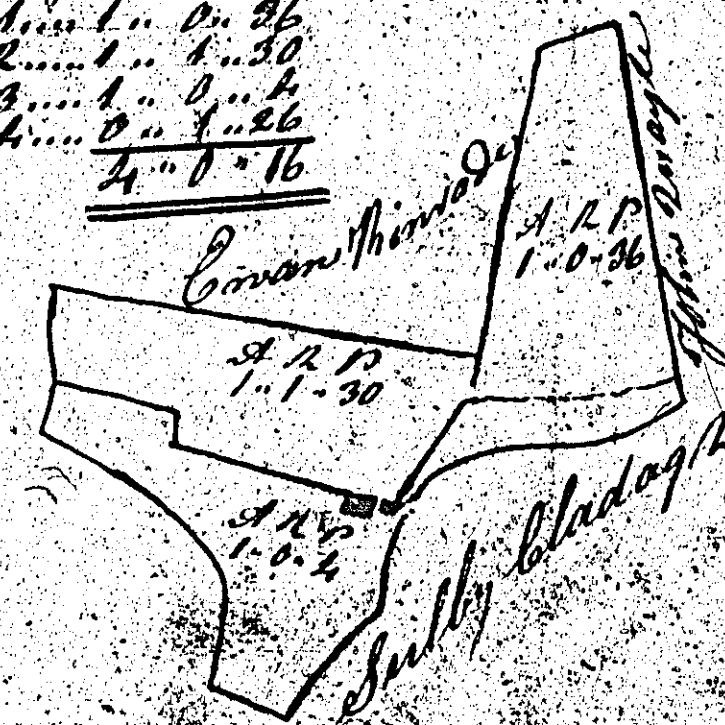

No. 94 and 95 of the Book

*Part of the West Ballamannah
Quarterland in the parish of
Lezayre the property of
Hugh Minrade taken June 1859
by J. Gregson
was the 21st of March 1862.*

J. Corrie (7)

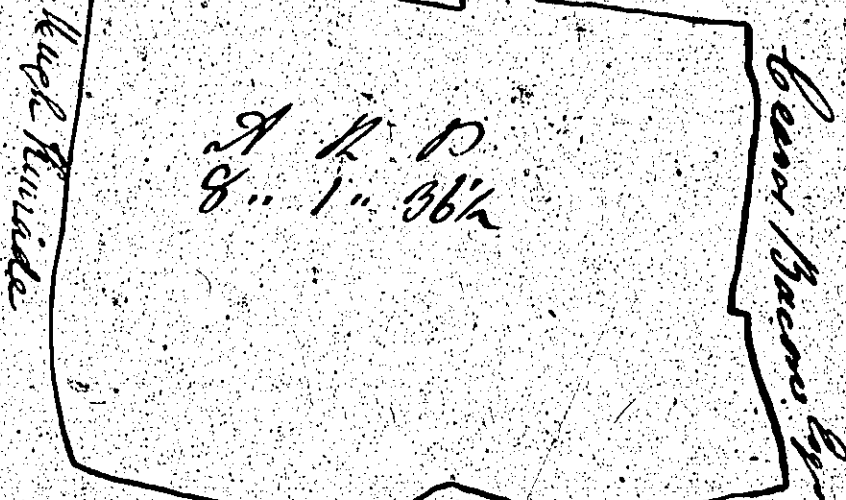

Scale 30

ISLE OF MAN GOVERNMENT: GENERAL REGISTRY

ASYLUM PLANS: PARISH OF LEZAYRE

Original monotone

1:23

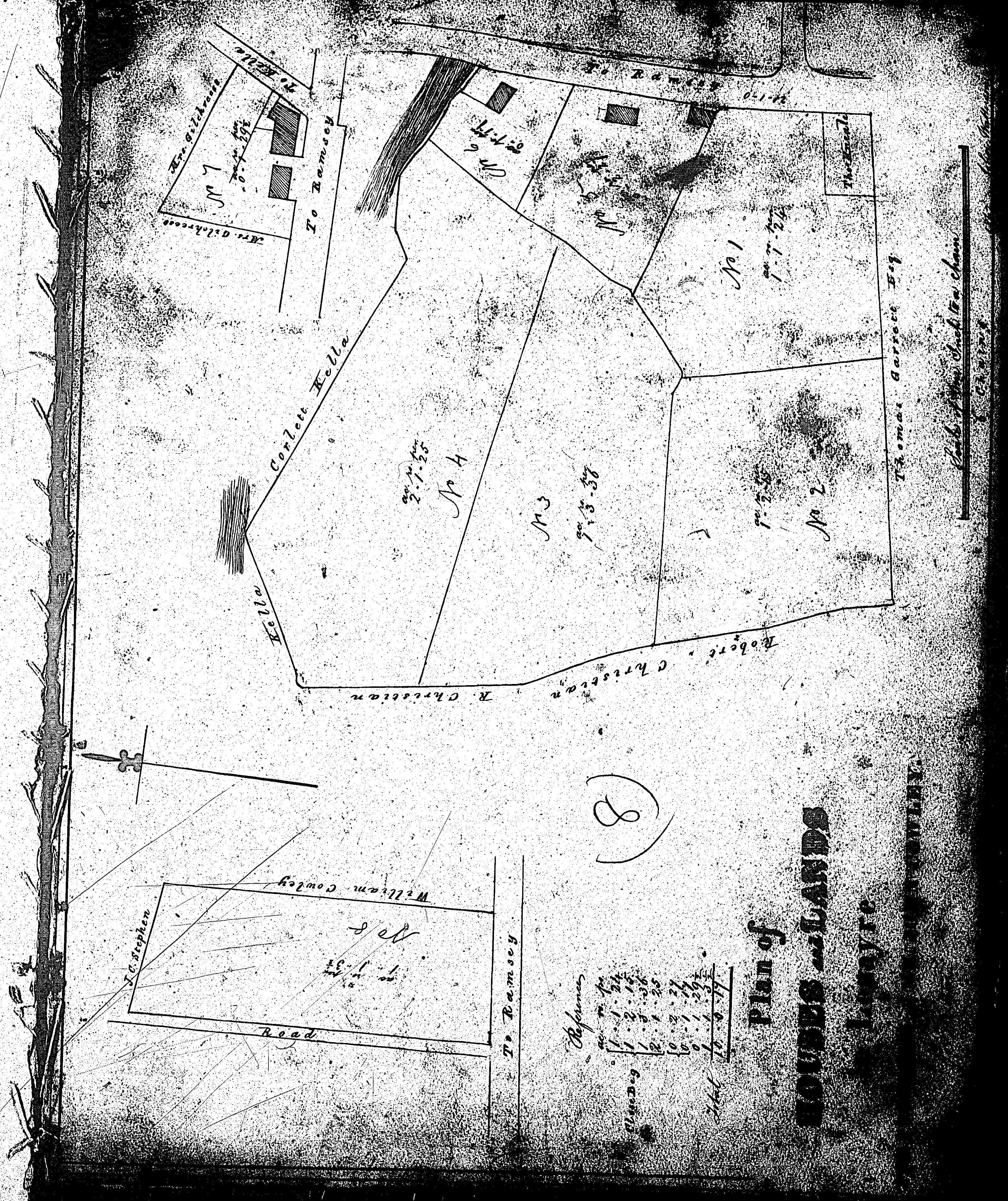

ISLE OF MAN GOVERNMENT: GENERAL REGISTRY

ASYLUM PLANS: PARISH OF LEZAYRE

Original monotone

1:23

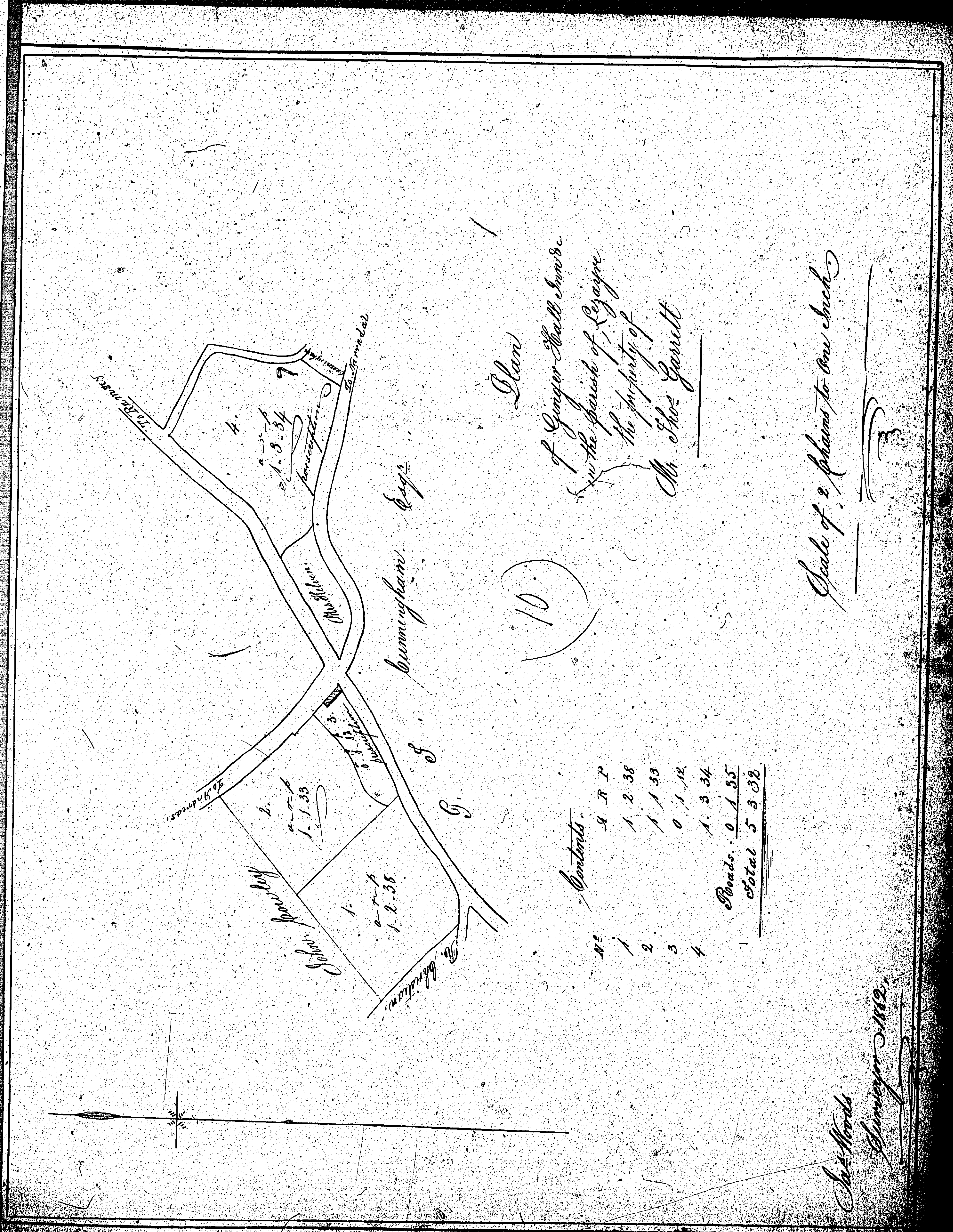

ISLE OF MAN GOVERNMENT: GENERAL REGISTRY

ASYLUM PLANS: PARISH OF LEZAYRE

Original monotone

1:23

