

133

ISLE OF MAN GOVERNMENT: GENERAL REGISTRY

ASYLUM PLANS: PARISH OF GERMAN

Originals monotone

1:23

134

Part of Ballalough in German
belonging to Joseph Wade

Contents
No. 1. 2. 3. 4.
1. 6. 1. 18
2. 0. 0. 12
Total 6. 1. 30

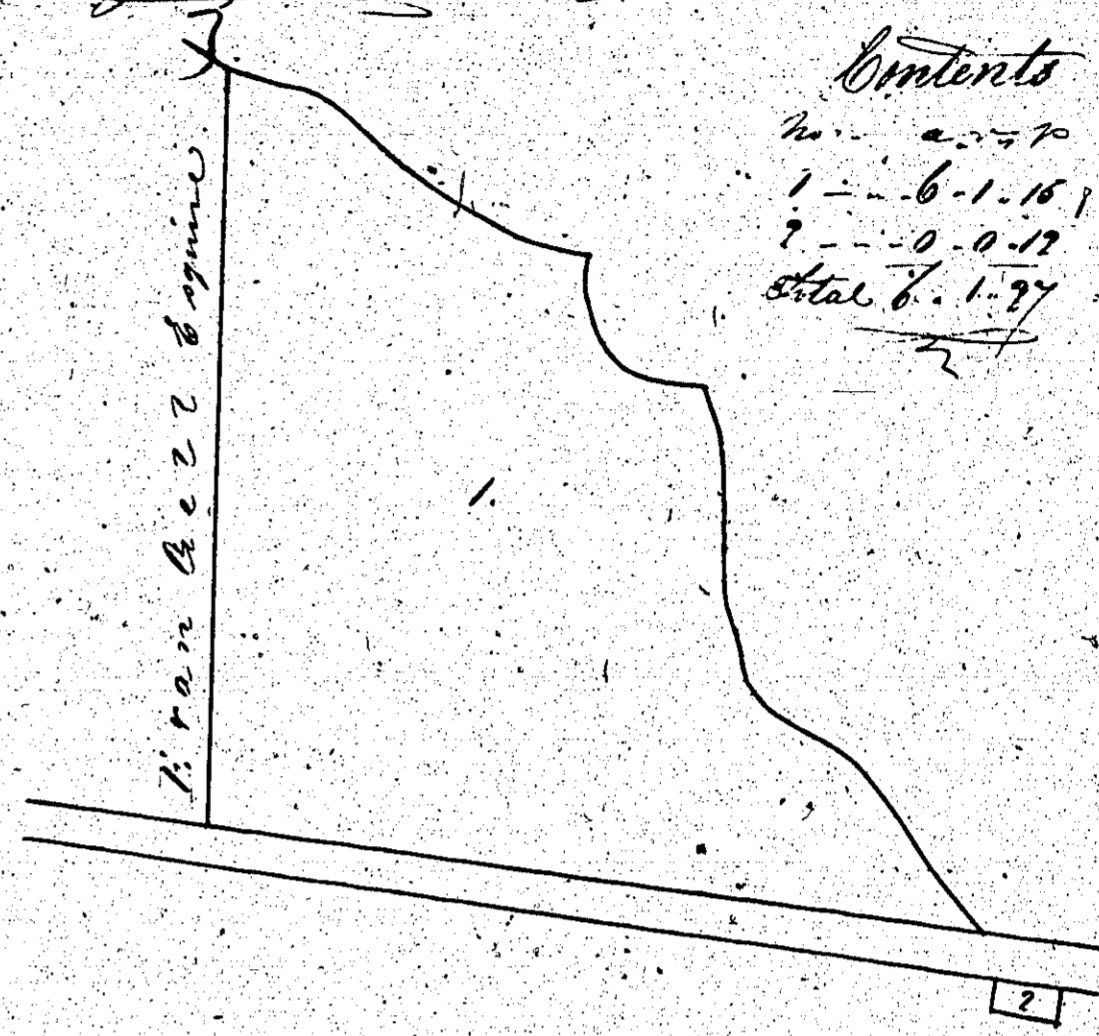

Scale
10 chains

Copied from plan 133 by
Woods 1864

Plan of a small piece of land
situate near the town of Peel
in the Parish of German
The property of
Mr. Robert Colague.

135

Reference
No. 1. 2. 3. 4.
1. 0. 0. 12
Total 0. 0. 31 1/2

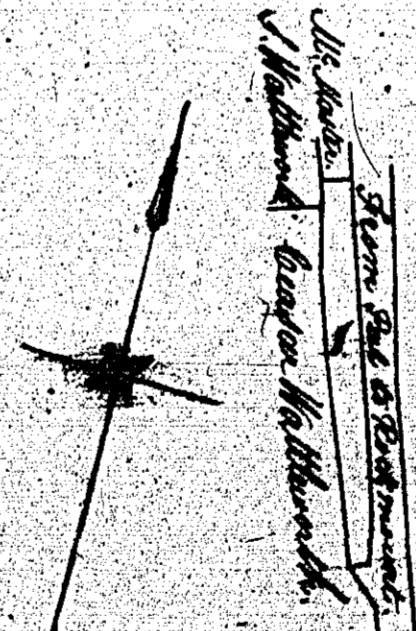

Scale
1 2 3 4 5 chains

Wm. Knight, Surveyor, 1867

ISLE OF MAN GOVERNMENT: GENERAL REGISTRY

ASYLUM PLANS: PARISH OF GERMAN

Original coloured

1:23

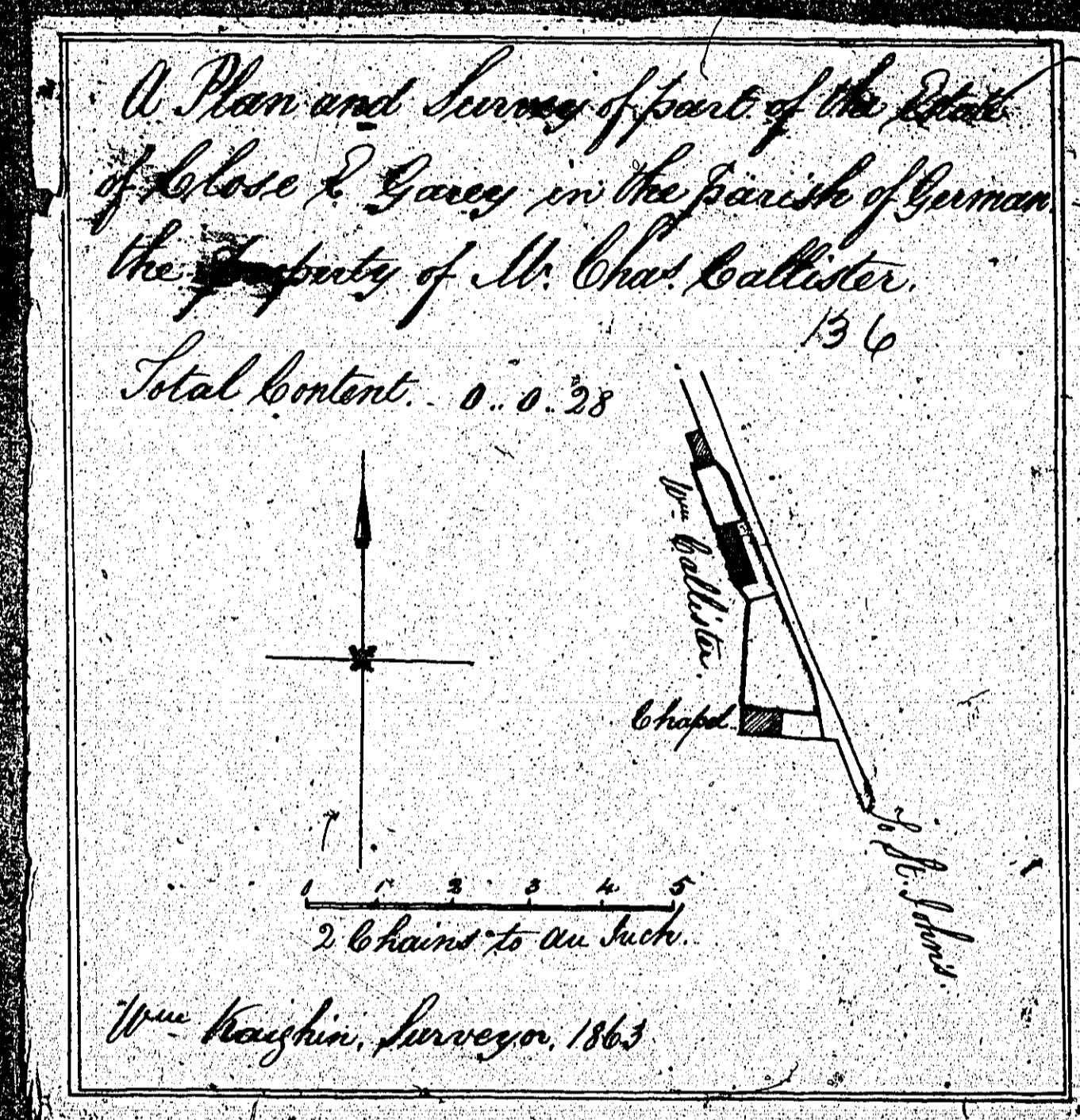

ISLE OF MAN GOVERNMENT: GENERAL REGISTRY
 ASYLUM PLANS: PARISH OF GERMAN

Original monotone

1:23

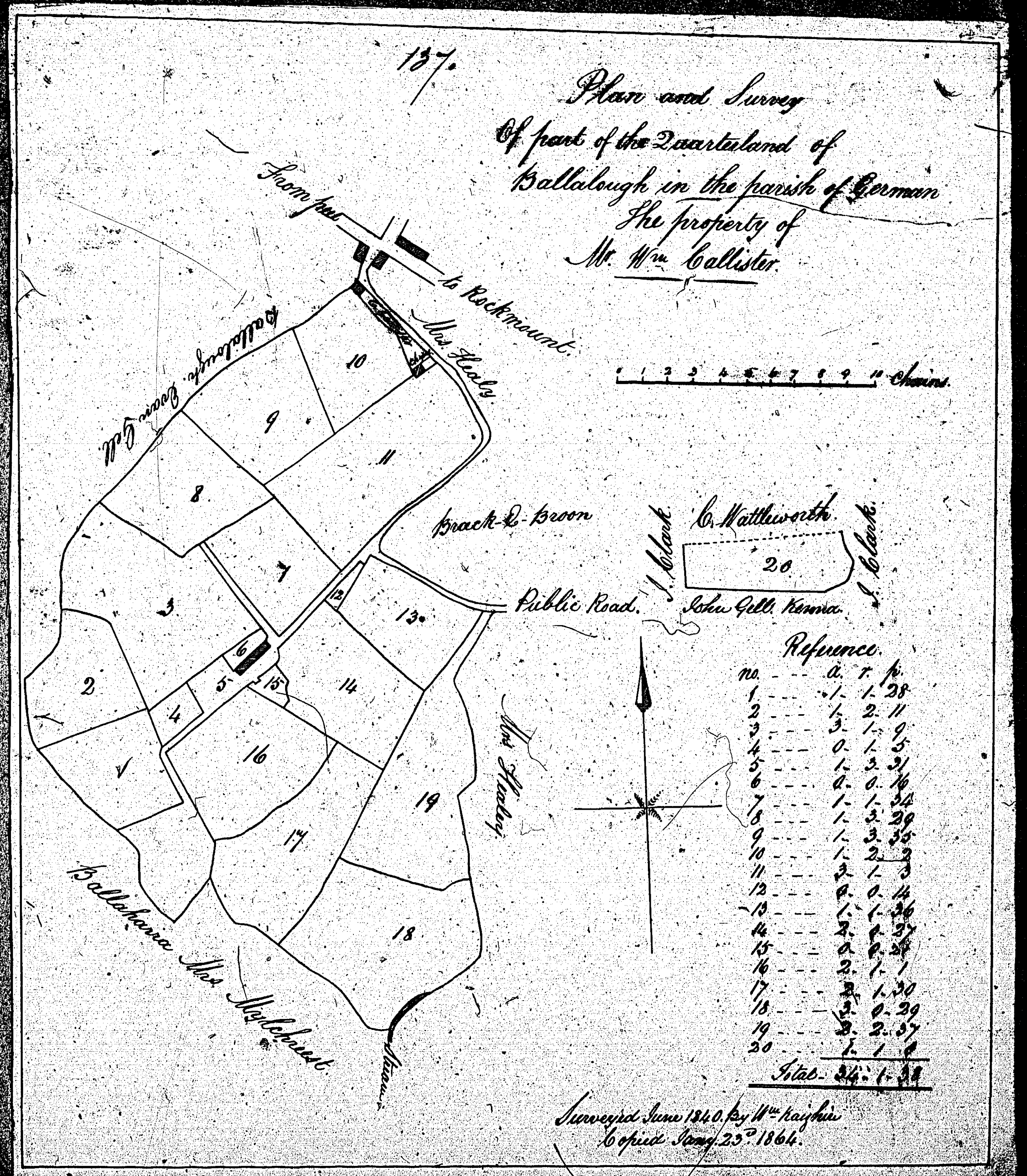

Contents

no.	a.	r.	p.
1	3	2	20
2	0	0	19
3	0	0	27
4	0	1	19
5	0	0	23
6	6	1	25
7	5	0	8
8	3	2	21
9	7	2	8
10	6	1	24
11	7	1	9
12	3	3	17
13	4	3	16
14	0	1	39
15	2	0	14
16	0	0	13
17	7	1	21
18	9	1	24
19	3	3	8
20	7	0	25
21	1	3	4
22	6	2	2
23	6	1	2
24	5	1	32
25	2	2	14
Private Road	0	0	22
Total	102	2	16

138

Plan of the Estate of
 Balla-lough in the parish of German,
 the property of
 Mr. Evan Gell.

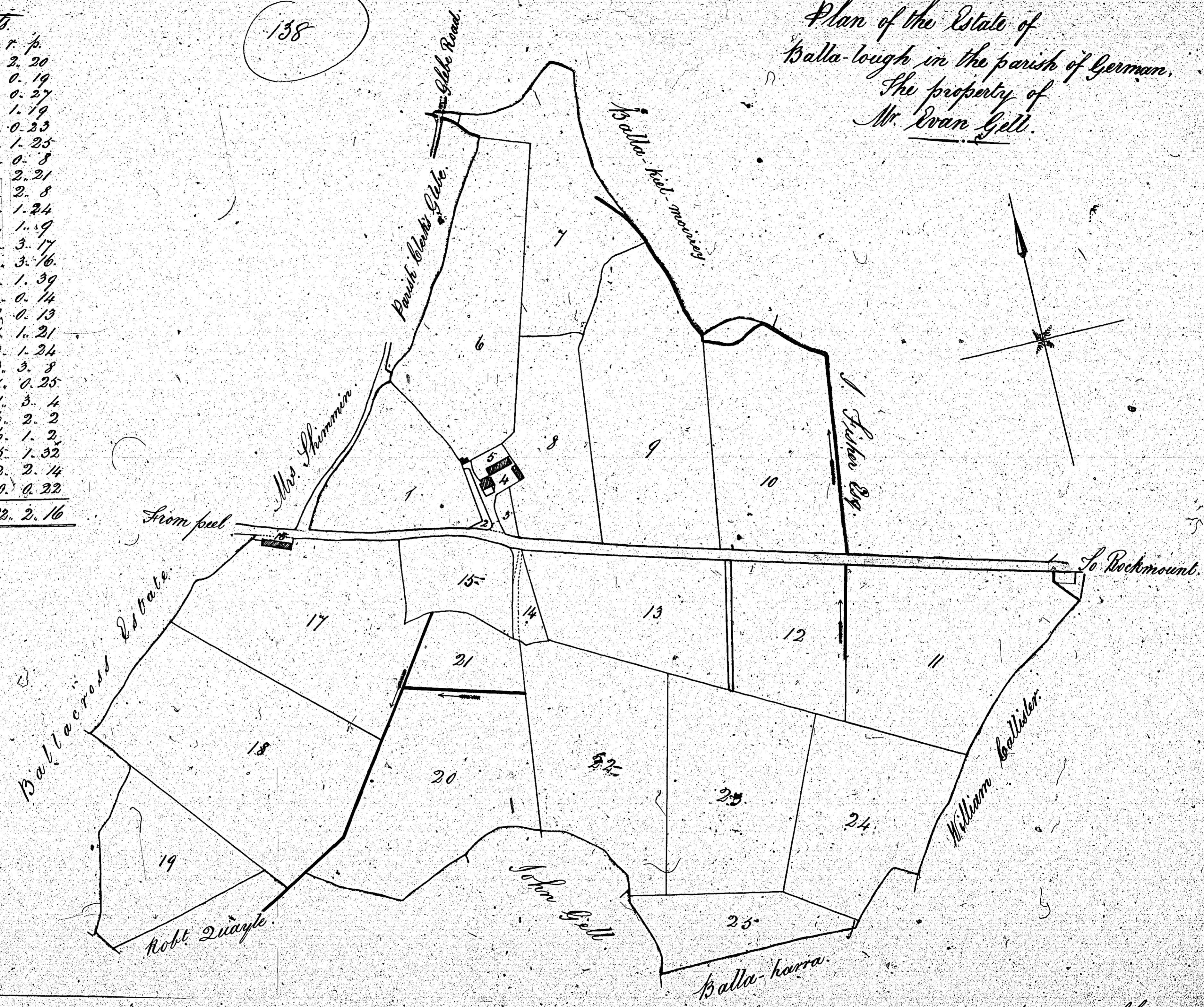

0 1 2 3 4 5 6 7 8 9 10 chains
 Cowley & Haighin, Surveyors, 1863.

ISLE OF MAN GOVERNMENT: GENERAL REGISTRY

ASYLUM PLANS: PARISH OF GERMAN

Original coloured

1:23

ISLE OF MAN GOVERNMENT: GENERAL REGISTRY

ASYLUM PLANS: PARISH OF GERMAN

1:23

- 139 Original coloured
- 140 Original monotone
- 141 Original coloured (decorative)

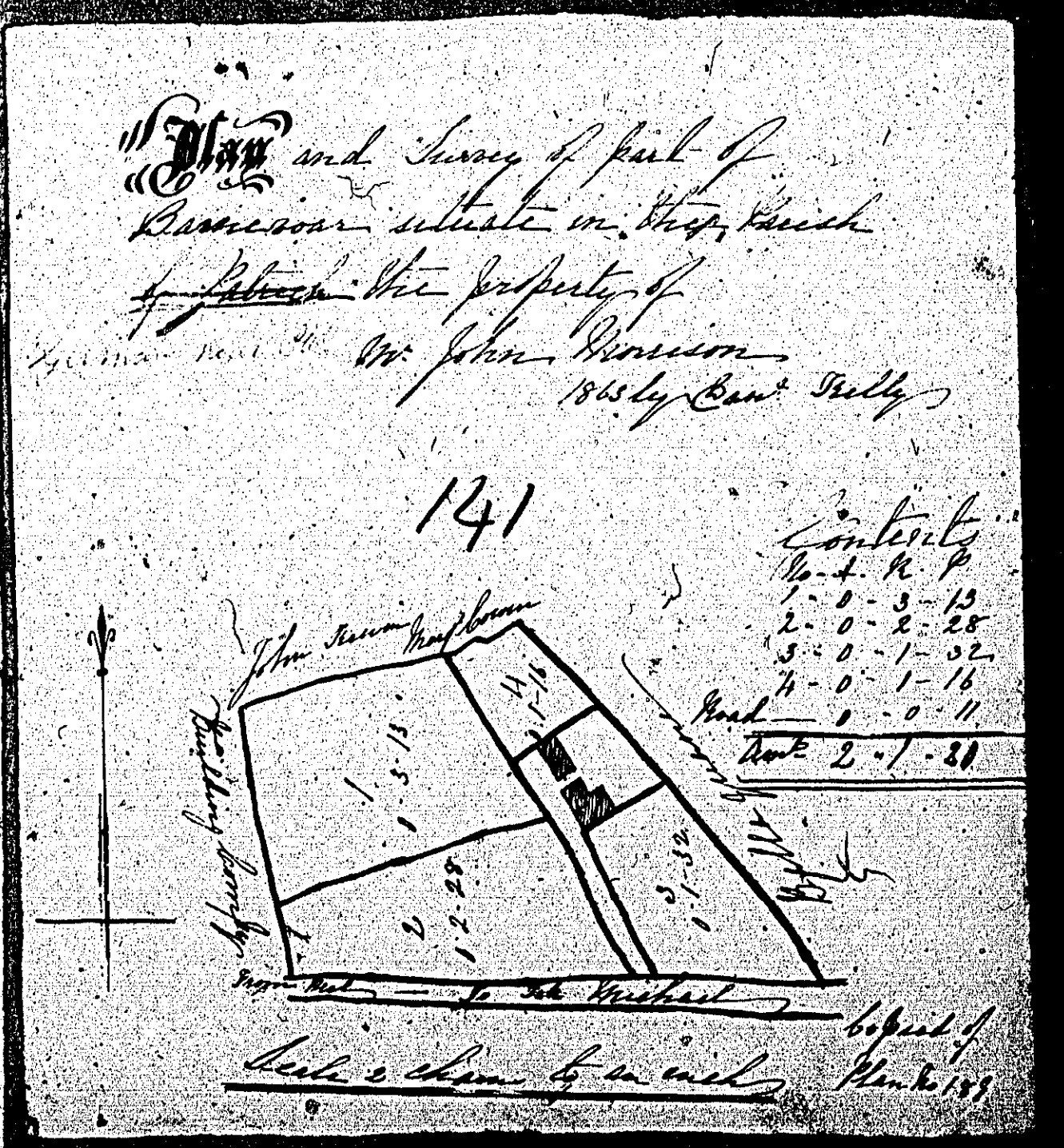
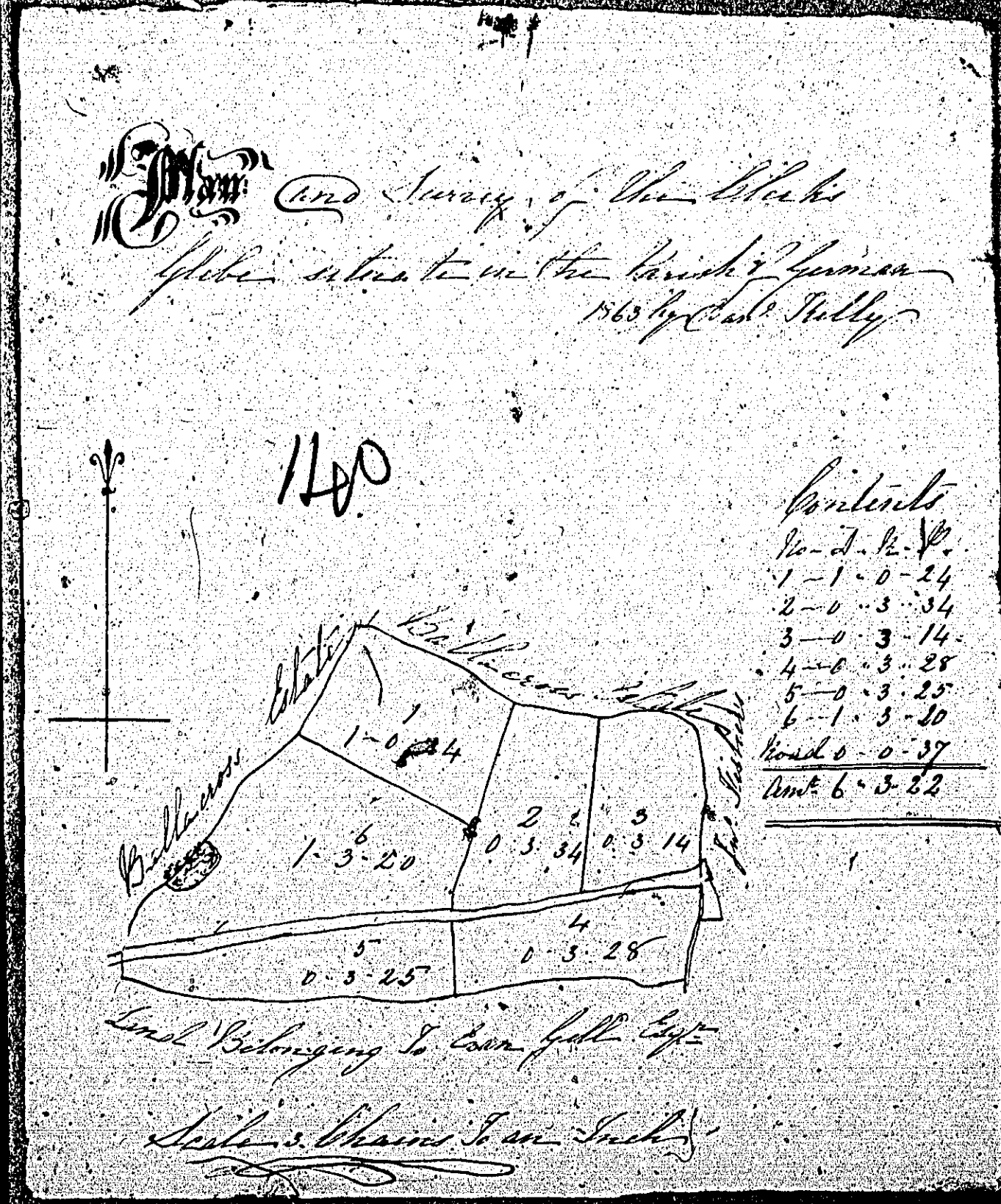
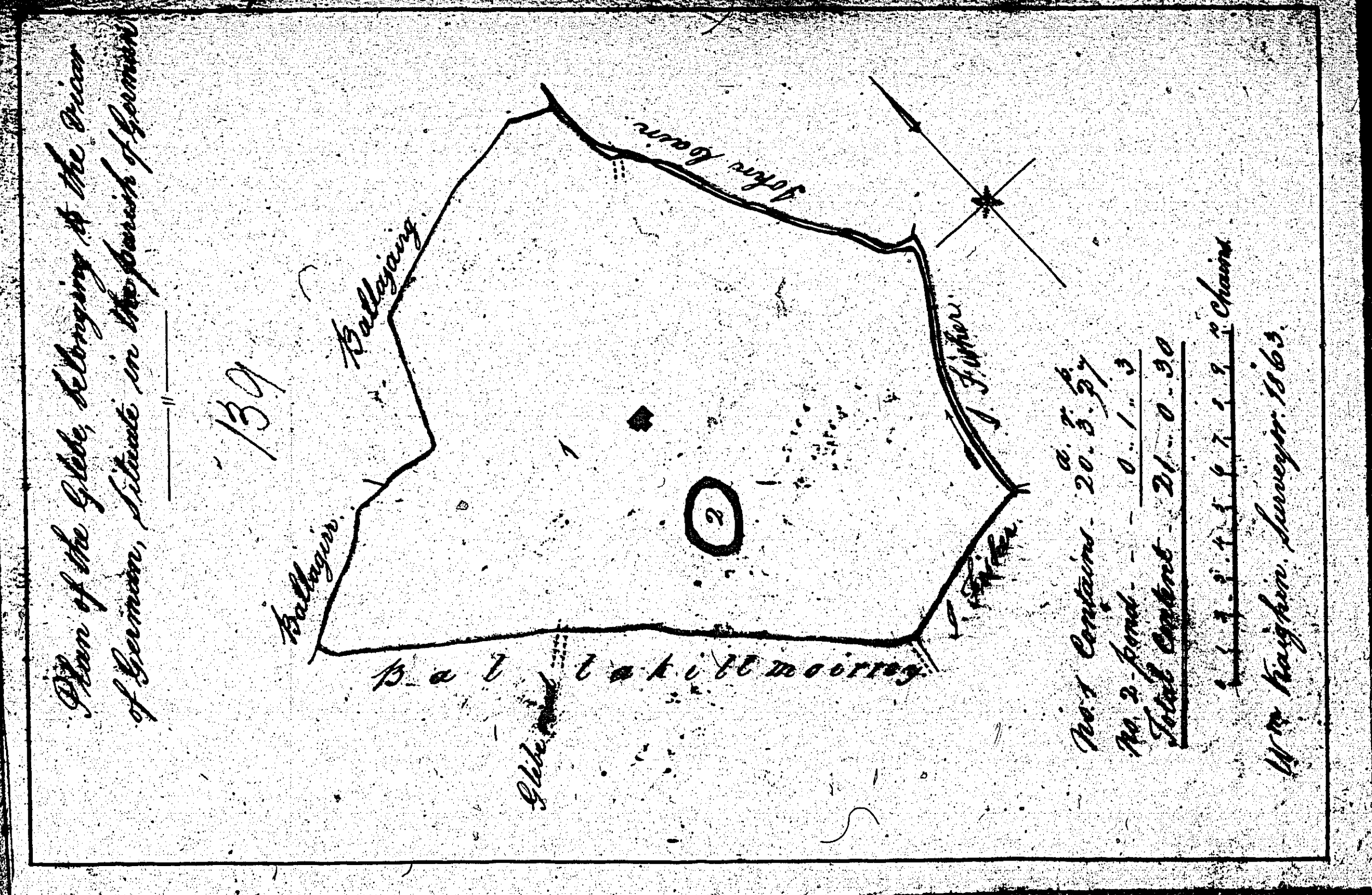

The following two
plans are both
numbered

143

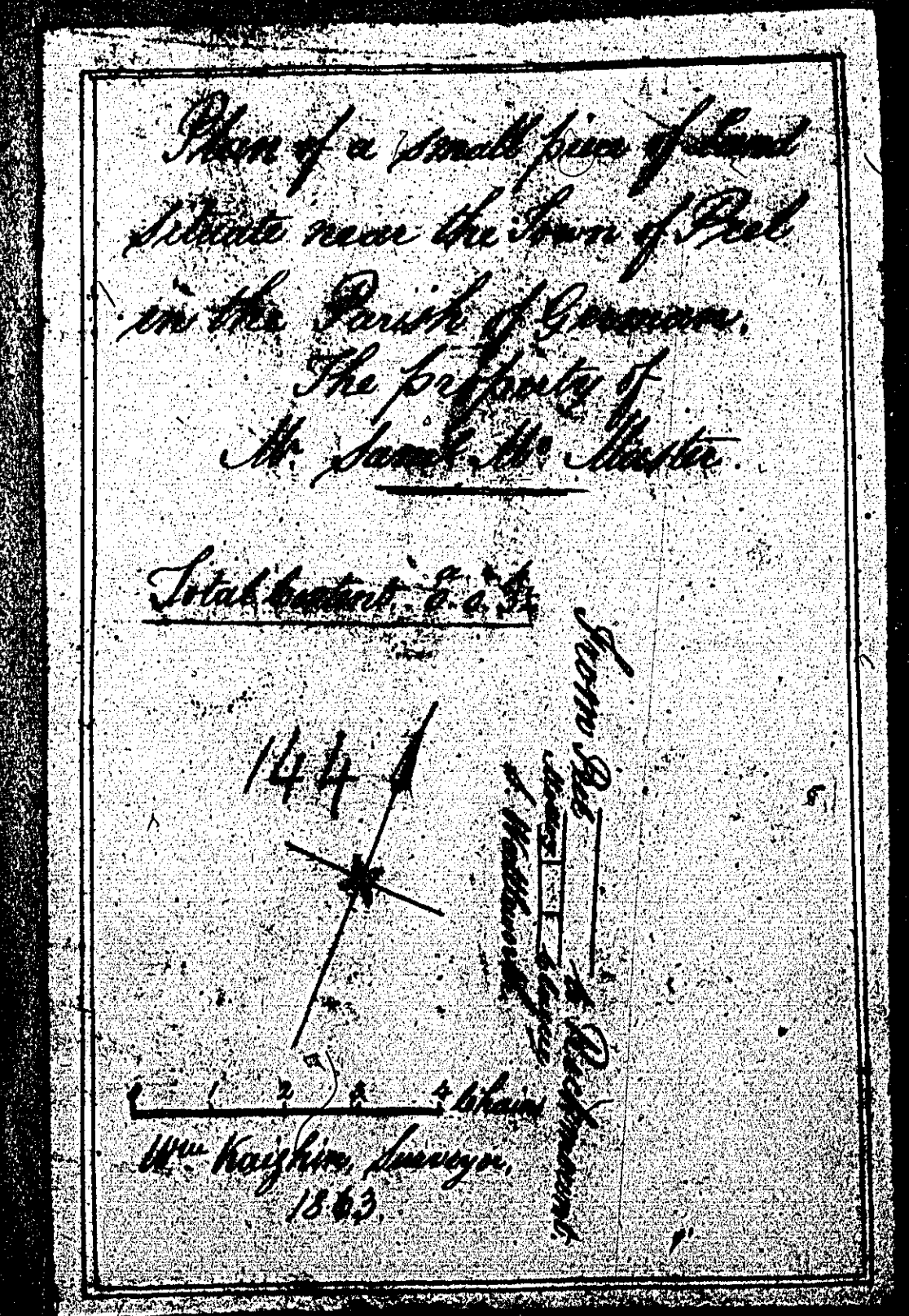
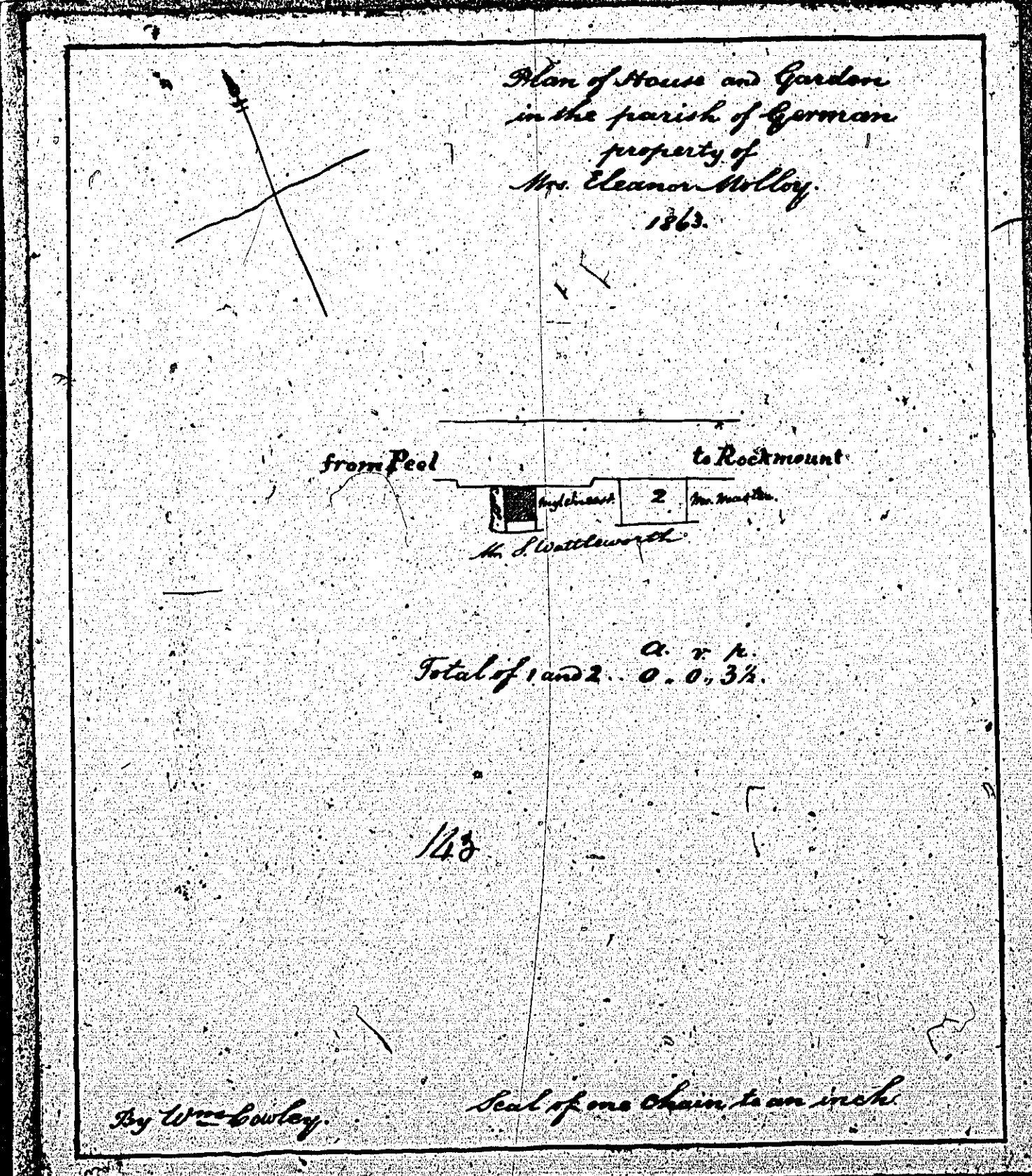
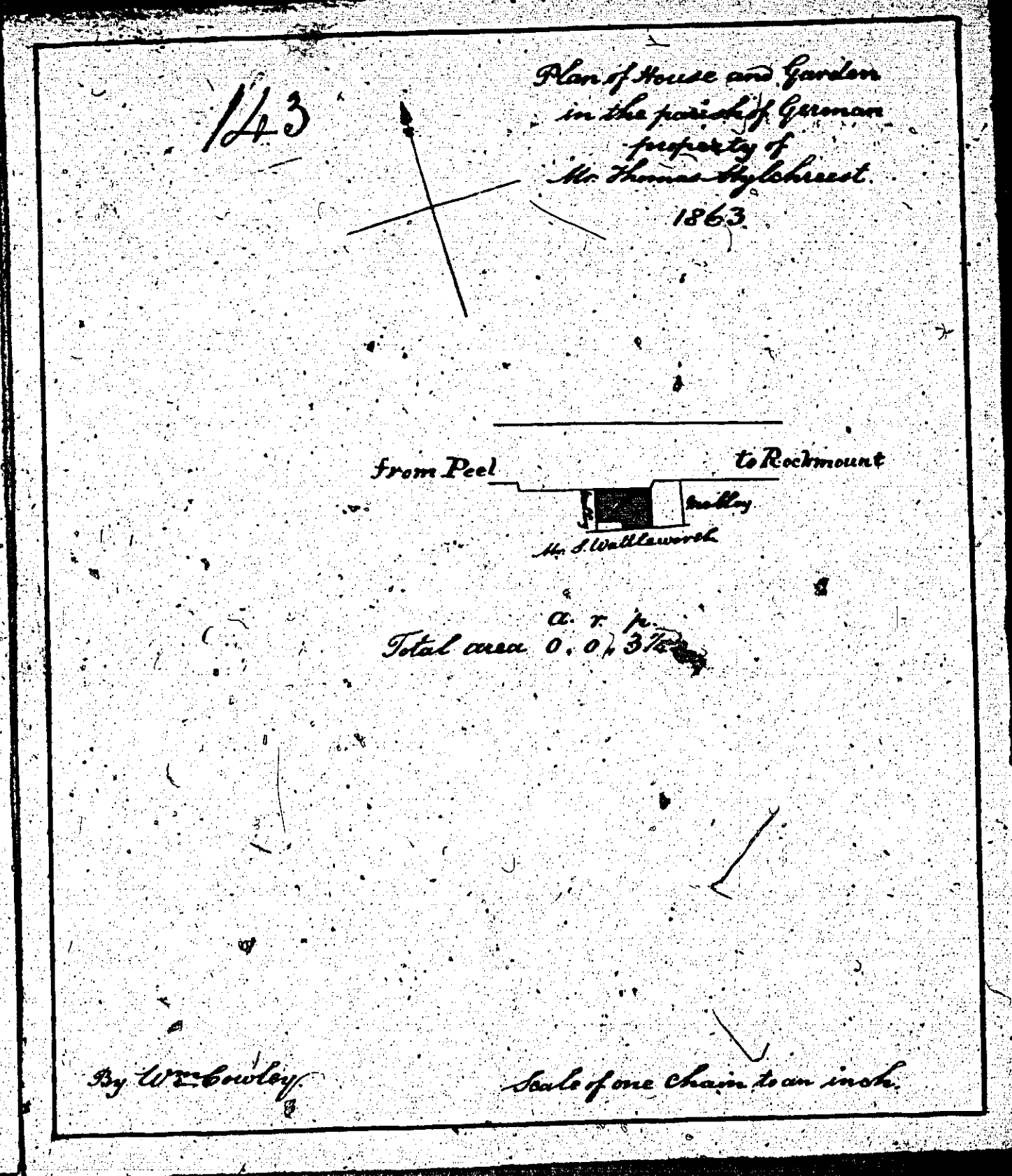
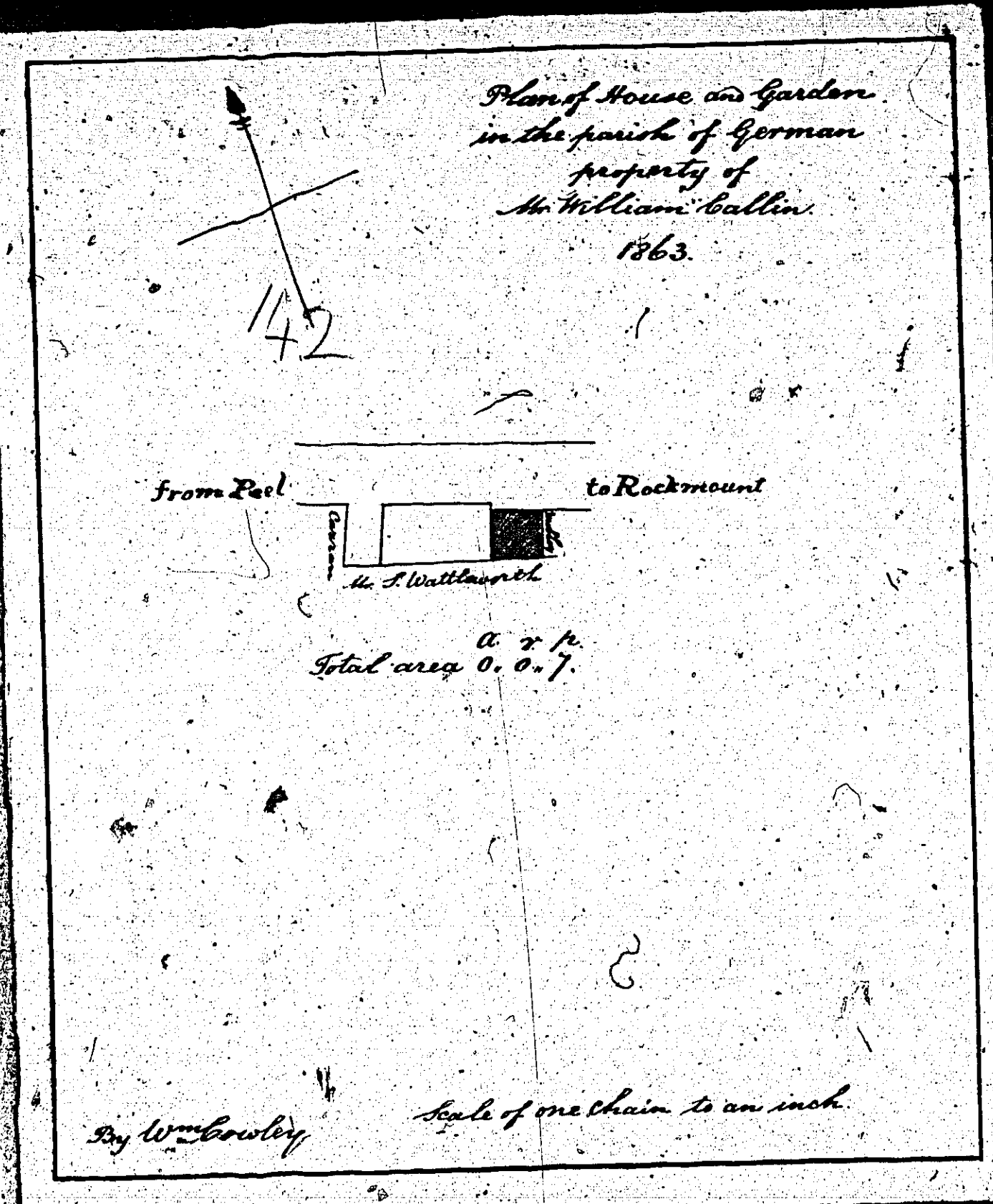

ISLE OF MAN GOVERNMENT: GENERAL REGISTRY
ASYLUM PLANS: PARISH OF GERMAN

Originals monotone

1:23