

ISLE OF MAN GOVERNMENT: GENERAL REGISTRY

ASYLUM PLANS: PARISH OF BRADDAN

Original coloured

1:23

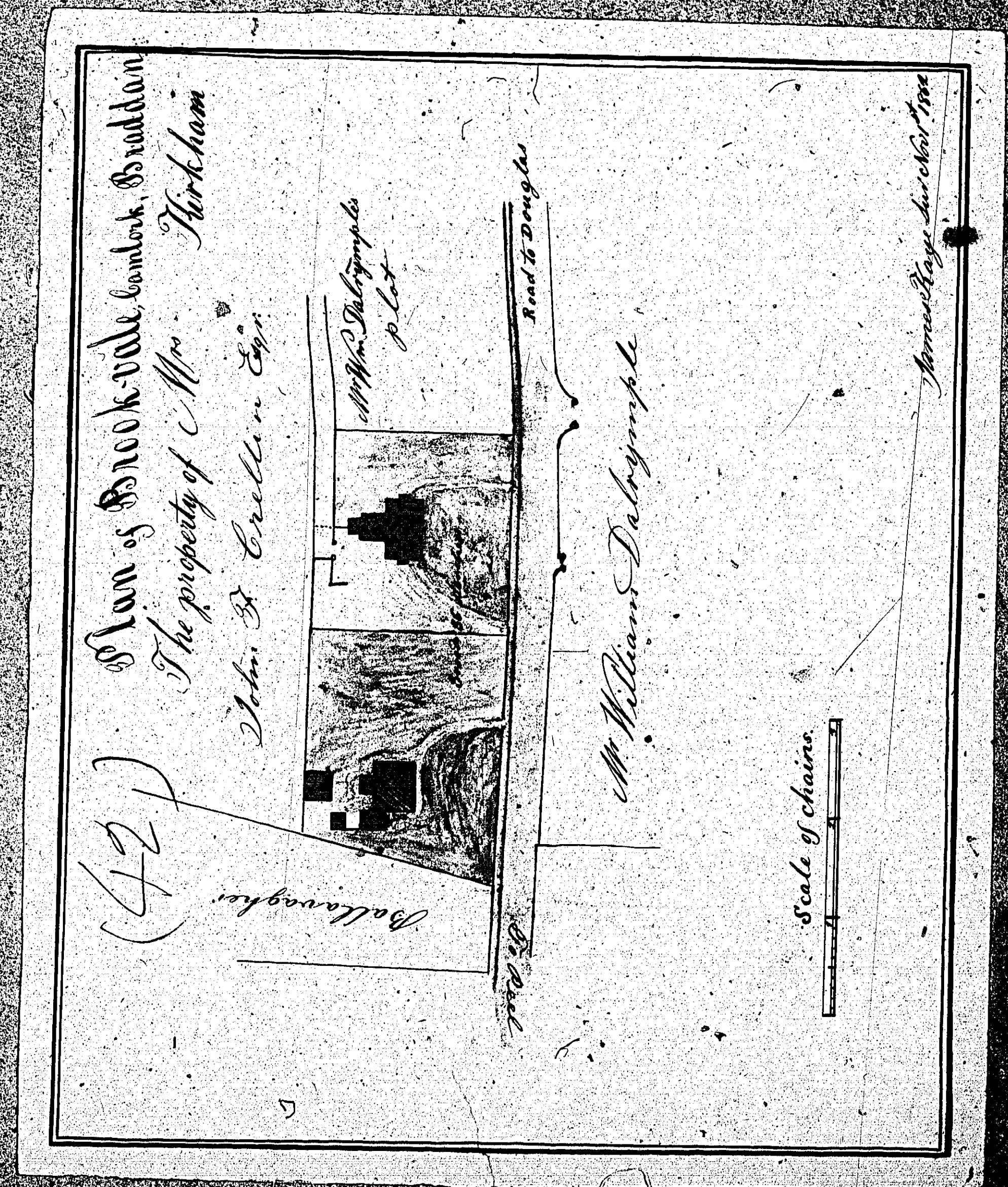

ISLE OF MAN GOVERNMENT: GENERAL REGISTRY

ASYLUM PLANS: PARISH OF BRADDAN

Originals coloured

1:23

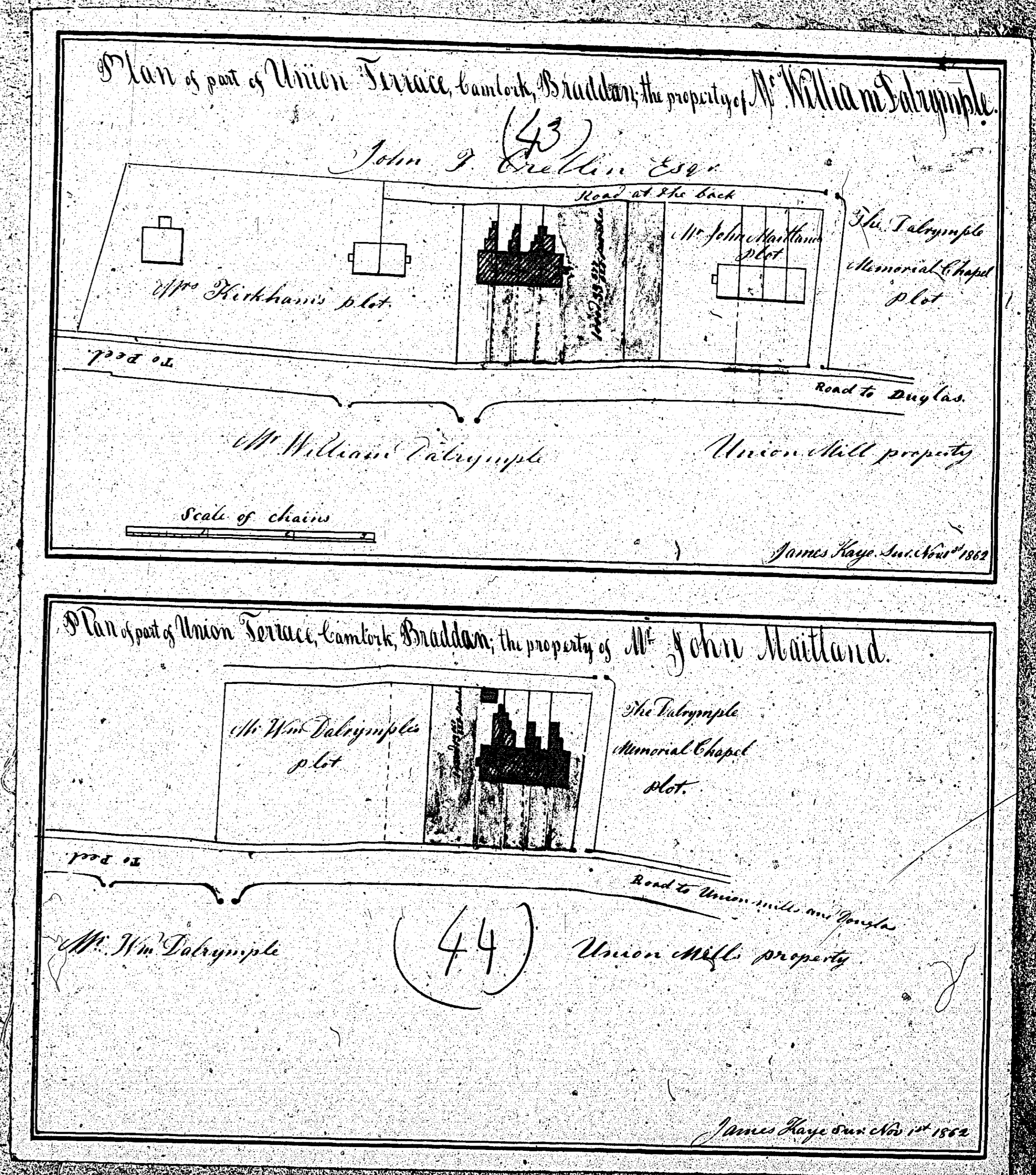

ISLE OF MAN GOVERNMENT: GENERAL REGISTRY

ASYLUM PLANS: PARISH OF BRADDAN

1:23

45 Original monotone

46 Original coloured (decorative)

(45)

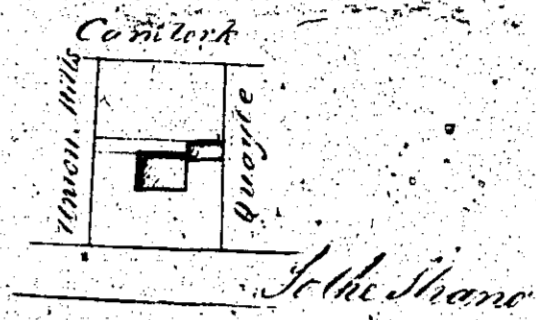

Canterbury
in
Braddan
belonging to
Paul Kelly Esq.
2 Chains to an Inch

To the Woods
Surveyor 1862

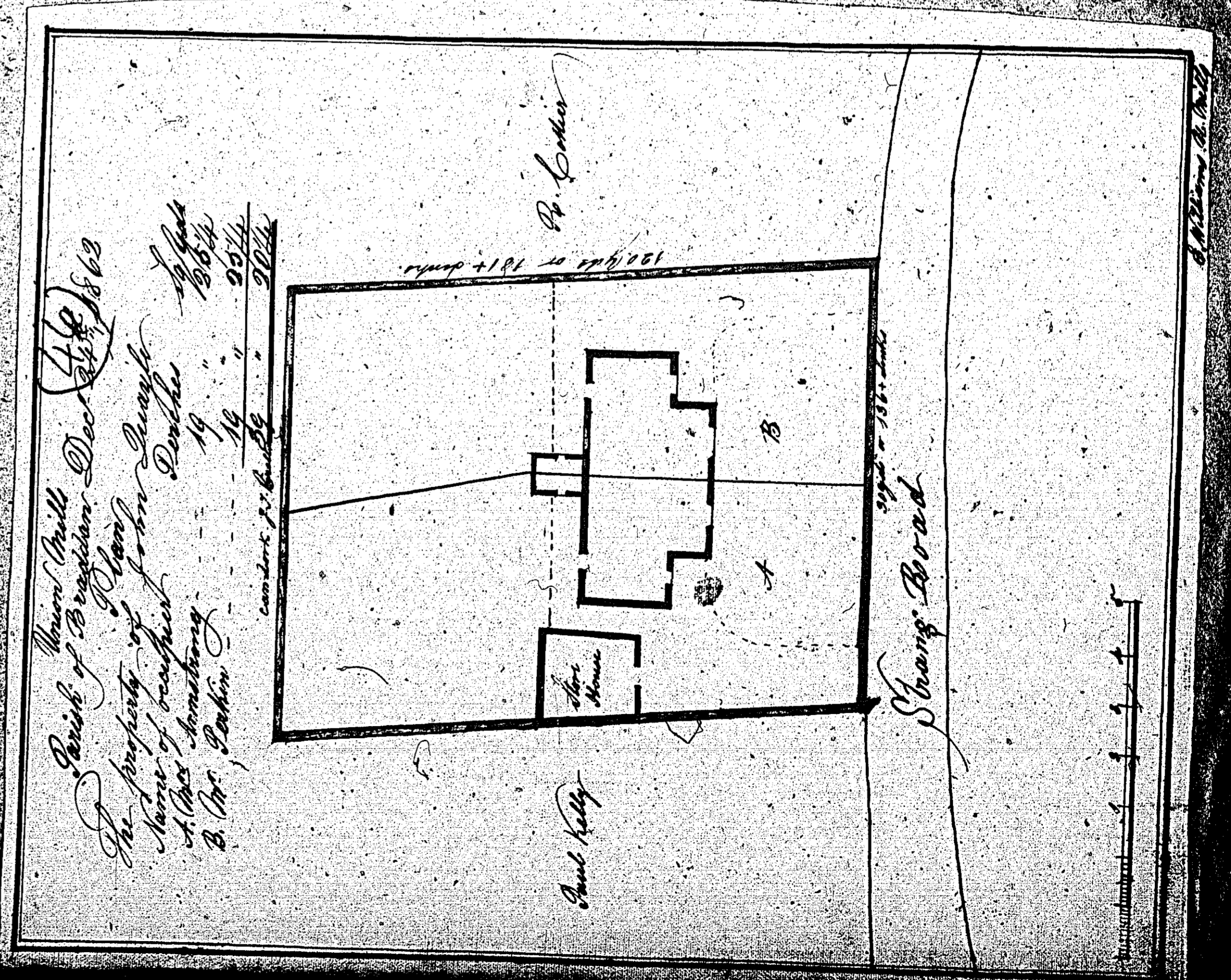

ISLE OF MAN GOVERNMENT: GENERAL REGISTRY

ASYLUM PLANS: PARISH OF BRADDAN

Originals coloured

1:23

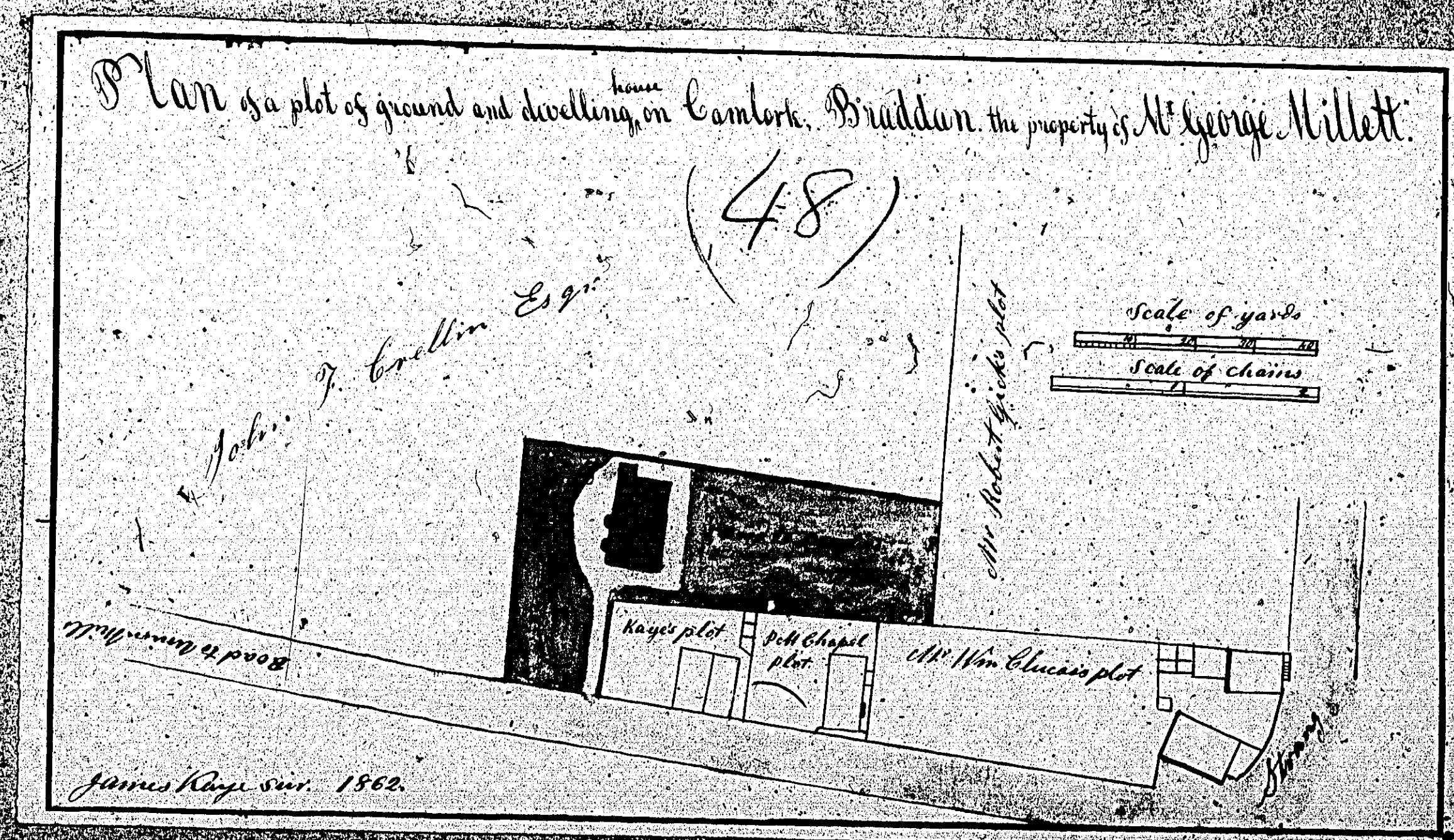
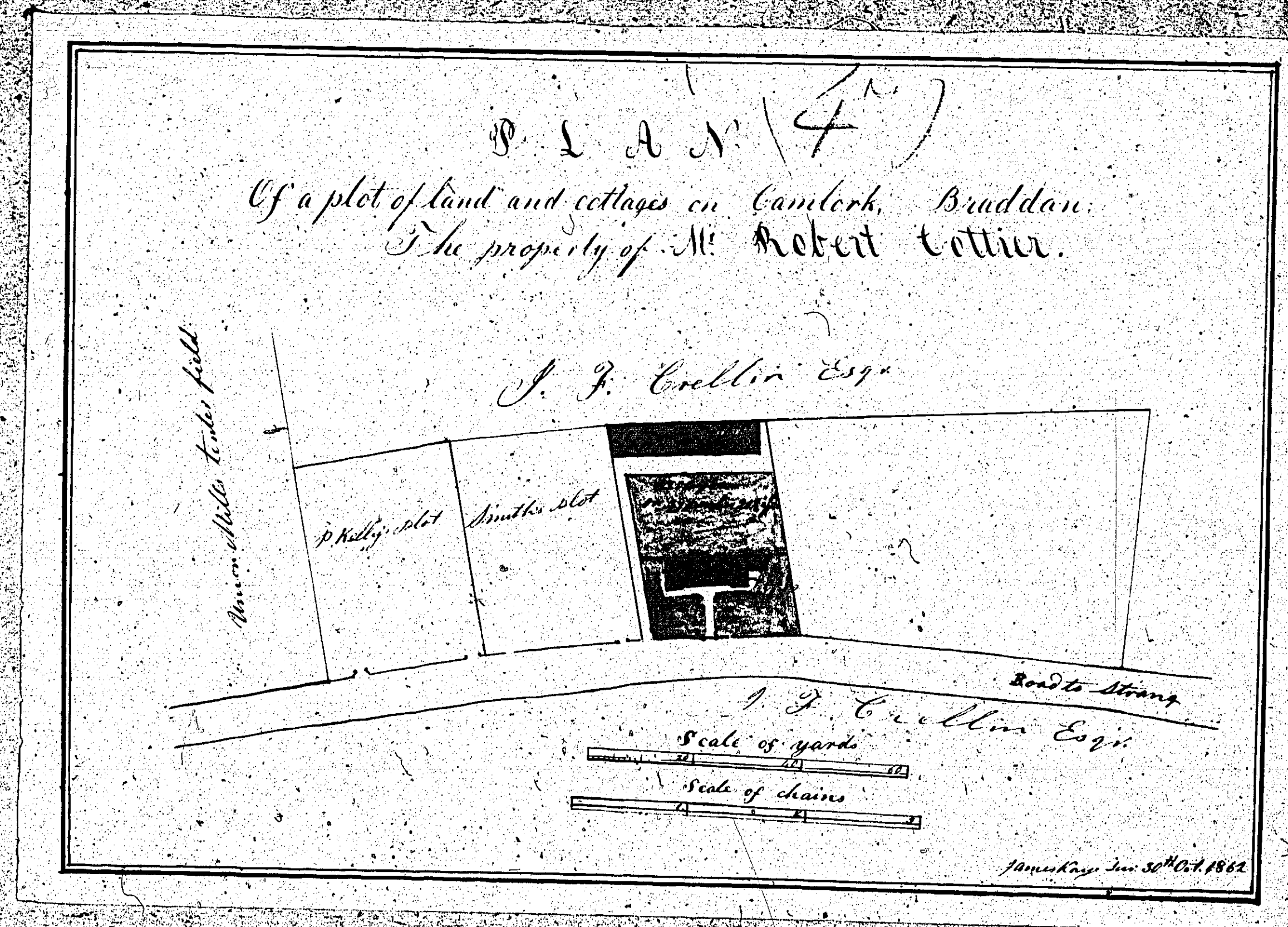

ISLE OF MAN GOVERNMENT: GENERAL REGISTRY

ASYLUM PLANS: PARISH OF BRADDAN

Originals coloured

1:23

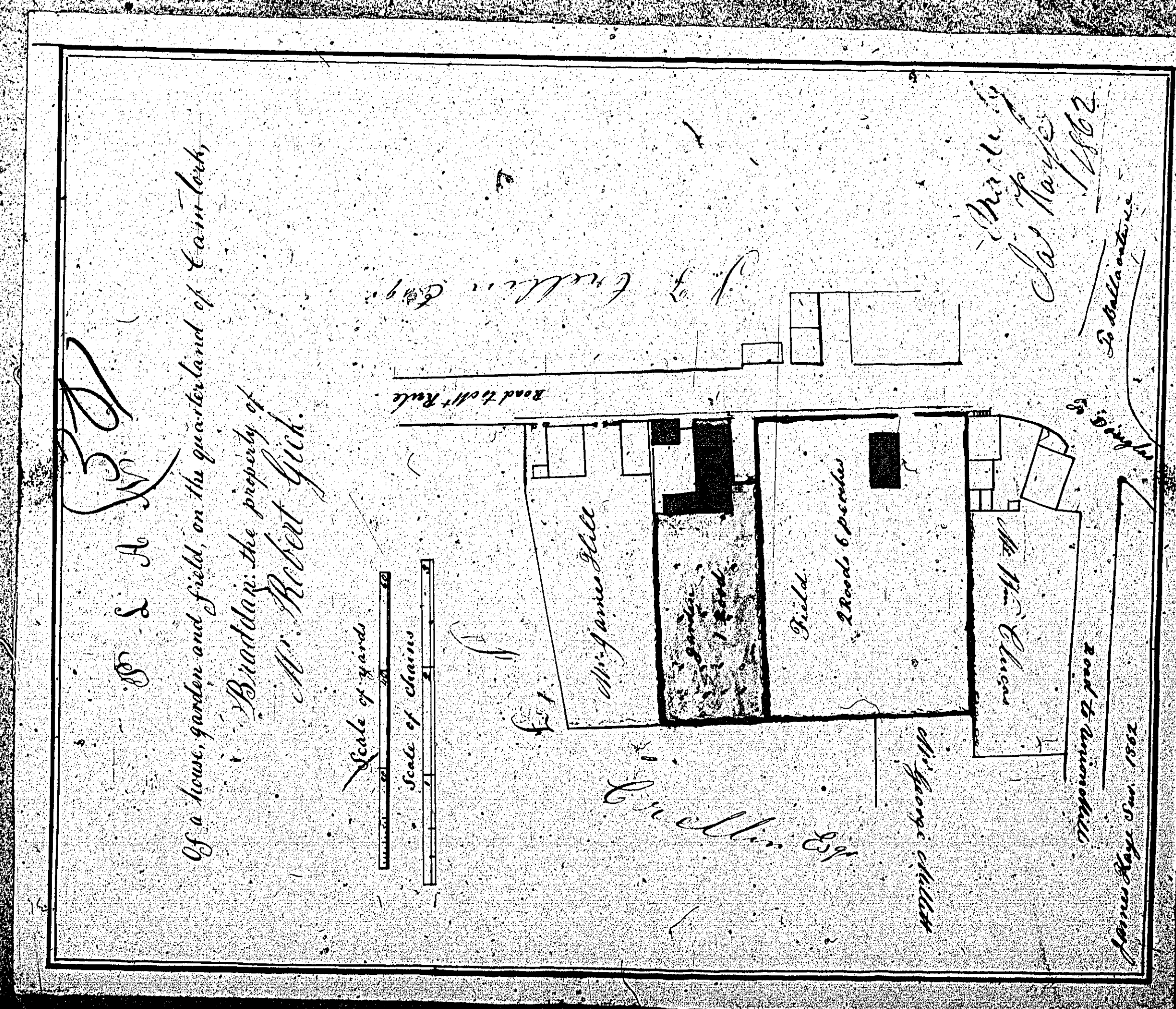
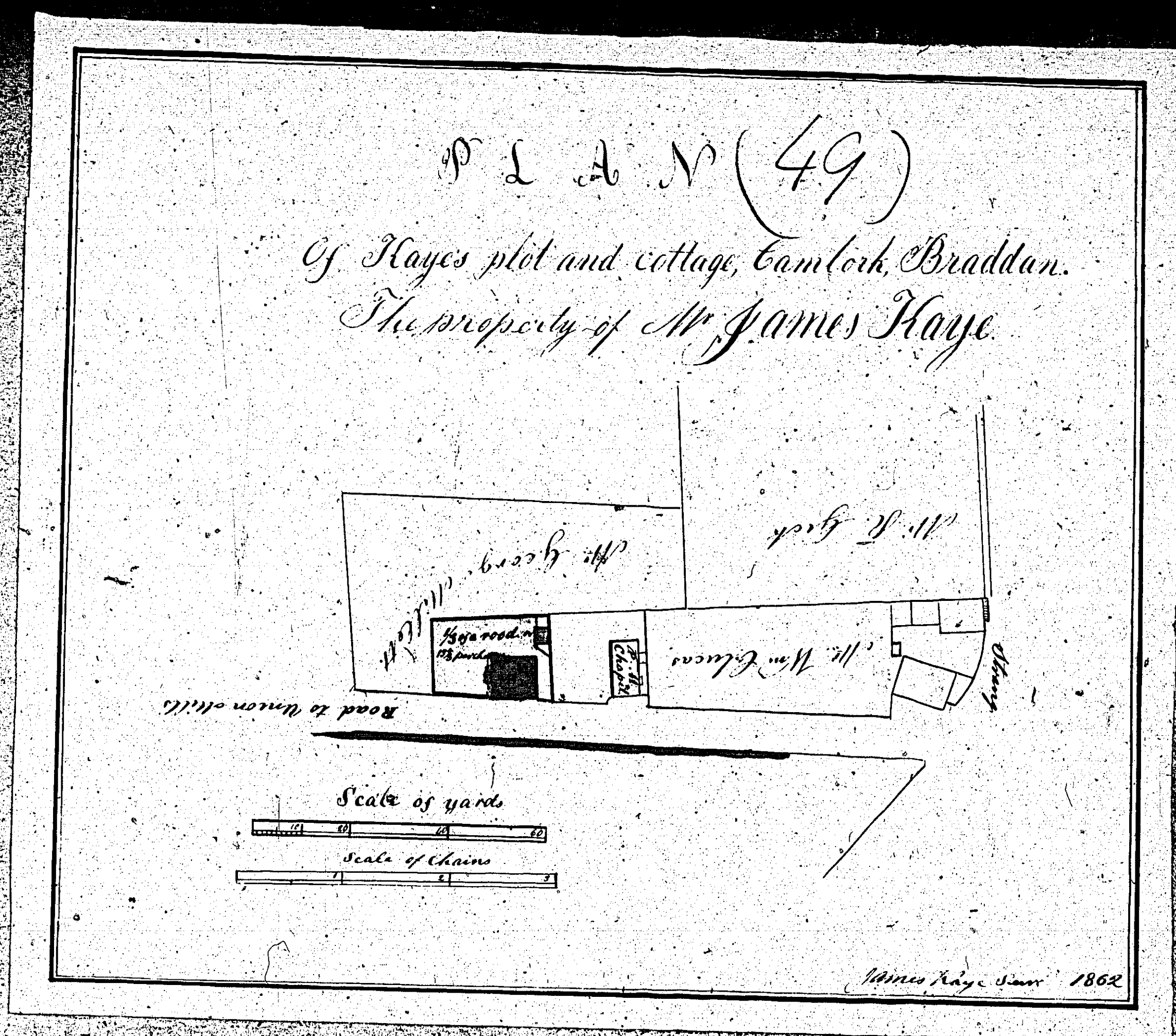

ISLE OF MAN GOVERNMENT: GENERAL REGISTRY

ASYLUM PLANS: PARISH OF BRADDAN

Original coloured

1:23

