

ISLE OF MAN GOVERNMENT: GENERAL REGISTRY

ASYLUM PLANS: PARISH OF BRADDAN

Original monotone

1:23

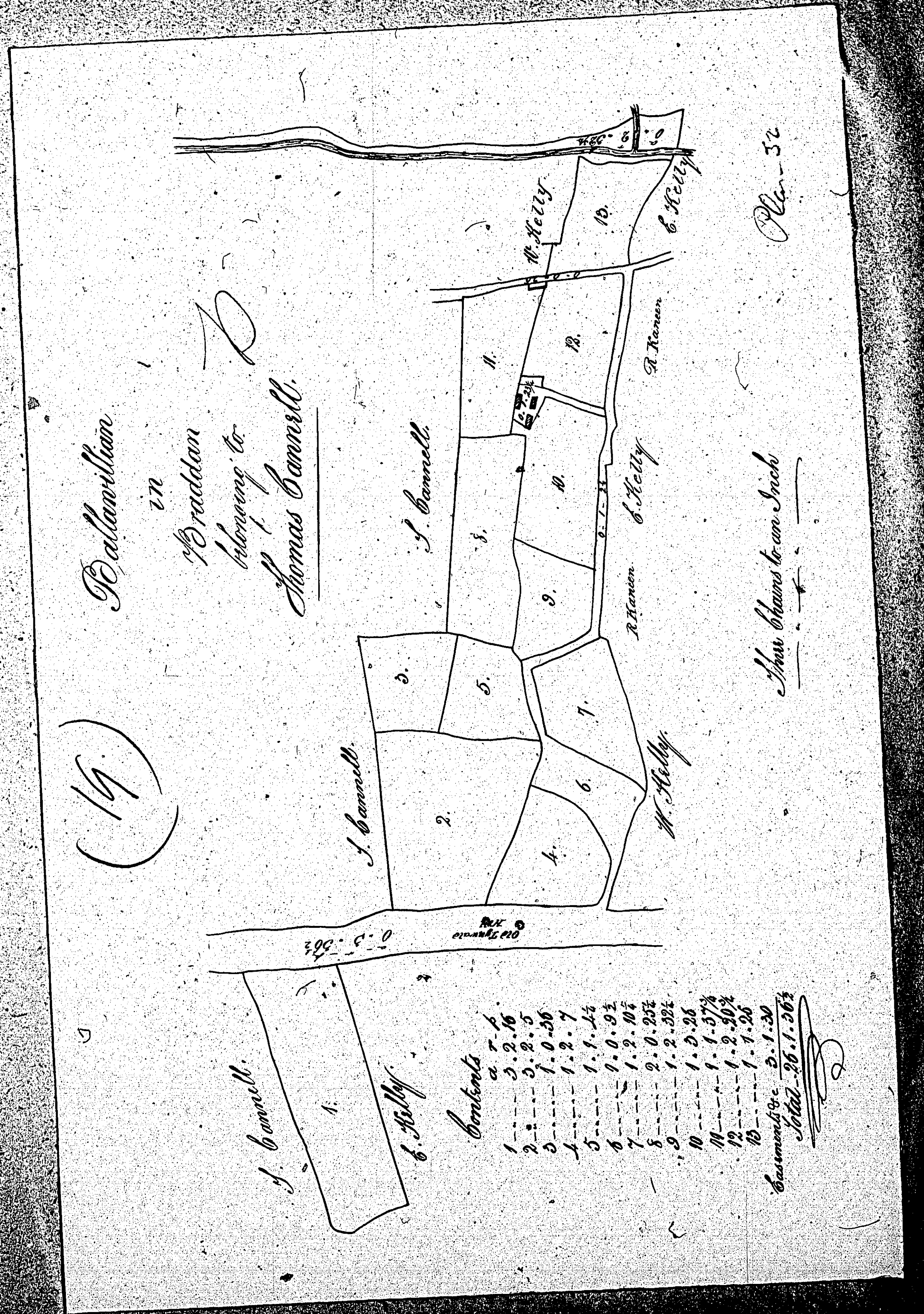



ISLE OF MAN GOVERNMENT: GENERAL REGISTRY

ASYLUM PLANS: PARISH OF BRADDAN

Originals monotone

1:23

*Ballawillian in Braddan  
belonging to Sabella Cairn*

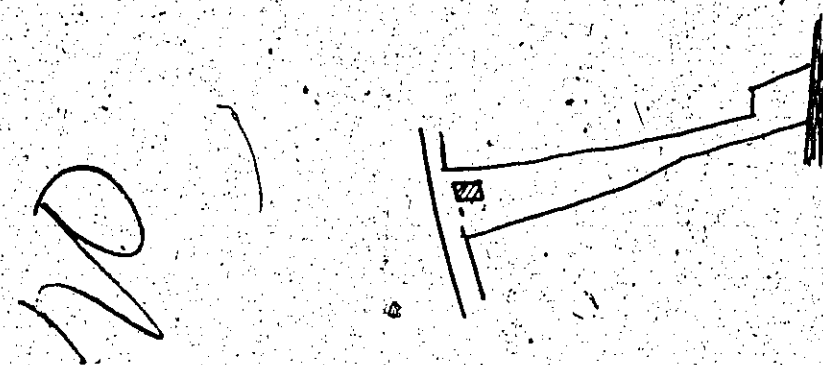

*Scale 3 chains*

*Content 0.2.54*

*Copied from Plan 336  
J. Woods 1863*

(21)

*Ballawillian  
in  
Braddan  
belonging to  
Mrs Ballou*

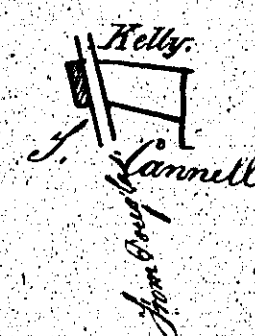

*Contents 0.0.18*

*3 chains to an Inch*

*Jas Woods  
Surveyor 1862.*



ISLE OF MAN GOVERNMENT: GENERAL REGISTRY  
 ASYLUM PLANS: PARISH OF BRADDAN

Original\* monotone

1:23

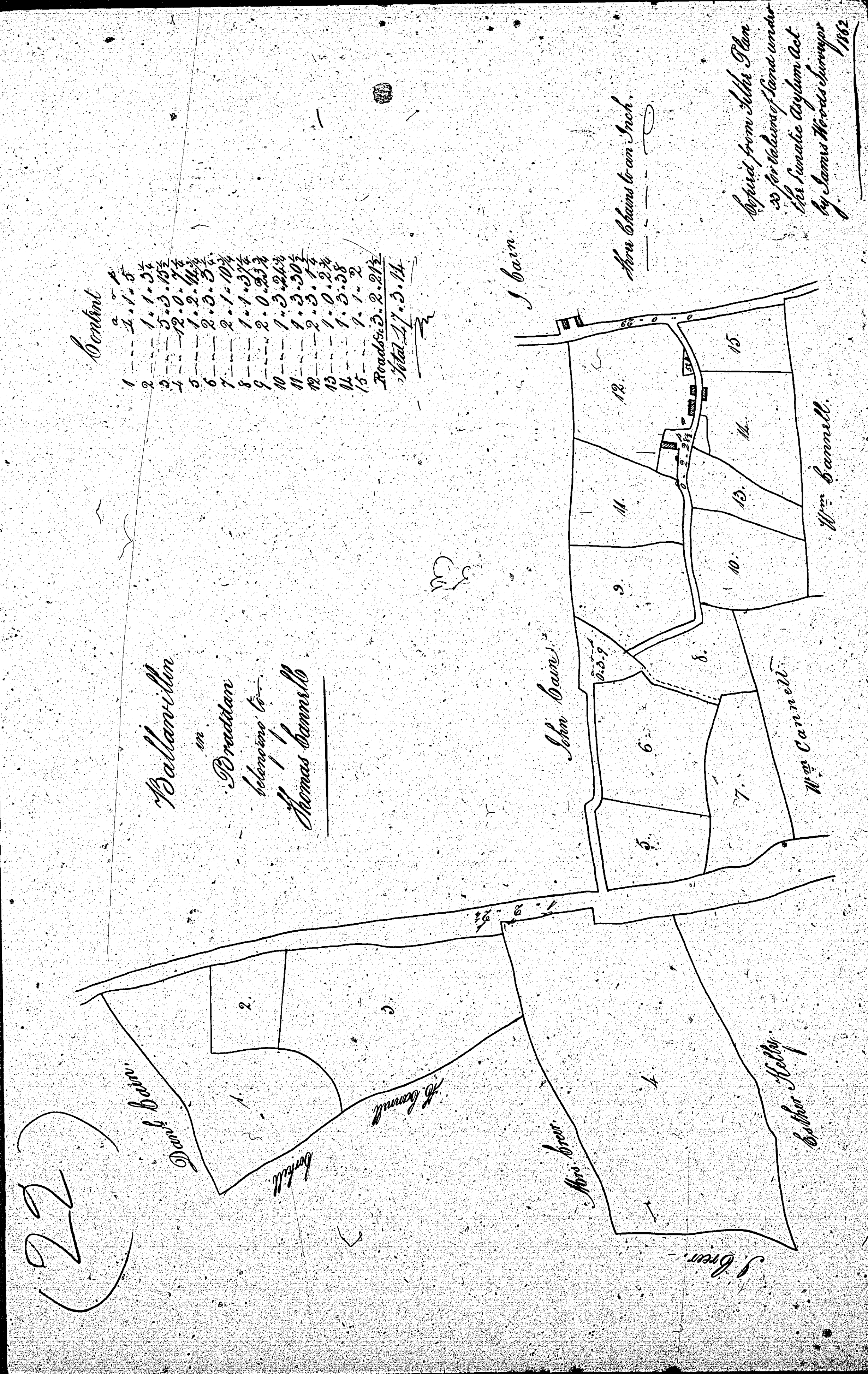



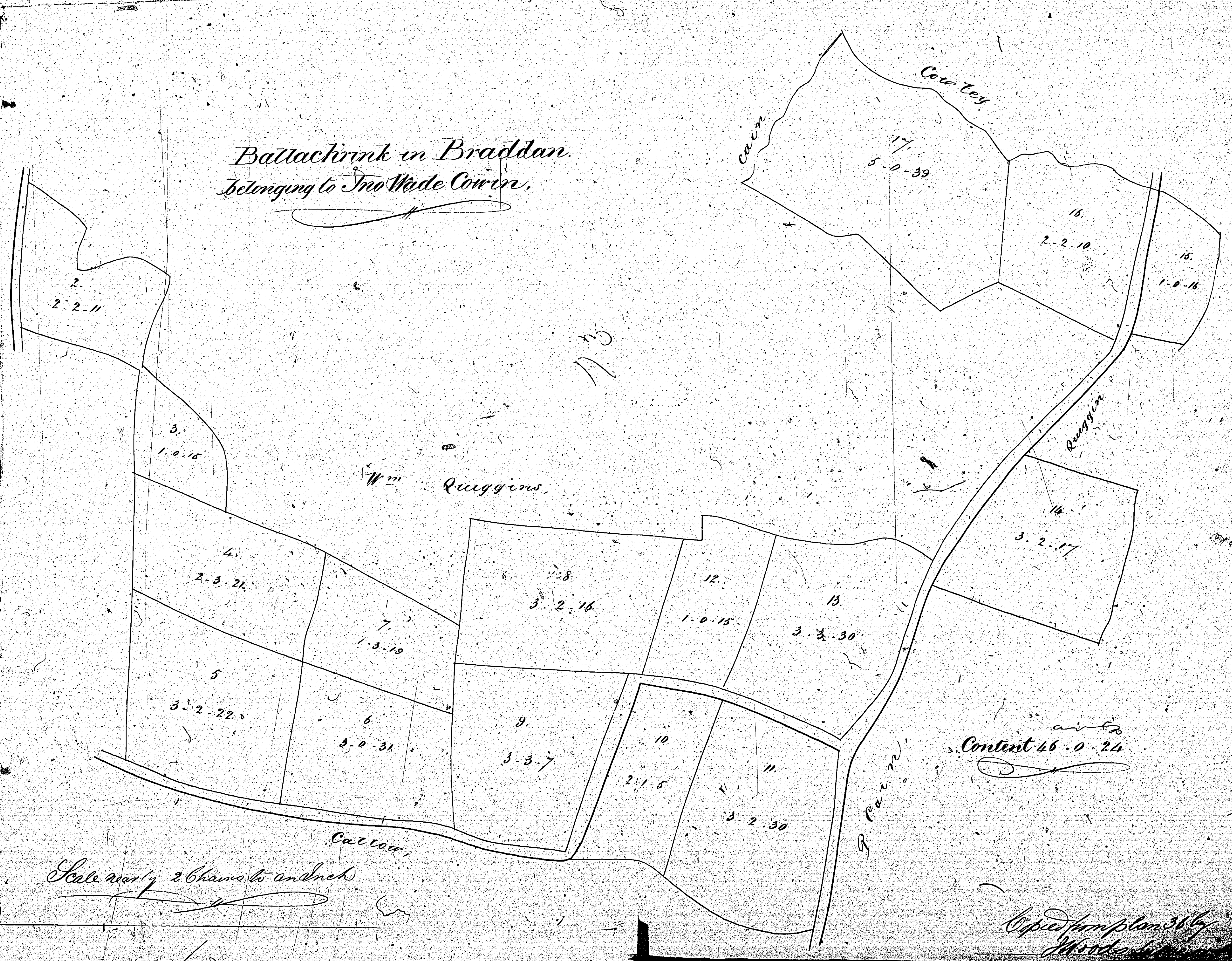

ISLE OF MAN GOVERNMENT: GENERAL REGISTRY  
ASYLUM PLANS: PARISH OF BRADDAN

Original monotone

1:23



ISLE OF MAN GOVERNMENT: GENERAL REGISTRY  
 ASYLUM PLANS: PARISH OF BRADDAN

Original monotone

23

24)

Doon  
 in  
 Braddan  
 belonging to  
 Dan. Hanrahan

*Contents*

	<i>a-r-p</i>
1	17.1.25 $\frac{1}{2}$
2	0.0.0
3	8.5.21 $\frac{1}{2}$
4	3.0.55
5	1.0.52 $\frac{1}{2}$
6	2.0.27 $\frac{1}{2}$
7	1.1.27 $\frac{1}{2}$
8	1.1.25 $\frac{1}{2}$
9	1.0.3
10	1.5.38
11	2.0.13
12	2.1.57 $\frac{1}{2}$
13	1.5.24
14	1.5.0 $\frac{1}{2}$
15	2.5.15 $\frac{1}{2}$
16	1.5.24 $\frac{1}{2}$
17	1.5.24 $\frac{1}{2}$
18	5.1.7 $\frac{1}{2}$
19	1.0.28
20	2.1.22 $\frac{1}{2}$
21	1.0.34 $\frac{1}{2}$
22	2.2.6 $\frac{1}{2}$
<i>Basements &amp;c</i>	2.0.15 $\frac{1}{2}$
<i>Total</i>	105.1.58 $\frac{1}{2}$

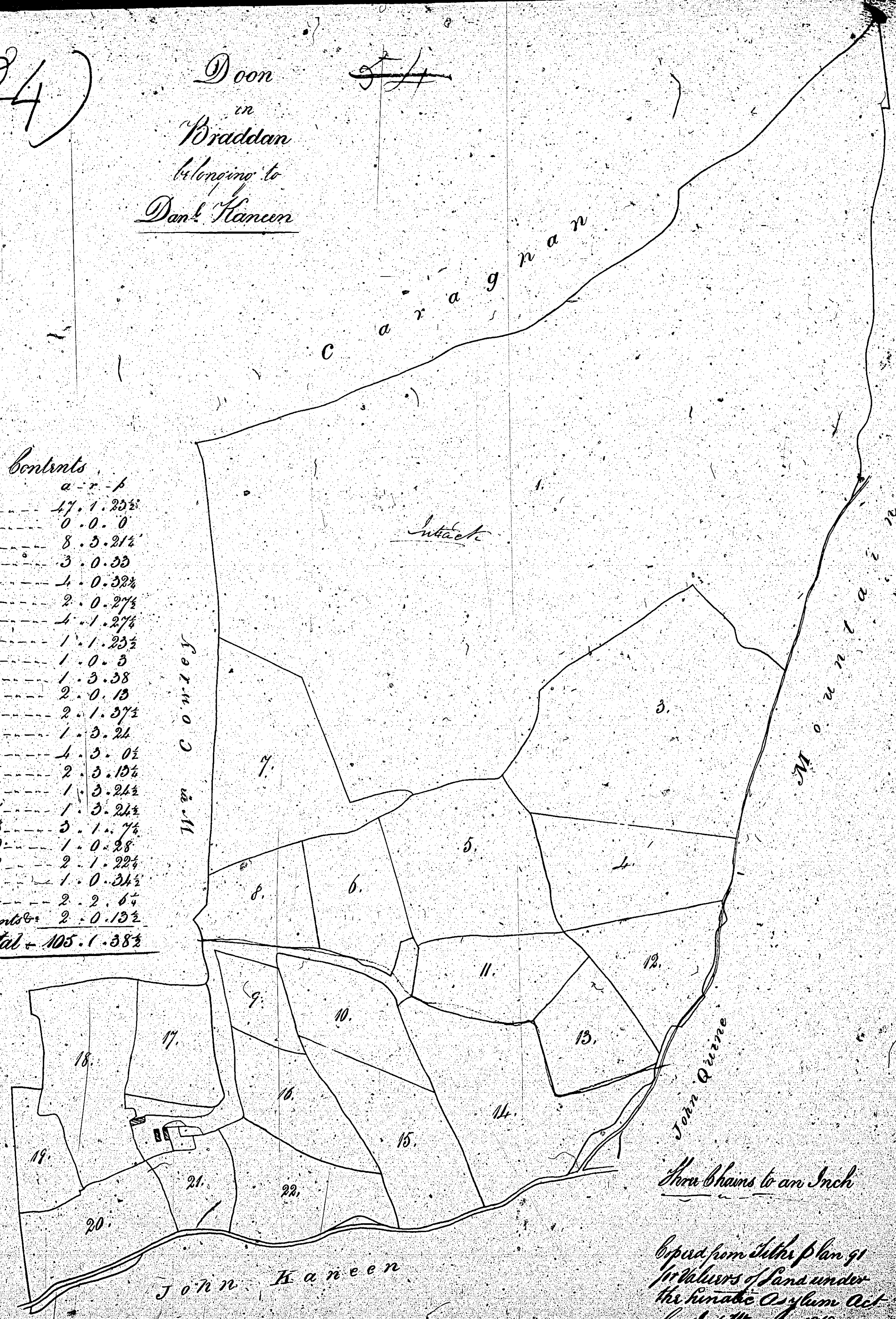

Scale shows to an Inch

Copied from the plan of  
 the values of land under  
 the Lunatic Asylum Act  
 by Jas Woods 1862.



ISLE OF MAN GOVERNMENT: GENERAL REGISTRY

ASYLUM PLANS: PARISH OF BRADDAN

Original coloured

1:23

References

1	2	3	4	5	6	7	8	9	10	11	12	13	14	15	16	17	18	19	20	21	22	23	24	25	26	27	28	29	30	31	32	33	34	35	36	37	38	39	40	41	42	43	44	45	46	47	48	49	50	51	52	53	54	55	56	57	58	59	60	61	62	63	64	65	66	67	68	69	70	71	72	73	74	75	76	77	78	79	80	81	82	83	84	85	86	87	88	89	90	91	92	93	94	95	96	97	98	99	100
---	---	---	---	---	---	---	---	---	----	----	----	----	----	----	----	----	----	----	----	----	----	----	----	----	----	----	----	----	----	----	----	----	----	----	----	----	----	----	----	----	----	----	----	----	----	----	----	----	----	----	----	----	----	----	----	----	----	----	----	----	----	----	----	----	----	----	----	----	----	----	----	----	----	----	----	----	----	----	----	----	----	----	----	----	----	----	----	----	----	----	----	----	----	----	----	----	----	----	-----

Ch. B. De laud. system is copied from  
a plan and survey, made by  
Mr James Gray, dated 21<sup>st</sup>  
1841.

Part of the Quarters of Luggaveen and an Outack.  
Braddan. The property of Mr Robert Linn of Braddan.

