

ISLE OF MAN GOVERNMENT: GENERAL REGISTRY

ASYLUM PLANS: PARISH OF BALLAUGH

Originals coloured

1:23

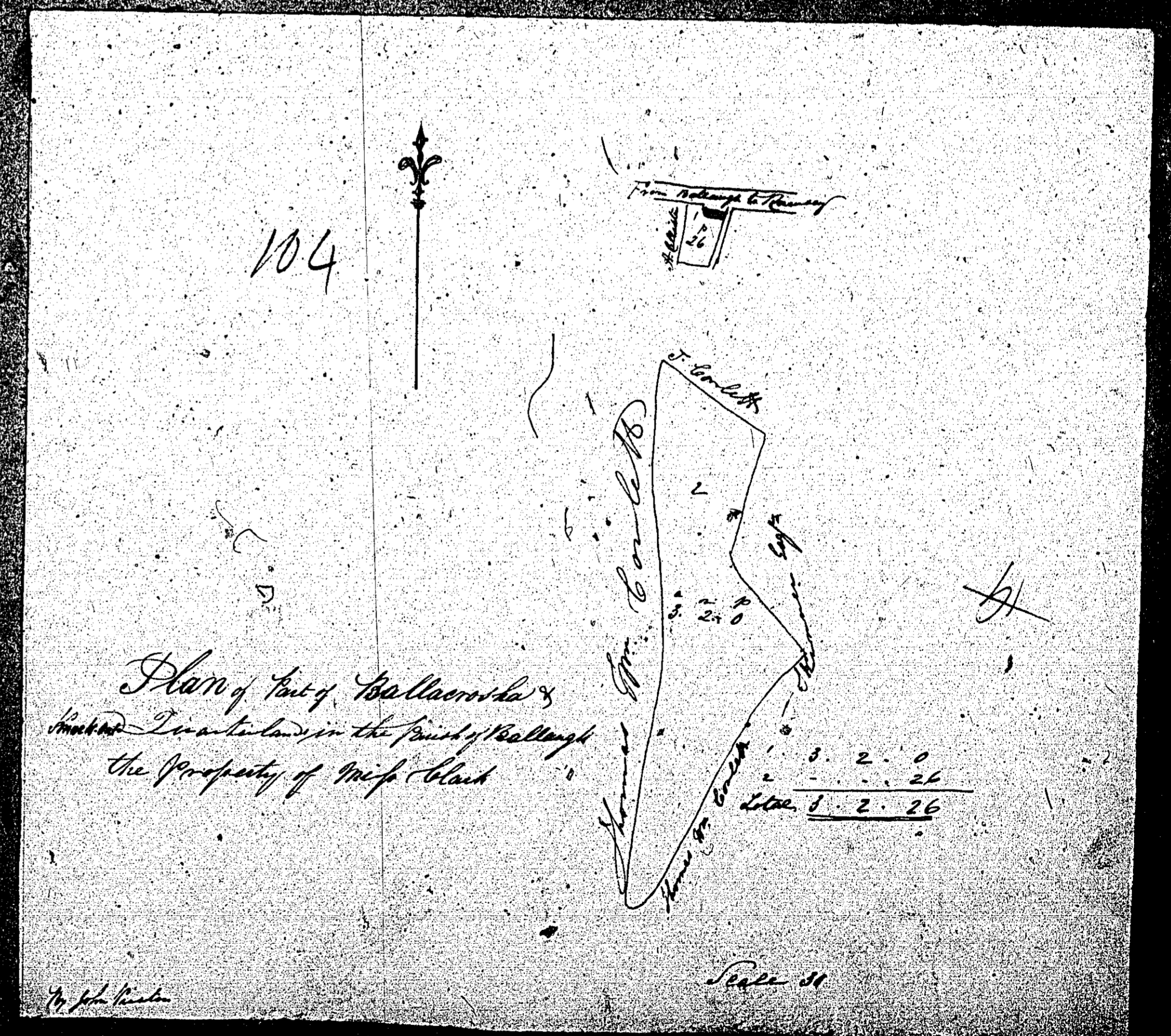
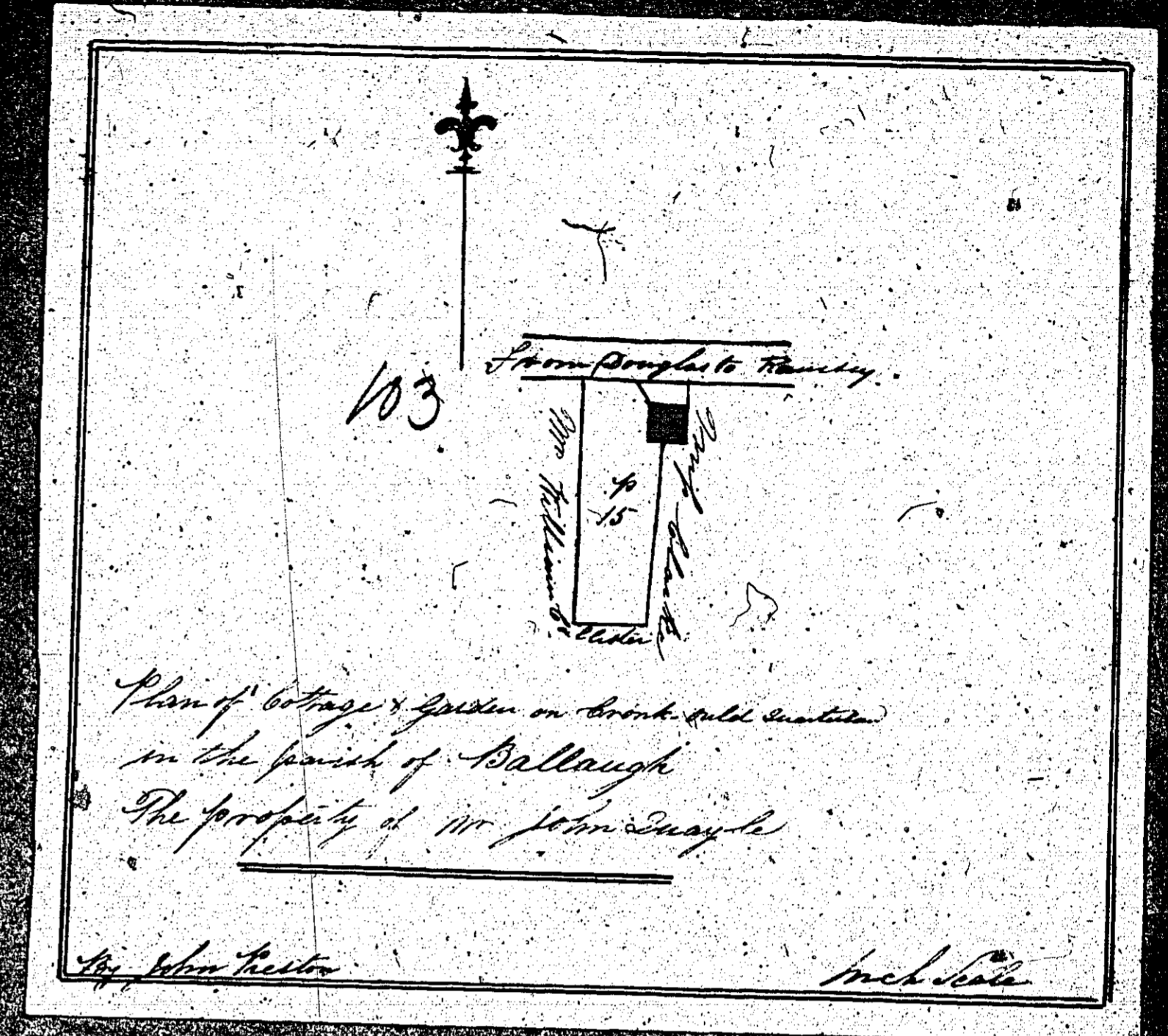

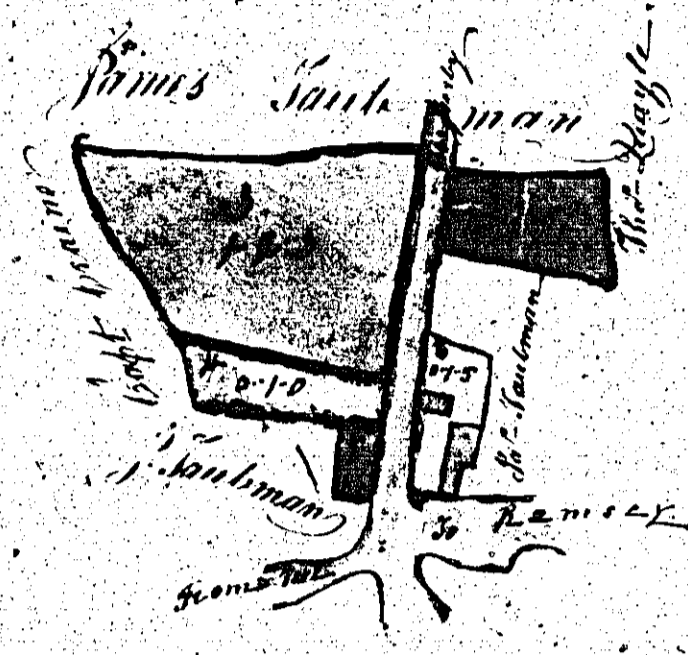

Plan and Survey of Part of the Townland of
 Cairmodil, Wood and other Lands Situate in
 the Parish of Ballaugh, the Property of
 John Gasar (Heir) 1837
 By D. Kelly 1862

Contents of other Land

1	3	1	13
2	3	1	34
3	1	2	3
4	6	7	0
5	0	1	11
6	0	1	5
7	5	3	17 1/2
8	5	3	28
9	4	3	0
amt	25	1	31

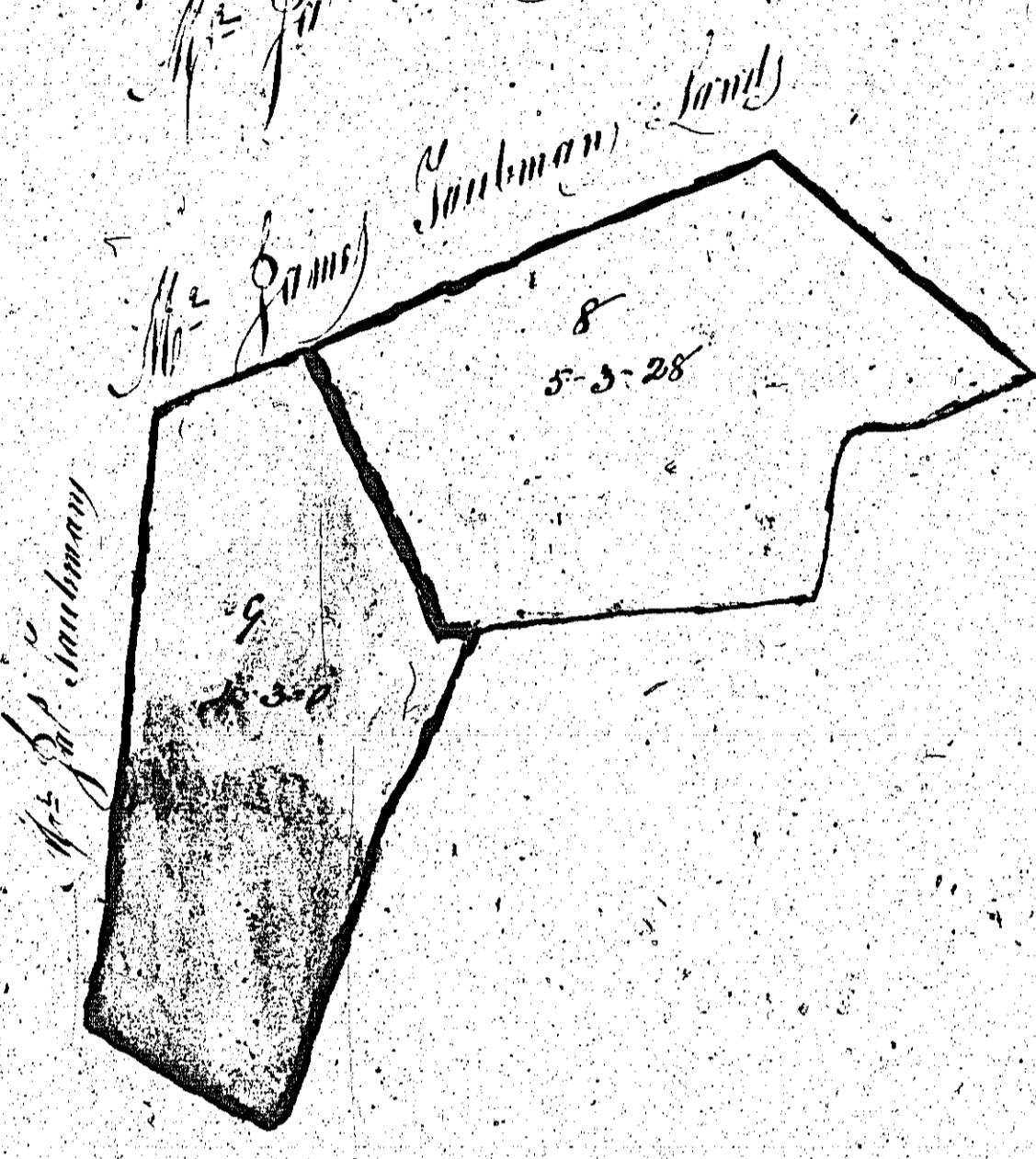
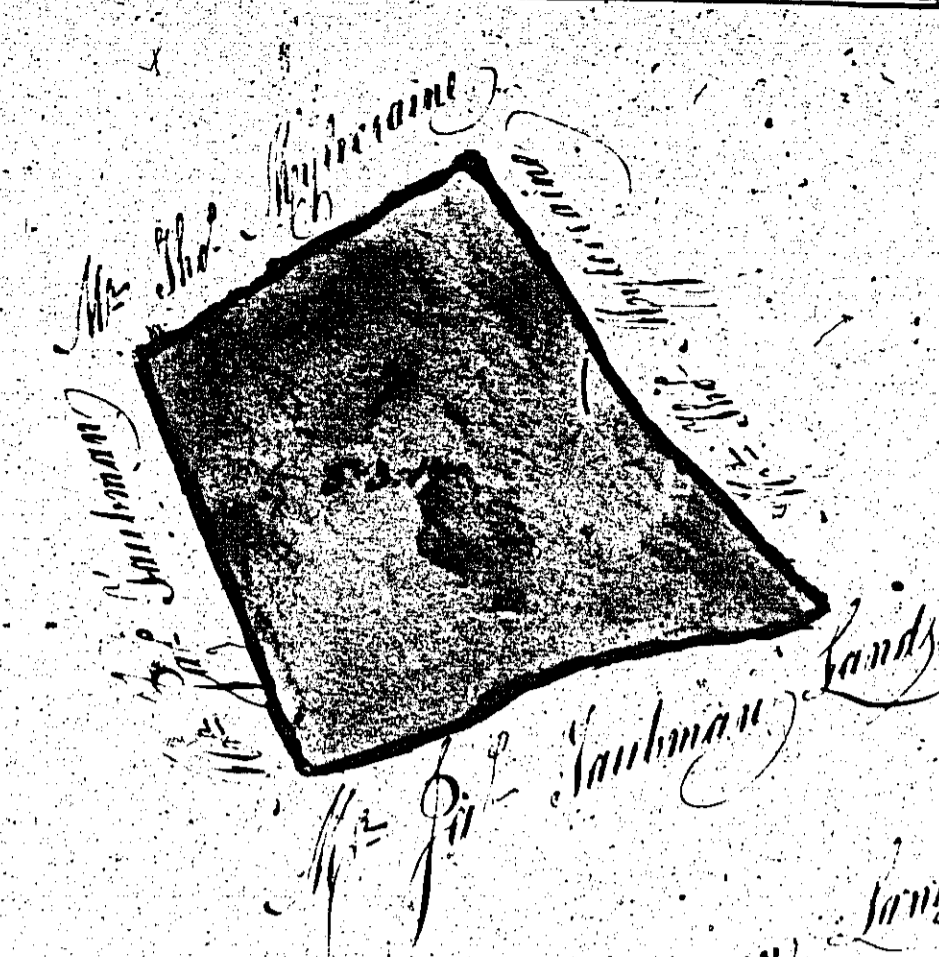

Contents of Cairmodil

1	1	3	20 1/2
2	2	3	35
3	1	1	32
4	7	2	36
5	2	1	26 1/2
6	1	1	10 1/2
7	3	1	36 1/2
8	2	3	27 1/4
9	3	2	39 1/2
10	5	1	27 1/4
11	3	3	34 1/2
12	5	2	8 1/2
13	3	1	15
14	7	3	0 1/4
15	5	3	24 1/2
16	6	2	11 1/4
17	3	1	33
18	4	3	5
19	0	2	0
total amt	70	0	19

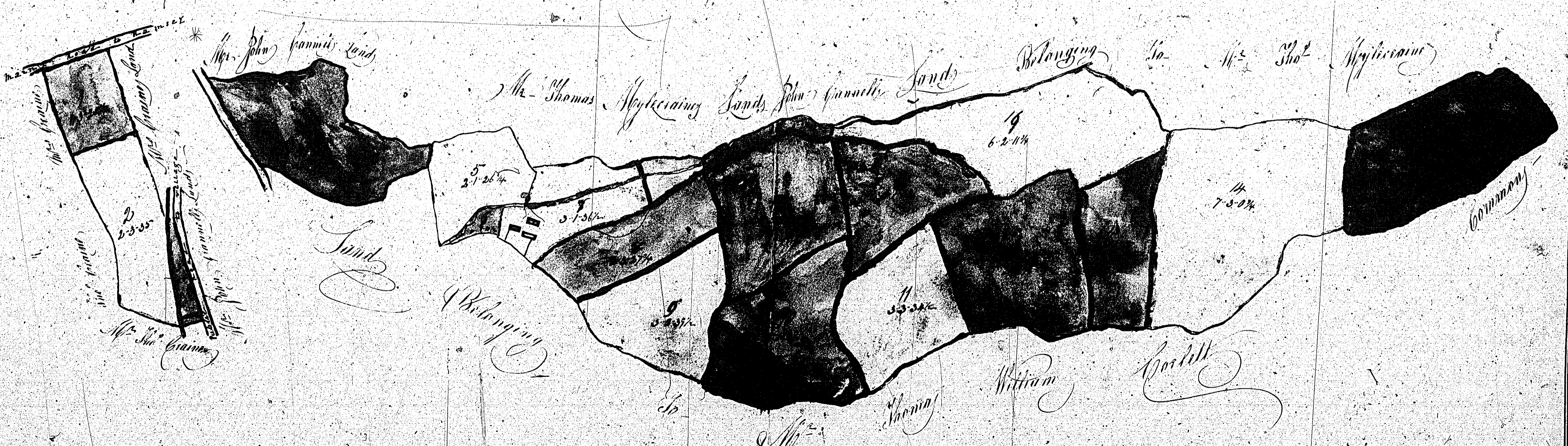

Scale & Chain to an inch

ISLE OF MAN GOVERNMENT: GENERAL REGISTRY

ASYLUM PLANS: PARISH OF BALLAUGH

Original coloured

1:23

There is no plan

numbered

108

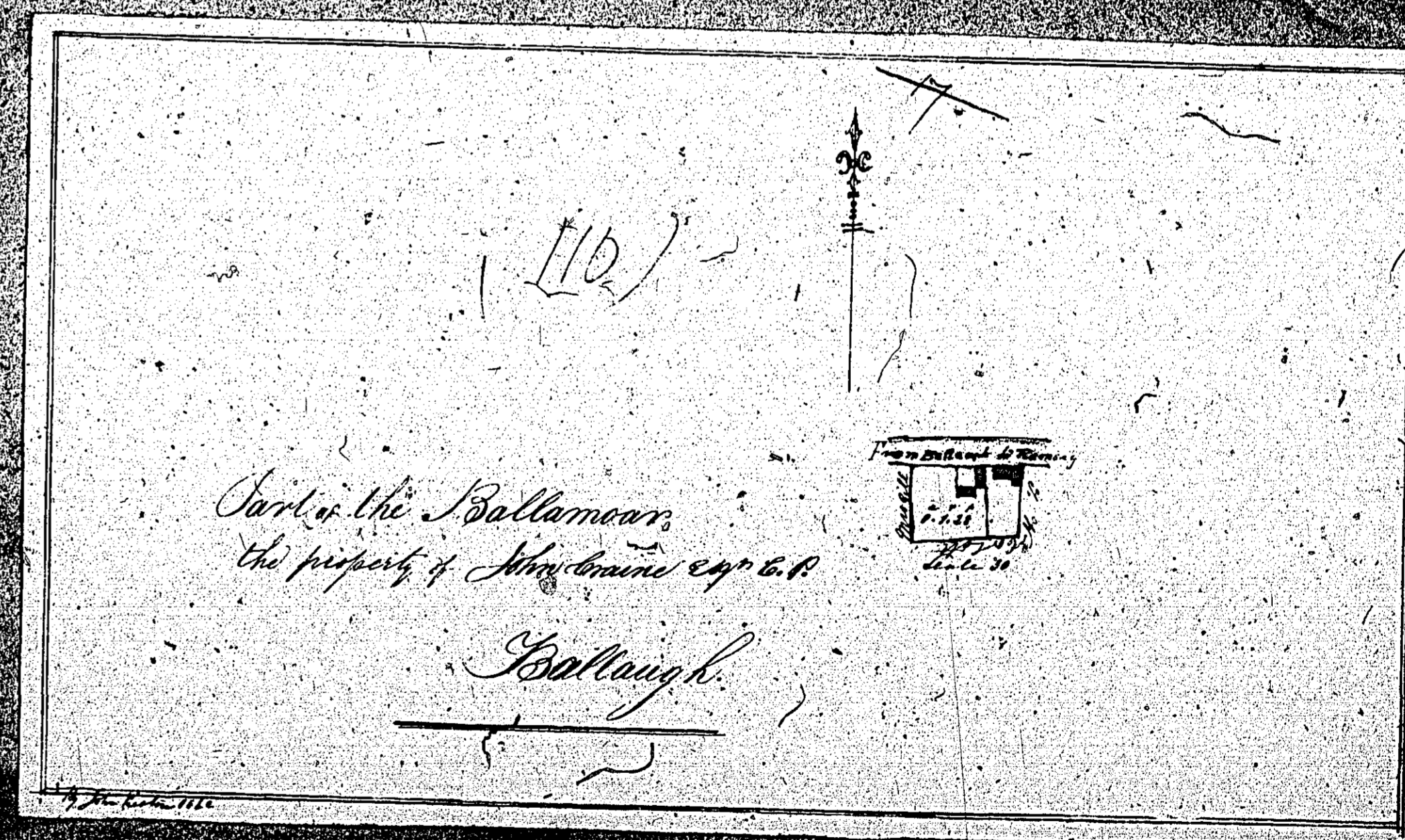
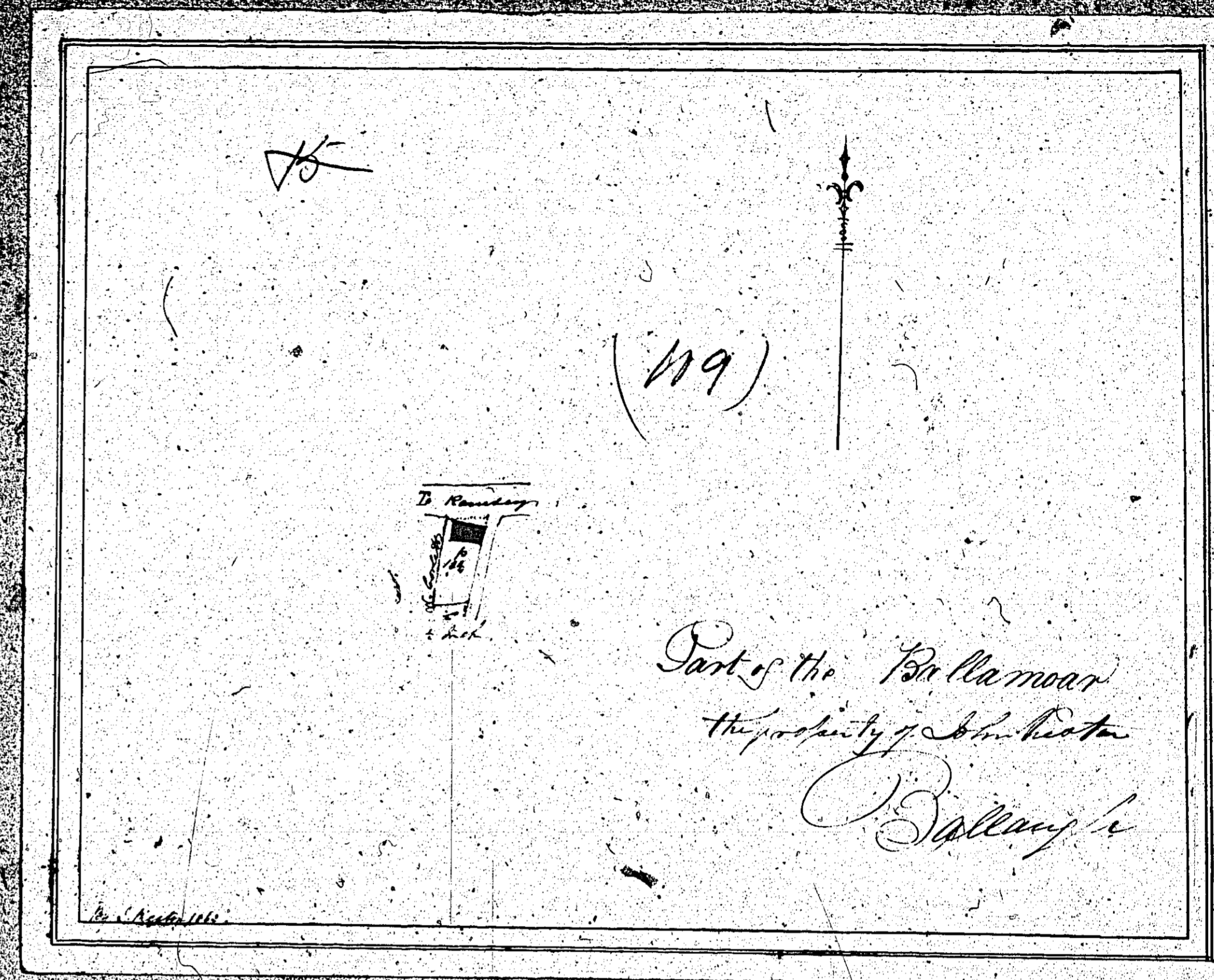

ISLE OF MAN GOVERNMENT: GENERAL REGISTRY

ASYLUM PLANS: PARISH OF BALLAUGH

Originals coloured

1:23

ISLE OF MAN GOVERNMENT: GENERAL REGISTRY

ASYLUM PLANS: PARISH OF BALLAUGH

Original coloured

1:23

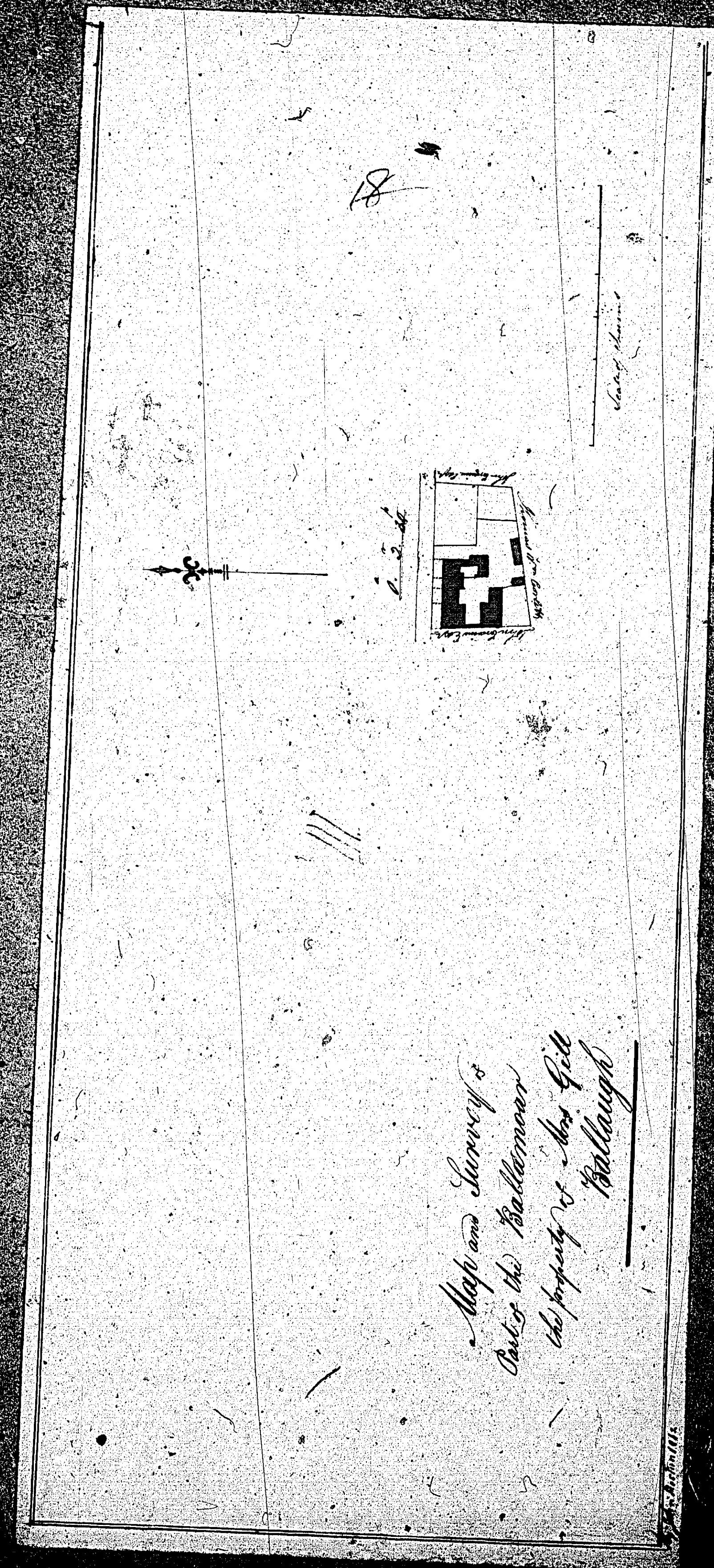

ISLE OF MAN GOVERNMENT: GENERAL REGISTRY

ASYLUM PLANS: PARISH OF BALLAUGH

Originals coloured

1:23

