

NOTES

The plans have been filmed in their bound state

This will have caused some image distortion particularly where large plans go into the binding gutter and/or have been folded

Many of the larger plans are damaged

Where plans are coloured this has been noted; 'monochrome' indicates a single ink colour which may be black, brown or blue

START OF VOLUME

The following two
plans are both
numbered

1

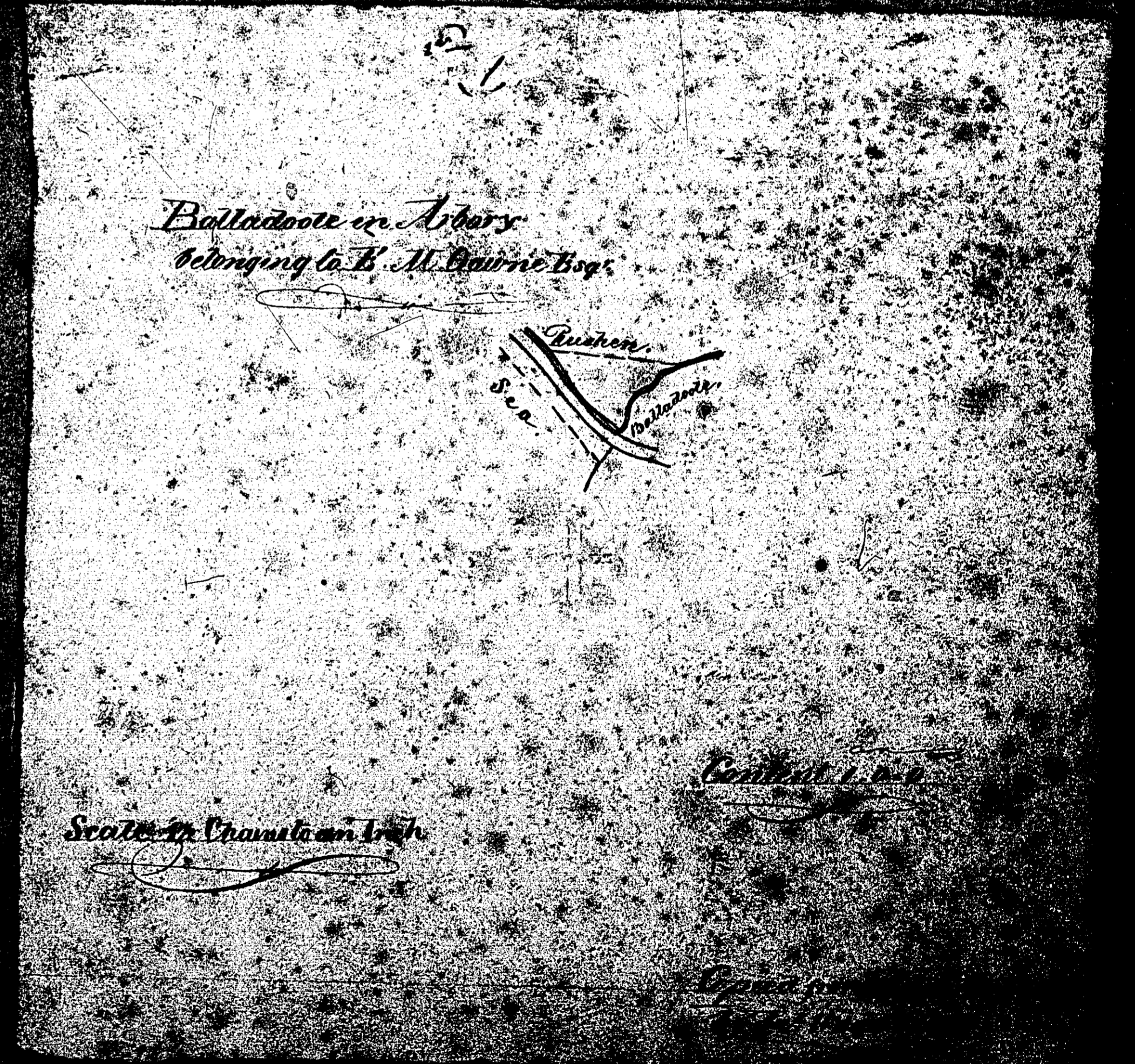
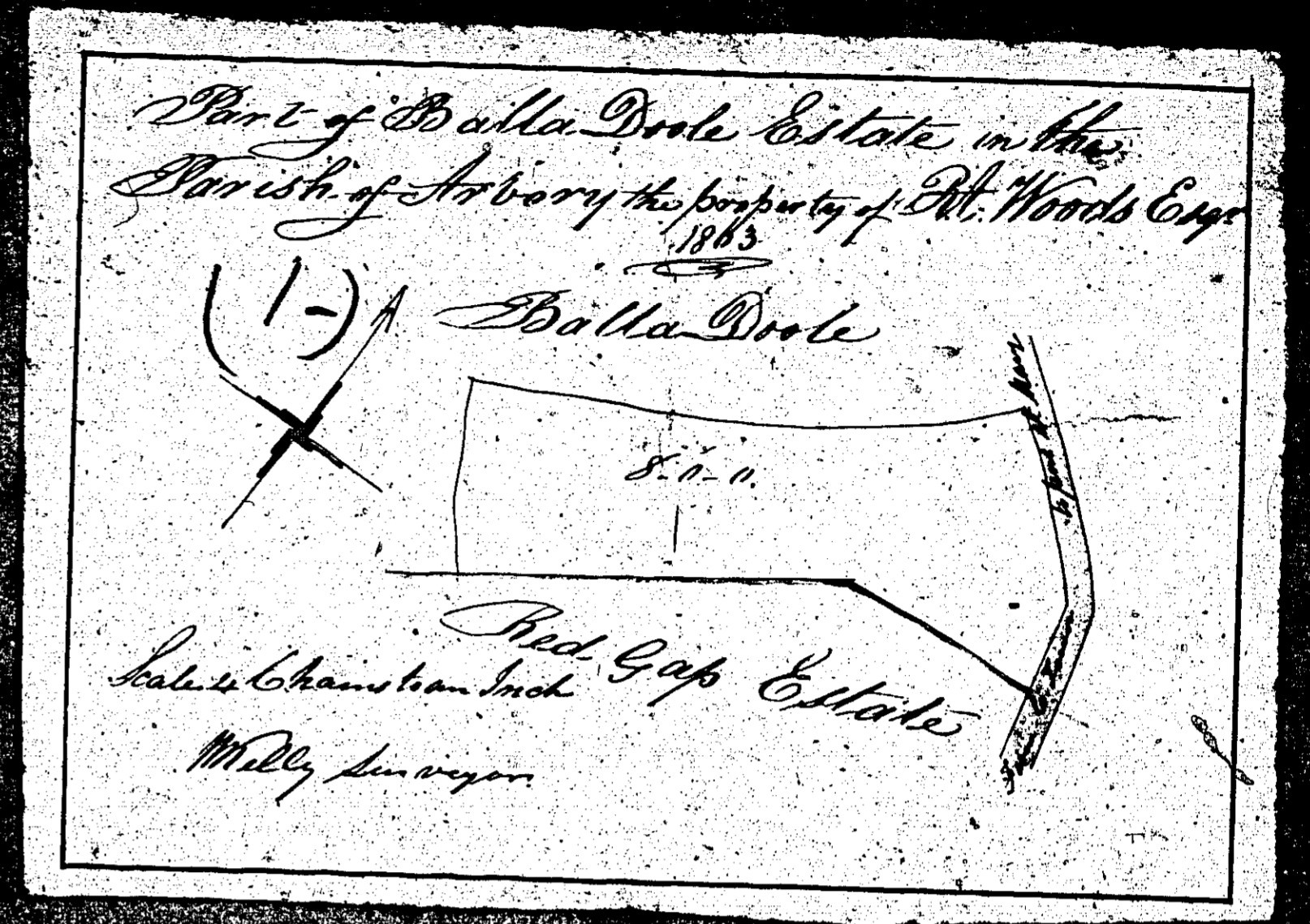

ISLE OF MAN GOVERNMENT: GENERAL REGISTRY

ASYLUM PLANS: PARISH OF ARBORY

1:23

1 Original coloured
[1] Original monotone

ISLE OF MAN GOVERNMENT: GENERAL REGISTRY

ASYLUM PLANS: PARISH OF ARBORY

Original coloured

1:23

2

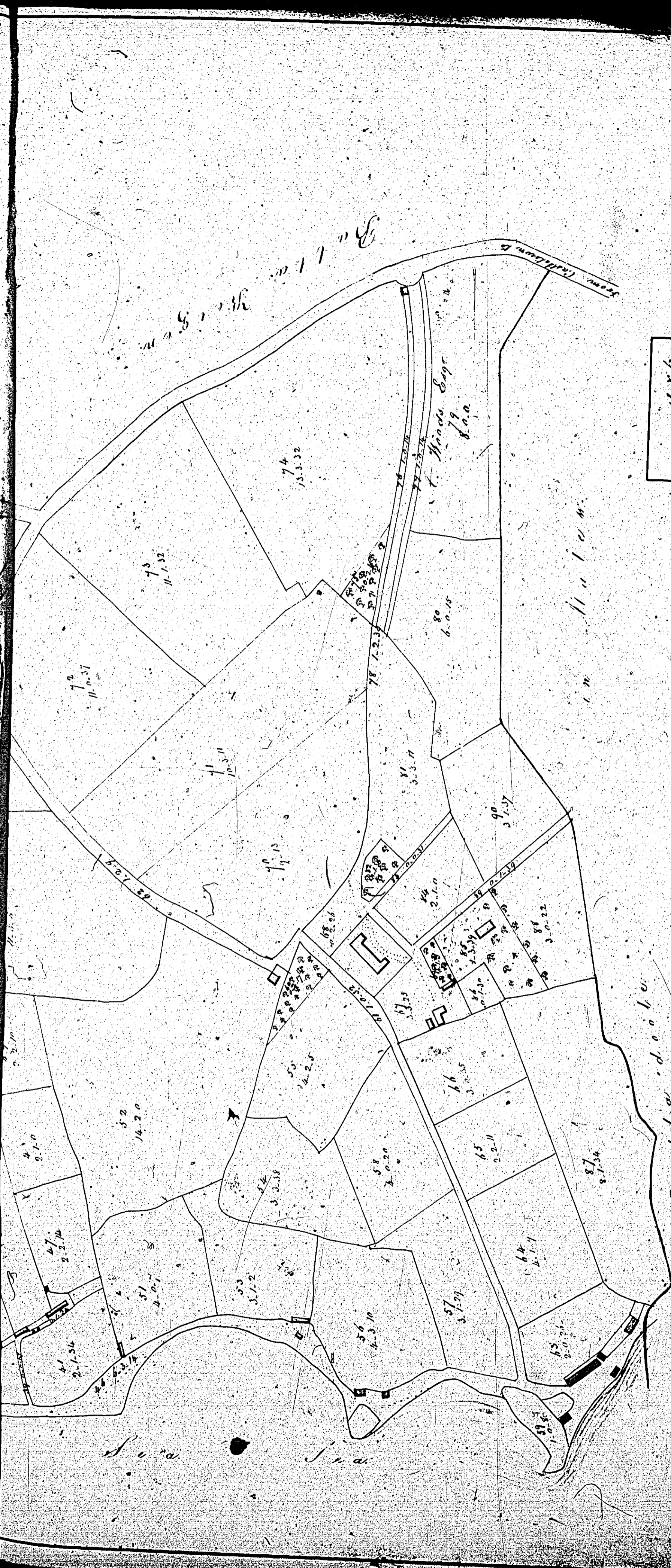
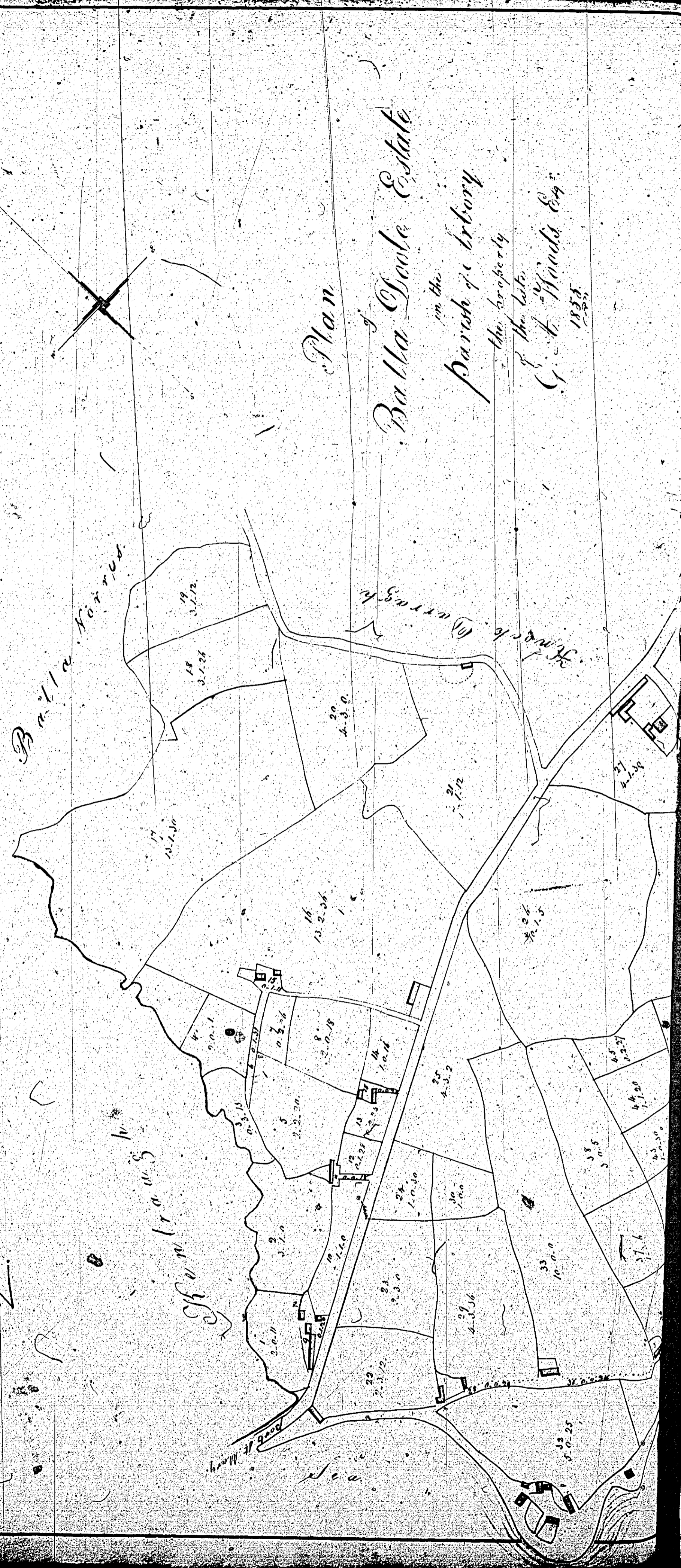
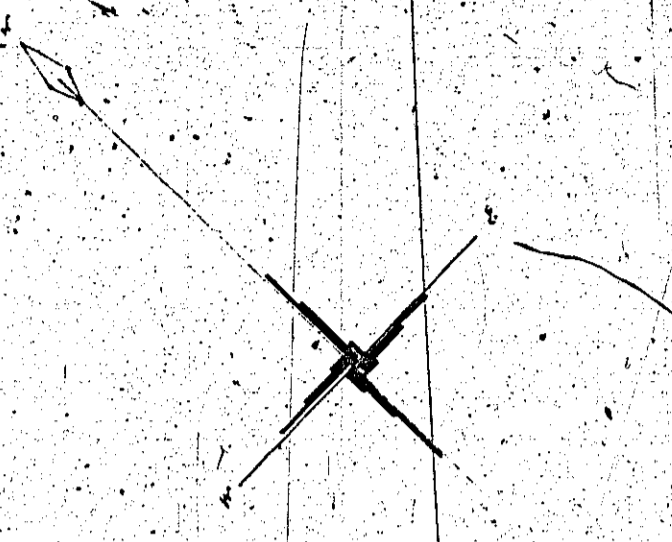

11.7.6
200.3.27
333-1-22
312.3.27

Scale of Chains
100

W. J. Young

ISLE OF MAN GOVERNMENT: GENERAL REGISTRY

ASYLUM PLANS: PARISH OF ARBORY

1:23

- 3 Original coloured
- 4 Original coloured
- 5 Original monotone

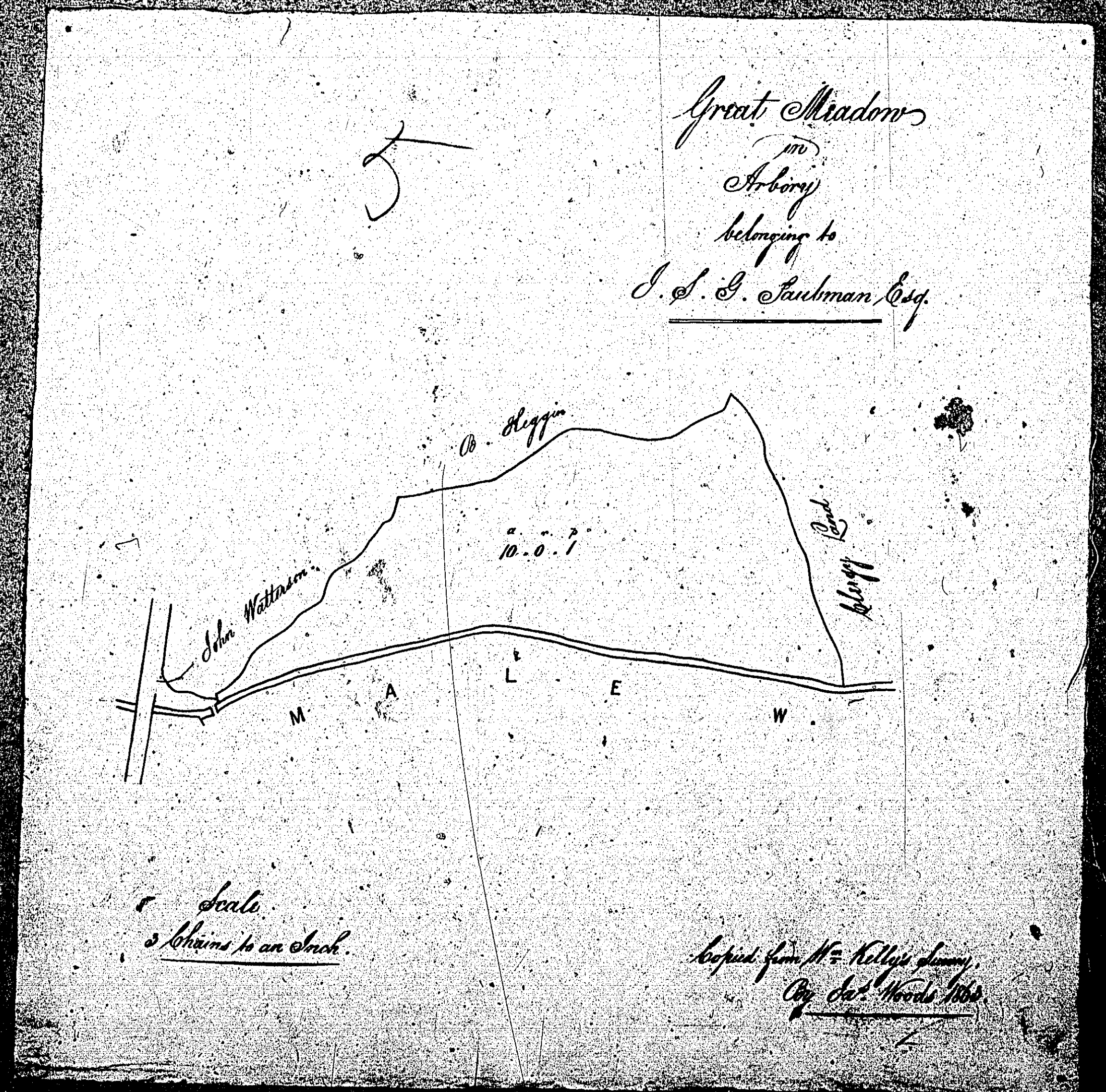
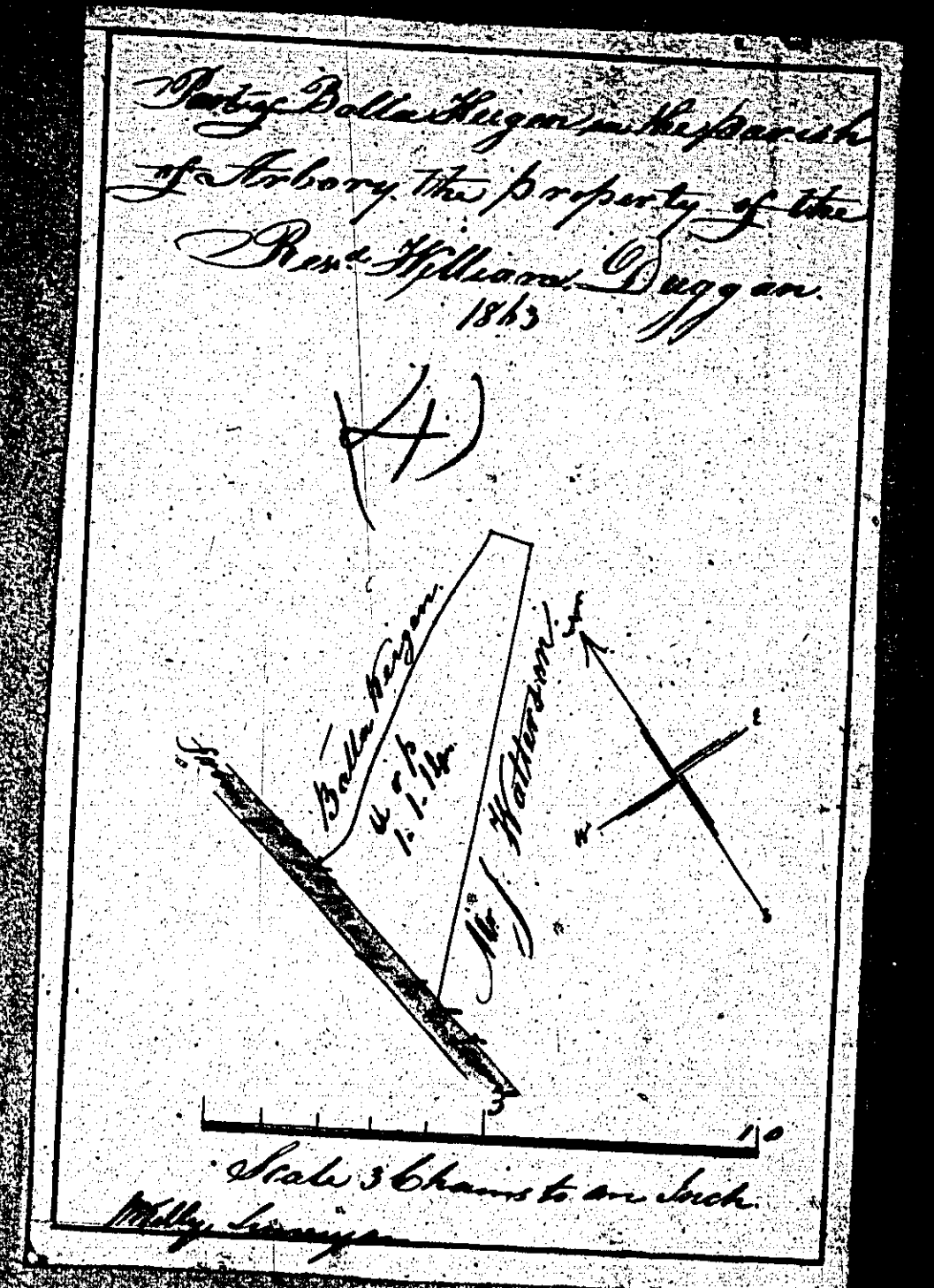
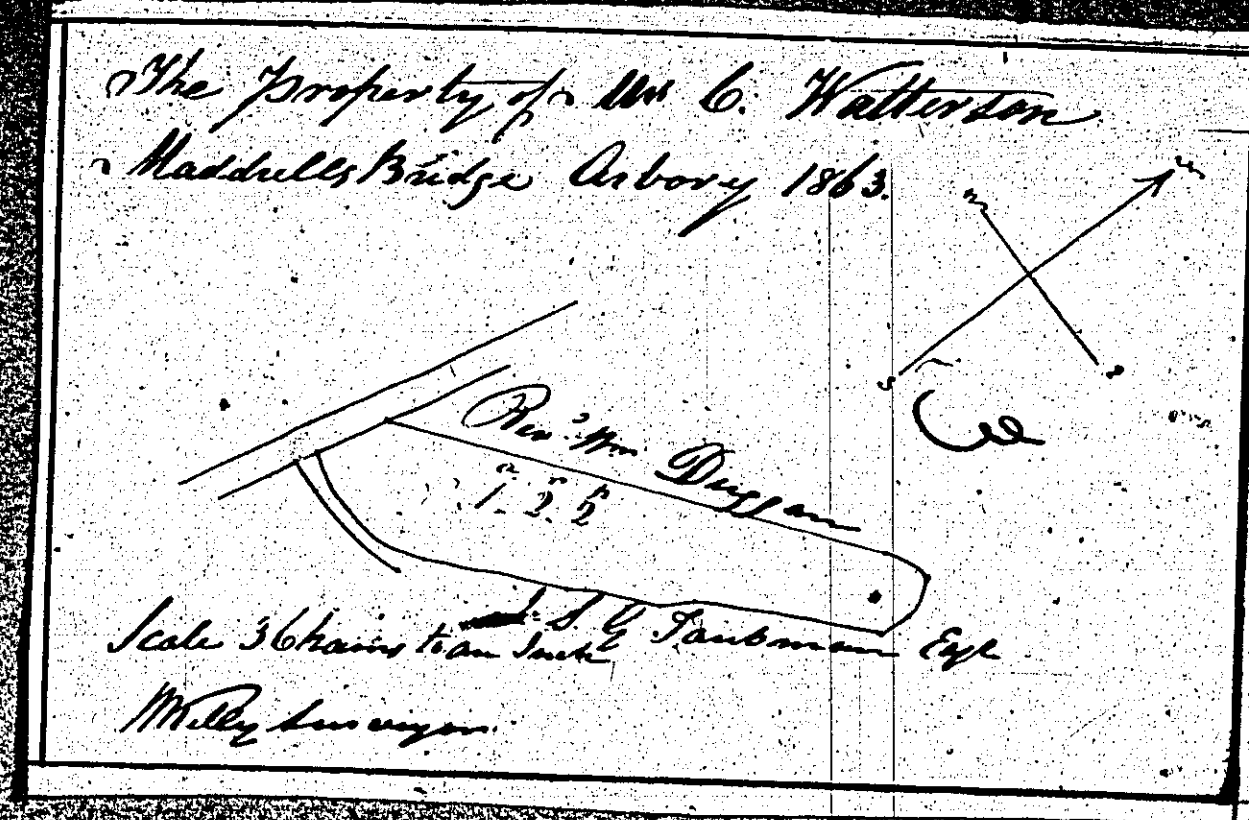

The following two
plans are both
numbered

6

ISLE OF MAN GOVERNMENT: GENERAL REGISTRY

ASYLUM PLANS: PARISH OF ARBORY

1:23

- 6 Original monotone
- [6] Original coloured (decorative)

