

The following three
plans are all
numbered

77

ISLE OF MAN GOVERNMENT: GENERAL REGISTRY

ASYLUM PLANS: PARISH OF ANDREAS

Originals monotone

1:23

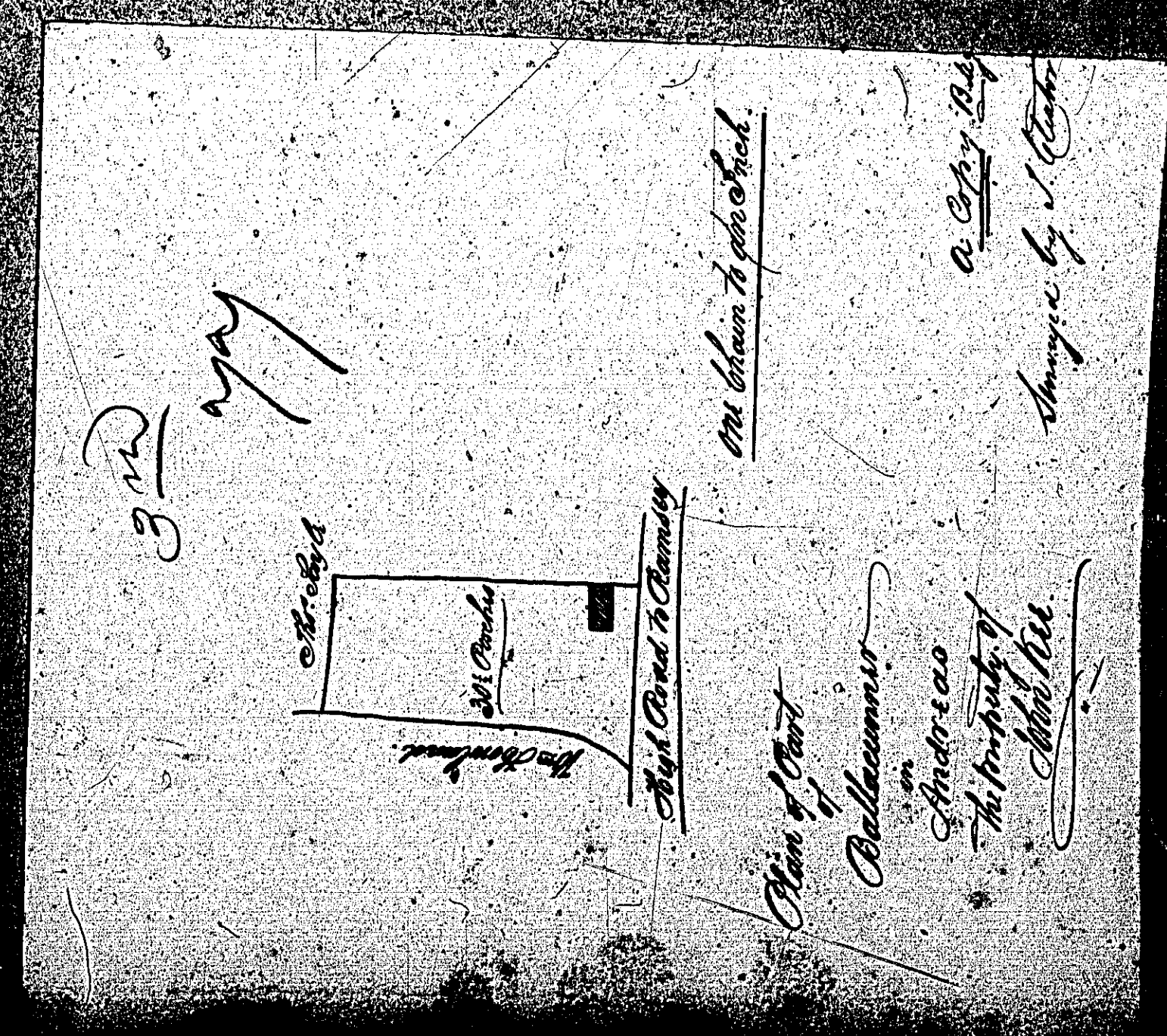
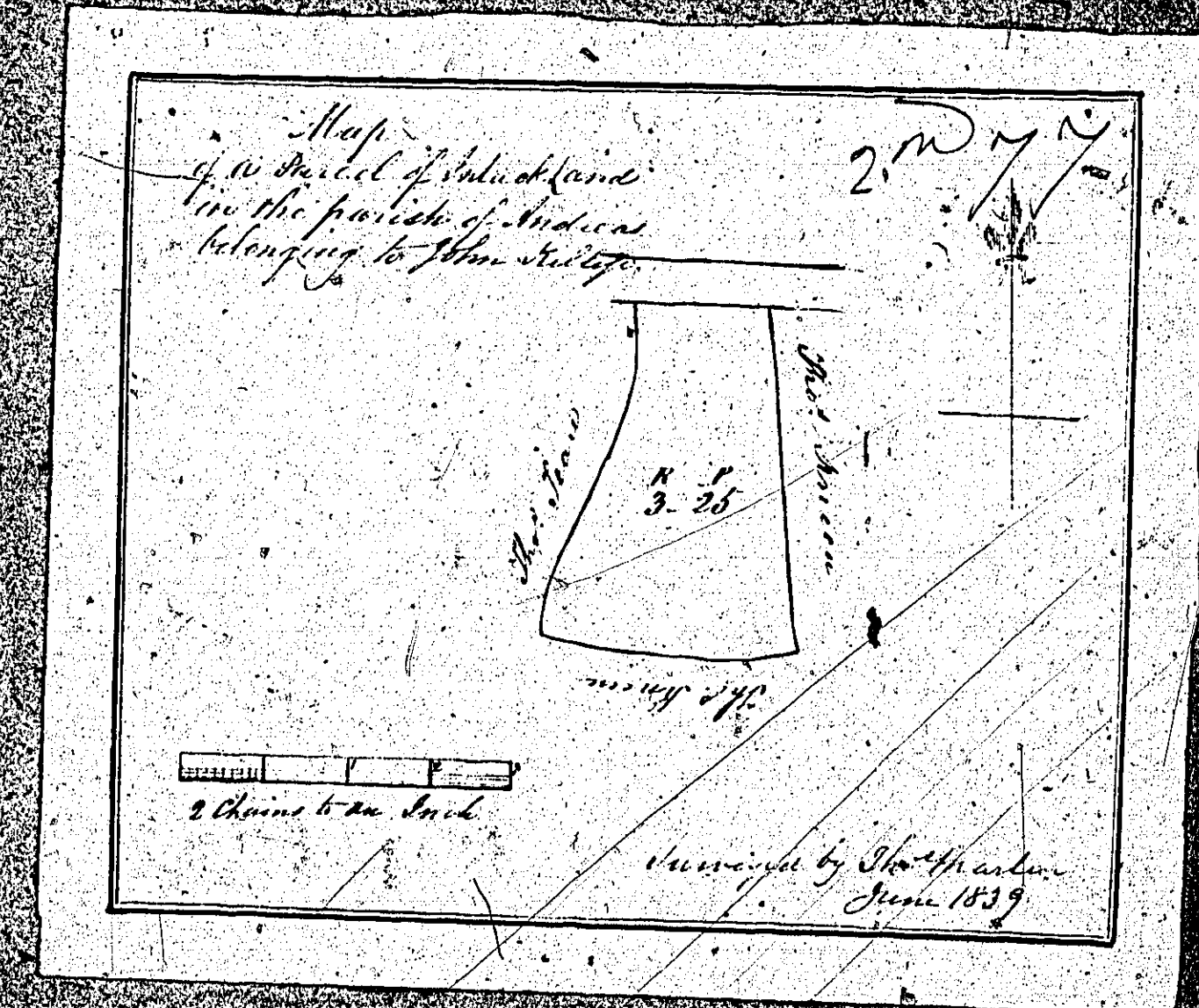
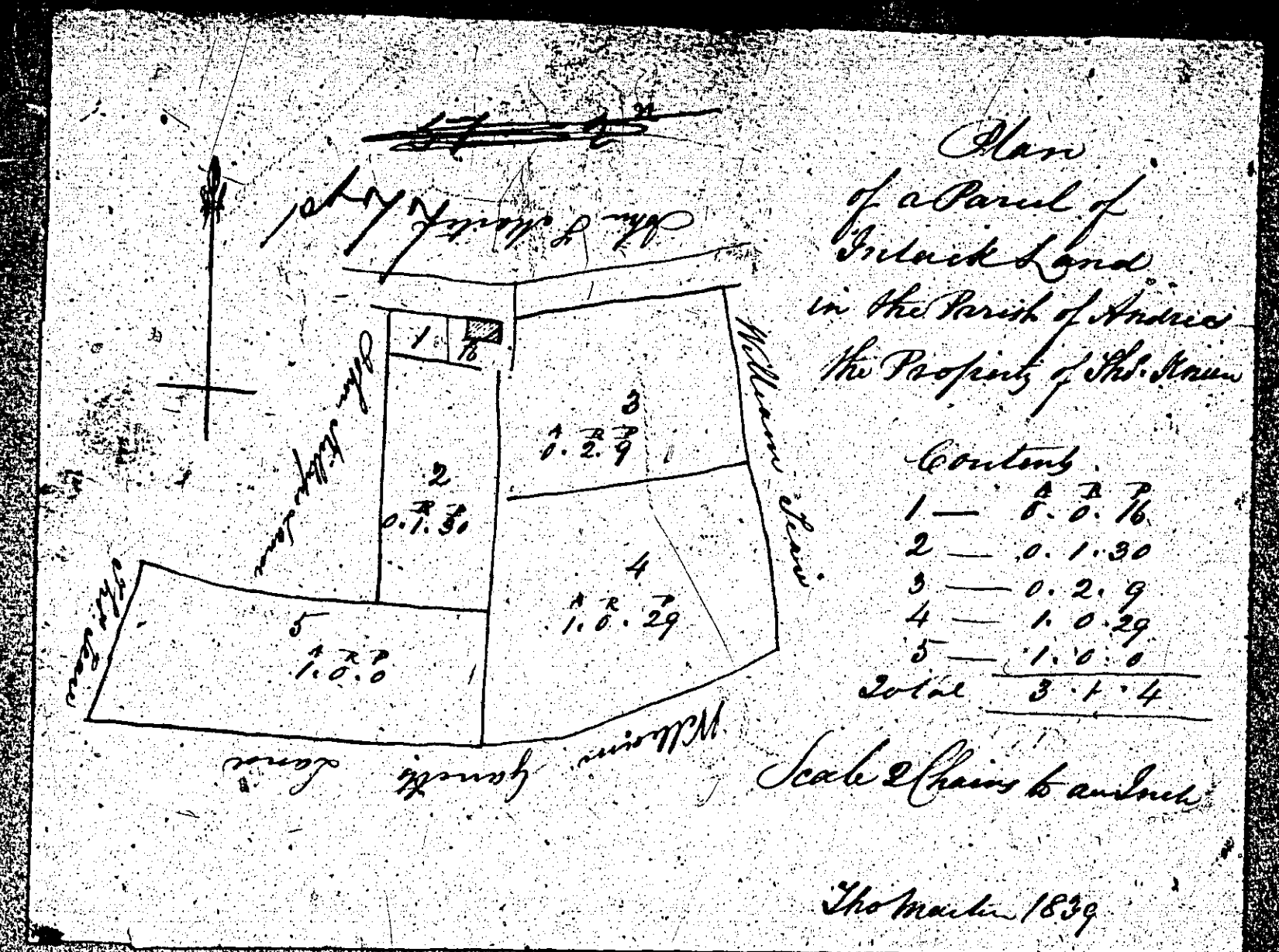

ISLE OF MAN GOVERNMENT: GENERAL REGISTRY

ASYLUM PLANS: PARISH OF ANDREAS

Original coloured

1:23

A Plan Surveyed
of a part of
the Estate of
Baillanaston
in the parish of Andreas
the property of Mr John Doyle

79

William Callister Esq.

W Callister Esq.

John Radcliffe Land

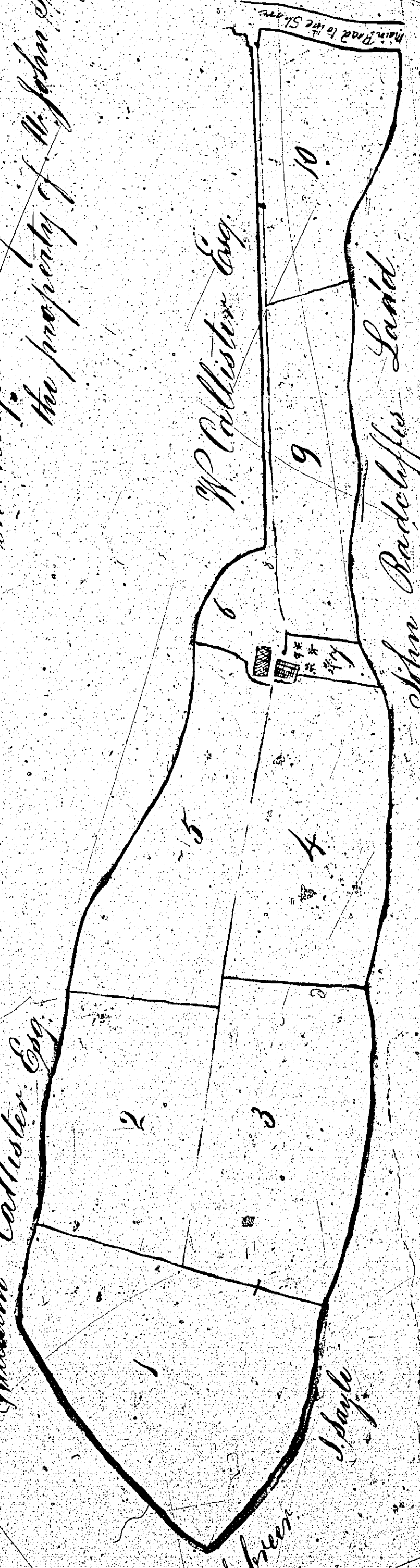

Contents	7	8	9	10
1	1	1	1	1
2	2	2	2	2
3	3	3	3	3
4	4	4	4	4
5	5	5	5	5
6	6	6	6	6
7	7	7	7	7
8	8	8	8	8
9	9	9	9	9
10	10	10	10	10
Total	70	70	70	70

John Doyle
Surveyor

Thomas Clator
Surveyor

ISLE OF MAN GOVERNMENT: GENERAL REGISTRY
ASYLUM PLANS: PARISH OF ANDREAS

Original monotone

1:23

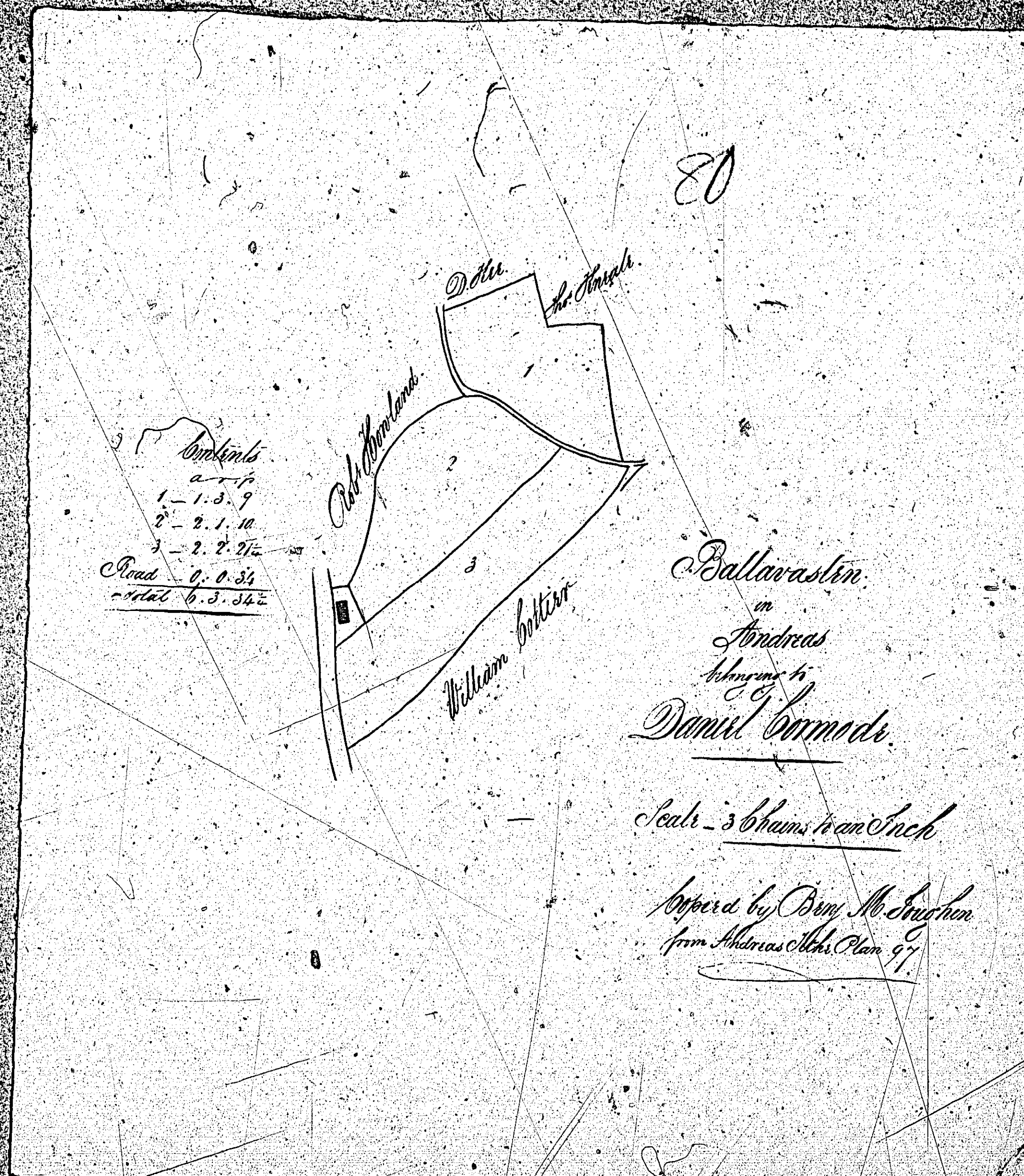

ISLE OF MAN GOVERNMENT: GENERAL REGISTRY

ASYLUM PLANS: PARISH OF ANDREAS

Original monotone

1:23

Headquarters

Andreas

belonging

to

William Ballister Esq.

Scale - 3 chains to an Inch

QV

Contents

1	4	1	17
2	4	3	28
3	9	3	25
4	8	3	24
5	4	0	16
6	6	2	37
7	8	0	7
8	8	2	16
9	8	3	30
10	7	1	4
11	4	1	16
13	10	3	16
14	7	2	10
15	5	2	11
16	7	1	11
17	4	1	4
18	6	2	13
19	8	3	24
20	2	1	0
21	1	3	28
22	2	2	38
23	2	3	12
24	2	2	34
High road	2	2	14
Chapel	3	3	31
London & Hamesstead	1	3	17
Drains	2	2	2
Total	150	2	51

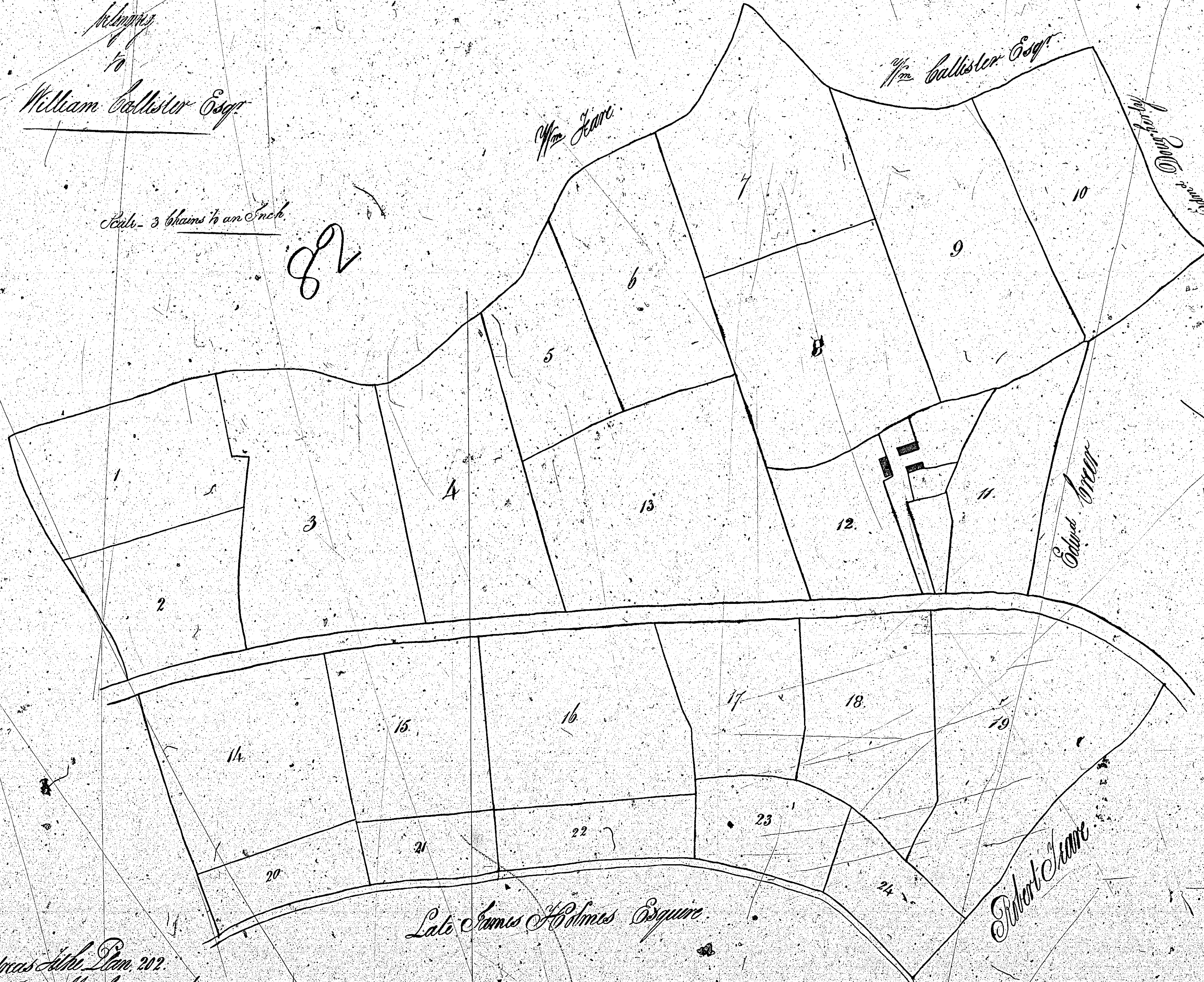

*Map of the Parish of Andreas taken from the original plan of 1802.
by Edw. Curran Esq. 1861.*

Inch