

There is no plan
numbered

69

ISLE OF MAN GOVERNMENT: GENERAL REGISTRY

ASYLUM PLANS: PARISH OF ANDREAS

1:23

- 70 Original coloured (decorative)
- 71 Original monotone

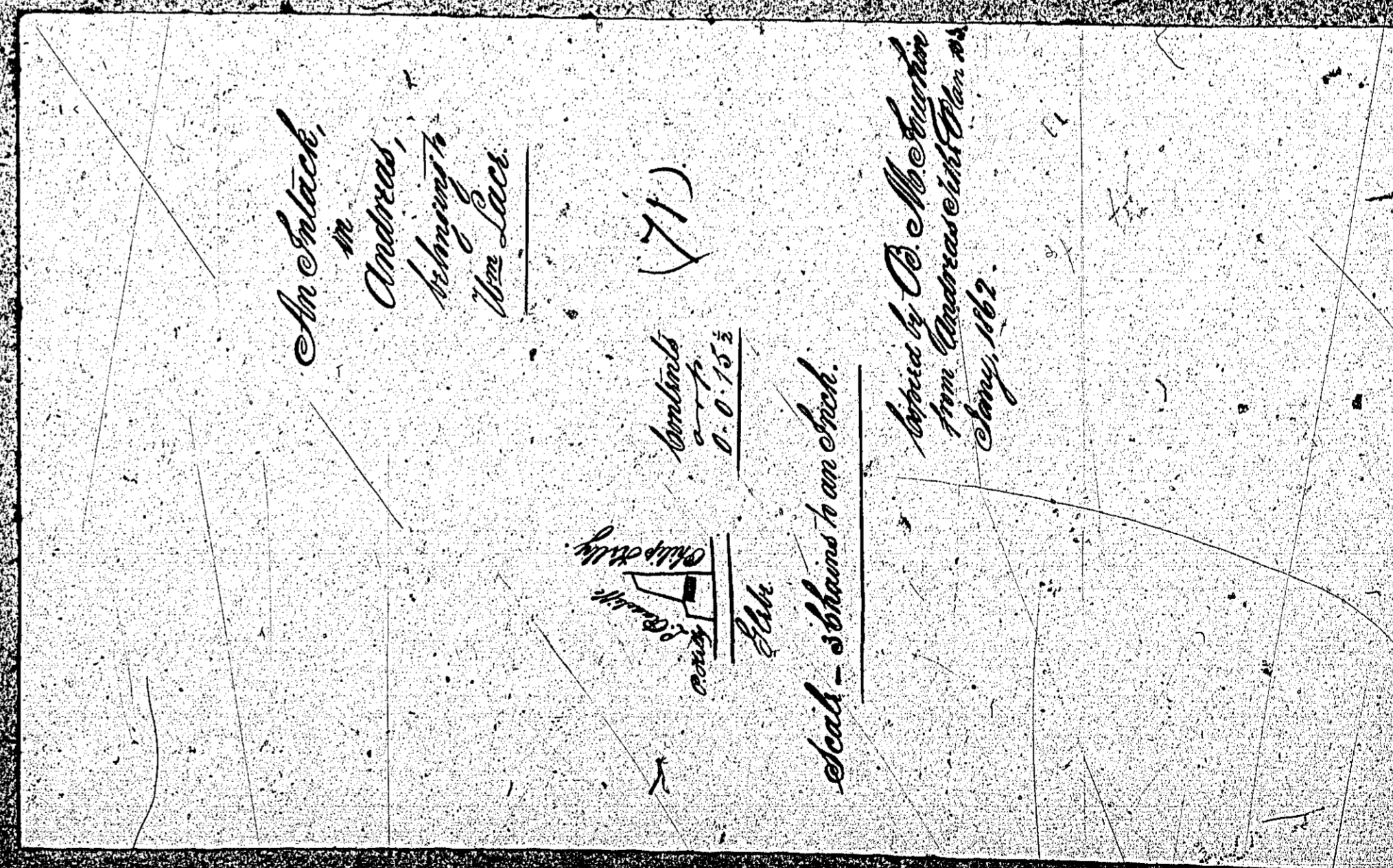
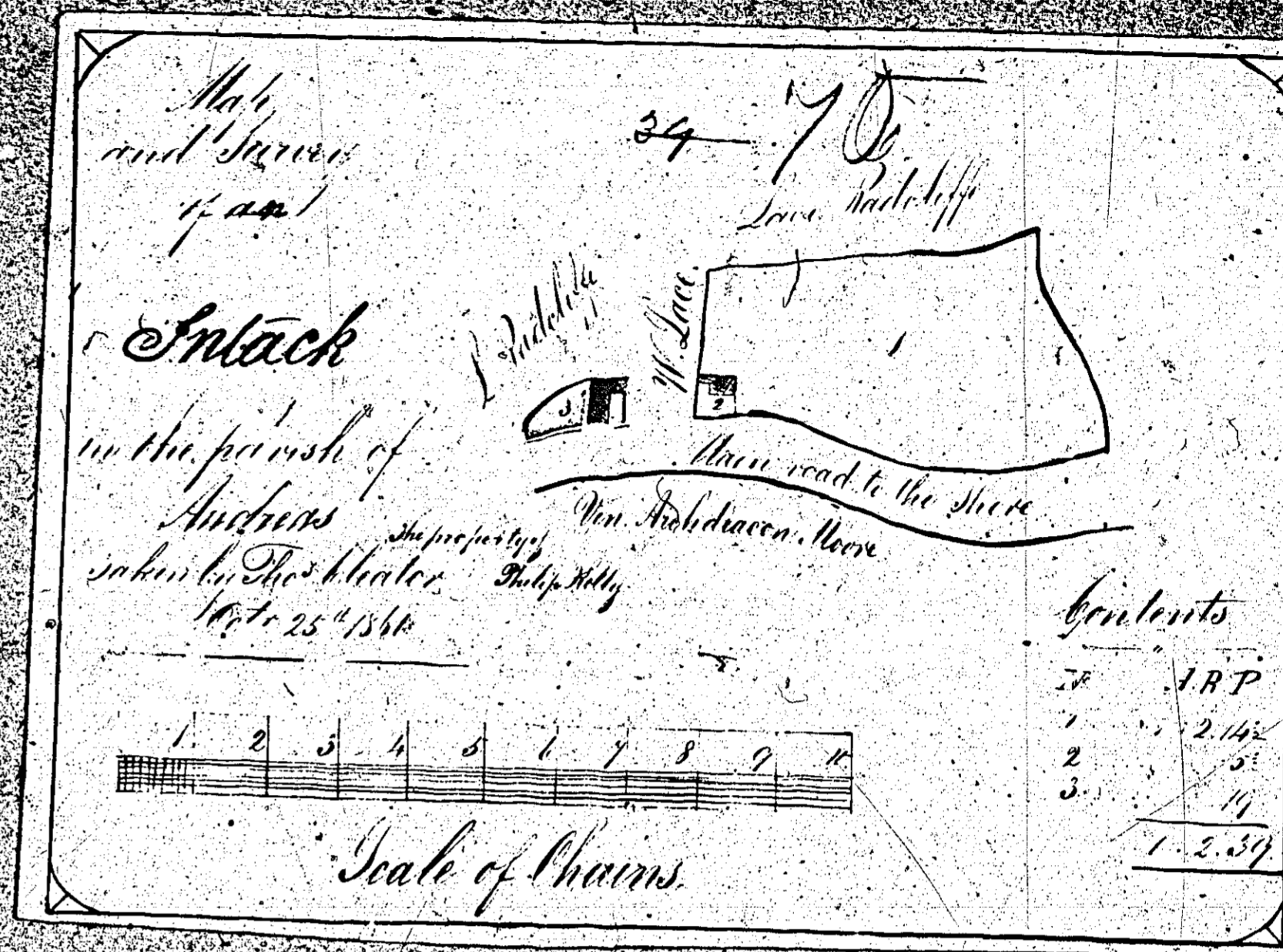

The following two
plans are both
numbered

72

ISLE OF MAN GOVERNMENT: GENERAL REGISTRY

ASYLUM PLANS: PARISH OF ANDREAS

Originals monotone

1:23

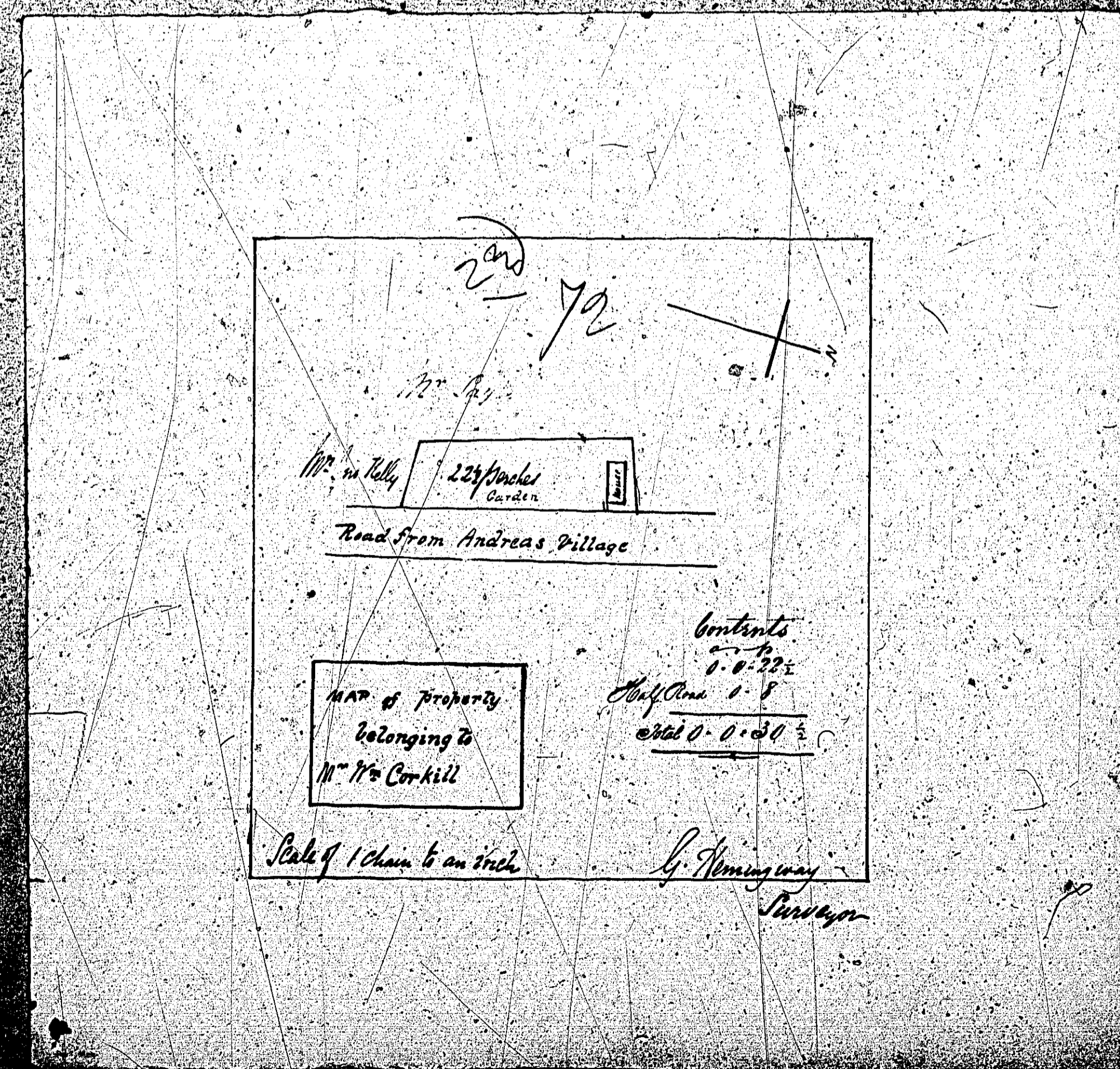
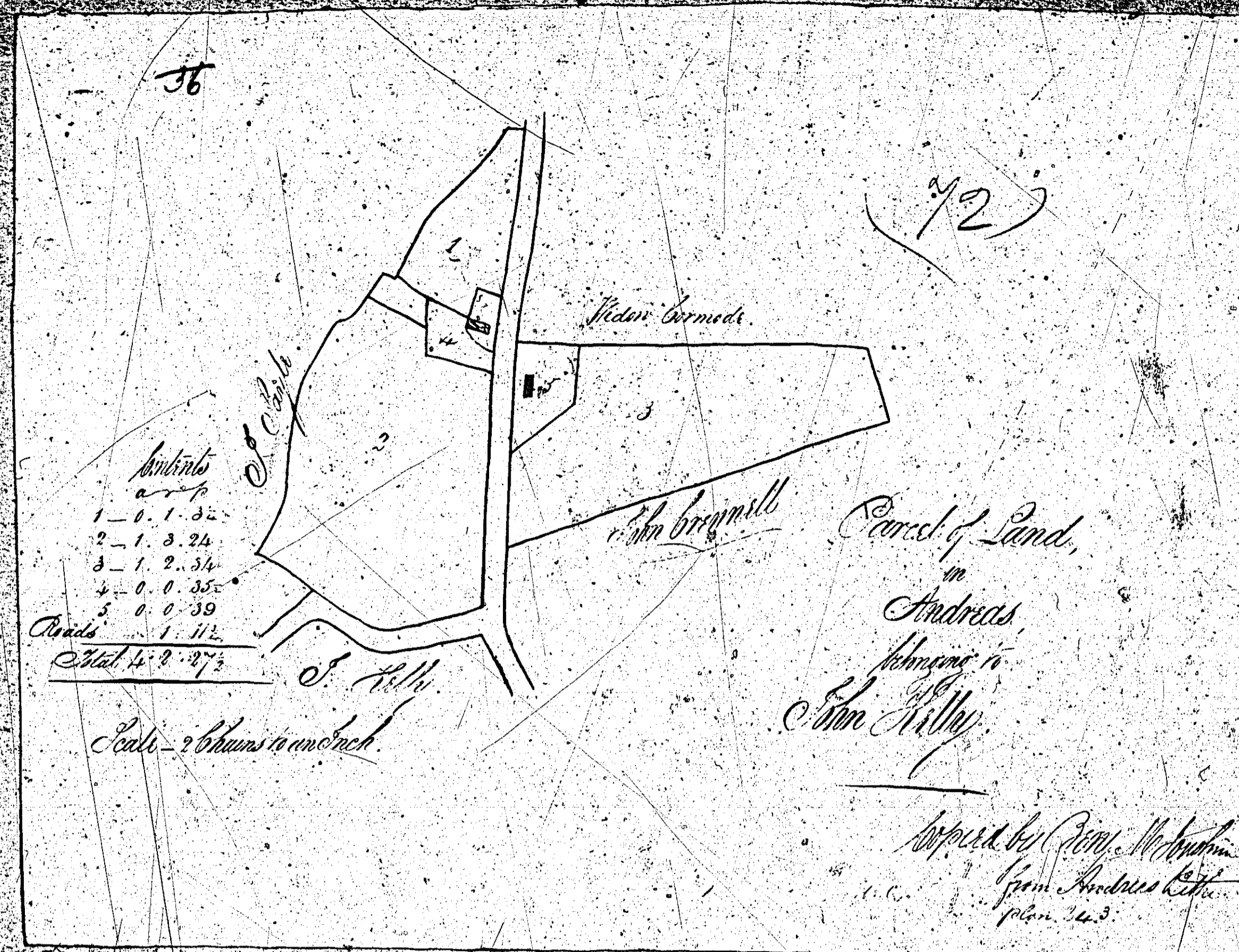

2^m 73

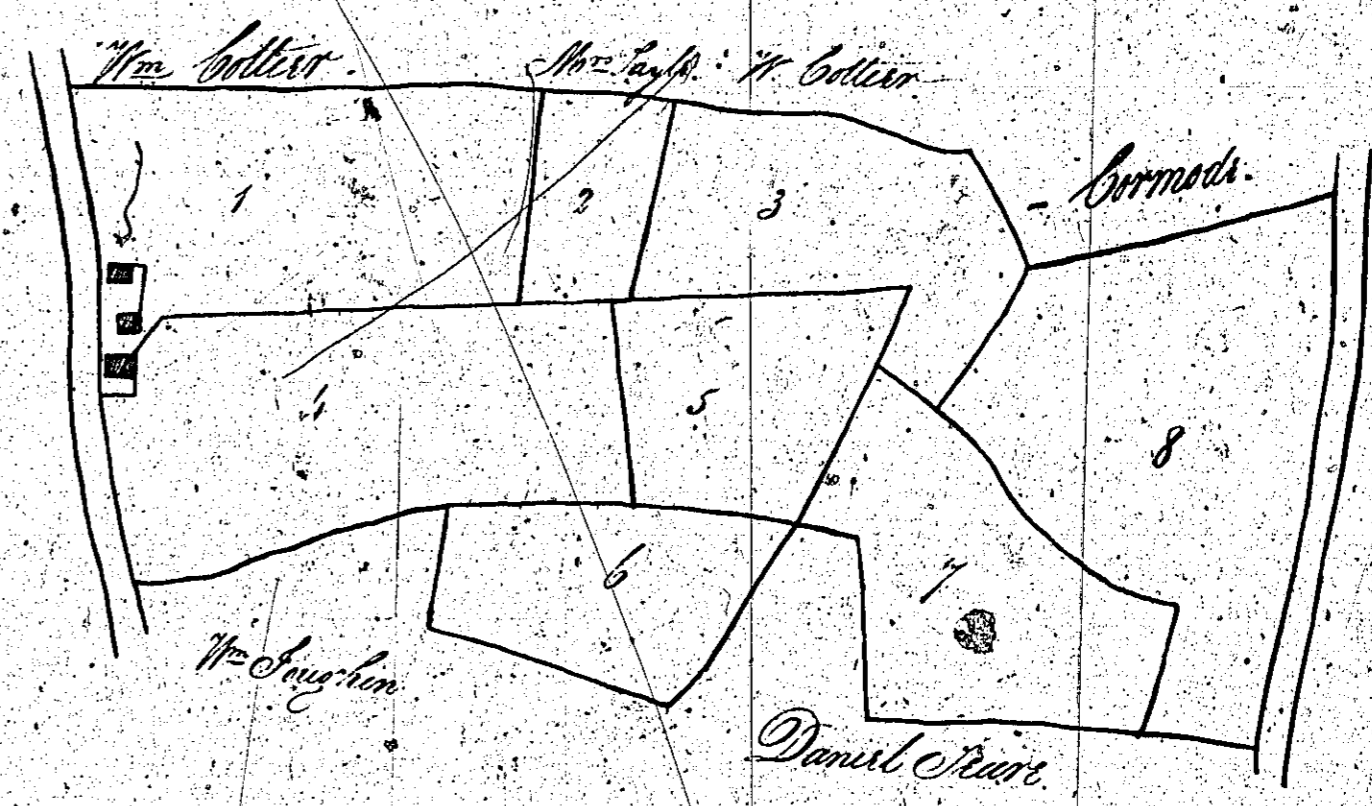
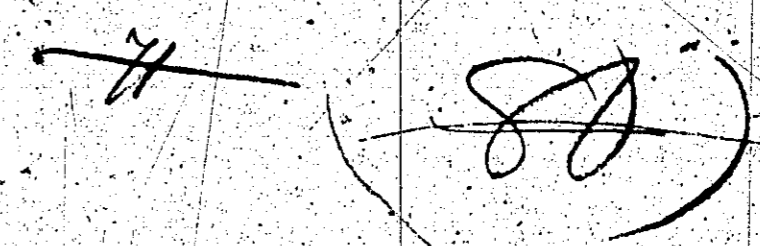

| Acreage | |
|---------|--------|
| 1 | 2.2.4 |
| 2 | 0.2.21 |
| 3 | 1.3.6 |
| 4 | 3.0.2 |
| 5 | 1.1.21 |
| 6 | 1.1.5 |
| 7 | 2.0.4 |
| 8 | 2.3.8 |

Ponds 0.0.30
 Total 15.2.21 1/2

Dullacra
 Plantation
 in
 Andrew
 King's
 Co. N. Carolina.

Scale - 3 chains to an inch

Surveyed from Andrew King's Plans
 1741, 97 by
 Peter M. Chapman

ISLE OF MAN GOVERNMENT: GENERAL REGISTRY

ASYLUM PLANS: PARISH OF ANDREAS

Original monotone

1:23

