

ISLE OF MAN GOVERNMENT: GENERAL REGISTRY

ASYLUM PLANS: PARISH OF ANDREAS

Original monotone

1:23

*Parish of Andreas  
belonging to  
John Gough*

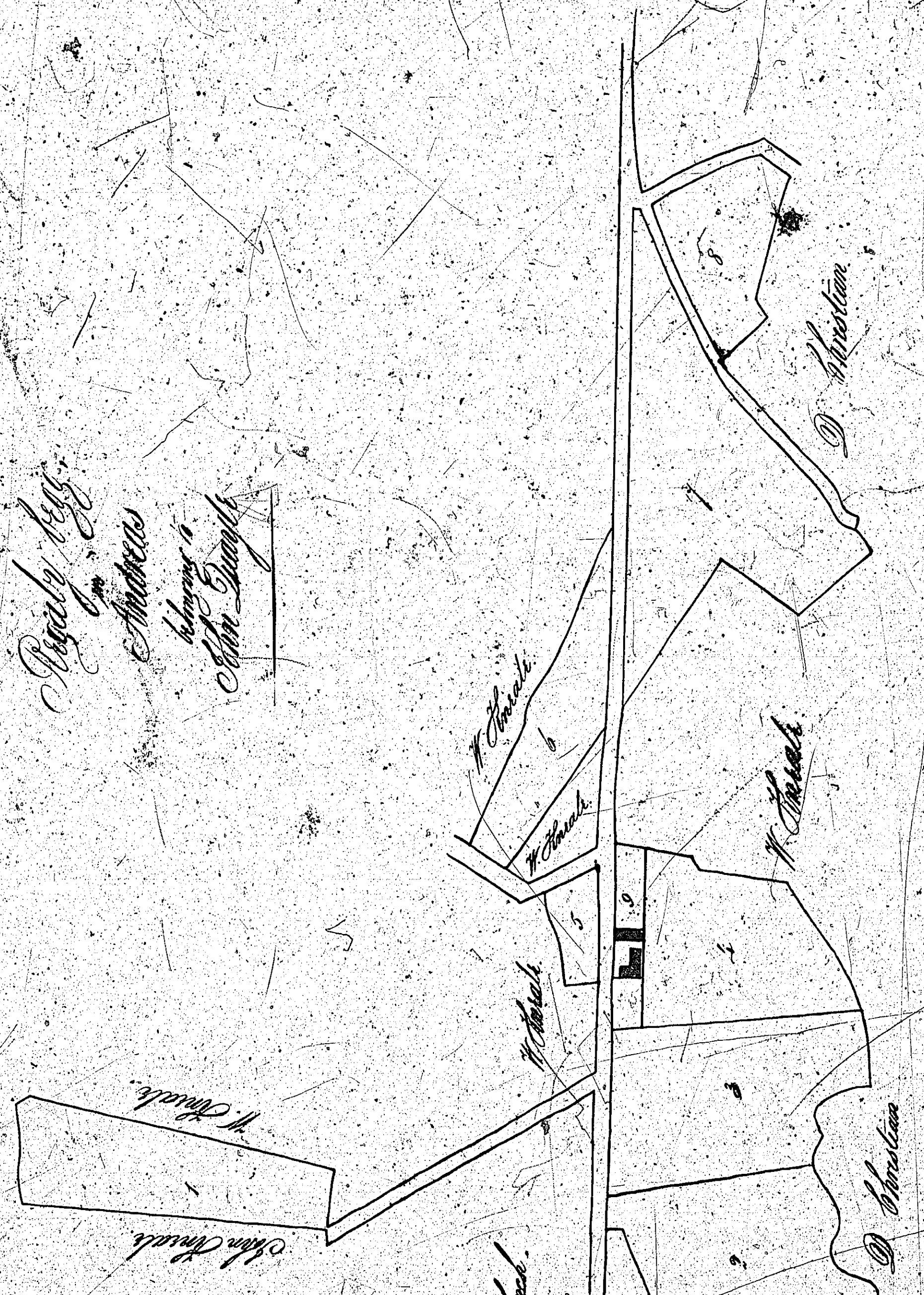

*Dimensions  
1 - 2.3.42  
2 - 3.1.45  
3 - 3.2.32  
4 - 2.3.47  
5 - 0.2.32  
6 - 1.2.27  
7 - 0.0.11  
8 - 1.2.102  
9 - 2.35  
Total 1.1.372  
Total 23.5.42*

*Scale 1/4 inch = 10 feet*

*Approved by R. L. Gough  
from 23.5.42*



ISLE OF MAN GOVERNMENT: GENERAL REGISTRY

ASYLUM PLANS: PARISH OF ANDREAS

Original monotone

1:23

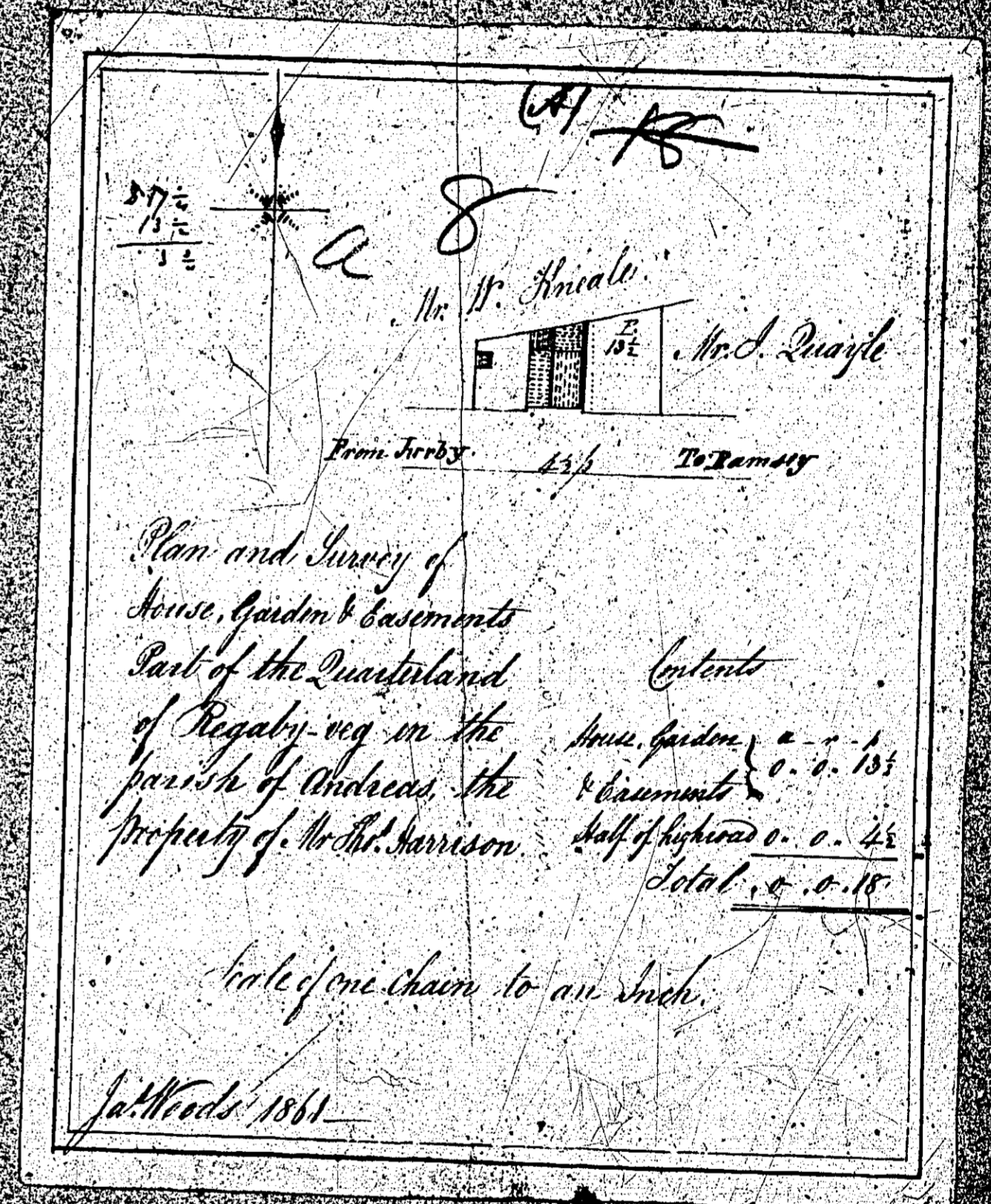



ISLE OF MAN GOVERNMENT: GENERAL REGISTRY  
 ASYLUM PLANS: PARISH OF ANDREAS

Original monotone

1:23

Contents	A	B	P
	8	2	27
	6	3	24
	5	2	27
	4	3	21
	4	2	15
	3	0	4
	4	3	30
	5	2	20
	0	1	34
Gardens	3	0	16
Roaches	1	1	24
Tota	53	0	28



*Map and Survey  
 of part of Ardo-min  
 in the Parish of Andreas  
 the Property of  
 Genl. A. Christian  
 from a Survey  
 by J. H. Meale in 1839  
 J. H. Meale 1861.*

*Three chains  
 to one inch*











ISLE OF MAN GOVERNMENT: GENERAL REGISTRY

ASYLUM PLANS: PARISH OF ANDREAS

Original coloured (decorative)

1:23

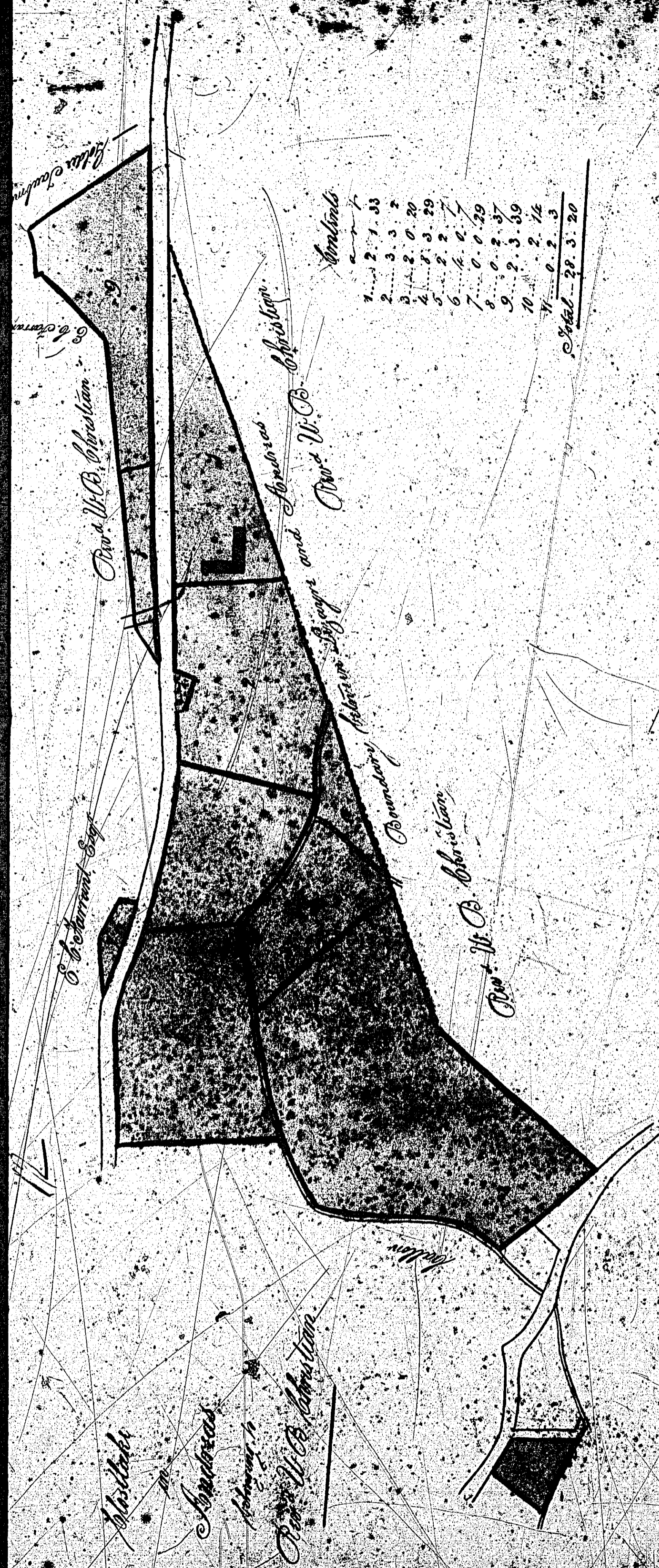

Scale - 3 Chains to an Inch