

TOWN AND COUNTRY PLANNING ACT 1991

THE REGISTERED BUILDINGS (GENERAL) REGULATIONS 1991

To:

Mr and Mrs Christopher, c/o 22 Colbost, Glen Dale, Isle of Skye,
IV55 8ZT

Mr and Mrs Christopher, c/o Judy Thornley, St Georges House, Bay
View Road, Port St Mary

Mr and Mrs Christopher, c/o Dean Wood, 37 Victoria Street, Douglas
Manx National Heritage, Kingswood Grove, Douglas

Advisory Council, Rose Cottage, Mount Rule, Braddan

Patrick Commissioners, Mullen Beg, Patrick

Mr and Mrs G Dixon, Upper Ballanea, Kirk Michael

NOTICE IS HEREBY GIVEN that at a meeting held on the 26th October 1995, the PLANNING COMMITTEE of the Department of Local Government and the Environment, in pursuance of its powers under the above Acts and Regulations REGISTERED **The Village House and Shop, Main Road, Higher Foxdale, Patrick**, as defined in red on the enclosed plan, in the PROTECTED BUILDINGS REGISTER by reason of architectural and historic interest.

THE EFFECT OF THIS REGISTRATION IS IMMEDIATE and prohibits the alteration or demolition of the structure or appearance of any part of the building except in compliance with an obligation imposed by or under any statutory provision or with the prior written consent of the Planning Committee.

Dated this 31st day of October, 1995

By Order of the Committee



R M Quine

Secretary, Planning Committee.

3rd Floor, Murray House,
Mount Havelock,
Douglas,
Isle of Man.

NOTE: Rights to request de-registration of the building are provided under the Regulations and in summary are that:

Application in writing for de-registration may be made by the owner or occupier of, and any other person having an interest in the buildings within a period of 28 days of service of this notice. Such application should be sent to the Secretary, Planning Committee, 3rd Floor, Murray House, Mount Havelock, Douglas.

In the event that de-registration is not requested by any party within the 28 day period described above, then de-registration may not be requested within a period of 3 years.

- cc
- 1) R B File
 - 2) Patrick Commissioners, Mullen Beg, Patrick
 - 3) Manx National Heritage, Kingswood Grove, Douglas
 - 4) ADCO, Rose Cottage, Mount Rule, Braddan
-
-

Scale 1:200

©Copyright Department of Local Government and the Environment, Isle of Man. Unauthorised reproduction infringes copyright.

Dingle No

135 : 9m

Bridge House

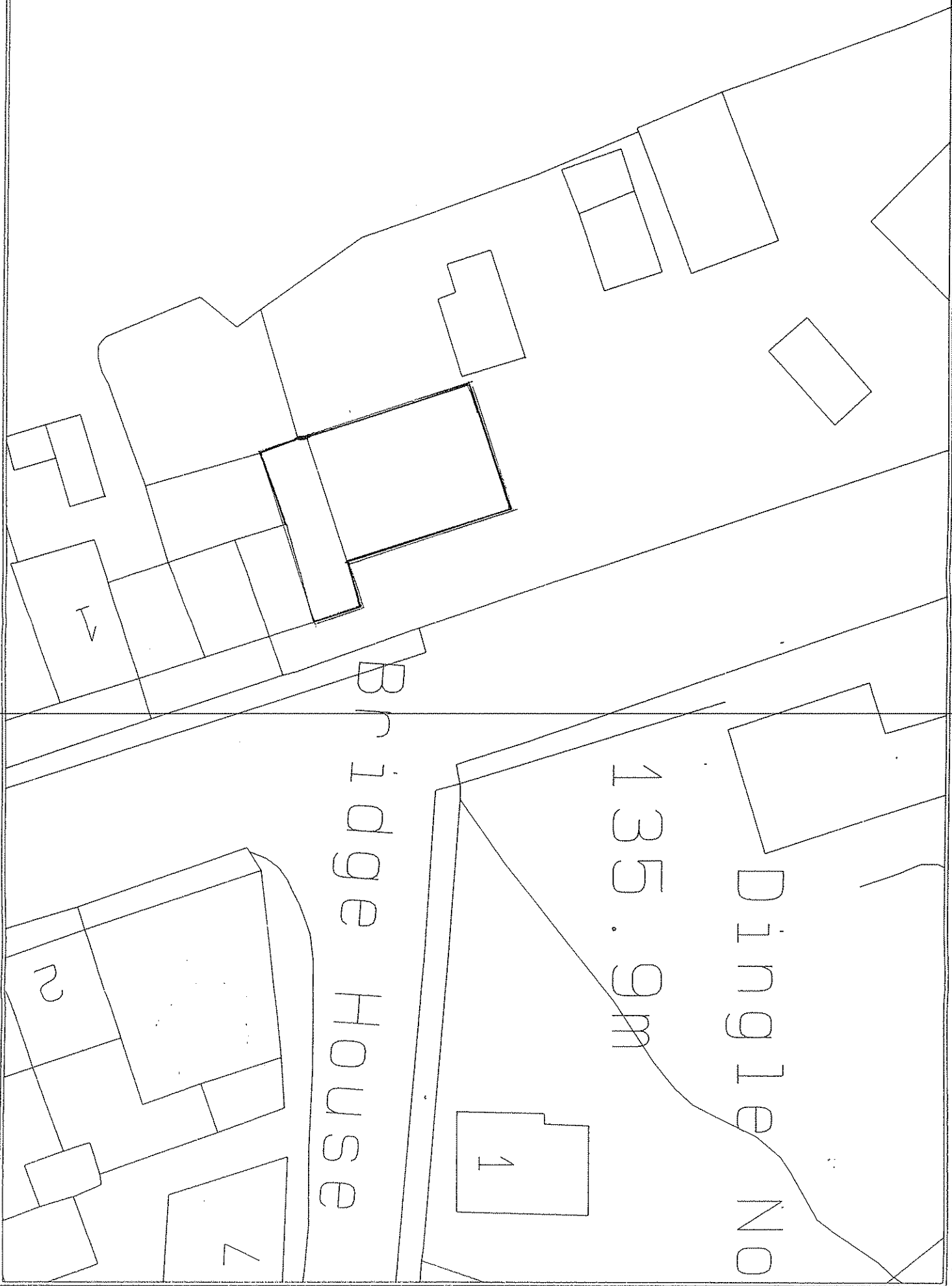





FOR SALE 
DearnWood
01206 204616

... A3
A3
... A3
Peel (A1) 