

Form RBI

Registered Building No. 110
Ref: CCM/MC

TOWN AND COUNTRY PLANNING ACT 1981

THE REGISTERED BUILDINGS (GENERAL) REGULATIONS 1982

TO: For the attention of Mr. R.P. Neiland,
Trustees of the Headfort Settlement,
Bank of Ireland (Jersey) Ltd.,
P.O. Box 416,
Union Street,
St. Helier,
Jersey,
Channel Islands.

NOTICE IS HEREBY GIVEN that at a meeting held on the 15th March, 1989, the PLANNING COMMITTEE of the Department of Local Government and the Environment, in pursuance of its powers under the above Acts and Regulations REGISTERED the South, East and West elements of the Courtyard at Ellerslie Farm, in the Parish of Marown, as defined with a red line on the enclosed plan, in the PROTECTED BUILDINGS REGISTER by reason of its architectural and historic interest.

THE EFFECT OF THIS REGISTRATION IS IMMEDIATE and prohibits the alteration or demolition of the structure or appearance of any part of the building except in compliance with an obligation imposed by or under any statutory provision or with the prior written consent of the Planning Committee.

Public notice of the Registration will be published on the 23rd day of March, 1989.

Dated this 16th day of March, 1989.

By Order of the Committee



C. C. Magee

Secretary, Planning Committee

Central Government Offices,
Douglas,
Isle of Man.

NOTE: Rights of Review and Appeal against this registration are provided under the Regulations and summarised on the enclosed leaflet.

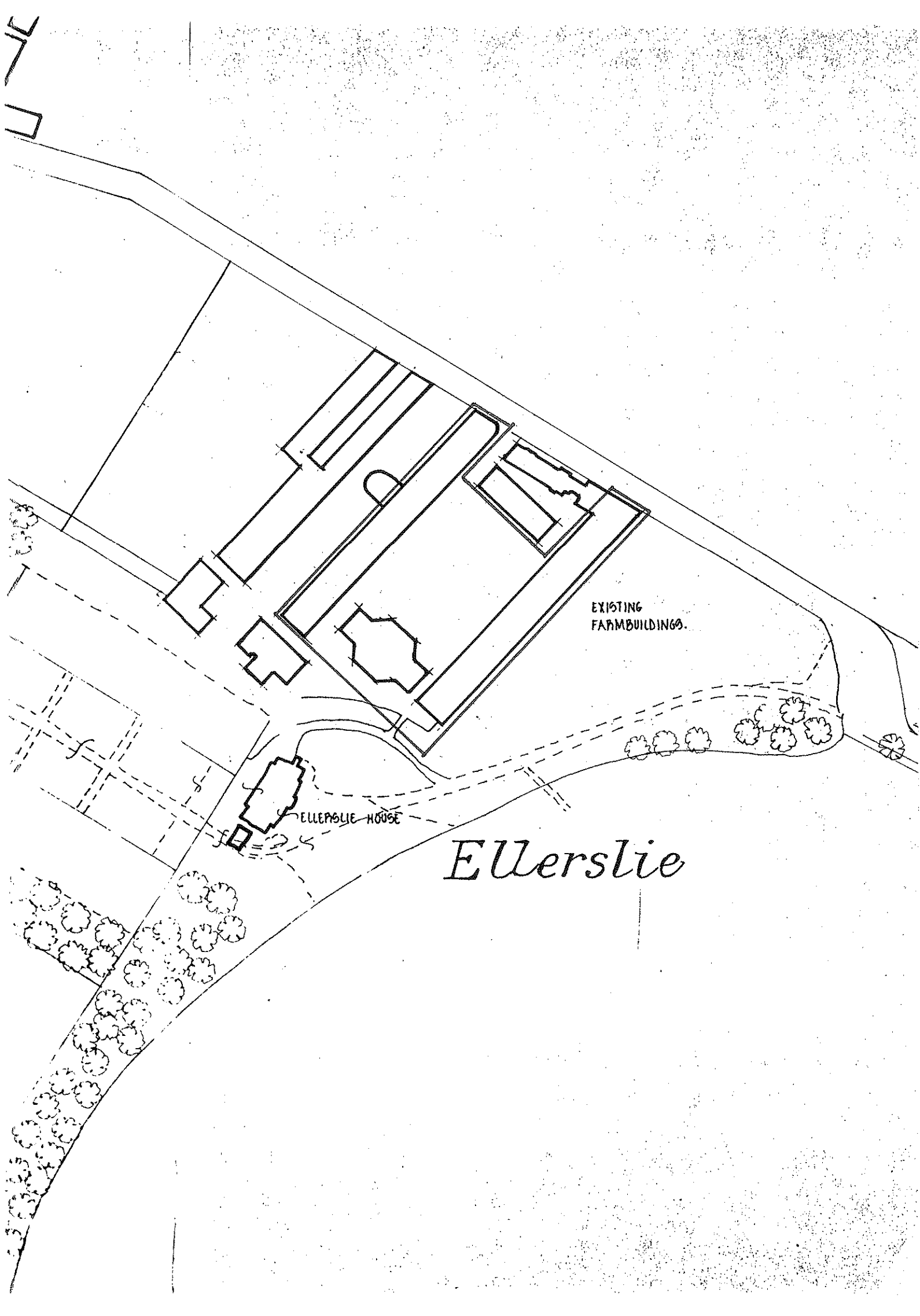
A copy of Schedule 2 of the Town and Country Planning Act 1981 is appended hereto.



EXISTING
FARMBUILDINGS.

ELLERSLIE HOUSE

Ellerslie