

There are no plans
numbered 148 149 or 150

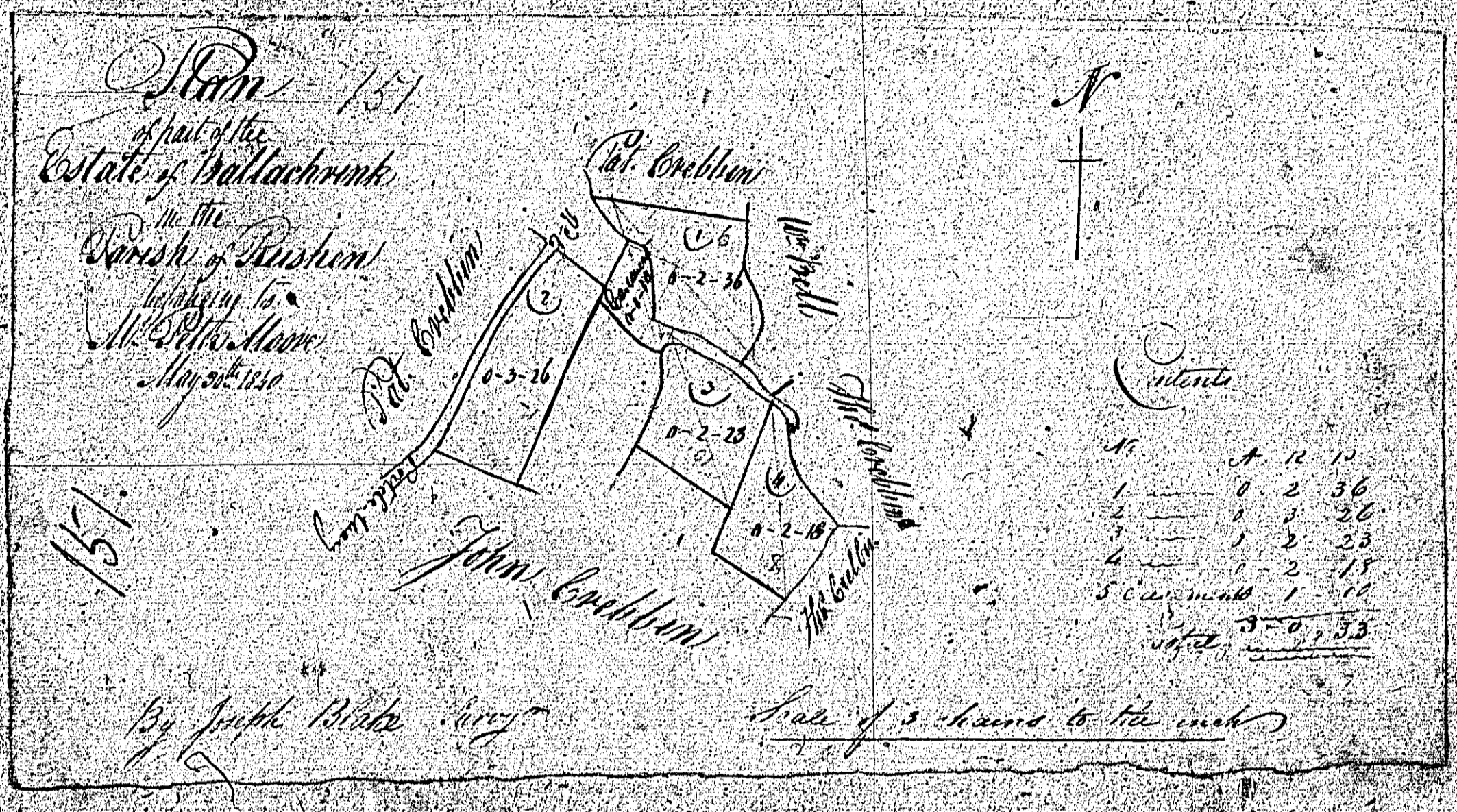

ISLE OF MAN GOVERNMENT: GENERAL REGISTRY

TITHE PLANS: PARISH OF RUSHEN

Original monotone

1:30

152.
Part of
Sturby Moor Quarterland
situate in Radnor
the Property of M^r Tho^s Moore
152.
Scale of 3 chains to the inch

not used

Plan 153
of part of the
Estate of Bullafin
in the
Parish of Rushew
belonging to
Mr. W. Moore
June 6th 1810

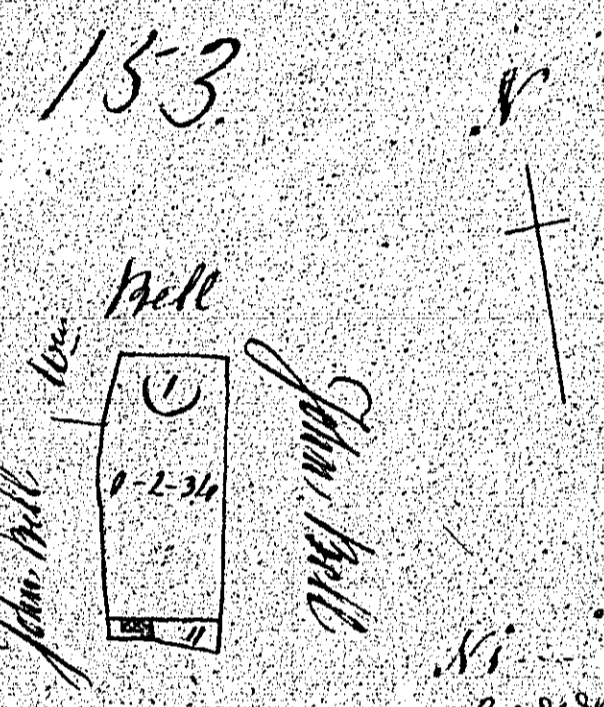

A. N. O.
N. 1. 0-2-34
gare. 11
1100- 0-3-4

Three Chams to a Tuck
Joseph Blake Surveyor

Notes
134
1

BALLAGLONEY

in Rushet.

The Property of Thomas Moore.

May 1840.



Total Contents $\frac{63}{2} \frac{20}{100}$
Proportion of Lismore 52 1 3
Do. Occupied Roads 0 1 6

Wm. Jeffery & Co. Surveyors

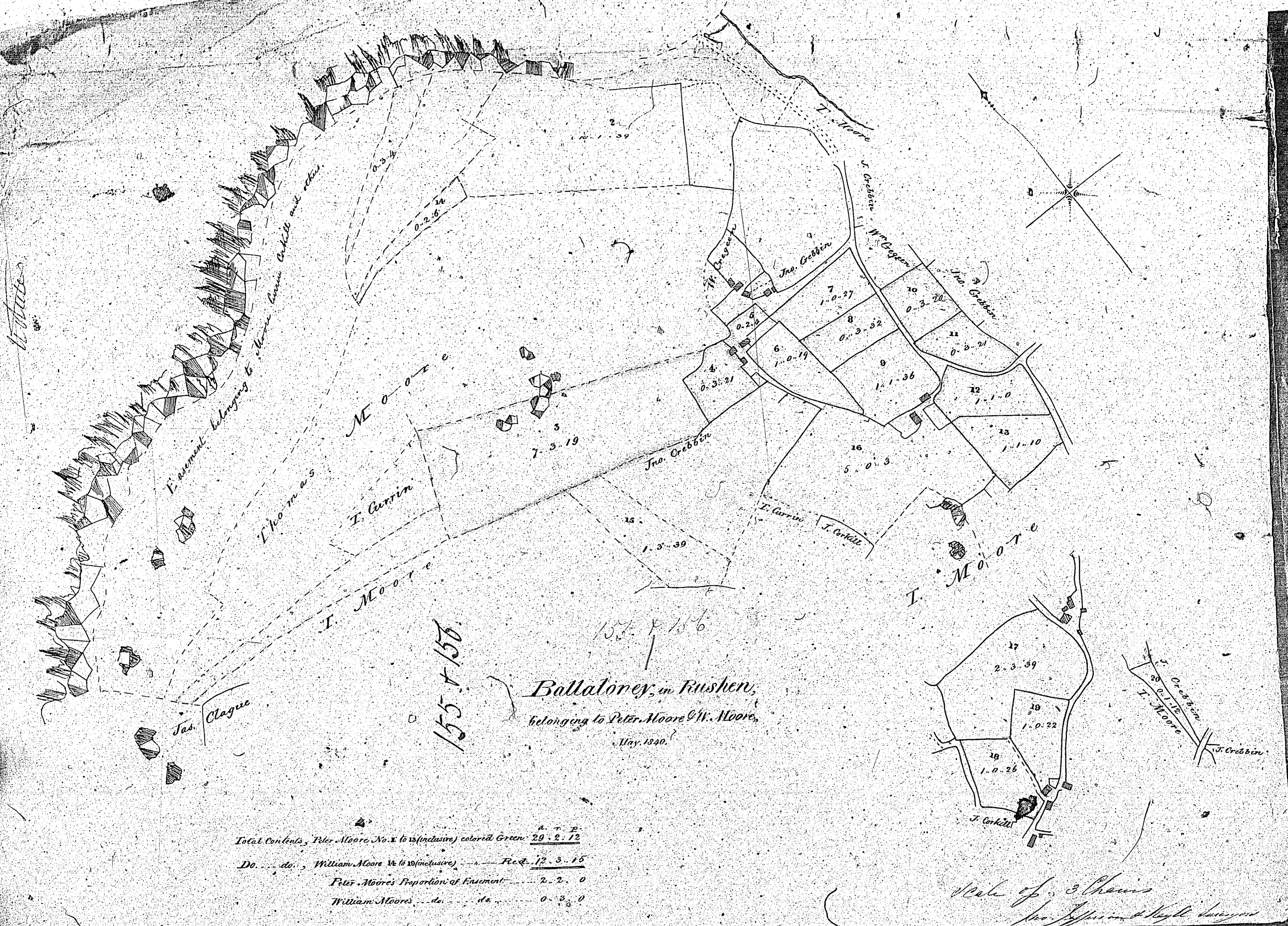

ISLE OF MAN GOVERNMENT: GENERAL REGISTRY

TITHE PLANS: PARISH OF RUSHEN

Original coloured (decorative)

1:30