

50

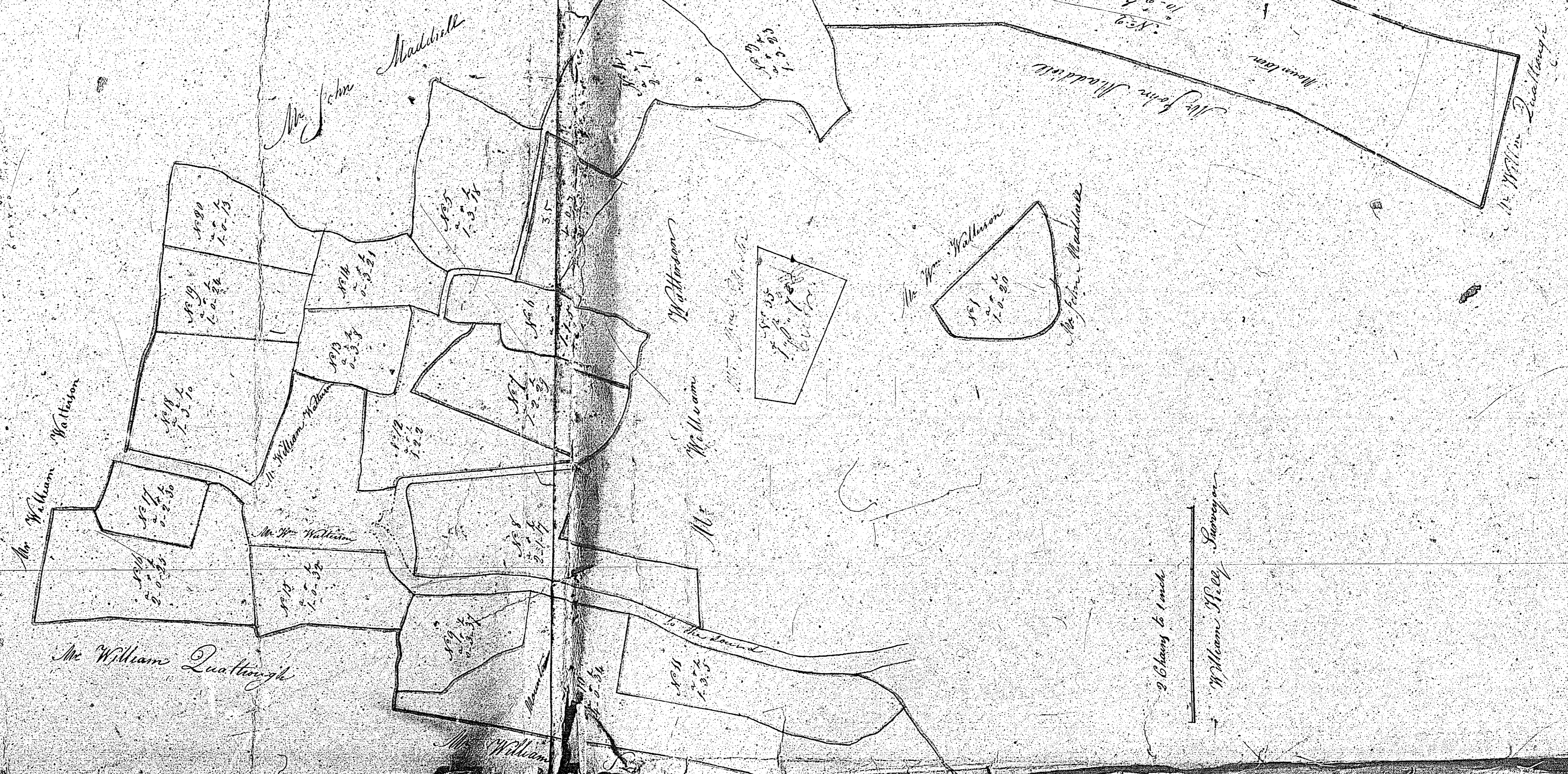

ISLE OF MAN GOVERNMENT: GENERAL REGISTRY
 TITHE PLANS: PARISH OF RUSHEN
 Original coloured
 1:30

A15 A14 A13 A12 A11

Witnessed

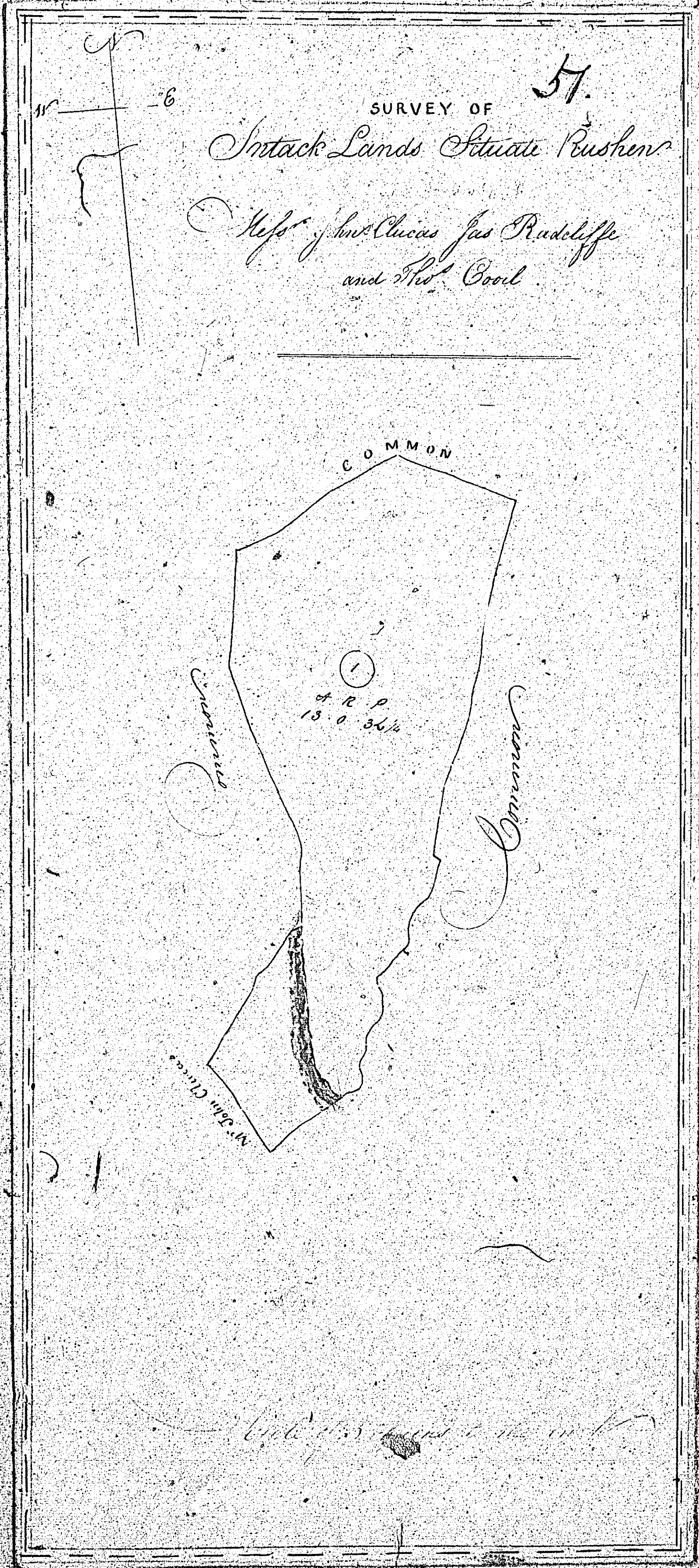

Perches

1	1/2
2	2 1/2
3	2 1/2
4	3 1/2
5	3 1/2
6	4 1/2
7	4 1/2
8	5 1/2
9	5 1/2
10	6 1/2
11	6 1/2
12	7 1/2
13	7 1/2
14	8 1/2
15	8 1/2
16	9 1/2
17	9 1/2
18	10 1/2
19	10 1/2
20	11 1/2
21	11 1/2
22	12 1/2
23	12 1/2
24	13 1/2
25	13 1/2
26	14 1/2
27	14 1/2
28	15 1/2
29	15 1/2
30	16 1/2
31	16 1/2
32	17 1/2
33	17 1/2
34	18 1/2
35	18 1/2
36	19 1/2
37	19 1/2
38	20 1/2
39	20 1/2
40	21 1/2
41	21 1/2
42	22 1/2
43	22 1/2
44	23 1/2
45	23 1/2
46	24 1/2
47	24 1/2
48	25 1/2
49	25 1/2
50	26 1/2
51	26 1/2
52	27 1/2
53	27 1/2
54	28 1/2
55	28 1/2
56	29 1/2
57	29 1/2

1	2	3	4	5	6	7	8	9	10	11	12	13	14	15	16	17	18	19	20	21	22	23	24	25	26	27	28	29	30	31	32	33	34	35	36	37	38	39	40	41	42	43	44	45	46	47	48	49	50	51	52	53	54	55	56	57	58	59	60	61	62	63	64	65	66	67	68	69	70	71	72	73	74	75	76	77	78	79	80	81	82	83	84	85	86	87	88	89	90	91	92	93	94	95	96	97	98	99	100
---	---	---	---	---	---	---	---	---	----	----	----	----	----	----	----	----	----	----	----	----	----	----	----	----	----	----	----	----	----	----	----	----	----	----	----	----	----	----	----	----	----	----	----	----	----	----	----	----	----	----	----	----	----	----	----	----	----	----	----	----	----	----	----	----	----	----	----	----	----	----	----	----	----	----	----	----	----	----	----	----	----	----	----	----	----	----	----	----	----	----	----	----	----	----	----	----	----	----	-----

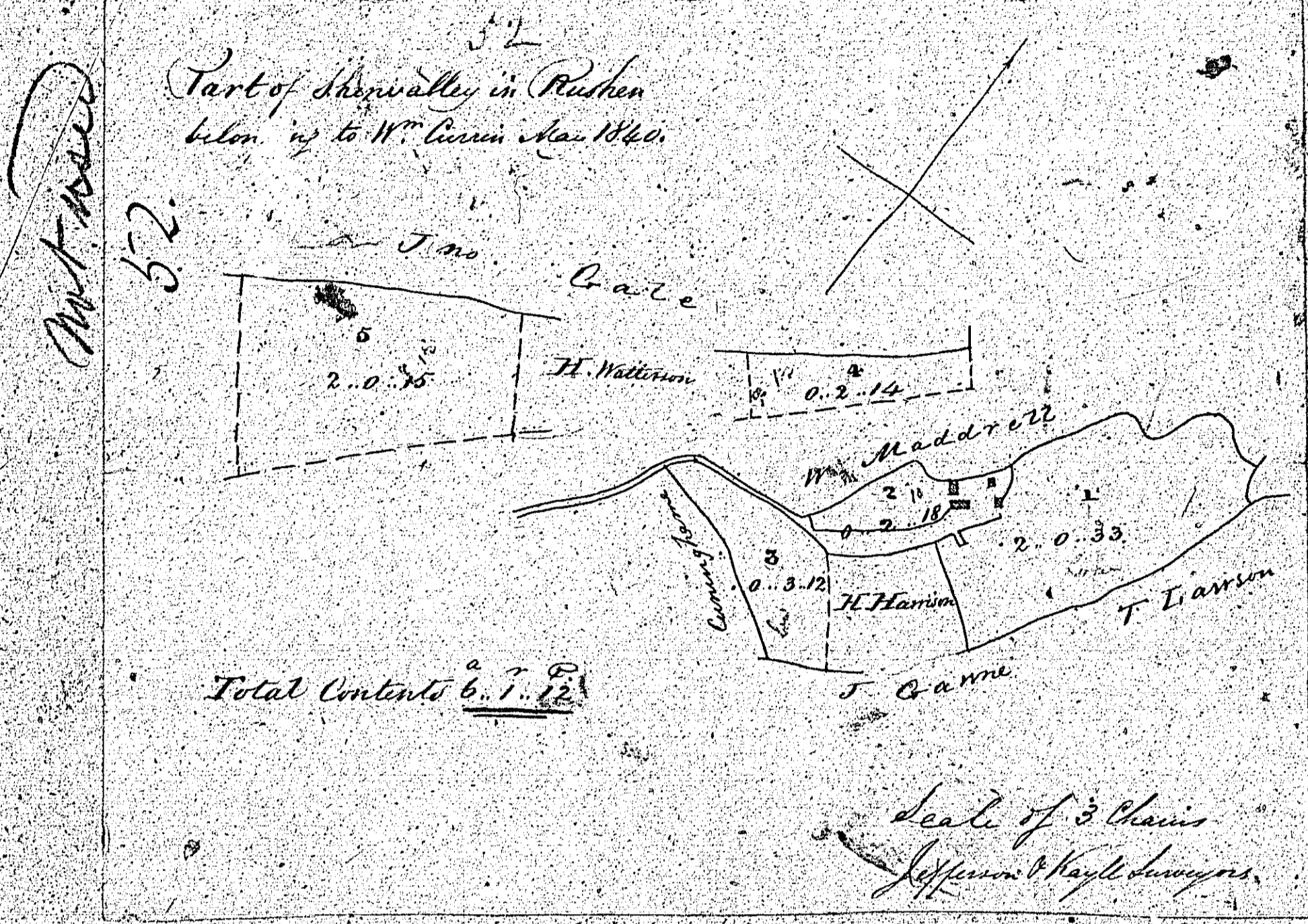

ISLE OF MAN GOVERNMENT: GENERAL REGISTRY
 TITHE PLANS: PARISH OF RUSHEN
 Original monotone 1:30

Notice
Property in Rushen
belonging to Wm J^r Cunningham Esq.

May 1840.

53.

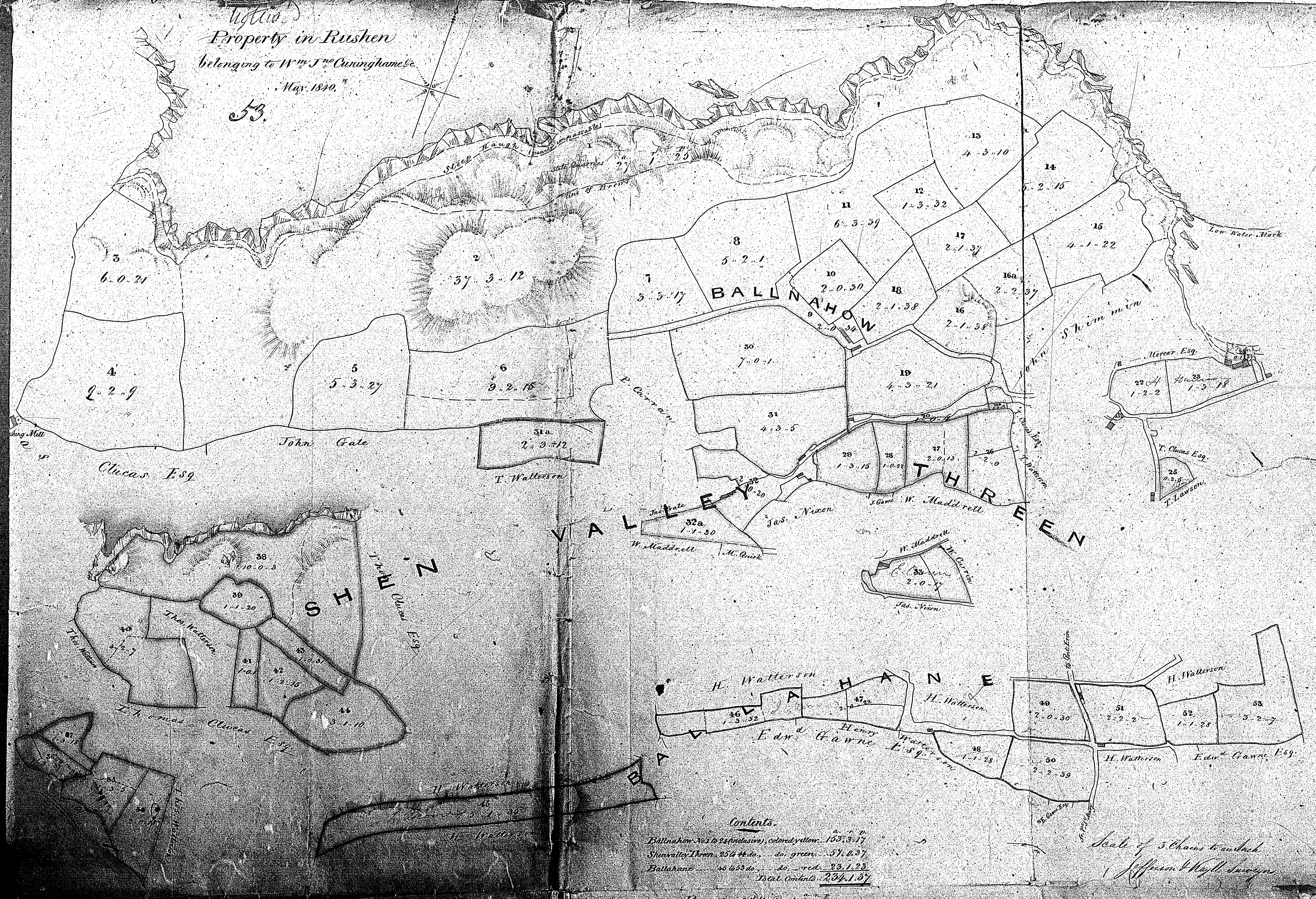

Contents.

Ballnahow 202 to 246 (inclusive), colored yellow.	153, 3-17
Shenvally Threen 254 to do.	57, 0-37
Ballhane 45 to 53 do.	23, 1-23
Total Contents.	234, 1-57

Proportion of White Roads 0, 1-31

Scale of 5 Chains to an Inch
Jefferson & Kayll Surveyors



Volume 34.

Plan and Survey
of Part of the Quarterland
of Frigineasky
in the Parish of St. Christ Rushen
the Property of
Mr. W. Harran

Contents

1	0	0
2	0	0
3	0	0
4	0	0
5	0	0
6	0	0
7	0	0
8	0	0
9	0	0
10	0	0
11	0	0
12	0	0
13	0	0
14	0	0
15	0	0
16	0	0
17	0	0
18	0	0
19	0	0
20	0	0
21	0	0
22	0	0
23	0	0
24	0	0
25	0	0
26	0	0
27	0	0
28	0	0
29	0	0
30	0	0
31	0	0
32	0	0
33	0	0
34	0	0
35	0	0
36	0	0
37	0	0
38	0	0
39	0	0
40	0	0
41	0	0
42	0	0
43	0	0
44	0	0
45	0	0
46	0	0
47	0	0
48	0	0
49	0	0
50	0	0
51	0	0
52	0	0
53	0	0
54	0	0
55	0	0
56	0	0
57	0	0
58	0	0
59	0	0
60	0	0
61	0	0
62	0	0
63	0	0
64	0	0
65	0	0
66	0	0
67	0	0
68	0	0
69	0	0
70	0	0
71	0	0
72	0	0
73	0	0
74	0	0
75	0	0
76	0	0
77	0	0
78	0	0
79	0	0
80	0	0
81	0	0
82	0	0
83	0	0
84	0	0
85	0	0
86	0	0
87	0	0
88	0	0
89	0	0
90	0	0
91	0	0
92	0	0
93	0	0
94	0	0
95	0	0
96	0	0
97	0	0
98	0	0
99	0	0
100	0	0



Contents

1	0	0
2	0	0
3	0	0
4	0	0
5	0	0
6	0	0
7	0	0
8	0	0
9	0	0
10	0	0
11	0	0
12	0	0
13	0	0
14	0	0
15	0	0
16	0	0
17	0	0
18	0	0
19	0	0
20	0	0
21	0	0
22	0	0

55. *Wotton* Plan
 of part of the Quarterlands
 of *Glenshass and Westard*
 in the Parish of *St. Christ Bushell*
 the Property of
Mr. Edw. Curran

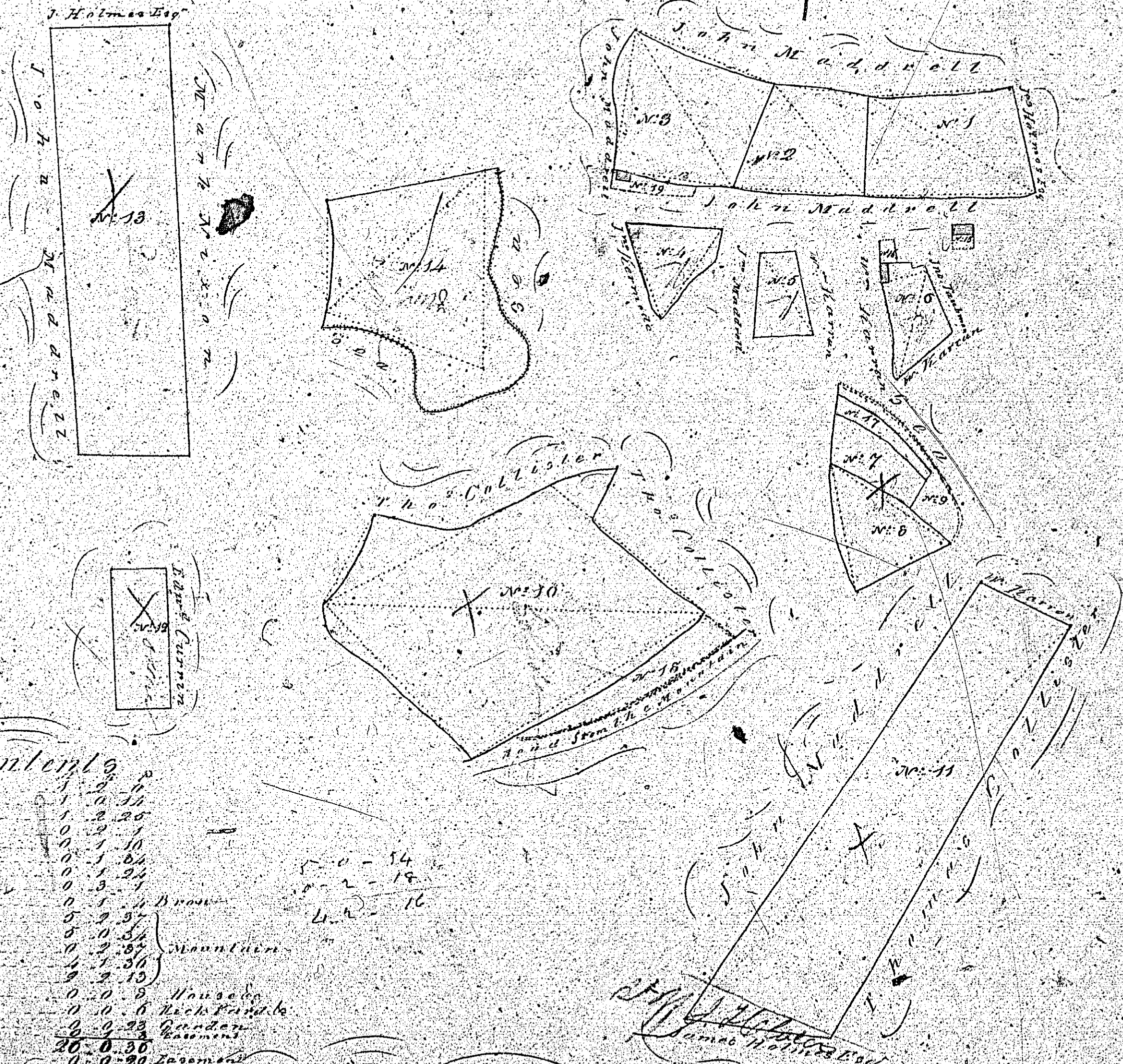

Contents

1	0. 10
2	0. 10
3	0. 10
4	0. 10
5	0. 10
6	0. 10
7	0. 10
8	0. 10
9	0. 10
10	0. 10
11	0. 10
12	0. 10
13	0. 10
14	0. 10
15	0. 10
16	0. 10
17	0. 10
18	0. 10
19	0. 10
20	0. 10
21	0. 10
22	0. 10
23	0. 10
24	0. 10
25	0. 10

Contents

No	A	T	Ac
1	1	2	27
2	1	2	27
3	1	2	27
4	1	2	27
5	1	2	27
6	1	2	27
7	1	2	27
8	1	2	27
9	1	2	27
10	1	2	27
11	1	2	27
12	1	2	27
13	1	2	27
14	1	2	27
15	1	2	27
16	1	2	27
17	1	2	27
18	1	2	27
19	1	2	27
20	1	2	27
21	1	2	27
22	1	2	27
23	1	2	27
24	1	2	27
25	1	2	27

Scale 5 Chains in an Inch

Thomas Cook Surveyor
 1840