

Isle of Man Government: General Registry

PLANS DEPOSITED IN THE
ROLLS OFFICE
UNDER THE
TITHE COMMUTATION ACT
1839

PARISH OF RUSHEN

Volume 1

(1 - 90)

Microfilm Data (IOM) Ltd., Alpine Mews,
Strathallan Lane, Onchan, Isle of Man, IM3 1NL

May 1997

NOTES

The plans have been filmed in their bound state

This will have caused some image distortion particularly where large plans go into the binding gutter and/or have been folded

Many of the larger plans are damaged

Where plans are coloured this has been noted; 'monochrome' indicates a single ink colour which may be black, brown or blue

START OF VOLUME

PLAN
 of the
 TIERGARTH
 of the Church of
 RUSHEN ABBEY
 of the Property of
 Sir James Bredon
 Surveyed 18th Dec 1791

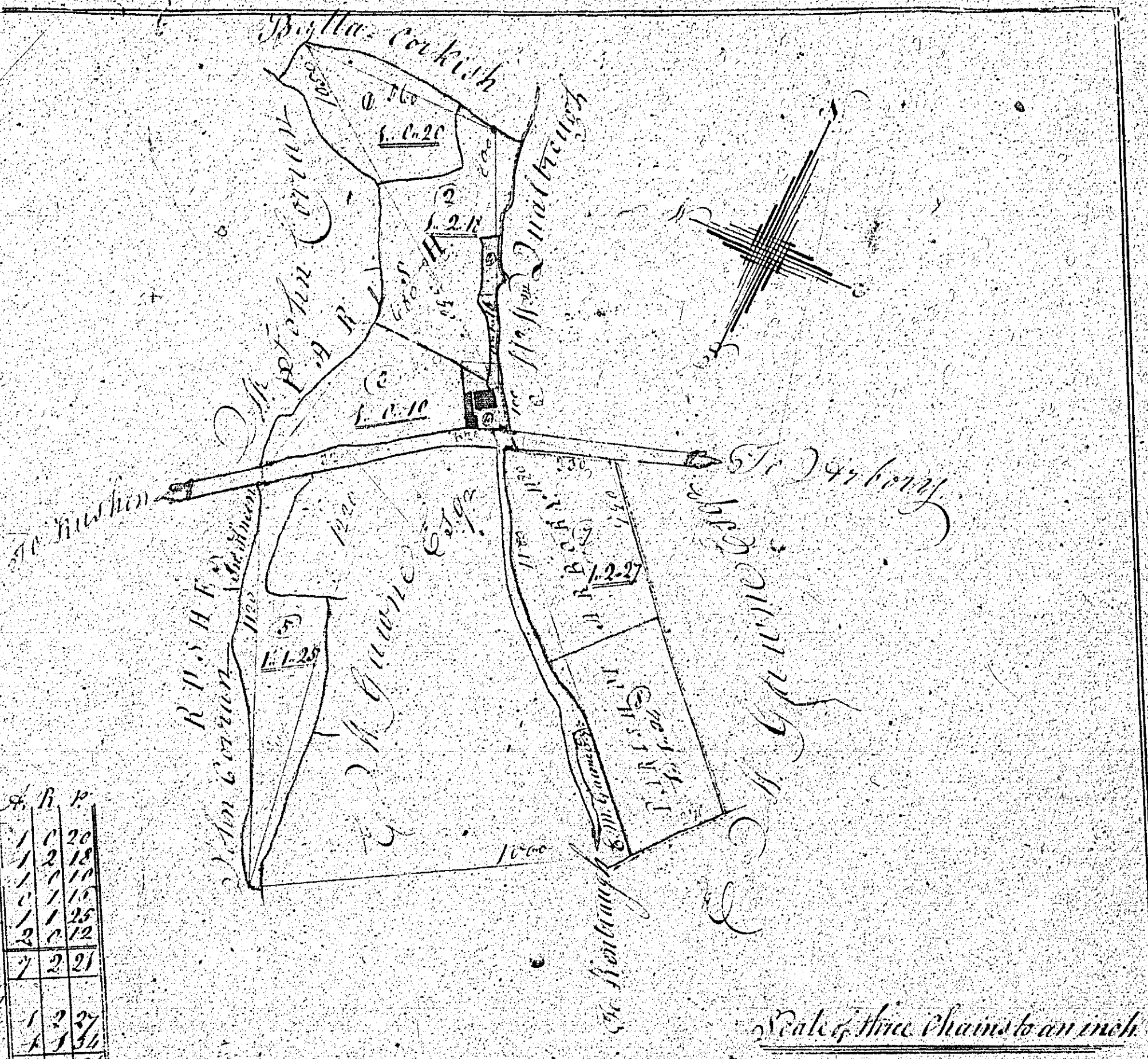

Contents

Rushen Parish	S.	R.	P.
Upper field	1	2	20
Middle field	1	2	18
High Road field	1	1	15
Lower field	1	1	25
Northen field	2	2	12
St. Mary's Church	7	2	27
St. John's Church	1	2	27
Upper field	1	1	16
Lower field	1	1	21
St. Mary's Church	3	1	21
Total	10	3	2

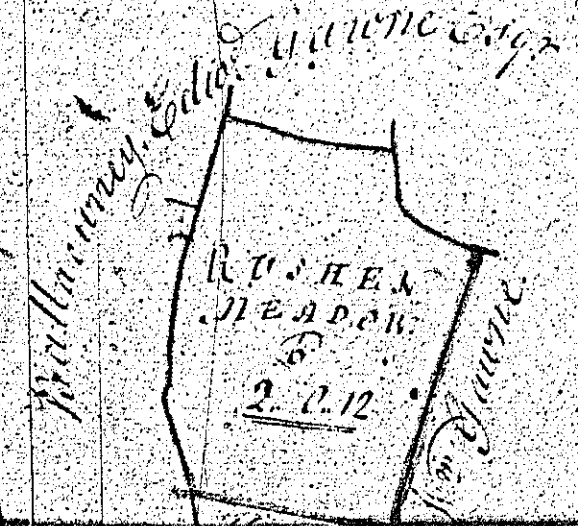

Scale of three Chains to an inch

ISLE OF MAN GOVERNMENT: GENERAL REGISTRY

TITHE PLANS: PARISH OF RUSHEN

Original coloured

1:30

Plot used

Plan 2

*A part of the estate of Dallahalay
in the
Parish of St. Andrew
the property of
Mr. John Hill
June 1st 1840*

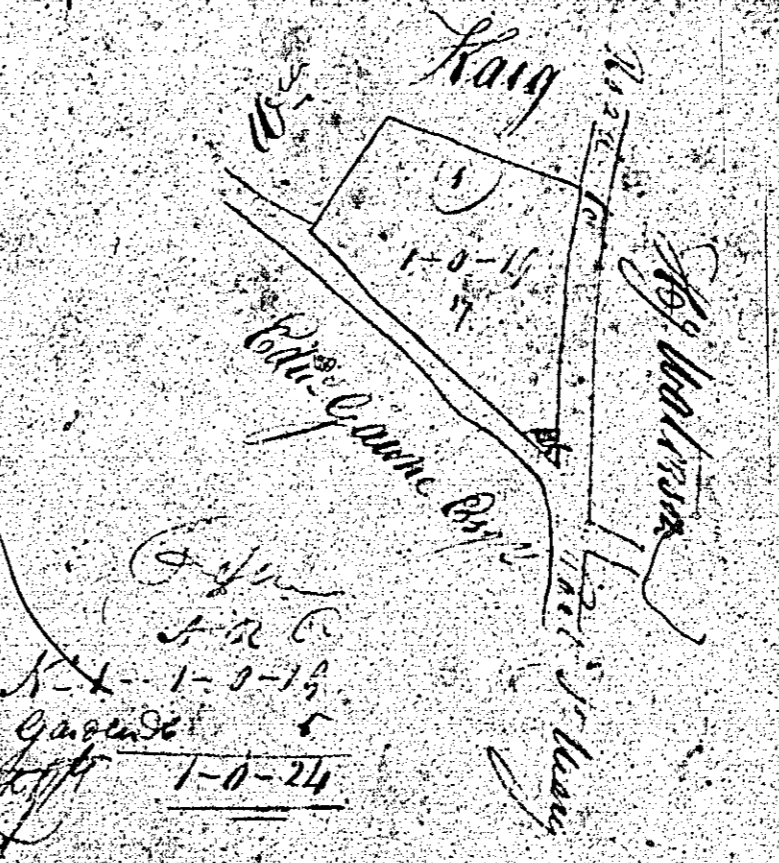

Then chains to a Foch

